

B.M. CY 5491 ELEV. 141.545
 FROM T&B W/D. CO. BY LA CIENEGA BLVD
 SERVICE ISLAND 1" NO. R.A. NO. R.L.A.
 CIENEGA AND 28" NO. R. 64th ST.
 GULVEY QUAD. 19 80

3" S.P. 19391 - WIRE SIZE IN W/D. IN SERVICE TO
 LA CIENEGA BLVD 3" NO. R.A. 64th ST. (NO. R.L.A.)
 BY (FD LEAD & STK. - NOT MAINTAINED)
 ELEV. 142.070 1975

NOTE: All elevations on these plans
 are based on L.A. Co. Rd. Dept.
 B.M. CY 5191, Add 0.14' to agree with
 City of L.A. B.M. 17-05291 (1975).

NOTICE TO CONTRACTORS: (CITY OF L.A.)
 1. SPECIFICATIONS: ALL WORK SHALL CONFORM TO STANDARD SPECIFICATIONS FOR PUBLIC WORKS
 CONSTRUCTION, 1978 EDITION, 1980 SUPPLEMENT AND STANDARD PLAN S-810-11.
 2. THIS IMPROVEMENT CONSISTS OF WORK CALLED FOR ONLY ON THIS PLAN.
 3. ALL WORK AND MATERIAL ARE SUBJECT TO INSPECTION PURSUANT TO SECTION 2-10
 OF THE STANDARD SPECIFICATIONS. CALL 465-2002 BEFORE NEARBY OF THE WORKING
 DAY BEFORE THE DAY INSPECTION IS REQUIRED. (FOR SEWER HOUSE CONNECTIONS)

4. THE CONTRACTOR SHALL SALVAGE AND RETURN M.M. FRAMES AND COVERS TO THE L.A. CO.
 SEWER MAINTENANCE YARD, #29 W. 68TH ST., L.A. 90048, TEL. 233-3930.

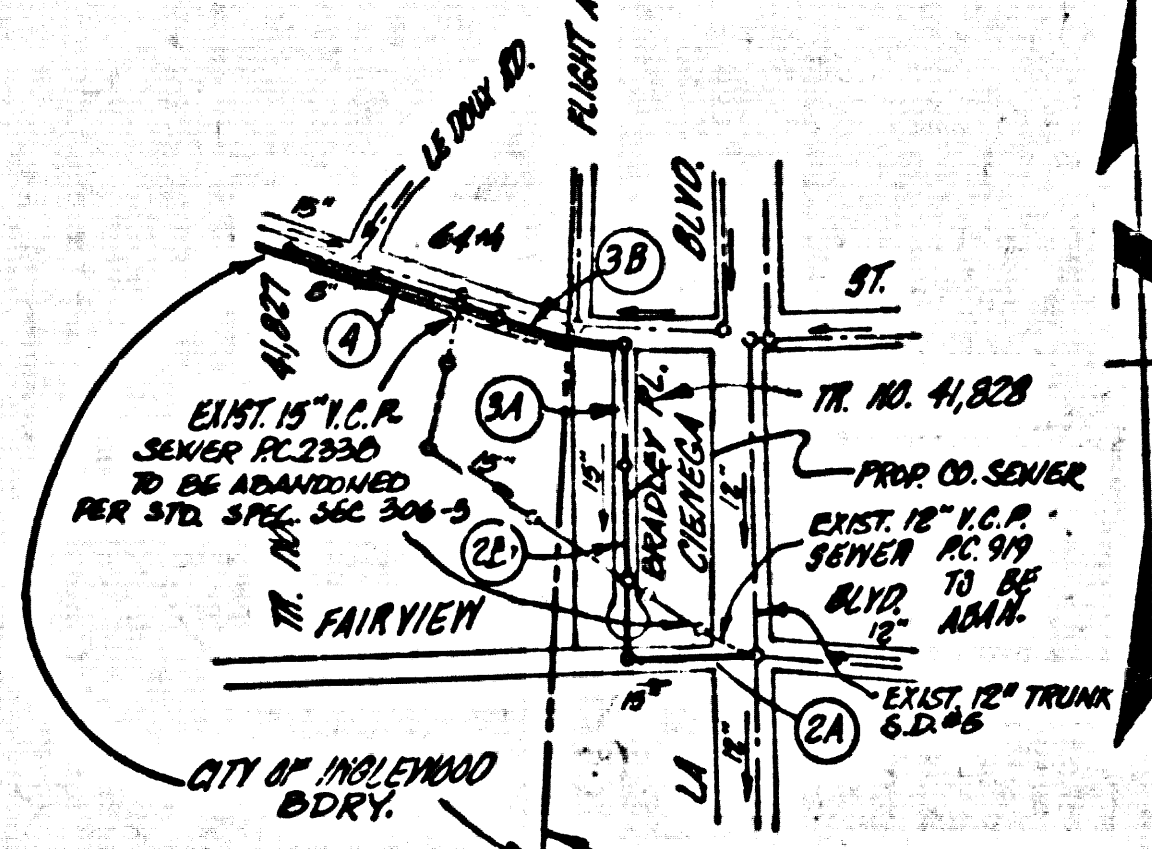

INDEX MAP
 P.C. 10021
 TR. NO. 41828
 SCALE: 1" = 600'

Prepared in the office of
Church Engineering, Inc.
 Consulting Civil Engineers 3931 Birch Street
 Newport Beach CA 92660
 Land Planners (714) 540-7377
 Land Surveyors

Douglas W. Bender
 DOUGLAS W. BENDER, R.C.E. 20946
 3/25/82 DATE

REVISION NO. 1 FEB. 16, 1983
 REVISED M.M. LOCATION FROM STA. 4150 TO
 STA. 5149. LATERAL LOCATION FROM STA. 5185
 TO STA. 5187.

APPROVED: *William J. Mahoney* 2/19/83
 OFFICE OF COUNTY ENGINEER

STANDARD PLANS
 IN ADDITION TO THE FOLLOWING COUNTY SANITATION DISTRICT
 STANDARDS SHALL APPLY TO THE CONSTRUCTION OF THIS PROJECT:
 STANDARD METHOD OF INSTALLING SADDLES S-8-79
 STANDARD MANHOLE TYPE "D" S-8-204
 STANDARD 24" MANHOLE FRAME & COVER S-8-207
 STANDARD MANHOLE STEPS S-8-209

STANDARD PLANS (CITY OF LOS ANGELES)
 H.C. SEWERS S-10-0
 PIPE LAYS IN TRENCHES S-25-0
 CHIMNEYS S-160-0

NO CONNECTION FOR THE DISPOSAL OF INDUSTRIAL WASTES
 SHALL BE MADE TO SEWERS SHOWN ON THESE DRAWINGS UNTIL
 A PERMIT FOR INDUSTRIAL WASTEWATER DISCHARGE HAS BEEN
 ISSUED BY THE SANITATION DISTRICTS FOR SAID CONNECTION.
 BEFORE BREAKING INTO OR CONSTRUCTION ON A COUNTY
 SANITATION DISTRICT SEWER AND PRIOR TO FINAL
 ACCEPTANCE OF THE PROJECT, SANITATION DISTRICT
 INSPECTOR SHALL BE NOTIFIED BY PHONE - 468-9999-
 638-1161 SO THAT REQUIRED INSPECTION CAN BE MADE.

CITY OF INGLEWOOD
 APPROVED:
William J. Mahoney 3/13/82
 DATE

REVISION NO. 2 MAR. 17, 1983
 REVISED M.M. LOCATION FROM
 STA. 1238.81 TO 1232.00 ON PAGE 30

APPROVED: *Donald C. Thelman*
 OFFICE OF COUNTY ENGINEER

CITY OF LOS ANGELES
 DONALD C. THELMAN CITY ENGINEER

John J. Mahoney 7/14/82 4/11/82
 DIV. DIST. ENGINEER R.E. NO. DATE
John J. Mahoney 7/14/82 5/7/82
 DEPUTY ENGINEER R.E. NO. DATE
 APPROVED: *William J. Mahoney* 12/19/82
 ACTING CITY ENGINEER



GENERAL NOTES:

1. ELEVATIONS ARE IN FEET ABOVE U.S.C. & G.S. SEA LEVEL DATUM OF 1929.
2. NO REVISIONS SHALL BE MADE IN THESE PLANS WITHOUT THE APPROVAL OF THE COUNTY ENGINEER.
3. NO REPRESENTATIVE OF THE COUNTY ENGINEER WILL SURVEY OR LAY OUT ANY PORTION OF THE WORK.
4. GRADES TO WHICH THIS IMPROVEMENT IS TO BE CONSTRUCTED ARE SHOWN ON PLANS AND PROFILES. GRADE POINTS FOR TOP OF CURB, CENTER LINE OF STREET, OR CENTER LINE OF ALLEY ARE SHOWN BY CIRCLES ON P.C. 10021. AT ALL POINTS BETWEEN DESIGNATED POINTS THE GRADE SHALL BE ESTABLISHED SO AS TO CONFORM TO A STRAIGHT LINE DRAWN BETWEEN SAID DESIGNATED POINTS.
5. THE PRIVATE ENGINEER SHALL FURNISH THE COUNTY ENGINEER WITH GRANT SHEETS AND STATIONING FOR ALL HOUSE LATERALS AND "T" OR "Y" BRANCHES AND SHALL PROVIDE STAKES FOR THEM AT THEIR PROPER LOCATIONS WITH STATIONING PLANNED MAKERS. ALL HOUSE LATERALS SHALL BE CONSTRUCTED IN A STRAIGHT ALIGNMENT AT RIGHT ANGLES FROM THE MAIN LINE SEWER EXCEPT AS SHOWN ON THE PLANS. HOUSE LATERALS FROM CHIMNEYS SHALL NOT HAVE AN ANGLE OF LESS THAN 45° WITH THE MAIN LINE SEWER. ANY CHANGE IN ALIGNMENT SHALL BE NOTICED BY THE PRIVATE ENGINEER.
6. THE PRIVATE ENGINEER SHALL FURNISH THE HOUSE LATERAL BIRTH AT THE PROPERTY LINE BELOW THE TOP OF CURB ELEVATION FOR EACH HOUSE LATERAL ON THE COUNTY SIDE.
7. BEFORE WORK CAN BE STARTED, THE CONTRACTOR MUST OBTAIN A PERMIT TO EXCAVATE IN CITY STREETS FROM THE COUNTY ENGINEER'S OFFICE. THE CONTRACTOR SHALL BE RESPONSIBLE FOR THE COST OF CONSTRUCTION INSPECTION AND RECORD PLANS. BEFORE WORK CAN BE STARTED, THE CONTRACTOR MUST OBTAIN A PERMIT TO EXCAVATE IN COUNTY STREETS FROM THE L.A. COUNTY ROAD DEPT., DISTRICT OFFICE NO. 3, AND PAY A FEE TO THE COUNTY ENGINEER, 560 S. FARMINGTON, LOS ANGELES, TO COVER THE COST OF CONSTRUCTION INSPECTION AND RECORD PLANS.
8. IF WORK IS TO BE DONE IN A STATE HIGHWAY, A PERMIT MUST BE OBTAINED FROM THE STATE OF CALIFORNIA, DIVISION OF HIGHWAY, 120 SOUTH SPRING STREET, LOS ANGELES, CALIFORNIA.
9. APPROVAL OF THE PLAN BY THE COUNTY OF LOS ANGELES DOES NOT CONSTITUTE A REPRESENTATION AS TO THE ACCURACY OF THE LOCATION OF OR THE EXISTENCE OR NON-EXISTENCE OF ANY UNDERGROUND UTILITY PIPE, OR STRUCTURE WITHIN THE LIMITS OF THE PROJECT. THIS NOTE APPLIES TO ALL PAGES.
10. REFER TO SECTION 2-10.41 OF THE STANDARD SPECIFICATIONS, REGARDING SAFETY ORDER.
11. **ADDITIONAL NOTES:** THE CONTRACTOR SHALL OBTAIN AND FURNISH WITH THE CITY OF INGLEWOOD A PERMIT TO EXCAVATE IN CAL. DIV. OF INDUSTRIAL SAFETY AND A CERT. OF WORKERS COMPENSATION INS. WITH THE PERMITS ON EXHIBIT 530 S. FARMINGTON AVE., L.A. 90028, IN THE NAME OF THE CONTRACTOR TO BE NOTICED 60 DAYS PRIOR TO COMMENCEMENT OF WORK.

CONSTRUCTION NOTES:

1. WORK SHALL BE CONSTRUCTED ACCORDING TO THE STANDARD SPECIFICATIONS FOR PUBLIC WORKS CONSTRUCTION 1978 EDITION AND COUNTY ENGINEER SPECIAL PROVISIONS FOR THE CONSTRUCTION OF SANITARY SEWERS DATED 5/21/79.
2. THE CONTRACTOR SHALL NOTIFY THE DISTRICT ENGINEER BY TELEPHONE, 788-2166, AT LEAST TWENTY-FOUR HOURS BEFORE STARTING ANY WORK UNDER THIS CONTRACT.
3. HOUSE LATERALS TO BE CONSTRUCTED WITH INVERTS AT PROPERTY LINE 4 FEET BELOW CURB GRADE EXCEPT AS NOTED.
4. WYE OR T BRANCHES MAY BE USED FOR CONNECTIONS TO MAINLINE SEWERS EXCEPT AS NOTED.
5. ALL STRUCTURES SHALL BE BUILT PER MANHOLE PER S-8 OR PRECAST CONCRETE MANHOLES PER S-8, EXCEPT AS NOTED.
6. PROVIDE STAKES ON THE PROPERTY LINE OR PROPERTY LINES PRODUCED AT RIGHT ANGLES TO THE SEWER LINE AT THE CENTER LINE OF EACH MANHOLE.
7. MANHOLE TOPS IN UNIMPROVED RIGHTS OF WAY TO BE SIX INCHES ABOVE FINISHED GRADE.
8. VITRIFIED CLAY PIPE JOINTS SHALL BE TYPE "P" OR "G" PER STANDARD SPECIFICATIONS SECTION 205-2.
9. IF A POWER POLE IS WITHIN THREE FEET OF THE SEWER, THE SEWER SHALL BE ENCASED PER S-33, CASE 22 UNLESS OTHERWISE APPROVED BY THE COUNTY ENGINEER.
10. IF DURING THE COURSE OF CONSTRUCTION IT IS DETERMINED THAT THERE IS LESS THAN FOUR FEET OF COVER OVER THE TOP OF A MAIN LINE OR HOUSE LATERAL (C.P. SEWER WHICH IS NOT INDICATED ON THE PLANS, THE PIPE SHALL BE ENCASED PER S-33, CASE 22 UNLESS OTHERWISE APPROVED BY THE COUNTY ENGINEER.
11. ALL JOINTS BETWEEN CAST IRON PIPE AND VITRIFIED CLAY PIPE SHALL BE MADE WITH A RUBBER SLEEVE JOINT, TYPE "C" (WITH RUBBERING) IF NECESSARY PER STANDARD SPECIFICATIONS, SECTION 205-2.
12. SEWERS TO BE TESTED FOR LEAKAGE PER SECTION 206-1 OF THE STANDARD SPECIFICATIONS AND SPECIAL PROVISIONS.
13. RESURFACE ALL TRENCHES WITHIN PAVED AREAS TO MEET L.A. COUNTY ROAD DEPT. OR CALIFORNIA STATE ROADWAY REQUIREMENTS IN ACCORDANCE WITH PERMITS.
14. FULL COMPLIANCE WITH SECTION 206-1 OF THE SPECIAL PROVISIONS WILL BE REQUIRED FOR BACKFILL IN STREETS. CERTIFICATION OF BACKFILL COMPLETION AND LANE EQUIVALENTS BY A QUALIFIED, REGISTERED TESTING LABORATORY SHALL BE PROVIDED BY THE PERMITTEE PRIOR TO THE ISSUANCE OF A CERTIFICATE OF PARTIAL ACCEPTANCE.
15. TRAFFIC LANE REQUIREMENTS:
 LA CIENEGA BLVD - 3 LANES IN EACH DIRECTION FROM 7AM TO 9AM AND FROM 5PM TO 6 PM. 2 LANES IN EACH DIRECTION AT ALL OTHER TIMES.
 CONTRACTOR SHALL NOT WORK ON MORE THAN ONE ROADWAY AT SAME TIME.

PROFILE, ALIGNMENT AND GRADE OF
COUNTY SANITARY SEWERS PAGE 1
 TO BE CONSTRUCTED IN

TRACT NOS. 41827, 41828
 PRIVATE CONTRACT NO. 10021
 C-73
 W.S. 24

2 SHEETS, 4 PAGES
 SCALE: VERT. 1" = 8'
 HORIZ. 1" = 40'

SEPTEMBER, 1981
 PREPARED IN THE OFFICES OF
CHURCH ENGINEERING, INC.
 3931 BIRCH ST.
 NEWPORT BEACH, CA 92660
 (714) 540-7377

APPROVED: *George D. Smith* 9/15/82
 COUNTY ENGINEER

APPROVED: *Walter E. Harrison* 9/15/82
 CHIEF ENGINEER

CHECKED: *John J. Mahoney* 9/15/82
 DATE

NO. C.E. NO. 16933
 LENNOX BLDG. DIST. 7

COUNTY OF LOS ANGELES, CALIFORNIA

STAFF: J. KOONS, COUNTY ENGINEER
 WALTER E. HARRISON, CHIEF ENGINEER
 APPROVED: *George D. Smith* 9/15/82
 CHECKED: *John J. Mahoney* 9/15/82

50179

DRAWN BY PRIVATE	PROJECT ENGINEER	R.E. NO.
SUPERVISED BY	ASST. DIV. DIST. ENGINEER	R.E. NO.
REVIEWED BY	STRUCTURES	R/W
STREETS	STREETS	STREETS
STREETS	STREETS	STREETS
STREETS	STREETS	STREETS

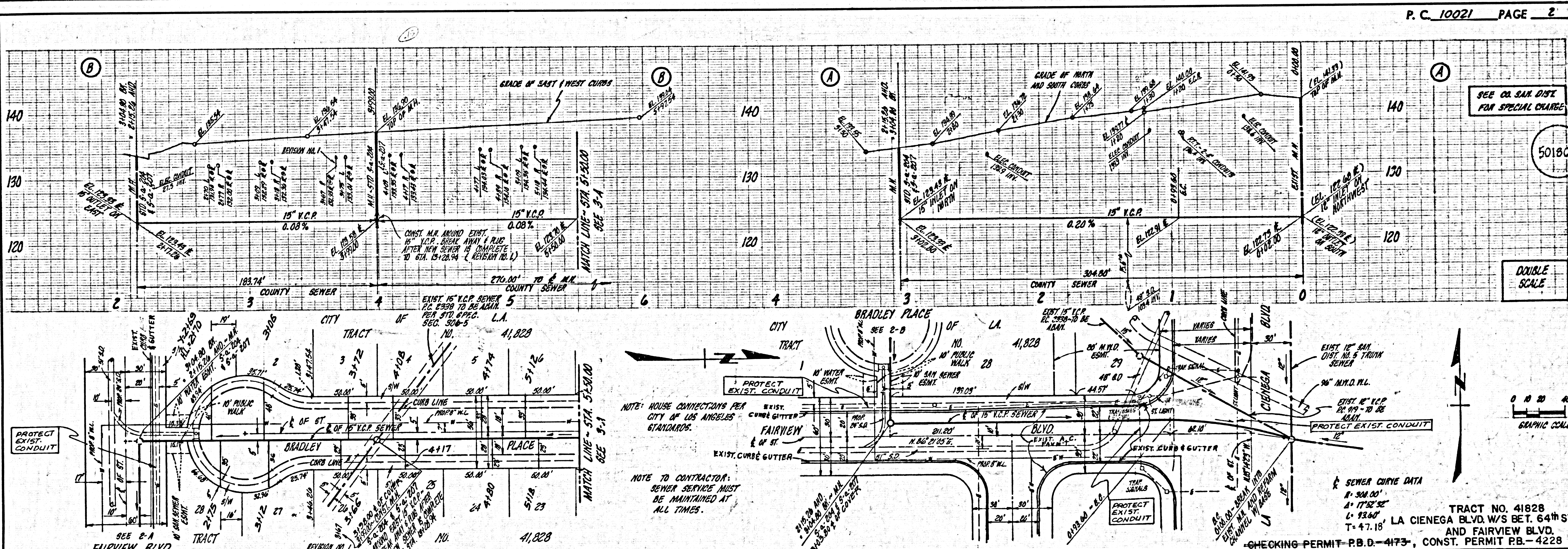

50180

DOUBLE SCALE

GRAPHIC SCALE
 0 20 40

REFERENCES	DATE	BY
DRAINAGE MAP NO. 7830		
DRAINAGE MAP NO. 559		
SUPERSEDES PLAN NO.		
INDEX GRIDS		
PROJECT DISPOSITION		
WORK ACCEPTED		
CONSTRUCTION CHANGES MADE		

TRACT NO. 41828
 LA CIENEGA BLVD. W/S BET. 64th ST.
 AND FAIRVIEW BLVD.
 T-47.18
 CHECKING PERMIT P.B.D.-4173, CONST. PERMIT PB.-4228

