

SANITARY SEWERS

TO BE CONSTRUCTED IN

TRACT No. 40583

PRIVATE CONTRACT NO. 10066

C-A-60 W.S. 62

2 SHEETS, 3 PAGES

50005

SCALE: VERT. 1"=4' HORIZ. 1"=40' MAY, 1982

PREPARED IN THE OFFICES OF E.L. PEARSON AND ASSOCIATES, 1555 W. REDONDO BEACH BLVD., GARDEN, CA. 90247

BY: REG. C. E. No. 24990

B.M. 811724 ELEV. 1366.606
C.A. C.R.D. B.M. 740 E. CURB WHITES
CANYON RD. 40' NORTH S.C.R. @ N.E.
CORNER SOLEDAD CANYON RD. @ WHITES
CANYON RD. 134 FT. N. 840 FT. E. @ INT.
NEWHALL QUAD. 19 TRADJ.

NOTE: BLDG. 2-3 IS TO BE SERVED FROM EXIST. 8" V.C.P. SEWER, P.C. 9737, LOCATED ADJACENT TO ELY BOUNDARY OF TRACT

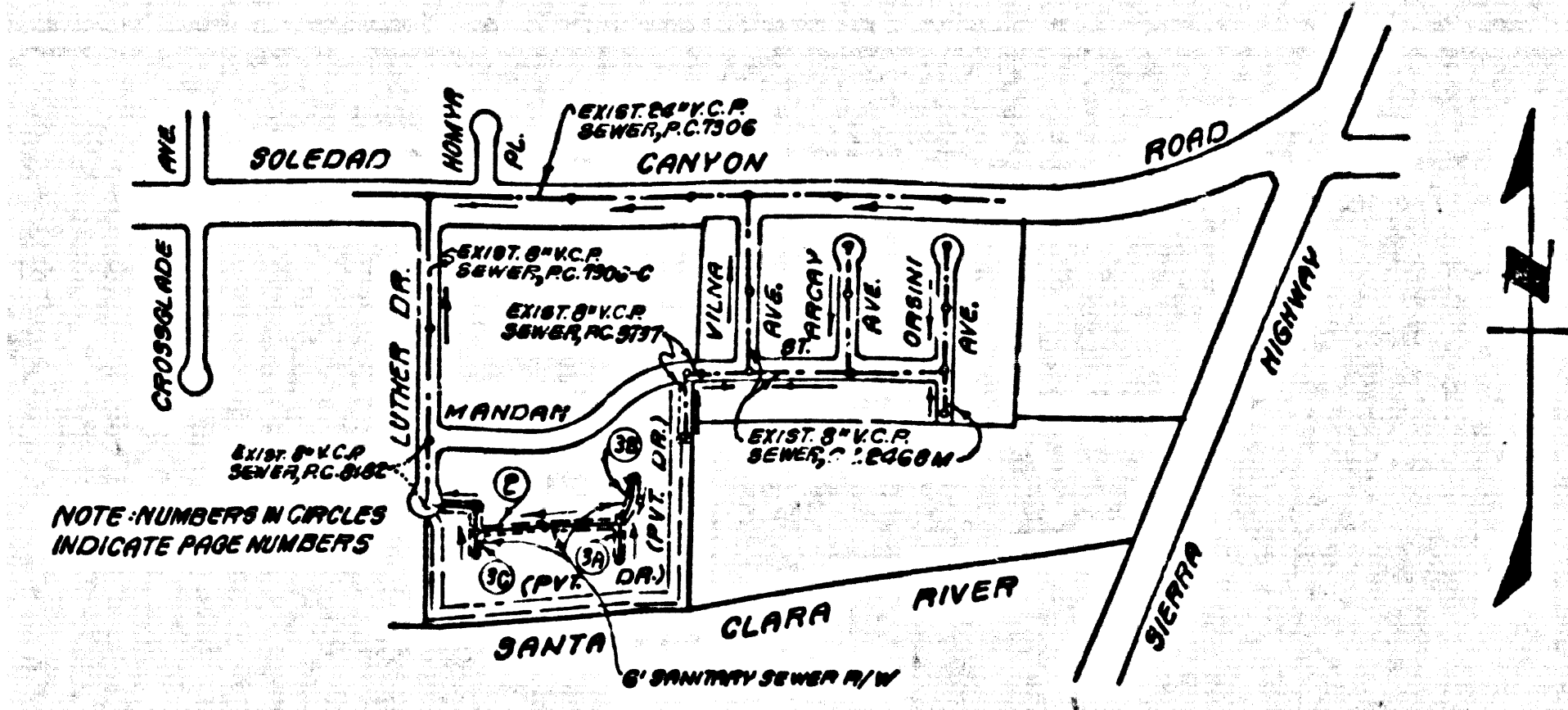

INDEX MAP TRACT No. 40583 P.C. No. 10066 SCALE: 1"=600'

NO CONNECTION FOR THE DISPOSAL OF INDUSTRIAL WASTES SHALL BE MADE TO SEWERS SHOWN ON THESE DRAWINGS UNTIL A PERMIT FOR INDUSTRIAL WASTEWATER DISCHARGE HAS BEEN ISSUED BY THE SANITATION DISTRICTS FOR SAID CONNECTION. BEFORE BREAKING INTO OR CONSTRUCTION ON A COUNTY SANITATION DISTRICT SEWER AND PRIOR TO FINAL ACCEPTANCE OF THE PROJECT, SANITATION DISTRICT INSPECTOR SHALL BE NOTIFIED BY PHONE - 962-8605, 638-1161 SO THAT REQUIRED INSPECTION CAN BE MADE.

CONSTRUCTION NOTES CONTINUED
16. FULL COMPLIANCE WITH PART 12 OF THE SPECIAL PROVISIONS IS REQUIRED FOR THE INSTALLATION OF A COMPOSITE PIPE.
17. MANHOLE WATER STOP GASKETS AND CLIMPS ARE REQUIRED FOR THE CONNECTION OF A.S.S. COMPOSITE PIPE TO MANHOLE STRUCTURES.
18. A.S.S. COMPOSITE PIPE SHALL BE USED FOR MAIN AND HOUSE LATERAL CONNECTIONS TO A.S.S. COMPOSITE MANHOLE SEWER PIPE.
19. A.S.S. COMPOSITE PIPE SHALL BE USED IN COMPLIANCE WITH THE TABLE IN SECTION 6-5.4 OF PART 12 OF THE SPECIAL PROVISIONS.
20. 3-DEGREE DEFLECTION COUPLERS SHOULD BE USED TO ACCOMPLISH RADII OF CURVATURE LESS THAN 300' FOR 8" PIPE.

THE EXISTENCE AND LOCATION OF ANY UNDERGROUND UTILITY PIPES OR STRUCTURES SHOWN ON THESE PLANS ARE OBTAINED BY A SEARCH OF THE AVAILABLE RECORDS TO THE BEST OF MY KNOWLEDGE THERE ARE NO EXISTING UTILITIES EXCEPT AS SHOWN ON THESE PLANS. THE CONTRACTOR IS REQUIRED TO TAKE THE DUE PRECAUTIONARY MEASURES TO PROTECT THE UTILITY LINES. SHOW AND NAME ALL OTHER LINES NOT OF RECORD OR NOT SHOWN ON THESE PLANS.

Robert T. Quinn
ROBERT T. QUINN R.C.E. 24990

GENERAL NOTES:

- 1. ELEVATIONS ARE IN FEET ABOVE M.S.L. UNLESS OTHERWISE NOTED.
- 2. NO REVISIONS SHALL BE MADE IN THESE PLANS WITHOUT THE APPROVAL OF THE COUNTY ENGINEER.
- 3. NO REPRESENTATIVE OF THE COUNTY ENGINEER WILL SURVEY OR LAY OUT ANY PORTION OF THE WORK.
- 4. GRADES TO WHICH THIS IMPROVEMENT IS TO BE CONSTRUCTED ARE SHOWN ON PLANS AND PROFILES. GRADE POINTS FOR TOP OF CURBS, CENTER LINE OF STREETS, OR CENTER LINE OF ALLEYS ARE SHOWN BY CIRCLES ON PROFILES. AT ALL POINTS BETWEEN DESIGNATED POINTS THE GRADE SHALL BE ESTABLISHED SO AS TO CONFORM TO A STRAIGHT LINE DRAWN BETWEEN SAID DESIGNATED POINTS.
- 5. THE PRIVATE ENGINEER SHALL FURNISH THE COUNTY ENGINEER WITH GRADE SHEETS AND STATIONING FOR ALL HOUSE LATERALS AND 12" OR 18" MANHOLES AND SHALL PROVIDE STAKES FOR THEM AT THEIR PROPOSED LOCATIONS WITH THE FOLLOWING PLAIN MARKED: ALL HOUSE LATERALS SHALL BE CONSTRUCTED IN A STRAIGHT ALIGNMENT AT RIGHT ANGLES FROM THE MAIN LINE SEWER EXCEPT AS SHOWN ON THE PLANS. HOUSE LATERALS FROM CHIMNEYS SHALL NOT HAVE AN ANGLE OF LESS THAN 45° WITH THE MAIN LINE SEWER. ANY CHANGE IN ALIGNMENT SHALL BE REQUESTED IN WRITING BY THE PRIVATE ENGINEER.
- 6. THE PRIVATE ENGINEER SHALL FURNISH THE HOUSE LATERAL DEPTH AT THE FINISHED GRADE SURFACE. ELEVATION FOR EACH HOUSE LATERAL ON THE GRADE SHEET.
- 7. BEFORE WORK CAN BE STARTED, THE CONTRACTOR MUST OBTAIN A PERMIT TO EXCAVATE IN COUNTY STREETS FROM THE L.A. COUNTY ROAD DEPT., DISTRICT OFFICE NO. 2, 480 SOUTH VENTURA ST., LOS ANGELES, CALIF. 90005, AND PAY A FEE TO THE COUNTY ENGINEER, 800 SOUTH VENTURA ST., LOS ANGELES, CALIF. 90005, TO COVER THE COST OF CONSTRUCTION INSPECTION AND RECORD PLANS.
- 8. IF WORK IS TO BE DONE IN A STATE HIGHWAY, A PERMIT MUST BE OBTAINED FROM THE STATE OF CALIFORNIA, DIVISION OF HIGHWAYS, 120 SOUTH SPRING STREET, LOS ANGELES, CALIFORNIA.
- 9. APPROVAL OF THIS PLAN BY THE COUNTY OF LOS ANGELES DOES NOT CONSTITUTE A REPRESENTATION AS TO THE ACCURACY OF THE LOCATION OF OR THE EXISTENCE OR NON-EXISTENCE OF ANY UNDERGROUND UTILITY PIPE, OR STRUCTURE WITHIN THE LIMITS OF THIS PROJECT. THIS NOTE APPLIES TO ALL PAGES.
- 10. REFER TO SECTION 7.16.1 OF THE STANDARD SPECIFICATIONS, REGARDING SAFETY ORDERS.
- 11. PRIOR TO THE ISSUANCE OF THE REQUIRED SEWER CONSTRUCTION PERMIT, THE CONTRACTOR SHALL OBTAIN AND FILE WITH THE COUNTY ENGINEER A PERMIT TO EXCAVATE IN COUNTY STREETS FROM THE LOS ANGELES COUNTY ROAD DEPARTMENT, A PERMIT FOR EXCAVATIONS AND TRENCHES FROM THE STATE OF CALIFORNIA, DIVISION OF INDUSTRIAL SAFETY AND A CERTIFICATE OF WORKERS COMPENSATION INSURANCE WITH THE DEPARTMENT OF COUNTY ENGINEER, 800 SOUTH VENTURA ST., LOS ANGELES, CALIFORNIA 90005, DATED AND FILED WITH THE CONTRACTOR AT LEAST 30 DAYS PRIOR TO CANCELLATION OF POLICY.

CONSTRUCTION NOTES:

- 1. WORK SHALL BE CONSTRUCTED ACCORDING TO THE STANDARD SPECIFICATIONS FOR PUBLIC WORKS CONSTRUCTION (1982 EDITION), AND COUNTY ENGINEER SPECIAL PROVISIONS FOR THE CONSTRUCTION OF SANITARY SEWERS DATED 11/27/81 AND SHALL BE PROSECUTED ONLY IN THE PRESENCE OF THE COUNTY ENGINEER.
- 2. THE CONTRACTOR SHALL NOTIFY THE ENVIRONMENTAL DEVELOPMENT DIVISION BY TELEPHONE, 738-2188, AT LEAST TWENTY-FOUR HOURS BEFORE STARTING ANY WORK UNDER THIS CONTRACT.
- 3. HOUSE LATERALS TO BE CONSTRUCTED WITH 1/2" PER FOOT TO RIDGE OF FINISHED GRADE, EXCEPT AS NOTED.
- 4. WYE OR TE BENDS SHALL BE USED FOR CONNECTIONS TO MANHOLES EXCEPT AS NOTED.
- 5. WYE BRANCHES ONLY MAY BE USED FOR CONNECTIONS TO MAINLINE SEWERS PER S.C.P. 7.3 (2) (D).
- 6. ALL STRUCTURES SHALL BE EITHER BRICK MANHOLES PER 8-1.3 OR PRECAST CONCRETE MANHOLES PER 8-1.3, EXCEPT AS NOTED.
- 7. PROVIDE STAKES ON THE PROPERTY LINE OR PROPERTY LINES PRODUCED AT RIGHT ANGLES TO THE SEWER LINE AT THE CENTER LINE OF EACH MANHOLE.
- 8. MANHOLE TOPS IN UNIMPROVED PORTS OF WAY TO BE SIX INCHES ABOVE FINISHED GRADE.
- 9. VITRIFIED CLAY PIPE JOINTS SHALL BE TYPE "D" OR "E" PER STANDARD SPECIFICATIONS SECTION 208-2.
- 10. IF A POWER POLE IS WITHIN THREE FEET OF THE SEWER, THE SEWER SHALL BE ENCASED, PER 8-2.6, CASE 1, TWO FEET ON EACH SIDE FROM THE POINT OF INTERFERENCE.
- 11. IF DURING THE COURSE OF CONSTRUCTION IT IS DETERMINED THAT THERE IS LESS THAN FOUR FEET OF COVER OVER THE TOP OF A MAIN LINE OR HOUSE LATERAL SEWER WHICH IS NOT INDICATED ON THE PLANS, THE PIPE SHALL BE ENCASED PER 8-2.6, CASE 1 UNLESS OTHERWISE APPROVED BY THE COUNTY ENGINEER.
- 12. ALL JOINTS BETWEEN CAST IRON PIPE AND VITRIFIED CLAY PIPE SHALL BE MADE WITH A RUBBER SLEEVE JOINT, TYPE "C" OR "D".
- 13. (WITH BUSINESS NECESSARY) PER STANDARD SPECIFICATIONS, SECTION 208-2.
- 14. ALL TRENCHES SHALL BE BACKFILLED PER SECTION 208-1.4 OF THE STANDARD SPECIFICATIONS AND SPECIAL PROVISIONS.
- 15. RESURFACE ALL TRENCHES WITHIN PAVED AREAS TO MEET L.A. COUNTY ROAD DEPT. OR CALIFORNIA STATE HIGHWAY REQUIREMENTS IN ACCORDANCE WITH PERMITS.
- 16. FULL COMPLIANCE WITH SECTION 808-1.3.3 OF THE SPECIAL PROVISIONS WILL BE REQUIRED FOR BACKFILL IN STREETS. CERTIFICATION OF BACKFILL COMPACTION AND SAND EQUIVALENTS BY A QUALIFIED, REGISTERED TESTING LABORATORY SHALL BE PROVIDED BY THE PERMITTEE PRIOR TO THE RESUME OF A CERTIFICATE OF PARTIAL ACCEPTANCE.
- 17. SPECIAL BACKFILL IN EASEMENT CONSTRUCTION: (A) BACKFILL TRENCH AND REPLACE OTHER EARTH SO AS TO ALIEVE THE NATURAL OR FINISHED GRADES AND SLOPES SHOWN ON THE DRAINAGE PLAN APPROVED FOR THE DEVELOPMENT BY THE BUILDING AND SAFETY DIVISION. (B) ALL BACKFILL AND EARTH REPLACED SHALL BE COMPACTED TO A MINIMUM OF 90% OF MAXIMUM DENSITY PER A.S.T.M. STD. METHOD OF TEST D1557 AS MODIFIED. ACCEPTABLE CERTIFICATION OF SUCH COMPACTION SHALL BE SUBMITTED TO THE ENVIRONMENTAL DEVELOPMENT DIVISION.

THE FOLLOWING LATEST REVISED STANDARD PLANS ON FILE IN THE OFFICE OF THE COUNTY ENGINEER SHALL APPLY IN THE CONSTRUCTION OF THIS PROJECT.

STANDARD PUBLIC SAFETY ENCLOSURES	8-1
BRICK MANHOLE	8-2
STANDARD MANHOLE RING	8-3
BRICK MANHOLE RING	8-4
CASTING AND ENCASING	8-5
WYE OR TE SUPPORT	8-6
ALLOWABLE TRENCH WIDTHS	8-7
SOCKET MANHOLE RING AND COVER	8-8
NON-REINFORCED PRECAST CONCRETE MANHOLE	8-9

COUNTY OF LOS ANGELES, CALIFORNIA
STEPHEN J. KOONCE, COUNTY ENGINEER WALTER E. GARRISON, CHIEF ENGINEER
APPROVED: [Signature] DATE: [Signature] DATE: [Signature] DATE: [Signature] DATE:
CHECKED: [Signature] DATE: [Signature] DATE: [Signature] DATE:
SANTA CLARITA BLDG. DIST. 8E VALLEY

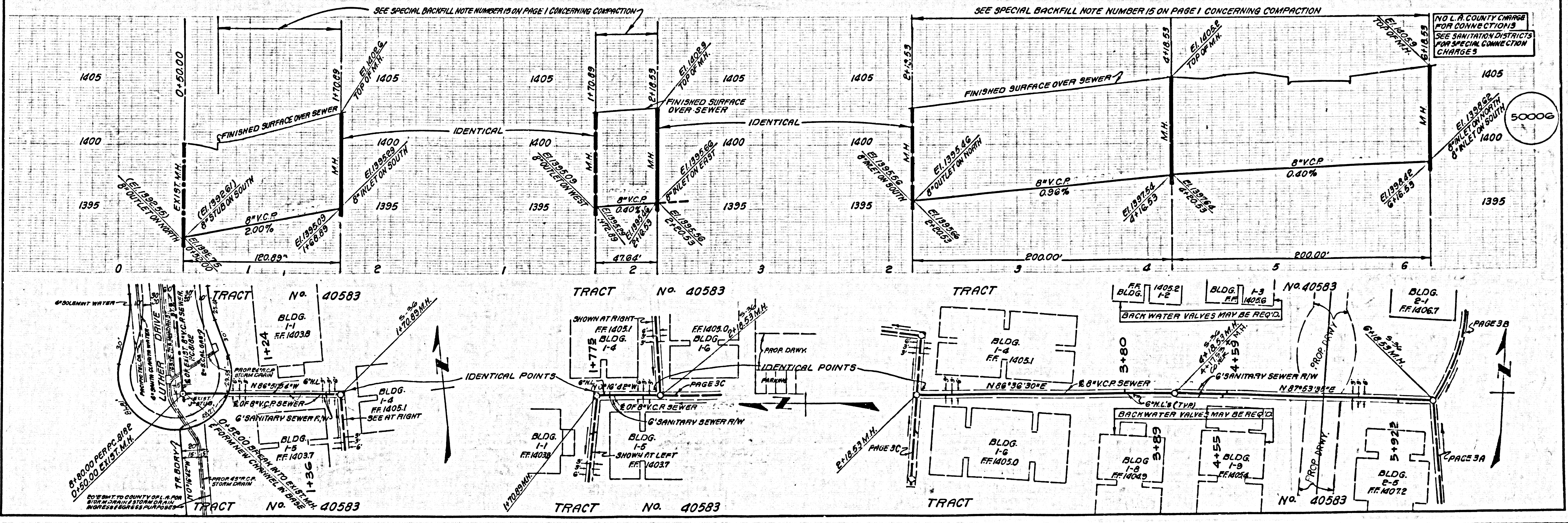

1542325
1542325
1542325

5
93001.09
68204.34 TRACT

