

B.M. CG. 670 ELEV. 362.454  
 L & T. W. CURB W. SERVICE RD.  
 80' W. OF CL. ROSEMEAD BLVD.  
 ON CL. PENTLAND ST. RD. DEPT.  
 ARCADIA QUAD. 19 82

NO CONNECTION FOR THE DISPOSAL OF INDUSTRIAL WASTES SHALL BE MADE TO SEWERS SHOWN ON THESE DRAWINGS UNTIL A PERMIT FOR INDUSTRIAL WASTEWATER DISCHARGE HAS BEEN ISSUED BY THE SANITATION DISTRICT FOR SAID CONNECTION.

BEFORE BREAKING INTO OR CONSTRUCTION ON A COUNTY SANITATION DISTRICT SEWER AND PRIOR TO FINAL ACCEPTANCE OF THE PROJECT, SANITATION DISTRICT INSPECTOR SHALL BE NOTIFIED BY PHONE - 962-8403, 929-2294, SO THAT REQUIRED INSPECTION CAN BE MADE.

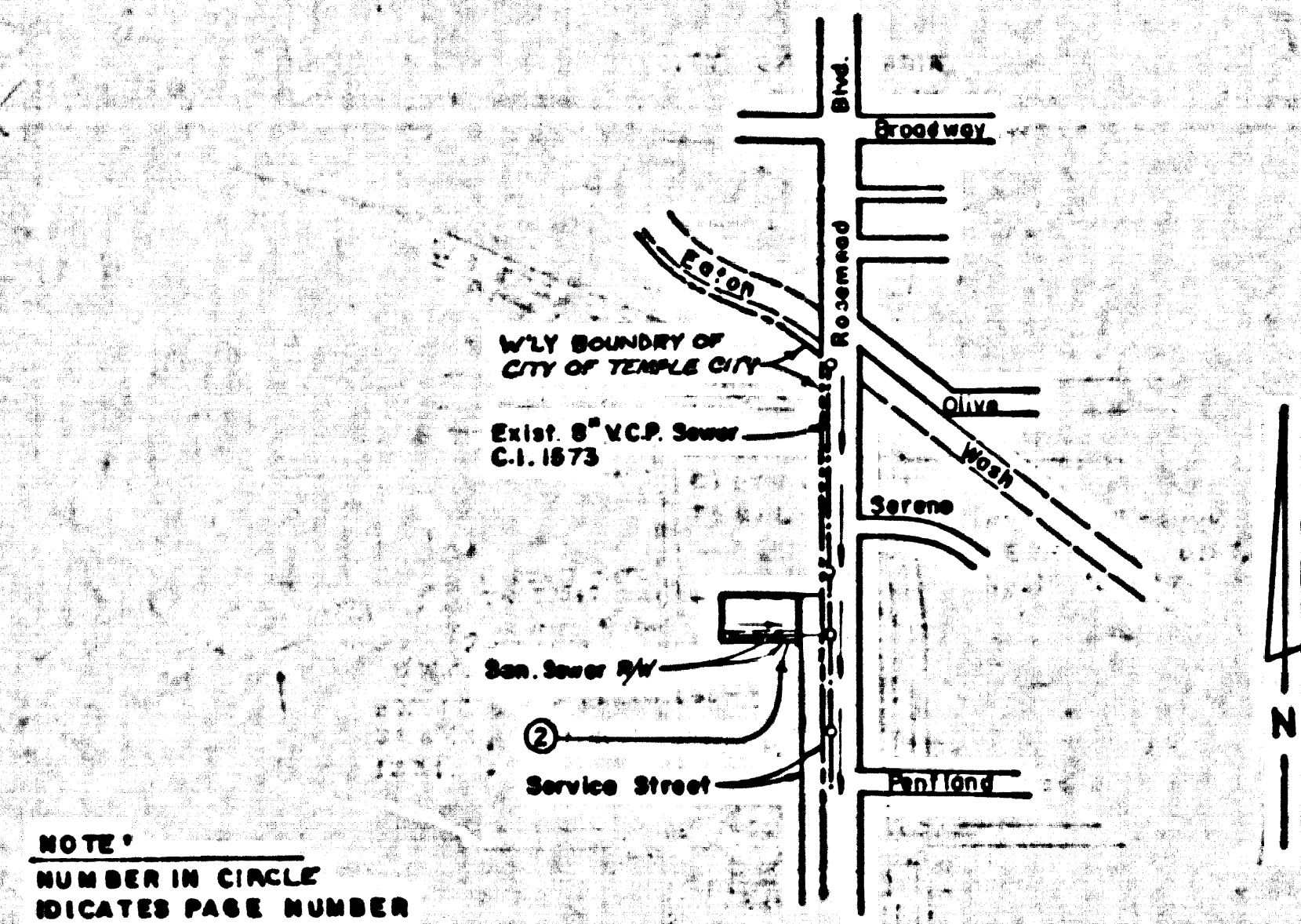

INDEX MAP  
 SCALE: 1" = 600'  
 P. C. 10118  
 TRACT No. 37547

GENERAL NOTES:

1. ELEVATIONS ARE IN FEET ABOVE U.S.C. & G.S. MEAN SEA LEVEL DATUM OF 1929.
2. NO STRUCTURES SHALL BE PLACED IN THESE AREAS WITHOUT THE APPROVAL OF THE COUNTY ENGINEER.
3. NO REPRESENTATIVE OF THE COUNTY ENGINEER SHALL SURVEY OR LAY OUT ANY PORTION OF THE WORK.
4. GRADES TO WHICH THIS IMPROVEMENT IS TO BE CONSTRUCTED ARE SHOWN ON PLANS AND PROFILES. GRADE POINTS FOR TOP OF CURBS, CENTER LINE OF STREETS, OR CENTER LINE OF ALLEYS ARE SHOWN BY CIRCLES ON PROFILES. AT ALL POINTS BETWEEN DESIGN DATA POINTS THE GRADES SHALL BE ESTABLISHED SO AS TO CONFORM TO A STRAIGHT LINE BETWEEN SAID DESIGNATED POINTS.
5. THE PRIVATE ENGINEER SHALL FURNISH THE COUNTY ENGINEER WITH GRADE SHEETS AND STATIONING FOR ALL HOUSE LATERALS AND "T" OR "Y" BRANCHES AND SHALL PROVIDE STAKE FOR THEM AT THE PROPER LOCATIONS WITH STATIONING PLAINLY MARKED. ALL HOUSE LATERALS SHALL BE CONSTRUCTED IN A STRAIGHT ALIGNMENT AT RIGHT ANGLES FROM THE MAIN LINE SEWER EXCEPT AS SHOWN ON THE PLANS. HOUSE LATERALS FROM CHIMNEYS SHALL NOT HAVE AN ANGLE OF LESS THAN 45° WITH THE MAIN LINE SEWER. ANY CHANGE IN ALIGNMENT SHALL BE REQUESTED BY WRITING BY THE PRIVATE ENGINEER.
6. THE PRIVATE ENGINEER SHALL FURNISH THE HOUSE LATERAL BIRTH AT THE PROPERTY LINE BELOW THE TOP OF CURB ELEVATION FOR EACH HOUSE LATERAL ON THE GRADE SHEET.
7. BEFORE WORK CAN BE STARTED, THE CONTRACTOR MUST OBTAIN A PERMIT TO EXCAVATE IN COUNTY STREETS FROM THE L.A. COUNTY ROAD DEPT., DISTRICT OFFICE NO. 1, AND PAY A FEE TO THE COUNTY ENGINEER, 550 S. VERMONT AVENUE, L.A., CALIF. TO COVER THE COST OF CONSTRUCTION INSPECTION AND RECORD PLANS.
8. IF WORK IS TO BE DONE IN A STATE HIGHWAY, A PERMIT MUST BE OBTAINED FROM THE STATE OF CALIFORNIA, DIVISION OF HIGHWAYS, 128 SOUTH SPRING STREET, LOS ANGELES, CALIFORNIA.
9. APPROVAL OF THIS PLAN BY THE COUNTY OF LOS ANGELES DOES NOT CONSTITUTE A REPRESENTATION AS TO THE ACCURACY OF THE LOCATION OF OR THE EXISTENCE OR NON-EXISTENCE OF ANY UNDERGROUND UTILITY PIPE, OR STRUCTURE WITHIN THE LIMITS OF THIS PROJECT. THIS NOTE APPLIES TO ALL PAGES.
10. REFER TO SECTION 7-101 OF THE STANDARD SPECIFICATIONS, REGARDING SAFETY CONES.
11. PRIOR TO THE ISSUANCE OF THE REQUIRED SEWER CONSTRUCTION PERMIT, THE CONTRACTOR SHALL OBTAIN AND FILE WITH THE COUNTY ENGINEER, COPIES OF A PERMIT TO EXCAVATE IN COUNTY STREET FROM THE LOS ANGELES COUNTY ROAD DEPARTMENT, A PERMIT FOR EXCAVATIONS AND TRENCHES FROM THE STATE OF CALIFORNIA, DIVISION OF INDUSTRIAL SAFETY AND A CERTIFICATE OF WORKERS COMPENSATION INSURANCE WITH THE DEPARTMENT OF COUNTY ENGINEER, 550 S. VERMONT RM. 408, LOS ANGELES, CALIFORNIA 90010, DATED AND SIGNED BY THE CONTRACTOR. THE CONTRACTOR SHALL BE NOTIFIED 30 DAYS PRIOR TO CANCELLATION OF POLICY.
12. ALL JOINTS BETWEEN CAST IRON PIPE AND ABS/CP SHALL BE MADE WITH APPROVED FITTINGS.

CONSTRUCTION NOTES:

1. WORK SHALL BE CONSTRUCTED ACCORDING TO THE STANDARD SPECIFICATIONS FOR PUBLIC WORKS CONSTRUCTION (1985 EDITION) AND COUNTY ENGINEER SPECIAL PROVISIONS FOR THE CONSTRUCTION OF SANITARY SEWER SYSTEMS.
2. THE CONTRACTOR SHALL NOTIFY THE ENV. DEV. DIVISION BY TELEPHONE, 738-2155, AT LEAST TWENTY (20) HOURS BEFORE STARTING ANY WORK UNDER THIS CONTRACT.
3. HOUSE LATERALS TO BE CONSTRUCTED WITH INVERTS AT PROPERTY LINE & FEET ABOVE CURB GRADE EXCEPT AS NOTED.
4. USE OF TEE BRANCHES MAY BE USED FOR CONNECTIONS TO MAINLINE SEWERS IF U.S.P. IS USED.
5. ALL STRUCTURES SHALL BE EITHER BRICK MANHOLES PER S-3 OR PRECAST CONCRETE MANHOLES PER S-36, EXCEPT AS NOTED.
6. PROVIDE STAKES ON THE PROPERTY LINE OR PROPERTY LINE PRODUCED AT RIGHT ANGLES TO THE SEWER LINE AT THE CENTER LINE OF EACH MANHOLE.
7. MANHOLE TOPS IN UNIMPROVED PORTS OF WAY TO BE SIX INCHES ABOVE FINISHED GRADE.
8. WITHIN CLAY PIPE JOINTS SHALL BE TYPE "W", "Y" OR "Z" PER STANDARD SPECIFICATIONS SECTION 300-5.
9. IF A POWER POLE IS WITHIN THREE FEET OF THE SEWER, THE SEWER SHALL BE ENCASED PER S-35, CASE II, TWO FEET ON EACH SIDE FROM THE POINT OF INTERFERENCE.
10. IF DURING THE COURSE OF CONSTRUCTION IT IS DETERMINED THAT THERE IS LESS THAN FOUR FEET OF COVER OVER THE TOP OF A MAIN LINE OR HOUSE LATERAL V.C.P. SEWER WHICH IS NOT INDICATED ON THE PLANS, THE PIPE SHALL BE ENCASED PER S-35, CASE II, UNLESS OTHERWISE APPROVED BY THE COUNTY ENGINEER.
11. ALL JOINTS BETWEEN CAST IRON PIPE AND WITHIN CLAY PIPE SHALL BE MADE WITH A RUBBER SLEEVE JOINT, TYPE "C" OR "D", WITHIN RABBITS IF NECESSARY PER STANDARD SPECIFICATIONS, SECTION 300-5.
12. SEWERS TO BE TESTED FOR LEAKAGE PER SECTION 300-16 OF THE STANDARD SPECIFICATIONS AND SPECIAL PROVISIONS.
13. INSURE ALL TRENCHES WITHIN PAVED AREAS TO MEET L.A. COUNTY ROAD DEPT. OR CALIFORNIA STATE HIGHWAY REQUIREMENTS IN ACCORDANCE WITH PERMITS.
14. FULL COMPLIANCE WITH SECTION 306-1.5 OF THE SPECIAL PROVISIONS WITH REGARDING PROTECTION FOR SCAFFOLD IN STREETS. CERTIFICATION OF BACKFILL COMPACTION AND SAND EQUIVALENTS IN A CHANNEL, REGISTERED TESTING LABORATORY SHALL BE PROVIDED BY THE PERMITTEE PRIOR TO THE ISSUANCE OF A CERTIFICATE OF FINAL ACCEPTANCE.

15. SPECIAL BACKFILL IN EASEMENT CONSTRUCTION
  - a. Backfill trench and replace other earth so as to achieve the natural or finished grades and slopes shown on the grading plan approved for this development by the Building and Safety Division.
  - b. All backfill and earth replaced shall be compacted to a minimum of 90% of maximum density per A.S.T.M. standard method of test D698-57T as modified. Acceptable certification of such compaction shall be submitted to the Design Division.
16. Full compliance with Part IV of the special provisions is required for the installation of A.B.S. composite pipe.
17. Manhole water stop gaskets & clamps are required for the connection of A.B.S. composite pipe to manhole structures.
18. A.B.S. solid wall pipe must be used for Wye and house lateral connections to A.B.S. composite mainline sewer pipe.
19. A.B.S. COMPOSITE PIPE SHALL BE BEDDED IN CONFORMANCE WITH THE TABLE IN SECTION 3-31 OF PART III OF THE SPECIAL PROVISIONS.
20. S-DEGREE DEFLECTION COUPLERS SHALL BE USED TO ACCOMPLISH RADIUS OF CURVATURE LESS THAN 90°.

TO BE CONSTRUCTED IN  
**TRACT NO. 37547**  
**PRIVATE CONTRACT NO. 10118**

W.S. 44-4-20  
 1 SHEET, 2 PAGES  
 SCALE: HORIZ. 1" = 40' VERT. 1" = 4'  
 FEBRUARY, 1983  
 PREPARED IN THE OFFICES OF  
 LOREN PHILLIPS & ASSOC.  
 1740 E. HUNTINGTON DRIVE  
 DIARTE, CA. 91010  
 P.M. 1813 681-7885  
 BY: *Loren Phillips*  
 REG. C.E. No. 30343

50091

THE FOLLOWING LATEST REVISED STANDARD PLANS ON FILE IN THE OFFICE OF THE COUNTY ENGINEER SHALL APPLY IN THE CONSTRUCTION OF THIS PROJECT.

STANDARD PUBLIC SAFETY REQUIREMENTS	S-3
BRICK MANHOLES	S-35
STANDARD MANHOLE BIRTH	S-37
MANHOLES FOR POWER POLES	S-38
CHANNELS AND ENCASUREMENT	S-39
WYE OR TEE SUPPORT	S-35
ALLOWABLE TRENCH WIDTHS	S-36
BEDDING MANHOLES FRAMES AND COVERS	S-38
NON-REINFORCED PRECAST CONCRETE MANHOLES	S-36

COUNTY OF LOS ANGELES, CALIFORNIA  
 STEPHEN A. KOONCE, COUNTY ENGINEER WALTER GARRISON, CHIEF ENGINEER  
 CO. SAN DIST. NO. 18  
 APPROVED *George D. Smith* 3/2/83 APPROVED *Walter Garrison* 3/2/83  
 CHECKED *Ralph D. Smith* 3/2/83  
 REG. C.E. NO. 16833  
 Temple City BLDG. DIST. 508

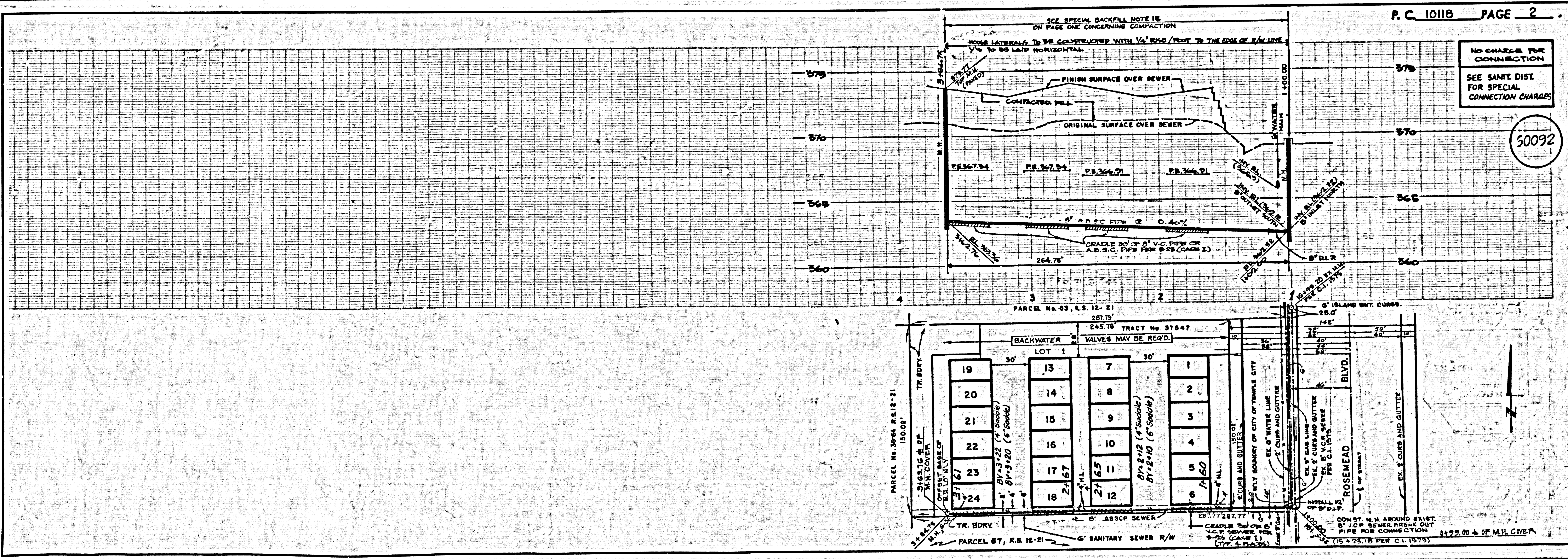

NO CHARGES FOR CONNECTION  
 SEE SANIT. DIST. FOR SPECIAL CONNECTION CHARGES

50092