

SANITARY SEWERS
TO BE CONSTRUCTED IN
PARCEL MAP NO. 15163

PRIVATE CONTRACT NO. 10162

C-81
WS 26
SHEET 2 PAGES

50639

SCALE: 1" = 10'
BY: Edward L. Pearson
REG. C.E. NO. 8783

PC 10162
WS 26

GENERAL NOTES:

- Elevations are in feet above U.S.C.G.S. sea level datum of 1929.
- NO REVISIONS SHALL BE MADE IN THESE PLANS WITHOUT THE APPROVAL OF THE COUNTY ENGINEER.
- NO REPRESENTATIVE OF THE COUNTY ENGINEER WILL SURVEY OR LAY OUT ANY PORTION OF THE WORK.
- GRADIENTS TO WHICH THIS IMPROVEMENT IS TO BE CONSTRUCTED ARE SHOWN ON PLANS AND NO PRIVATELY GRADE POINTS FOR TOP OF CURBS, CENTER LINE OF STREETS, OR CENTER LINE OF ALLEYS ARE SHOWN BY UNLESS INDICATED BY A POINT BETWEEN DESIGNATED POINTS THE GRADE SHALL BE ESTABLISHED TO A STRAIGHT LINE UNLESS OTHERWISE SPECIFIED.
- THE PRIVATE ENGINEER SHALL FURNISH THE COUNTY ENGINEER WITH GRADE SHEETS AND STATIONING IN ALL HOUSE LATERALS AND TOP OF BRANCHES AND SHALL PROVIDE STAKES FOR THESE PLACES WITH STATIONING IN ALL HOUSE LATERALS AND TOP OF BRANCHES AND SHALL PROVIDE STAKES FOR THESE PLACES WITH STATIONING IN ALL HOUSE LATERALS AND TOP OF BRANCHES AND SHALL PROVIDE STAKES FOR THESE PLACES WITH STATIONING IN ALL HOUSE LATERALS AND TOP OF BRANCHES.
- IF WORK IS TO BE DONE IN A STATE HIGHWAY, A PERMIT MUST BE OBTAINED FROM THE STATE OF CALIFORNIA, DIVISION OF HIGHWAYS, 120 SOUTH SPRING STREET, LOS ANGELES, CALIFORNIA.
- APPROVAL OF THIS PLAN BY THE COUNTY OF LOS ANGELES DOES NOT CONSTITUTE A REPRESENTATION AS TO THE ACCURACY OF THE LOCATION OF OR THE EXISTENCE OR NON-EXISTENCE OF ANY UNDERGROUND UTILITY PIPE OR STRUCTURE WITHIN THE LIMITS OF THIS PROJECT. THIS NOTE APPLIES TO ALL PAGES.
- REFER TO SECTION 7.16.41 OF THE STANDARD SPECIFICATIONS, REGARDING SAFETY GRADING.
- PRIOR TO THE ISSUANCE OF THE REQUIRED SEWER CONSTRUCTION PERMIT, THE CONTRACTOR SHALL OBTAIN AND FILE WITH THE COUNTY ENGINEER COMES ON A PERMIT TO EXCAVATE IN COUNTY STREETS FROM THE LOS ANGELES COUNTY ROAD DEPARTMENT, A PERMIT FOR EXCAVATIONS AND TRENCHES FROM THE STATE OF CALIFORNIA, DIVISION OF INDUSTRIAL SAFETY AND A CERTIFICATE OF WORKERS' COMPENSATION INSURANCE WITH THE DEPARTMENT OF COUNTY ENGINEER, 360 SOUTH VERMONT, P.O. BOX 100, LOS ANGELES, CALIFORNIA. WORK NAMED AS THE CERTIFICATE HOLDER TO BE NOTIFIED 30 DAYS PRIOR TO CANCELLATION OF PUBLIC.

CONSTRUCTION NOTES:

- WORK SHALL BE CONSTRUCTED ACCORDING TO THE STANDARD SPECIFICATIONS FOR PUBLIC WORKS CONSTRUCTION, (LATEST EDITION) WITH STANDARD COUNTY ENGINEER SPECIAL PROVISIONS FOR THE CONSTRUCTION OF SANITARY SEWERS DATED 12/20/78.
- THE CONTRACTOR SHALL NOTIFY THE ENVIRONMENTAL DEVELOPMENT DIVISION BY TELEPHONE, 799-2188, AT LEAST TWENTY-FOUR HOURS BEFORE STARTING ANY WORK UNDER THIS CONTRACT.
- HOUSE LATERALS TO BE CONSTRUCTED WITH INVERTS AT LEAST ONE FOOT BELOW CURB GRADE EXCEPT AS NOTED.
- WYE OR TEE BRANCHES MAY BE USED FOR CONNECTIONS TO MAINLINE SEWERS EXCEPT AS NOTED.
- ALL STRUCTURES SHALL BE EITHER BRICK MANHOLES PER 5-B OR PRECAST CONCRETE MANHOLES PER 5-B, EXCEPT AS NOTED.
- MANHOLE STAKES ON THE PROPERTY LINE OR PROPERTY LINES PROVIDED AT RIGHT ANGLES TO THE SEWER LINE AT THE CENTER LINE OF EACH MANHOLE.
- MANHOLE TOPS IN UNIMPROVED RIGHTS OF WAY TO BE SIX INCHES ABOVE FINISHED GRADE.
- VERTICAL CLAY PIPE JOINTS SHALL BE TYPE "D" OR "B" PER STANDARD SPECIFICATIONS SECTION 208-2.
- IF A POWER POLE IS WITHIN THREE FEET OF THE SEWER, THE SEWER SHALL BE ENCASED PER 23 CASE (A) TWO FEET ON EACH SIDE FROM THE POINT OF INTERFERENCE.
- IF DURING THE COURSE OF CONSTRUCTION IT IS DETERMINED THAT THERE IS LESS THAN FOUR FEET OF COVER OVER THE TOP OF A MAIN LINE OR HOUSE LATERAL SEWER WHICH IS NOT INDICATED ON THE PLANS, THE PIPE SHALL BE ENCASED PER 23 CASE (A) UNLESS OTHERWISE APPROVED BY THE COUNTY ENGINEER.
- ALL JOINTS BETWEEN CAST IRON PIPE AND VITRIFIED CLAY PIPE SHALL BE MADE WITH A RUBBER SLEEVE JOINT, TYPE "C" OR "D" (WITH BURRING IF NECESSARY) PER STANDARD SPECIFICATIONS, SECTION 208-2.
- SEWERS TO BE TESTED FOR LEAKAGE PER SECTION 208-1.4 OF THE STANDARD SPECIFICATIONS AND SPECIAL PROVISIONS.
- RESURFACE ALL TRENCHES WITHIN PAVED AREAS TO MEET L.A. COUNTY ROAD DEPT. OR CALIFORNIA STATE HIGHWAY REQUIREMENTS IN ACCORDANCE WITH PERMITS.
- ALL COMPLIANCE WITH SECTION 208-1.3 OF THE SPECIAL PROVISIONS WILL BE REQUIRED FOR BACKFILL IN STREETS. CENTRALIZATION OF BACKFILL COMPACTION AND SAND EQUIVALENTS BY A QUALIFIED, REGISTERED TESTING LABORATORY SHALL BE PROVIDED BY THE PERMITTEE PRIOR TO THE ISSUANCE OF A CERTIFICATE OF PARTIAL ACCEPTANCE.
- SPECIAL BACKFILL IN EASEMENT CONSTRUCTION: IN BACKFILL TRENCH AND REPLACE OTHER PARTS SO AS TO ACHIEVE THE NATURAL OR FINISHED GRADERS AND ANGLES SHOWN ON THE GRADING PLAN APPROVED FOR THIS DEVELOPMENT BY THE COUNTY AND SAFETY DIVISION. (ALL BACKFILL AND EARTH REPLACEMENT SHALL BE COMPACTED TO A MINIMUM OF 90% OF MAXIMUM DENSITY PER A.S.T.M. STD. METHOD OF TEST UNLESS OTHERWISE ACCEPTABLE CERTIFICATION OF SUCH COMPACTION SHALL BE SUBMITTED TO THE ENVIRONMENTAL DEVELOPMENT DIVISION.

THE FOLLOWING LISTED REVISIONS TO THE STANDARD PLANS ON FILE IN THE OFFICE OF THE COUNTY ENGINEER SHALL APPLY IN THE CONSTRUCTION OF THIS PROJECT:

REVISION	DATE
1. CHANGE PUBLIC SAFETY DEPARTMENT	8-2
2. CHANGE MANHOLE	8-2
3. CHANGE MANHOLE TOP	8-17
4. CHANGE HOUSE LATERAL	8-17
5. CHANGE AND BACKFILL	8-17
6. WYS IN THE SURFACE	8-17
7. ALL IN CASE TRENCH WIDTH	8-17
8. SOCKET MANHOLE FRAME AND COVER	8-17
9. MANHOLE TOPS PRECAST CONCRETE MANHOLE	8-17

COUNTY OF LOS ANGELES, CALIFORNIA
STEPHEN J. KOONCE, COUNTY ENGINEER WALTER E. GARRISON, CHIEF ENGINEER
APPROVED: George D. Smith 7/5/81 APPROVED: Walter E. Garrison 7/5/81
CHECKED: Edith Davis 7/5/81
WS CE NO. 16883
DOMINGUEZ ALBEX DIST. 13

B.M. CK 261 ELEV. 191.870
1.5' Spt. in point 18' ft. W of S of Wilmington Avenue & 1' 20" S of S of Victoria Street
GARDENA QUAD. 19 80

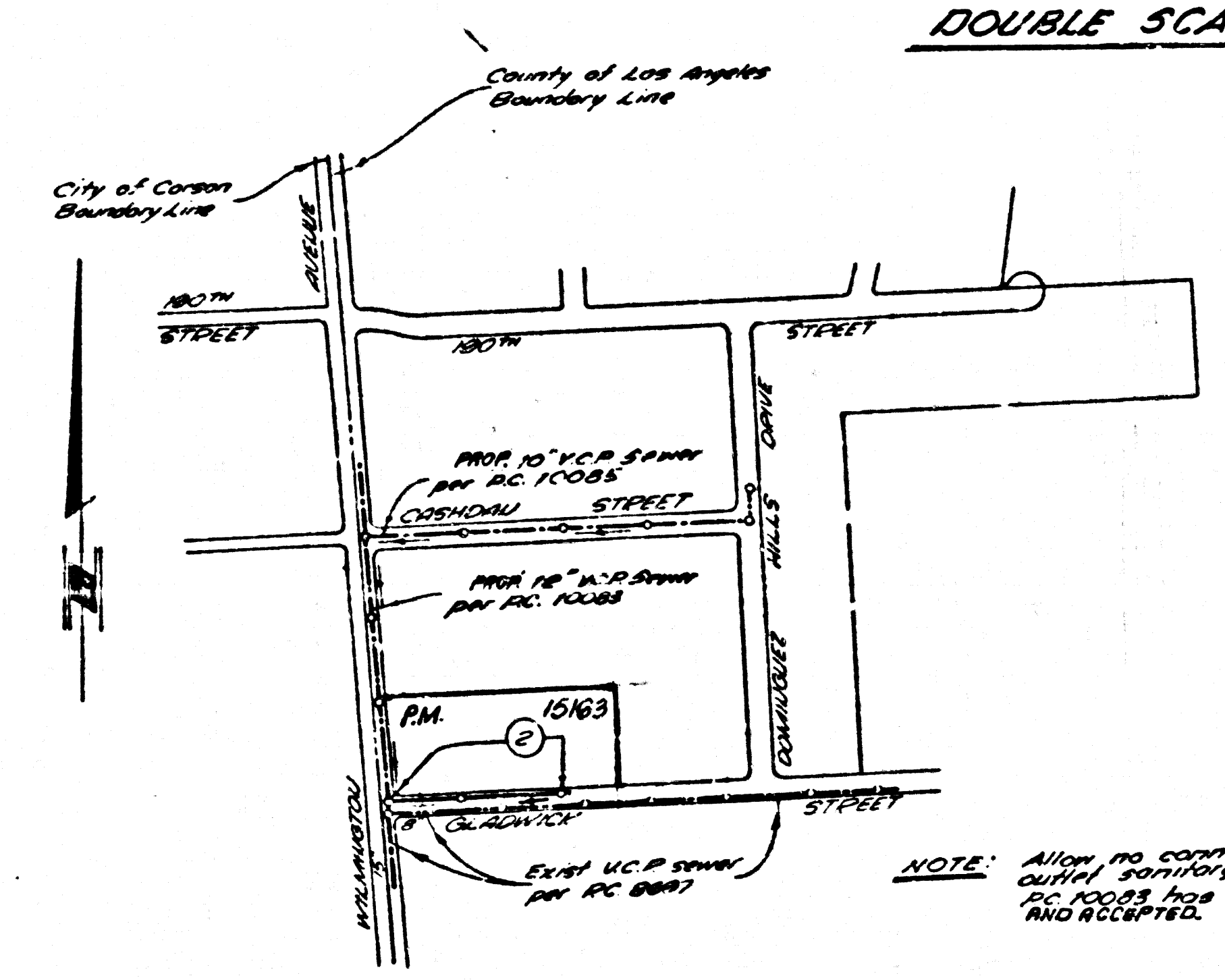

CONSTRUCTION NOTES (CONT.)
1. The contractor shall be responsible for the purchase of all pipe, fittings, manholes, etc. to be used in the construction of the sewer system. E.L. PEARSON & ASSOCIATES, 1555 W. REDONDO BEACH BLVD., TORRANCE, CALIF. 90501, is the authorized agent for the purchase of all pipe, fittings, manholes, etc. to be used in the construction of the sewer system.

INDEX MAP
Scale: 1" = 100'
PARCEL MAP NO. 15163
AC 10162

NO CONNECTION FOR THE DISPOSAL OF INDUSTRIAL WASTES SHALL BE MADE TO SEWERS SHOWN ON THESE DRAWINGS UNTIL A PERMIT FOR INDUSTRIAL WASTEWATER DISCHARGE HAS BEEN ISSUED BY THE MARSHALL DISTRICT FOR SAID CONNECTION.
BEFORE BEGAINING INTO CONSTRUCTION ON A COUNTY SANITATION DISTRICT, SANITATION DISTRICT INSPECTION SHALL BE NOTIFIED BY PHONE - 942-8405, 638-1161 SO THAT REQUIRED INSPECTION CAN BE MADE.
THE EXISTENCE AND LOCATION OF ANY UNDERGROUND PIPES, CABLES OR STRUCTURES SHOWN ON THESE PLANS ARE OBTAINED BY A SEARCH OF THE AVAILABLE RECORDS. TO THE BEST OF MY KNOWLEDGE THERE ARE NO EXISTING UTILITIES EXCEPT AS SHOWN ON THESE PLANS. THE CONTRACTOR IS REQUIRED TO TAKE THE NECESSARY PRECAUTIONARY MEASURES TO PROTECT THE UTILITY LINES SHOWN AND ANY OTHER LINES NOT OF RECORD OR NOT SHOWN ON THESE PLANS.
Edward L. Pearson
EDWARD L. PEARSON R.C.E. 8783

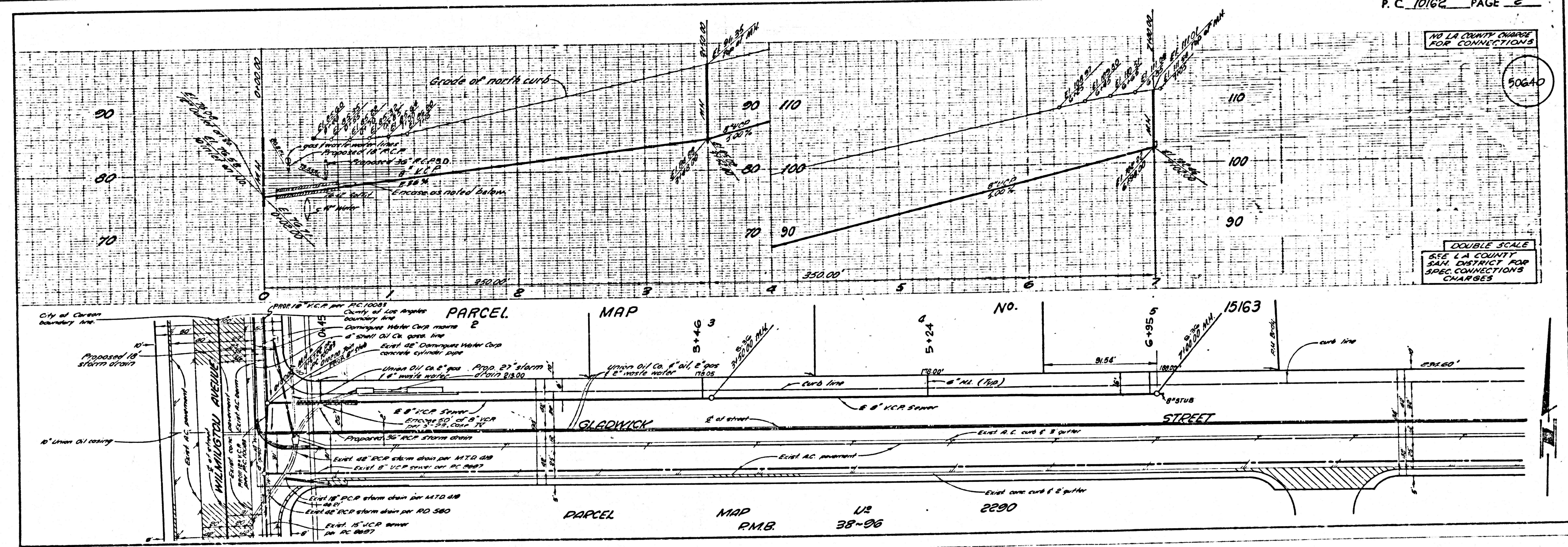

City of Culver Boundary Line
City of Los Angeles Boundary Line
WILMINGTON AVENUE
GARDENA QUAD. 19 80
PARCEL MAP NO. 15163
AC 10162
GARDENA QUAD. 19 80
PARCEL MAP NO. 2290
RMB. 38-96