

B.M. CY 4981 ELEV. 50.550  
 L + ROUND HD 6" V.C.P. 8 FT. S.N. B.C.R.  
 PLUMB CORNER COMPTON BLDG. + GRENSHAW  
 BLDG. 80 FT. N. + 35 FT. W. OF INT. MKR.  
 BASELINE QUAD. 1925

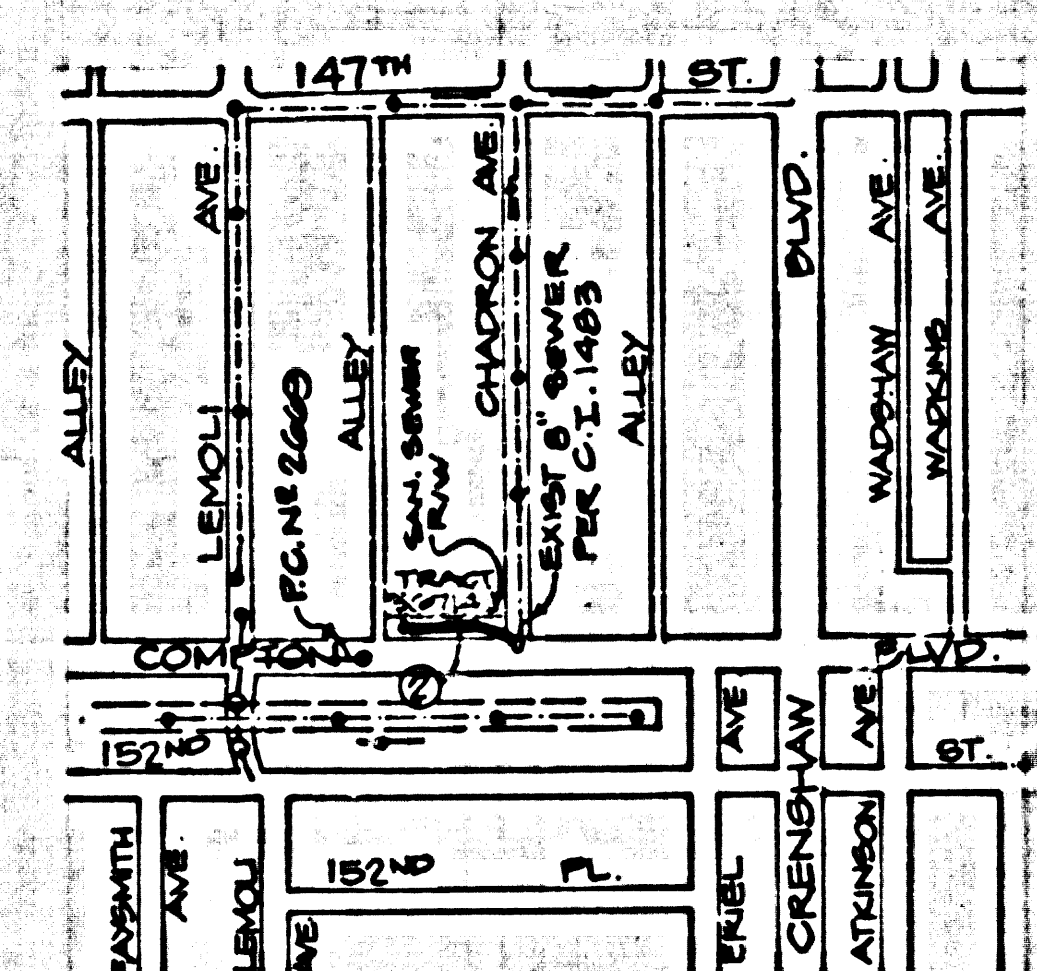
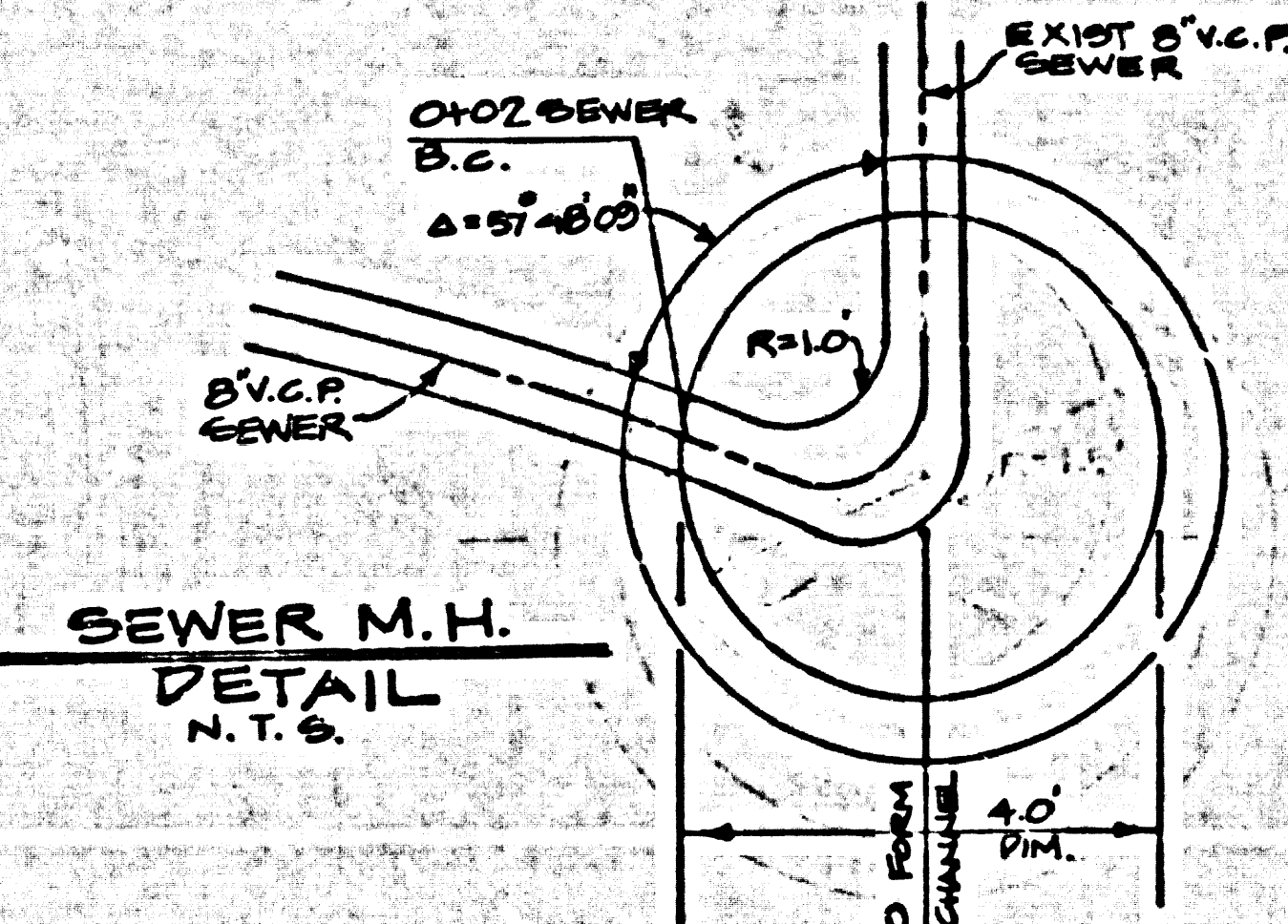

INDEX MAP  
 SCALE: 1" = 600'  
 P.C. 10166 TR. NR. 36714

NOTE:  
 NUMBER IN CIRCLE INDICATES  
 PAGE NUMBER

NO CONNECTION FOR THE DISPOSAL OF INDUSTRIAL WASTES  
 SHALL BE MADE TO SEWERS SHOWN ON THESE DRAWINGS UNTIL  
 A PERMIT FOR INDUSTRIAL WASTEWATER DISCHARGE HAS BEEN  
 ISSUED BY THE SANITATION DISTRICTS FOR SAID CONNECTION.  
 BEFORE BREAKING INTO OR CONSTRUCTION ON A COUNTY  
 SANITATION DISTRICT SEWER AND PRIOR TO FINAL  
 ACCEPTANCE OF THE PROJECT, SANITATION DISTRICT  
 INSPECTOR SHALL BE NOTIFIED BY PHONE - NUMBER  
 638-1161 SO THAT REQUIRED INSPECTION CAN BE MADE.

- GENERAL NOTES:**
1. ELEVATIONS ARE IN FEET ABOVE M.S.C. & G.S. SEA LEVEL DATUM OF 1929.
  2. NO REVISIONS SHALL BE MADE IN THESE PLANS WITHOUT THE APPROVAL OF THE COUNTY ENGINEER.
  3. NO REPRESENTATIVE OF THE COUNTY ENGINEER SHALL BE ON SITE AT ANY PORTION OF THE WORK.
  4. CHAINS TO WHICH THE IMPROVEMENT IS TO BE CONSTRUCTED ARE SHOWN ON PLANS AND PROFILES. GRADE POINTS FOR TOP OF CURBS, CENTER LINE OF STREETS, OR CENTER LINE OF ALLEYS ARE SHOWN BY CIRCLES ON PLANS AND PROFILES. GRADE POINTS FOR TOP OF MAIN LINE SEWER, OR CENTER LINE OF ALLEYS ARE SHOWN BY CIRCLES ON PLANS AND PROFILES. GRADE POINTS FOR TOP OF MAIN LINE SEWER, OR CENTER LINE OF ALLEYS ARE ESTABLISHED AS TO CONFORM TO A STRAIGHT LINE DRAWN BETWEEN SAID DESIGNATED POINTS.
  5. THE PRIVATE ENGINEER SHALL FURNISH THE COUNTY ENGINEER WITH GRADE SHEETS AND STATIONING FOR ALL HOUSE LATERALS AND "T" OR "Y" BRANCHES AND SHALL PROVIDE STAGES FOR THEM AT THESE PROPER LOCATIONS WITH STATIONING PLAINLY MARKED. ALL HOUSE LATERALS SHALL BE CONSTRUCTED IN A STRAIGHT ALIGNMENT AT RIGHT ANGLES FROM THE MAIN LINE SEWER EXCEPT AS SHOWN ON THE PLANS. HOUSE LATERALS FROM CURBSIDE SHALL NOT HAVE AN ANGLE OF LESS THAN 45° WITH THE MAIN LINE SEWER. ANY CHANGE IN ALIGNMENT SHALL BE REQUESTED IN WRITING BY THE PRIVATE ENGINEER.
  6. THE PRIVATE ENGINEER SHALL FURNISH THE HOUSE LATERAL SEWER AT THE PROPERTY LINE BELOW THE TOP OF CURB ELEVATION FOR EACH HOUSE LATERAL ON THE GRADE SHEET.
  7. BEFORE WORK CAN BE STARTED, THE CONTRACTOR MUST OBTAIN A PERMIT TO EXCAVATE IN COUNTY STREETS FROM THE L.A. COUNTY ROAD DEPT., DISTRICT OFFICE NO. 3, AND PAY A FEE TO THE COUNTY ENGINEER, 550 S. VERMONT AVE., LOS ANGELES, CALIF. 90005 TO COVER THE COST OF CONSTRUCTION INSPECTION AND INCOME TAXES.
  8. IF WORK IS TO BE DONE IN A STATE HIGHWAY, A PERMIT MUST BE OBTAINED FROM THE STATE OF CALIFORNIA, DIVISION OF HIGHWAYS, 1400 SOUTH SPRING STREET, LOS ANGELES, CALIFORNIA.
  9. APPROVAL OF THIS PLAN BY THE COUNTY OF LOS ANGELES DOES NOT CONSTITUTE A REPRESENTATION AS TO THE ACCURACY OF THE LOCATION OF OR THE EXISTENCE OR NON-EXISTENCE OF ANY UNDERGROUND UTILITY PIPE, OR STRUCTURE WITHIN THE LIMITS OF THE PROJECT. THIS NOTE APPLIES TO ALL PAGES.
  10. REFER TO SECTION 7-18.4.3 OF THE STANDARD SPECIFICATIONS REGARDING SAFETY CROSSINGS.
  11. PRIOR TO THE ISSUANCE OF THE REQUIRED SEWER CONNECTION PERMIT, THE CONTRACTOR SHALL CERTAINLY FILE WITH THE COUNTY ENGINEER, COPIES OF A PERMIT TO EXCAVATE IN COUNTY STREETS FROM THE LOS ANGELES COUNTY ROAD DEPT., A PERMIT FOR EXCAVATIONS AND TRENCHES FROM THE STATE OF CALIFORNIA, DIVISION OF INDUSTRIAL SAFETY AND A CERTIFICATE OF WORKERS COMPENSATION INSURANCE WITH THE DEPARTMENT OF COUNTY ENGINEERS, 550 S. VERMONT AVE., LOS ANGELES, CALIF. 90005, FROM 1000 HANOVER AS THE CERTIFICATE HOLDER, TO BE NOTIFIED 30 DAYS PRIOR TO CANCELLATION OF PERMIT.

- CONSTRUCTION NOTES:**
1. WORK SHALL BE CONSTRUCTED ACCORDING TO THE STANDARD SPECIFICATIONS FOR PUBLIC WORKS CONSTRUCTION 1982 EDITION WITH THE SUPPLEMENT AND COUNTY ENGINEER SPECIAL PROVISIONS FOR THE CONSTRUCTION OF SANITARY SEWERS DATED OCT. 3, 1982 AND SHALL BE PROCEEDED ONLY IN THE PRESENCE OF THE COUNTY ENGINEER.
  2. THE CONTRACTOR SHALL NOTIFY THE ENVIRONMENTAL DIVISION BY TELEPHONE, 780-2156, AT LEAST TWENTY FOUR HOURS BEFORE STARTING ANY WORK UNDER THIS CONTRACT.
  3. HOUSE LATERALS TO BE CONSTRUCTED WITH INVERTS AT PROPERTY LINE & FEET BELOW CURB GRADE EXCEPT AS NOTED.
  4. USE OF THE MANHOLES MAY BE USED FOR CONNECTIONS TO ALIEN LINE SEWERS EXCEPT AS NOTED.
  5. ALL STRUCTURES SHALL BE EITHER BRICK MANHOLES PER 5-8 OR PRECAST CONCRETE MANHOLES PER 5-36, EXCEPT AS NOTED.
  6. PROVIDE STAGES ON THE PROPERTY LINE OR PROPERTY LINE PRODUCE AT RIGHT ANGLES TO THE SEWER LINE AT THE CENTER LINE OF EACH MANHOLE.
  7. MANHOLES FOR IN UNIMPROVED RIGHTS OF WAY TO BE SEE SECTIONS ABOVE FINISHED GRADE.
  8. WITHIN CLAY PIPE JOINTS SHALL BE TYPE "B", "C", OR "D" PER STANDARD SPECIFICATIONS SECTION 306-2.
  9. IF A POWER POLE IS WITHIN THREE FEET OF THE SEWER, THE SEWER SHALL BE ENCASED, PER 5-35, CASE II, TWO FEET ON EACH SIDE FROM THE POINT OF INTERFERENCE.
  10. IF DURING THE COURSE OF CONSTRUCTION IT IS DETERMINED THAT THERE IS LESS THAN FOUR FEET OF COVER OVER THE TOP OF A MAIN LINE OR HOUSE LATERAL V.C.P. SEWER WHICH IS NOT INDICATED ON THE PLANS, THE PIPE SHALL BE ENCASED PER 5-35, CASE II UNLESS OTHERWISE APPROVED BY THE COUNTY ENGINEER.
  11. ALL JOINTS BETWEEN CAST IRON PIPE AND OTHER CAST IRON PIPE SHALL BE MADE WITH A RUBBER SLAVE JOINT, TYPE "C" OR "D", WITH GASKETS IF NECESSARY PER STANDARD SPECIFICATIONS, SECTION 306E.
  12. SEWERS TO BE TESTED FOR LEAKAGE PER SECTION 306-1.4 OF THE STANDARD SPECIFICATIONS AND SPECIAL PROVISIONS.
  13. REPAIR ALL TRENCHES WITHIN PAVED AREAS TO MEET L.A. COUNTY ROAD DEPT. OR CALIFORNIA STATE HIGHWAY REQUIREMENTS BY ACCORDANCE WITH PERMITS.
  14. FULL COMPLIANCE WITH SECTION 306-1.35 OF THE SPECIAL PROVISIONS WILL BE REQUIRED FOR BACKFILL IN STREETS. CERTIFICATION OF BACKFILL COMPACTION AND SAND EQUIVALENTS BY A QUALIFIED, REGISTERED TESTING LABORATORY SHALL BE PROVIDED BY THE CONTRACTOR PRIOR TO THE ISSUANCE OF A CERTIFICATE OF PARTIAL ACCEPTANCE.
  15. SPECIAL BACKFILL IN UNIMPROVED CONSTRUCTION: (A) BACKFILL TRENCH AND REPLACE OTHER BACKFILL SO AS TO ACHIEVE THE NATURAL OR FINISHED SURFACE AND COVERED THROUGH THE TRENCH TO THE SURFACE FOR THE PROTECTION OF THE BUILDING & SAFETY DIVISION (B) ALL BACKFILL AND SAND EQUIVALENTS SHALL BE COMPACTED TO MAXIMUM PERCENTAGE OF STANDARD TEST METHOD (C) TEST METHOD SHALL BE APPROVED BY THE COUNTY ENGINEER (D) CERTIFICATE OF SUCH COMPACTION SHALL BE SUBMITTED TO THE ENVIRONMENTAL DEVELOPMENT DIVISION.

PROFILE, ALIGNMENT AND GRADE OF  
**SANITARY SEWERS** PAGE 1  
 TO BE CONSTRUCTED IN  
**TRACT NO. 36714**  
**PRIVATE CONTRACT NO. 10166**  
 C-50  
 W.S. 25  
 1 SHEET 2 PAGES  
 SCALE: HORIZ. 1" = 40' VERT. 1" = 4'  
 JULY 1983  
 PREPARED IN THE OFFICES OF  
**DALCIN CUMMING ASSOCIATES**  
 TORRANCE CALIF. 90504, 327-0018  
 BY: *[Signature]*  
 REG. C.E. NO. 92797

THE FOLLOWING LATEST REVISED STANDARD PLANS ON FILE IN THE OFFICE OF THE COUNTY ENGINEER SHALL APPLY IN THE CONSTRUCTION OF THIS PROJECT.

BRICK	5-36
MANHOLES PER SANITATION DISTRICTS	5-36
BRICK MANHOLES	5-36
STANDARD MANHOLE STEP	5-37
BRICKING FOR SEWER PIPE	5-38
CASTING AND DISCHARGING	5-38
PIPE ON THE REPORT	5-38
ALLOWABLE TRENCH WIDTHS	5-38
SOCKET MANHOLE FRAME AND COVER	5-38
NON-BEHAVIOR PRECAST CONCRETE MANHOLES	5-38

COUNTY OF LOS ANGELES, CALIFORNIA  
 STEPHEN J. KOONCE COUNTY ENGINEER WALTER B. GARRISON CHIEF ENGINEER  
 CO. SAN. DIST. NO. 2  
 APPROVED *[Signature]* 9/9/83 APPROVED *[Signature]* 9/9/83  
 DATE DATE  
 CHECKED *[Signature]* 9/9/83 DATE  
 REG. C.E. NO. 16889  
 LENNOX BLDG. DIST. 7

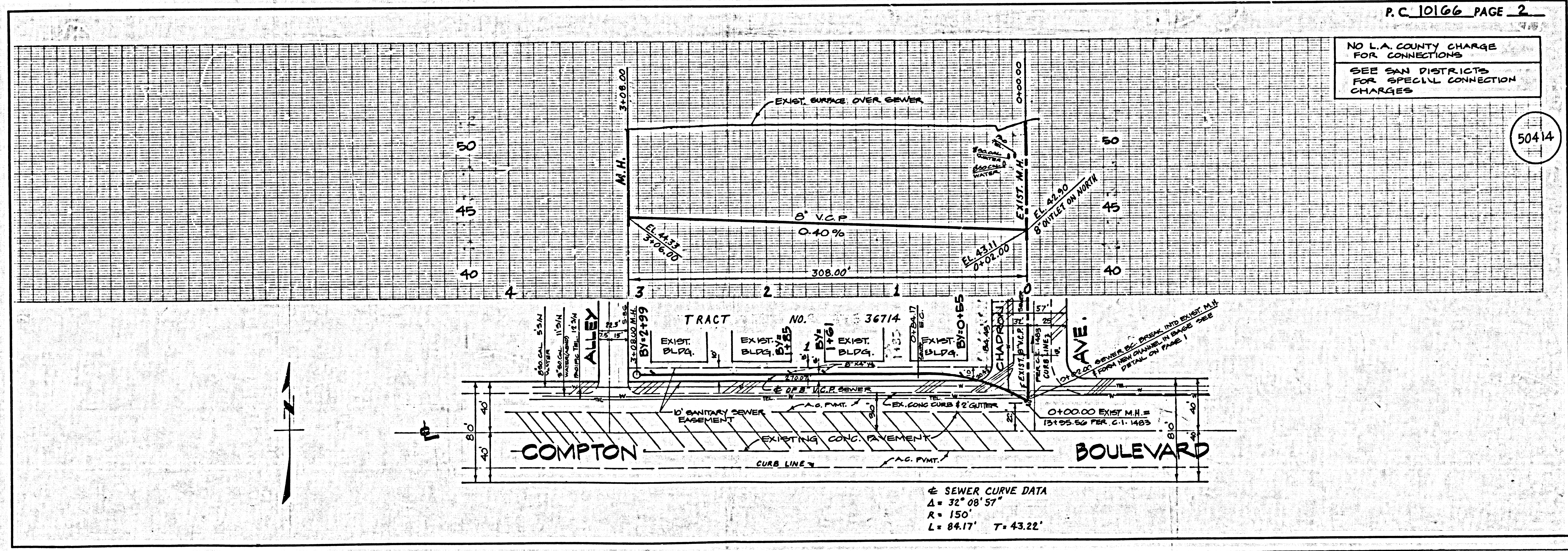

SEWER CURVE DATA  
 $\Delta = 32^{\circ} 08' 57''$   
 $R = 150'$   
 $L = 84.17'$   $T = 43.22'$

NO L.A. COUNTY CHARGE  
 FOR CONNECTIONS  
 SEE SAN DISTRICTS  
 FOR SPECIAL CONNECTION  
 CHARGES

