

B.M. C.T. 10013 ELEV. 1028.027
 L & BR 1" CONC. CO. 4FT 5/0 PARK
 GRANADA & 45FT W/O PARKWAY
 CALABASAS
 MALIBU QUAD. 19 80

PRIVATE ENGINEER'S NOTICE TO CONTRACTORS
 The existence and location of any underground utility pipes or structures shown on these plans are obtained by a search of the available records. To the best of our knowledge there are no existing utilities except as shown on these plans. The contractor is required to take due precautionary measures to protect the utility lines shown and any other lines not of record or not shown on these plans. The contractor shall be responsible for notifying "UNDERGROUND SERVICE ALERT" at 1-800-422-4133 two working days prior to any excavation or construction.

Registered Engineer R.C.E. No. 19233

GENERAL NOTES: DOUBLE SCALE

PROFILE, ALIGNMENT AND GRADE OF PAGE 1

SANITARY SEWERS
 TO BE CONSTRUCTED IN
SEWER IN RIGHT OF WAY
WEST OF PARK CAPRI
PRIVATE CONTRACT NO. 10254
 C-232, G-2
 W.S. GO
 1 SHEET, 2 PAGES

SCALE: VERT. 1" = 4' HORIZ. 1" = 20' APRIL, 1984

PREPARED IN THE OFFICES OF
 LIND & HILLER, INC.
 205 HUNTINGTON DRIVE
 SAN MARINO, CA 91108
 REG. C.E. No. 19233
 JOHN N. SARRACINO

50502

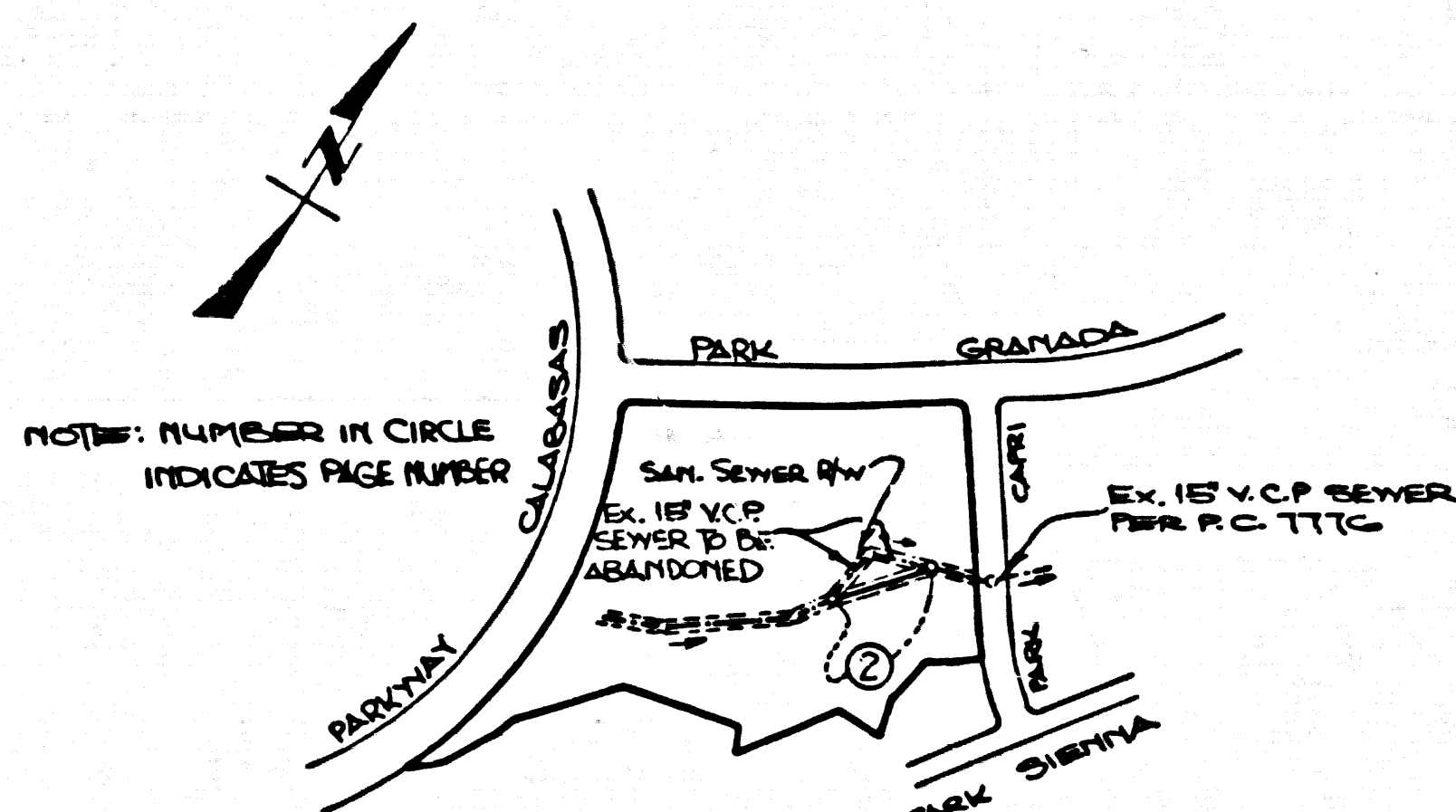

REVISION NO. 1
 APPROVED: [Signature]
 L.A. COUNTY ENGINEER
 DATE: 5/13/84

CONSTRUCTION NOTES CONT'D.

- TESTING PER LAS VIRGENES MUNICIPAL WATER DISTRICT:
 - INFILTRATION & LEAKAGE TESTS: METHOD USED FOR TESTING WILL BE THE SAME AS L.A. COUNTY EXCEPT THE FORMULA TO BE USED IS AS FOLLOWS:
 0.033 GALLONS/MINUTE/INCH OF DIAMETER/1,000 FEET OR
 250 @ 4.0 LBS/DAY/INCH OF DIAMETER/MILE
 - MANHOLE LEAKAGE TESTS: AT THE DISCRETION OF THE DISTRICT'S REPRESENTATIVE ONE MANHOLE OUT OF EVERY TEN MANHOLES, AND A MINIMUM OF TWO WILL BE FILLED WITH WATER & AFTER THREE HOURS WILL BE CHECKED FOR LEAKAGE, WITH NO DROP IN LEVEL. FOR EVERY ONE MANHOLE NOT PASSING TESTS FIVE MORE WILL BE TESTED AT THE DISCRETION OF THE DISTRICT'S REPRESENTATIVE
 - AIR TESTS: WHERE THE DIFFERENCE IN ELEVATION BETWEEN THE INVERT OF THE UPPER STRUCTURE & THE INVERT OF THE LOWER STRUCTURE IS MORE THAN SIX (6) FEET AN AIR TEST WILL BE MADE.
 THE TIME TAKEN TO LOSE ONE (1) POUND PER SQUARE INCH GAUGE PRESSURE FROM THREE (3) POUNDS PER SQUARE INCH GAUGE PRESSURE TO TWO (2) POUNDS PER SQUARE INCH GAUGE PRESSURE SHALL NOT BE LESS THAN TIMES SHOWN ON THE FOLLOWING TABLE:

PIPE SIZE (DIAMETER)	MINIMUM TIME LOSE
12"	15 MINUTES
24"	30 "
36"	45 "

 IF THE TIME IS LESS THAN LISTED IN THE TABLE ABOVE, THE CONTRACTOR SHALL MAKE SUCH REPAIRS AS ARE NECESSARY TO ELIMINATE THE EXCESSIVE LEAKAGE.

CONSTRUCTION NOTES:

- WORK SHALL BE CONSTRUCTED ACCORDING TO THE STANDARD SPECIFICATIONS FOR PUBLIC WORKS CONSTRUCTION (1982 EDITION) WITH THE SUPPLEMENTS AND COUNTY ENGINEER SPECIAL PROVISIONS FOR THE CONSTRUCTION OF SANITARY SEWERS DATED 11/81, 12/81, AND 1/82, AND SHALL BE PROSECUTED ONLY IN THE PRESENCE OF THE COUNTY ENGINEER.
- THE CONTRACTOR SHALL NOTIFY THE PROJECT MANAGEMENT DIVISION BY TELEPHONE 738-2156 AT LEAST TWENTY-FOUR HOURS BEFORE STARTING ANY WORK UNDER THIS CONTRACT.
- HOUSE LATERALS TO BE CONSTRUCTED WITH INVERTS AT PROPERTY LINE 8 FEET BELOW CURB GRADE EXCEPT AS NOTED.
- WYE OR TEE BRANCHES MAY BE USED FOR CONNECTIONS TO MAINLINE SEWERS EXCEPT AS NOTED.
- ALL STRUCTURES SHALL BE EITHER BRICK MANHOLES PER 8-3 OR PRECAST CONCRETE MANHOLES PER 8-3B, EXCEPT AS NOTED.
- PROVIDE STAKES ON THE PROPERTY LINE OR PROPERTY LINES PRODUCED AT RIGHT ANGLES TO THE SEWER LINE AT THE CENTER LINE OF EACH MANHOLE.
- MANHOLE TOPS IN UNIMPROVED RIGHTS OF WAY TO BE SIX INCHES ABOVE FINISHED GRADE.
- WYTHIFFED CLAY PIPE JOINTS SHALL BE TYPE "D" OR "E" PER STANDARD SPECIFICATIONS SECTION 308-3.
- IF A POWER POLE IS WITHIN THREE FEET OF THE SEWER, THE SEWER SHALL BE ENCASED PER 8-3B CASE 4 TWO FEET OF EACH SIDE FROM THE POINT OF INTERFERENCE.
- IF DURING THE COURSE OF CONSTRUCTION IT IS DETERMINED THAT THERE IS LESS THAN FOUR FEET OF COVER OVER THE TOP OF A MAIN LINE OR HOUSE LATERAL SEWER WHICH IS NOT INDICATED ON THE PLANS, THE PIPE SHALL BE ENCASED PER 8-3B CASE 4 UNLESS OTHERWISE APPROVED BY THE COUNTY ENGINEER.
- ALL JOINTS BETWEEN CAST IRON PIPE AND WYTHIFFED CLAY PIPE SHALL BE MADE WITH A RUBBER SLEEVE JOINT, TYPE "C" OR "D", (WITH BUSHING IF NECESSARY) PER STANDARD SPECIFICATIONS, SECTION 308-3.
- RESURFACE ALL TRENCHES WITHIN PAVED AREAS TO MEET L.A. COUNTY ROAD DEPT. OR CALIFORNIA STATE HIGHWAY REQUIREMENTS IN ACCORDANCE WITH PERMITS.
- FULL COMPLIANCE WITH SECTION 308-1.3.5 OF THE SPECIAL PROVISIONS WILL BE REQUIRED FOR BACKFILL IN STREETS. CERTIFICATION OF BACKFILL COMPACTION AND SAND EQUIVALENTS BY A QUALIFIED REGISTERED TESTING LABORATORY SHALL BE PROVIDED BY THE PERMITTEE PRIOR TO THE ISSUANCE OF A CERTIFICATE OF PARTIAL ACCEPTANCE.
- SPECIAL BACKFILL IN EASEMENT CONSTRUCTION: (A) BACKFILL TRENCH AND REPLACE OTHER EARTH SO AS TO ACHIEVE THE NATURAL OR FINISHED GRADES AND SLOPES SHOWN ON THE GRADING PLAN APPROVED FOR THE DEVELOPMENT BY THE BUILDING AND SAFETY DIVISION; (B) ALL BACKFILL AND EARTH REPLACES SHALL BE COMPACTED TO A MINIMUM OF 90% OF MAXIMUM DENSITY PER A.S.T.M. STD. METHOD OF TEST D6957 AS MODIFIED. ACCEPTABLE CERTIFICATION OF SUCH COMPACTION SHALL BE SUBMITTED TO THE PROJECT MANAGEMENT DIVISION.

THE FOLLOWING LATEST REVISED STANDARD PLANS ON FILE IN THE OFFICE OF THE COUNTY ENGINEER SHALL APPLY IN THE CONSTRUCTION OF THIS PROJECT.

MINIMUM PUBLIC SAFETY ENCLOSURE	8-3
BRICK MANHOLE	8-3
STANDARD MANHOLE STEP	8-37
REWORKING FOR SEWER PIPE	8-38
CHASING AND RECHASING	8-38
WYE OR TEE SUPPORT	8-38
ALLOWABLE TRENCH WIDTHS	8-38
SECONDARY MANHOLE FRAMES AND COVERS	8-38
NON-BRICKWORK PRECAST CONCRETE MANHOLE	8-38

COUNTY OF LOS ANGELES, CALIFORNIA
 STEPHEN J. KOONCE, COUNTY ENGINEER LAS VIRGENES MUNICIPAL WATER DISTRICT
 APPROVED: [Signature] DATE: 5/13/84
 APPROVED: [Signature] DATE: 5/13/84
 H.W. STOKES, CHIEF ENGINEER
 CHECKED: [Signature] DATE: 5/13/84
 REG. C.E. NO. 32149
 CALABASAS BLDG. DIST. 9.1

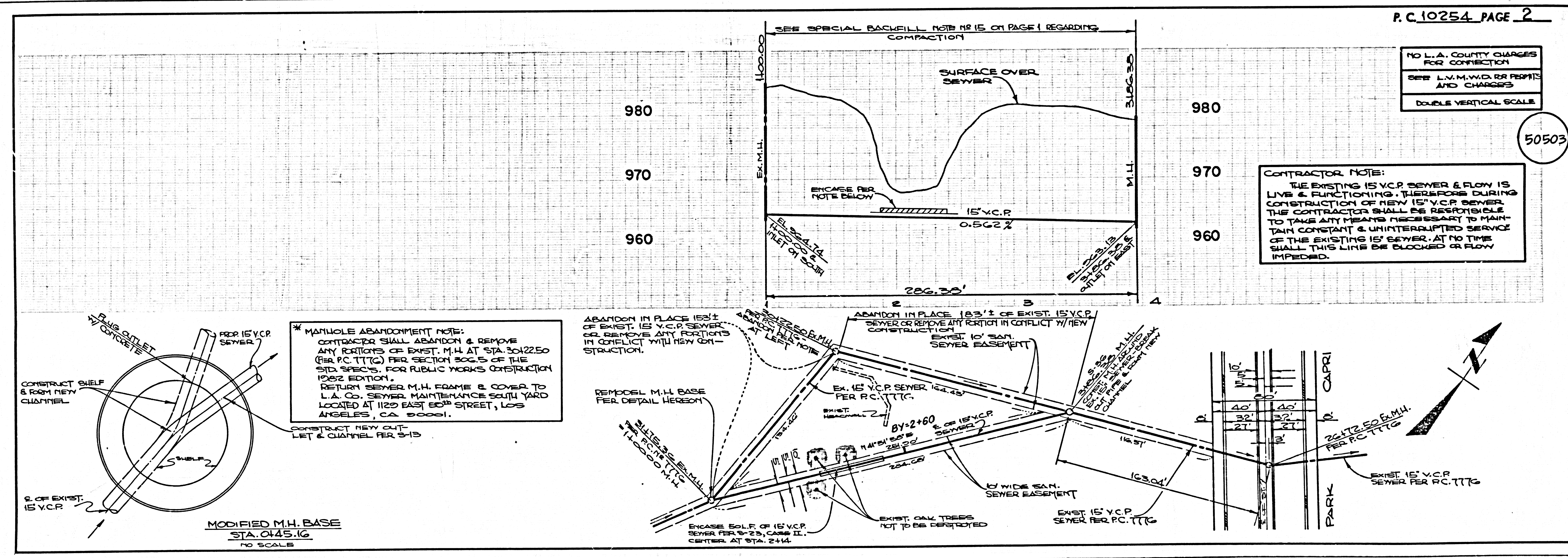

BC 10521

SEWER IN R/W WEST OF PARK CAPRI