

B.M. 104-14 ELEV. 2501.710 1977 ADJ.
CEFB 4415 Pg 20
AVE. M & 55TH ST. W. 38.5 FT. So. & 37 FT.
W. OF E. INT. 14.0 FT. So. OF P.P. # 468828E.
SET IN TOP OF A 12" CONC. POST UP 4".

DOUBLE SCALE

REVISION No. 3
PAGE 3. DELETE CHIMNEYS AT STA. 2158.82 & 2159.00
BY: [Signature] DATE: 2-5-86
APPROVED: [Signature] OFFICE OF COUNTY PUBLIC WORKS

REVISION No. 1 DATE 2-5-1986
PAGE 3. REVISED SEWER MAINLINE ALIGNMENT FROM STA. 0+35.00 TO STA. 6+14.14.
PAGE 2. REVISED GRADE OF SEWER LINE FROM STA. 3+52.00 TO STA. 6+12.14.
PAGE 3. RELOCATED MANHOLE FROM STA. 2158.82 TO STA. 2159.00.

REVISION No. 2 DATE: 4-1-86
PAGE 2. REVISED GRADE OF SEWER LINE FROM STA. 0+35.00 TO STA. 6+14.14.
PAGE 2. SPECIFIED CONSTRUCTION OF TWO (2) CHIMNEYS.
PAGE 3. SPECIFIED ENLARGEMENT OF SEWER LINE FROM STA. 0+37.00 TO STA. 2+60.00.
PAGE 3. REVISED GRADE OF SEWER LINE FROM STA. 21+19.71 TO STA. 27+79.82.
PAGE 3. SPECIFIED CONSTRUCTION OF SIX CHIMNEYS.
PAGE 3. SPECIFIED ENLARGEMENT OF SEWER LINE FROM STA. 20+78.00 TO STA. 27+79.82.
BY: [Signature] DATE: 4-1-86
APPROVED: [Signature] OFFICE OF COUNTY PUBLIC WORKS

NO CONNECTION FOR THE DISPOSAL OF INDUSTRIAL WASTES SHALL BE MADE TO SEWERS SHOWN ON THESE DRAWINGS UNTIL A PERMIT FOR INDUSTRIAL WASTEWATER DISCHARGE HAS BEEN ISSUED BY THE SANITATION DISTRICTS FOR SAID CONNECTION.

BEFORE BREAKING INTO OR CONSTRUCTION ON A COUNTY SANITATION DISTRICT SEWER PRIOR TO FINAL ACCEPTANCE OF THE PROJECT, SANITATION DISTRICT INSPECTOR SHALL BE NOTIFIED BY THIS E. (805) 468-8028 SO THAT REQUIRED INSPECTION CAN BE MADE.

NO CONNECTIONS WILL BE PERMITTED TILL OUTLET SEWER P.C. 10215 IS COMPLETED AND ACCEPTED BY COUNTY ENGINEER.

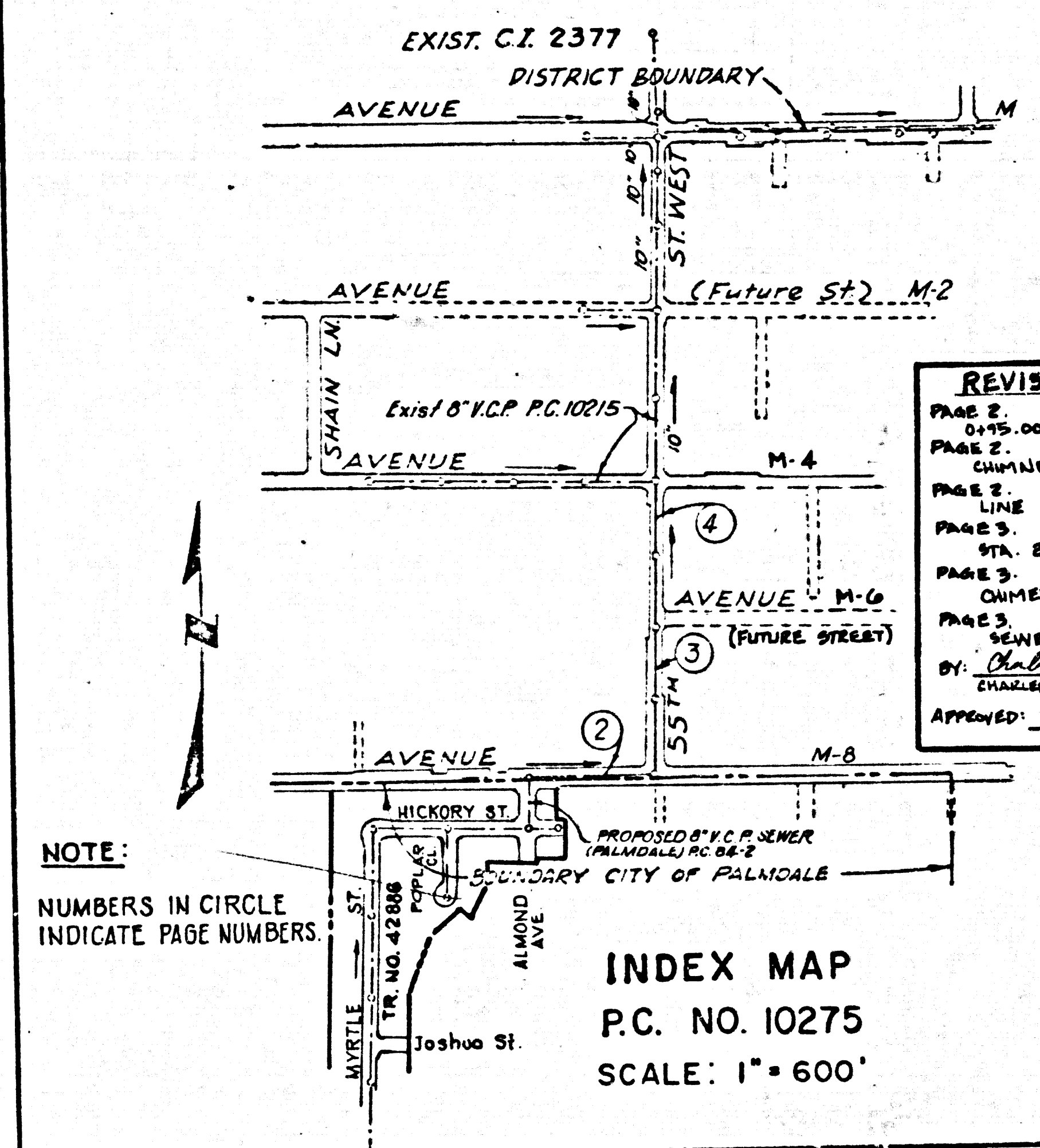

INDEX MAP
P.C. NO. 10275
SCALE: 1" = 600'

NOTE:
NUMBERS IN CIRCLE INDICATE PAGE NUMBERS.

- GENERAL NOTES:**
- ELEVATIONS ARE IN FEET ABOVE SEA LEVEL DATUM OF 1929.
 - NO REVISIONS SHALL BE MADE IN THESE PLANS WITHOUT THE APPROVAL OF THE COUNTY ENGINEER.
 - NO REPRESENTATIVE OF THE COUNTY ENGINEER WILL SURVEY OR LAY OUT ANY PORTION OF THE WORK.
 - GRADES TO WHICH THIS IMPROVEMENT IS TO BE CONSTRUCTED ARE SHOWN ON PLANS AND PROFILES. GRADE POINTS FOR TOP OF CURBS, CENTER LINE OF STREETS, OR CENTER LINE OF ALLEYS ARE SHOWN BY CIRCLES OR PROFILES. AT ALL POINTS BETWEEN DESIGNATED POINTS THE GRADE SHALL BE ESTABLISHED SO AS TO CONFORM TO STRAIGHT LINE DRAWN BETWEEN SAID DESIGNATED POINTS.
 - THE PRIVATE ENGINEER SHALL FURNISH THE COUNTY ENGINEER WITH GRADE SHEETS AND STATIONING FOR ALL HOUSE LATERALS AND "Y" OR "T" BRANCHES AND SHALL PROVIDE STAKES FOR THEM AT THEIR PROPER LOCATIONS WITH STATIONING PLAINLY MARKED. ALL HOUSE LATERALS SHALL BE CONSTRUCTED IN A STRAIGHT ALIGNMENT AT RIGHT ANGLES FROM MAIN LINE SEWER EXCEPT AS SHOWN ON THE PLANS. HOUSE LATERALS FROM CHIMNEYS SHALL NOT HAVE AN ANGLE LESS THAN 45° WITH THE MAIN LINE SEWER. ANY CHANGE IN ALIGNMENT SHALL BE REQUESTED IN WRITING BY THE PRIVATE ENGINEER BELOW THE TOP OF CURB ELEVATION FOR EACH HOUSE. LATERAL ON THE GRADE SHEET.
 - BEFORE WORK CAN BE STARTED THE CONTRACTOR MUST OBTAIN A PERMIT TO EXCAVATE IN COUNTY STREET FROM THE L.A. COUNTY ROAD DEPT. DISTRICT OFFICE, NO. 5, AND PAY A FEE TO THE COUNTY ENGINEER, 550 S. VERMONT AVENUE, LOS ANGELES, CA. 90020, TO COVER THE COST OF CONSTRUCTION INSPECTION AND RECORD PLANS.
 - IF WORK IS TO BE DONE IN A STATE HIGHWAY A PERMIT MUST BE OBTAINED FROM THE STATE OF CALIFORNIA, DIVISION OF HIGHWAYS, 120 SOUTH SPRING STREET, LOS ANGELES, CALIFORNIA.
 - APPROVAL OF THIS PLAN BY THE COUNTY OF LOS ANGELES DOES NOT CONSTITUTE A REPRESENTATION AS TO THE ACCURACY OF THE LOCATION OF OR THE EXISTENCE OF ANY UNDERGROUND UTILITY PIPE, OR STRUCTURE WITHIN THE LIMITS OF THIS PROJECT. THIS NOTE APPLIES TO ALL PAGES.
 - REFER TO SECTION 710 & 1 OF THE STANDARD SPECIFICATIONS REGARDING SAFETY ORDERS.
 - PRIOR TO THE ISSUANCE OF THE REQUIRED SEWER CONSTRUCTION PERMIT, THE CONTRACTOR SHALL OBTAIN AND FILL WITH THE COUNTY ENGINEER COPIES OF A PERMIT TO EXCAVATE IN COUNTY STREETS FROM THE LOS ANGELES COUNTY ROAD DEPARTMENT. A PERMIT FOR EXCAVATIONS AND TRENCHES FROM THE STATE OF CALIFORNIA, DIVISION OF INDUSTRIAL SAFETY AND A CERTIFICATE OF WORKER'S COMPENSATION INSURANCE WITH THE DEPARTMENT OF COUNTY ENGINEER, 550 SOUTH VERMONT, RM. 406 LOS ANGELES, CALIFORNIA, 90020, NAMED AS THE CERTIFICATE HOLDER TO BE NOTIFIED 30 DAYS PRIOR TO CANCELLATION OF POLICY.

- CONSTRUCTION NOTES:**
- WORK SHALL BE CONSTRUCTED ACCORDING TO THE STANDARD SPECIFICATIONS FOR PUBLIC WORKS CONSTRUCTION (1982 EDITION WITH 1984 SUPPLEMENTS) AND ANY ENGINEER SPECIAL PROVISIONS FOR THE CONSTRUCTION OF SANITARY SEWERS DATED SEPT. 21, 1976 AND SHALL BE PROSECUTED ONLY IN THE PRESENCE OF THE COUNTY ENGINEER.
 - THE CONTRACTOR SHALL NOTIFY THE PROJECT MANAGEMENT DIVISION BY TELEPHONE, 730-2158, AT LEAST TWENTY-FOUR HOURS BEFORE STARTING ANY WORK UNDER THIS CONTRACT. NOTIFY CO. SANITATION DIST. (805) 242-5027.
 - HOUSE LATERALS TO BE CONSTRUCTED WITH INVERTS AT PROPERTY LINE & FEET BELOW CURB GRADE EXCEPT AS NOTED.
 - WYE OR TEE BRANCHES MAY BE USED FOR CONNECTIONS TO MANHOLE SEWERS EXCEPT AS NOTED.
 - ALL STRUCTURES SHALL BE EITHER BRICK MANHOLES PER S-3 OR PRECAST CONCRETE MANHOLES PER S-36, EXCEPT AS NOTED.
 - PROVIDE STAKES ON THE PROPERTY LINE OR PROPERTY LINES PRODUCED AT RIGHT ANGLES TO THE SEWER LINE AT THE CENTER LINE OF EACH MANHOLE.
 - MANHOLE TOPS IN UNIMPROVED RIGHT OF WAY TO BE SIX INCHES ABOVE FINISHED GRADE.
 - VITRIFIED CLAY PIPE JOINTS SHALL BE TYPE "D" OR "D" PER STANDARD SPECIFICATIONS SECTION 206-2.
 - IF A POWER POLE IS WITHIN THREE FEET OF THE SEWER, THE SEWER SHALL BE ENCASED PER S-25, CASE II, TWO FEET ON EACH SIDE FROM THE POINT OF INTERFERENCE.
 - IF DURING THE COURSE OF CONSTRUCTION IT IS DETERMINED THAT THERE IS LESS THAN FOUR FEET OF COVER OVER THE TOP OF A MAIN LINE OR HOUSE LATERAL SEWER WHICH IS NOT INDICATED ON THE PLANS, THE PIPE SHALL BE ENCASED PER S-25 CASE II UNLESS OTHERWISE APPROVED BY THE COUNTY ENGINEER.
 - ALL JOINTS BETWEEN CAST IRON PIPE AND VITRIFIED CLAY PIPE SHALL BE MADE WITH A RUBBER SLEEVE JOINT, TYPE "C" OR "D" (WITH BUSHING IF NECESSARY) PER STANDARD SPECIFICATIONS, SECTION 206-2.
 - SEWERS TO BE TESTED FOR LEAKAGE PER SECTION 206-1.4 OF THE STANDARD SPECIFICATIONS AND SPECIAL PROVISIONS.
 - RESURFACE ALL TRENCHES WITHIN PAVED AREAS TO MEET L.A. COUNTY ROAD DEPT. OR CALIFORNIA STATE HIGHWAY REQUIREMENTS IN ACCORDANCE WITH PERMITS.
 - FULL COMPLIANCE WITH SECTION 206-1.15 OF THE SPECIAL PROVISIONS WILL BE REQUIRED FOR BACKFILL IN STREETS. CERTIFICATION OF BACKFILL COMPACTION AND SAND EQUIVALENTS BY A QUALIFIED, REGISTERED TESTING LABORATORY SHALL BE PROVIDED BY THE PERMITTEE PRIOR TO THE ISSUANCE OF A CERTIFICATE OF PARTIAL ACCEPTANCE.
 - SPECIAL BACKFILL ELEMENTS SHALL BE CONSTRUCTED IN BACKFILL TRENCH AND REPLACE OTHER EXISTING TO ACHIEVE THE NATURAL OR FINISHED GRADES AND SLOPES SHOWN ON THE GRADING PLAN APPROVED FOR THIS DEVELOPMENT BY THE BUILDING AND SAFETY DIVISION. METHOD OF TEST DRAWING, IF AS MODIFIED, ACCEPTABLE CERTIFICATION OF SUCH CONSTRUCTION SHALL BE SUBMITTED TO THE PROJECT MANAGEMENT DIVISION.

- THE UNDER-SIGNED IS THE COMPANY WITHIN THE LIMITS OF THIS PROJECT ARE AS FOLLOWS:
- PALM RANCH IRRIGATION DISTRICT.
 - SOUTHERN CALIFORNIA GAS COMPANY.
 - GENERAL TELEPHONE COMPANY.
 - SOUTHERN CALIFORNIA EDISON COMPANY.
 - L.A. COUNTY WATERWORK DIST. NO. 4.

PROFILE, ALIGNMENT AND GRADE OF
SANITARY SEWERS PAGE 1
TO BE CONSTRUCTED IN
AVENUE M-8 and 55TH STREET WEST
PRIVATE CONTRACT NO. 10275

A-292, C-2 & 3
W.S. 71
2 SHEETS; 4 PAGES
SCALE: VERT. 1" = 8'
HORIZ. 1" = 40'
JUNE, 1984
PREPARED IN THE OFFICES OF
ANDEL ENGINEERING COMPANY
24707 SAN FERNANDO ROAD
NEWHALL, CALIFORNIA
E.L. BOLDEN JR. R.C.E. 10533

51390

THE FOLLOWING LATEST REVISED STANDARD PLANS ON FILE IN THE OFFICE OF THE COUNTY ENGINEER SHALL APPLY IN THE CONSTRUCTION OF THIS PROJECT:

LEGEND	S-1
MINIMUM PUBLIC SAFETY REQUIREMENTS	S-2
BRICK MANHOLE	S-3
STANDARD MANHOLE STEP	S-7
BEDDING FOR SEWER PIPE	S-21
CRADLING AND ENCASUREMENT	S-23
WYE OR TEE SUPPORT	S-26
ALLOWABLE TRENCH WIDTHS	S-28
LOCKING MANHOLE FRAME AND COVER	S-36
NON-REINFORCED PRECAST CONCRETE MANHOLE	S-36

In addition, the following Standard Plans of County Sanitation District No. 14 of Los Angeles County shall apply in the construction of this project:
Standard Manhole Type "D" S-404, Standard 14" Manhole Frame & Cover S-407, Standard Manhole Step S-409.

COUNTY OF LOS ANGELES, CALIFORNIA
STEPHEN J. KOONCE, COUNTY ENGINEER
Charles W. Carry, CHIEF ENGINEER
CO. SAN. DIST. NO. 14
APPROVED: [Signature] DATE: 7/19/84
[Signature] DATE: 7-19-84
CHECKED: 32149 DATE: 7-19-84
REG. C.E. NO. [Blank]
LANCASTER, BUILDING DISTRICT NO. 3

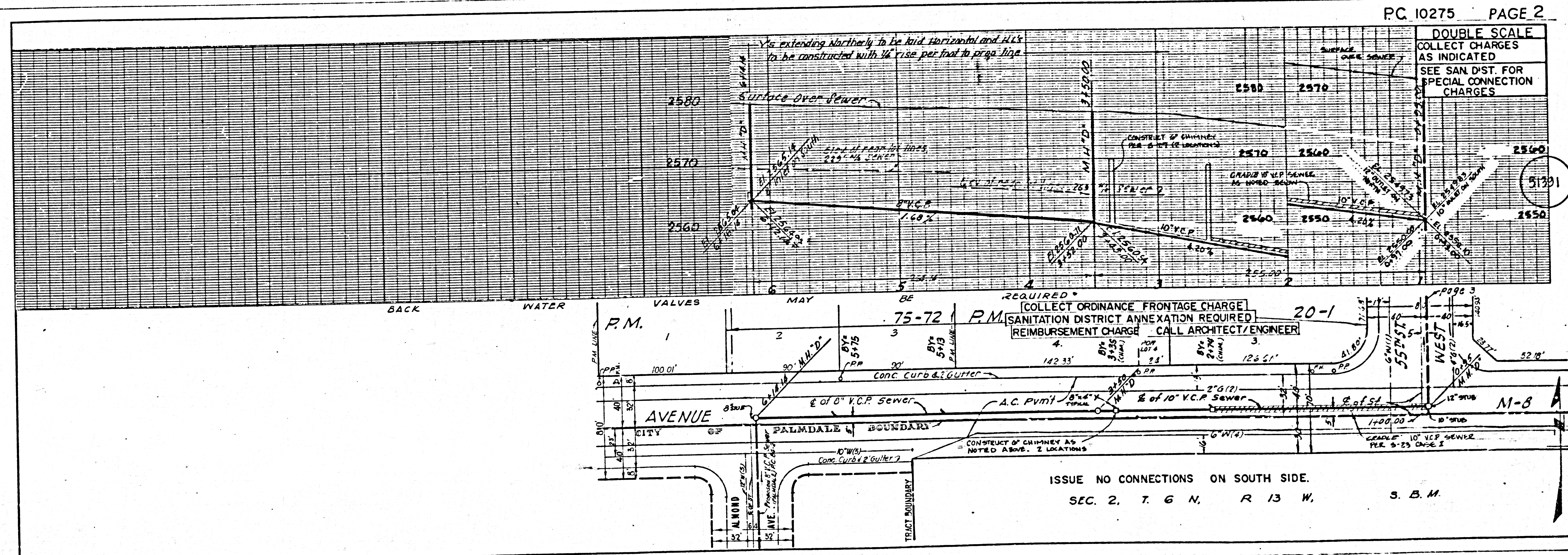

REQUIRED:
[COLLECT ORDINANCE FRONTAGE CHARGE]
[SANITATION DISTRICT ANNEXATION REQUIRED]
[REIMBURSEMENT CHARGE CALL ARCHITECT/ENGINEER]

ISSUE NO CONNECTIONS ON SOUTH SIDE.
SEC. 2, T. 6 N., R. 13 W., S. B. M.

PC. 10275 PAGE 2

DOUBLE SCALE
COLLECT CHARGES AS INDICATED
SEE SAN. DIST. FOR SPECIAL CONNECTION CHARGES

51391

