

B.M. CL 2913 ELEV. 1165.654
 RD. BM TAG EAST C.B. BOUQUET CYN RD. 30 FT.
 E/D CENTER LINE AND 175 FT. W/D CENTER
 LINE MAGIC MOUNTAIN PARKWAY
 NEWHALL QUAD. 19 78

GENERAL NOTES CONT.:
 12. ALL REFERENCES ON THIS PLAN TO THE COUNTY ENGINEER, THE ROAD DEPARTMENT, OR THE FLOOD CONTROL DISTRICT SHALL APPLY TO THOSE APPROPRIATE SECTIONS OF DEPARTMENT OF PUBLIC WORKS.

REVISION NO. 1

APPROVED -	DATE
12-24-88	

PAGE 1: KEY MAP
 PAGE 2: A. REVISE LOCATION OF EXIST. 34" GAS LINE
 B. REVISE LOCATION OF M.H. @ STA 4490 TO STA 4452 & M.H. @ STA 7718 TO 8105
 C. RAISE MAINLINE 6" OF STA 7410
 PAGE 3: ELIMINATE MAINLINE 6" OF STA. 16105. ADD M.H. @ STA 16105

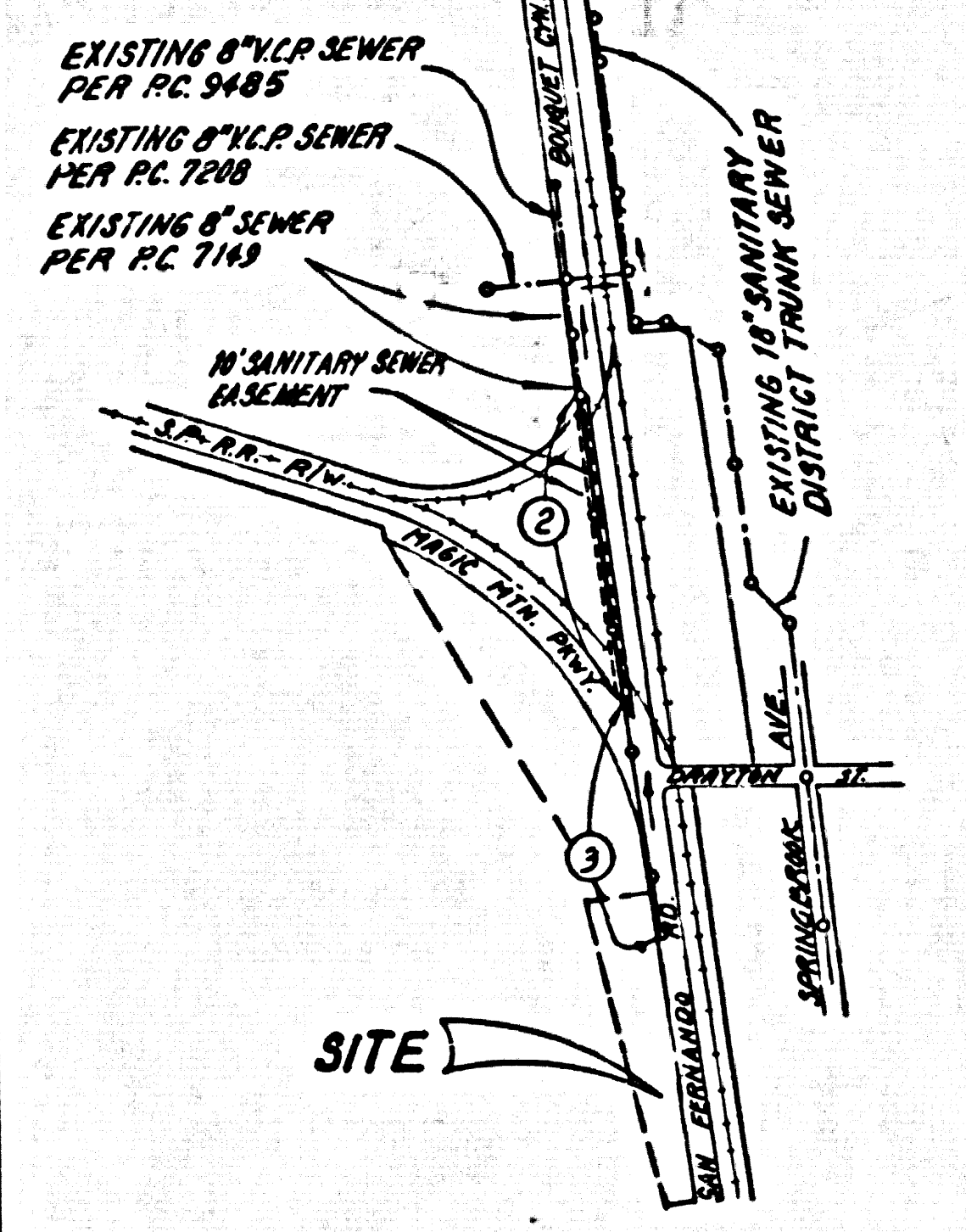

NOTE: PRIVATE EJECTOR PUMP REQUIRED TO SERVE PARCEL O.R. 1358-243

INDEX MAP - P.C. 10388
 SCALE 1"=60'
 SEWERS IN BOUQUET CYN RD.

NO CONNECTION FOR THE DISPOSAL OF INDUSTRIAL WASTES SHALL BE MADE TO SEWERS SHOWN ON THESE DRAWINGS UNTIL A PERMIT FOR INDUSTRIAL WASTEWATER DISCHARGE HAS BEEN ISSUED BY THE SANITATION DISTRICTS FOR SAID CONNECTION.
 BEFORE BREAKING INTO OR CONSTRUCTION ON A COUNTY SANITATION DISTRICT SEWER AND PRIOR TO FINAL ACCEPTANCE OF THE PROJECT, SANITATION DISTRICT INSPECTOR SHALL BE NOTIFIED BY PHONE 818 - 962-8605 SO THAT REQUIRED INSPECTION CAN BE MADE.

- GENERAL NOTES:
- ELEVATIONS ARE IN FEET ABOVE U.S.C. & G.S. SEA LEVEL DATUM OF 1929.
 - NO REVISIONS SHALL BE MADE IN THESE PLANS WITHOUT THE APPROVAL OF THE COUNTY ENGINEER.
 - NO REPRESENTATIVE OF THE COUNTY ENGINEER WILL SURVEY OR LAY OUT ANY PORTION OF THE WORK.
 - GRADES TO WHICH THIS IMPROVEMENT IS TO BE CONSTRUCTED ARE SHOWN ON PLANS AND PROFILES. GRADE POINTS FOR TOP OF CURBS, CENTER LINE OF STREETS, OR CENTER LINE OF ALLEYS ARE SHOWN BY CIRCLES ON PROFILES. AT ALL POINTS BETWEEN DESIGNATED POINTS THE GRADE SHALL BE ESTABLISHED SO AS TO CONFORM TO A STRAIGHT LINE DRAWN BETWEEN SAID DESIGNATED POINTS.
 - THE PRIVATE ENGINEER SHALL FURNISH THE COUNTY ENGINEER WITH GRADE SHEETS AND STATIONING FOR ALL HOUSE LATERALS AND "T" OR "Y" BRANCHES AND SHALL PROVIDE STAKES FOR THEM AT THEIR PROPER LOCATIONS WITH STATIONING PLAINLY MARKED AS SHOWN ON THE PLANS. HOUSE LATERALS FROM CHIMNEYS SHALL NOT HAVE AN ANGLE OF LESS THAN 45° WITH THE MAIN LINE SEWER. ANY CHANGE IN ALIGNMENT SHALL BE REQUESTED IN WRITING BY THE PRIVATE ENGINEER.
 - THE PRIVATE ENGINEER SHALL FURNISH THE HOUSE LATERAL DEPTH AT THE PROPERTY LINE BELOW THE TOP OF CURB ELEVATION FOR EACH HOUSE LATERAL ON THE GRADE SHEET.
 - BEFORE WORK CAN BE STARTED, THE CONTRACTOR MUST OBTAIN A PERMIT TO EXCAVATE IN COUNTY STREETS FROM THE L.A. COUNTY ROAD DEPT., DISTRICT 10, AND PAY A FEE TO THE COUNTY ENGINEER, 866 S. VERNON AVENUE, LOS ANGELES, CA 90005. TO COVER THE COST OF CONSTRUCTION INSPECTION AND RECORD PLANS.
 - IF WORK IS TO BE DONE IN A STATE HIGHWAY, A PERMIT MUST BE OBTAINED FROM THE STATE OF CALIFORNIA, DIVISION OF HIGHWAYS, 120 SOUTH SPRING STREET, LOS ANGELES, CALIFORNIA.
 - APPROVAL OF THIS PLAN BY THE COUNTY OF LOS ANGELES DOES NOT CONSTITUTE A REPRESENTATION AS TO THE ACCURACY OF THE LOCATION OR OF THE EXISTENCE OR NON-EXISTENCE OF ANY UNDERGROUND UTILITY PIPE, OR STRUCTURE WITHIN THE LIMITS OF THIS PROJECT. THIS NOTE APPL. TO ALL PAGES.
 - REFER TO SECTION 718.1 OF THE STANDARD SPECIFICATIONS, REGARDING SAFETY ORDERS.
 - PRIOR TO THE ISSUANCE OF THE REQUIRED SEWER CONSTRUCTION PERMIT, THE CONTRACTOR SHALL OBTAIN AND FILE WITH THE COUNTY ENGINEER COPIES OF A PERMIT TO EXCAVATE IN COUNTY STREETS FROM THE LOS ANGELES COUNTY ROAD DEPARTMENT, COUNTY ENGINEER OFFICE, 866 S. VERNON AVENUE, LOS ANGELES, CALIFORNIA, DIVISION OF INDUSTRIAL SAFETY AND A CERTIFICATE OF WORKER'S COMPENSATION INSURANCE WITH THE DEPARTMENT OF COUNTY ENGINEER, 866 SOUTH VERNON, RM. 408, LOS ANGELES, CALIFORNIA 90005, DATED AS THE CERTIFICATE HOLDER TO BE NOTIFIED 30 DAYS PRIOR TO CANCELLATION OF POLICY.

- CONSTRUCTION NOTES:
- WORK SHALL BE CONSTRUCTED ACCORDING TO THE STANDARD SPECIFICATIONS FOR PUBLIC WORKS CONSTRUCTION 1988 EDITION WITH SUPPLEMENTS AND COUNTY ENGINEER SPECIAL PROVISIONS FOR THE CONSTRUCTION OF SANITARY SEWERS DATED 8/22/87 AND SHALL BE PROSECUTED ONLY IN THE PRESENCE OF THE COUNTY ENGINEER.
 - THE CONTRACTOR SHALL NOTIFY THE CONTRACTING DIVISION OF PUBLIC WORKS BY TELEPHONE 800-886-8867 AT LEAST TWENTY-FOUR HOURS BEFORE STARTING ANY WORK UNDER THIS CONTRACT.
 - HOUSE LATERALS TO BE CONSTRUCTED WITH INVERTS AT PROPERTY LINE 8 FEET BELOW CURB GRADE EXCEPT AS NOTED.
 - WYE OR TEE BRANCHES MAY BE USED FOR CONNECTIONS TO MAINLINE SEWERS EXCEPT AS NOTED.
 - ALL STRUCTURES SHALL BE EITHER BRICK MANHOLES PER S-3 OR PRECAST CONCRETE MANHOLES PER S-26, EXCEPT AS NOTED.
 - PROVIDE STAKES ON THE PROPERTY LINE OR PROPERTY LINES PRODUCED AT RIGHT ANGLES TO THE SEWER LINE AT THE CENTER LINE OF EACH MANHOLE.
 - MANHOLE TOPS IN UNIMPROVED RIGHTS OF WAY TO BE SIX INCHES ABOVE FINISHED GRADE.
 - WITRIFIED CLAY PIPE JOINTS SHALL BE TYPE "D" OR "E" PER STANDARD SPECIFICATIONS SECTION 208-2.
 - IF A POWER POLE IS WITHIN THREE FEET OF THE SEWER, THE SEWER SHALL BE ENCASED, PER S-26, CASE R, TWO FEET ON EACH SIDE FROM THE POINT OF INTERFERENCE.
 - IF DURING THE COURSE OF CONSTRUCTION IT IS DETERMINED THAT THERE IS LESS THAN FOUR FEET OF COVER OVER THE TOP OF A MAIN LINE OR HOUSE LATERAL SEWER WHICH IS NOT INDICATED ON THE PLANS, THE PIPE SHALL BE ENCASED PER S-26, CASE R UNLESS OTHERWISE APPROVED BY THE COUNTY ENGINEER.
 - ALL JOINTS BETWEEN CAST IRON PIPE AND WITRIFIED CLAY PIPE SHALL BE MADE WITH A RUBBER SLEEVE JOINT, TYPE "C" OR "D" (WITH BUSHING IF NECESSARY) PER STANDARD SPECIFICATIONS, SECTION 208-2.
 - SEWERS TO BE TESTED FOR LEAKAGE PER SECTION 208-1.4 OF THE STANDARD SPECIFICATIONS AND SPECIAL PROVISIONS.
 - RESURFACE ALL TRENCHES WITHIN PAVED AREAS TO MEET L.A. COUNTY ROAD DEPT. OR CALIFORNIA STATE HIGHWAY REQUIREMENTS IN ACCORDANCE WITH PERMITS.
 - FULL COMPLIANCE WITH SECTION 208-1.3.2 OF THE SPECIAL PROVISIONS WILL BE REQUIRED FOR BACKFILL IN STREETS. CERTAIN CATION OF BACKFILL COMPACTION AND SAND EQUIVALENTS BY A QUALIFIED, REGISTERED TESTING LABORATORY SHALL BE PROVIDED BY THE PERMITTEE PRIOR TO THE ISSUANCE OF A CERTIFICATE OF PARTIAL ACCEPTANCE.
 - SPECIAL BACKFILL IN BASEMENT CONSTRUCTION (A) BACKFILL TRENCH AND REPLACE OTHER EARTH SO AS TO ACHIEVE THE NATURAL OR FINISHED GRADES AND SLOPES SHOWN ON THE GRADING PLAN APPROVED FOR THIS DEVELOPMENT BY THE BUILDING AND SAFETY DIVISION (B) ALL BACKFILL AND EARTH REPLACED SHALL BE COMPACTED TO A MINIMUM OF 90% OF MAXIMUM DENSITY PER ASTM D1557 METHOD OR TEST THEREOF AS NOTED. ACCEPTABLE CERTIFICATION OF SUCH COMPACTION SHALL BE SUBMITTED TO THE CONTRACTING DIVISION OF PUBLIC WORKS.

PROFILE, ALIGNMENT AND GRADE OF PAGE 1
SANITARY SEWERS
 TO BE CONSTRUCTED IN
BOUQUET CYN. RD AND SAN FERNANDO CYN. RD.
PRIVATE CONTRACT NO. 10388
 A-63-D, E-4f5

2 SHEETS, 3 PAGES
 51118

SCALE: HORIZ. 1"=60' VERT. 1"=4'
 MAY 8, 1985
 PREPARED IN THE OFFICES OF
 SHAND ENGINEERING ASSOCIATES 15230 BURBANK BLVD.
 VAN NUYS, CALIFORNIA 91411 818-787-8558
 BY: *Ronald K. Horn*
 REG. C. E. No. 14913

THE FOLLOWING LATEST REVISED STANDARD PLANS ON FILE IN THE OFFICE OF PUBLIC WORKS SHALL APPLY IN THE CONSTRUCTION OF THIS PROJECT:

SEWER	S-2
MINIMUM PUBLIC SAFETY ENCLOSURES	S-3
BRICK MANHOLES	S-4
STANDARD MANHOLE 8" IP	S-5
BRICK MANHOLE 18" IP	S-6
CASTING AND ENCASING	S-7
WYE OR TEE SUPPORT	S-8
ALLOWABLE TRENCH WIDTHS	S-9
SOCKING MANHOLE PLANS AND COVER	S-10
NON-ANCHORED PRECAST CONCRETE MANHOLE	S-11

COUNTY OF LOS ANGELES, CALIFORNIA
 THOMAS A. TIDEMANSON DIRECTOR OF PUBLIC WORKS
 APPROVED: *Ronald K. Horn* 11-18-85
 CHECKED: *Samuel G. Helli* 11-18-85
 REG. C. E. No. 33134
 SANTA CLARITA VALLEY BLDG. DIST. 82

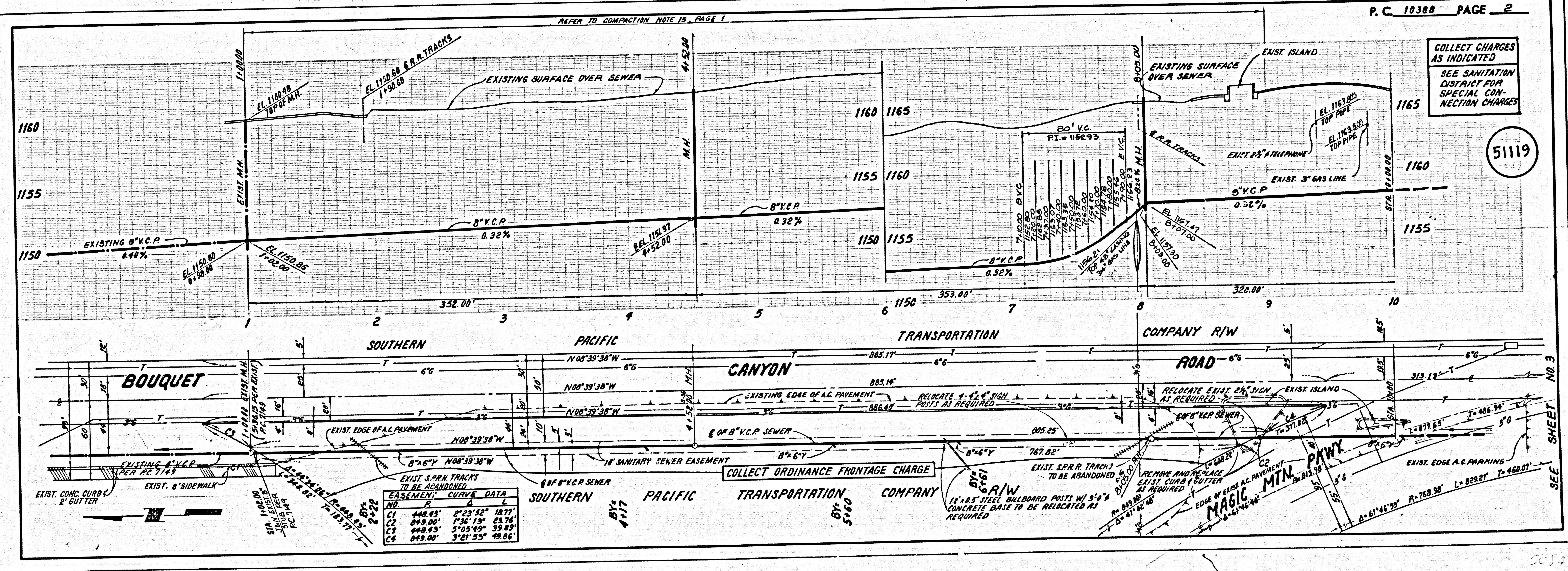

EASEMENT CURVE DATA

NO.	R	Δ	L	PC	PT
C1	440.43'	6°23'52"	1877'		
C2	440.00'	7°58'13"	2376'		
C3	440.43'	5°05'49"	39.83'		
C4	440.00'	3°01'55"	49.86'		

COLLECT CHARGES AS INDICATED
SEE SANITATION DISTRICT FOR SPECIAL CONNECTION CHARGES

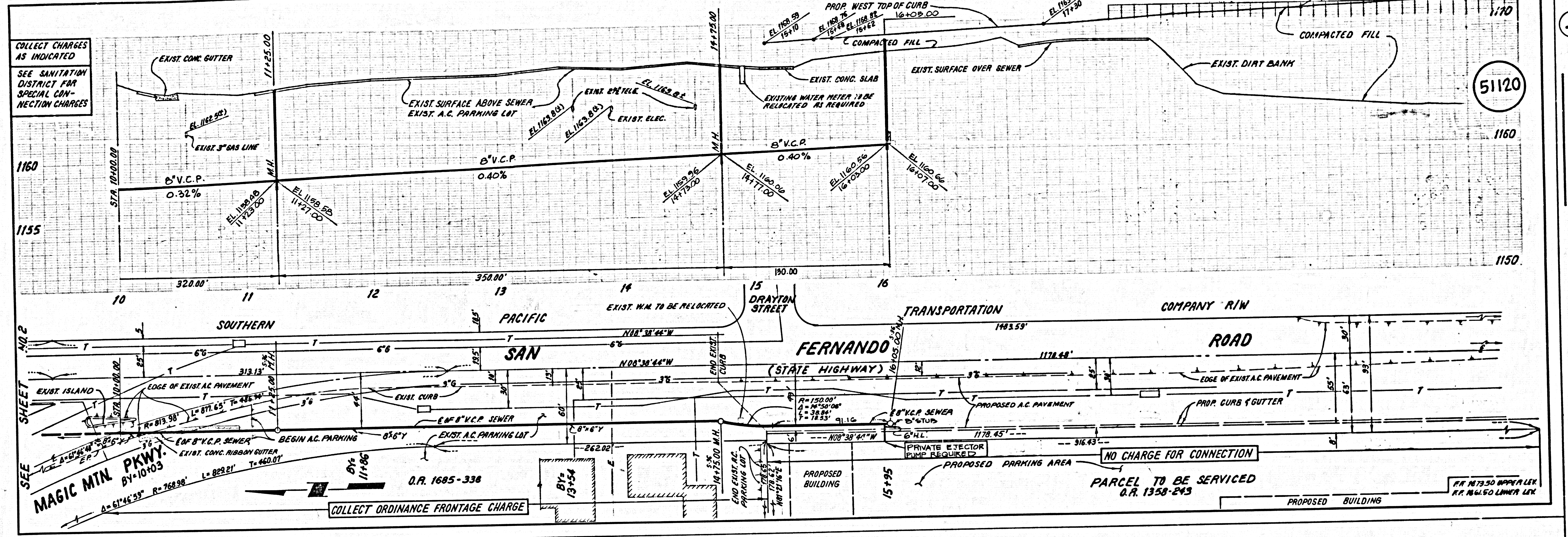

51120

1160

1155

1150

1145

1140

1135

1130

1125

1120

1115

1110

1105

1100

1095

1090

1085

1080

1075

1070

1065

1060

1055

1050

1045

1040

1035

1030

1025

1020

1015

1010

1005

1000

995

990

985

980

975

970

965

960

955

950

945

940

935

930

925

920

915

910

905

900

895

890

885

880

875

870

865

860

855

850

845

840

835

830

825

820

815

810

805

800

795

790

785

780

775

770

765

760

755

750

745

740

735

730

725

720

715

710

705

700

695

690

685

680

675

670

665

660

655

650

645

640

635

630

625

620

615

610

605

600

595

590

585

580

575

570

565

560

555

550

545

540

535

530

525

520

515

510

505

500

495

490

485

480

475

470

465

460

455

450

445

440

435

430

425

420

415

410

405

400

395

390

385

380

375

370

365

360

355

350

345

340

335

330

325

320

315

310

305

300

295

290

285

280

275

270

265

260

255

250

245

240

235

230

225

220

215

210

205

200

195

190

185

180

175

170

165

160

155

150

145

140

135

130

125

120

115

110

105

100

95

90

85

80

75

70

65

60

55

50

45

40

35

30

25

20

15

10

5

0

-5

-10

-15

-20

-25

-30

-35

-40

-45

-50

-55

-60

1

BC 10388

5054

DEE PUMP

M-5

M-5

M-5