

B.M. CL 3024 ELEV. 1247.748
 L&T IN CONC. RAMP OF SE. CORNER OF LYONS AVE.
 & WHEELER RD. 20' EAST & 80' SOUTH OF
 INTERSECTION
 NEWHALL QUAD. 1985.

DOUBLE SCALE.

SANITARY SEWERS

TO BE CONSTRUCTED IN
 VERMONT DR & WHEELER RD
 AND OTHER RIGHT OF WAY

PRIVATE CONTRACT NO. 10406

A-26
 W.S. 63

52690

SCALE: 1" = 8'
 1" = 8' HORIZ. 1" = 8' VERT.
 SEP. 1985

PREPARED IN THE OFFICES OF
 EFIM G. KASMAN DESIGN SERVICE
 1240 GYPSUM ST. DR. WOODLAND, CA 91366
 BY: GEORGE J. KASMAN, P.E. George Kasman
 REG. C. E. No. 40185

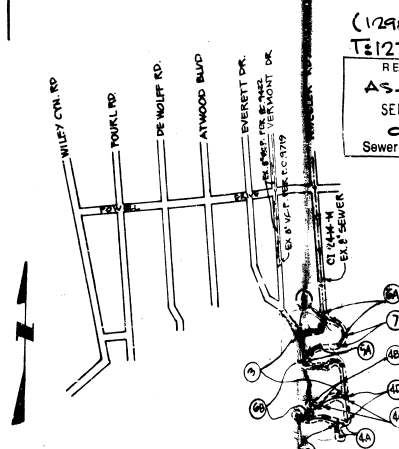

INDEX MAP
 P.C. 10406 VERMONT DR & WHEELER RD.

SCALE: 1" = 600'

NOTE: NUMBERS IN CIRCLES INDICATE PAGE NUMBERS
 ALL SEWERS IN THIS PROJECT ARE IN SANITARY
 SEWER 15"

REVISION NO. DATE 1-15-87, PAGE 6, ADDED M.H. AT STA 1400.00, REVISED FINISHED SURFACE OVER SAN. SEWER M.H. AT STA 1400.00
 STA 1400.00 TO 1400.12, STA 15+47.50 FROM 1448.00 TO 1419.25, STA 15+71.71 FROM 1421.00 TO 1421.00, STA 15+71.71 FROM 1421.00 TO 1421.00
 STA 15+71.71 FROM 1421.00 TO 1421.00, STA 15+71.71 FROM 1421.00 TO 1421.00, STA 15+71.71 FROM 1421.00 TO 1421.00
 STA 15+71.71 FROM 1421.00 TO 1421.00, STA 15+71.71 FROM 1421.00 TO 1421.00, STA 15+71.71 FROM 1421.00 TO 1421.00

THIS P.C. IS APPROVED AS DRY SEWER ONLY,
 EXCEPT SEWERS ON PAGES GA & 7

ISSUE NO CONSTRUCTION PERMIT FOR SEWER
 OUTLET FROM STA. 1404.64 TO STA. 8+92.07
 UNTIL R.W. IS RECORDED SHOWN ON PAGE 2

CONSTRUCTION NOTES CONT'D

16. FULL COMPLIANCE WITH PART IV OF THE SPECIAL PROVISIONS IS REQUIRED FOR THE INSTALLATION OF A.B.S. COMPOSITE PIPE.
17. MANHOLE WATER STOP GASKETS AND CLAMPS ARE REQUIRED FOR THE CONNECTION OF A.B.S. COMPOSITE PIPE TO MANHOLE STRUCTURES.
18. A.B.S. SOLID WALL PIPE MUST BE USED FOR WYE AND HOUSE LATERAL CONNECTIONS TO A.B.S. COMPOSITE MAINLINE SEWER PIPE.
19. A.B.S. COMPOSITE PIPE SHALL BE BEDDED IN CONFORMANCE WITH THE TABLE IN SECTION B-51 OF PART IV OF THE SPECIAL PROVISIONS.
20. THREE DEGREE DEFLECTION COUPLER ARE REQUIRED FOR RADIUS OF CURVATURE LESS THAN 300 FEET WHEN USING A.B.S. COMPOSITE PIPE.
21. NO CONNECTIONS FOR DISPOSAL OF INDUSTRIAL WASTE IS ALLOWED IF A.B.S. COMPOSITE PIPE IS USED.
22. WHEN LITTLE PLASTIC PIPE INCLUDING A.B.S. COMPOSITE PIPE.
23. ALL WYES AND/OR HOUSE LATERALS ARE TO BE LOCATED AT LEAST FIVE FEET AWAY AND WHEN POSSIBLE NOT CLOSER THAN FIVE FEET TO ANY MANHOLE.
24. A.B.S. SOLID WALL PIPE IS NOT ACCEPTABLE FOR USE AS MAINLINE SEWER.
25. ANY WYE BRANCHES ARE TO BE USED FOR CONNECTION TO A.B.S. COMPOSITE MAINLINE SEWER PIPE.

REVISION NO. DATE 9-20-1986
 PAGE 1: ADDED CONST. NOTES 16 THROUGH 25, REVISED INDEX MAP, REVISED SHEETS, PAGES NUMBERS ADDED PAGES
 PAGE 2: VOID SEWER FROM STA. 1204.64 TO STA. 10+40.36
 PAGE 3: ADDED OUTLET WEST TO M.H. AT STA. 10+40.36, VOID OUTLET AT STA. 10+38.36, ADDED 4"x8" STUB AT STA. 10+38.36
 PAGE 4, 5, 6, 7: ADDED TO SEWER LINE "OR A.B.S."
 PAGE 8: REVISED F.6 OVER SEWER BETWEEN STA. 1400.00 & 1400.12, REVISED INVERT EL. (STA. 1400.00) 10.00' (1400.00)
 REVISION NO. DATE 10-1-87
 PAGE GA: LOWER M.H. AT STA. 1400.00
 APPROVED: *[Signature]* 10-29-86

NO CONNECTION FOR THE DISPOSAL OF INDUSTRIAL WASTE SHALL BE MADE TO SEWERS SHOWN ON THESE DRAWINGS UNTIL A PERMIT FOR INDUSTRIAL WASTEWATER DISCHARGE HAS BEEN ISSUED BY THE SANITATION DISTRICTS FOR SAID CONNECTION.

BEFORE BREAKING INTO OR CONSTRUCTION ON A COUNTY SANITATION DISTRICT SEWER AND PRIOR TO FINAL ACCEPTANCE OF THE PROJECT, SANITATION DISTRICT INSPECTOR SHALL BE NOTIFIED BY PHONE 818 - 962-8605 SO THAT REQUIRED INSPECTION CAN BE MADE.

GENERAL NOTES:

1. ELEVATIONS ARE IN FEET ABOVE U.S.C. & G.S. SEA LEVEL DATUM OF 1929
2. NO REVISIONS SHALL BE MADE IN THESE PLANS WITHOUT THE APPROVAL OF DIRECTOR OF PUBLIC WORKS
3. NO REPRESENTATIVE OF THE DEPT. OF PUBLIC WORKS WILL SURVEY OR LAY OUT ANY PORTION OF THE WORK
4. GRADES TO WHICH THIS IMPROVEMENT IS TO BE CONSTRUCTED ARE SHOWN ON PLANS AND PROFILES. GRADE POINTS FOR TOP OF CURB, CENTER LINE OF STREETS, OR CENTER LINE OF ALLEYS ARE SHOWN BY CIRCLES ON PROFILES. AT ALL POINTS BETWEEN DESIGNATED POINTS THE GRADE SHALL BE ESTABLISHED SO AS TO CONFORM TO A STRAIGHT LINE DRAWN BETWEEN SAID DESIGNATED POINTS
5. THE PRIVATE ENGINEER SHALL FURNISH THE DEPT. OF PUBLIC WORKS WITH GRADE SHEETS AND STATIONING FOR ALL HOUSE LATERALS AND "T" OR "Y" BRANCHES AND SHALL PROVIDE STAKES FOR THEM AT THEIR PROPER LOCATIONS WITH STATIONING PLAINLY MARKED. ALL HOUSE LATERALS SHALL BE CONSTRUCTED IN A STRAIGHT ALIGNMENT AT RIGHT ANGLES FROM THE MAIN LINE SEWER EXCEPT AS SHOWN ON THE PLANS. HOUSE LATERALS FROM CHIMNEYS SHALL NOT HAVE AN ANGLE OF LESS THAN 45° WITH THE MAIN LINE SEWER. ANY CHANGE IN ALIGNMENT SHALL BE REQUESTED IN WRITING BY THE PRIVATE ENGINEER
6. THE PRIVATE ENGINEER SHALL FURNISH THE HOUSE LATERAL, DRAINING THE PROPERTY LINE BELOW THE TOP OF CURB ELEVATION FOR EACH HOUSE LATERAL ON THE GRADE SHEET
7. BEFORE WORK CAN BE STARTED, THE CONTRACTOR MUST OBTAIN A PERMIT TO EXCAVATE IN COUNTY STREETS FROM THE ROAD ELEMENTS DIVISION, DEPT. OF PUBLIC WORKS, DISTRICT OFFICE NO. 7, AND PAY A FEE TO THE DEPT. OF PUBLIC WORKS \$500.00 PER ALLEYS, ST. LOS ANGELES, CA 90013 TO COVER THE COST OF CONSTRUCTION INSPECTION AND RECORD PLANS
8. IF WORK IS TO BE DONE IN A STATE HIGHWAY, A PERMIT MUST BE OBTAINED FROM THE STATE OF CALIFORNIA, DIVISION OF HIGHWAYS, 180 SOUTH SPRING STREET, LOS ANGELES, CALIFORNIA
9. APPROVAL OF THIS PLAN BY THE COUNTY OF LOS ANGELES DOES NOT CONSTITUTE A REPRESENTATION AS TO THE ACCURACY OF THE LOCATION OF OR THE EXISTENCE OR NON-EXISTENCE OF ANY UNDERGROUND UTILITY PIPE, OR STRUCTURE WITHIN THE LIMITS OF THIS PROJECT. THIS NOTE APPLIES TO ALL PAGES
10. REFER TO SECTION 7.10.41 OF THE STANDARD SPECIFICATIONS, REGARDING SAFETY ORDERS
11. PRIOR TO THE ISSUANCE OF THE REQUIRED SEWER CONSTRUCTION PERMIT, THE CONTRACTOR SHALL OBTAIN AND FILE WITH THE DEPT. OF PUBLIC WORKS COPIES OF A PERMIT TO EXCAVATE IN COUNTY STREETS FROM THE ROAD ELEMENTS DIVISION, DEPT. OF PUBLIC WORKS
12. A PERMIT FOR EXCAVATIONS AND TRENCHES FROM THE STATE OF CALIFORNIA, DIVISION OF INDUSTRIAL SAFETY AND A CERTIFICATE OF WORKERS COMPENSATION INSURANCE WITH THE DEPARTMENT OF PUBLIC WORKS, 233 WALCARRAN ST., A 209, LOS ANGELES, CALIFORNIA 90013 MUST BE OBTAINED AS THE CERTIFICATE HOLDER TO BE NOTIFIED 30 DAYS PRIOR TO CANCELLATION OF POLICY

CONSTRUCTION NOTES:

1. WORK SHALL BE CONSTRUCTED ACCORDING TO THE STANDARD SPECIFICATIONS FOR PUBLIC WORKS CONSTRUCTION PAGES EDITION WITH SUPPLEMENTS AND DEPT. OF PUBLIC WORKS SPECIAL PROVISIONS FOR THE CONSTRUCTION OF SANITARY SEWERS DATED: SEPT. 21, 1976 AND SHALL BE PROSECUTED ONLY IN THE PRESENCE OF THE DEPT. OF PUBLIC WORKS
2. THE CONTRACTOR SHALL NOTIFY THE CONSTRUCTION DIVISION BY TELEPHONE 405-211-1111, AT LEAST FIFTY-FOUR HOURS BEFORE STARTING ANY WORK UNDER THIS CONTRACT
3. HOUSE LATERALS TO BE CONSTRUCTED WITH INVERTS AT PROPERTY LINE 3 FEET BELOW CURB GRADE EXCEPT AS NOTED
4. WYE OR TEE BRANCHES MAY BE USED FOR CONNECTIONS TO MAINLINE SEWERS EXCEPT AS NOTED
5. ALL STRUCTURES SHALL BE EITHER BRICK MANHOLES PER S-3 OR PRECAST CONCRETE MANHOLES PER S-3B, EXCEPT AS NOTED
6. PROVIDE STAKES ON THE PROPERTY LINE OR PROPERTY LINES LOCATED AT RIGHT ANGLES TO THE SEWER LINE AT THE CENTER LINE OF EACH MANHOLE
7. MANHOLE TOPS IN UNIMPROVED RIGHTS OF WAY TO BE SIX INCHES ABOVE FINISHED GRADE
8. VITRIFIED CLAY PIPE JOINTS SHALL BE TYPE "D" OR "E" PER STANDARD SPECIFICATIONS SECTION 208-2
9. IF A POWER POLE IS WITHIN THREE FEET OF THE SEWER, THE SEWER SHALL BE ENCASED, PER S-23, CASE II, TWO FEET ON EACH SIDE FROM THE POINT OF INTERFERENCE
10. IF DURING THE COURSE OF CONSTRUCTION IT IS DETERMINED THAT THERE IS LESS THAN FOUR FEET OF COVER OVER THE TOP OF A MAIN LINE OR HOUSE LATERAL SEWER WHICH IS NOT INDICATED ON THE PLANS, THE PIPE SHALL BE ENCASED PER S-23, CASE II UNLESS OTHERWISE APPROVED BY THE DIRECTOR OF PUBLIC WORKS
11. ALL JOINTS BETWEEN CAST IRON PIPE AND VITRIFIED CLAY PIPE SHALL BE MADE WITH A RUBBER SLEEVE JOINT, TYPE "C" OR "D" (WITH BUSHINGS IF NECESSARY) PER STANDARD SPECIFICATIONS, SECTION 208-2
12. SEWERS TO BE TESTED FOR LEAKAGE PER SECTION 208-1.1 OF THE STANDARD SPECIFICATIONS AND SPECIAL PROVISIONS
13. RESURFACE ALL TRENCHES WITHIN PAVED AREAS TO MEET L.A. COUNTY PUBLIC WORKS OR CALIFORNIA STATE HIGHWAY REQUIREMENTS IN ACCORDANCE WITH PERMITS
14. FULL COMPLIANCE WITH SECTION 208-1.23 OF THIS SPECIAL PROVISIONS WILL BE REQUIRED FOR BACKFILL IN STREETS. CERTIFICATION OF BACKFILL COMPACTION AND SAND EQUIVALENTS BY A QUALIFIED, REGISTERED TESTING LABORATORY SHALL BE PROVIDED BY THE PERMITTEE PRIOR TO THE ISSUANCE OF A CERTIFICATE OF PARTIAL ACCEPTANCE
15. SPECIAL BACKFILL IN EASEMENT CONSTRUCTION (A) BACKFILL TRENCH AND REPLACE OTHER EARTH SO AS TO ACHIEVE THE NATURAL OR FINISHED GRADES AND SLOPES SHOWN ON THE GRADING PLAN APPROVED FOR THIS DEVELOPMENT BY THE BUILDING AND SAFETY DIVISION (B) ALL BACKFILL AND EARTH REPLACED SHALL BE COMPACTED TO A MINIMUM OF 80% OF MAXIMUM DENSITY PER A.S.T.M. STD. METHOD OF TEST D6957 AS MODIFIED. ACCEPTABLE CERTIFICATION OF SUCH COMPACTION SHALL BE SUBMITTED TO THE CONSTRUCTION DIVISION OF THE DEPT. OF PUBLIC WORKS

THE FOLLOWING LATEST REVISED STANDARD PLANS ON FILE IN THE OFFICE OF THE COUNTY ENGINEER SHALL APPLY IN THE CONSTRUCTION OF THIS PROJECT:

MINIMUM PUBLIC SAFETY ARRANGEMENTS	S-1
BRICK SEWER MANHOLE	S-3
STANDARD MANHOLE STOP	S-3B
BRICKS FOR SEWER PIPE	S-3C
CLEANING AND ENCLOSURE	S-3D
WYS IN THE SUPPORT	S-3E
ALLOWABLE TRENCH WIDTHS	S-3F
LOADING MANHOLE FRAME AND COVER	S-3G
NON-SINKFORTH PERMIT CONCRETE SEWER MANHOLE	S-3H

PS000574

COUNTY OF LOS ANGELES, CALIFORNIA
 THOMAS A. TIDEMANSON, DIRECTOR OF PUBLIC WORKS
 CHARLES W. CARRY, CHIEF ENGINEER

APPROVED: *[Signature]* 9/11/86
 DATE: 9/11/86

CHECKED: *[Signature]* 9-11-86
 DATE: 9-11-86
 S.P. C.E. NO. 17536

SANTA CLARITA VALLEY BLDG. DIST. 8-2
 SEP 06 1990
 Sewer Maintenance

SEE SPECIAL BACKFILL NOTE ON PAGE 1 CONCERNING COMPACTION

REVIEWED BY: *[Signature]*

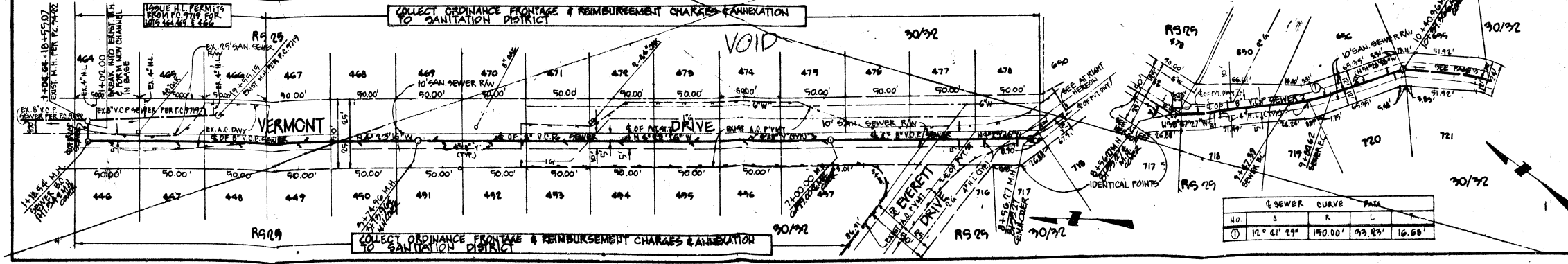
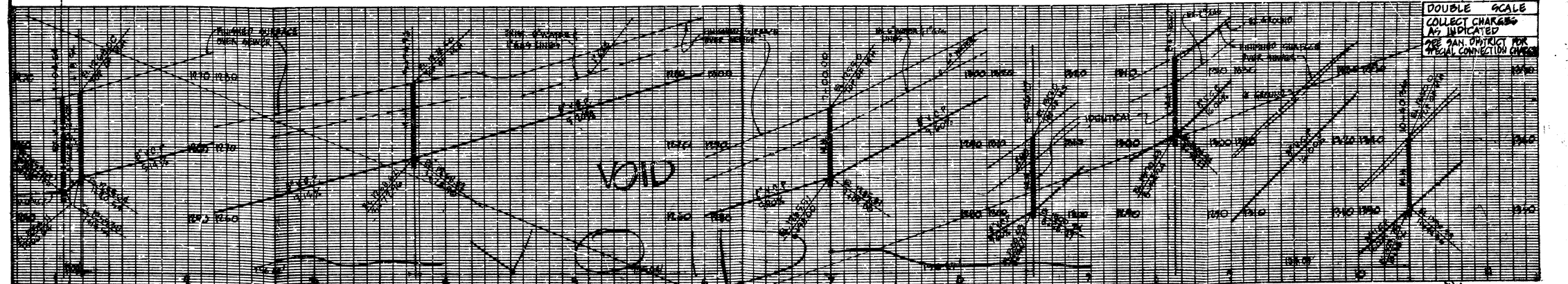

LOCATION: CITY OF SANTA CLARITA
 PROJECT: VERMONT DR & WHEELER RD
 DRAWN BY: *[Signature]*

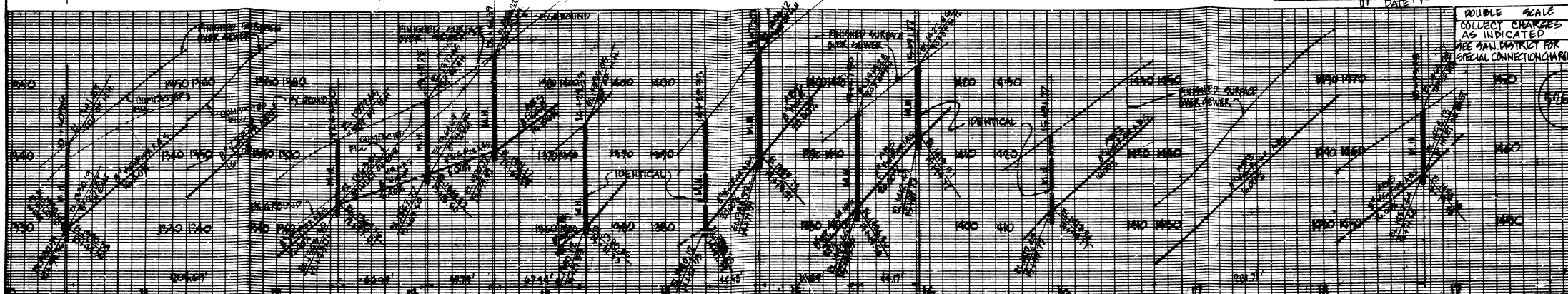

DOUBLE SCALE
COLLECT CHARGES
AS INDICATED
SEE SAN DISTRICT FOR
SPECIAL CONNECTION CHARGES

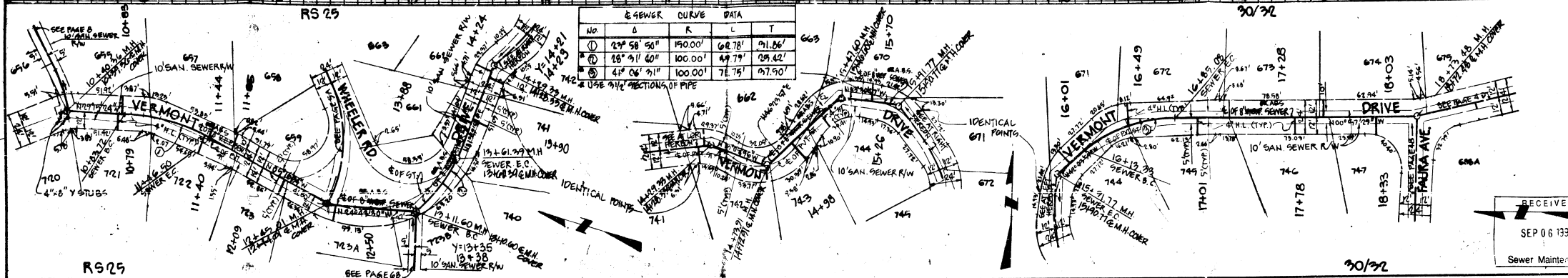

RECEIVED
SEP 06 1930
Sewer Maintenance

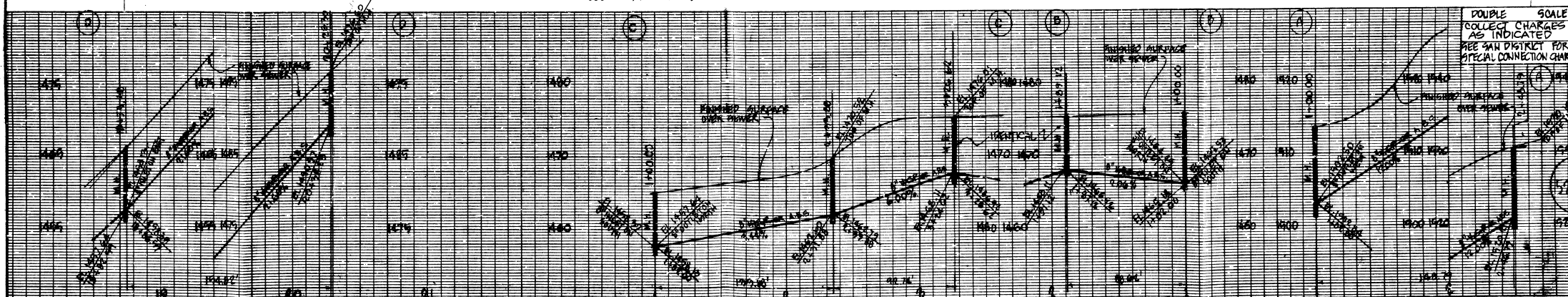

DOUBLE SCALE
COLLECT CHARGES
AS INDICATED
SEE SAN DISTRICT FOR
SPECIAL CONNECTION CHARGES

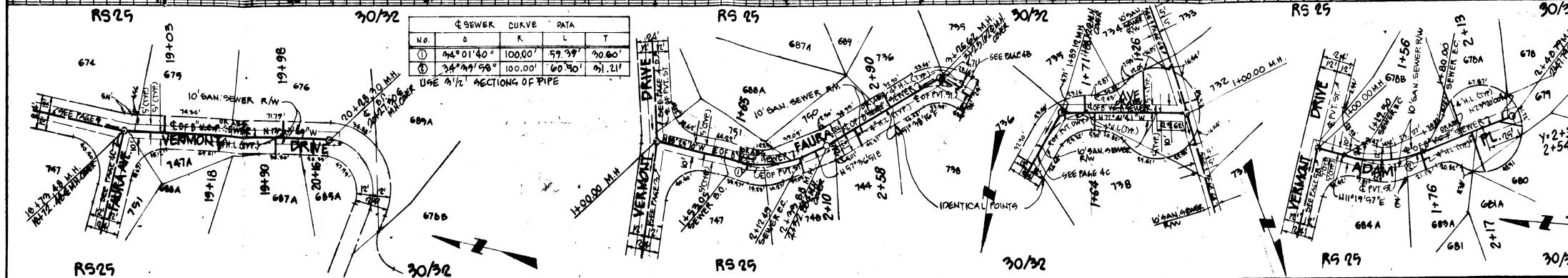

RECEIVED
SEP 06 1930
Sewer Maintenance

VERMONT DR. & WHEELER DR
P.C. 10406

SEE SPECIAL BACKFILL NOTE ON PAGE 1 CONCERNING COMPACTION

REVIEWED BY [Signature]

P.C. 10406 PAGE 5

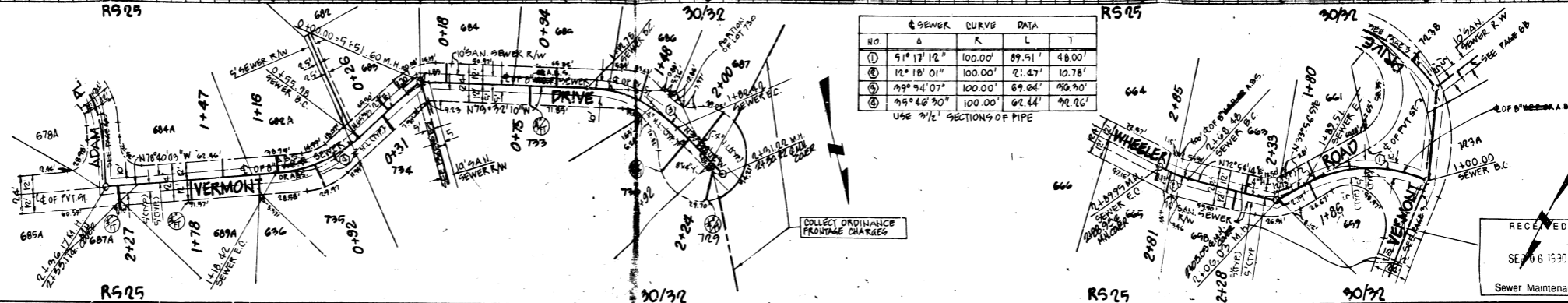
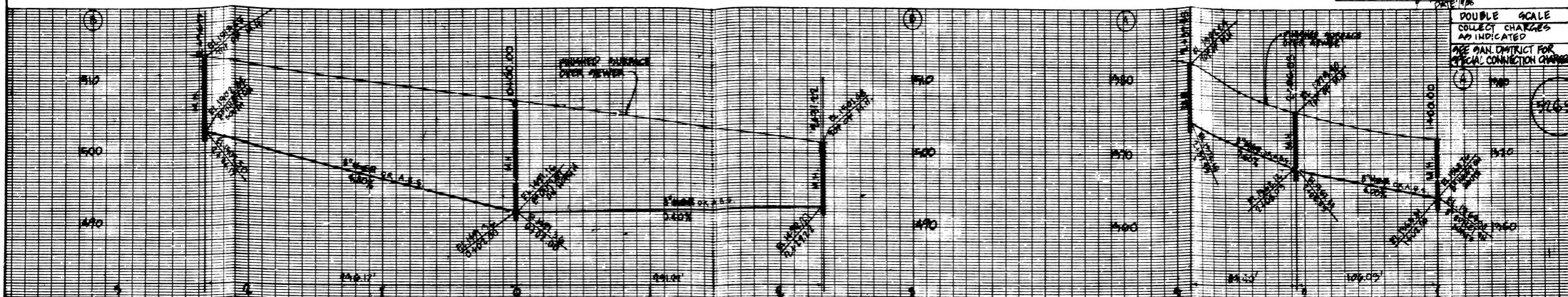

SEWER CURVE DATA

NO	Δ	R	L	T
1	51° 17' 12"	100.00'	89.51'	48.00'
2	12° 18' 01"	100.00'	21.47'	10.78'
3	199° 54' 07"	100.00'	69.64'	192.70'
4	95° 46' 30"	100.00'	62.44'	92.76'

USE 3/4" SECTIONS OF PIPE

RECEIVED
 SEP 06 1930
 Sewer Maintenance

SEE SPECIAL BACKFILL NOTE ON PAGE 1 CONCERNING COMPACTION

REVIEWED BY [Signature]

P.C. 10406 PAGE 6

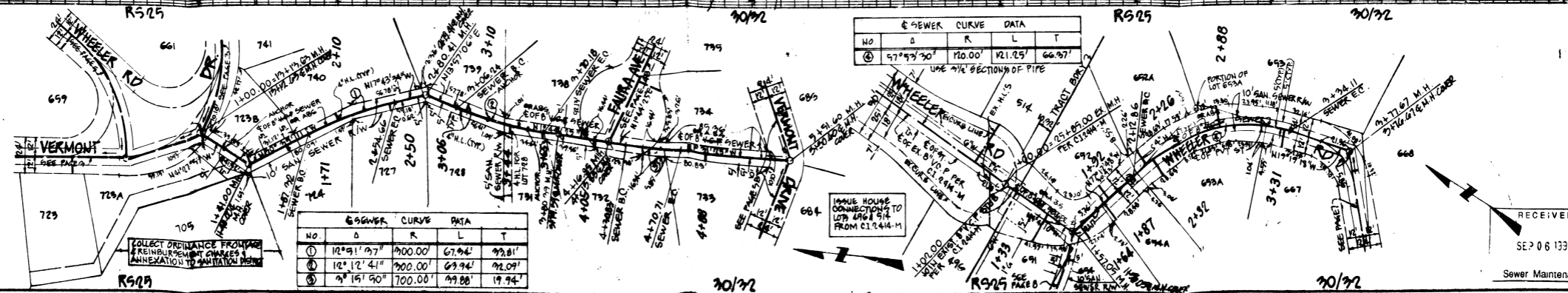
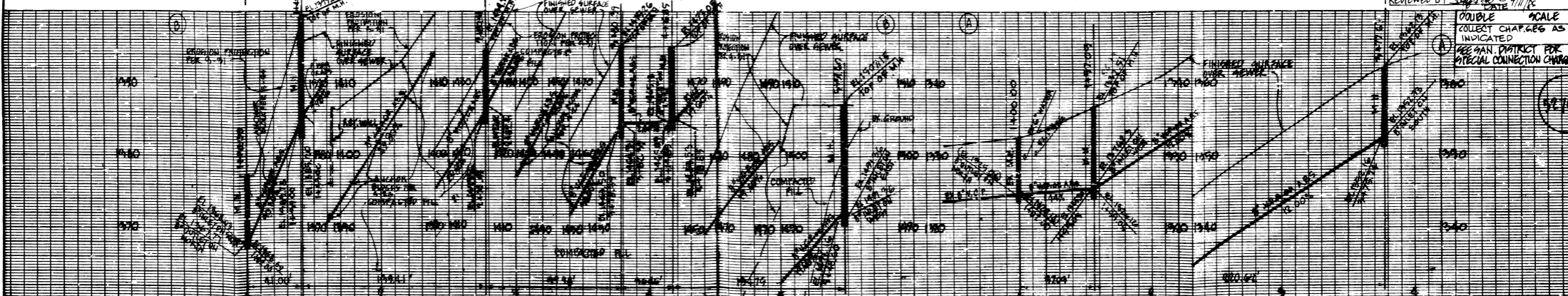

SEWER CURVE DATA

NO	Δ	R	L	T
1	57° 43' 30"	110.00'	121.25'	66.97'

USE 3/4" SECTIONS OF PIPE

RECEIVED
 SEP 06 1930
 Sewer Maintenance

ACKNOWLEDGMENT BY: WHEELER RD
 BC 10406

