

TO BE CONSTRUCTED IN  
**TRACT NO. 34108**

**PRIVATE CONTRACT NO. 10441**  
INDEX C 211, 212

3 SHEETS; 6 PAGES  
SCALE: VERT. 1"=8'  
HORIZ. 1"=80'  
OCTOBER, 1985  
PREPARED IN THE OFFICES OF  
**E.L. PEARSON AND ASSOCIATES**  
1555 W. REDONDO BEACH BLVD. GARDEN, CA. 90247  
BY: *Robert T. Quinn*  
REG. C.E. No. 24380

51483

**DOUBLE SCALE**

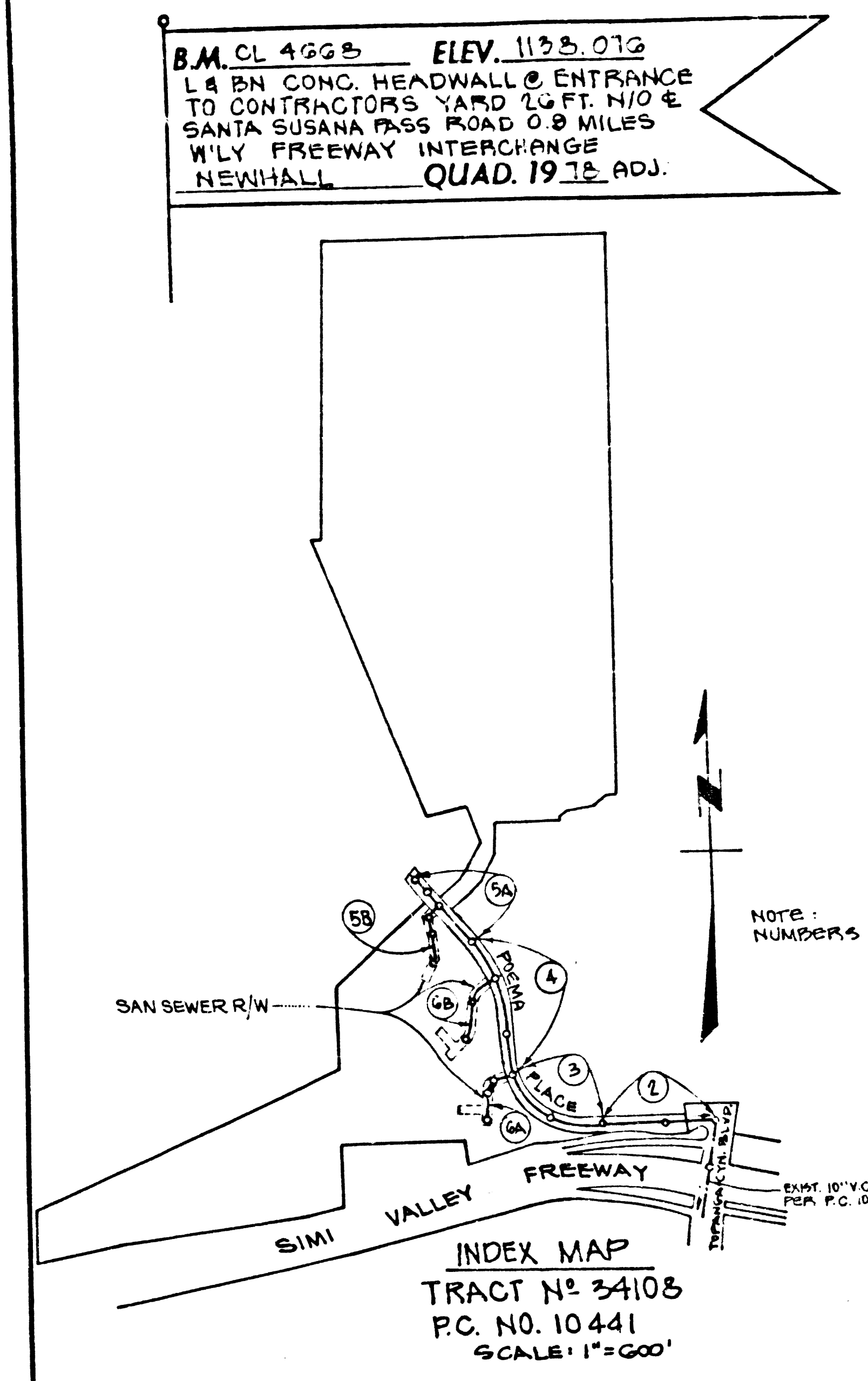

REVISION NO. 1, DATE 2-6-87  
PAGE 2, REVISE M.H. LOCATION  
APPROVED: *Sauji G. Ibali* 2-12-87  
DEPT. OF PUBLIC WORKS DATE

ALLOW NO CONNECTIONS UNTIL OUTLET SEWER P.C. 10094 IS ACCEPTED FOR PUBLIC USE BY THE COUNTY OF LOS ANGELES

**GENERAL NOTES:**

- ELEVATIONS ARE IN FEET ABOVE U.S.C. & G.S. SEA LEVEL DATUM OF 1929
- NO REVISIONS SHALL BE MADE IN THESE PLANS WITHOUT THE APPROVAL OF THE DEPT. OF PUBLIC WORKS
- NO REPRESENTATIVE OF THE DEPT. OF PUBLIC WORKS SHALL BE AT ANY POSITION ON THE WORK
- GRADES TO WHICH THIS IMPROVEMENT IS TO BE CONSTRUCTED ARE SHOWN ON PLANS AND PROFILES. GRADE POINTS FOR TOP OF CURBS, CENTER LINE OF STREETS, OR CENTER LINE OF ALLEYS ARE SHOWN BY CHECKS ON PROFILES AT ALL POINTS BETWEEN DESIGNATED POINTS THE GRADE SHALL BE ESTABLISHED SO AS TO CONFORM TO A STRAIGHT LINE DRAWN BETWEEN SAID DESIGNATED POINTS
- THE PRIVATE ENGINEER SHALL FURNISH THE DEPT. OF PUBLIC WORKS WITH GRADE SHEETS AND STATIONING FOR ALL HOUSE LATERALS AND "T" BRANCHES AND SHALL PROVIDE STAKES FOR THEM AT THEIR PROPER LOCATIONS WITH STATIONING PLAINLY MARKED. ALL HOUSE LATERALS SHALL BE CONSTRUCTED IN A STRAIGHT ALIGNMENT AT RIGHT ANGLES FROM THE MAIN LINE SEWER EXCEPT AS SHOWN ON THE PLANS. HOUSE LATERALS FROM CHIMNEYS SHALL NOT HAVE AN ANGLE OF LESS THAN 45° WITH THE MAIN LINE SEWER. ANY CHANGE IN ALIGNMENT SHALL BE REQUESTED IN WRITING BY THE PRIVATE ENGINEER
- THE PRIVATE ENGINEER SHALL FURNISH THE HOUSE LATERAL DEPTH AT THE PROPERTY LINE BELOW THE TOP OF CURB ELEVATION FOR EACH HOUSE LATERAL ON THE GRADE SHEET
- BEFORE WORK CAN BE STARTED, THE CONTRACTOR MUST OBTAIN A PERMIT TO EXCAVATE IN COUNTY STREETS FROM THE L.A. COUNTY DEPT. OF PUBLIC WORKS, DISTRICT OFFICE NO. 9, AND PAY A FEE TO THE DEPT. OF PUBLIC WORKS \$50 PER FRONTAGE FOOT, OR, CA. TIMES REGIONAL OFFICE TO COVER THE COST OF CONSTRUCTION, INSPECTION AND RECORD PLANS
- IF WORK IS TO BE DONE IN A STATE HIGHWAY, A PERMIT MUST BE OBTAINED FROM THE STATE OF CALIFORNIA, DIVISION OF HIGHWAYS, 120 SOUTH SPRING STREET, LOS ANGELES, CALIFORNIA
- APPROVAL OF THIS PLAN BY THE COUNTY OF LOS ANGELES DOES NOT CONSTITUTE A REPRESENTATION AS TO THE ACCURACY OF THE LOCATION OF OR THE EXISTENCE OR NON EXISTENCE OF ANY UNDERGROUND UTILITY PIPE, OR STRUCTURE WITHIN THE LIMITS OF THIS PROJECT. THIS NOTE APPLIES TO ALL PAGES
- REFER TO SECTION 718.41 OF THE STANDARD SPECIFICATIONS, REGARDING SAFETY ORDERS
- PRIOR TO THE COMMENCEMENT OF THE PROPOSED WORK, THE CONTRACTOR SHALL OBTAIN AND FILE WITH THE DEPT. OF PUBLIC WORKS, COPIES OF A PERMIT TO EXCAVATE IN COUNTY STREETS FROM THE L.A. COUNTY DEPT. OF PUBLIC WORKS, DISTRICT OFFICE NO. 9, AND PAY A FEE TO THE DEPT. OF PUBLIC WORKS \$50 PER FRONTAGE FOOT, OR, CA. TIMES REGIONAL OFFICE TO COVER THE COST OF CONSTRUCTION, INSPECTION AND RECORD PLANS
- APPROVAL FOR EXCAVATION AND TRENCHING FROM THE STATE OF CALIFORNIA, DIVISION OF HIGHWAYS, 120 SOUTH SPRING STREET, LOS ANGELES, CALIFORNIA, IS NOT NECESSARY FOR THIS PROJECT. THE CONTRACTOR SHALL BE NOTIFIED 30 DAYS PRIOR TO THE COMMENCEMENT OF EXCAVATION AND TRENCHING BY THE COUNTY OF LOS ANGELES, DEPT. OF PUBLIC WORKS, DISTRICT OFFICE NO. 9, AND PAY A FEE TO THE DEPT. OF PUBLIC WORKS \$50 PER FRONTAGE FOOT, OR, CA. TIMES REGIONAL OFFICE TO COVER THE COST OF CONSTRUCTION, INSPECTION AND RECORD PLANS

**CONSTRUCTION NOTES:**

- WORK SHALL BE CONSTRUCTED ACCORDING TO THE STANDARD SPECIFICATIONS FOR PUBLIC WORKS CONSTRUCTION (SECTION 300-1.1) AND SHALL BE PROSECUTED ONLY IN THE PRESENCE OF THE DEPT. OF PUBLIC WORKS, DISTRICT OFFICE NO. 9, OR CA. TIMES REGIONAL OFFICE TO COVER THE COST OF CONSTRUCTION, INSPECTION AND RECORD PLANS
- THE CONTRACTOR SHALL NOTIFY THE CONSTRUCTION DIVISION PUBLIC WORKS BY TELEPHONE 818-226-8281 BY LATEST TIME FOUR HOURS BEFORE STARTING ANY WORK UNDER THIS CONTRACT
- HOUSE LATERALS TO BE CONSTRUCTED WITH INVERTS AT PROPERTY LINE 4 FEET BELOW CURB GRADE EXCEPT AS NOTED
- WYE OR TEE BRANCHES MAY BE USED FOR CONNECTIONS TO MAINLINE SEWERS EXCEPT AS NOTED
- ALL STRUCTURES SHALL BE EITHER BRICK MANHOLES PER S-3 OR PRECAST CONCRETE MANHOLES PER S-3A, EXCEPT AS NOTED
- PROTECT STAKES ON THE PROPERTY LINE OR PROPERTY LINES PROTECTED AT RIGHT ANGLES TO THE SEWER LINE AT THE CENTER LINE OF EACH MANHOLE
- MANHOLE TOPS IN UNIMPROVED AREAS OF WAY TO BE SIX INCHES ABOVE FINISHED GRADE
- VITRIFIED CLAY PIPE JOINTS SHALL BE TYPE "D", OR "D" PER STANDARD SPECIFICATIONS SECTION 300-2
- IF A POWER POLE IS WITHIN THREE FEET OF THE SEWER, THE SEWER SHALL BE ENCASED PER S-23, CASE II TWO FEET ON EACH SIDE FROM THE POINT OF INTERFERENCE
- IF DURING THE COURSE OF CONSTRUCTION IT IS DETERMINED THAT THERE IS LESS THAN FOUR FEET OF COVER OVER THE TOP OF A MAIN LINE OR HOUSE LATERAL V.C.P. SEWER WHICH IS NOT INDICATED ON THE PLANS, THE PIPE SHALL BE ENCASED PER S-23, CASE II UNLESS OTHERWISE APPROVED BY THE DEPT. OF PUBLIC WORKS
- ALL JOINTS BETWEEN CAST IRON PIPE AND VITRIFIED CLAY PIPE SHALL BE MADE WITH A RUBBER SLEEVE JOINT, TYPE "C" OR "D" WITH RUBBERING IF NECESSARY PER STANDARD SPECIFICATIONS, SECTION 300-2
- SEWERS TO BE TESTED FOR LEAKAGE PER SECTION 300-4 OF THE STANDARD SPECIFICATIONS AND SPECIAL PROVISIONS
- RESURFACE ALL TRENCHES WITHIN PAVED AREAS TO MEET L.A. COUNTY DEPT. OF PUBLIC WORKS, CALIFORNIA STATE HIGHWAY REQUIREMENTS IN ACCORDANCE WITH PERMITS
- FINAL COMPLIANCE WITH SECTION 300-8.5 OF THE SPECIAL PROVISIONS WILL BE REQUIRED FOR BACKFILL IN STREETS. CERTIFICATION OF BACKFILL COMPACTION AND SAND EQUIVALENTS BY A QUALIFIED, REGISTERED TESTING LABORATORY SHALL BE PROVIDED BY THE PERMITTEE PRIOR TO THE ISSUANCE OF A CERTIFICATE OF PARTIAL ACCEPTANCE
- SPECIAL BACKFILL IN DRAINAGE CONSTRUCTION (A BACKFILL TRENCH AND PIPELAYS BATH) IS AS TO ACHIEVE THE NATURE OF FINISHED GRADES AND SLOPES SHOWN ON THE SPECIAL PROVISIONS. BACKFILL SHALL BE PROVIDED FOR THE DEVELOPMENT BY THE BUILDING AND SAFETY DIVISION, CALIF. AND SOUTH PASADENA SHALL BE COMPLETED THROUGHIN BY THE STATE HIGHWAY DIVISION FOR A L.A. COUNTY DEPT. OF PUBLIC WORKS, DISTRICT OFFICE NO. 9, AND PAY A FEE TO THE DEPT. OF PUBLIC WORKS \$50 PER FRONTAGE FOOT, OR, CA. TIMES REGIONAL OFFICE TO COVER THE COST OF CONSTRUCTION, INSPECTION AND RECORD PLANS

THE FOLLOWING LATEST REVISED STANDARD PLANS ON FILE IN THE OFFICE OF THE COUNTY ENGINEER SHALL APPLY IN THE CONSTRUCTION OF THIS PROJECT.

LEGEND	S-1
MINIMUM PUBLIC SAFETY REQUIREMENTS	S-2
BRICK SEWER MANHOLE	S-3
STANDARD BRICKMANHOLE STEP	S-4
BIDDING FOR SEWER PIPE	S-5
ENCASING AND PROTECTION	S-6
WYE OR TEE SUPPORT	S-7
ALLOWABLE TRENCH WIDTHS	S-8
LOCKING MANHOLE FRAME AND COVER	S-9
NON-REINFORCED PRECAST CONCRETE SEWER MANHOLE	S-10

COUNTY OF LOS ANGELES, CALIFORNIA  
THOMAS A. TIDEMANSON, DIRECTOR OF PUBLIC WORKS  
APPROVED: *Carl A. Blum* 4/19/86  
CHECKED: *Jimmy* 6/11/86  
REG. C.E. NO. 16841  
CALIFORNIA BICG DIST. 31

LAS VIRGENES MUNICIPAL WATER DISTRICT  
APPROVED: *J. W. Stokes* 4-21-86  
DATE  
H.W. STOKES - CHIEF ENGINEER

L.A. COUNTY DEPT. OF PUBLIC WORKS

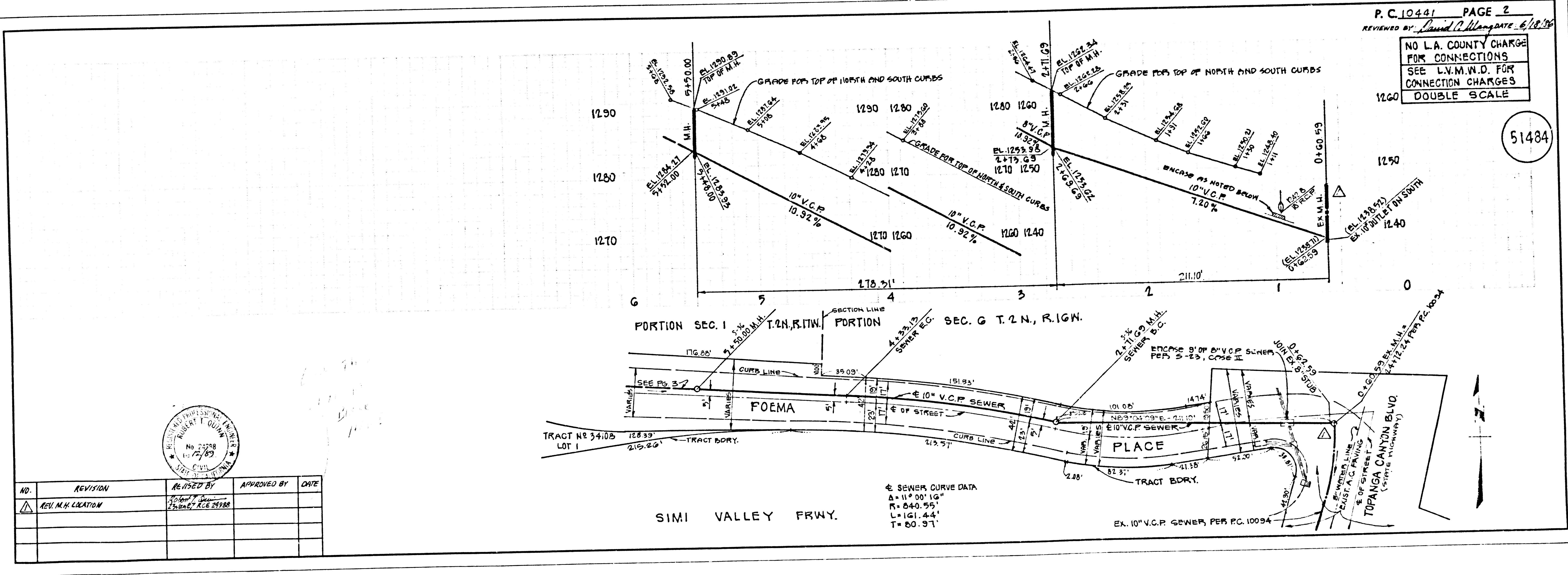

NO.	REVISION	REVISED BY	APPROVED BY	DATE
1	REV. M.H. LOCATION	<i>Robert T. Quinn</i>	<i>Sauji G. Ibali</i>	2/12/87



