

BENEDA LANE
PRIVATE CONTRACT NO. 10499
A-74, A-5,6
SHEET 2 PAGES

SCALE: HORIZ. 1" = 40'
VERT. 1" = 5'
PREPARED IN THE OFFICES OF
ANDEL ENGINEERING COMPANY
24707 SAN FERNANDO ROAD
NEWHALL, CALIFORNIA
E.L. BOLDEN JR. RCE 10533

51325

- GENERAL NOTES:**
- ELEVATIONS ARE IN FEET ABOVE U.S.C. & G.S. SEA LEVEL DATUM OF 1929.
 - NO REVISIONS SHALL BE MADE TO THESE PLANS WITHOUT THE APPROVAL OF THE DIRECTOR OF PUBLIC WORKS.
 - NO REPRESENTATIVE OF THE DEPARTMENT OF PUBLIC WORKS WILL SURVEY OR LAY OUT ANY PORTION OF THE WORK.
 - CONTRACTOR SHALL BE RESPONSIBLE FOR THE CORRECTNESS OF ALL DIMENSIONS AND PROFILES. GRADE POINTS FOR TOP OF PIPE SHALL BE SHOWN AT EVERY 100 FEET OR FRACTION THEREOF. ALL POINTS BETWEEN GRADE POINTS SHALL BE INTERPOLATED. GRADE SHALL BE SHOWN BY DOTTED LINE. GRADE BETWEEN GRADE POINTS SHALL BE SHOWN BY DOTTED LINE.
 - THE PRIVATE CONTRACTOR SHALL FURNISH THE CIVIL ENGINEER WITH PROFILES AND STATISTICS FOR ALL HOME LATERALS AND 4" OR 6" BRANCHES AND SHALL PROVIDE STAKES FOR TOP OF ALL FACTS PROVIDED LOCATIONS WITH STATISTICAL PLANS. ALL HOME LATERALS AND BRANCHES SHALL BE CONSTRUCTED IN A STRAIGHT LINE FROM THE MAIN LINE SEWER EXCEPT AS SHOWN ON THE PLANS. HOME LATERALS FROM CHIMNEYS SHALL NOT BE MORE THAN 10 FEET FROM THE MAIN LINE SEWER. HOME LATERALS SHALL BE GRADEDED AS SHOWN IN THE PLANS. HOME LATERALS SHALL BE CONSTRUCTED WITHIN THE PROPERTY LINE UNLESS OTHERWISE SHOWN.
 - THE PRIVATE CONTRACTOR SHALL FURNISH THE HOME LATERAL DEPTH AT THE PROPERTY LINE BELOW THE TOP OF MAIN LATERAL FOR EACH HOME LATERAL ON THE GRADE SHEET.
 - BEFORE WORK CAN BE BEGUN, THE CONTRACTOR MUST OBTAIN A PERMIT TO EXCAVATE IN COUNTY STREETS FROM THE S.P.A. COUNTY ROAD DEPT., DISTRICT OFFICE NO. 2, AND PAY A FEE TO THE DIRECTOR OF PUBLIC WORKS, 500 S. VERNON AVE., LOS ANGELES, CALIFORNIA. UNDER THE SANITATION DISTRICTS ACT AND UNDER THE PUBLIC UTILITY PIPE, OR STRUCTURE WITHIN THE LIMITS OF THE PUBLIC UTILITY DISTRICTS ACT.
 - IF WORK IS TO BE DONE IN A STATE STREET, A PERMIT MUST BE OBTAINED FROM THE STATE OF CALIFORNIA. DIVISION OF HIGHWAYS, 100 SOUTH MAIN STREET, LOS ANGELES, CALIFORNIA.
 - APPROVAL OF THIS PLAN BY THE COUNTY ENGINEER DOES NOT CONSTITUTE A REPRESENTATION AS TO THE ACCURACY OF THE LOCATION OF THE EXISTING OR PROPOSED UTILITIES OR THE EXISTENCE OF ANY UNDERGROUND UTILITY PIPE, OR STRUCTURE WITHIN THE LIMITS OF THE PUBLIC UTILITY DISTRICTS ACT.
 - WORK IN SECTION 10-10-1.1 OF THE STANDARD SPECIFICATIONS, RECOMMENDED SAFETY SIGNS.
 - PLEASE TO THE LANGUAGE OF THE RECOMMENDED SAFETY SIGNS. THE CONTRACTOR SHALL OBTAIN AND FILE WITH THE COUNTY ENGINEER A COPY OF A PERMIT TO EXCAVATE IN COUNTY STREETS FROM THE PUBLIC UTILITY DISTRICTS ACT AND A PERMIT TO EXCAVATE AND WORK IN COUNTY STREETS FROM THE PUBLIC UTILITY DISTRICTS ACT. A CERTIFICATE OF WORKER'S COMPENSATION INSURANCE WITH AN AMOUNT OF \$100,000.00 AND A CERTIFICATE OF LIABILITY INSURANCE WITH AN AMOUNT OF \$100,000.00, DATED ON THE DATE OF THE PERMIT TO EXCAVATE IN COUNTY STREETS SHALL BE SUBMITTED TO THE COUNTY ENGINEER PRIOR TO COMMENCEMENT OF WORK.

- CONSTRUCTION NOTES:**
- WORK SHALL BE CONSTRUCTED ACCORDING TO THE STANDARD SPECIFICATIONS FOR PUBLIC WORKS SUBSTITUTIVE CHAPTER 10-10-1.1, REVISED AND AMENDED EDITION, AND THE STANDARD SPECIFICATIONS FOR THE CONSTRUCTION OF SANITARY SEWERS, SECTION 10-10-1.1, REVISED AND AMENDED EDITION, AND THE STANDARD SPECIFICATIONS FOR THE CONSTRUCTION OF SANITARY SEWERS, SECTION 10-10-1.1, REVISED AND AMENDED EDITION, AND THE STANDARD SPECIFICATIONS FOR THE CONSTRUCTION OF SANITARY SEWERS, SECTION 10-10-1.1, REVISED AND AMENDED EDITION.
 - THE CONTRACTOR SHALL VERIFY THE CORRECTLY CIRCULATED POSITION OF TELEPHONE CABLES, AT LEAST TWENTY FEET FROM THE CENTER LINE OF THE MAIN LINE SEWER UNDER THIS CONTRACT.
 - HOME LATERALS TO BE CONSTRUCTED WITHIN PROPERTY LINE 6 FEET BELOW MAIN GRADE EXCEPT AS NOTED.
 - USE THE DIMENSIONS SHOWN ON THE PLANS FOR DETERMINING THE LOCATION OF HOME LATERALS EXCEPT AS NOTED.
 - ALL STRUCTURES SHALL BE EITHER OPEN OR CLOSED PER 10-10-1.1 OF THE STANDARD SPECIFICATIONS FOR PUBLIC WORKS, EXCEPT AS NOTED.
 - HOME LATERALS TO BE CONSTRUCTED WITHIN PROPERTY LINE 6 FEET BELOW MAIN GRADE EXCEPT AS NOTED.
 - UNLESS NOTED OTHERWISE, ALL STRUCTURES SHALL BE CONSTRUCTED WITHIN PROPERTY LINE 6 FEET BELOW MAIN GRADE EXCEPT AS NOTED.
 - VERIFIED MAIN PIPE JOISTS SHALL BE TYPE "M", "N", OR "P" PER STANDARD SPECIFICATIONS SECTION 10-10-1.1, REVISED AND AMENDED EDITION, AND THE STANDARD SPECIFICATIONS FOR THE CONSTRUCTION OF SANITARY SEWERS, SECTION 10-10-1.1, REVISED AND AMENDED EDITION.
 - IF HOME LATERALS ARE TO BE CONSTRUCTED WITHIN PROPERTY LINE 6 FEET BELOW MAIN GRADE EXCEPT AS NOTED, THE CONTRACTOR SHALL VERIFY THE CORRECTLY CIRCULATED POSITION OF TELEPHONE CABLES, AT LEAST TWENTY FEET FROM THE CENTER LINE OF THE MAIN LINE SEWER UNDER THIS CONTRACT.
 - ALL JOISTS BETWEEN MAIN LINE PIPE AND VERIFIED MAIN PIPE SHALL BE MADE WITH A RIGID JOIST, TYPE "M", "N", OR "P" PER STANDARD SPECIFICATIONS FOR PUBLIC WORKS, SECTION 10-10-1.1, REVISED AND AMENDED EDITION.
 - SEWERS TO BE TESTED FOR LEAKAGE PER SECTION 10-10-1.1 OF THE STANDARD SPECIFICATIONS AND SPECIAL PROVISIONS.
 - REPAIRS TO ALL EXISTING UTILITIES SHALL BE MADE TO MEET L.A. COUNTY PUBLIC WORKS OR CALIFORNIA STATE HIGHWAY REQUIREMENTS TO CONFORM WITH PERMITS.
 - ALL COMPLIANCE WITH SECTION 10-10-1.1 OF THE STANDARD SPECIFICATIONS WILL BE REQUIRED FOR BANSHELL IN STREET. NOTIFICATION OF BANSHELL IN STREET SHALL BE MADE TO THE COUNTY ENGINEER PRIOR TO THE COMMENCEMENT OF WORK.
 - SPECIAL BANSHELL IN STREET REQUIREMENTS SHALL BE REQUIRED FOR BANSHELL IN STREET. NOTIFICATION OF BANSHELL IN STREET SHALL BE MADE TO THE COUNTY ENGINEER PRIOR TO THE COMMENCEMENT OF WORK.

THE FOLLOWING LATEST REVISED STANDARD PLANS ON FILE IN THE OFFICE OF THE COUNTY ENGINEER SHALL APPLY TO THE CONSTRUCTION OF THIS PROJECT:

STANDARD PLAN NO. 10-10-1.1	STANDARD SPECIFICATIONS FOR PUBLIC WORKS SUBSTITUTIVE CHAPTER 10-10-1.1, REVISED AND AMENDED EDITION
STANDARD PLAN NO. 10-10-1.2	STANDARD SPECIFICATIONS FOR THE CONSTRUCTION OF SANITARY SEWERS, SECTION 10-10-1.2, REVISED AND AMENDED EDITION
STANDARD PLAN NO. 10-10-1.3	STANDARD SPECIFICATIONS FOR THE CONSTRUCTION OF SANITARY SEWERS, SECTION 10-10-1.3, REVISED AND AMENDED EDITION
STANDARD PLAN NO. 10-10-1.4	STANDARD SPECIFICATIONS FOR THE CONSTRUCTION OF SANITARY SEWERS, SECTION 10-10-1.4, REVISED AND AMENDED EDITION
STANDARD PLAN NO. 10-10-1.5	STANDARD SPECIFICATIONS FOR THE CONSTRUCTION OF SANITARY SEWERS, SECTION 10-10-1.5, REVISED AND AMENDED EDITION
STANDARD PLAN NO. 10-10-1.6	STANDARD SPECIFICATIONS FOR THE CONSTRUCTION OF SANITARY SEWERS, SECTION 10-10-1.6, REVISED AND AMENDED EDITION
STANDARD PLAN NO. 10-10-1.7	STANDARD SPECIFICATIONS FOR THE CONSTRUCTION OF SANITARY SEWERS, SECTION 10-10-1.7, REVISED AND AMENDED EDITION
STANDARD PLAN NO. 10-10-1.8	STANDARD SPECIFICATIONS FOR THE CONSTRUCTION OF SANITARY SEWERS, SECTION 10-10-1.8, REVISED AND AMENDED EDITION
STANDARD PLAN NO. 10-10-1.9	STANDARD SPECIFICATIONS FOR THE CONSTRUCTION OF SANITARY SEWERS, SECTION 10-10-1.9, REVISED AND AMENDED EDITION
STANDARD PLAN NO. 10-10-1.10	STANDARD SPECIFICATIONS FOR THE CONSTRUCTION OF SANITARY SEWERS, SECTION 10-10-1.10, REVISED AND AMENDED EDITION

COUNTY OF LOS ANGELES, CALIFORNIA
THOMAS A. TIDMANN, DIRECTOR OF PUBLIC WORKS
APPROVED: *Carroll Blum* 4/21/86
CHECKED: *F. J. ...* 4/21/86
DATE: 4/21/86
APPROVED OFFICE EMPLOYED DATE: 4/21/86
DATE: 4/21/86
REG. C.E. NO. ...

SANTA CLARITA VALLEY BUILDING DISTRICT NO. 12

B.M. CL 2953 ELEV. 1540.412
F.C. MON. SW COR. CONC. BRIDGE 61507 15 FT. W. 478 FT. S. & INT. SIERRA HWY. & SCHERZINGER LN. (N. INT.) MMD. (B.M. 97-14 1950)

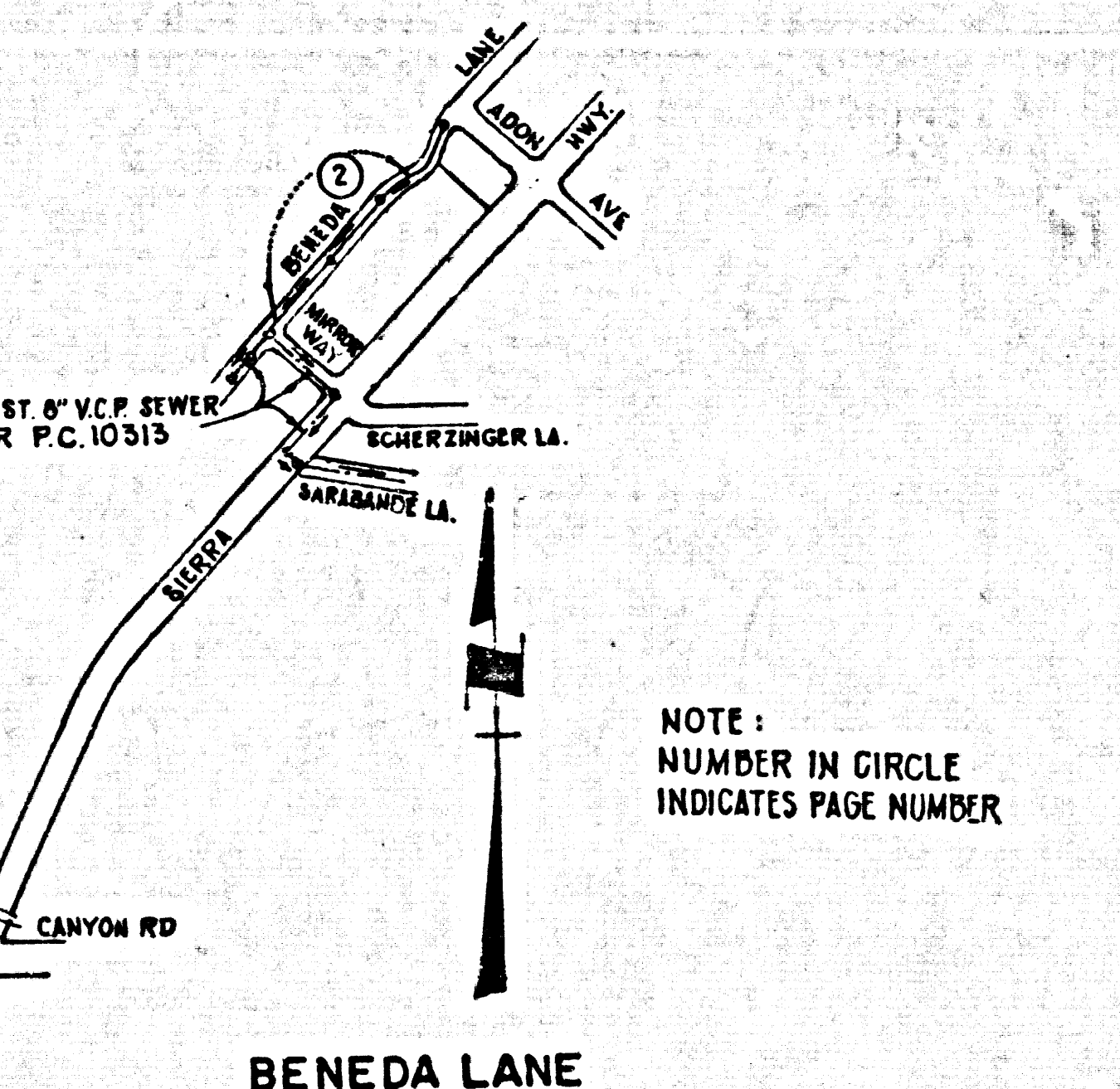

BENEDA LANE
P.C. NO. 10499
INDEX MAP
SCALE: 1" = 600'

DOUBLE SCALE

NO CONNECTION FOR THE DISPOSAL OF INDUSTRIAL WASTEWATER SHALL BE MADE TO SEWERS SHOWN ON THESE DRAWINGS UNTIL A PERMIT FOR INDUSTRIAL WASTEWATER DISCHARGE HAS BEEN ISSUED BY THE SANITATION DISTRICTS FOR SAID CONNECTION.

BEFORE BREAKING INTO OR CONSTRUCTION ON A COUNTY SANITATION DISTRICT SEWER AND PRIOR TO FINAL ACCEPTANCE OF THE PROJECT, SANITATION DISTRICT INSPECTOR SHALL BE NOTIFIED BY PHONE (805) 947-5027 SO THAT REQUIRED INSPECTION CAN BE MADE.

NOTICE TO CONTRACTOR

BEFORE ANY EXCAVATION NEAR CROSSING OF EXISTING BEN-SHUR WATER LINES, CONTRACTOR MUST NOTIFY WATER MASTER, MR. OLLING AT (252) 3409 - 24 HOURS BEFORE STARTING ANY WORK.

ALL COST TO BE BORNE BY CONTRACTOR

REVIEWED BY *...* DATE *4/21/86*

P.C. 10499 PAGE 2
SEE COUNTY SANITATION DIST. FOR SPECIAL CONNECTION CHARGES
COLLECT CHARGES AS INDICATED

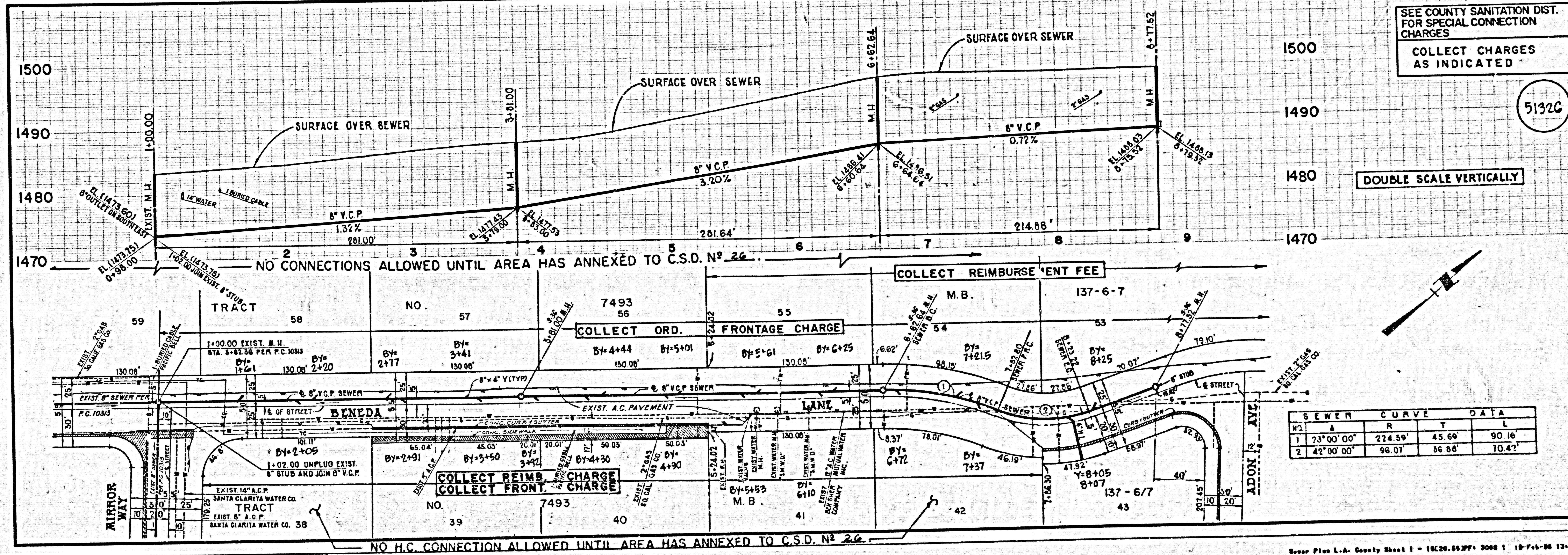

SEWER CURVE DATA

NO.	A	R	T	L
1	23°00'00"	224.59'	45.60'	90.16'
2	42°00'00"	96.07'	36.88'	10.42'