

B.M. C.L. 1744 ELEV. 1078.401
 RDBM TAG S.C.B. TRAFFIC ISL. 15 FT.
 N.C.V. S. ROWBY MARG. MT. PKWY. E 70 FT.
 W.C.V. GOLDEN ST. FRYW. BRIDGE B 53-1625
 NEWHALL QUAD. 1979

DOUBLE SCALE

REVISION NO. 1
 PAGE 2: REVISED PLAN & PROFILE FROM STA. 0+00.00 TO STA. 0+90.20
 APPROVED BY: *Paul P. Ham* 1-15-87
 DEPT. OF PUBLIC WORKS DATE

REVISION NO. 2
 PAGE 2: ADDED 6" H.L. IN LOT 7 AT STA. 8+99
 APPROVED BY: *Paul P. Ham* 2/22/87
 DEPT. OF PUBLIC WORKS DATE

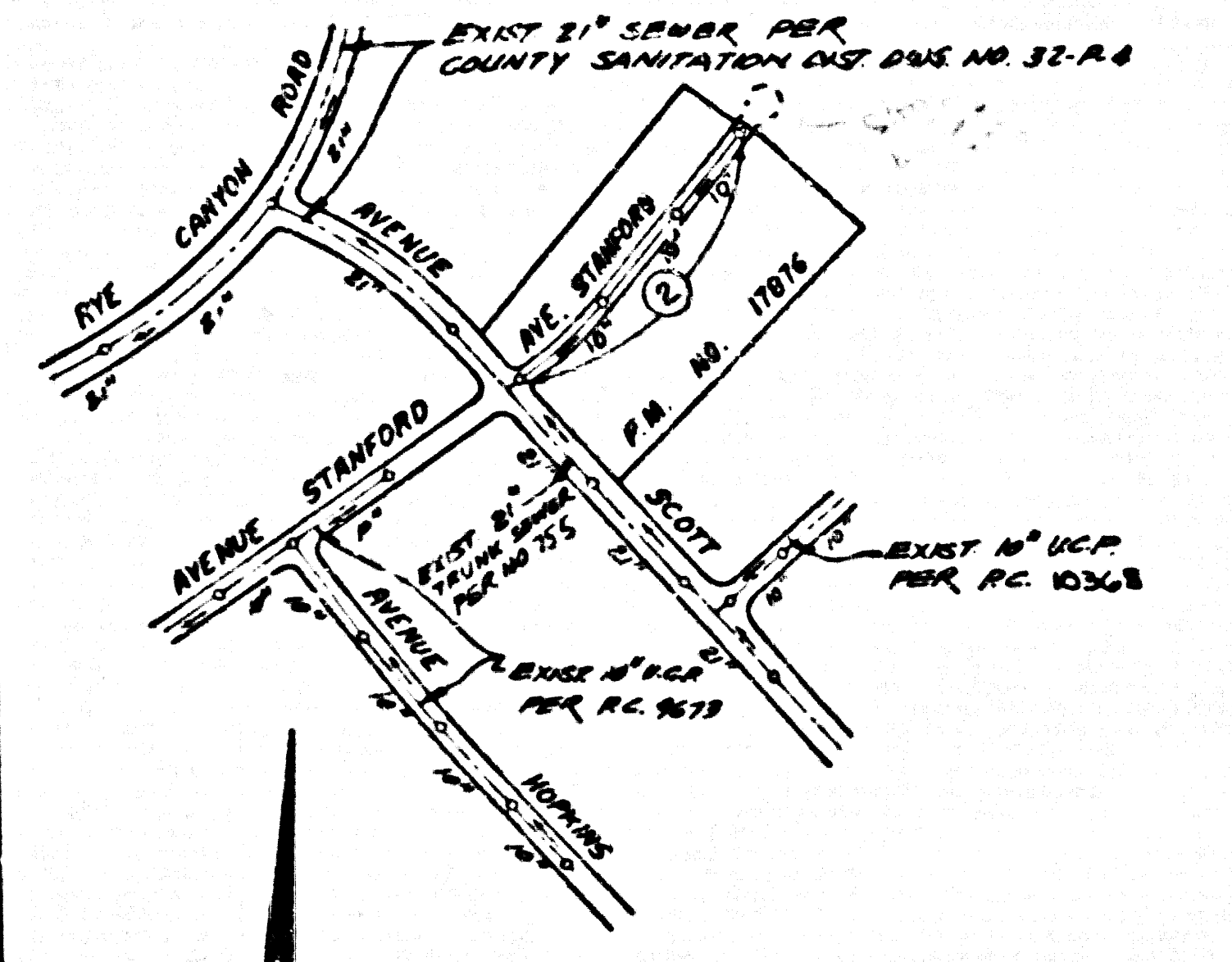

INDEX MAP
 SCALE: 1" = 600'
 P.C. NO. 10524
 P.M. NO. 17876

NOTE: NUMBERS IN CIRCLES INDICATES PAGE NUMBER

NO CONNECTION FOR THE DISPOSAL OF INDUSTRIAL WASTES SHALL BE MADE TO SEWERS SHOWN ON THESE DRAWINGS UNTIL A PERMIT FOR INDUSTRIAL WASTEWATER DISCHARGE HAS BEEN ISSUED BY THE SANITATION DISTRICTS FOR SAID CONNECTION.

BEFORE BREAKING INTO OR CONSTRUCTION ON A COUNTY SANITATION DISTRICT SEWER AND PRIOR TO FINAL ACCEPTANCE OF THE PROJECT, SANITATION DISTRICT INSPECTOR SHALL BE NOTIFIED BY PHONE 818 - 962-8605 SO THAT REQUIRED INSPECTION CAN BE MADE.

- GENERAL NOTES:**
- ELEVATIONS ARE REFERRED ABOVE U.S.C. & G.S. SEA LEVEL DATUM OF 1989.
 - NO REVISIONS SHALL BE MADE IN THESE PLANS WITHOUT THE APPROVAL OF THE DIRECTOR OF PUBLIC WORKS.
 - NO REPRESENTATIVE OF THE DEPARTMENT OF PUBLIC WORKS SHALL BE PRESENT ON ANY PORTION OF THE WORK.
 - GRADES TO WHICH THIS IMPROVEMENT IS TO BE CONSTRUCTED ARE SHOWN ON PLANS AND PROFILES. GRADES FOR TOP OF CURBS, CENTER LINE OF STREETS, OR TOP OF SIDEWALKS SHALL BE SHOWN BY CIRCLES OR SQUARES. GRADES FOR TOP OF CURBS, CENTER LINE OF STREETS, OR TOP OF SIDEWALKS SHALL BE SHOWN BY TRIANGLES. GRADES FOR TOP OF CURBS, CENTER LINE OF STREETS, OR TOP OF SIDEWALKS SHALL BE SHOWN BY TRIANGLES. GRADES FOR TOP OF CURBS, CENTER LINE OF STREETS, OR TOP OF SIDEWALKS SHALL BE SHOWN BY TRIANGLES.
 - THE PRIVATE ENGINEER SHALL FURNISH THE DEPARTMENT OF PUBLIC WORKS WITH STANDARD SHEETS AND STRIPINGS FOR ALL HOUSE LATERALS AND "Y" OR "T" BRANCHES AND SHALL PROVIDE STAGES FOR THREE AT THESE LOCATIONS TO BE PROVIDED. PLANS SHALL BE SHOWN ON THE PLANS. HOUSE LATERALS SHALL NOT HAVE AN ANGLE OF LESS THAN 45° WITH THE MAIN LINE SEWER. ANY CHANGE IN ALIGNMENT SHALL BE REQUESTED IN WRITING BY THE PRIVATE ENGINEER.
 - THE PRIVATE ENGINEER SHALL FURNISH THE HOUSE LATERAL DEPTH AT THE PROPERTY LINE BELOW THE TOP OF CURB ELEVATION FOR EACH HOUSE LATERAL ON THE GRADE SHEET.
 - NO WORK CAN BE STARTED UNTIL THE CONTRACTOR OBTAINS A PERMIT TO EXCAVATE IN COUNTY STREETS FROM THE ROAD & STREET DIVISION OF THE COUNTY OF LOS ANGELES DEPARTMENT OF PUBLIC WORKS. THE PERMIT FEE IS \$250.00 PER DAY. THE PERMIT FEE IS \$250.00 PER DAY. THE PERMIT FEE IS \$250.00 PER DAY.
 - IF WORK IS TO BE DONE IN A STATE HIGHWAY, A PERMIT MUST BE OBTAINED FROM THE STATE OF CALIFORNIA DIVISION OF HIGHWAYS, 130 SOUTH SPRING STREET, LOS ANGELES, CALIFORNIA.
 - APPROVAL OF THIS PLAN BY THE COUNTY OF LOS ANGELES DOES NOT CONSTITUTE A REPRESENTATION AS TO THE ACCURACY OF THE LOCATION OF OR THE EXISTENCE OR NON-EXISTENCE OF ANY UNDERGROUND UTILITY PIPE, OR STRUCTURE WITHIN THE LIMITS OF THIS PROJECT. THIS NOTE APPLIES TO ALL PAGES.
 - REFER TO SECTION 7.1.1.1 OF THE STANDARD SPECIFICATIONS REGARDING SAFETY ORDERS.
 - IN ACCORDANCE WITH THE STANDARD SPECIFICATIONS FOR PUBLIC WORKS CONSTRUCTION, THE CONTRACTOR SHALL OBTAIN AND FILE WITH THE DEPARTMENT OF PUBLIC WORKS COPIES OF A PERMIT TO EXCAVATE IN COUNTY STREETS FROM THE ROAD & STREET DIVISION OF THE COUNTY OF LOS ANGELES DEPARTMENT OF PUBLIC WORKS. A PERMIT FOR EXCAVATION SHALL BE OBTAINED FROM THE COUNTY OF LOS ANGELES DEPARTMENT OF PUBLIC WORKS. A PERMIT FOR EXCAVATION SHALL BE OBTAINED FROM THE COUNTY OF LOS ANGELES DEPARTMENT OF PUBLIC WORKS.
 - ALL JOINTS BETWEEN CAST IRON PIPE AND WITHEDED CLAY PIPE SHALL BE MADE WITH A RUBBER BUSH JOINT TYPE "C" OR "D" WITH BUSHING IF NECESSARY PER STANDARD SPECIFICATIONS, SECTION 200-2.
 - SEWERS TO BE TESTED FOR LEAKAGE PER SECTION 200-1.4 OF THE STANDARD SPECIFICATIONS AND SPECIAL PROVISIONS.
 - RESURFACE ALL TRENCHES WITHIN PAVED AREAS TO MEET LOS ANGELES COUNTY PUBLIC WORKS OR CALIFORNIA STATE HIGHWAY REQUIREMENTS AS ACCORDANCE WITH PERMITS.
 - FULL COMPLIANCE WITH SECTION 200-1.4 OF THE STANDARD SPECIFICATIONS SHALL BE REQUIRED FOR BACKFILL. STREETS, CERTIFICATION OF BACKFILL COMPACTION AND SAND EQUIVALENT BY A QUALIFIED INDEPENDENT TESTING LABORATORY SHALL BE PROVIDED BY THE PERMITTEE PRIOR TO THE ISSUANCE OF A CERTIFICATE OF FINAL ACCEPTANCE.
 - SPECIAL BACKFILL REQUIREMENTS CONSTRUCTION IS BACKFILL TRENCH AND REPLACE OTHER BACKFILL SO AS TO ACHIEVE THE NATURAL OR PREVIOUS GRADES AND SLOPES SHOWN ON THE GRADING PLAN APPROVED FOR THIS DIVISION BY THE BUILDING AND SAFETY DIVISION. IN ALL BACKFILL AND EARTH REPAIRS SHALL BE COMPACTED TO A MINIMUM OF 90% OF MAXIMUM DENSITY PER A.S.T.M. METHOD OF TESTS. ALL BACKFILL AND EARTH REPAIRS SHALL BE SUBMITTED TO THE CONSTRUCTION DIVISION.

- CONSTRUCTION NOTES:**
- WORK SHALL BE CONSTRUCTED ACCORDING TO THE STANDARD SPECIFICATIONS FOR PUBLIC WORKS CONSTRUCTION, 1989 EDITION WITH THE COUNTY OF LOS ANGELES DEPARTMENT OF PUBLIC WORKS SPECIAL PROVISIONS AND THE COUNTY OF LOS ANGELES DEPARTMENT OF PUBLIC WORKS SPECIAL PROVISIONS.
 - THE CONTRACTOR SHALL NOTIFY THE CONSTRUCTION DIVISION BY TELEPHONE 228-2281 AT LEAST TWENTY-FOUR HOURS BEFORE STARTING ANY WORK UNDER THIS CONTRACT.
 - HOUSE LATERALS TO BE CONSTRUCTED WITH INVERTS AT PROPERTY LINE 8 FEET BELOW CURB GRADE EXCEPT AS NOTED.
 - PIPE OR THE BRANCHES MAY BE USED FOR CONNECTIONS TO MAINLINE SEWERS EXCEPT AS NOTED.
 - ALL STRUCTURES SHALL BE EITHER BRICK MANHOLES PER 9-9 OR PRECAST CONCRETE MANHOLES PER 9-9 EXCEPT AS NOTED.
 - PROPOSED STAGES ON THE PROPERTY LINE OR PROPERTY LINES PRODUCE AT RIGHT ANGLES TO THE SEWER LINE AT THE CENTER LINE OF EACH MANHOLE.
 - MANHOLE TOPS IN UNIMPROVED RIGHTS OF WAY TO BE SIX INCHES ABOVE FINISHED GRADE.
 - WITHEDED CLAY PIPE JOINTS SHALL BE TYPE "C" OR "D" PER STANDARD SPECIFICATIONS SECTION 200-2.
 - IF A POWER POLE IS WITHIN THREE FEET OF THE SEWER, THE SEWER SHALL BE ENCASED PER 9-9.5. CASE H TWO FEET ON EACH SIDE FROM THE POINT OF INTERFERENCE.
 - IF DURING THE COURSE OF CONSTRUCTION IT IS DETERMINED THAT THERE IS LESS THAN FOUR FEET OF COVER OVER THE TOP OF A MAIN LINE OR HOUSE LATERAL V.C.P. SEWER WHICH IS NOT INDICATED ON THE PLANS, THE PIPE SHALL BE ENCASED PER 9-9.5. CASE H UNLESS OTHERWISE APPROVED BY THE DIRECTOR OF PUBLIC WORKS.
 - ALL JOINTS BETWEEN CAST IRON PIPE AND WITHEDED CLAY PIPE SHALL BE MADE WITH A RUBBER BUSH JOINT TYPE "C" OR "D" WITH BUSHING IF NECESSARY PER STANDARD SPECIFICATIONS, SECTION 200-2.
 - SEWERS TO BE TESTED FOR LEAKAGE PER SECTION 200-1.4 OF THE STANDARD SPECIFICATIONS AND SPECIAL PROVISIONS.
 - RESURFACE ALL TRENCHES WITHIN PAVED AREAS TO MEET LOS ANGELES COUNTY PUBLIC WORKS OR CALIFORNIA STATE HIGHWAY REQUIREMENTS AS ACCORDANCE WITH PERMITS.
 - FULL COMPLIANCE WITH SECTION 200-1.4 OF THE STANDARD SPECIFICATIONS SHALL BE REQUIRED FOR BACKFILL. STREETS, CERTIFICATION OF BACKFILL COMPACTION AND SAND EQUIVALENT BY A QUALIFIED INDEPENDENT TESTING LABORATORY SHALL BE PROVIDED BY THE PERMITTEE PRIOR TO THE ISSUANCE OF A CERTIFICATE OF FINAL ACCEPTANCE.
 - SPECIAL BACKFILL REQUIREMENTS CONSTRUCTION IS BACKFILL TRENCH AND REPLACE OTHER BACKFILL SO AS TO ACHIEVE THE NATURAL OR PREVIOUS GRADES AND SLOPES SHOWN ON THE GRADING PLAN APPROVED FOR THIS DIVISION BY THE BUILDING AND SAFETY DIVISION. IN ALL BACKFILL AND EARTH REPAIRS SHALL BE COMPACTED TO A MINIMUM OF 90% OF MAXIMUM DENSITY PER A.S.T.M. METHOD OF TESTS. ALL BACKFILL AND EARTH REPAIRS SHALL BE SUBMITTED TO THE CONSTRUCTION DIVISION.

PROFILE ALIGNMENT AND GRADE OF
SANITARY SEWERS
 TO BE CONSTRUCTED IN
 P.M. NO. 17876
 PRIVATE CONTRACT NO. 10524
 INDEX: A69-E-3 W.S. 63
 1 SHEET 2 PAGES

SCALE: VERT. 1" = 4'
 HORIZ. 1" = 40'

PREPARED IN THE OFFICES OF
 CIVIL ENGINEERING ASSOCIATES
 1525 BROADWAY, SUITE 200
 VAN NUYS, CALIFORNIA 91411
 BY: *Paul P. Ham*
 REG. CE NO. 16912

THE FOLLOWING LATEST REVISED STANDARD PLANS ON FILE IN THE OFFICE OF THE DEPARTMENT OF PUBLIC WORKS SHALL APPLY TO THE CONSTRUCTION OF THIS PROJECT:

LEGEND	9-1
MINIMUM PUBLIC SAFETY REQUIREMENTS	9-2
BRICK MANHOLE	9-3
STANDARD MANHOLE STEP	9-7
BEDDING FOR SEWER PIPE	9-11
CRACKING AND ENCASING	9-13
PIPE ON THE SUPPORT	9-14
ALLOWABLE TRENCH WIDTHS	9-16
LOADING MANHOLE FRAME AND COVER	9-18
HOW REINFORCED PRECAST CONCRETE MANHOLES IN RIGHT-OF-WAY & COUNTY SIDEWALK STANDARD SHALL APPLY TO THE CONSTRUCTION OF THIS PROJECT.	9-20

COUNTY OF LOS ANGELES, CALIFORNIA
 THOMAS A. FIDEMANSON
 DIRECTOR OF PUBLIC WORKS

APPROVED: *Paul P. Ham* 10/21/86
 DATE

CHECKED: *Henry C. Anderson* 10/16/86
 DATE

REG. CE NO. 17133

SANTA CLARITA VALLEY BLDG. DIST. # 2

