

# SANITARY SEWERS

TO BE CONSTRUCTED IN

R/W N/O MOONEY DRIVE

PRIVATE CONTRACT NO. 10548

U-32 ~ A.2

1 SHEETS, 2 PAGES

51776

SCALE: HORIZ. 1" = 40' VERT. 1" = 4'

JUNE 1966

PREPARED IN THE OFFICES OF

STEPHEN FANG

1105 FREEMONT AVE., ALHAMBRA, CA TELE (818) 283-0877

BY: *Stephen Fang*

REG. CE NO. 28,226

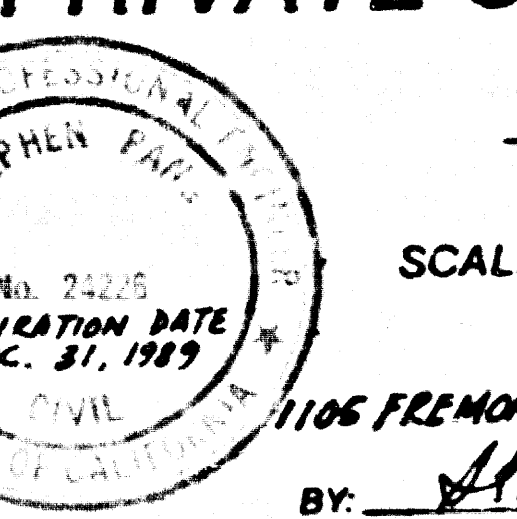

## DOUBLE SCALE

B.M. CY 9439 ELEV. 321.132  
 E.D.B.M. TAG E. CURB, 1' N/O BCR AT NE COR.  
 SAN GABRIEL BLVD. & BLECKER ST. 42'E.  
 841' N/O 6 INT.  
 WHITTIER QUAD. 1975

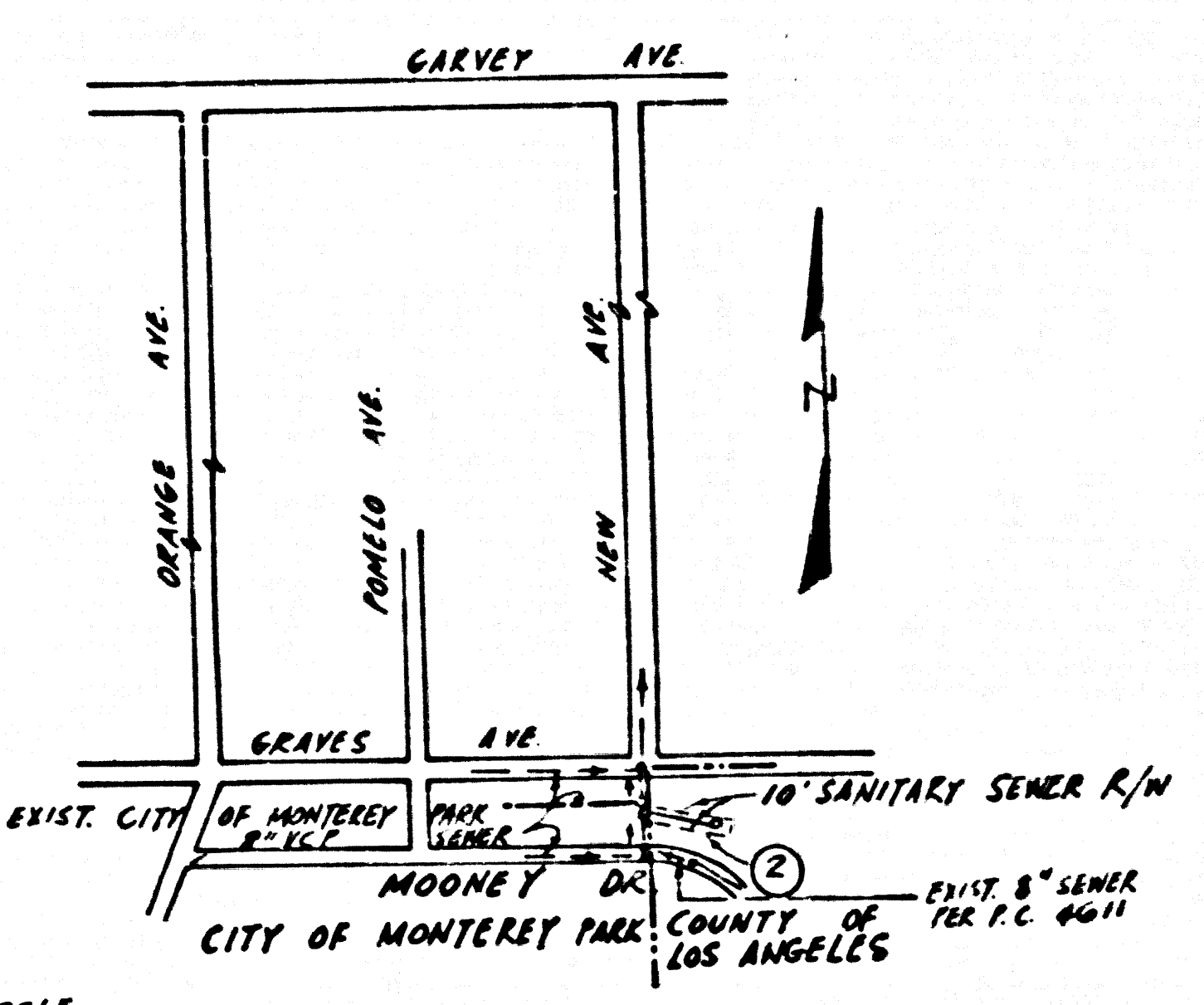

NOTE: NUMBER IN CIRCLE INDICATES PAGE NUMBER

VICINITY MAP  
 SCALE: 1" = 600'  
 RIGHT OF WAY N/O MOONEY DRIVE  
 P.C. NO 10548

NO CONNECTION FOR THE DISPOSAL OF INDUSTRIAL WASTES SHALL BE MADE TO SEWERS SHOWN ON THESE DRAWINGS UNTIL A PERMIT FOR INDUSTRIAL WASTEWATER DISCHARGE HAS BEEN ISSUED BY THE SANITATION DISTRICTS FOR SAID CONNECTION.

BEFORE BREAKING INTO OR CONSTRUCTION ON A COUNTY SANITATION DISTRICT SEWER AND PRIOR TO FINAL ACCEPTANCE OF THE PROJECT, SANITATION DISTRICT INSPECTOR SHALL BE NOTIFIED BY PHONE (818) 962-8605 SO THAT REQUIRED INSPECTION CAN BE MADE.

### GENERAL NOTES:

- ELEVATIONS ARE IN FEET ABOVE U.S.C. & G.S. MEAN LEVEL OF TIDE OF 1989.
- NO REVISIONS SHALL BE MADE IN THESE PLANS WITHOUT THE APPROVAL OF THE DIRECTOR OF PUBLIC WORKS.
- NO REVISIONS SHALL BE MADE IN THESE PLANS WITHOUT THE APPROVAL OF THE DIRECTOR OF PUBLIC WORKS.
- CONTRACTOR SHALL BE RESPONSIBLE FOR OBTAINING ALL NECESSARY PERMITS AND APPROVALS FROM THE CITY OF MONTEREY PARK AND THE COUNTY OF LOS ANGELES.
- THE CONTRACTOR SHALL FURNISH THE DEPARTMENT OF PUBLIC WORKS WITH SUFFICIENT STAKES AND STATIONING FOR ALL HOUSE LATERALS AND HOUSE LATERALS SHALL BE CONSTRUCTED IN A STRAIGHT ALIGNMENT AT RIGHT ANGLES FROM THE MAIN LINE SEWER EXCEPT AS SHOWN ON THE PLANS. HOUSE LATERALS FROM CHIMNEYS SHALL NOT HAVE AN ANGLE OF LESS THAN 45° WITH THE MAIN LINE SEWER. ANY CHANGE IN ALIGNMENT SHALL BE REQUESTED IN WRITING BY THE PRIVATE ENGINEER.
- THE PRIVATE ENGINEER SHALL FURNISH THE HOUSE LATERAL DEPTH AT THE PROPERTY LINE BELOW THE TOP OF CURB ELEVATION FOR EACH HOUSE LATERAL ON THE GRADE SHEET.
- BEFORE WORK CAN BE STARTED, THE CONTRACTOR MUST OBTAIN A PERMIT TO EXCAVATE IN COUNTY STREETS FROM THE ROAD ELEMENT OF THE LOS ANGELES DEPARTMENT OF PUBLIC WORKS, DISTRICT OFFICE NO. 6, AND PAY A FEE TO THE DIRECTOR OF PUBLIC WORKS, 2200 BEAVER ST., LOS ANGELES, CALIFORNIA 90007, TO COVER THE COST OF CONSTRUCTION INSPECTION AND RECORD PLANS.
- IF WORK IS TO BE DONE IN STATE HIGHWAY, A PERMIT MUST BE OBTAINED FROM THE STATE OF CALIFORNIA, DIVISION OF HIGHWAY, 130 SOUTH SPRING STREET, LOS ANGELES, CALIFORNIA.
- APPROVAL OF THIS PLAN BY THE COUNTY OF LOS ANGELES DOES NOT CONSTITUTE A REPRESENTATION AS TO THE ACCURACY OF THE LOCATION OR THE EXISTENCE OR NON-EXISTENCE OF ANY UNDERGROUND UTILITY PIPE OR STRUCTURE WITHIN THE LIMITS OF THIS PROJECT. THIS NOTE APPLIES TO ALL PAGES.
- REFER TO SECTION 710.4 OF THE STANDARD SPECIFICATIONS REGARDING SAFETY ORDERS.
- PRIOR TO THE ISSUANCE OF THE REQUIRED SEWER CONSTRUCTION PERMIT, THE CONTRACTOR MUST OBTAIN AND FILE WITH THE DEPARTMENT OF PUBLIC WORKS COPIES OF A PERMIT TO EXCAVATE IN COUNTY STREETS FROM THE ROAD ELEMENT AT THE DEPARTMENT OF PUBLIC WORKS, A PERMIT FOR EXCAVATIONS AND TRENCHES FROM THE STATE OF CALIFORNIA, A DIVISION OF INDUSTRIAL SAFETY AND A CERTIFICATE OF WORKERS COMPENSATION INSURANCE WITH THE DEPARTMENT OF PUBLIC WORKS, 2200 BEAVER ST., LOS ANGELES, CALIFORNIA 90007, BOOK AND NUMBER AS THE CERTIFICATE HOLDER TO BE NOTIFIED 30 DAYS PRIOR TO CANCELLATION OF POLICY.

### CONSTRUCTION NOTES:

- WORK SHALL BE CONSTRUCTED ACCORDING TO THE STANDARD SPECIFICATIONS FOR PUBLIC WORKS CONSTRUCTION 1986 EDITION WITH 1988 SUPPLEMENTS AND COUNTY DEPT. OF PUBLIC WORKS SPECIAL PROVISIONS FOR THE CONSTRUCTION OF SANITARY SEWERS DATED 12/11/78, AND SHALL BE PROSECUTED ONLY IN THE PRESENCE OF THE COUNTY DEPT. OF PUBLIC WORKS.
- THE CONTRACTOR SHALL NOTIFY THE CONSTRUCTION DIVISION BY TELEPHONE 226-8281 AT LEAST TWENTY-FOUR HOURS BEFORE START AND ANY WORK UNDER THE CONTRACT.
- HOUSE LATERALS TO BE CONSTRUCTED WITH INVERTS AT PROPERTY LINE 6 FEET BELOW CURB GRADE EXCEPT AS NOTED.
- WIRE OR TEE BRANCHES MAY BE USED FOR CONNECTIONS TO MAINLINE SEWERS EXCEPT AS NOTED.
- STRUCTURAL SHALL BE EITHER BRICK MANHOLES PER 3-36 OR PRECAST CONCRETE MANHOLES PER 3-36 EXCEPT AS NOTED.
- PROVIDE STAKES ON THE PROPERTY LINE OR PROPERTY LINES PRODUCED AT RIGHT ANGLES TO THE SEWER LINE AT THE CENTER LINE OF EACH MANHOLE.
- MANHOLE TOPS IN UNIMPROVED RIGHTS OF WAY TO BE SIX INCHES ABOVE FINISHED GRADE.
- WYTRIFIED CLAY PIPE JOINTS SHALL BE TYPE "D" OR "E" PER STANDARD SPECIFICATIONS SECTION 309-2.
- IF A POWER POLE IS WITHIN THREE FEET OF THE SEWER, THE SEWER SHALL BE ENCASED PER 3-36 CASE II TWO FEET FROM EACH SIDE FROM THE POINT OF INTERFERENCE.
- IF DURING THE COURSE OF CONSTRUCTION IT IS DETERMINED THAT THERE IS LESS THAN FOUR FEET OF COVER OVER THE TOP OF A MAIN LINE OR HOUSE LATERAL, V.C.P. SEWER WHICH IS NOT INDICATED ON THE PLANS, THE PIPE SHALL BE ENCASED PER 3-36 CASE II UNLESS OTHERWISE APPROVED BY THE DIRECTOR OF PUBLIC WORKS.
- ALL JOINTS BETWEEN CAST IRON PIPE AND WYTRIFIED CLAY PIPE SHALL BE MADE WITH A RUBBER SLEEVE JOINT, TYPE "C" OR "D" WITH BUSHING IF NECESSARY PER STANDARD SPECIFICATIONS, SECTION 309-3.
- SEWERS TO BE TESTED FOR LEAKAGE PER SECTION 309-1.4 OF THE STANDARD SPECIFICATIONS AND SPECIAL PROVISIONS.
- RESURFACE ALL TRENCHES WITHIN PAVED AREAS TO MEET LOS ANGELES COUNTY PUBLIC WORKS OR CALIFORNIA STATE HIGHWAY RECORD SPEC. 2 IN ACCORDANCE WITH PERMITS.
- FULL COMPLIANCE WITH SECTION 308-1.8.4 OF THE STANDARD SPEC. WILL BE REQUIRED FOR BACKFILL IN STREETS. CERTIFICATION OF BACKFILL COMPACTION AND SAND EQUIVALENTS BY A QUALIFIED REGISTERED TESTING LABORATORY SHALL BE PROVIDED BY THE CONTRACTOR PRIOR TO THE ISSUANCE OF A CERTIFICATE OF PARTIAL ACCEPTANCE.
- SPECIAL BACKFILL IN EXISTENT CONSTRUCTION (IN BACKFILL TRENCH AND REPLACE OTHER EARTH) SO AS TO ACHIEVE THE NATURAL OR FINISHED GRADES AND SLOPES SHOWN ON THE GRADING PLAN APPROVED FOR THE DEVELOPMENT BY THE BUILDING AND SAFETY DIVISION. ALL BACKFILL AND EARTH REPLACES SHALL BE COMPACTED TO A MINIMUM OF 90% OF MAXIMUM DENSITY PER A 5.1 M STD METHOD OF TEST OVER SIX INCHES. ACCEPTABLE CERTIFICATION OF SUCH COMPACTION SHALL BE SUBMITTED TO THE CONSTRUCTION DIVISION.

THE FOLLOWING LATEST REVISED STANDARD PLANS ON FILE IN THE OFFICE OF THE DEPARTMENT OF PUBLIC WORKS SHALL APPLY TO THE CONSTRUCTION OF THIS PROJECT:

LEGEND	0-1
MINIMUM PUBLIC SAFETY REQUIREMENTS	0-2
BRICK MANHOLE	0-3
STANDARD MANHOLE STEP	0-17
RECORDING FOR SEWER PIPE	0-17
CRACKING AND ENCASUREMENT	0-23
WYE OR TEE SUPPORT	0-23
ALLOWABLE TRENCH WIDTHS	0-28
LOCKED MANHOLE FRAME AND COVER	0-28
NON-REINFORCED PRECAST CONCRETE MANHOLE	0-28
RECTANGULAR SMALLER MANHOLE	1-7

COUNTY OF LOS ANGELES, CALIFORNIA  
 THOMAS A. TIDEMANSON  
 DIRECTOR OF PUBLIC WORKS

CHARLES W. CARRY  
 CHIEF ENGINEER

APPROVED: *Carl S. Blum* 12/17/86 (DATE)  
 APPROVED: *John J. Hansen* 12/18/86 (DATE)

CHECKED: *Henry C. Anderson* 7/1/86 (DATE)

REG. CE NO. 17536  
 EAST LOS ANGELES BLDG. DIST. 6

CITY OF MONTEREY PARK  
 APPROVED: *Richard Schneider* 12-5-86 (DATE)  
 CITY ENGINEER

REVIEWED BY *Samuel G. Bal...* 12-11-86 (DATE)

NO L.A. COUNTY CHARGE FOR CONNECTIONS SEE COUNTY SANITATION DISTRICT FOR SPECIAL CONNECTION CHARGES  
 DOUBLE SCALE

51776

