

SANITARY SEWERS

TO BE CONSTRUCTED IN

P.M. NO. 17649

PRIVATE CONTRACT NO. 10549

A-69, F2
1 SHEET; 2 PAGES

SCALE: VERT. 1" = 4'
HORIZ. 1" = 40'

SEPTEMBER, 1986

PREPARED IN THE OFFICES OF
STIKAND ENGINEERING ASSO.
15230 BURBANK BLVD VANNUYS
CA 91411 (213) 787 8550

BY Ronald R. Han
REG. CE NO. 16913



9338A

GENERAL NOTES:

- ELEVATIONS ARE IN FEET, UNLESS OTHERWISE SPECIFIED.
- NO DIMENSIONS SHALL BE MADE IN THESE PLANS WITHOUT THE APPROVAL OF THE DEPARTMENT OF PUBLIC WORKS.
- NO REPRESENTATIVE OF THE DEPARTMENT OF PUBLIC WORKS WILL SURVEY OR LAYOUT ANY PORTION OF THE WORK.
- GRADES TO WHICH THIS IMPROVEMENT IS TO BE CONSTRUCTED ARE SHOWN IN INCHES AND MINUTE GRADE POINTS FOR TOP OF CURB, CENTERLINE OF STREETS OR CENTERLINE OF ALLEYS AND SHOWING GRADES IN FEET AND MINUTE GRADE POINTS. THE GRADE SHALL BE ESTABLISHED SO AS TO CONFORM TO A STRAIGHT LINE DRAWN BETWEEN SAID GRADE POINTS.
- THE PRIVATE ENGINEER SHALL FURNISH THE DEPARTMENT OF PUBLIC WORKS WITH GRADE SHEETS AND STATIONING FOR ALL HOUSE LATERALS AND 10' OR 15' BRANCHES AND SHALL PROVIDE STAKES FOR THEM AT THEIR PROPER LOCATIONS WITH STATIONING PLAINLY MARKED. ALL HOUSE LATERALS SHALL BE CONSTRUCTED IN A STRAIGHT ALIGNMENT AT RIGHT ANGLES FROM THE MAIN LINE SEWER UNLESS AS SHOWN ON THE PLANS. HOUSE LATERALS FROM CHIMNEYS SHALL NOT HAVE AN ANGLE OF LESS THAN 90° WITH THE MAIN LINE SEWER UNLESS OTHERWISE SPECIFIED.
- THE PRIVATE ENGINEER SHALL FURNISH THE HOUSE LATERAL DEPTH AT THE PROPERTY LINE BELOW THE TOP OF CURB ELEVATION FOR EACH HOUSE LATERAL ON THE GRADE SHEET.
- IF WORK IS TO BE STARTED THE CONTRACTOR MUST OBTAIN A PERMIT TO EXCAVATE IN COUNTY STREETS FROM THE COUNTY DEPT. OF PUBLIC WORKS. PERMIT OFFICE NO. 8 AND PAY FEE TO THE DEPARTMENT OF PUBLIC WORKS, 200 N. MAIN ST., LOS ANGELES, CA 90012, TO COVER THE COST OF CONSTRUCTION INSPECTION (NO RECORD PLANS).
- IF WORK IS TO BE DONE ON STATE HIGHWAY A PERMIT MUST BE OBTAINED FROM THE STATE OF CALIFORNIA, DIVISION OF HIGHWAYS, 130 SOUTH SPRING STREET, LOS ANGELES, CALIFORNIA.
- APPROVAL OF THIS PLAN BY THE COUNTY OF LOS ANGELES DOES NOT CONSTITUTE A REPRESENTATION AS TO THE ACCURACY OF THE LOCATION OF OR THE EXISTENCE OR NON-EXISTENCE OF ANY UNDERGROUND UTILITY PIPE OR STRUCTURE WITHIN THE LIMITS OF THE PROJECT. THIS NOTE APPLIES TO ALL PAGES.
- REFER TO SECTION 710-41 OF THE STANDARD SPECIFICATIONS REGARDING SAFETY UNIFORMS.
- PRIOR TO THE ISSUANCE OF THE REQUIRED PERMIT TO EXCAVATE THE CONTRACTOR SHALL OBTAIN AND FILE WITH THE DEPARTMENT OF PUBLIC WORKS A PERMIT TO EXCAVATE IN COUNTY STREETS FROM THE COUNTY DEPT. OF PUBLIC WORKS, PERMIT OFFICE NO. 8, AND PAY FEE TO THE DEPARTMENT OF PUBLIC WORKS, 200 N. MAIN ST., LOS ANGELES, CA 90012, TO COVER THE COST OF CONSTRUCTION INSPECTION (NO RECORD PLANS). A CERTIFICATE OF WORKERS COMPENSATION INSURANCE WITH THE DEPARTMENT OF PUBLIC WORKS, 200 N. MAIN ST., LOS ANGELES, CA 90012, MUST BE OBTAINED AND FILED WITH THE DEPARTMENT OF PUBLIC WORKS. THE CERTIFICATE HOLDER IS TO BE NOTIFIED 30 DAYS PRIOR TO CANCELLATION OF POLICY.

CONSTRUCTION NOTES:

- WORK SHALL BE CONSTRUCTED ACCORDING TO THE STANDARD SPECIFICATIONS FOR PUBLIC WORKS CONSTRUCTION, EDITION WITH SUPPLEMENTS AND A.P.C. SPECIAL PROVISIONS FOR THE CONSTRUCTION OF SANITARY SEWERS DATED JUNE 24, 1976 AND SHALL BE PROTECTED ONLY IN THE PRESENCE OF THE DEPARTMENT OF PUBLIC WORKS.
- THE CONTRACTOR SHALL NOTIFY THE COUNTY DEPT. OF PUBLIC WORKS TELEPHONE 226-8881 AT LEAST TWENTY-FOUR HOURS BEFORE STARTING ANY WORK UNDER THIS CONTRACT.
- HOUSE LATERALS TO BE CONSTRUCTED WITH INVERTS AT PROPERTY LINE & FEET BELOW CURB GRADE EXCEPT AS NOTED.
- PIPE OR TEE BRANCHES MAY BE USED FOR CONNECTIONS TO MAIN LINE SEWER EXCEPT AS NOTED.
- ALL STRUCTURES SHALL BE EITHER BRICK MANHOLES PER S-3 OR PRECAST CONCRETE MANHOLES PER S-36 EXCEPT AS NOTED.
- PROVIDE STAKES ON THE PROPERTY LINE OR PROPERTY LINES PRODUCED AT RIGHT ANGLES TO THE SEWER LINE AT THE CENTERLINE OF EACH MANHOLE.
- MANHOLE TOPS IN UNIMPROVED RIGHTS OF WAY TO BE SIX INCHES ABOVE FINISHED GRADE.
- WETTED CLAY PIPE JOINTS SHALL BE TYPE "D" OR "E" PER STANDARD SPECIFICATIONS SECTION 200-2.
- IF A POWER POLE IS WITHIN THREE FEET OF THE SEWER THE SEWER SHALL BE ENCASED PER S-23 CASE II, TWO FEET ON EACH SIDE FROM THE POINT OF INTERFERENCE.
- IF DURING THE COURSE OF CONSTRUCTION IT IS DETERMINED THAT THERE IS LESS THAN FOUR FEET OF COVER OVER THE TOP OF A MAIN LINE OR HOUSE LATERAL SEWER WHICH IS NOT INDICATED ON THE PLANS, THE PIPE SHALL BE ENCASED PER S-23 CASE II UNLESS OTHERWISE APPROVED BY THE DEPARTMENT OF PUBLIC WORKS.
- ALL JOINTS OF THE CAST IRON PIPE AND WETTED CLAY PIPE SHALL BE MADE WITH A RUBBER BLEEVE JOINT TYPE "C" OR "D" WITH BUSHING IF NECESSARY PER STANDARD SPECIFICATIONS SECTION 200-2.
- SEWERS TO BE TESTED FOR LEAKAGE PER SECTION 200-1.8 OF THE STANDARD SPECIFICATIONS AND SPECIAL PROVISIONS.
- RESURFACE ALL THE AREAS WITHIN PAVED AREAS TO MEET AND MAINTAIN THE EXISTING FINISH GRADE AND SURFACE REQUIREMENTS IN ACCORDANCE WITH PERMITS.
- FULL COMPLIANCE WITH SECTION 200-1.8 OF THE STANDARD SPECIFICATIONS AND SPECIAL PROVISIONS FOR THE BACKFILL IN STREETS (CERTIFICATION OF BACKFILL COMPACTION AND SAND EQUIVALENTS BY A QUALIFIED REGISTERED TESTING LABORATORY SHALL BE PROVIDED BY THE PERMITTEE PRIOR TO THE ISSUANCE OF A CERTIFICATE OF PARTIAL ACCEPTANCE).
- SPECIAL BACKFILL IN BASEMENT CONSTRUCTION IN BACKFILL TRENCH AND REPLACE OTHER EARTH SO AS TO ACHIEVE THE NATURAL OR FINISHED GRADES AND SLOPES SHOWN ON THE GRADING PLAN APPROVED FOR THIS DEVELOPMENT BY THE LAND DEVELOPMENT DIVISION. IN ALL BACKFILL AND EARTH REPLACED SHALL BE COMPACTED TO A MINIMUM OF 90% OF MAXIMUM DENSITY PER ASTM D 1557 AND OR TEST 088-87 AS MODIFIED ACCEPTABLE CERTIFICATION OF SUCH COMPACTION SHALL BE SUBMITTED TO THE COUNTY DEPT. OF PUBLIC WORKS.

THE FOLLOWING LATEST REVISED STANDARD PLANS ON FILE IN THE OFFICE OF THE DEPARTMENT OF PUBLIC WORKS SHALL APPLY IN THE CONSTRUCTION OF THIS PROJECT

LEGEND	NO.
MINIMUM PUBLIC SAFETY REQUIREMENTS	S-1
BRICK MANHOLE	S-2
STANDARD MANHOLE STEP	S-17
BRIDGING FOR SEWER PIPE	S-21
CRACKING AND ENCASEMENT	S-23
PIPE OR TEE JOINTS	S-26
ALLOWABLE TRENCH WIDTHS	S-28
LOCKING MANHOLE FRAME AND COVER	S-35
NON-REINFORCED PRECAST CONCRETE MANHOLE	S-36

COUNTY OF LOS ANGELES, CALIFORNIA

THOMAS A. TIDEMANSON
DIRECTOR OF PUBLIC WORKS

CHARLES W. CARRY
CHIEF ENGINEER

APPROVED: Carl D. Blum 4/14/87
SDE

APPROVED: John W. Jahn 4/24/87
OFFICE ENGINEER

CHECKED: James Jahn 4/18/87
REG. CE NO. 16881

SANTA CLARA VALLEY BLDG. DIST. B-2

B.M. C.L. 1744 ELEV. 1078.401
RDBM TAG S.C.B. TRAFFIC ISLAND 15 FT.
N. C/L S. RDWY MAGIC MT PKWY @
70 FT WC/L GOLDEN ST. FRWY. BRIDGE
NEWHALL QUAD. 1978 B53-1625

DOUBLE SCALE

REVISION NO. 1 DATE: 5-27-87
PAGE 2: RELOCATED HOUSE LATERALS & LOT LINES
REVISED STORM DRAIN ALIGNMENT & REDUCED
30' ENCASUREMENT TO 15' ENCASUREMENT.
APPROVED BY: Ronald R. Han 4/15/87 R.C.E. 30980
OFFICE OF THE DIRECTOR OF PUBLIC WORKS

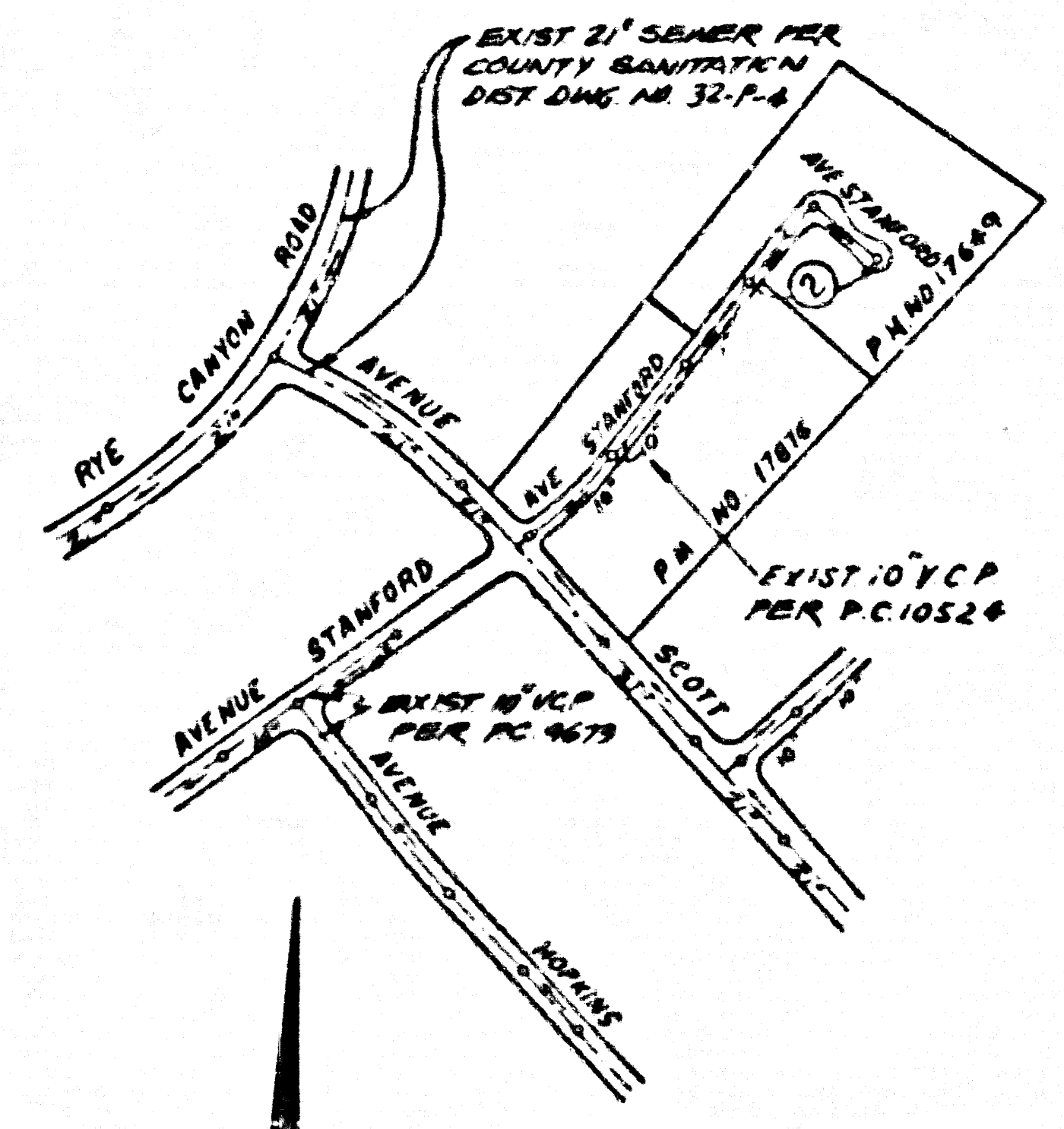

INDEX MAP

SCALE: 1" = 600'
P.C. NO. 10549
P.M. NO. 17649

NOTE: NUMBER IN CIRCLE INDICATES PAGE NUMBER

NO CONNECTION FOR THE DISPOSAL OF INDUSTRIAL WASTES SHALL BE MADE TO SEWERS SHOWN ON THESE DRAWINGS UNTIL A PERMIT FOR INDUSTRIAL WASTEWATER DISCHARGE HAS BEEN ISSUED BY THE SANITATION DISTRICTS FOR SAID CONNECTION.

BEFORE BREAKING INTO OR CONSTRUCTION ON A COUNTY SANITATION DISTRICT SEWER AND PRIOR TO FINAL ACCEPTANCE OF THE PROJECT, SANITATION DISTRICT INSPECTOR SHALL BE NOTIFIED BY PHONE (818) 962-8605 SO THAT REQUIRED INSPECTION CAN BE MADE.

ISSUE NO CONNECTION PERMITS UNTIL OUTLET SEWER P.C. 10524 IS ACCEPTED FOR PUBLIC USE BY THE COUNTY OF LOS ANGELES.

REVIEWED BY: Samy G. Balci 4/9/87 P.C. 10549 PAGE 2

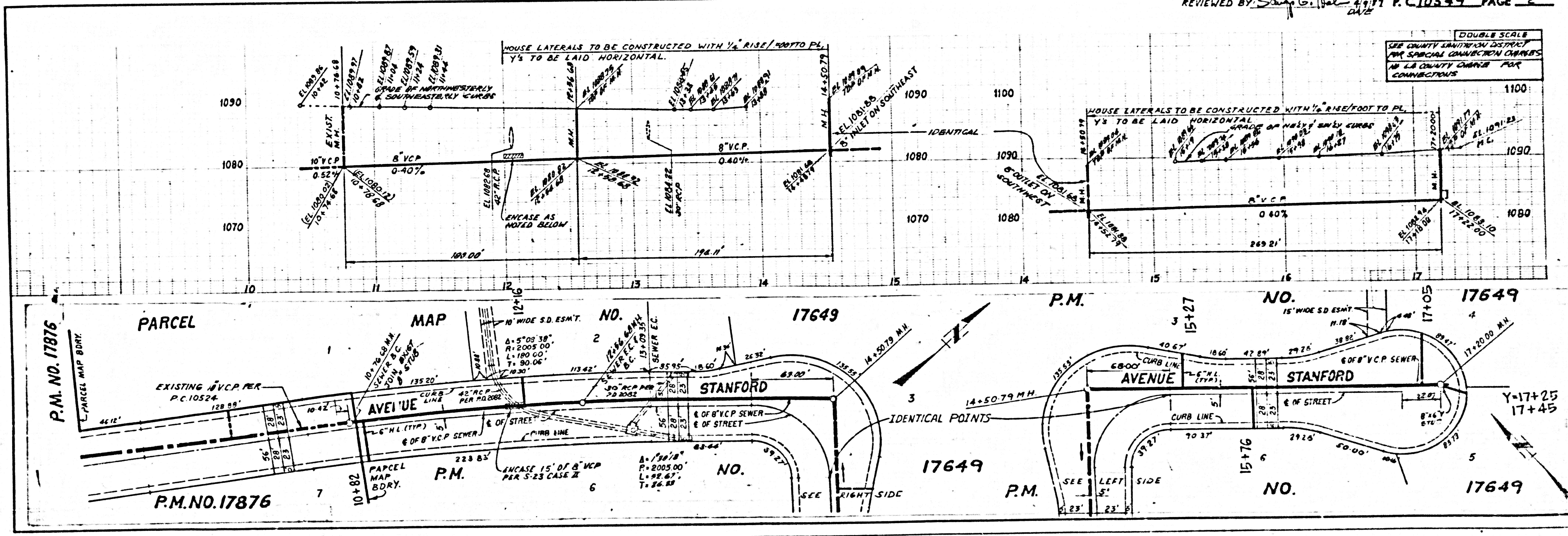

DOUBLE SCALE
SEE COUNTY SANITATION DISTRICT FOR SPECIAL CONNECTION CHANGES IN LA COUNTY CURBS FOR CONNECTIONS

PA20109 PA20109