

B.M. CL 2569 ELEV. 2695.039
 C.S. MON. IN WELL DN 7IN. @ INT. AVE. N
 @ 55th. ST. W. LKID. 614 COS. 2 H TGN
 R13W RE5869 USE NE EDGE
 PALMDALE QUAD. 1980

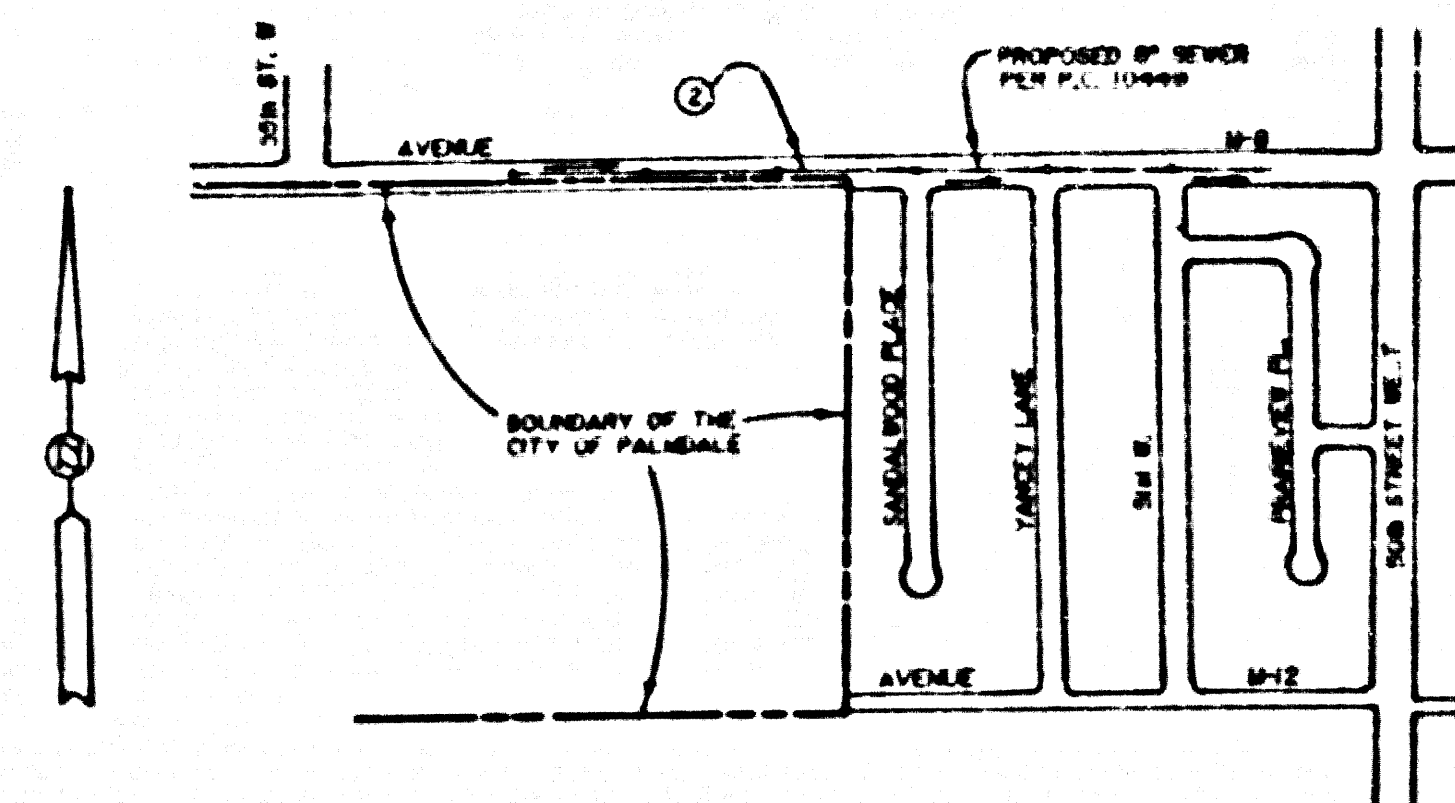

INDEX MAP
 P.C. NO. 10607
 SCALE 1" = 600'
 SEWERS IN AVENUE M-8

NO CONNECTION FOR THE DISPOSAL OF INDUSTRIAL WASTES SHALL BE MADE TO SEWERS SHOWN ON THESE DRAWINGS UNTIL A PERMIT FOR INDUSTRIAL WASTEWATER DISCHARGE HAS BEEN ISSUED BY THE SANITATION DISTRICTS FOR SAID CONNECTION.

BEFORE BREAKING INTO OR CONSTRUCTION ON A COUNTY SANITATION DISTRICT SEWER AND PRIOR TO FINAL ACCEPTANCE OF THE PROJECT, SANITATION DISTRICT INSPECTOR SHALL BE NOTIFIED BY PHONE (905) 947-5027 SO THAT REQUIRED INSPECTION CAN BE MADE.

ISSUE NO HOUSE LATERAL CONNECTION PERMITS UNTIL OUTLET SEWER, PC 10449 IS ACCEPTED FOR PUBLIC USE BY LOS ANGELES COUNTY.

GENERAL NOTES:

1. ELEVATIONS ARE IN FEET ABOVE U.T.C. 1983 SEA LEVEL DATUM OF 1985
2. NO REVISIONS SHALL BE MADE ON THESE PLANS WITHOUT THE APPROVAL OF THE DIRECTOR OF PUBLIC WORKS
3. NO REPRESENTATIVE OF THIS DEPARTMENT OF PUBLIC WORKS SHALL SURVEY OR LAY OUT ANY PORTION OF THE WORK
4. GRADIES TO WHICH THIS APPROVEMENT IS TO BE CONSTRUCTED ARE SHOWN ON PLANS AND PROFILES GRADE POINTS FOR TOP OF CURBS, CENTER LINE OF STREET'S CENTER LINE OF ALLEYS AND BRANCHES TO CURBS. IN PROFILES, A FALL PL. INDICATES THERE IS A CHANGE FROM TOP OF CURBS TO GRADE SHALL BE ESTABLISHED TO CONFORM TO THE STRAIGHT LINE GRADE BETWEEN GRADE POINTS
5. THE HOUSE LATERALS SHALL FURNISH THE DEPARTMENT OF PUBLIC WORKS WITH 3/4" x 3/4" SHEETS AND STATIONING FOR ALL HOUSE LATERALS AND "T" OR "F" BRANCHES AND SHALL PROVIDE STAIRS FOR THEM AT THEIR INCHER LOCATIONS WITH 2 1/2" THICK PLANS. ALL HOUSE LATERALS SHALL BE CONSTRUCTED AS A STRAIGHT ALIGNMENT AT RIGHT ANGLES TO THE MAIN LINE AND SHALL BE SET AS SHOWN ON THE PLANS. HOUSE LATERAL SYSTEM CHANGES SHALL NOT HAVE A SLOPE OF LESS THAN 1/8" IN THE MAIN LINE BE THE ANY CHANGE IN ALIGNMENT SHALL BE REQUESTED AND NOTED BY THE PRIVATE ENGINEER
6. THE PRIVATE ENGINEER SHALL FURNISH THE HOUSE LATERAL DEPTH AT THE PROPERTY LINE BELOW THE TOP OF CURB ELEVATION FOR EACH HOUSE LATERAL ON THE GRADE SHEET
7. BEFORE WORK CAN BE STARTED, THE CONTRACTOR MUST OBTAIN A PERMIT TO EXCAVATE IN COUNTY'S STREETS FROM THE "COUNTY DIV. OF PUBLIC WORKS" AND A PERMIT TO OCCUPY THE STREETS FROM THE "COUNTY DIV. OF PUBLIC WORKS".
8. IF WORK IS TO BE DONE IN A STATE HIGHWAY A PERMIT MUST BE OBTAINED FROM THE STATE OF CALIFORNIA, DIVISION OF HIGHWAYS, 120 SOUTH SPRING STREET, LOS ANGELES, CALIFORNIA
9. APPROVAL OF THIS PLAN BY THE COUNTY OF LOS ANGELES DOES NOT CONSTITUTE A REPRESENTATION AS TO THE ACCURACY OF THE LOCATION OF OR THE EXISTENCE OR NON-EXISTENCE OF ANY UNDERGROUND UTILITY CURB, OR STRUCTURE WITHIN THE LIMITS OF THIS PROJECT. THIS NOTE APPLIES TO ALL PAGES
10. REFER TO SECTION 7 AND 1 OF THE STAMPED SPECIFICATIONS REGARDING SAFETY ORDERS
11. PRIOR TO THE BEGINNING OF THE REQUIRED SEWER CONSTRUCTION PERMIT, THE CONTRACTOR SHALL OBTAIN AND FILE WITH THE DEPARTMENT OF PUBLIC WORKS COPIES OF A PERMIT TO OCCUPY THE STREETS FROM THE COUNTY DIV. OF PUBLIC WORKS AND A PERMIT FOR EXCAVATIONS AND TRENCHES FROM THE STATE OF CALIFORNIA, DIVISION OF INDUSTRIAL SAFETY AND CERTIFICATES OF SAFETY FOR CONSTRUCTION IN ACCORDANCE WITH THE DEPARTMENT OF PUBLIC WORKS. THE APPROVAL OF CALIFORNIA, DIVISION OF INDUSTRIAL SAFETY, AS THE CERTIFICATE HOLDER TO BE NOTIFIED BY PHONE PRIOR TO COMMENCEMENT OF PUBLIC WORKS.

CONSTRUCTION NOTES:

1. WORK SHALL BE CONSTRUCTED ACCORDING TO THE STANDARD SPECIFICATIONS FOR PUBLIC WORKS CONSTRUCTION, 1986 EDITION WITH SUPPLEMENTS AND LATEST EDITIONS, AS PUBLISHED BY THE COUNTY OF LOS ANGELES, DEPARTMENT OF PUBLIC WORKS, 120 SOUTH SPRING STREET, LOS ANGELES, CALIFORNIA 90012.
2. THE CONTRACTOR SHALL NOTIFY THE CONSTRUCTION DIVISION BY TELEPHONE AT LEAST TWENTY-FOUR HOURS BEFORE START OF WORK UNDER THIS CONTRACT.
3. HOUSE LATERALS TO BE CONSTRUCTED WITH INVERTS AT PROPERTY LINE 6 FEET BELOW CURB GRADE EXCEPT AS NOTED
4. PIPE OR THE BRANCHES MAY BE USED FOR CONNECTIONS TO ANALOGOUS SEWERS EXCEPT AS NOTED
5. ALL STRUCTURES SHALL BE EITHER BRICK MANHOLES PER 8-3 OR PRECAST CONCRETE MANHOLES PER 8-3 EXCEPT AS NOTED
6. APPROVE STAIRS ON THE PROPERTY LINE OR PROPERTY LINES PRODUCED AT RIGHT ANGLES TO THE SEWER LINE AT THE CENTER LINE OF EACH MANHOLE
7. MANHOLE TOPS IN UNIMPROVED RIGHTS OF WAY TO BE SIX INCHES ABOVE FINISHED GRADE
8. WITHIN 6" CLAY PIPE JOINTS SHALL BE TYPE "C" OR "E" PER STANDARD SPECIFICATIONS SECTION 809-2
9. IF A POWER POLE IS WITHIN THREE FEET OF THE SEWER, THE SEWER SHALL BE ENCASED PER 8-3 CASE 4. TWO FEET ON EACH SIDE FROM THE POINT OF INTERFERENCE
10. IF DURING THE COURSE OF CONSTRUCTION IT IS DETERMINED THAT THERE IS LESS THAN FOUR FEET OF COVER OVER THE TOP OF A MANHOLE OR HOUSE LATERAL V.C.P. SEWER WHICH IS NOT INDICATED ON THE PLANS, THE PIPE SHALL BE ENCASED PER 8-3 CASE 4 UNLESS OTHERWISE APPROVED BY THE DIRECTOR OF PUBLIC WORKS
11. ALL JOINTS BETWEEN CAST IRON PIPE AND VITRIFIED CLAY PIPE SHALL BE MADE WITH A RUBBER GASKET JOINT TYPE "C" OR "E" WITH BUTTING IF NECESSARY PER STANDARD SPECIFICATIONS SECTION 809-2
12. SEWERS TO BE TESTED FOR LEAKAGE PER SECTION 809-1 OF THE STANDARD SPECIFICATIONS AND SPECIAL PROVISIONS
13. RESURFACE ALL TRENCHES WITHIN PAVED AREAS TO MEET LOS ANGELES COUNTY PUBLIC WORKS OR CALIFORNIA STATE HIGHWAY REQUIREMENTS IN ACCORDANCE WITH PERMITS
14. FULL COMPLIANCE WITH SECTION 809-2 AND 809-3 OF THE STANDARD SPECIFICATIONS WILL BE REQUIRED FOR BACKFILL IN SLOTTED CERAMIC TILE OR BACKFILL CONSTRUCTION AND SAME REQUIREMENTS BY A QUALIFIED REGISTERED TESTING LABORATORY SHALL BE PROVIDED BY THE PERMITTEE PRIOR TO THE ISSUANCE OF A CERTIFICATE OF PARTIAL ACCEPTANCE
15. SPECIAL BACKFILL IS REQUIRED AT CONSTRUCTION IN BACKFILL TRENCH AND REPLACE OTHER EARTH SO AS TO ACHIEVE THE MAXIMUM FINISHED GRADE AND SLOPE SHOWN ON THE GRADING PLAN APPROVED FOR THIS DEVELOPMENT BY THE LAND DEVELOPMENT DIVISION. ALL BACKFILL AND EARTH REPLACEMENT SHALL BE COMPACTED TO A MINIMUM OF 90% OF MAXIMUM DENSITY PER A.S.T.M. METHOD OF TEST C99-57 AS SPECIFIED. ACCEPTABLE CERTIFICATION OF SUCH COMPACTION SHALL BE SUBMITTED TO THE CONSTRUCTION DIVISION, DEPARTMENT OF PUBLIC WORKS

SANITARY SEWERS
 TO BE CONSTRUCTED IN
AVENUE M-8
 E/O 55th. ST. W
PRIVATE CONTRACT NO. 10607
 INDEX A-292
 1 SHEET, 2 PAGES

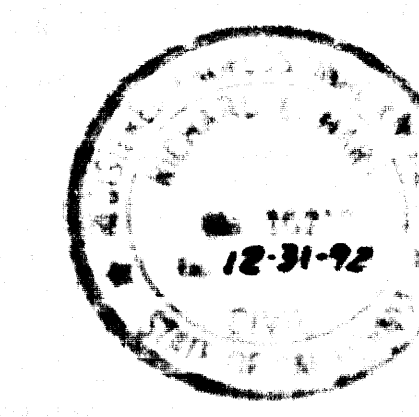

SCALE: VERT. 1" = 6'
 HORIZ. 1" = 60'
 OCT. 20, 1987
 PREPARED IN THE OFFICES OF
 WAGNER-KERR ASSOC., INC.
 6740 VESPER AVE., SUITE 200, VAN NUYS, CALIF. 91411, (818) 708-0711
 BY: *Richard L. Hart*
 REG. C.E. NO. 12347
 RICHARD L. HART

THE FOLLOWING LATEST REVISED STANDARD PLANS ON FILE IN THE OFFICE OF THE DEPARTMENT OF PUBLIC WORKS SHALL APPLY TO THE CONSTRUCTION OF THIS PROJECT

LEGENDS	8-1
MINIMUM PUBLIC SAFETY REQUIREMENTS	8-2
BRICK MANHOLE	8-3
STANDARD MANHOLE STEP	8-17
BE CHAIN FOR SEWER PIPE	8-21
CRACKING AND ENCASEMENT	8-23
PIPE OR TIE SUPPORT	8-24
ALLOWABLE TRENCH WIDTHS	8-25
LOCKING MANHOLE FRAMES AND COVER	8-26
NON-REINFORCED PRECAST CONCRETE MANHOLE	8-28

COUNTY OF LOS ANGELES, CALIFORNIA
 THOMAS A. TIDEMANSON
 DIRECTOR OF PUBLIC WORKS
 APPROVED *Carl J. Blum* 12/23/87
 CHECKED *Sally G. Bolz* 12-22-87
 REG. C.E. NO. 53134
 LANCASTER BLDG. DIST. 8-2

CHARLES W. CARRY
 CHIEF ENGINEER
 CO. SAN. DIST. NO. 14
 APPROVED *Charles W. Carry* 12/27/87
 REG. C.E. NO. 14

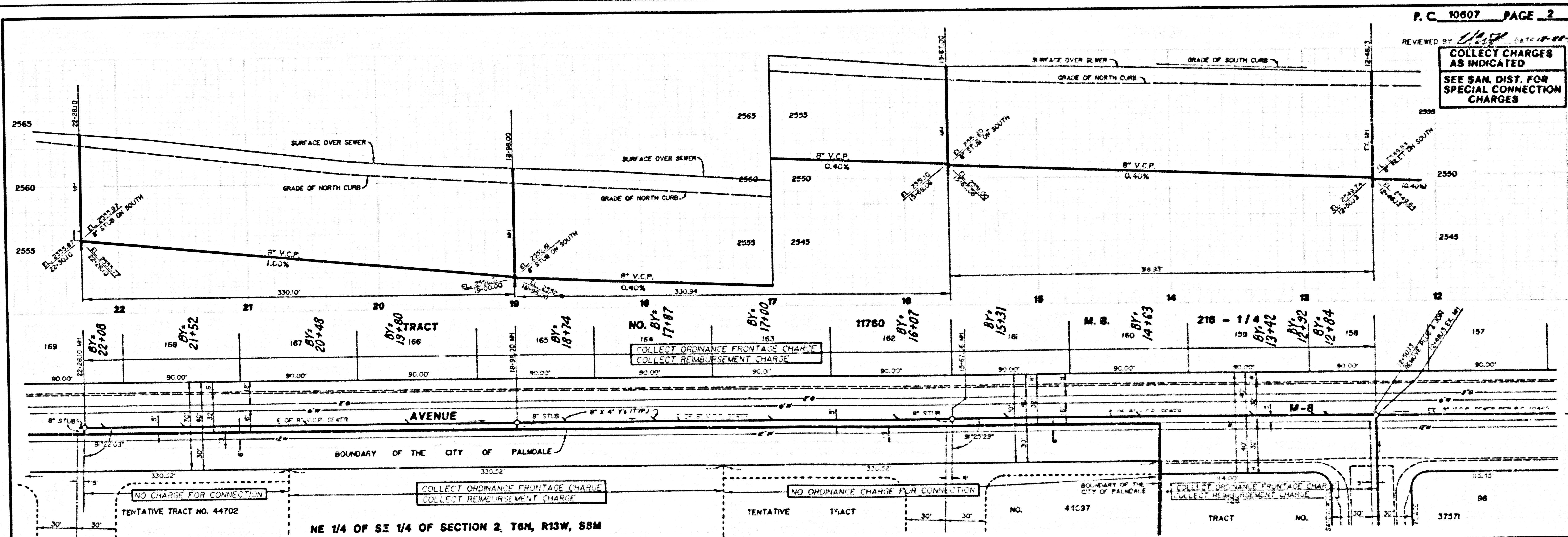

REVIEWED BY *[Signature]* DATE 12-22-87
 COLLECT CHARGES AS INDICATED
 SEE SAN. DIST. FOR SPECIAL CONNECTION CHARGES