

B.M. C.L. 1947 ELEV. 1057.214
 RDBM TAG CTR S END MEDIAN CB
 OF THE OLD ROAD @ N SIDE RYE
 CANYON ROAD
 NEWHALL QUAD. 19 83

DOUBLE SCALE

REVISION NO. 1 DATE 6-30-88
 PAGE 1: REVISED INDEX MAP & 4 SHEETS, 7 PAGES TO
 3 SHEETS, 6 PAGES
 PAGE 6: VOIDED 8" V.C.P. SEWER AT STA. 16+14.93 FROM
 PLAN & PROFILE
 PAGE 7: VOIDED PLAN & PROFILE
 APPROVED BY: *Sam G. Hal* R.C.E. 33134
 OFFICE OF THE DIRECTOR OF PUBLIC WORKS
 7-7-88

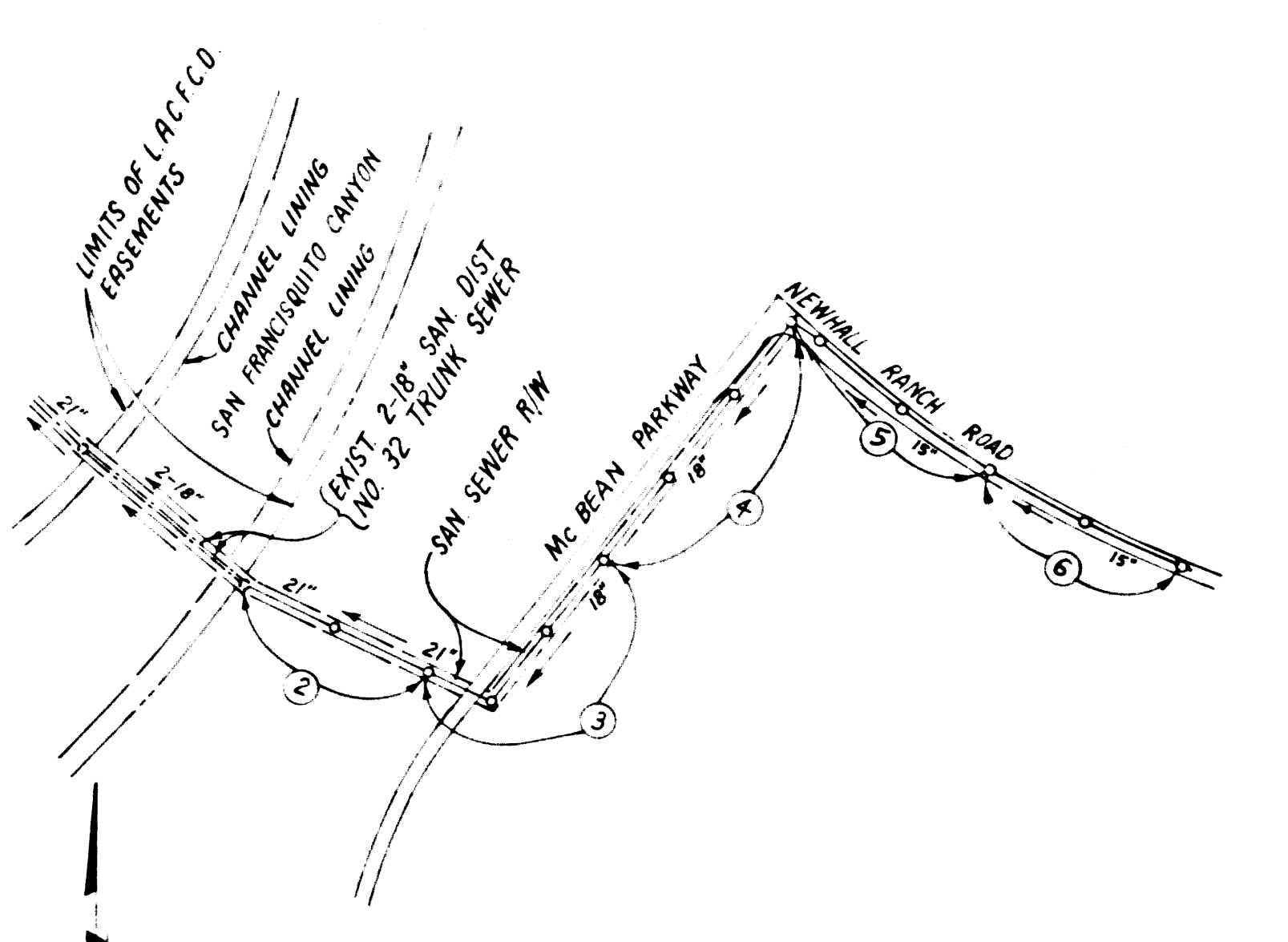

INDEX MAP
 P.C. 10614
 Mc BEAN PKWY. & NEWHALL RANCH RD.
 SCALE 1"=600'
 NOTE: NUMBERS IN CIRCLES INDICATE PAGE NUMBERS

NO CONNECTION TO SEWERS OF INDUSTRIAL WASTES SHALL BE MADE FOR SEWERS SHOWN ON THESE DRAWINGS UNTIL A PERMIT FOR INDUSTRIAL WASTEWATER DISCHARGE HAS BEEN ISSUED BY THE SANITATION DISTRICTS FOR SAID CONNECTION.
 BEFORE BREAKING INTO OR CONSTRUCTION ON A COUNTY SANITATION DISTRICT SEWER AND PRIOR TO FINAL ACCEPTANCE OF THE PROJECT, SANITATION DISTRICT INSPECTOR SHALL BE NOTIFIED BY PHONE (818) 962-8605 SO THAT REQUIRED INSPECTION CAN BE MADE.

GENERAL NOTES:

- ELEVATIONS ARE NOTED ABOVE U.S.C. & G.S. SEA LEVEL DATUM OF 1929.
- NO REVISIONS SHALL BE MADE IN THESE PLANS WITHOUT THE APPROVAL OF THE DIRECTOR OF PUBLIC WORKS.
- NO REPRESENTATIVE OF THE DEPARTMENT OF PUBLIC WORKS WILL SURVEY OR LAY OUT ANY PORTION OF THE WORK.
- GRADES TO WHICH THIS IMPROVEMENT IS TO BE CONSTRUCTED ARE SHOWN ON PLANS AND PROFILES. GRADE POINTS FOR TOP OF CURBS, CENTER LINE OF STREETS, CENTER LINE OF ALLWAYS AND HIGHWAYS BY CURVES ONLY, AT ALL POINTS BETWEEN DESIGNATED POINTS THE GRADE SHALL BE ESTABLISHED AS TO CONFORM TO A STRAIGHT LINE OR CURVE BETWEEN SAID DESIGNATED POINTS.
- THE PRIVATE ENGINEER SHALL FURNISH THE DEPARTMENT OF PUBLIC WORKS WITH GRADE SHEETS AND STATIONING FOR ALL HOUSE LATERALS AND 12" OR 18" BRANCHES AND SHALL PROVIDE STAKES FOR THEM AT THEIR PROPER LOCATIONS WITH STATIONING PLAINLY MARKED. ALL HOUSE LATERALS SHALL BE CONSTRUCTED IN A STRAIGHT ALIGNMENT AT RIGHT ANGLES FROM THE MAIN LINE SEWER EXCEPT AS SHOWN ON THE PLANS. HOUSE LATERALS FROM CHIMNEYS SHALL NOT HAVE AN ANGLE OF LESS THAN 45° WITH THE MAIN LINE SEWER AND ANY CHANGE IN ALIGNMENT SHALL BE REQUESTED IN WRITING BY THE PRIVATE ENGINEER.
- THE PRIVATE ENGINEER SHALL FURNISH THE HOUSE LATERAL DEPTH AT THE PROPERTY LINE BELOW THE TOP OF CURB ELEVATION FOR EACH HOUSE LATERAL ON THE GRADE SHEET.
- BEFORE WORK CAN BE STARTED THE CONTRACTOR MUST OBTAIN A PERMIT TO EXCAVATE IN COUNTY STREETS FROM THE L.A. COUNTY CONST. DIV. OF THE LOS ANGELES DEPARTMENT OF PUBLIC WORKS. PERMIT OF L.C. NO. _____ AND PAY A FEE TO THE DIRECTOR OF PUBLIC WORKS, 900 N. FRESNO ST., ALHAMBRA, CA 91803 TO COVER THE COST OF CONSTRUCTION INSPECTION AND RECORD PLANS.
- IF WORK IS TO OCCUR IN A STATE HIGHWAY AS SHOWN ON THESE PLANS, A PERMIT MUST BE OBTAINED FROM THE STATE OF CALIFORNIA, DIVISION OF HIGHWAYS, 720 SOUTH SPRING STREET, LOS ANGELES, CALIFORNIA.
- APPROVAL OF THIS PLAN BY THE COUNTY OF LOS ANGELES DOES NOT CONSTITUTE A REPRESENTATION AS TO THE ACCURACY OF THE LOCATION OR OF THE EXISTENCE OR NON-EXISTENCE OF ANY UNDERGROUND UTILITY PIPE OR STRUCTURE WITHIN THE LIMITS OF THIS PROJECT. THIS NOTE APPLIES TO ALL PAGES.
- REFER TO SECTION 7 TO 4 OF THE STANDARD SPECIFICATIONS, REGARDING SAFETY ORDERS.
- IN ORDER TO THE ISSUANCE OF THE REQUIRED SEWER CONSTRUCTION PERMIT THE CONTRACTOR SHALL OBTAIN AND FILE WITH THE DEPARTMENT OF PUBLIC WORKS COPIES OF A PERMIT TO EXCAVATE IN COUNTY STREETS FROM THE COUNTY DIV. AT THE DEPARTMENT OF PUBLIC WORKS. A PERMIT FOR EXCAVATIONS AND TRENCHES FROM THE STATE OF CALIFORNIA, DIVISION OF HIGHWAYS, 720 SOUTH SPRING STREET, LOS ANGELES, CALIFORNIA, COMPENSATION INSURANCE WITH THE DEPARTMENT OF PUBLIC WORKS, 900 N. FRESNO ST., ALHAMBRA, CA 91803 97% NAME AS THE CERTIFICATE HOLDER TO BE NOTIFIED 30 DAYS PRIOR TO CANCELLATION OF POLICY.

CONSTRUCTION NOTES:

- WORK SHALL BE CONSTRUCTED ACCORDING TO THE STANDARD SPECIFICATIONS FOR PUBLIC WORKS CONSTRUCTION 1985 EDITION WITH THE 1978 SUPPLEMENTS AND COUNTY ENGINEER SPECIAL PROVISIONS FOR THE CONSTRUCTION OF SANITATION SEWERS DATED SEPT. 21, 1978 AND SHALL BE PROSECUTED ONLY IN THE PRESENCE OF THE DEPT. OF PUBLIC WORKS.
- THE CONTRACTOR SHALL NOTIFY THE CONSTRUCTION DIVISION BY TELEPHONE AT LEAST TWENTY FOUR HOURS BEFORE STARTING ANY WORK UNDER THIS CONTRACT.
- HOUSE LATERALS TO BE CONSTRUCTED WITH INVERTS AT PROPERTY LINE & FEET BELOW CURB GRADE EXCEPT AS NOTED.
- WYE OR TEE BRANCHES MAY BE USED FOR CONNECTIONS TO MAIN LINE SEWERS EXCEPT AS NOTED.
- ALL STRUCTURES SHALL BE EITHER BRICK MANHOLES PER S-3 OR PRECAST CONCRETE MANHOLES PER S-3H EXCEPT AS NOTED.
- PROVIDE STAKES ON THE PROPERTY LINE OR PROPERTY LINES PRODUCED AT RIGHT ANGLES TO THE SEWER LINE AT THE CENTER LINE OF EACH MANHOLE.
- MANHOLE TOPS IN UNIMPROVED HEIGHTS OF WAY TO BE SIX INCHES ABOVE FINISHED GRADE.
- VITRIFIED CLAY PIPE JOINTS SHALL BE TYPE 'D' OR 'D' PER STANDARD SPECIFICATIONS SECTION 208-2.
- IF A POWER POLE IS WITHIN THREE FEET OF THE SEWER THE SEWER SHALL BE ENCASED PER S-23 CASE II TWO FEET ON EACH SIDE FROM THE POINT OF INTERFERENCE.
- IF DURING THE COURSE OF CONSTRUCTION IT IS DETERMINED THAT THERE IS LESS THAN FOUR FEET OF COVER OVER THE TOP OF A MAIN LINE OR HOUSE LATERAL V.C.P. SEWER WHICH IS NOT INDICATED ON THE PLANS, THE PIPE SHALL BE ENCASED PER S-24 CASE II UNLESS OTHERWISE APPROVED BY THE DIRECTOR OF PUBLIC WORKS.
- ALL JOINTS BETWEEN CAST IRON PIPE AND VITRIFIED CLAY PIPE SHALL BE MADE WITH A RUBBER SLEEVE JOINT TYPE 'C' OR 'D' WITH BUSHING IF NECESSARY PER STANDARD SPECIFICATIONS SECTION 208-2.
- SEWERS TO BE TESTED FOR LEAKAGE PER SECTION 306.4 OF THE STANDARD SPECIFICATIONS AND SPECIAL PROVISIONS.
- SHALL BE TESTED FOR LEAKAGE PER SECTION 306.4 OF THE STANDARD SPECIFICATIONS AND SPECIAL PROVISIONS.
- FULL COMPLIANCE WITH SECTION 306.4 OF THE STANDARD SPECIFICATIONS WILL BE REQUIRED FOR BACKFILL IN STREETS AND BACKFILL IN AREAS TO BE TESTED FOR LEAKAGE PER SECTION 306.4 OF THE STANDARD SPECIFICATIONS AND SPECIAL PROVISIONS.
- SPECIAL BACKFILL IN EASEMENT CONSTRUCTION IN BACKFILL TRENCHING AND REPLACE OTHER EARTH SO AS TO ACHIEVE THE NATURAL OR FINISHED GRADES AND SLOPES SHOWN ON THE GRADING PLAN APPROVED FOR THIS DEVELOPMENT BY THE LAND DEVELOPMENT DIVISION. IN ALL BACKFILL AND EARTH REPAIRED SHALL BE COMPACTED TO A MINIMUM OF 90% OF MAXIMUM DENSITY PER A 5" X 10" METHOD OF TEST SPECIFICALLY MOTICATED. ACCEPTABLE CERTIFICATION OF SUCH COMPACTION SHALL BE SUBMITTED TO THE CONSTRUCTION DIVISION, PUBLIC WORKS DEPT.

PROFILE ALIGNMENT AND GRADE OF **PAGE 1**

SANITARY SEWERS

TO BE CONSTRUCTED IN

Mc BEAN PARKWAY AND NEWHALL RANCH ROAD

PRIVATE CONTRACT NO. 10614

A-70
3 SHEETS, 6 PAGES

SCALE: VERT. 1"=8'
 HORIZ. 1"=40'
 OCTOBER, 1988

PREPARED IN THE OFFICES OF
SINANO ENGINEERING ASSOCIATES
 12530 BURBANK BLVD
 VAN NUYS, CA 91411 (818) 787-8550
 BY: *Ronald K. Horn*
 REG. C.E. NO. 16213



THE FOLLOWING LATEST REVISED STANDARD PLANS ON FILE IN THE OFFICE OF THE DEPARTMENT OF PUBLIC WORKS SHALL APPLY IN THE CONSTRUCTION OF THIS PROJECT

LEGEND	S-1
MINIMUM PUBLIC SAFETY REQUIREMENTS	S-2
BRICK MANHOLE	S-3
STANDARD MANHOLE STEP	S-17
BEDDING FOR SEWER PIPE	S-21
CRACKING AND ENCASEMENT	S-23
WYE OR TEE EQUIPMENT	S-28
ALLOWABLE TRENCH WIDTHS	S-33
LOCKING MANHOLE FRAME AND COVER	S-35
NON-REINFORCED PRECAST CONCRETE MANHOLE	S-38

COUNTY OF LOS ANGELES, CALIFORNIA
 THOMAS A. TIDEMANSON
 DIRECTOR OF PUBLIC WORKS

CHARLES W. CARRY
 CHIEF ENGINEER
 CO. SAN. DIST. NO. 32

APPROVED: *Cal H. Blum* 12/17/87 (DATE) APPROVED: *Sam G. Hal* 12/14/87 (DATE)
 CHECKED: *John J. ...* 12/14/87 (DATE)
 REG. C.E. NO. 16841
 STA. CLARITA VALLEY BLDG. DIST. 82

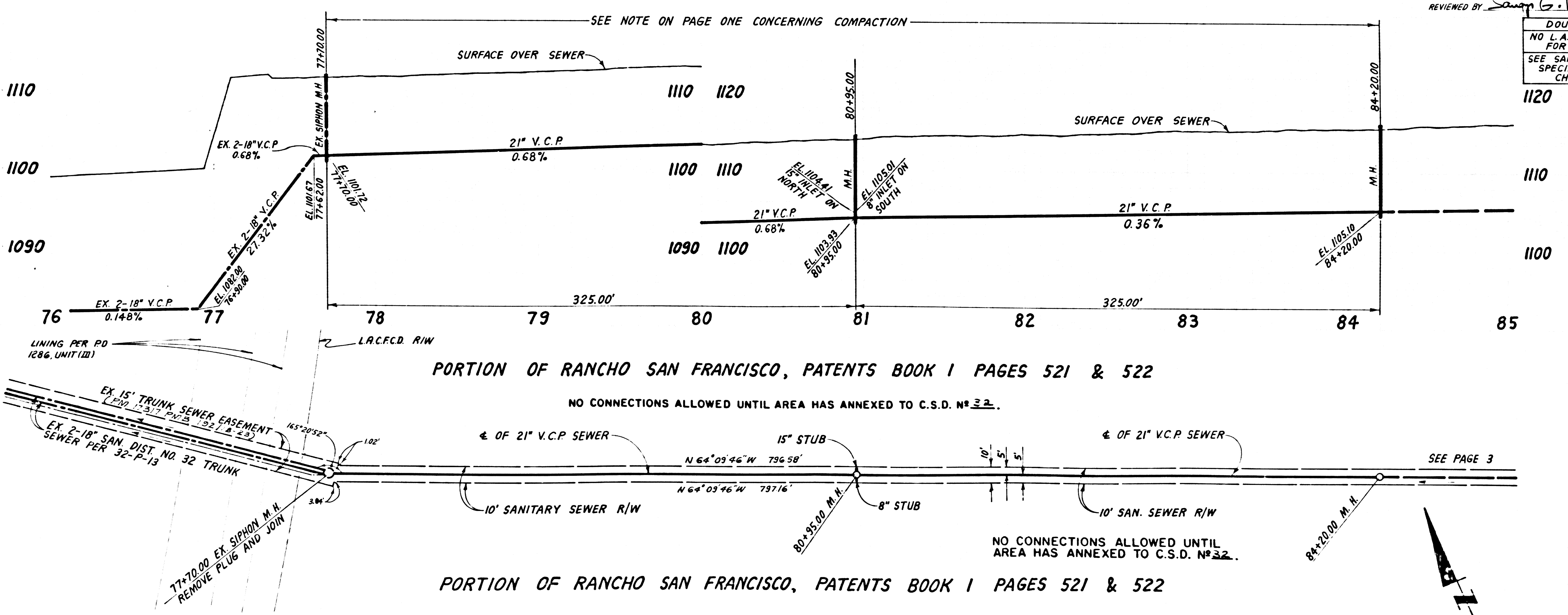

P.C. 10614 PAGE 2

REVIEWED BY: *Sam G. Hal* 12-14-87
 DOUBLE SCALE
 NO L.A. COUNTY CHARGE FOR CONNECTION
 SEE SAN. DISTRICTS FOR SPECIAL CONNECTION CHARGES

PORTION OF RANCHO SAN FRANCISCO, PATENTS BOOK 1 PAGES 521 & 522

NO CONNECTIONS ALLOWED UNTIL AREA HAS ANNEXED TO C.S.D. NO. 32.

PORTION OF RANCHO SAN FRANCISCO, PATENTS BOOK 1 PAGES 521 & 522

1
 1201 29

1
 Mc BEAN PARKWAY AND NEWHALL RANCH RD

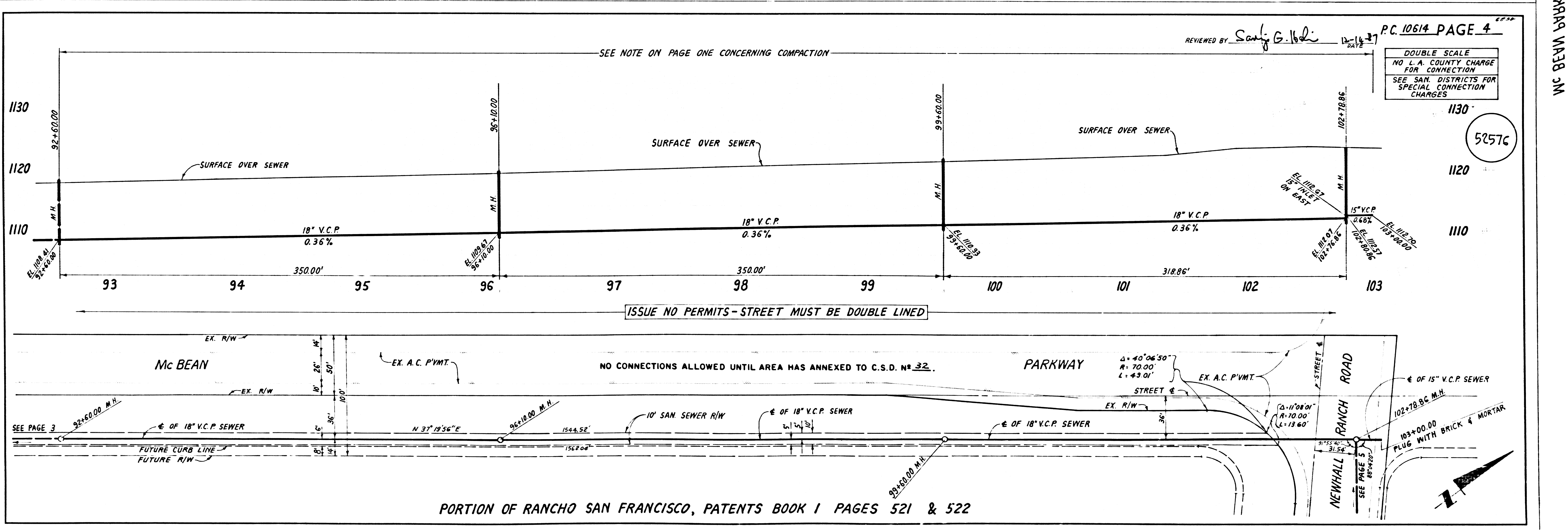
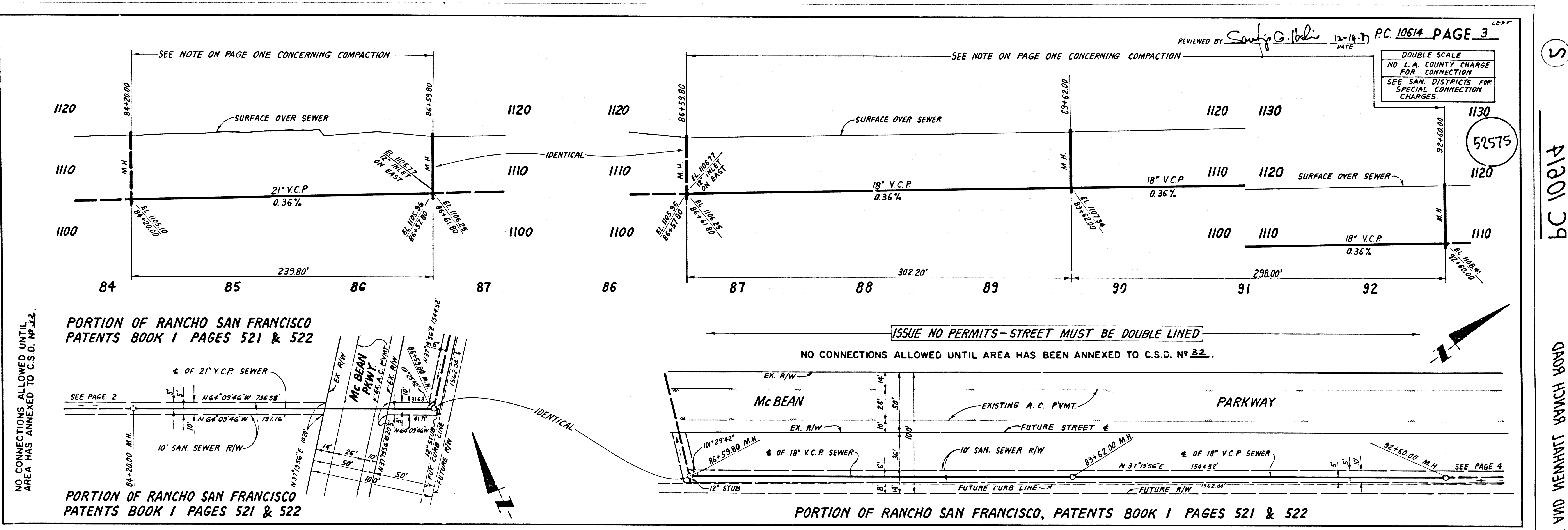

5

52575

MC BEAN PARKWAY AND NEWHALL RANCH ROAD

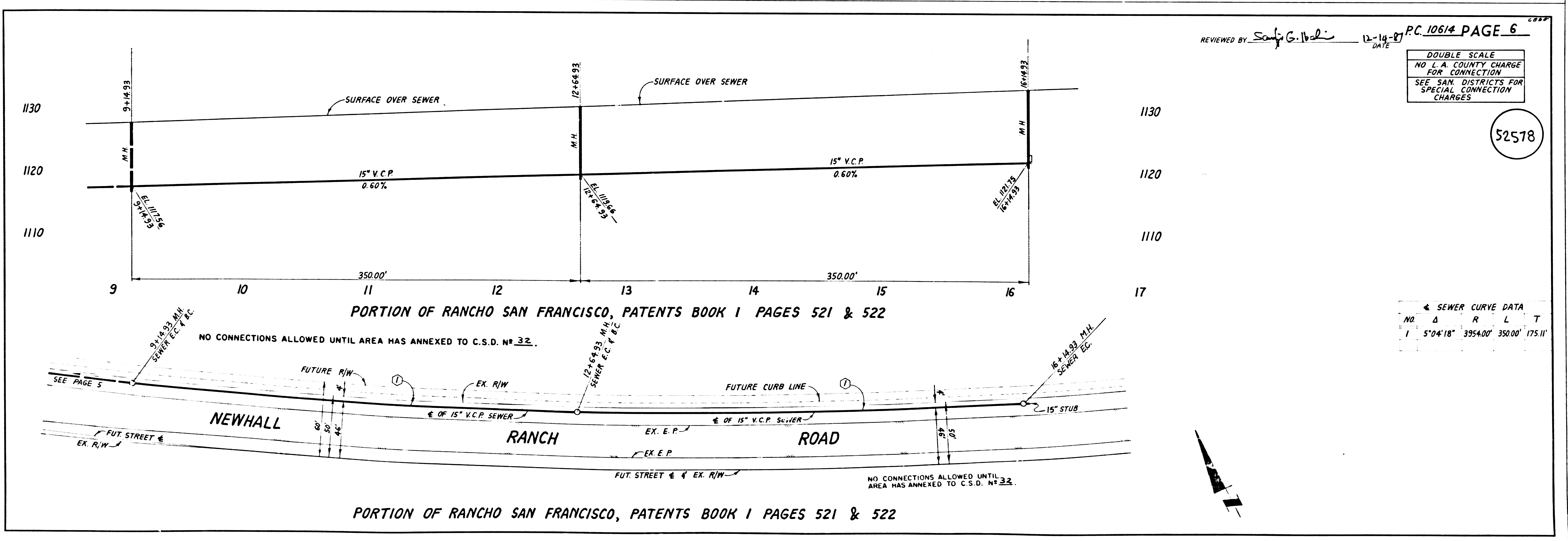
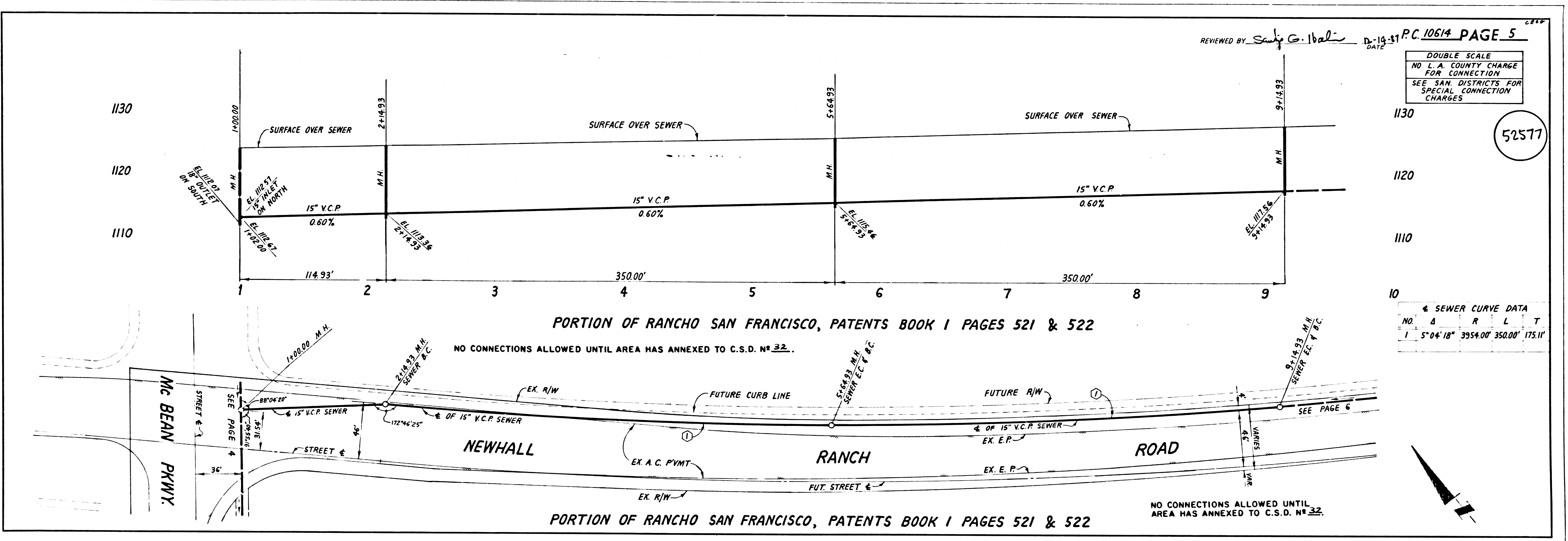

3
A1201 29
DADR 12MNA 12MNA11 DVA YANNA121 M3B 3M