

B.M. CY 757 ELEV. 114.663
 1/4 CT @ COR. 52 FT. S & 45 FT. E
 E. CAL INT. ROSECRANS AVE. AND BROADWAY.
 GARDENA QUAD. 19 12.

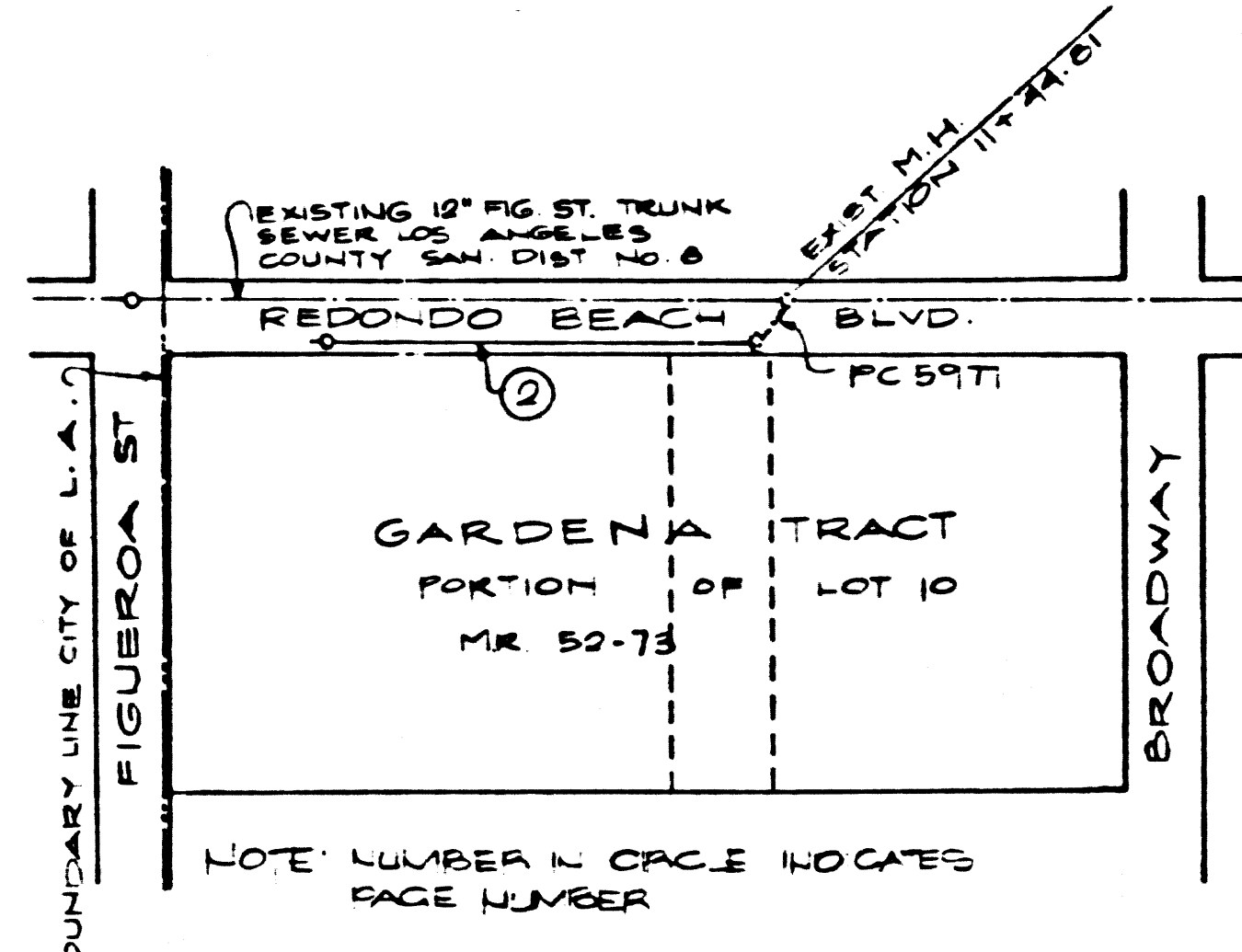

INDEX MAP
 P.C. 10682
 SCALE 1"=600'

REVISION No. 1 DATE: 3/2/87
 CHANGE: MIN. INV. EL. 50.50 @ STA. 1+29 TO INV. EL. 50.00
 CHANGE: MAX. INV. EL. 50.95 @ STA. 4+29 TO INV. EL. 51.45
 CHANGE: 8" DIA. W/ 12' DIA. 4-42 TO 12" DIA. 50.45 TO 51.45
 CHANGE: DISTANCE FROM C.P. OF SEWER LINE TO E. SIDE OF LOT 10 FROM 10' TO 12'
 APPROVED: *Sally G. Hoan* 3/2/87
 OFFICE OF DIRECTOR, PUBLIC WORKS

NO CONNECTION FOR THE DISPOSAL OF INDUSTRIAL WASTES SHALL BE MADE TO SPERSERS SHOWN ON THESE DRAWINGS UNTIL A PERMIT FOR INDUSTRIAL WASTEWATER DISCHARGE HAS BEEN ISSUED BY THE SANITATION DISTRICTS FOR SAID CONNECTION.
 BEFORE BEGINNING OR CONSTRUCTION ON A COUNTY SANITATION DISTRICT SEWER AND PRIOR TO FINAL ACCEPTANCE OF THE PROJECT, SANITATION DISTRICT INSPECTION SHALL BE NOTIFIED BY PHONE 638-1161 SO THAT REQUIRED INSPECTION CAN BE MADE.

GENERAL NOTES:

1. ELEVATIONS ARE IN FEET ABOVE THE M.S.C. & D.S. SEA LEVEL DATUM OF 1929.
2. NO REVISIONS SHALL BE MADE IN THESE PLANS WITHOUT THE APPROVAL OF THE DIRECTOR OF PUBLIC WORKS.
3. NO REPRESENTATIVE OF THE DEPT. OF PUBLIC WORKS SHALL SURVEY OR LAY OUT ANY PORTION OF THE WORK.
4. GRADES TO WHICH THIS IMPROVEMENT IS TO BE CONSTRUCTED ARE SHOWN ON PLANS AND PROFILES. GRADE POINTS FOR TOP OF CURVE CENTERLINE OF STREETS OR CENTERLINE OF ALL EYES ARE SHOWN BY CIRCLES ON PROFILES AT ALL POINTS BETWEEN THREE OF SIGHTED POINTS. THE GRADE SHALL BE ESTABLISHED SO AS TO CONFORM TO A STRAIGHT LINE OR TO A STRAIGHT LINE BETWEEN SIGHTED POINTS.
5. THE PRIVATE ENGINEER SHALL FURNISH THE DEPT. OF PUBLIC WORKS WITH GRADE SHEETS AND STATIONING FOR ALL HOUSE LATERALS AND 12" OR 15" BRANCHES AND SHALL PROVIDE STAKES FOR THEM AT THEIR PROPER LOCATIONS WITH STATIONING PLAINLY MARKED. ALL HOUSE LATERALS SHALL BE CONSTRUCTED IN A STRAIGHT ALIGNMENT AT PROPER ANGLES FROM THE MAIN LINE SEWER EXCEPT AS SHOWN ON THE PLANS. HOUSE LATERALS FROM CHIMNEYS SHALL NOT HAVE AN ANGLE OF LESS THAN 45° WITH THE MAIN LINE SEWER. ANY CHANGE IN ALIGNMENT SHALL BE RECORDED IN WRITING BY THE PRIVATE ENGINEER.
6. THE PRIVATE ENGINEER SHALL FURNISH THE HOUSE LATERAL DEPTH AT THE PROPERTY LINE BELOW THE TOP OF CURVE ELEVATION FOR EACH HOUSE LATERAL ON THE GRADE SHEET.
7. BEFORE WORK CAN BE STARTED THE CONTRACTOR MUST OBTAIN A PERMIT TO EXCAVATE NEARLY ADJACENT TO THE DEEPEST ADJ. OF THE LOCAL AGENCY DEPT. OF PUBLIC WORKS. PERMITS ARE TO BE OBTAINED FROM THE DEPARTMENT OF PUBLIC WORKS, 2517 S. MAIN ST., LOS ANGELES, CALIF. PRIOR TO COVER THE COST OF CONSTRUCTION INSPECTION AND RECORD PLANS.
8. IF WORK IS DONE IN A STATE HIGHWAY A PERMIT MUST BE OBTAINED FROM THE STATE OF CALIFORNIA, DIVISION OF HIGHWAYS, 120 SOUTH SPRING STREET, LOS ANGELES, CALIFORNIA.
9. APPROVAL OF THIS PLAN BY THE QUALITY OF 10% ANGLES DOES NOT CONSTITUTE A REPRESENTATION AS TO THE ACCURACY OF THE LOCATION OF OR THE EXISTENCE OR NON-EXISTENCE OF ANY UNDERGROUND UTILITY PIPE OR STRUCTURE WITHIN THE LIMITS OF THIS PROJECT. THIS NOTE APPLIES TO ALL PAGES.
10. REFER TO SECTION 716.41 OF THE STANDARD SPECIFICATIONS FOR PUBLIC SAFETY CORDS.
11. PRIOR TO THE ISSUANCE OF THE REQUIRED SERVICE CONSTRUCTION PERMIT THE CONTRACTOR SHALL OBTAIN AND FILE WITH THE COUNTY ENGINEER OR PUBLIC WORKS DIVISION OF A PERMIT TO EXCAVATE NEARLY ADJACENT TO THE DEEPEST ADJ. AT THE DEPARTMENT OF PUBLIC WORKS. PERMITS ARE TO BE OBTAINED FROM THE DEPARTMENT OF PUBLIC WORKS, 2517 S. MAIN ST., LOS ANGELES, CALIF. PRIOR TO COVER THE COST OF CONSTRUCTION INSPECTION AND RECORD PLANS.

CONSTRUCTION NOTES:

1. WORK SHALL BE CONSTRUCTED ACCORDING TO THE STANDARD SPECIFICATIONS FOR PUBLIC WORKS CONSTRUCTION 1985 EDITION WITH THE LATEST REVISIONS AND ANY SPECIAL PROVISIONS FOR THE CONSTRUCTION OF SANITARY SEWERS DATED 8/27/85.
2. THE CONTRACTOR SHALL NOTIFY THE CONSTRUCTION DIVISION BY TELEPHONE (213) 821-1111 AT LEAST TWENTY-FOUR HOURS BEFORE START OF ANY WORK UNDER THIS CONTRACT.
3. HOUSE LATERALS TO BE CONSTRUCTED WITH 1/2" DIA. RIBBON PIPE TO THE BODIES OF 12" OR 15" LINES.
4. RIBBON PIPE BRANCHES MAY BE USED FOR CONNECTIONS TO MAINLINE SEWERS EXCEPT AS NOTED.
5. ALL STRUCTURES SHALL BE EITHER BRICK MANHOLES PER 50 OR PRECAST CONCRETE MANHOLES PER 50 EXCEPT AS NOTED.
6. INDOOR STAKES ON THE PROPERTY LINE OR PROPERTY LINES PRODUCED AT RIGHT ANGLES TO THE SEWER LINE AT THE CENTERLINE OF EACH MANHOLE.
7. MANHOLE TOPS IN UNIMPROVED AREAS OF WAY TO BE 54" HIGHER ABOVE FINISHED GRADE.
8. 12" DIA. CLAY PIPE JOINTS SHALL BE TYPE "C" OR "D" PER STANDARD SPECIFICATIONS SECTION 209.2.
9. IF A HOLE IS WITHIN THREE FEET OF THE SEWER THE SEWER SHALL BE ENCASED PER 203 CASE II TWO FEET ON EACH SIDE FROM THE POINT OF INTERFERENCE.
10. IF DURING THE COURSE OF CONSTRUCTION IT IS DETERMINED THAT THERE IS LESS THAN FOUR FEET OF COVER OVER THE TOP OF A MAIN LINE OR HOUSE LATERAL OF SEWER WHICH IS INDICATED ON THE PLANS, THE PIPE SHALL BE ENCASED PER 203 CASE II UNLESS OTHERWISE APPROVED BY THE DIRECTOR OF PUBLIC WORKS.
11. ALL JOINTS BETWEEN CAST IRON PIPE AND WHITE CLAY PIPE SHALL BE MADE WITH A RUBBER SLEEVE JOINT TYPE "C" OR "D" WITH A RIBBON PIPE BRANCH PER STANDARD SPECIFICATIONS SECTION 209.2.
12. SEWERS TO BE TESTED FOR LEAKAGE PER SECTION 209.4 OF THE STANDARD SPECIFICATIONS AND SPECIAL PROVISIONS.
13. RESURFACE ALL TRENCHES WITHIN PAVED AREAS TO MEET ALL APPLICABLE LOCAL, COUNTY, STATE AND FEDERAL REQUIREMENTS AS ACCORDANCE WITH PERMITS.
14. FULL COMPLIANCE WITH SECTION 209.2 OF THE STANDARD SPECIFICATIONS WILL BE REQUIRED FOR ALL TRENCHES TO BE CONSTRUCTED IN PAVED AREAS. ALL TRENCHES TO BE CONSTRUCTED IN UNPAVED AREAS SHALL BE CONSTRUCTED TO MEET THE REQUIREMENTS OF SECTION 209.2 OF THE STANDARD SPECIFICATIONS AND SPECIAL PROVISIONS.
15. SPECIAL REPORTS ON SETTLEMENTS, CONSTRUCTION, AND QUALITY CONTROL SHALL BE SUBMITTED TO THE COUNTY ENGINEER OR PUBLIC WORKS DIVISION OF A PERMIT TO EXCAVATE NEARLY ADJACENT TO THE DEEPEST ADJ. AT THE DEPARTMENT OF PUBLIC WORKS, 2517 S. MAIN ST., LOS ANGELES, CALIF. PRIOR TO COVER THE COST OF CONSTRUCTION INSPECTION AND RECORD PLANS.

PROFILE, ALIGNMENT AND GRADE OF
SANITARY SEWERS
 TO BE CONSTRUCTED IN
 REDONDO BEACH BLVD.
 E/O FIGUEROA STREET
 PRIVATE CONTRACT NO. 10682
 C-44
 1 SHEET OF 2 PAGES
 52464

SCALE: VERT. 1"=4'
 HORIZ. 1"=40'
 DEC. 1986

PREPARED IN THE OFFICES OF
P.A. ARCA ENGINEERING INC.
 2517 S. MAIN ST., STE. 110, CARSON, CA. 90745
 REG. C.E. NO. 12218

THE FOLLOWING LATEST REVISED STANDARD PLANS ON FILE IN THE OFFICE OF THE DEPARTMENT OF PUBLIC WORKS SHALL APPLY TO THE CONSTRUCTION OF THIS PROJECT:

LEGEND	01
MINIMUM PUBLIC SAFETY REQUIREMENTS	02
BRICK MANHOLE	03
STANDARD MANHOLE STEP	04
LOADING FOR SEWER PIPE	05
GRADING AND ENCASUREMENT	06
PIPE ON THE SUPPORT	07
LOCKABLE TRENCH WIDTHS	08
LOCKING MANHOLE FRAME AND COVER	09
NON-REINFORCED PRECAST CONCRETE MANHOLE	10

COUNTY OF LOS ANGELES, CALIFORNIA
 THOMAS A. TIDEMANSON
 DIRECTOR OF PUBLIC WORKS
 CHARLES W. CARRY
 CHIEF ENGINEER

APPROVED: *Carl J. Hoan* 2/20/87
 OFF. DATE
 CHECKED: *[Signature]* DATE
 REG. C.E. NO. 12218

LEN. LLOYD, B.L.O.G. DIST. 7

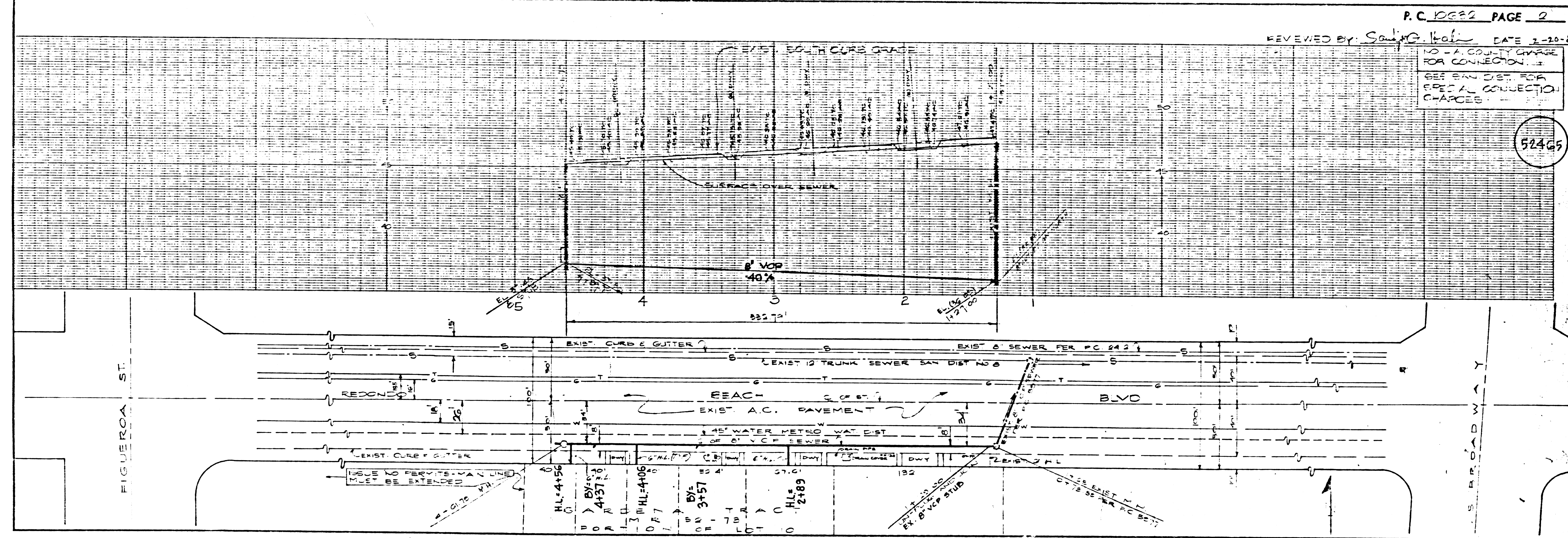

P.C. 10682 PAGE 2
 REVIEWED BY: *Sally G. Hoan* DATE: 2-20-87
 NO COUNTY CHARGE FOR CONNECTION.
 SEE SAN. DIST. FOR SPECIAL COLLECTION CHARGES.
 52465