

TO BE CONSTRUCTED IN

PARCEL MAP NO. 17565

PRIVATE CONTRACT NO. 10634
INDEX U-73, F-3

1 SHEET, 2 PAGES

SCALE: VERT. 1" = 4' HORIZ. 1" = 40'
NOVEMBER, 1986
PREPARED IN THE OFFICES OF
HOPEN, HEDLUND & DARBY, INC.
3080 W. MAIN STREET, ALHAMBRA, CA 91801 (818) 289-0105
REG. C.E. No. 14075

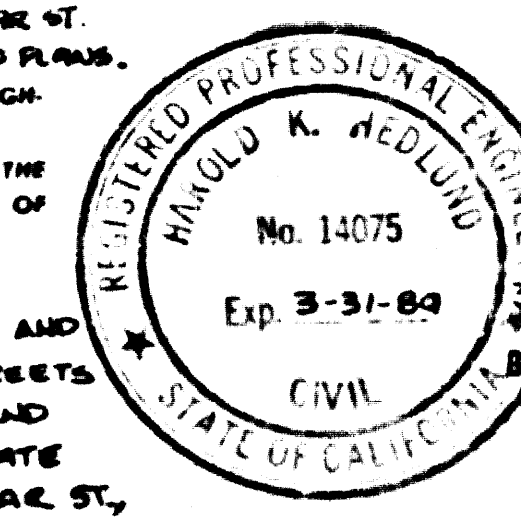

B.M. 220. 2220. ELEV. 717.897
L+T IN SOUTH CURB, CYPRESS AVENUE AT
CURB RETURN, S.W. CORNER LYMAN AVENUE,
2 95' W. AND 2 28' S. OF & INTERSECTION.
SAN DIMAS QUAD. 19 00

12. PRIOR TO COMMENCING WORK WITHIN LYMAN AVENUE
CONTRACTOR SHALL OBTAIN AN EXCAVATION PERMIT
FROM THE CITY OF COVINA EMP. BEHAVIOR DEPARTMENT
PHONE (818) 351-0111, EXT. 251.
NO CONNECTION FOR THE DISPOSAL OF INDUSTRIAL WASTES
SHALL BE MADE TO SEWERS SHOWN ON THESE DRAWINGS UNTIL
A PERMIT FOR INDUSTRIAL WASTEWATER DISCHARGE HAS BEEN
ISSUED BY THE SANITATION DISTRICTS FOR SAID CONNECTION.
BEFORE BREAKING INTO OR CONSTRUCTION ON A COUNTY
SANITATION DISTRICT SEWER AND PRIOR TO FINAL
ACCEPTANCE OF THE PROJECT, SANITATION DISTRICT
INSPECTOR SHALL BE NOTIFIED BY PHONE (818) 962-8605
SO THAT REQUIRED INSPECTION CAN BE MADE.

GENERAL NOTES:

- ELEVATIONS ARE IN FEET ABOVE M.S.C. & U.S. SEA LEVEL DATUM OF 1929.
- NO REVISIONS SHALL BE MADE IN THESE PLANS WITHOUT THE APPROVAL OF THE DIRECTOR OF PUBLIC WORKS.
- NO REPRESENTATIVE OF THE CITY OF COVINA SHALL BE PRESENT AT THE PROJECT LOCATION WITH STATIONING MARKS
MADE TO WHICH THIS IMPROVEMENT IS TO BE CONSTRUCTED ARE SHOWN ON PLANS AND PROFILES GRADE POINTS FOR TOP OF
CURB, CENTER LINE OF STREETS, OR CENTER LINE OF ALLEYS ARE SHOWN BY CHECKS ON PROFILES. AT ALL POINTS BETWEEN BE-
TWEEN POINTS THE GRADE SHALL BE ESTABLISHED SO AS TO CONFORM TO A STRAIGHT LINE BEYOND EACH BEYOND A/B
POINTS.
- THE PRIVATE ENGINEER SHALL FURNISH THE BEST OF PUBLIC WORKS WITHIN 24 HOURS AND FOLLOWING FOR ALL HOUSE LATERALS
AND 12" OR 15" MAINS AND SHALL PROVIDE STAKES FOR THEM AT THEIR PROPER LOCATION. WITH STATIONING MARKS
MADE. ALL HOUSE LATERALS SHALL BE CONSTRUCTED IN A STRAIGHT ALIGNMENT AT RIGHT ANGLES FROM THE MAIN LINE SEWER
EXCEPT AS SHOWN ON THE PLANS. HOUSE LATERALS FROM CHIMNEYS SHALL NOT HAVE AN ANGLE OF LESS THAN 45° WITH THE
MAIN LINE SEWER. ANY CHANGE IN ALIGNMENT SHALL BE REQUESTED BY WRITING BY THE PRIVATE ENGINEER.
- THE PRIVATE ENGINEER SHALL FURNISH THE HOUSE LATERAL DEPTH AT THE PROPERTY LINE BELOW THE TOP OF CURB ELEVATION
FOR EACH HOUSE LATERAL ON THE GRADE SHEET.
- WORK WHICH CAN BE STARTED: THE CONTRACTOR MUST OBTAIN A PERMIT TO EXCAVATE IN COUNTY STREETS FROM THE L.A. COUNTY CONSTRUCTION DIVISION
DISTRICT OFFICE NO. 5 AND PAY A FEE TO THE DIRECTOR OF PUBLIC WORKS, 2250 ALCAHIRE ST.
LOS ANGELES, CALIFORNIA 90058, TO COVER THE COST OF CONSTRUCTION INSPECTION AND RECORD PLANS.
- IF WORK IS TO BE DONE IN A STATE HIGHWAY, A PERMIT MUST BE OBTAINED FROM THE STATE OF CALIFORNIA, DIVISION OF HIGH-
WAYS, 128 SOUTH SPRING STREET, LOS ANGELES, CALIFORNIA.
- APPROVAL OF THIS PLAN BY THE COUNTY OF LOS ANGELES DOES NOT CONSTITUTE A REPRESENTATION AS TO THE ACCURACY OF THE
LOCATION OF OR THE EXISTENCE OR NON-EXISTENCE OF ANY UNDERGROUND UTILITY PIPE, OR STRUCTURE WITHIN THE LIMITS OF
THIS PROJECT. THIS NOTE APPLIES TO ALL PAGES.
- REFER TO SECTION 7-18.1 OF THE STANDARD SPECIFICATIONS, REGARDING SAFETY ORDERS.
- PRIOR TO ISSUANCE OF THE REQUIRED SELLER CONSTRUCTION PERMIT, THE CONTRACTOR SHALL OBTAIN AND
FILE WITH THE DEPARTMENT OF PUBLIC WORKS COPIES OF A PERMIT TO EXCAVATE IN COUNTY STREETS
FROM THE COUNTY DIVISION, AT THE DEPARTMENT OF PUBLIC WORKS, A PERMIT FOR ELEVATIONS AND
STAKES FROM THE STATE OF CALIFORNIA, A DIVISION OF INDUSTRIAL SAFETY AND A CERTIFICATE
OF WORKER'S COMPENSATION ISSUABLE WITH THE DEPARTMENT OF PUBLIC WORKS, 2250 ALCAHIRE ST.,
LOS ANGELES, CA 90058, ROOM 220, WORK AS THE CERTIFICATE HOLDER TO BE NOTIFIED SO DAYS PRIOR
TO COMMENCEMENT OF WORK.

CONSTRUCTION NOTES:

- WORK SHALL BE CONSTRUCTED ACCORDING TO THE STANDARD SPECIFICATIONS FOR PUBLIC WORKS CONSTRUCTION 1978 EDITION
WITH PERMITS SUPPLEMENTED AND COUNTY ENGINEER SPECIAL PROVISIONS FOR THE CONSTRUCTION OF SANITARY SEWERS PART
26.1, 21, 1110 AND SHALL BE PROSECUTED ONLY IN THE PRESENCE OF THE DEPT. OF PUBLIC WORKS.
- THE CONTRACTOR SHALL NOTIFY THE CONSTRUCTION DIVISION BY TELEPHONE, ALHAMBRA 9 47 AM, BY 8:15 AM AT LEAST TWENTY
FOUR HOURS BEFORE STARTING ANY WORK UNDER THIS CONTRACT.
- HOUSE LATERALS TO BE CONSTRUCTED WITH INVERTS AT LEAST ONE FEET BELOW CURB GRADE EXCEPT AS NOTED.
- PIPE OR THE BRANCHES MAY BE USED FOR CONNECTION TO MAINLINE SEWERS EXCEPT AS NOTED.
- ALL STRUCTURES SHALL BE BUILT ACCORDING TO THE STANDARD SPECIFICATIONS, SECTION 200.2.
- POCKET STAKES ON THE PROPERTY LINE OR PROPERTY LINES PRODUCED AT RIGHT ANGLES TO THE SEWER LINE AT THE CENTER LINE
OF EACH MANHOLE.
- MANHOLES FOR UNIMPROVED RIGHTS OF WAY TO BE SIX INCHES ABOVE FINISHED GRADE.
- WHENEVER CURB JOINTS SHALL BE FIVE (5) INCHES OR MORE APART, THE STANDARD SPECIFICATIONS SECTION 200.3.
- IF A POWER POLE IS WITHIN THREE FEET OF THE SEWER, THE SEWER SHALL BE ENCASED, PER 2.23, CASE II, TWO FEET ON EACH SIDE
FROM THE POINT OF INTERFERENCE.
- IF DURING THE COURSE OF CONSTRUCTION IT IS DETERMINED THAT THERE IS LESS THAN FOUR FEET OF COVER OVER THE TOP OF A
MAIN LINE OF HOUSE LATERAL V.C.P. SEWERS WHICH IS NOT INDICATED ON THE PLANS, THE PIPE SHALL BE ENCASED PER 2.23, CASE
II UNLESS OTHERWISE APPROVED BY THE DIRECTOR OF PUBLIC WORKS.
- ALL JOINTS BETWEEN CAST IRON PIPE AND VITRIFIED CLAY PIPE SHALL BE MADE WITH A RUBBER GASKET JOINT, TYPE "C" OR "D",
WITH BEARING IF NECESSARY PER STANDARD SPECIFICATIONS, SECTION 200.2.
- SEWERS TO BE TESTED FOR LEAKS PER SECTION 200.2.2.7 OF THE STANDARD SPECIFICATIONS AND SPECIAL PROVISIONS.
- REPAIRS TO ALL TRENCHES WITHIN PAVED AREAS TO MEET L.A. COUNTY ROAD DEPT. OR CALIFORNIA STATE HIGHWAY REQUIREMENTS
IN ACCORDANCE WITH PERMITS.
- FULL COMPLIANCE WITH SECTION 200.1.3.3 OF THE STANDARD SPECIFICATIONS WILL BE REQUIRED FOR EXCEPT IN STREETS CONSTRUCTION
OF SATELITE CONNECTION AND SAND EQUIVALENTS BY A QUALIFIED REGISTERED TESTING LABORATORY SHALL BE PROVIDED BY THE
PERMITS HOOK TO THE ISSUANCE OF A CERTIFICATE OF PARTIAL ACCEPTANCE.
- SPECIAL BRICKS FOR BENCHING CONSTRUCTION: (A) BRICKS, THROUGH AND THROUGH, CRUISE BATH
SO AS TO RECEIVE THE CURB AND SIDEWALKS AND (B) BRICKS, THROUGH AND THROUGH, CRUISE BATH
BYPASS, FOR DEVELOPMENT BY THE LAND DEVELOPMENT DIVISION. (B) ALL BRICKS SHALL
BE APPROVED BY THE REGISTERED ENGINEER AND SHALL BE REPLACED BY A QUALIFIED TESTING LABORATORY SHALL BE PROVIDED BY THE
PERMITS HOOK TO THE ISSUANCE OF A CERTIFICATE OF PARTIAL ACCEPTANCE.

APPROVED
CITY OF COVINA
Wagner P. Soudry 1-10-87
PUBLIC WORKS DIRECTOR - CITY ENGINEER DATE

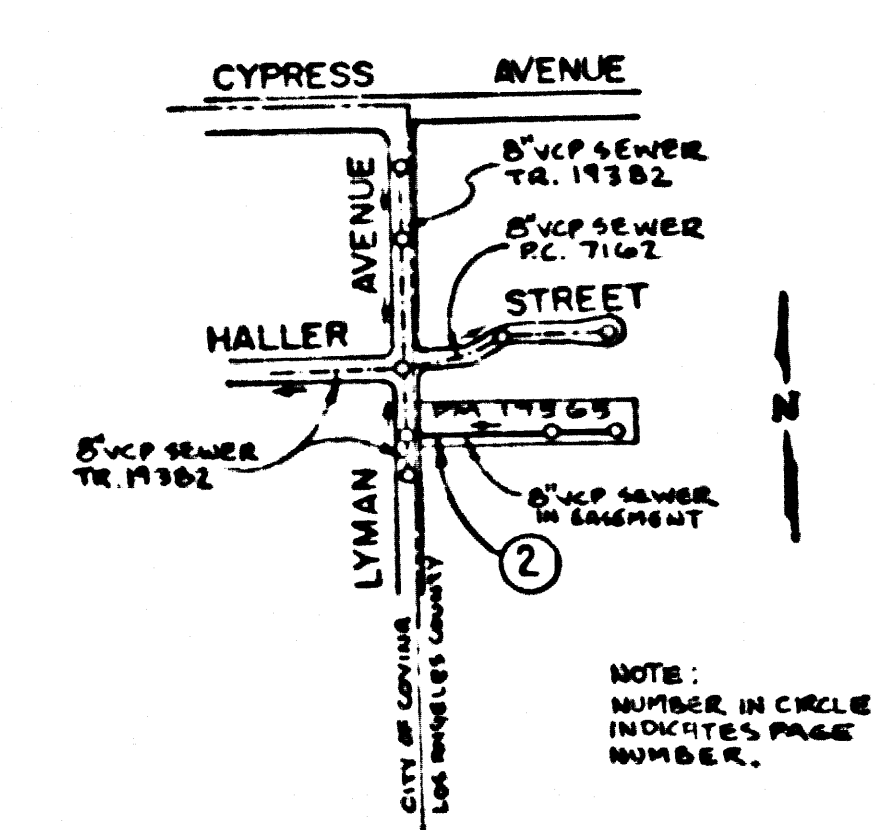

INDEX MAP
SCALE: 1" = 600'
PC 10634

THE FOLLOWING LATEST REVISED STANDARD PLANS ON FILE IN THE OFFICE OF THE COUNTY ENGINEER SHALL APPLY IN THE CON-
STRUCTION OF THIS PROJECT:

| | |
|--|-----|
| SECTION | 5-7 |
| MINIMUM PUBLIC SAFETY REQUIREMENTS | 5-7 |
| BRICK MANHOLES | 5-8 |
| STANDARD MANHOLES WITH | 5-7 |
| BENCHING FOR SEWER PIPE | 5-7 |
| CEILING AND BRICKWORK | 5-7 |
| PIPE ON THE APPROX | 5-8 |
| ALONGSIDE BRICKWORK | 5-8 |
| LOCATING MANHOLE PLANS AND COVER | 5-8 |
| NON-REINFORCED PRECAST CONCRETE MANHOLES | 5-8 |

COUNTY OF LOS ANGELES, CALIFORNIA
THOMAS A. TIDEWANTON, DIRECTOR OF PUBLIC WORKS
CHARLES W. CARRY, CHIEF ENGINEER
APPROVED *Carl Tidewanton* 4/27/87
CHECKED *Sybil...* 4/27/87
REG. C.E. No. 16841
SAN DIMAS BLDG. DIST. 10.00

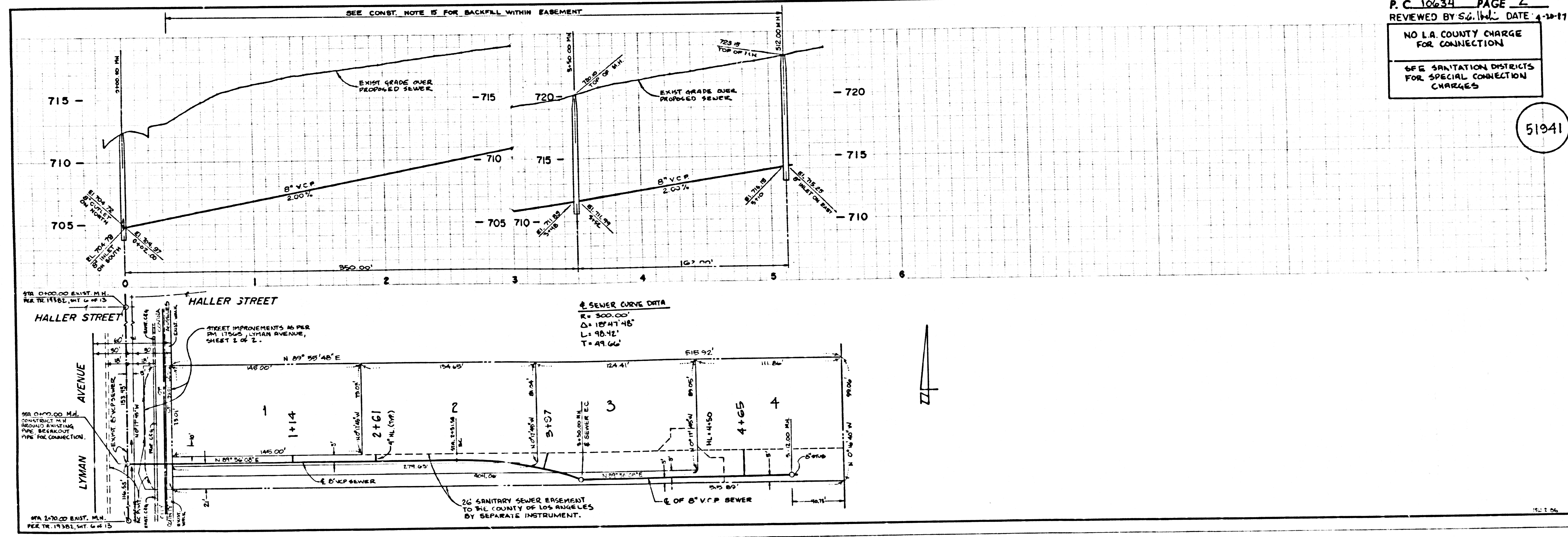

P.C. 10634 PAGE 2
REVIEWED BY S.G. HALL DATE 4-28-87
NO L.A. COUNTY CHARGE FOR CONNECTION
SEE SANITATION DISTRICTS FOR SPECIAL CONNECTION CHARGES