

B.M. CL 1997 ELEV. 802.433
 C.S. MON. IN WELL 6" DN AT C.A. INT. AVE.
 R 13 W AND 70 TH ST. W.P.K.D. (33 34 4 3 T6N,
 R 13 W)
 PALMDALE QUAD. 1973 ADJ.

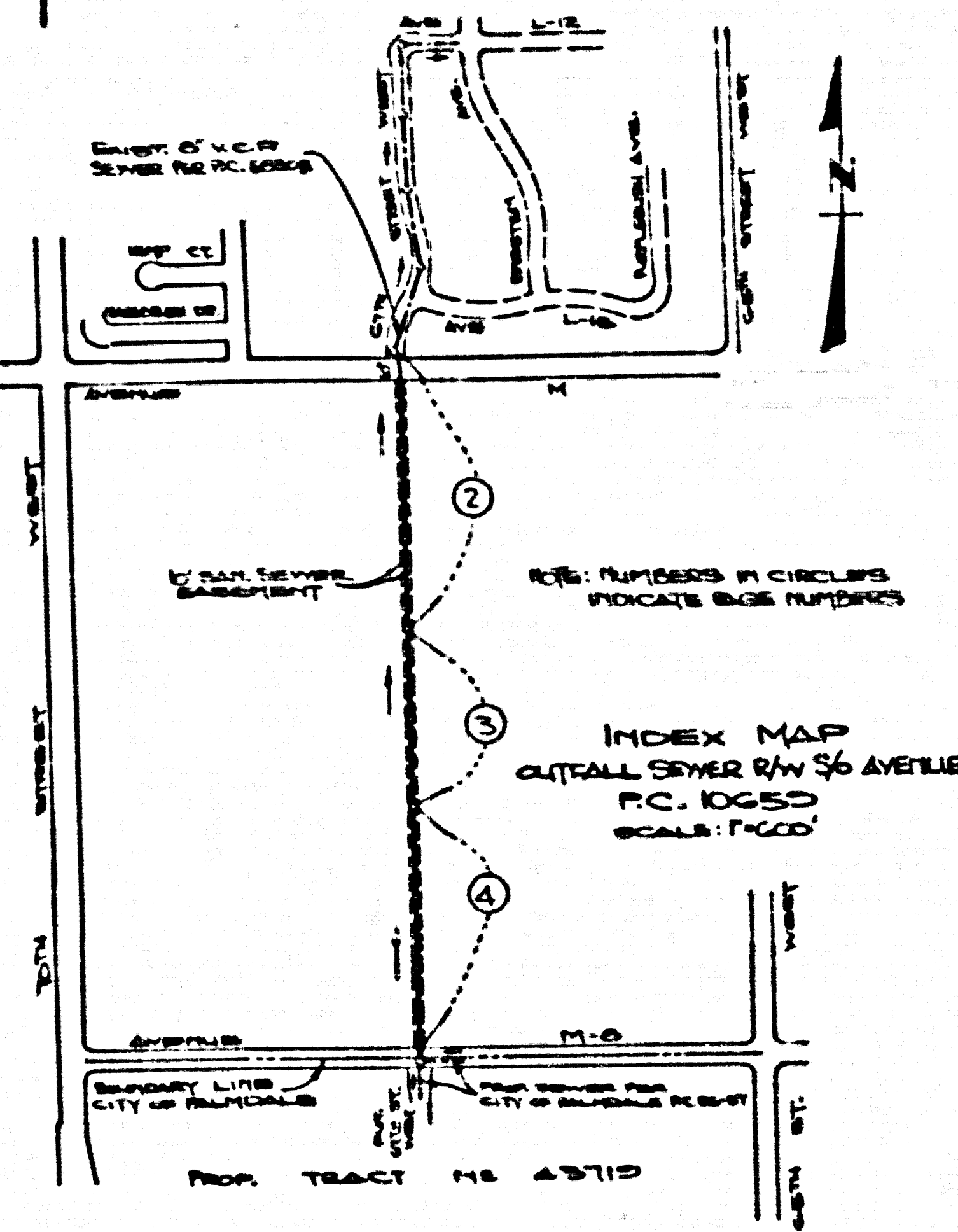

PRIVATE ENGINEER'S NOTICE TO CONTRACTORS

THE EXISTENCE AND LOCATION OF ANY UNDERGROUND UTILITY PIPES OR STRUCTURES SHOWN ON THESE PLANS ARE AS SHOWN BY A BRANCH OF THE SANITATION DISTRICT TO THE BEST OF OUR KNOWLEDGE. THERE ARE NO OTHER UTILITIES SHOWN ON THESE PLANS. THE CONTRACTOR IS REQUIRED TO TAKE ALL PRECAUTIONARY MEASURES TO PROTECT THE UTILITY LINES SHOWN AND ANY OTHER LINES NOT SHOWN OR NOT SHOWN ON THESE PLANS. THE CONTRACTOR SHALL BE RESPONSIBLE FOR LOCATING UNDERGROUND UTILITIES AS SHOWN BY THE SANITATION DISTRICT BEFORE ANY CONSTRUCTION OF THE PROJECT.

CONSTRUCTION NOTES CONT.

- 16. FULL COMPLIANCE WITH PART IV OF THE SPECIAL PROVISIONS IS REQUIRED FOR THE INSTALLATION OF A.B.S. COMPOSITE PIPE.
- 17. MANHOLE WATER STOP GASKETS AND CLAMPS ARE REQUIRED FOR THE CONNECTION OF A.B.S. COMPOSITE PIPE TO MANHOLE STRUCTURES.
- 18. A.B.S. SOLID WALL PIPE MUST BE USED FOR WYE AND HOUSE LATERAL CONNECTIONS TO A.B.S. COMPOSITE MAINLINE SEWER PIPE.
- 19. A.B.S. COMPOSITE PIPE SHALL BE WEDGED IN ACCORDANCE WITH THE TABLE IN SECTION 90.1 OF PART IV OF THE SPECIAL PROVISIONS.
- 20. THREE DESIRED DEFLECTION COUPLER BARS ARE REQUIRED FOR RADIIUS OF CURVATURE LESS THAN 300 FEET WHEN USING A.B.S. COMPOSITE PIPE.
- 21. NO CONNECTIONS FOR DISPOSAL OF INDUSTRIAL WASTE IS ALLOWED IF A.B.S. COMPOSITE PIPE IS USED.
- 22. SLEWER LINE CURVATURE SHALL NOT BE ACHIEVED BY PULLING OF JOINTS OR SPREADING PIPE ENDS WHEN USING PLASTIC PIPE INCLUDING A.B.S. COMPOSITE PIPE.
- 23. ALL WYE AND/OR HOUSE LATERALS ARE TO BE LOCATED AT LEAST FIVE FEET APART AND WHEN POSSIBLE NOT CLOSER THAN FIVE FEET TO ANY MANHOLE.
- 24. A.B.S. SOLID WALL PIPE IS NOT ACCEPTABLE FOR USE AS MAINLINE SEWER.
- 25. ONLY WYE BRANCHES ARE TO BE USED FOR CONNECTION TO A.B.S. COMPOSITE MAINLINE SEWER PIPE.

NO CONNECTION FOR THE DISPOSAL OF INDUSTRIAL WASTES SHALL BE MADE TO SEWERS SHOWN ON THESE DRAWINGS UNTIL A PERMIT FOR INDUSTRIAL WASTEWATER DISCHARGE HAS BEEN ISSUED BY THE SANITATION DISTRICTS FOR SAID CONNECTION.

BEFORE BREAKING INTO OR CONSTRUCTION ON A COUNTY SANITATION DISTRICT SEWER AND PRIOR TO FINAL ACCEPTANCE OF THE PROJECT, SANITATION DISTRICT INSPECTOR SHALL BE NOTIFIED BY PHONE (805) 947-5027 SO THAT REQUIRED INSPECTION CAN BE MADE.

GENERAL NOTES:

- 1. REVISIONS ARE IN RED UNLESS INDICATED OTHERWISE.
- 2. NO REVISIONS SHALL BE MADE TO THESE PLANS WITHOUT THE APPROVAL OF THE DIRECTOR OF PUBLIC WORKS.
- 3. ALL REVISIONS OF THE DEPT. OF PUBLIC WORKS SHALL BE SHOWN ON THE PLAN BY A RED LINE OR BY A RED CIRCLE.
- 4. BRANCHES TO WHICH THIS NOTICE APPLIES TO BE CONSTRUCTED ARE SHOWN ON PLANS AND PREPARED BY THE SANITATION DISTRICT. CENTER LINE OF STREETS OR CENTER LINE OF ALLEYS ARE SHOWN BY CIRCLES ON PLANS. AT ALL POINTS BETWEEN CONSTRUCTION PLANTS THE GRADE SHALL BE DETERMINED AS TO CONFORMANCE WITH THE STANDARD SPECIFICATIONS FOR SANITATION DISTRICTS.
- 5. THE PRIVATE ENGINEER SHALL FURNISH THE DEPT. OF PUBLIC WORKS WITH GRADE SHEETS AND STATIONS FOR ALL HOUSE LATERALS AND 12" OR 14" BRANCHES. PRIVATE ENGINEER'S LINES FOR THESE AT HOUSE LATERAL LOCATIONS WITH STATIONS PLANS, SHOWN ON PLANS, SHALL BE CONSTRUCTED TO A VERTICAL ALIGNMENT AT RIGHT ANGLES TO THE MAIN LINE SEWER EXCEPT AS NOTED ON THE PLANS. ALL WYE LATERALS FROM CHANGES SHALL NOT HAVE AN ANGLE OF LESS THAN 45° WITH THE MAIN LINE SEWER. ANY CHANGE IN ALIGNMENT SHALL BE REQUESTED IN WRITING BY THE PRIVATE ENGINEER.
- 6. THE PRIVATE ENGINEER SHALL FURNISH THE HOUSE LATERAL DEPTH AT THE PROPERTY LINE BELOW THE TOP OF CURB OR FINISH FOR EACH HOUSE LATERAL ON THE GRADE SHEET.
- 7. BEFORE WORK CAN BE STARTED THE CONTRACTOR SHALL BE AWARE THAT ANY STREETS FROM THE CONSTRUCTION TO THE DEPT. OF PUBLIC WORKS SHALL BE OPEN TO THE DEPT. OF PUBLIC WORKS. THE CONTRACTOR SHALL BE RESPONSIBLE FOR THE COST OF CONSTRUCTION INSPECTION AND RECORD PLANS.
- 8. IF WORK IS TO BE DONE IN A STATE HIGHWAY A PERMIT MUST BE OBTAINED FROM THE STATE OF CALIFORNIA, DIVISION OF HIGHWAYS, 180 SOUTH SPRING STREET, LOS ANGELES, CALIFORNIA.
- 9. APPROVAL OF THIS PLAN BY THE COUNTY OF LOS ANGELES DOES NOT CONSTITUTE A REPRESENTATION AS TO THE ACCURACY OF THE LOCATION OR THE EXISTENCE OR NON-EXISTENCE OF ANY UNDERGROUND UTILITY PIPE, OR STRUCTURE WITHIN THE LIMITS OF THIS PROJECT. THIS NOTE APPLIES TO ALL PAGES.
- 10. REFER TO SECTION 7.04.1 OF THE STANDARD SPECIFICATIONS REGARDING SAFETY CHARGES.
- 11. PRIOR TO THE BEGINS OF THE REQUIRED SEWER CONSTRUCTION THE CONTRACTOR SHALL OBTAIN AND FILE WITH THE DEPT. OF PUBLIC WORKS COPIES OF A PERMIT TO EXCAVATE IN COUNTY STREETS FROM THE COUNTY DEPT. AT THE DEPT. OF PUBLIC WORKS A PERMIT FOR EXCAVATION AND TRENCHES FROM THE STATE OF CALIFORNIA DIVISION OF HIGHWAYS. THE CONTRACTOR SHALL OBTAIN A CERTIFICATE OF COMPLIANCE WITH THE DEPARTMENT OF PUBLIC WORKS 90.2 & 90.3 FROM THE COUNTY DEPT. OF PUBLIC WORKS, 1100 WEST 1ST STREET, LOS ANGELES, CALIFORNIA 90012. THE CONTRACTOR SHALL BE RESPONSIBLE FOR THE COST OF OBTAINING THIS PERMIT.

CONSTRUCTION NOTES:

- 1. ROOMS SHALL BE CONSTRUCTED ACCORDING TO THE STANDARD SPECIFICATIONS FOR PUBLIC WORKS CONSTRUCTION. THIS SECTION IS TO BE SUPPLEMENTED BY THE DEPT. OF PUBLIC WORKS SPECIAL PROVISIONS FOR THE CONSTRUCTION OF SANITATION SEWERS DATED SEPTEMBER 21, 1978 AND SHALL BE PRESENTED TO THE DEPT. OF PUBLIC WORKS.
- 2. THE CONTRACTOR SHALL NOTIFY THE CONSTRUCTION DEPT. OF PUBLIC WORKS 24 HOURS BEFORE STARTING ANY WORK UNDER THIS CONTRACT.
- 3. HOUSE LATERALS TO BE CONSTRUCTED WITH INVERTS AT PROPERTY LINE 4 FEET BELOW CURB GRADE EXCEPT AS NOTED.
- 4. WYE OR THE BRANCHES MAY BE USED FOR CONNECTIONS TO MAINLINE SEWERS EXCEPT AS NOTED.
- 5. WYE BRANCHES ONLY MAY BE USED FOR CONNECTIONS TO MAINLINE SEWERS IF A.B.S.C.P. IS USED.
- 6. ALL STRUCTURES SHALL BE EITHER BRICK MANHOLES PER 9.3 OR PRECAST CONCRETE MANHOLES PER 9.3.3 EXCEPT AS NOTED.
- 7. PRECAST STAGES ON THE PROPERTY LINE OR PROPERTY LINES PROHIBITED AT RIGHT ANGLES TO THE SEWER LINE AT THE CENTER LINE OF ANY MANHOLE.
- 8. MANHOLE TOPS IN UNIMPROVED AREAS TO BE 18" ABOVE FINISHED GRADE.
- 9. WYTHED CLAY PIPE JOINTS SHALL BE TYPE "D" OR "E" PER STANDARD SPECIFICATIONS SECTION 90.3.
- 10. IF A POWER POLE IS WITHIN THREE FEET OF THE SEWER, THE SEWER SHALL BE ENCASED PER 9.3.3. CASE 2 AND MUST BE 18" FROM THE POINT OF INTERFERENCE.
- 11. ALL JOINTS BETWEEN CAST IRON PIPE AND WYTHED CLAY PIPE SHALL BE MADE WITH A RUBBER SLEEVE JOINT, TYPE "C" OR "D" WITH GASKETS IF NECESSARY PER STANDARD SPECIFICATIONS SECTION 90.3.
- 12. ALL JOINTS BETWEEN CAST IRON PIPE AND A.B.S.C.P. SHALL BE MADE WITH APPROVED FITTINGS.
- 13. SEWERAGE TO BE TESTED FOR LEAKAGE PER SECTION 90.4 OF THE STANDARD SPECIFICATIONS AND SPECIAL PROVISIONS.
- 14. REPAIRS TO ALL FINISHED WYTHED AREAS TO MEET LA COUNTY ROAD DEPT. OR CALIFORNIA STATE HIGHWAY REQUIREMENTS IN ACCORDANCE WITH PERMITS.
- 15. FULL COMPLIANCE WITH SECTION 90.3 & 90.4 OF THE STD. SPECIFICATIONS WILL BE REQUIRED. FOR BACKFILL IN WYTHED CONNECTIONS OF BRICKLINED CONNECTIONS AND SAND BOUNDARIES BY A QUALIFIED, REGISTERED TESTS LABORATORY SHALL BE PROVIDED BY THE PERMITTEE PRIOR TO THE ISSUANCE OF A CERTIFICATE OF PARTIAL ACCEPTANCE.
- 16. SPECIAL BACKFILL IN WYTHED CONNECTIONS IS BACKFILL FRENCH AND REPLACE OTHER DATA SO AS TO ACHIEVE THE NATURAL OR FINISHED GRADE AND SLOPE SHOWN ON THE SPECIAL PLAN APPROVED FOR THE DEVELOPMENT BY THE LAND DEVELOPMENT DIVISION. ALL BACKFILL AND EARTH REPLACEMENT SHALL BE COMPACTED TO A MINIMUM OF 90% OF MAXIMUM DENSITY PER A.S.T.M. METHOD OF TEST D95 BY AN APPROVED ACCEPTABLE CERTIFICATION OF SUCH COMPACTON SHALL BE SUBMITTED TO THE CONTRACTOR FOR THE PUBLIC WORKS DEPT.

DOUBLE SCALE

SANITARY SEWERS
 TO BE CONSTRUCTED
OUTFALL SEWER R/W S/O AVE. M
FOR TRACT # 43719
PRIVATE CONTRACT NO. 10659

INDEX A-291
 W.S. 71
 2 SHEETS, 4 PAGES
 PREPARED IN THE OFFICES OF
LIND & MILLER, INC.
 1400 WESTINGTON DRIVE
 SAN MARINO, CA 91766
 BY: *[Signature]*
 JOHN A. LAMARCO REG. CE 18233

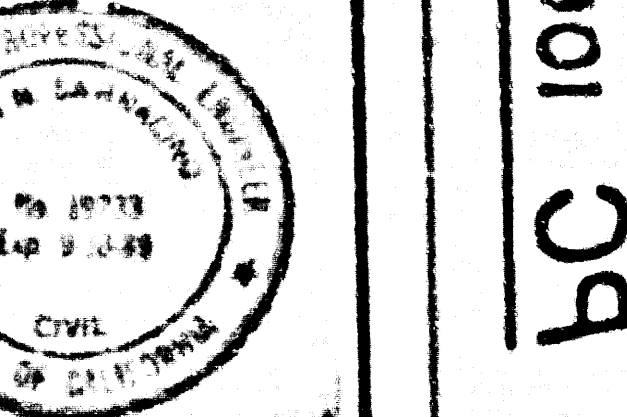

THE FOLLOWING LATEST REVISED STANDARD PLANS ON FILE IN THE OFFICE OF THE DEPARTMENT OF PUBLIC WORKS SHALL APPLY TO THE CONSTRUCTION OF THIS PROJECT:

| | |
|---|------|
| LEAKAGE | 9.1 |
| MINIMUM PUBLIC SAFETY REQUIREMENTS | 9.2 |
| BRICK SEWER MANHOLE | 9.3 |
| BRICK AND MANHOLE STOP | 9.4 |
| RECORDS FOR SEWER PIPE | 9.5 |
| CHANGING AND ENCASING | 9.6 |
| WYE OR THE BRANCH | 9.7 |
| ALLOWABLE TRENCH WIDTHS | 9.8 |
| ACCESSORY MANHOLE FRAMES AND COVERS | 9.9 |
| NON-REINFORCED PRECAST CONCRETE SEWER MANHOLE | 9.10 |
| BREAKING INTO EXISTING BRICK OR PRECAST CONCRETE SEWER MANHOLES | 9.11 |

COUNTY OF LOS ANGELES, CALIFORNIA
 THOMAS A. TIDEMANSON, DIRECTOR
 DEPARTMENT OF PUBLIC WORKS
 APPROVED: *[Signature]* 12/17/87
 CHECKED: *[Signature]* 12/17/87
 CHARLES W. CARRY, CHIEF ENGINEER
 CO. SAN. DIST. NO. 14
 APPROVED: *[Signature]* 1/29/88
 DATE: 1/29/88
 P.C. NO. 10659
 LANCASTER, BLDG. DIST. 8.

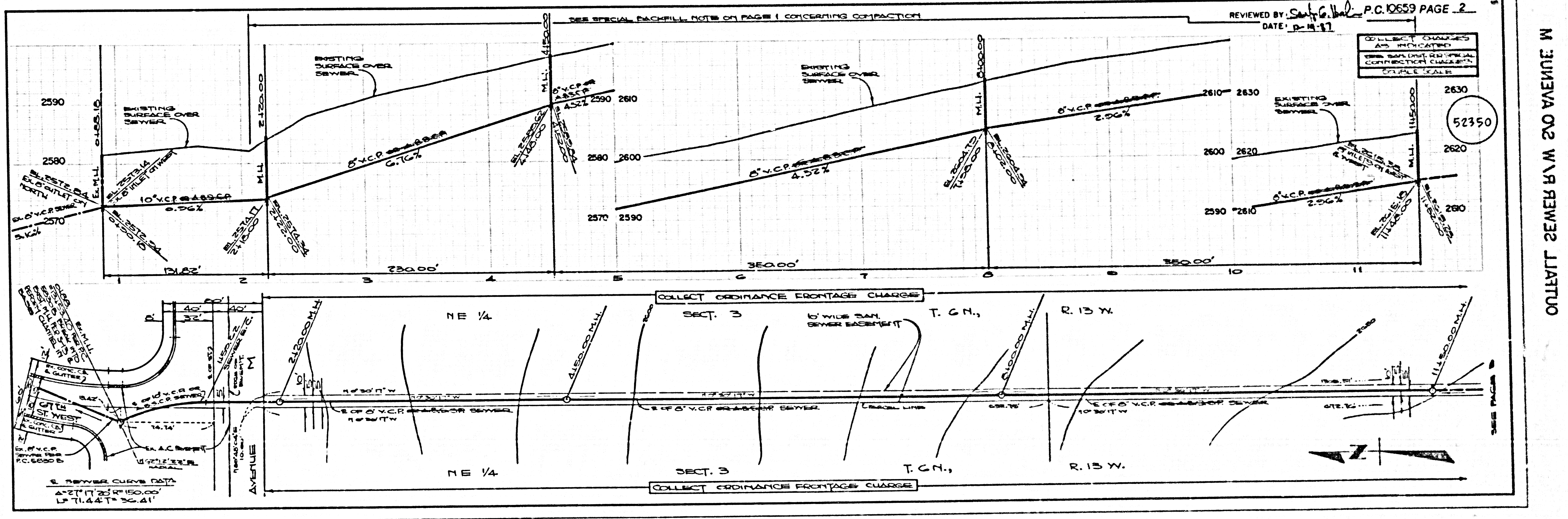

S. SEWER CURVE DATA
 A=271.72 R=150.00
 L=71.44 T=36.41

M. JUNEVA 02 W.P.R. 2EW32 L2AT100

BC 1022

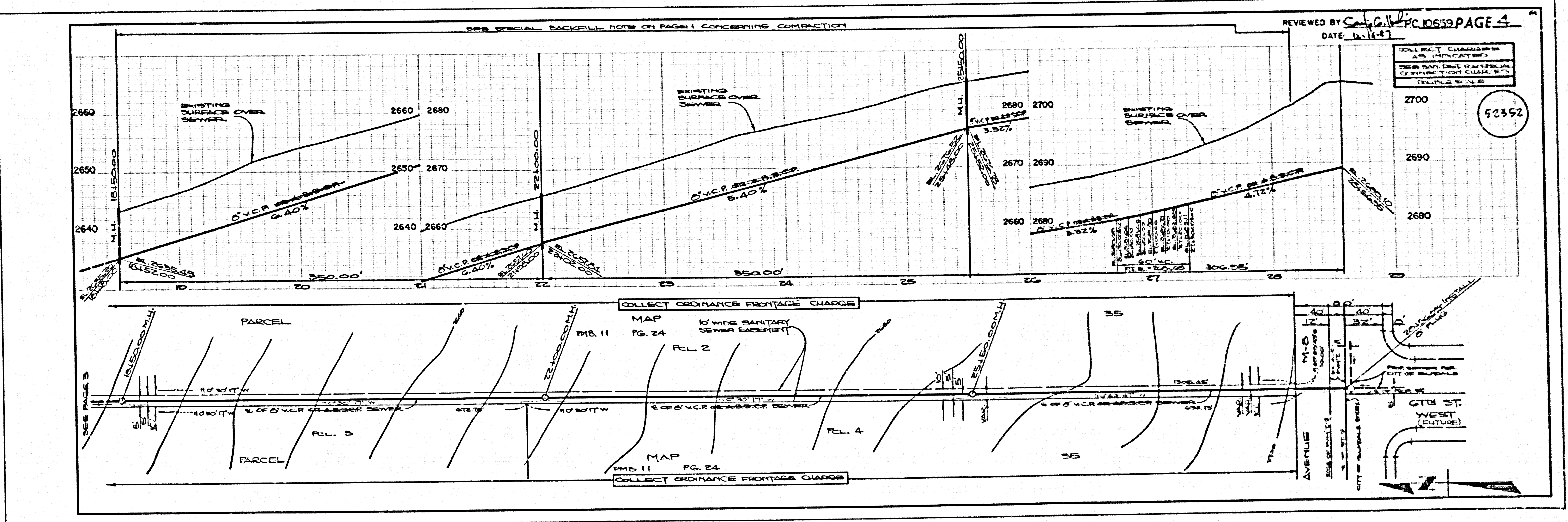
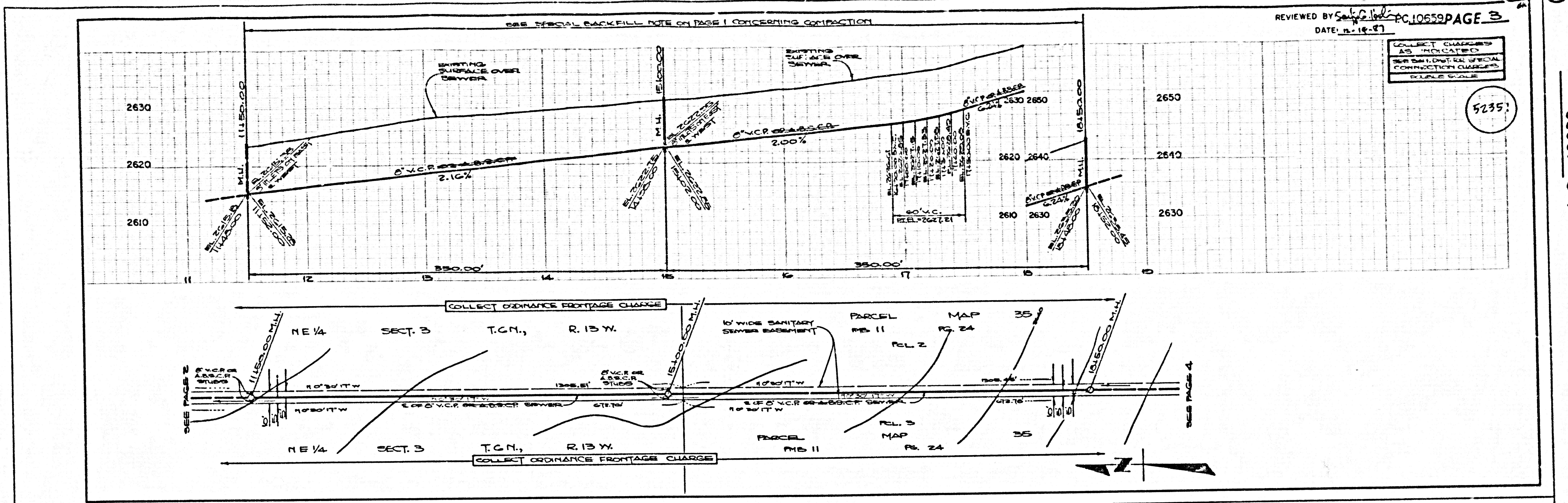

PC 10659

M EUNIVA 012 W/R SEWER 210 AVENUE 012 W/R SEWER 210 AVENUE