

B.M. CY 8208 ELEV. 204.834
 R.D.B.M. 1st E.C.R. @ S.E. Cor.
 LAMBERT RD. & COLE RD. 100 Ft. E.
 & 32 Ft. S. of E. INT.
 SANTA FE QUAD. 1980

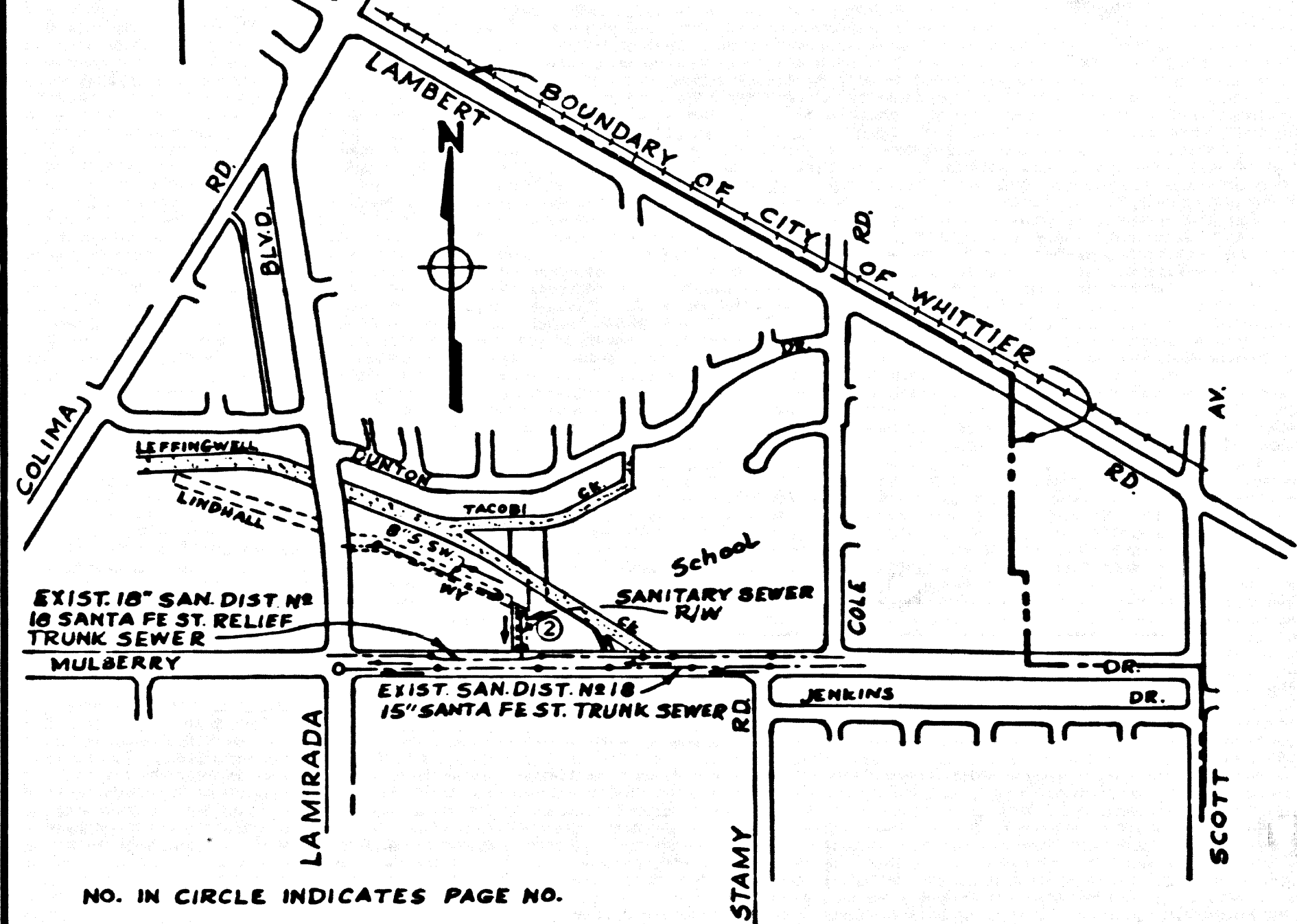

INDEX MAP
 P.C. 10757 RIGHT OF WAY NORTH OF MULBERRY DRIVE
 SCALE: 1" = 600'

STANDARD PLANS
 IN ADDITION THE FOLLOWING COUNTY
 SANITATION DISTRICT STANDARDS
 SHALL APPLY TO THE CONSTRUCTION
 OF THIS PROJECT.
 STD. METHODS FOR CONNECTION TO
 PIPE & STRUCTURES S-A-86

- GENERAL NOTES:**
1. ELEVATIONS ARE IN FEET ABOVE U.S.C. & G.S. SEA LEVEL DATUM OF 1929.
 2. NO REVISIONS SHALL BE MADE IN THESE PLANS WITHOUT THE APPROVAL OF THE DIRECTOR OF PUBLIC WORKS.
 3. NO REPRESENTATIVE OF THE DEPT. OF PUBLIC WORKS SHALL SURVEY OR LAY OUT ANY PORTION OF THE WORK.
 4. GRADES TO WHICH THIS IMPROVEMENT IS TO BE CONSTRUCTED ARE SHOWN ON PLANS AND PROFILES. GRADE POINTS FOR TOP OF CURBS, CENTER LINE OF STREETS, ON CENTER LINE OF ALLEYS AND SHOWN BY CIRCLES ON PROFILES AT ALL POINTS BETWEEN ADJACENT POINTS. THE GRADE SHALL BE ESTABLISHED TO AGREE TO CONFORM TO A STRAIGHT LINE DRAWN BETWEEN SAID DESIGNATED POINTS.
 5. THE PRIVATE ENGINEER SHALL FURNISH THE DEPT. OF PUBLIC WORKS AND "D" OR "T" BRANCHES AND SHALL PROVIDE STAKES FOR THEM AT THEIR PROPER LOCATIONS WITH STATIONING PLAINLY MARKED AS SHOWN ON THE PLANS. HOUSE LATERALS FROM CHIMNEYS SHALL NOT HAVE AN ANGLE OF LESS THAN 45° WITH THE MAIN LINE SEWER EXCEPT WHERE AN CHANGE IN ALIGNMENT SHALL BE REQUESTED IN WRITING BY THE PRIVATE ENGINEER.
 6. THE PRIVATE ENGINEER SHALL FURNISH THE HOUSE LATERAL DEPTH AT THE PROPERTY LINE BELOW THE TOP OF CURB ELEVATION FOR EACH HOUSE LATERAL ON THE GRACE SHEET.
 7. BEFORE WORK CAN BE STARTED, THE CONTRACTOR MUST OBTAIN A PERMIT TO EXCAVATE IN COUNTY STREETS FROM THE C.B.M.S.T. DIV., L.A. CO. DEPT. OF PUBLIC WORKS, PERMIT OFFICE NO. G AND PAY A FEE TO THE DIRECTOR OF PUBLIC WORKS, 500 S. FLEMING AVENUE, ALHAMBRA, CALIF. 91803 TO COVER THE COST OF CONSTRUCTION INSPECTION AND RECORD PLANS.
 8. IF WORK IS TO BE DONE IN A STATE HIGHWAY A PERMIT MUST BE OBTAINED FROM THE STATE OF CALIFORNIA, DIVISION OF HIGHWAYS, 120 SOUTH SPRING STREET, LOS ANGELES, CALIFORNIA.
 9. APPROVAL OF THIS PLAN BY THE COUNTY OF LOS ANGELES DOES NOT CONSTITUTE A REPRESENTATION AS TO THE ACCURACY OF THE LOCATION OF OR THE EXISTENCE OR NON-EXISTENCE OF ANY UNDERGROUND UTILITY PIPE OR STRUCTURE WITHIN THE LIMITS OF THIS PROJECT. THIS NOTE APPLIES TO ALL PAGES.
 10. REFER TO SECTION 7.04.1 OF THE STANDARD SPECIFICATIONS, REGARDING SAFETY ORDERS.
 11. PRIOR TO THE ISSUANCE OF THE REQUIRED SEWER CONSTRUCTION PERMIT, THE CONTRACTOR SHALL OBTAIN AND FILE WITH THE COUNTY ENGINEER COPIES OF A PERMIT TO EXCAVATE IN COUNTY STREETS FROM THE C.B.M.S.T. DIVISION, DIVISION OF PERMITS FOR EXCAVATIONS AND TRENCHES FROM THE STATE OF CALIFORNIA, DIVISION OF INDUSTRIAL SAFETY AND CERTIFICATE OF WORKERS COMPENSATION INSURANCE WITH THE DEPARTMENT OF PUBLIC WORKS, 500 S. FLEMING AVENUE, ALHAMBRA, CALIFORNIA 91803 NAMED AS THE CERTIFICATE HOLDER TO BE NOTIFIED 30 DAYS PRIOR TO CANCELLATION OF POLICY.

- CONSTRUCTION NOTES:**
1. WORK SHALL BE CONSTRUCTED ACCORDING TO DEPT. OF PUBLIC WORKS EDITION WITH PERMITS AND SPECIAL PROVISIONS FOR THE CONSTRUCTION OF SANITARY SEWERS DATED 5 SEPT. 21, 1976, AND SHALL BE PROCEEDED ONLY IN THE PRESENCE OF THE COUNTY ENGINEER.
 2. THE CONTRACTOR SHALL NOTIFY THE COUNTY ENGINEER DIVISION BY TELEPHONE (818) 458-3125 HOURS BEFORE STARTING ANY WORK UNDER THIS CONTRACT.
 3. HOUSE LATERALS TO BE CONSTRUCTED WITHIN A PROPERTY LINE 4 FEET BELOW CURB UNLESS EXCEPT AS NOTED.
 4. WYE OR TEE BRANCHES MAY BE USED FOR CONNECTIONS TO MANHOLE SEWERS EXCEPT AS NOTED.
 5. ALL STRUCTURES SHALL BE EITHER PRECAST CONCRETE MANHOLES PER S-38, EXCEPT AS NOTED.
 6. PROVIDE STAKES ON THE PROPERTY LINE OR PROPERTY LINES PRODUCED AT RIGHT ANGLES TO THE SEWER LINE AT THE CENTER LINE OF EACH MANHOLE.
 7. MANHOLE TOPS BE IMPROVED HEIGHTS OF MAY TO BE LEVEL WITH FINISHED GRADE.
 8. WITRIFIED CLAY PIPE JOINTS SHALL BE TYPE "D" OR "B" PER STANDARD SPECIFICATIONS SECTION 200-2.
 9. IF A POWER POLE IS WITHIN THREE FEET OF THE SEWER, THE SEWER SHALL BE ENCASED PER S-38, CASE B TWO FEET ON EACH SIDE FROM THE POINT OF INTERFERENCE.
 10. IF DURING THE COURSE OF CONSTRUCTION IT IS DETERMINED THAT THERE IS LESS THAN FOUR FEET OF COVER OVER THE TOP OF A MAIN LINE OR HOUSE LATERAL/LEACH WHICH IS NOT INDICATED ON THE PLANS, THE PIPE SHALL BE ENCASED PER S-38, CASE B UNLESS OTHERWISE APPROVED BY THE DEPT. OF PUBLIC WORKS.
 11. ALL JOINTS BETWEEN CAST IRON PIPE AND WITRIFIED CLAY PIPE SHALL BE MADE WITH A RUBBER SLEEVE JOINT, TYPE "D" OR "D", (WITH BUSHING IF NECESSARY) PER STANDARD SPECIFICATIONS, SECTION 200-3.
 12. SEWERS TO BE TESTED FOR LEAKAGE PER SECTION 200-1.4 OF THE STANDARD SPECIFICATIONS AND SPECIAL PROVISIONS.
 13. REPAIRS TO ALL TRENCHES WITHIN FAYED AREAS TO MEET L.A. COUNTY DEPT. OF PUBLIC WORKS OR CALIFORNIA STATE HIGHWAY REQUIREMENTS IN ACCORDANCE WITH PERMITS.
 14. FULL COMPLIANCE WITH SECTION 200-1.3 OF THE ORIGINAL PROVISIONS WILL BE REQUIRED FOR BACKFILL AT STREETS, CERTIFICATION OF BACKFILL CONSTRUCTION AND SAND EQUIVALENTS BY A QUALIFIED, REGISTERED TESTING LABORATORY SHALL BE PROVIDED BY THE PERMITTEE PRIOR TO THE ISSUANCE OF A CERTIFICATE OF PARTIAL ACCEPTANCE.
 15. SPECIAL BACKFILL IN EXISTING CONSTRUCTION (A) BACKFILL TRENCH AND REPLACE OTHER GARTH SO AS TO ACHIEVE THE ORIGINAL FINISHED GRADES AND (B) FILL SHOWN ON THE DRAWINGS PLAN APPROVED FOR THE DEVELOPMENT BY THE LAND DEVELOPMENT DIVISION (H) ALL BACKFILL AND GARTH REPLACED SHALL BE COMPACTED TO A MINIMUM OF 90% OF MAXIMUM DENSITY PER A.S.T.M. STD. METHOD OF TEST D957 AS NOTED. ACCEPTABLE CERTIFICATION OF SUCH COMPACTION SHALL BE SUBMITTED TO THE CONSTRUCTION DIVISION, DEPT. OF PUBLIC WORKS.

NO CONNECTION FOR THE DISPOSAL OF INDUSTRIAL WASTES SHALL BE MADE TO SEWERS SHOWN ON THESE DRAWINGS UNTIL A PERMIT FOR INDUSTRIAL WASTEWATER DISCHARGE HAS BEEN ISSUED BY THE SANITATION DISTRICTS FOR SAID CONNECTION.

BEFORE BREAKING INTO OR CONSTRUCTION ON A COUNTY SANITATION DISTRICT SEWER AND PRIOR TO FINAL ACCEPTANCE OF THE PROJECT, SANITATION DISTRICT INSPECTOR SHALL BE NOTIFIED BY PHONE (818) 962-9605 SO THAT REQUIRED INSPECTION CAN BE MADE.

PROFILE, ALIGNMENT AND GRADE OF PAGE 1
SANITARY SEWERS
 TO BE CONSTRUCTED IN
**RIGHT OF WAY NORTH OF
 MULBERRY DRIVE**
PRIVATE CONTRACT NO. 10757

INDEX G-154, G-G
 1 SHEET, 2 PAGES

SCALE: HORIZ. 1" = 40'
 VERT. 1" = 4'

JULY, 1987
 PREPARED IN THE OFFICES OF
CHARLES F. FLEMING, CIVIL ENGR.
 5714 DOWLING AVE., PICO RIVERA, CA. 90660 (213) 942-8531
 REG. C.E. No. 212324 Expires 3/31/89

REGISTRATION NO. 12324
 CIVIL
 STATE OF CALIFORNIA

EXPIRES DATE 3/31/89

THE FOLLOWING LATEST REVISED STANDARD PLANS ON FILE IN THE OFFICE OF THE DEPT. OF PUBLIC WORKS SHALL APPLY TO THE CONSTRUCTION OF THIS PROJECT:

SECTION	COUNTY
MINIMUM PUBLIC SAFETY REQUIREMENTS	S-1
WIDE SEWER MANHOLE	S-2
STANDARD MANHOLE SET	S-3
SEWERS FOR STEEP SLOPE	S-4
CHANGING AND BRANCHING	S-5
WYE OR TEE SUPPORT	S-6
ALLOWANCE TRENCH WIDTH	S-7
SOCKING MANHOLE PLANS AND COVER	S-8
NON-MANHOLES PRECAST CONCRETE SEWER MANHOLE	S-9
TRAP SEWER MANHOLE BASE	S-10
TRAP SEWER MANHOLE CASTING	S-11

ADDITIONAL STANDARD PLANS - SHOWN AT LEFT.
 COUNTY OF LOS ANGELES, CALIFORNIA

THOMAS A. TIDEMANSON
 DIRECTOR OF PUBLIC WORKS

CHARLES W. CARRY, CHIEF ENGINEER
 CO. SAN. DIST. NO. 18

APPROVED: *[Signature]* DATE: 7/1/87

CHECKED: *[Signature]* DATE: 7/1/87

REG. C.E. NO. 18,110
 L.A. PUENTE BLDG. DIST. 2

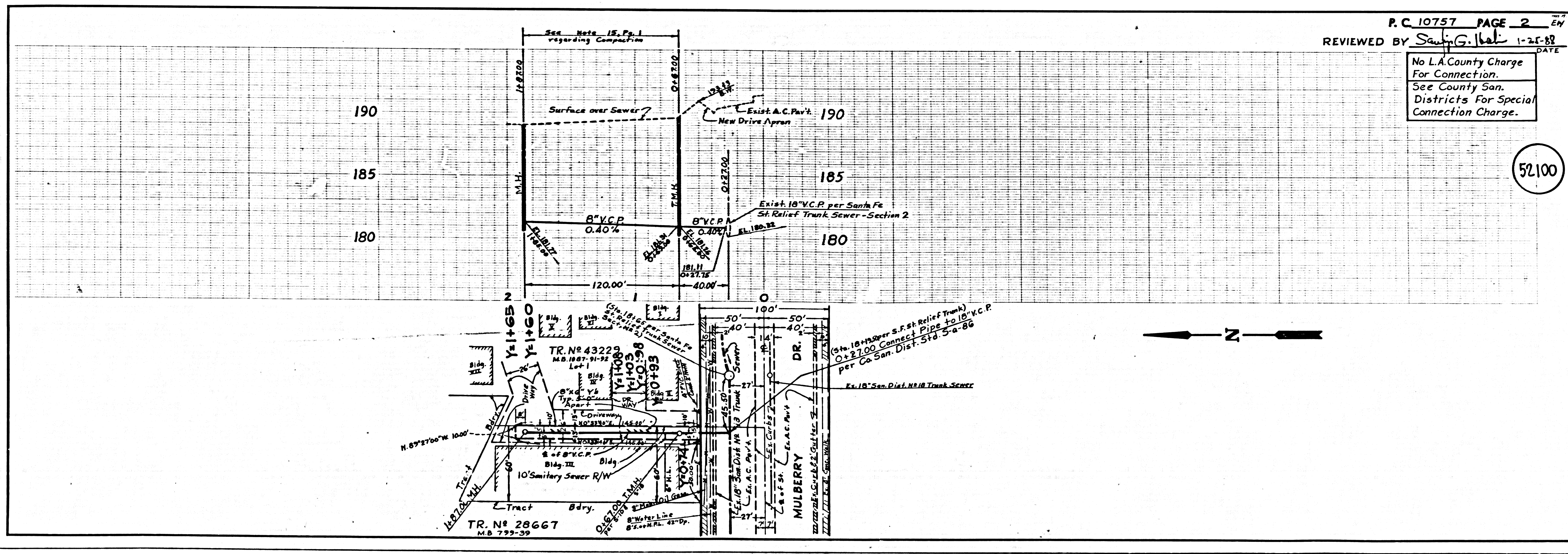

P.C. 10757 PAGE 2
 REVIEWED BY *[Signature]* DATE: 1-25-88

No L.A. County Charge For Connection.
 See County San. Districts For Special Connection Charge.

52100