

B.M. C.Y. 547 ELEV. 47.297
 LET. 1"=10' B.C.P.
 ON N.E. CORNER WESTERN AVE.
 & ROSECRANS AVE. 40 E 4 65 N.
 BASELINE QUAD. 1975

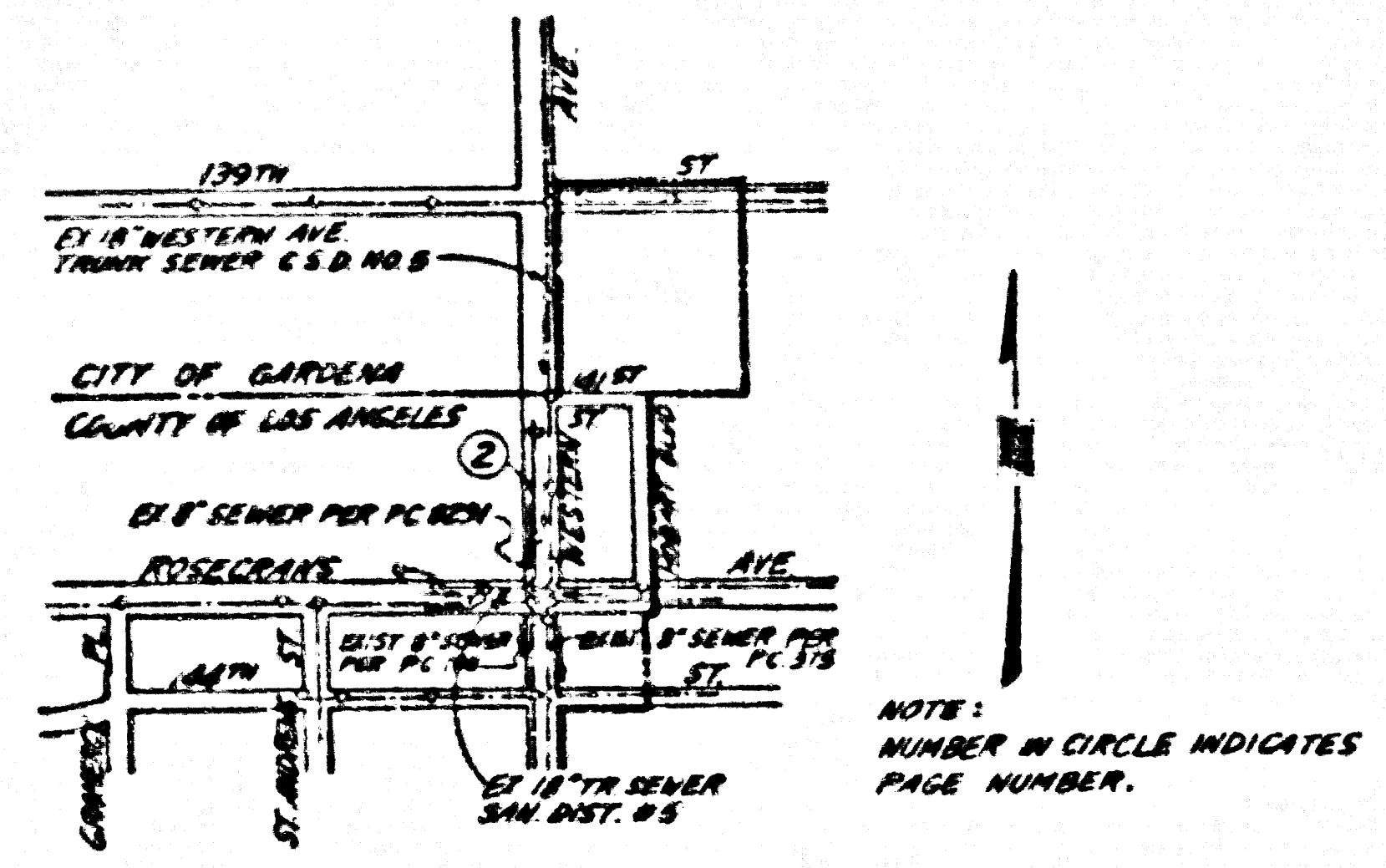

INDEX MAP
 SCALE: 1" = 600'
 WESTERN AVENUE
 P.C. 10780

NO CONNECTION FOR THE DISPOSAL OF INDUSTRIAL WASTES SHALL BE MADE TO SEWERS SHOWN ON THESE DRAWINGS UNTIL A PERMIT FOR INDUSTRIAL WASTEWATER DISCHARGE HAS BEEN ISSUED BY THE SANITATION DISTRICTS FOR SAID CONNECTION.

BEFORE BREAKING INTO OR CONSTRUCTION ON A COUNTY SANITATION DISTRICT SEWER AND PRIOR TO FINAL ACCEPTANCE OF THE PROJECT, SANITATION DISTRICT INSPECTOR SHALL BE NOTIFIED BY PHONE (213) 638-1161 SO THAT REQUIRED INSPECTION CAN BE MADE.

GENERAL NOTES:

1. ALL WORK SHALL BE IN ACCORDANCE WITH THE STANDARD SPECIFICATIONS FOR PUBLIC WORKS, 1967 EDITION WITH THE LATEST REVISIONS.
2. NO REVISIONS SHALL BE MADE IN THESE PLANS WITHOUT THE APPROVAL OF THE DIRECTOR OF PUBLIC WORKS.
3. NO REPRESENTATIVE OF THE DEPARTMENT OF PUBLIC WORKS SHALL SURVEY OR LAY OUT ANY PORTION OF THE WORK.
4. GRADERS TO WHICH THIS WORK IS TO BE CONSTRUCTED ARE SHOWN ON PLANS AND PROFILES. GRADE POINTS FOR TOP OF CURBS, CENTER LINE OF DRIVE OR SIDEWALK OR ALL OTHERS TO BE BY CURBS OR PROFILES AT ALL POINTS TO BE TYPED IN IN NUMERICAL FIGURES. THE GRADE SHALL BE ESTABLISHED SO AS TO CONFORM TO A STRAIGHT LINE BETWEEN THESE SAID DESIGNATED POINTS.
5. THE PRIVATE ENGINEER SHALL FURNISH THE UTILITY MAP OF PUBLIC WORKS DISTRICT MAPS SHEETS AND STATIONING FOR ALL WORKS. A TABLE AND 10' OF 1" SCALE AND SHALL PROVIDE STAKES FOR THEM AT THEIR PROPER LOCATIONS WITH STATIONING PLAINLY MARKED. ALL HOUSE LATERALS SHALL BE CONSTRUCTED IN A STRAIGHT LINE FROM THE MAIN LINE SEWER TO THE POINT OF ENTRY AS SHOWN ON THE PLANS. THE LATERAL SHALL NOT HAVE AN ANGLE OF LESS THAN 45 DEGREES. THE MAIN LINE SEWER OR ANY CHANGE OF ALIGNMENT SHALL BE RECORDED IN WRITING BY THE PRIVATE ENGINEER.
6. THE PRIVATE ENGINEER SHALL FURNISH THE HOUSE LATERAL DEPTH AT THE PROPERTY LINE BELOW THE TOP OF CURB (LEAVE FROM PORCH HOUSE LATERAL ON THE GRADE SHEET).
7. NO CURB WORK CAN BE STARTED UNTIL THE CONTRACTOR HAS OBTAINED A PERMIT TO LOCATE IN COUNTY STREETS FROM THE COUNTY ENGINEER, THE LOS ANGELES DEPARTMENT OF PUBLIC WORKS ENGINEERING OFFICE NO. 8, 1200 WEST 10TH STREET, LOS ANGELES, CALIFORNIA 90006. THE CONTRACTOR SHALL BE RESPONSIBLE FOR OBTAINING THE CITY OF LOS ANGELES DEPARTMENT OF PUBLIC WORKS ENGINEERING OFFICE NO. 8, 1200 WEST 10TH STREET, LOS ANGELES, CALIFORNIA 90006. THE CONTRACTOR SHALL BE RESPONSIBLE FOR OBTAINING THE CITY OF LOS ANGELES DEPARTMENT OF PUBLIC WORKS ENGINEERING OFFICE NO. 8, 1200 WEST 10TH STREET, LOS ANGELES, CALIFORNIA 90006.
8. IF WORK IS TO BE DONE IN A STREET OR ON A SIDEWALK FROM THE CITY OF LOS ANGELES DEPARTMENT OF PUBLIC WORKS ENGINEERING OFFICE NO. 8, 1200 WEST 10TH STREET, LOS ANGELES, CALIFORNIA 90006.
9. APPROVAL OF THIS PLAN BY THE COUNTY OF LOS ANGELES DOES NOT CONSTITUTE A WARRANTY WITHIN AS TO THE ACCURACY OF THE LOCATION OF OR THE EXISTENCE OF ANY UNDERGROUND UTILITY PUBLIC STRUCTURE WITHIN THE LIMITS OF THE PROJECT. THIS NOTE APPLIES TO ALL PLANS.
10. REFER TO SECTION 7.01 OF THE STANDARD SPECIFICATIONS, REGARDING SAFETY DURING CONSTRUCTION.
11. PRIOR TO THE BEGINNING OF THE REQUIRED SEWER CONSTRUCTION NEARBY THE CONTRACTOR SHALL FURNISH TO THE DEPARTMENT OF PUBLIC WORKS ENGINEERING OFFICE NO. 8, 1200 WEST 10TH STREET, LOS ANGELES, CALIFORNIA 90006, A PERMIT TO LOCATE IN COUNTY STREETS FROM THE DEPARTMENT OF PUBLIC WORKS ENGINEERING OFFICE NO. 8, 1200 WEST 10TH STREET, LOS ANGELES, CALIFORNIA 90006. THE CONTRACTOR SHALL BE RESPONSIBLE FOR OBTAINING THE CITY OF LOS ANGELES DEPARTMENT OF PUBLIC WORKS ENGINEERING OFFICE NO. 8, 1200 WEST 10TH STREET, LOS ANGELES, CALIFORNIA 90006.

CONSTRUCTION NOTES:

1. ALL WORK SHALL BE CONSTRUCTED IN ACCORDANCE WITH THE STANDARD SPECIFICATIONS FOR PUBLIC WORKS, 1967 EDITION WITH THE LATEST REVISIONS.
2. THE CONTRACTOR SHALL NOTIFY THE SANITATION DISTRICTS OF ANY CHANGES TO THE PLANS BEFORE THEY ARE MADE.
3. HOUSE LATERALS TO BE CONSTRUCTED WITH INVERTS AT PROPERTY LINE 6 FEET BELOW CURB GRADE EXCEPT AS NOTED.
4. PIPE OF 12" DIAMETER SHALL BE USED FOR ALL HOUSE LATERALS EXCEPT AS NOTED.
5. ALL STRUCTURES SHALL BE CONSTRUCTED IN ACCORDANCE WITH THE STANDARD SPECIFICATIONS FOR PUBLIC WORKS, 1967 EDITION WITH THE LATEST REVISIONS.
6. MANHOLE DEPTHS ON THE PROPERTY LINE OR PROPERTY LINES PRODUCED AT RIGHT ANGLES TO THE SEWER LINE AT THE CENTER LINE OF EACH BRANCH.
7. MANHOLE TOPS IN UNIMPROVED AREAS OF 8' TO 10' SHALL BE AT LEAST 18" BELOW GRADE.
8. IF IMPROVED CLAY PIPE JOINTS SHALL BE TYPE "D" OR "E" PER STANDARD SPECIFICATIONS SECTION 7.02.
9. IF A POWER POLE IS WITHIN THREE FEET OF THE SEWER THE SEWER SHALL BE ENCASED PER CASE 4. THIS FEET ON EACH SIDE FROM THE POINT OF INTERFERENCE.
10. IF DURING THE COURSE OF CONSTRUCTION IT IS DETERMINED THAT THERE IS LESS THAN FOUR FEET OF COVER OVER THE TOP OF MAIN LINE OR HOUSE LATERAL V.C.P. SEWER WHICH IS NOT INDICATED ON THE PLANS, THE PIPE SHALL BE ENCASED PER CASE 4 UNLESS OTHERWISE APPROVED BY THE SANITATION DISTRICTS.
11. ALL JOINTS BETWEEN CAST IRON PIPE AND SPUNNER CLAY PIPE SHALL BE MADE WITH A RUBBER BLEND JOINT TYPE "D" OR "E" WITH RUBBER GASKETS NECESSARY PER STANDARD SPECIFICATIONS SECTION 7.02.
12. SEWERS TO BE RESTORED FOR LEAKAGE PER SECTION 7.04 OF THE STANDARD SPECIFICATIONS AND SPECIAL PROVISIONS.
13. RECONSTRUCT ALL TRENCHES WITHIN PAVED AREAS TO MEET LOS ANGELES COUNTY PUBLIC WORKS OR CALIFORNIA STATE HIGHWAY REQUIREMENTS AS ACCORDANCE WITH PARTS 7.02 AND 7.03 OF THE STANDARD SPECIFICATIONS.
14. FULLY EQUIPPED WITHIN THE LIMITS OF THE PROJECT SHALL BE PROVIDED BY THE CONTRACTOR AND SHALL EQUIPMENTS BY A QUALIFIED REGISTERED TESTING LABORATORY SHALL BE PROVIDED BY THE CONTRACTOR PRIOR TO THE BEGINNING OF CONSTRUCTION.
15. SPECIAL PROVISIONS FOR THE CONSTRUCTION OF SEWERS SHALL BE PROVIDED BY THE CONTRACTOR AND SHALL BE APPROVED FOR THIS PROJECT BY THE SANITATION DISTRICTS.
16. SPECIAL PROVISIONS FOR THE CONSTRUCTION OF SEWERS SHALL BE PROVIDED BY THE CONTRACTOR AND SHALL BE APPROVED FOR THIS PROJECT BY THE SANITATION DISTRICTS.

PROFILE, ALIGNMENT AND GRADE OF
SANITARY SEWERS
 TO BE CONSTRUCTED IN
 WESTERN AVENUE

PRIVATE CONTRACT NO. 10780
 INDEX: C-59-C-5
 1 SHEET OF 2 PAGES

SCALE: HORIZ. 1" = 60' VERT. 1" = 4'
 DATE: OCTOBER, 1967
 PREPARED IN THE OFFICES OF
 RAY & KIM ENGINEERING CO.
 3000 W. 6TH ST. LOS ANGELES, CALIF. 90006
 BY: TAIK Y. KIM, TALK Y. KIM
 REG. C.E. NO. 42422 EXP. DATE 3-31-91

THE FOLLOWING LATEST REVISED STANDARD PLANS ON FILE IN THE OFFICE OF THE DEPARTMENT OF PUBLIC WORKS SHALL APPLY TO THE CONSTRUCTION OF THIS PROJECT:

STANDARD SPECIFICATIONS FOR PUBLIC WORKS, 1967 EDITION WITH THE LATEST REVISIONS	8-1
STANDARD SPECIFICATIONS FOR SEWER PIPE	8-2
STANDARD SPECIFICATIONS FOR SEWER MANHOLES	8-3
STANDARD SPECIFICATIONS FOR SEWER CONNECTIONS	8-4
STANDARD SPECIFICATIONS FOR SEWER SPECIAL HOUSE LATERALS	8-5

COUNTY OF LOS ANGELES, CALIFORNIA
 THOMAS A. TIDEMANSON, DIRECTOR OF PUBLIC WORKS
 CHARLES W. CARRY, CHIEF ENGINEER
 APPROVED: [Signature] DATE: 10/10/67
 CHECKED: [Signature] DATE: 10/10/67
 REG. C.E. NO. 10,110
 LENOX BLDG. DIST. 7

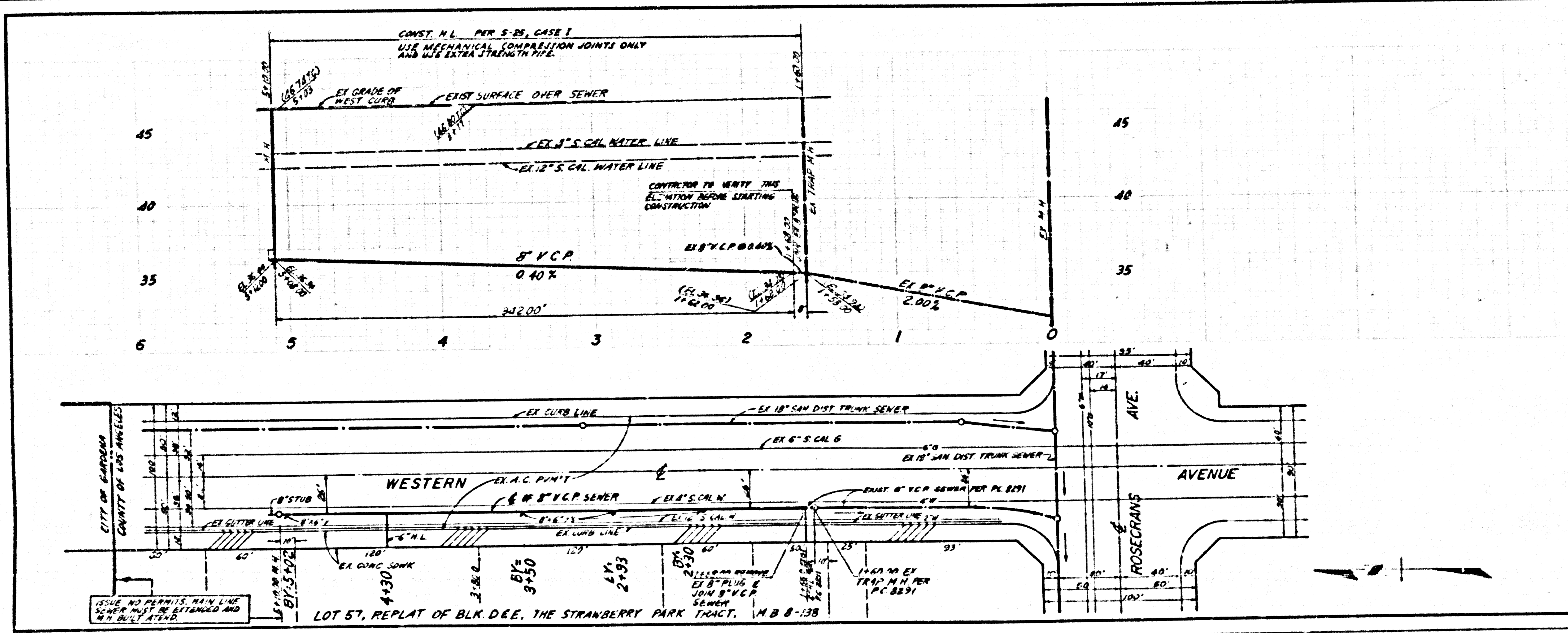

P.C. 10780 PAGE 2
 REVIEWED BY: [Signature] DATE: 10/10/67
 NO L.A. COUNTY CHARGE FOR CONNECTIONS
 SEE COUNTY SAN. DIST. FOR SPECIAL CONNECTION CHARGES

53484

10780 BC
 WESTERN AVENUE