

B.M. 476201 ELEV. 105.30
 P.S. 2517-26 @ THE S.E. CORNER OF ANTIPOLO AND CHERRY DR. DIST. 10000 SANTA FE QUAD. 19-15

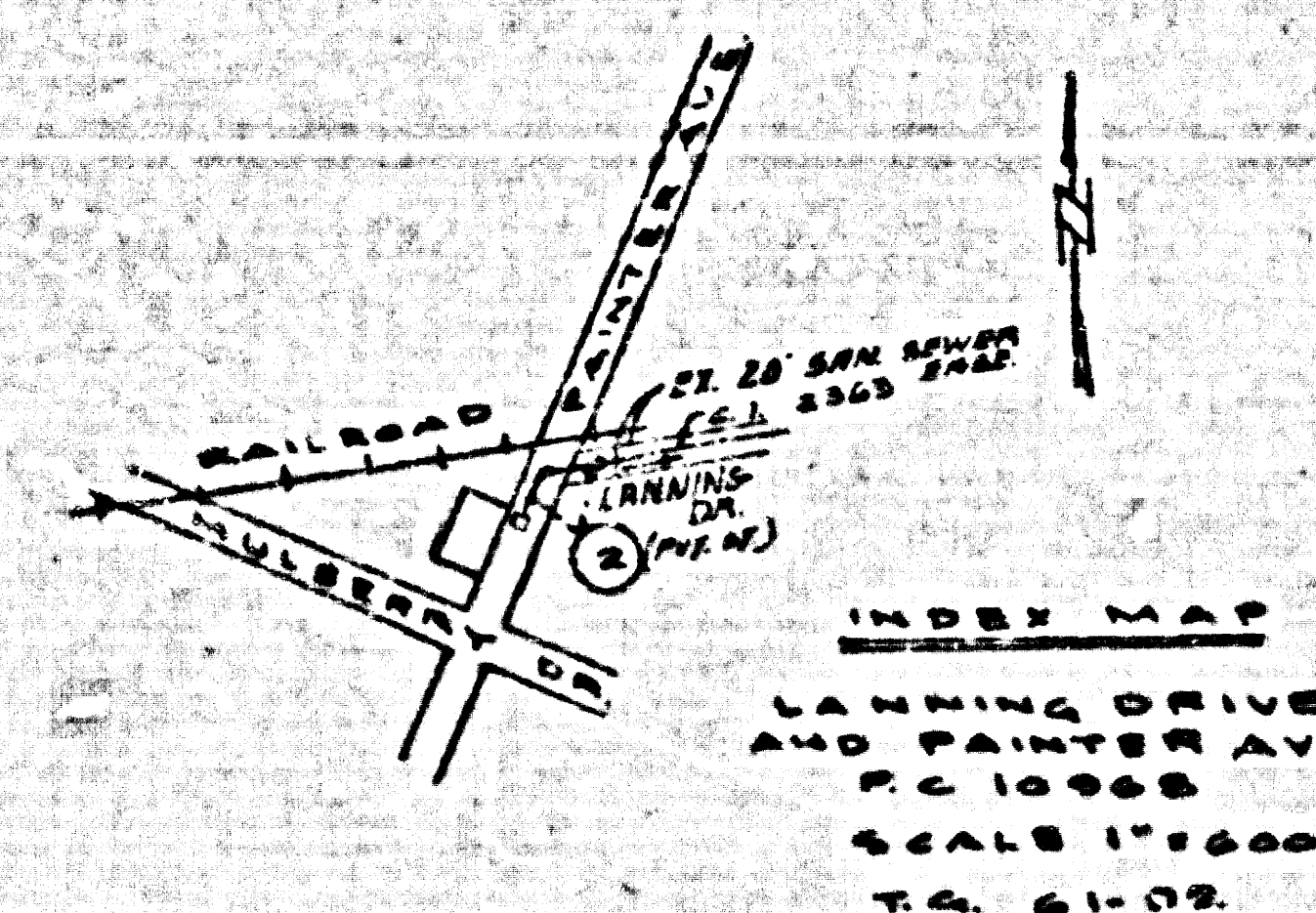

NOTE: NUMBER IN CIRCLE INDICATES PAGE NUMBER.

NO CONNECTION FOR THE DISPOSAL OF INDUSTRIAL WASTES SHALL BE MADE TO SEWERS SHOWN ON THESE DRAWINGS UNTIL A PERMIT FOR INDUSTRIAL WASTEWATER DISCHARGE HAS BEEN ISSUED BY THE SANITATION DISTRICTS FOR SAID CONNECTION.

BEFORE BREAKING INTO OR CONSTRUCTION ON A COUNTY SANITATION DISTRICT SEWER AND PRIOR TO FINAL ACCEPTANCE OF THE PROJECT, SANITATION DISTRICT INSPECTOR SHALL BE NOTIFIED BY PHONE (818) 962-8605 SO THAT REQUIRED INSPECTION CAN BE MADE.

CONTRACTOR TO NOTIFY UNDERGROUND UTILITY DISTRICT AT LEAST 48 HOURS PRIOR TO CONSTRUCTION.

GENERAL NOTES:

1. ELEVATIONS ARE IN FEET ABOVE U.S.S. & B.S. SEA LEVEL DATUM OF 1929.
2. NO REVISIONS SHALL BE MADE IN THESE PLANS WITHOUT THE APPROVAL OF THE DIRECTOR OF PUBLIC WORKS.
3. NO REPRESENTATIVE OF THE DEPARTMENT OF PUBLIC WORKS WILL SIGNIFY OR LAY OUT ANY PORTION OF THE WORK.
4. GRADES IN WHICH THE UNDERGROUND PIPE IS TO BE CONSTRUCTED AND FINISH GRADES AND FINISH ELEVATIONS SHALL BE SHOWN ON ALL LAYOUTS. THE GRADES SHALL BE SET AS SHOWN ON THE PLANS UNLESS OTHERWISE NOTED.
5. THE CONTRACTOR SHALL MAINTAIN THE DEPARTMENT OF PUBLIC WORKS IN THE GRADE SHOWN ON THE PLANS THROUGHOUT THE CONSTRUCTION OF ALL UNDERGROUND LINES AND SHALL PROVIDE STAKES FOR THE WORK AT THE PROPER INTERVALS. THE DEPARTMENT OF PUBLIC WORKS WILL MAINTAIN A RECORD OF ALL UNDERGROUND LINES AND SHALL PROVIDE STAKES FOR THE WORK AT THE PROPER INTERVALS. THE DEPARTMENT OF PUBLIC WORKS WILL MAINTAIN A RECORD OF ALL UNDERGROUND LINES AND SHALL PROVIDE STAKES FOR THE WORK AT THE PROPER INTERVALS.
6. THE PRIVATE ENGINEER SHALL FURNISH THE HOUSE LATERALS UP TO THE POINT OF CONNECTION TO THE SANITATION DISTRICT SEWER LATERAL ON THE GRADE SHOWN.
7. BEFORE ANY WORK CAN BE STARTED THE CONTRACTOR SHALL OBTAIN A PERMIT TO DIG FROM THE COUNTY STREET DEPARTMENT OF THE LOS ANGELES DEPARTMENT OF PUBLIC WORKS OFFICE NO. 10000 SANTA FE QUAD. 19-15. THE PERMIT SHALL BE OBTAINED FROM THE COUNTY STREET DEPARTMENT OF PUBLIC WORKS OFFICE NO. 10000 SANTA FE QUAD. 19-15.
8. IF WORK IS TO BE DONE IN A STATE "CITY" A PERMIT MUST BE OBTAINED FROM THE STATE OF CALIFORNIA DEPARTMENT OF HIGHWAYS, TREASURY & PUBLIC WORKS, LOS ANGELES OFFICE.
9. APPROVAL OF THIS PLAN BY THE COUNTY OF LOS ANGELES DOES NOT CONSTITUTE A REPRESENTATION AS TO THE ACCURACY OF THE LOCATION OF OR THE EXISTENCE OF ANY UNDERGROUND UTILITY PIPE OR STRUCTURE WITHIN THE LIMITS OF THE PROJECT. THIS NOTE APPLIES TO ALL PAGES.
10. REFER TO SECTION 7.12.4 OF THE STANDARD SPECIFICATIONS REGARDING SAFETY SIGNALS.
11. PRIOR TO THE BEGINNING OF THE UNDERGROUND CONSTRUCTION PERMIT THE CONTRACTOR SHALL NOTIFY THE DEPARTMENT OF PUBLIC WORKS OFFICE NO. 10000 SANTA FE QUAD. 19-15. THE CONTRACTOR SHALL MAINTAIN THE DEPARTMENT OF PUBLIC WORKS OFFICE NO. 10000 SANTA FE QUAD. 19-15. THE CONTRACTOR SHALL MAINTAIN THE DEPARTMENT OF PUBLIC WORKS OFFICE NO. 10000 SANTA FE QUAD. 19-15.

TO BE CONSTRUCTED IN LANNING DRIVE AND PAINTER AVENUE

PRIVATE CONTRACT NO. 10968
 INDEX 2-157
 SHEET 1 OF 2 PAGES

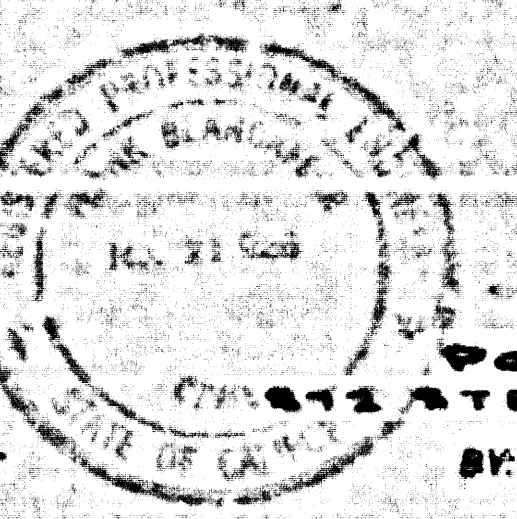

SCALE: HORIZ. 1"=50' VERT. 1"=4'

PREPARED IN THE OFFICES OF
POND & ASSOCIATES
 1100 N. GUY WIRE RD., LOS ANGELES, CALIF. 90016
 BY: *James E. Pond*
 REG. CE NO. 21225 FEB 1988
 REGISTRATION EXPIRES 7/30/93

CONSTRUCTION NOTES:

1. WORK SHALL BE CONSTRUCTED ACCORDING TO THE STANDARD SPECIFICATIONS FOR PUBLIC WORKS CONSTRUCTION (1988) AND THE COUNTY OF LOS ANGELES STANDARD SPECIFICATIONS FOR PUBLIC WORKS CONSTRUCTION (1988).
2. THE CONTRACTOR SHALL NOTIFY THE CONSTRUCTION DIVISION BY TELEPHONE AT LEAST TWENTY-FOUR HOURS BEFORE START OF ANY WORK UNDER THIS CONTRACT.
3. HOUSE LATERALS TO BE CONSTRUCTED WITH 18" DIA. RIBBON PIPE UNLESS OTHERWISE NOTED.
4. USE OF THE BRANCHED JOINT BE USED FOR CONNECTIONS TO HOUSE LATERALS UNLESS OTHERWISE NOTED.
5. ALL STRUCTURES SHALL BE OTHER THAN MANHOLES PER 8.01 PRECAST CONCRETE MANHOLES PER 8.05 EXCEPT AS NOTED.
6. HOUSE LATERALS ON THE PROPERTY LINE OR PROPERTY LINES SHALL BE MAINTAINED AT RIGHT ANGLES TO THE CENTER LINE OF EACH MANHOLE.
7. MANHOLE TOPS: 8. LAMPED LIGHT FIXTURES SHALL BE 4" DIA. UNLESS OTHERWISE NOTED.
8. UNIMPROVED CLAY PIPE JOINTS SHALL BE TYPE "D" OR "E" PER STANDARD SPECIFICATIONS SECTION 7.12.4.
9. IF A HOUSE LATERAL IS OTHER THAN 18" DIA. THE COVER SHALL BE ENLARGED TO 24" DIA. TO PROVIDE A MINIMUM CLEARANCE OF 18" TO THE CENTER LINE OF THE HOUSE LATERAL.
10. IF DURING THE COURSE OF CONSTRUCTION IT IS DETERMINED THAT THERE IS LESS THAN FOUR FEET OF COVER OVER THE TOP OF A MANHOLE OR HOUSE LATERAL, THE COVER SHALL BE ENLARGED TO 24" DIA. TO PROVIDE A MINIMUM CLEARANCE OF 18" TO THE CENTER LINE OF THE HOUSE LATERAL.
11. ALL JOINTS BETWEEN CAST IRON PIPE AND UNIMPROVED CLAY PIPE SHALL BE MADE WITH A RUBBER SLEEVE JOINT TYPE "C" OR "D" WITH BRUSHING IF NECESSARY PER STANDARD SPECIFICATIONS SECTION 8.01.
12. SEWERS TO BE TESTED FOR LEAKAGE PER SECTION 7.12.4 OF THE STANDARD SPECIFICATIONS AND SPECIAL PROVISIONS.
13. SURFACE ALL TRENCHES OTHER THAN SEWER TRENCHES TO MEET LOS ANGELES COUNTY PUBLIC WORKS OFFICE OF CALIFORNIA STATE HIGHWAY REQUIREMENTS AS INDICATED WITH SIGNS.
14. PER COMPLIANCE WITH SECTION 7.12.4 OF THE STANDARD SPECIFICATIONS AND SPECIAL PROVISIONS, THE CONTRACTOR SHALL OBTAIN A PERMIT TO DIG FROM THE COUNTY STREET DEPARTMENT OF PUBLIC WORKS OFFICE NO. 10000 SANTA FE QUAD. 19-15. THE CONTRACTOR SHALL MAINTAIN THE DEPARTMENT OF PUBLIC WORKS OFFICE NO. 10000 SANTA FE QUAD. 19-15.
15. SPECIAL BACKFILL IN SEWERAGE CONSTRUCTION IS BACKFILL TRENCH AND REPLACE OTHER LATERALS SO AS TO ACHIEVE THE NATURAL OR FINISHED GRADES AND SLOPES SHOWN ON THE DRAWINGS AS APPROVED FOR THE DISTRICT BY THE LAND DEVELOPMENT DIVISION. IN ALL BACKFILL AND SAND FILL SHALL BE CONFINED TO A MINIMUM OF 90% OF MAXIMUM DRY UNIT WEIGHT IN THE BOTTOM OF THE TRENCH AS APPROVED ACCEPTABLE CERTIFICATION OF SUCH CONSTRUCTION SHALL BE SUBMITTED TO THE COUNTY PUBLIC WORKS DEPARTMENT.

THE FOLLOWING LISTED ITEMS SHALL BE MAINTAINED IN AND OFFICE IN THE OFFICE OF THE DEPARTMENT OF PUBLIC WORKS SHALL APPLY TO THE CONSTRUCTION OF THIS PROJECT:

LEGEND	01
MINIMUM PUBLIC SAFETY REQUIREMENTS	01
BRICK MANHOLE	02
STANDARD MANHOLE STEP	03
BEDDING FOR SEWER PIPE	04
CAST-IRON AND ENCASEMENT	05
PIPE ON THE SURFACE	06
ALLOWABLE TRENCH WIDTHS	07
LOCKING MANHOLE FRAME AND COVER	08
HIGH-STRENGTH CONCRETE MANHOLE	09
PRECAST CONCRETE MANHOLE	10
PRECAST CONCRETE MANHOLE	11
PRECAST CONCRETE MANHOLE	12

COUNTY OF LOS ANGELES, CALIFORNIA
 THOMAS A. TIDEMANSON
 DIRECTOR OF PUBLIC WORKS

APPROVED: *Dean E. ...* 12/11/89
 CHECKED: *James E. Pond* 12/11/89

APPROVED: *Charles W. Carry* 12/11/89
 CHIEF ENGINEER

REG. CE NO. 18116

104 1471 B UN. BLDG. DIST. 11

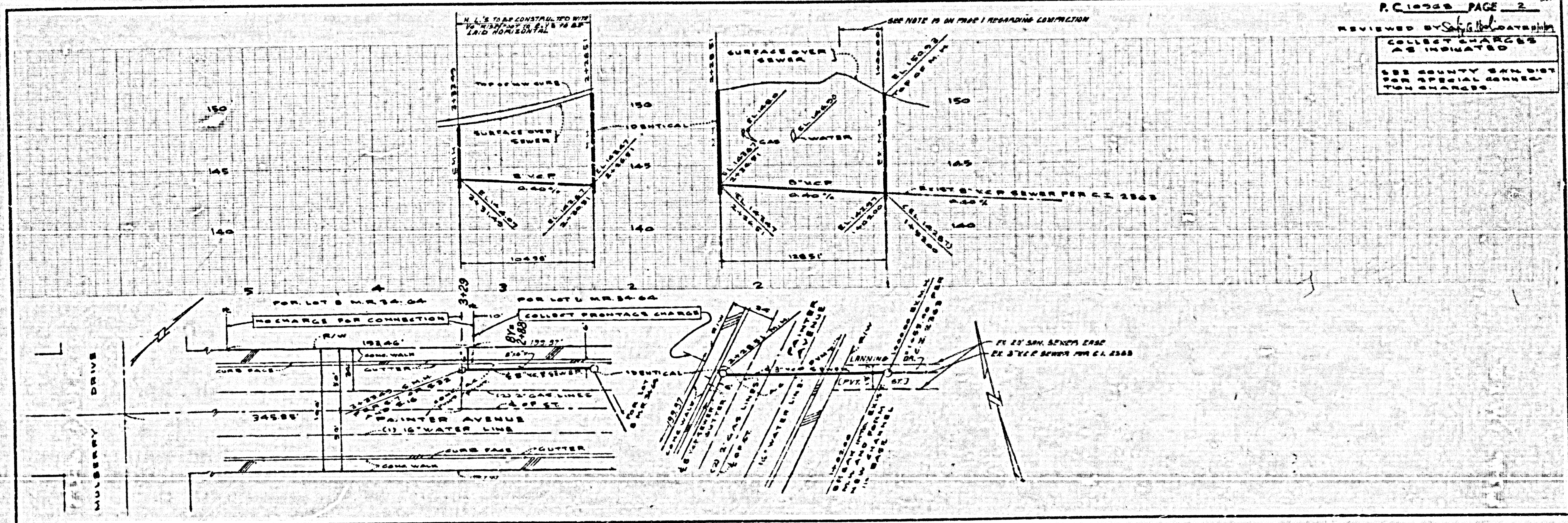

P.C. 10968 PAGE 2
 REVIEWED BY: *[Signature]*
 COLLECT CHARGES AS INDICATED
 SEE COUNTY SANITATION DISTRICT SPECIAL CONNECTION CHARGES