

**DOUBLE SCALE**

REVISION NO. 1 DATE: 2-7-90  
 REVISED HORIZONTAL AND VERTICAL ALIGNMENT BETWEEN STA. 11+170 TO STA. 13+50.0 DUE TO WATER MAIN ALIGNMENT.  
 APPROVED: Saul G. Bal 2-8-90  
 DEPT. OF PUBLIC WORKS

- GENERAL NOTES:**
- ELEVATIONS ARE IN FEET ABOVE U.S.C. & G.S. SEA LEVEL DATUM OF 1929.
  - NO REVISIONS SHALL BE MADE IN THESE PLANS WITHOUT THE APPROVAL OF THE DIRECTOR OF PUBLIC WORKS.
  - NO REPRESENTATIVE OF THE DEPARTMENT OF PUBLIC WORKS SHALL SURVEY OR LAY OUT ANY PORTION OF THE WORK.
  - GRADY TO WHICH THIS IMPROVEMENT IS TO BE CONSTRUCTED SHALL BE SHOWN ON ALL SHOTS AND PROFILES AS MADE FROM THE POINT OF CURVE CENTERLINE OR FROM THE POINT OF BEGINNING OF CURVE OR FROM THE POINT OF TANGENCY TO THE STRAIGHT LINE UNLESS OTHERWISE NOTED.
  - THE PRIVATE ENGINEER SHALL FURNISH THE DEPARTMENT OF PUBLIC WORKS WITH GRADE SHEETS AND STATIONING FOR ALL HOUSE LATERALS AND 12" OR 16" BRANCHES AND SHALL PROVIDE STAKES FOR THEM IN ACCORDANCE WITH THE STANDARD SPECIFICATIONS FOR PUBLIC WORKS. ALL HOUSE LATERALS SHALL BE CONSTRUCTED WITH A MINIMUM COVER OF 48" UNLESS OTHERWISE NOTED. ALL BRANCHES SHALL BE CONSTRUCTED WITH A MINIMUM COVER OF 36" UNLESS OTHERWISE NOTED. ALL BRANCHES SHALL BE CONSTRUCTED WITH A MINIMUM COVER OF 36" UNLESS OTHERWISE NOTED.
  - THE PRIVATE ENGINEER SHALL FURNISH THE HOUSE LATERAL DEPTH AT THE PROPERTY LINE BELOW THE TOP OF CURB ELEVATION FOR EACH HOUSE LATERAL ON THE GRADE SHEET.
  - IF ANY PORTION OF THIS PLAN IS TO BE CONSTRUCTED IN AN AREA WHERE THE DEPARTMENT OF PUBLIC WORKS HAS JURISDICTION OVER THE CONSTRUCTION OF PUBLIC WORKS, THE PRIVATE ENGINEER SHALL OBTAIN FROM THE DEPARTMENT OF PUBLIC WORKS A PERMIT FOR THE CONSTRUCTION OF PUBLIC WORKS. THE PERMIT SHALL BE OBTAINED FROM THE DEPARTMENT OF PUBLIC WORKS, 100 S. FREEMONT AVE., ALHAMBRA, CALIFORNIA 91801. THE PERMIT FEE IS \$100.00 PER 100 LINEAL FEET OF CONSTRUCTION. THE PERMIT SHALL BE OBTAINED FROM THE DEPARTMENT OF PUBLIC WORKS, 100 S. FREEMONT AVE., ALHAMBRA, CALIFORNIA 91801. THE PERMIT FEE IS \$100.00 PER 100 LINEAL FEET OF CONSTRUCTION.
  - IF WORK IS TO BE DONE IN A STATE HIGHWAY RIGHT-OF-WAY, THE PRIVATE ENGINEER SHALL OBTAIN FROM THE STATE OF CALIFORNIA DIVISION OF HIGHWAYS, 1200 T STREET, LOS ANGELES, CALIFORNIA, A PERMIT TO CONSTRUCT WORK IN A STATE HIGHWAY RIGHT-OF-WAY. THE PERMIT FEE IS \$100.00 PER 100 LINEAL FEET OF CONSTRUCTION.
  - APPROVAL OF THIS PLAN BY THE COUNTY OF LOS ANGELES DOES NOT CONSTITUTE A REPRESENTATION AS TO THE ACCURACY OF THE LOCATION OF OR THE EXISTENCE OR NON-EXISTENCE OF ANY UNDERGROUND UTILITY PIPE OR STRUCTURE WITHIN THE LIMITS OF THIS PROJECT. THIS NOTE APPLIES TO ALL PAGES.
  - REFER TO SECTION 7.10.1 OF THE STANDARD SPECIFICATIONS REGARDING SAFETY ORDERS.
  - FOR THE PURPOSES OF THE STANDARD SPECIFICATIONS REGARDING SAFETY ORDERS, THE CONTRACTOR SHALL OBTAIN AND FILE WITH THE DEPARTMENT OF PUBLIC WORKS A PERMIT FOR THE CONSTRUCTION OF PUBLIC WORKS. THE PERMIT SHALL BE OBTAINED FROM THE DEPARTMENT OF PUBLIC WORKS, 100 S. FREEMONT AVE., ALHAMBRA, CALIFORNIA 91801. THE PERMIT FEE IS \$100.00 PER 100 LINEAL FEET OF CONSTRUCTION.
  - ALL STRUCTURES SHALL BE EITHER BRICK SEWER MANHOLES PER 3-0 OR PRECAST CONCRETE SEWER MANHOLES PER 3-0 EXCEPT AS NOTED.
  - PRECAST STAKES ON THE PROPERTY LINE OR PROPERTY LINES PRODUCED AT RIGHT ANGLES TO THE SEWER LINE AT THE CENTER LINE OF EACH MANHOLE.
  - MANHOLE TOPS IN UNIMPROVED RIGHTS OF WAY TO BE 24" HIGHER ABOVE FINISHED GRADE.
  - INTERFACED JOINT JOINTS SHALL BE 7/8" OR 1" PER STANDARD SPECIFICATIONS SECTION 200-2.
  - IF A POWER POLE IS WITHIN THREE FEET OF THE SEWER, THE SEWER SHALL BE ENCASED PER 3-0. CASE II TWO FEET ON EACH SIDE FROM THE POINT OF INTERFERENCE.
  - IF DURING THE COURSE OF CONSTRUCTION IT IS DETERMINED THAT THERE IS LESS THAN FOUR FEET OF COVER OVER THE TOP OF MAIN LINE OR HOUSE LATERAL, 12" OR 16" SEWER WHICH IS NOT INDICATED ON THE PLANS, THE PIPE SHALL BE ENCASED PER 3-0. CASE II UNLESS OTHERWISE APPROVED BY THE DIRECTOR OF PUBLIC WORKS.
  - ALL JOINTS BETWEEN CAST IRON PIPE AND INTERFACED JOINTS SHALL BE MADE WITH A RUBBER SLEEVE JOINT, TYPE "C" OR "D" PER STANDARD SPECIFICATIONS SECTION 200-2.
  - SEWERS TO BE TESTED FOR LEAKAGE PER SECTION 200-1.4 OF THE STANDARD SPECIFICATIONS AND SPECIAL PROVISIONS.
  - RESURFACE ALL TRENCHES WITHIN PAVED AREAS TO MEET LOS ANGELES COUNTY PUBLIC WORKS OR CALIFORNIA STATE HIGHWAY REQUIREMENTS IN ACCORDANCE WITH PERMITS.
  - FULL COMPLIANCE WITH SECTION 18.0 OF THE STANDARD SPECIFICATIONS SHALL BE REQUIRED FOR BACKFILL IN STREETS. CERTIFICATION OF BACKFILL COMPLETION AND SAND SOURCE TESTS BY A QUALIFIED TESTING LABORATORY SHALL BE PROVIDED BY THE PERMITTEE PRIOR TO THE ISSUANCE OF A CERTIFICATE OF FINISH ACCEPTANCE.
  - SPECIAL BACKFILL IN EXISTING CONSTRUCTION IS BACKFILL TRENCH AND REPLACE OTHER EARTH SO AS TO ACHIEVE THE NATURAL OR FINISHED GRADE AND SO TO SHOW ON THE GRADING PLAN APPROVED FOR THIS PROJECT BY THE LAND DEVELOPMENT DIVISION OF THE COUNTY OF LOS ANGELES. ALL BACKFILL SHALL BE COMPACTED TO A MINIMUM OF 95% OF MAXIMUM DENSITY PER S.T.D. METHOD OF TESTS AS IT IS ACCEPTED ACCEPTABLE CERTIFICATION OF BACKFILL COMPLETION SHALL BE SUBMITTED TO THE CONSTRUCTION DIVISION OF PUBLIC WORKS DEPARTMENT.

PROFILE, ALIGNMENT AND GRADE OF  
**SANITARY SEWERS**  
 TO BE CONSTRUCTED IN  
**CANWOOD STREET**  
 PRIVATE CONTRACT NO. 10988  
 INDEX C-230  
 1 SHEET OF 2 PAGES  
 53377

SCALE: HORIZ. 1" = 40' VERT. 1" = 4'  
 AUGUST, 1989  
 PREPARED IN THE OFFICES OF  
 H. NAJEMI  
 2122 MONTE ROYAL DR. CHINO HILL, CA, 91709  
 BY: H. NAJEMI 8-9-89 TEL: (714) 628-5863  
 REV. C.E. NO. 0844157

THE FOLLOWING LATEST REVISED STANDARD PLANS ON FILE IN THE OFFICE OF THE DEPARTMENT OF PUBLIC WORKS SHALL APPLY IN THE CONSTRUCTION OF THIS PROJECT:

LEGEND	0-1
MINIMUM PUBLIC SAFETY REQUIREMENTS	0-2
BRICK MANHOLE	0-3
STANDARD MANHOLE STEP	0-4
BRICKWORK FOR SEWER PIPE	0-5
GRAVELING AND ENCASEMENT	0-6
PIPE ON THE SUPPORT	0-7
ALLOWABLE TRENCH WIDTHS	0-8
LOCKING MANHOLE FRAME AND COVER	0-9
MIN. REINFORCED PRECAST CONCRETE MANHOLE	0-10

COUNTY OF LOS ANGELES, CALIFORNIA  
 THOMAS A. TIDEMANSON  
 DIRECTOR OF PUBLIC WORKS

CITY OF AGOURA HILLS  
James E. Colbaugh 11/28/89  
 CITY ENGINEER

APPROVED: Dean E. Johnson 11/28/89  
 CITY ENGINEER

CHECKED: James E. Colbaugh 11/28/89  
 CITY ENGINEER

REG. NO. 18116  
 CALABASAS BLDG. DIST. 91 DIRECTOR OF PLANNING AND ENGINEERING

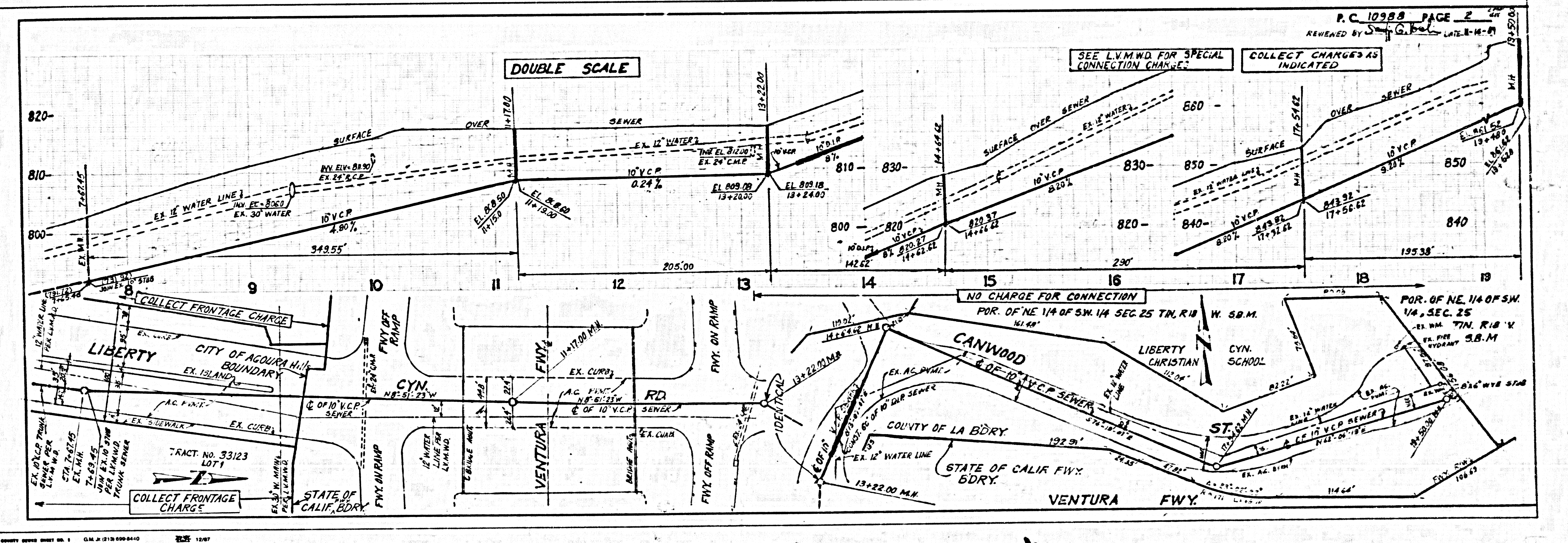

8801 BC  
 CANWOOD ST