

S.M. CT 3047 ELEV. 45.248
 21" DOWN, 2' WEST OF WESTERLY
 CATCH BASIN, 1ST 3 OF CARSON ST.
 1/2" W. OF NORMANDE AVENUE
 BARCELA QUAD. 19 BC.

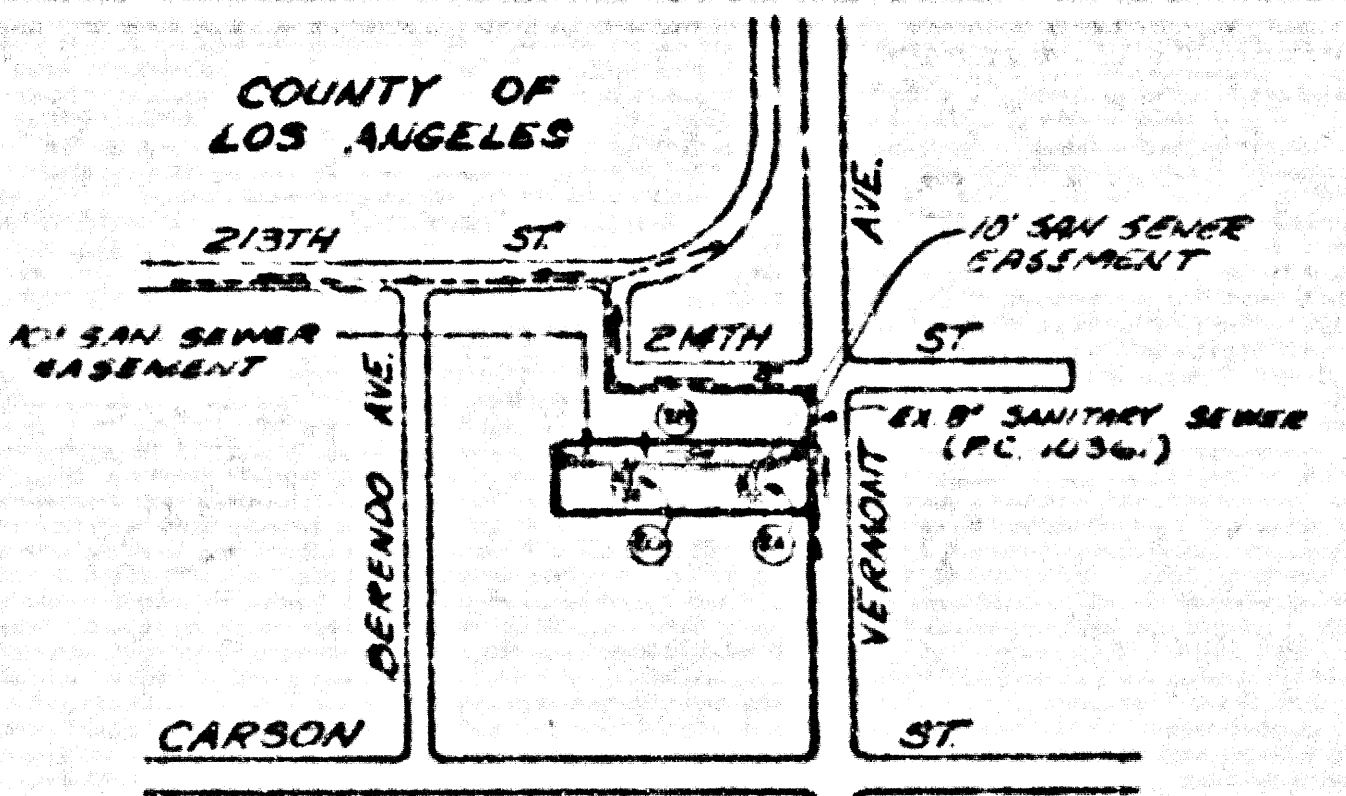

NOTE: ALIASES IN CIRCLES INDICATE PAGE NUMBERS.
 INDEX MAP
 SCALE: 1" = 600'
 TRACT NO. 46525
 PC 11053
 THOMAS GUIDE PAGE 68-F4

NO CONNECTION FOR THE DISPOSAL OF INDUSTRIAL WASTES SHALL BE MADE TO SEWERS SHOWN ON THESE DRAWINGS UNTIL A PERMIT FOR INDUSTRIAL WASTEWATER DISCHARGE HAS BEEN ISSUED BY THE SANITATION DISTRICTS FOR SAID CONNECTION.
 BEFORE BREAKING INTO OR CONSTRUCTION ON A COUNTY SANITATION DISTRICT SEWER AND PRIOR TO FINAL ACCEPTANCE OF THE PROJECT, SANITATION DISTRICT INSPECTOR SHALL BE NOTIFIED BY PHONE (213) 638-1161 SO THAT REQUIRED INSPECTION CAN BE MADE.

PLAN REVISION NOTE:
 REVISION NO. DATE
 1. DELETE PAGES #3 & #4.
 2. TRANSFER #6 TO #2.C.
 3. EXTEND MAIN LINE SEWER TO STA. 0+99.00
 4. RELOCATE HOUSE LATERALS
 5. CHANGE GRADE FROM 25.11 TO 25.00 THROUGH STA. 3+76.00 TO 4+81.00
 APPROVED: *Sandy G. Balala* 1/19/90
 CHIEF OF PUBLIC WORKS

GENERAL NOTES:

1. A STATE CONSTRUCTION PERMIT SHALL BE OBTAINED AND A PERMITS FEE FOR CONSTRUCTION INSPECTION AND THE PERMITS FEE TO THE DEPARTMENT OF PUBLIC WORKS SHALL BE PAID TO THE COUNTY ENGINEER AND THE PERMITS FEE TO THE COUNTY ENGINEER SHALL BE PAID TO THE COUNTY ENGINEER.
2. PERMITS TO EXCAVATE SHALL BE OBTAINED FROM THE COUNTY ENGINEER AND THE PERMITS FEE SHALL BE PAID TO THE COUNTY ENGINEER.
3. PERMITS TO EXCAVATE SHALL BE OBTAINED FROM THE COUNTY ENGINEER AND THE PERMITS FEE SHALL BE PAID TO THE COUNTY ENGINEER.
4. PERMITS TO EXCAVATE SHALL BE OBTAINED FROM THE COUNTY ENGINEER AND THE PERMITS FEE SHALL BE PAID TO THE COUNTY ENGINEER.
5. PERMITS TO EXCAVATE SHALL BE OBTAINED FROM THE COUNTY ENGINEER AND THE PERMITS FEE SHALL BE PAID TO THE COUNTY ENGINEER.
6. PERMITS TO EXCAVATE SHALL BE OBTAINED FROM THE COUNTY ENGINEER AND THE PERMITS FEE SHALL BE PAID TO THE COUNTY ENGINEER.
7. PERMITS TO EXCAVATE SHALL BE OBTAINED FROM THE COUNTY ENGINEER AND THE PERMITS FEE SHALL BE PAID TO THE COUNTY ENGINEER.
8. PERMITS TO EXCAVATE SHALL BE OBTAINED FROM THE COUNTY ENGINEER AND THE PERMITS FEE SHALL BE PAID TO THE COUNTY ENGINEER.
9. PERMITS TO EXCAVATE SHALL BE OBTAINED FROM THE COUNTY ENGINEER AND THE PERMITS FEE SHALL BE PAID TO THE COUNTY ENGINEER.
10. PERMITS TO EXCAVATE SHALL BE OBTAINED FROM THE COUNTY ENGINEER AND THE PERMITS FEE SHALL BE PAID TO THE COUNTY ENGINEER.
11. PERMITS TO EXCAVATE SHALL BE OBTAINED FROM THE COUNTY ENGINEER AND THE PERMITS FEE SHALL BE PAID TO THE COUNTY ENGINEER.
12. PERMITS TO EXCAVATE SHALL BE OBTAINED FROM THE COUNTY ENGINEER AND THE PERMITS FEE SHALL BE PAID TO THE COUNTY ENGINEER.
13. PERMITS TO EXCAVATE SHALL BE OBTAINED FROM THE COUNTY ENGINEER AND THE PERMITS FEE SHALL BE PAID TO THE COUNTY ENGINEER.
14. PERMITS TO EXCAVATE SHALL BE OBTAINED FROM THE COUNTY ENGINEER AND THE PERMITS FEE SHALL BE PAID TO THE COUNTY ENGINEER.

CONSTRUCTION NOTES:

1. PROFILE SURVEY STAKES ON THE ALTERNATE LINE OR PROPERTY LINES PRODUCED AT RIGHT ANGLES TO THE CENTER LINE AT THE CENTER LINE OF EACH MANHOLE.
2. WITHIN CLAY PIPE JOINTS SHALL BE 1/2" OR 3/4" PER STANDARD SPECIFICATIONS SECTION 200-2.
3. A POWER POLE IS WITHIN THREE FEET OF THE SEWER. THE SEWER SHALL BE ENCASED PER STANDARD PLAN 8-28. CASE 1 TWO FEET ON EACH SIDE FROM THE POLE. SEE CONSTRUCTION NOTE 14.
4. ALL JOINTS BETWEEN CAST-IRON PIPE AND VITRIFIED CLAY PIPE SHALL BE MADE WITH A RUBBER SLEEVE JOINT. TYPE "W" WITH BUSHING IF NECESSARY. PER STANDARD SPECIFICATIONS SECTION 200-2.
5. HOUSE LATERALS TO BE CONSTRUCTED WITH 4" DIA. 15' MIN. RISE WITH A 1/2" DIA. 15' MIN. RISE EXCEPT AS NOTED.
6. LIVE OR DEAD BRANCHES MAY BE USED FOR CONNECTIONS TO MANHOLE BRANCH EXCEPT AS NOTED.
7. IN BRANCHING THE COLUMN OF CONSTRUCTION IS TO BE MAINTAINED THAT THERE IS LESS THAN FOUR FEET OF COVER OVER THE TOP OF A MANHOLE OR 10' MIN. LATERAL. I.C.P. SEWER WHICH IS NOT INDICATED IN THE PLANS THE PIPE SHALL BE ENCASED PER STANDARD PLAN 8-28. CASE 1 UNLESS OTHERWISE SPECIFIED BY THE COUNTY OF PUBLIC WORKS.
8. ALL STRUCTURES SHALL BE EITHER BRICK TOWER MANHOLES PER STANDARD PLAN 8-28 OR PRECAST CONCRETE SEWER MANHOLES PER STANDARD PLAN 8-28 OR REINFORCED PRECAST CONCRETE MANHOLE PER STANDARD PLAN 8-28 EXCEPT AS NOTED.
9. REVISION: ALL TRENCHES WITHIN PAVED AREAS TO MEET LOS ANGELES COUNTY PUBLIC WORKS OR CALIFORNIA STATE HIGHWAY REQUIREMENTS AS ACCORDANCE WITH THE PERMITS.
10. FULL COMPLIANCE WITH SECTION 200-1.1 OF THE STANDARD SPECIFICATIONS SHALL BE REQUIRED FOR ALL STREETS, CORRIDORS, AND AREAS OF BACKLASH LUMPING AND SAND COLUMNS SHALL BE CERTIFIED BY A QUALIFIED CIVIL ENGINEER SHALL BE PROVIDED BY THE PERMITTEE PRIOR TO THE START OF A CERTIFICATE OF FINAL ACCEPTANCE.
11. ALL BACKFILL AND FILL OUTSIDE OF STREET RIGHT OF WAY SHALL BE COMPACTED TO 90% OF MAXIMUM DENSITY AS DETERMINED BY THE PROCTOR METHOD. THE BACKFILL SHALL BE CERTIFIED BY A QUALIFIED CIVIL ENGINEER SHALL BE PROVIDED BY THE PERMITTEE PRIOR TO THE START OF A CERTIFICATE OF FINAL ACCEPTANCE.
12. MANHOLE TOPS IN UNIMPROVED AREAS OR TO BE SIX INCHES ABOVE FINISHED GRADE.
13. SEWERS TO BE TESTED FOR LEAKAGE PER SECTION 200-1.4 OF THE STANDARD SPECIFICATIONS AND SPECIAL PROVISIONS.

SANITARY SEWERS

TO BE CONSTRUCTED IN
 TRACT NO. 46525

PRIVATE CONTRACT NO. 11053
 INDEX 1705
 2 SHEETS, 4 PAGES

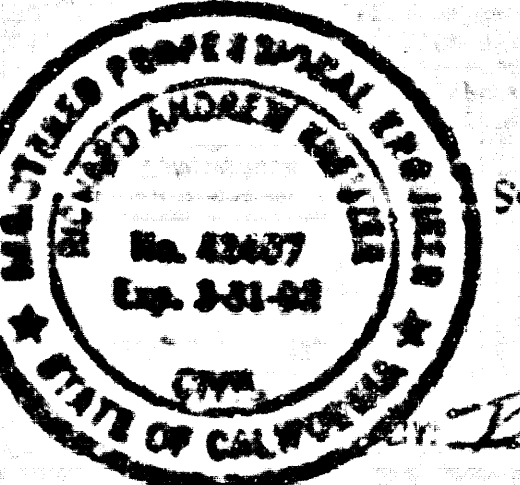

SCALE: HORIZ. 1" = 40' VERT. 1" = 4'
 FEBRUARY 1, 1990
 PREPARED IN THE OFFICES OF
 UMA ENGINEERING INC.
 12762 CUMMINS ST. IRVINE, CA. 92714
 TEL. NO. 714-660-0101
 REG. CE NO. 32202

THE FOLLOWING LATEST REVISED STANDARD PLANS ON FILE IN THE OFFICE OF THE DEPARTMENT OF PUBLIC WORKS SHALL APPLY TO THE CONSTRUCTION OF THIS PROJECT:

LEGEND:	SECTION
MINIMUM PUBLIC SAFETY REQUIREMENTS	8-1
BRICK MANHOLE	8-2
REINFORCED PRECAST CONCRETE MANHOLE	8-3
STANDARD MANHOLE STEP	8-4
REINFORCED CONCRETE PIPE	8-5
LANDING AND ENCASMENT	8-6
PIPE OR PIPE SUPPORT	8-7
RELOCABLE FRENCH BRUSHING	8-8
LOCKING MANHOLE FRAME AND COVER	8-9
NON-REINFORCED PRECAST CONCRETE MANHOLE	8-10

COUNTY OF LOS ANGELES, CALIFORNIA

THOMAS A. TIDEMANSON
 DIRECTOR OF PUBLIC WORKS
 APPROVED: *Dean F. Holman* 1/19/90
 CHECKED: *Sandy G. Balala* 1/19/90
 REG. CE NO. 18116
 DATE
 LOMITA BLDG. DIST. 12

CHARLES W. CARRY
 CHIEF ENGINEER
 GO. ENGINEER NO. 5087
 APPROVED: *Charles W. Carry* 1/19/90
 CHECKED: *Charles W. Carry* 1/19/90
 DATE

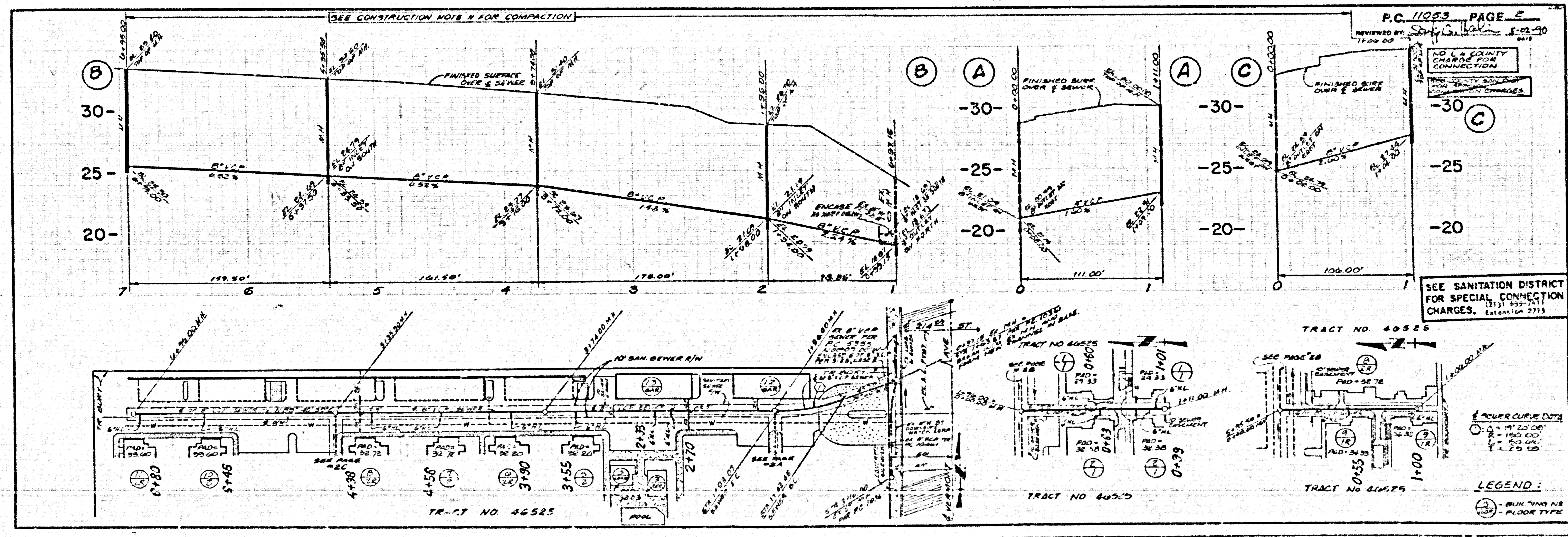

P.C. 11053 PAGE 2
 REVIEWED BY: *Sandy G. Balala* 1/19/90
 DATE

NO L.A. COUNTY CHARGE FOR CONNECTION
 SPECIAL CHARGES

SEE SANITATION DISTRICT FOR SPECIAL CONNECTION CHARGES.
 Extension 2713

TRACT NO. 46525

TRACT NO. 46525

TRACT NO. 46525

LEGEND:
 BLDG. TYPE AND FLOOR TYPE