

B.M. CG 9440 ELEV. 322.396
 C.E. 2 1/4" HIGH IN WELL 1 FT BK TO W. C.B. @
 D.T. 30 BCF @ 4" IN. COB SAN GABRIEL BLVD
 @ BLEWET ST 43 FT W @ 43.10 C/L. INT. HAD
 C.B.M. 1 - 24 C. 1970 RE 28663
 BASELINE QUAD. 1975.

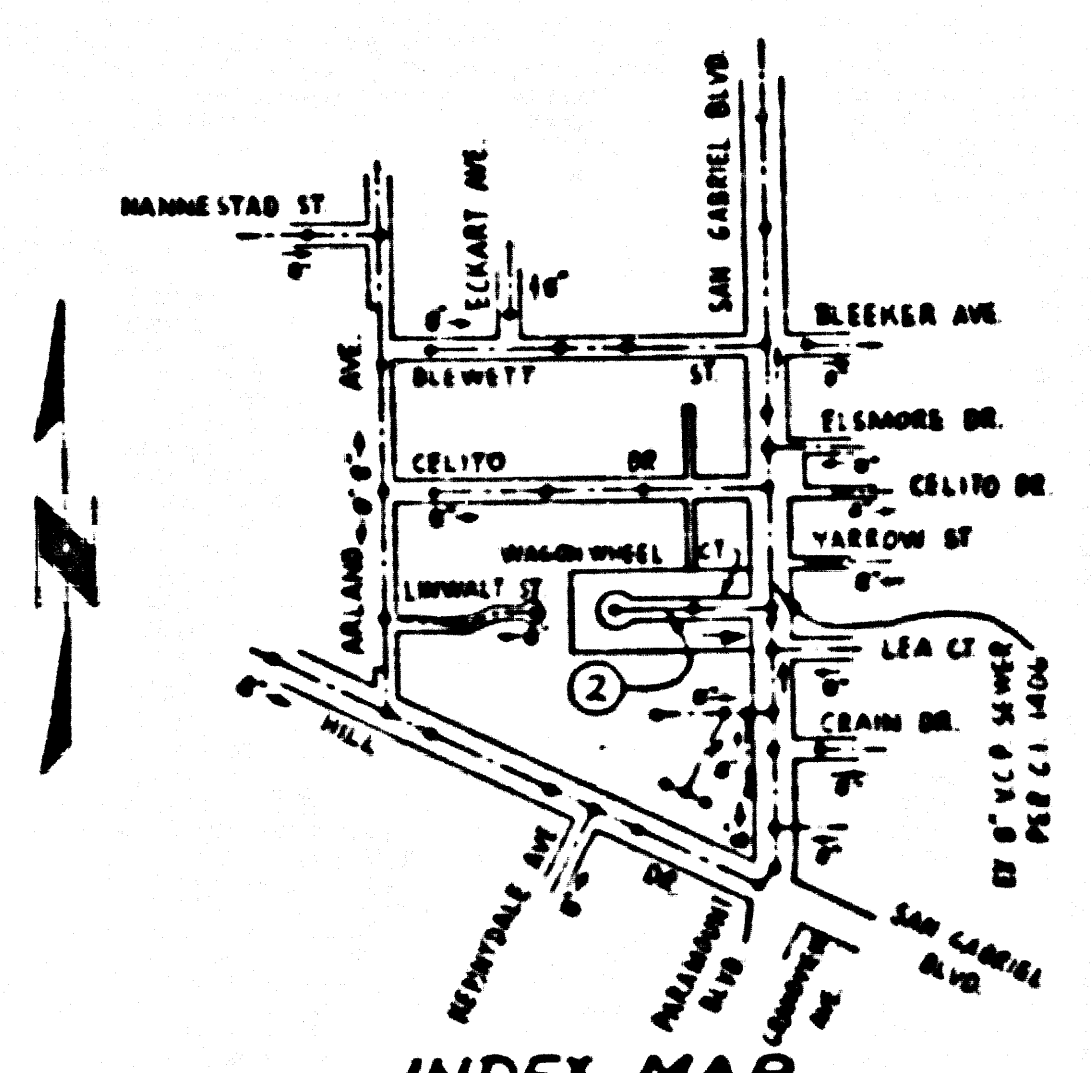

INDEX MAP
 P.C. 11108 TRACT NO. 48064
 SCALE 1"=600'
 T6 PG. 46-F3

NOTE:
 NUMBER IN CIRCLE INDICATES PAGE NUMBER

PRIVATE ENGINEER'S NOTICE TO CONTRACTORS

THE EXISTENCE AND LOCATION OF ANY UNDERGROUND UTILITY PIPES OR STRUCTURES SHOWN ON THESE PLANS ARE OBTAINED BY A SEARCH OF THE AVAILABLE RECORDS TO THE BEST OF OUR KNOWLEDGE. THERE ARE NO EXISTING UTILITIES EXCEPT AS SHOWN ON THESE PLANS. THE CONTRACTOR IS REQUIRED TO TAKE DUE PRECAUTIONARY MEASURES TO PROTECT THE UTILITY LINES SHOWN AND ANY OTHER LINES NOT OF RECORD OR NOT SHOWN ON THESE PLANS. THE CONTRACTOR SHALL BE RESPONSIBLE FOR NOTIFYING "UNDERGROUND SERVICE ALERT" AT 1-800-442-4133 TWO WORKING DAYS PRIOR TO ANY EXCAVATION OR CONSTRUCTION.

Catherine O'Brien
 REGISTERED ENGINEER E.E.C. NO. 34185

CONSTRUCTION NOTES CONT.

- 17 MANHOLE WATER STOP GASKETS AND CLAMPS ARE REQUIRED FOR THE CONNECTION OF 8" A.B.S. COMPOSITE PIPE TO MANHOLE STRUCTURES.
- 18 A.B.S. SOLID WALL PIPE MUST BE USED FOR WTE AND HOUSE LATERAL CONNECTIONS TO A.B.S. COMPOSITE MANHOLE JUNE PIPE.
- 19 A.B.S. COMPOSITE PIPE SHALL BE BEDDED IN CONFORMANCE WITH THE TABLE IN SECTION B-31 OF PART II OF THE SPECIAL PROVISIONS.
- 20 THREE DEGREE DEFLECTION COUPLERS ARE REQUIRED FOR RADII OF CURVATURE LESS THAN 380 FEET WHEN USING 8" A.B.S. COMPOSITE PIPE.
- 21 NO CONNECTION FOR DISPOSAL OF INDUSTRIAL WASTE IS ALLOWED IF A.B.S. COMPOSITE PIPE IS USED.
- 22 ALL WYES AND/OR HOUSE LATERALS ARE TO BE LOCATED AT LEAST FIVE FEET APART AND WHEN POSSIBLE NOT CLOSER THAN FIVE FEET TO ANY MANHOLE.

NO CONNECTION FOR THE DISPOSAL OF INDUSTRIAL WASTES SHALL BE MADE TO SEWERS SHOWN ON THESE DRAWINGS UNTIL A PERMIT FOR INDUSTRIAL WASTEWATER DISCHARGE HAS BEEN ISSUED BY THE SANITATION DISTRICTS FOR SAID CONNECTION.

BEFORE BREAKING INTO OR CONSTRUCTION ON A COUNTY SANITATION DISTRICT SEWER AND PRIOR TO FINAL ACCEPTANCE OF THE PROJECT, SANITATION DISTRICT INSPECTOR SHALL BE NOTIFIED BY PHONE (818) 962-8605 SO THAT REQUIRED INSPECTION CAN BE MADE.

GENERAL NOTES: DOUBLE SCALE

1. ALL WORK CONSTRUCTION PERMIT SHALL BE OBTAINED WITH A FEE AND ALL CONSTRUCTION AND RECORD PLANS TO THE DEPARTMENT OF PUBLIC WORKS AT THE COUNTY OFFICE AND TO THE SANITATION DISTRICTS. THE CONTRACTOR SHALL BE RESPONSIBLE FOR NOTIFYING "UNDERGROUND SERVICE ALERT" AT 1-800-442-4133 TWO WORKING DAYS PRIOR TO ANY EXCAVATION OR CONSTRUCTION.
2. PRIOR TO SUBMITTAL OF ANY PERMIT THE CONTRACTOR SHALL FILE A PERMIT FOR EXCAVATION AND TRENCHING FROM THE STATE OF CALIFORNIA TO PROTECT THE SAFETY AND CERTAINTY OF BURIED UTILITIES. THE PERMIT SHALL BE FILED WITH THE DEPARTMENT OF PUBLIC WORKS AND THE COUNTY ENGINEER. THE CONTRACTOR SHALL BE RESPONSIBLE FOR NOTIFYING "UNDERGROUND SERVICE ALERT" AT 1-800-442-4133 TWO WORKING DAYS PRIOR TO ANY EXCAVATION OR CONSTRUCTION.
3. WORK IS TO BE DONE IN A STATE MANNER A PERMIT MUST BE OBTAINED FROM THE STATE OF CALIFORNIA DIVISION OF HIGHWAYS FOR SOUTH SPRING STREET FOR SHOULDER CONSTRUCTION.
4. WHEN WORK IS TO BE DONE IN A CONTRACT CITY, THE CONTRACTOR MUST CONTACT THE DIRECTOR OF PUBLIC WORKS OF THAT CITY TO DETERMINE THE LOCATION TO BE THE INSPECTION FEE.
5. THE CONTRACTOR SHALL CONTACT THE COUNTY OFFICE LISTED ON THE APPLICATION FOR CONSTRUCTION PERMIT TO ARRANGE FOR ALL NECESSARY UTILITIES LOCATIONS AND SHALL NOTIFY THE COUNTY ENGINEER BY TELEPHONE (818) 962-8605 AT LEAST TWENTY-FOUR HOURS BEFORE STARTING ANY WORK UNDER THIS CONTRACT.
6. APPROVAL OF THIS PLAN BY THE COUNTY OF LOS ANGELES DOES NOT CONSTITUTE A REPRESENTATION AS TO ACCURACY OF THE LOCATION OF THE UTILITIES OR THE PRESENCE OF ANY UNDERGROUND UTILITY PIPE OR STRUCTURE WITHIN THE LIMITS OF THIS PROJECT. THIS NOTE APPLIES TO ALL PAGES.
7. ALL WORK SHALL BE IN ACCORDANCE WITH THE STANDARD SPECIFICATIONS FOR PUBLIC WORKS CONSTRUCTION FROM THE COUNTY OF LOS ANGELES. THE CONTRACTOR SHALL BE RESPONSIBLE FOR NOTIFYING "UNDERGROUND SERVICE ALERT" AT 1-800-442-4133 TWO WORKING DAYS PRIOR TO ANY EXCAVATION OR CONSTRUCTION.
8. THE CONTRACTOR'S OPERATION IS DIRECTED TO SECTION 101 OF THE STANDARD SPECIFICATIONS FOR PUBLIC WORKS CONSTRUCTION. THE CONTRACTOR SHALL BE RESPONSIBLE FOR NOTIFYING "UNDERGROUND SERVICE ALERT" AT 1-800-442-4133 TWO WORKING DAYS PRIOR TO ANY EXCAVATION OR CONSTRUCTION.
9. ELEVATIONS ARE IN FEET ABOVE U.S.C. & G.S. SEA LEVEL DATUM OF 1989.
10. NO REVISIONS SHALL BE MADE IN THESE PLANS WITHOUT THE APPROVAL OF THE DIRECTOR OF PUBLIC WORKS.
11. NO REPRESENTATIVE OF THE DEPARTMENT OF PUBLIC WORKS WILL SURVEY OR LAY OUT ANY PORTION OF THE WORK.
12. GRADES TO WHICH TO APPROXIMATE TO BE CONSTRUCTED ARE SHOWN ON PLANS AND PROFILES. GRADE POINTS FOR TOP OF CURBS, CENTERLINE OF STREETS OR CENTERLINE OF ALL LINES SHOWN ON PLANS SHALL BE IN FEET AND INCHES TO TWO DECIMAL PLACES. THE GRADE SHALL BE ESTABLISHED AS TO CONFORM TO A STRAIGHT LINE DRAWN BETWEEN SAID GRADE POINTS.
13. THE CONTRACTOR SHALL FURNISH THE DEPARTMENT OF PUBLIC WORKS WITH GRADE SHEETS AND STATIONING FOR ALL WORK UNDER THIS CONTRACT. THE CONTRACTOR SHALL BE RESPONSIBLE FOR NOTIFYING "UNDERGROUND SERVICE ALERT" AT 1-800-442-4133 TWO WORKING DAYS PRIOR TO ANY EXCAVATION OR CONSTRUCTION.
14. THE PRIVATE ENGINEER SHALL FURNISH THE HOUSE LATERAL DEPTH AT THE PROPERTY LINE BELOW THE TOP CURB ELEVATION FOR EACH HOUSE LATERAL ON THE GRADE SHEET.

CONSTRUCTION NOTES:

1. PROVIDE SLOPED STAIRS ON THE PROPERTY LINE OR PROPERTY LINES PRODUCED AT RIGHT ANGLES TO THE SEWER LINE AT THE CENTERLINE OF EACH MANHOLE.
2. INTERFACED CLAY PIPE JOINTS SHALL BE FIVE (5) OR 10" PER STANDARD SPECIFICATIONS SECTION 800-2.
3. IF A POWER POLE IS WITHIN THREE FEET OF THE SEWER, THE SEWER SHALL BE ENCASED PER STANDARD PLAN 9-2. CASE H TWO FEET ON EACH SIDE FROM THE POINT OF INTERFERENCE.
4. JOINTS BETWEEN CAST IRON PIPE AND INTERFACED CLAY PIPE SHALL BE MADE WITH A RUBBER SLIP JOINT. FIVE (5) INCHES BUSHING IS NECESSARY PER STANDARD SPECIFICATIONS SECTION 800-2.
5. HOUSE LATERALS TO BE CONSTRUCTED WITH INVERTS AT THE PROPERTY LINE 8 FEET BELOW CURB GRADE EXCEPT AS NOTED.
6. PIPE OR FITTINGS MAY BE USED FOR CONNECTIONS TO MANHOLE SEWERS EXCEPT AS NOTED.
7. IF DURING THE COURSE OF CONSTRUCTION IT IS DETERMINED THAT THERE IS LESS THAN FOUR FEET OF COVER OVER THE TOP OF A MANHOLE OR HOUSE LATERAL, A 36" DEGREE BENT SHALL BE LOCATED ON THE PLANS. THE PIPE SHALL BE ENCASED PER STANDARD PLAN 9-2. CASE H UNLESS OTHERWISE APPROVED BY THE DIRECTOR OF PUBLIC WORKS.
8. ALL STRUCTURES SHALL BE OTHER BRICK SEWER MANHOLES PER STANDARD PLAN 9-2 OR PRECAST CONCRETE. WTE MANHOLES PER STANDARD PLAN 9-2 OR UNREINFORCED PRECAST CONCRETE MANHOLES PER STANDARD PLAN 9-2 EXCEPT AS NOTED.
9. REINFORCE ALL TRENCHES OTHER THAN SEWERS TO MEET LOS ANGELES COUNTY PUBLIC WORKS OR CALIFORNIA STATE HIGHWAY REQUIREMENTS IN ACCORDANCE WITH THE PERMITS.
10. FULL COVER UNLESS OTHERWISE NOTED PER SECTION 800-2 OF THE STANDARD SPECIFICATIONS. PERMITS FOR BACKFILL STREET CLOSURE FOR BACKFILL CONTRACTOR AND COUNTY PERMITS FOR QUALIFIED CONTRACTOR ENGINEER SHALL BE PROVIDED BY THE PERMITTEE PRIOR TO THE SUBMITTAL OF A CERTIFICATE OF PERMITS ACCEPTANCE.
11. ALL MANHOLES AND FITTINGS OR STREET RIGHTS OF WAY SHALL BE CONSTRUCTED TO 80% OF GRADE OR DEPTH AS DETERMINED BY THE SOIL CONDITIONS TEST TO BE MADE. UNLESS OTHERWISE SPECIFIED, THE SHALL BE 4 FEET BY 4 FEET. ALL FITTINGS SHALL BE 18" DIA. UNLESS OTHERWISE SPECIFIED. THE CONTRACTOR SHALL BE RESPONSIBLE TO THE CONSTRUCTION DIVISION OF THE DEPARTMENT OF PUBLIC WORKS PRIOR TO ACCEPTANCE OF THE WORK BY THE COUNTY.
12. MANHOLE TRENCH UNREINFORCED RIGHTS OF WAY TO BE 36" MINIMUM ABOVE FINISHED GRADE.
13. SEWERS TO BE TESTED FOR LEAKAGE PER SECTION 800-11 OF THE STANDARD SPECIFICATIONS AND SPECIAL PROVISIONS.

PROFILE ALIGNMENT AND GRADE OF
SANITARY SEWERS
 TO BE CONSTRUCTED IN
TRACT NO. 48064

PAGE 1
 54090

PRIVATE CONTRACT NO. 11108
 INDEX U-32
 1 SHEET ; 2 PAGES

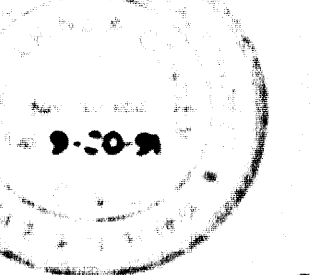

SCALE: HORIZ. 1"=80' VERT. 1"=8'
 JUNE, 1990
 PREPARED IN THE OFFICES OF
 JOHN B. S. BELL
 140 W. ORANGE ST.
 LOS ANGELES, CA 90015 TEL. NO. (818) 915-7671
 BY *Richard L. ...*
 REG. C.E. NO. 34193

THE FOLLOWING LATEST REVISED STANDARD PLANS ON FILE IN THE OFFICE OF THE DEPARTMENT OF PUBLIC WORKS SHALL APPLY IN THE CONSTRUCTION OF THIS PROJECT:

LEAKAGE	9-1
MINIMUM PUBLIC SAFETY REQUIREMENTS	9-2
BRICK MANHOLE	9-3
UNREINFORCED PRECAST CONCRETE MANHOLE	9-4
REINFORCED PRECAST CONCRETE MANHOLE	9-5
REINFORCED PRECAST CONCRETE STEP	9-6
REINFORCED PRECAST CONCRETE STEP	9-7
REINFORCED PRECAST CONCRETE STEP	9-8
CLAY AND INTERFACED CLAY PIPE	9-9
CLAY AND INTERFACED CLAY PIPE	9-10
LOCKING MANHOLE FRAMES AND COVER	9-11
NON-REINFORCED PRECAST CONCRETE MANHOLE	9-12

COUNTY OF LOS ANGELES, CALIFORNIA
 THOMAS A. TIDEMANSON DIRECTOR OF PUBLIC WORKS
 CHARLES W. CARRY CHIEF ENGINEER
 APPROVED: *Thomas Tidemanson* 6/14/90
 APPROVED: *Charles W. Carry* 6/14/90
 CHECKED: *Thomas Tidemanson* 6/14/90
 REG. C.E. NO. 20812
 SAN GABRIEL VALLEY, BLDG. DIST. F

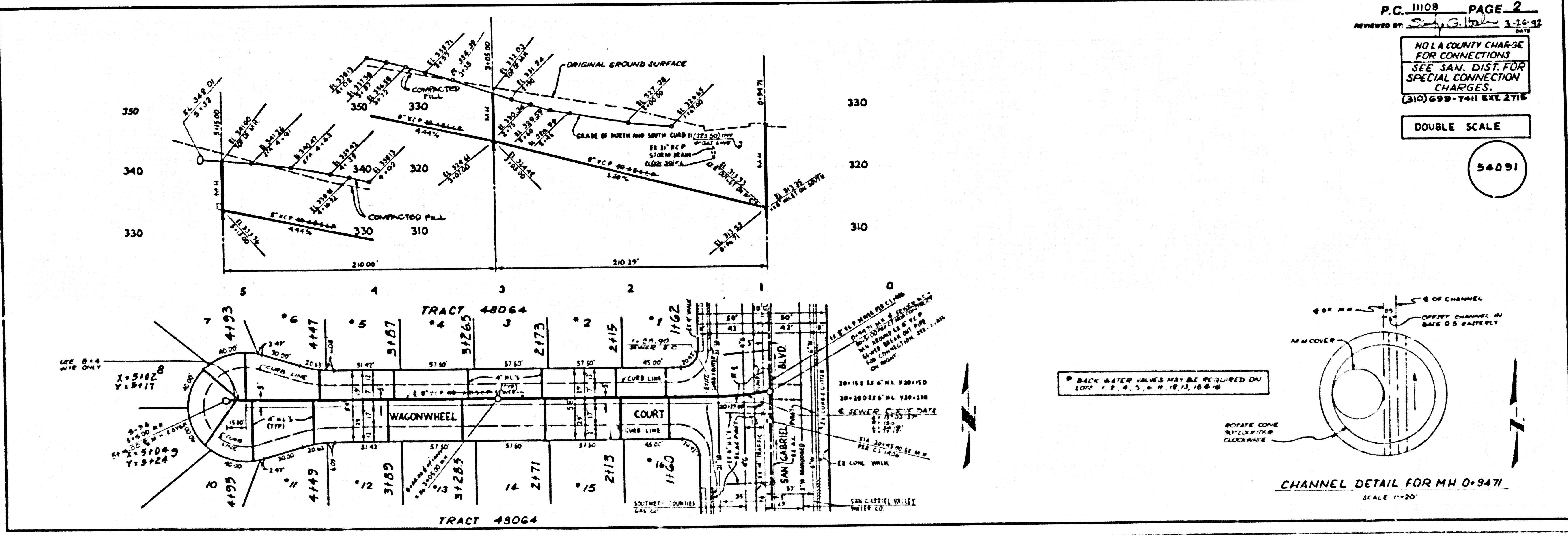

P.C. 11108 PAGE 2
 REVIEWED BY: *Sally Gilman* 6-16-92

NO A COUNTY CHARGE FOR CONNECTIONS
 SEE SAN. DIST. FOR SPECIAL CONNECTION CHARGES.
 (818) 962-7411 EXT. 2716

DOUBLE SCALE
 54091

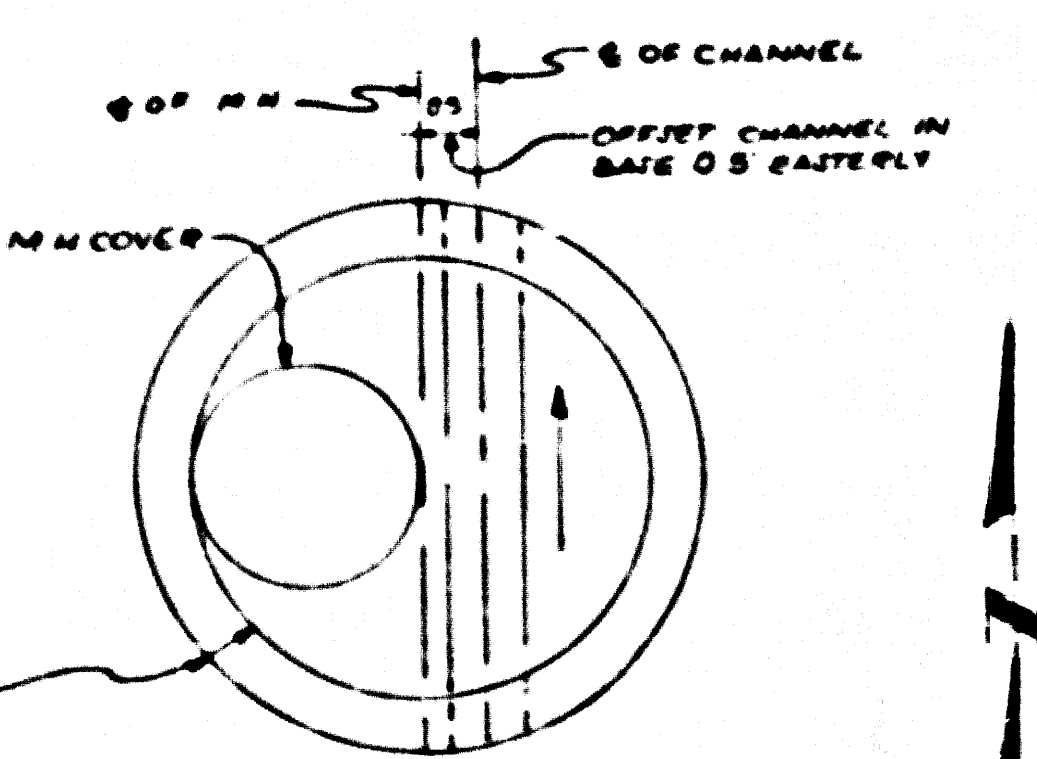

CHANNEL DETAIL FOR MH 0-947
 SCALE 1"=20'

1

BC 11108

48084 ON TRACT