

8.11.26.0000 ELEV. 6410.19  
 1/4" = 10' COVINA VALLEY BLVD. 1/2" SOUTH AND 0.50"  
 MILE EAST OF GRAND AVENUE, 1/2" SOUTH OF PL. MON.  
 MOBILE EAST PROP. LINES OF BUILDINGS NO.  
 22260 VALLEY BOULEVARD  
 COVINA QUAD. 19.25 ADJ.

NO CONNECTION FOR THE DISPOSAL OF INDUSTRIAL WASTES  
 SHALL BE MADE TO SEWERS SHOWN ON THESE DRAWINGS UNTIL  
 A PERMIT FOR INDUSTRIAL WASTEWATER DISCHARGE HAS BEEN  
 ISSUED BY THE SANITATION DISTRICTS FOR SAID CONNECTION.  
 BEFORE BREAKING INTO OR CONSTRUCTION ON A COUNTY  
 SANITATION DISTRICT SEWER AND PRIOR TO FINAL  
 ACCEPTANCE OF THE PROJECT, SANITATION DISTRICT  
 INSPECTORS SHALL BE NOTIFIED BY PHONE (818) 362-2605  
 SO THAT REQUIRED INSPECTION CAN BE MADE.

- GENERAL NOTES:**
1. ELEVATION POINTS ARE IN FEET ABOVE U.S.C. & G.S. SEA LEVEL UNLESS OTHERWISE NOTED.
  2. NO REVISIONS SHALL BE MADE TO THESE PLANS WITHOUT THE APPROVAL OF THE DIRECTOR OF PUBLIC WORKS.
  3. NO REVISIONS OF THE DEPARTMENT OF PUBLIC WORKS SHALL BE MADE ON ANY PART OF THESE PLANS.
  4. ALL WORK SHALL BE CONSTRUCTED IN ACCORDANCE WITH THE STANDARD SPECIFICATIONS FOR PUBLIC WORKS OF THE COUNTY OF LOS ANGELES, CALIFORNIA, 1980 EDITION, LATEST REVISIONS.
  5. THE CONTRACTOR SHALL BE RESPONSIBLE FOR OBTAINING ALL NECESSARY PERMITS FROM THE CITY OF WALNUT, THE CITY OF VALLEY, THE CITY OF INDUSTRY, AND THE COUNTY OF LOS ANGELES.
  6. THE CONTRACTOR SHALL BE RESPONSIBLE FOR OBTAINING ALL NECESSARY PERMITS FROM THE CITY OF WALNUT, THE CITY OF VALLEY, THE CITY OF INDUSTRY, AND THE COUNTY OF LOS ANGELES.
  7. THE CONTRACTOR SHALL BE RESPONSIBLE FOR OBTAINING ALL NECESSARY PERMITS FROM THE CITY OF WALNUT, THE CITY OF VALLEY, THE CITY OF INDUSTRY, AND THE COUNTY OF LOS ANGELES.
  8. THE CONTRACTOR SHALL BE RESPONSIBLE FOR OBTAINING ALL NECESSARY PERMITS FROM THE CITY OF WALNUT, THE CITY OF VALLEY, THE CITY OF INDUSTRY, AND THE COUNTY OF LOS ANGELES.
  9. THE CONTRACTOR SHALL BE RESPONSIBLE FOR OBTAINING ALL NECESSARY PERMITS FROM THE CITY OF WALNUT, THE CITY OF VALLEY, THE CITY OF INDUSTRY, AND THE COUNTY OF LOS ANGELES.
  10. THE CONTRACTOR SHALL BE RESPONSIBLE FOR OBTAINING ALL NECESSARY PERMITS FROM THE CITY OF WALNUT, THE CITY OF VALLEY, THE CITY OF INDUSTRY, AND THE COUNTY OF LOS ANGELES.
  11. THE CONTRACTOR SHALL BE RESPONSIBLE FOR OBTAINING ALL NECESSARY PERMITS FROM THE CITY OF WALNUT, THE CITY OF VALLEY, THE CITY OF INDUSTRY, AND THE COUNTY OF LOS ANGELES.
  12. THE CONTRACTOR SHALL BE RESPONSIBLE FOR OBTAINING ALL NECESSARY PERMITS FROM THE CITY OF WALNUT, THE CITY OF VALLEY, THE CITY OF INDUSTRY, AND THE COUNTY OF LOS ANGELES.

PROFILE ALIGNMENT AND TRADE OF  
**SANITARY SEWERS**  
 TO BE CONSTRUCTED IN  
**VALLEY BOULEVARD**  
**WALNUT MAINT. YARD E/O GRAND AVE**  
**PRIVATE CONTRACT NO. 11156**  
**INDEX U-144**  
**1 SHEET OF 2 PAGES**  
 SCALE: HORIZ. 1" = 40' VERT. 1" = 4'  
 NOVEMBER, 1990  
 PREPARED IN THE OFFICES OF  
**RON KRANZLER & ASSOCIATES, CITY ENGINEER**  
**5924 LAMAR STREET, SUITE 201, WALNUT, CA 91790**  
**BY RONALD L. KRANZLER, CITY ENGINEER**  
 REG. CE NO. 12552  
**Paul Krantzler**  
 CIVIL ENGINEER  
 No. 13503  
 6-30-88  
 STATE OF CALIFORNIA

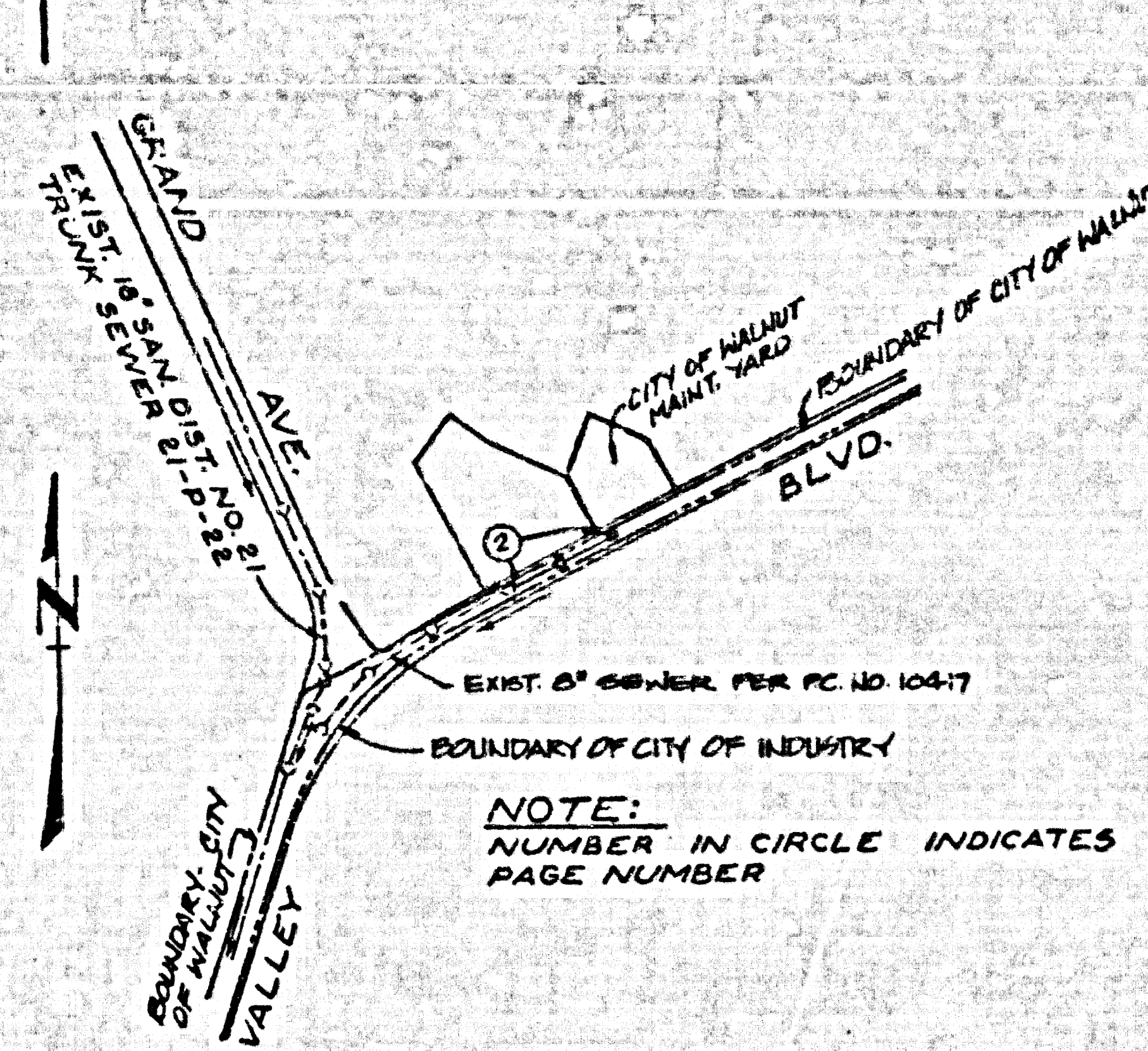

INDEX MAP - SCALE: 1" = 600'  
 PC NO. 11156  
 WALNUT MAINT. YARD - VALLEY BLVD. E/O GRAND AVE.  
 T.G. 93-05

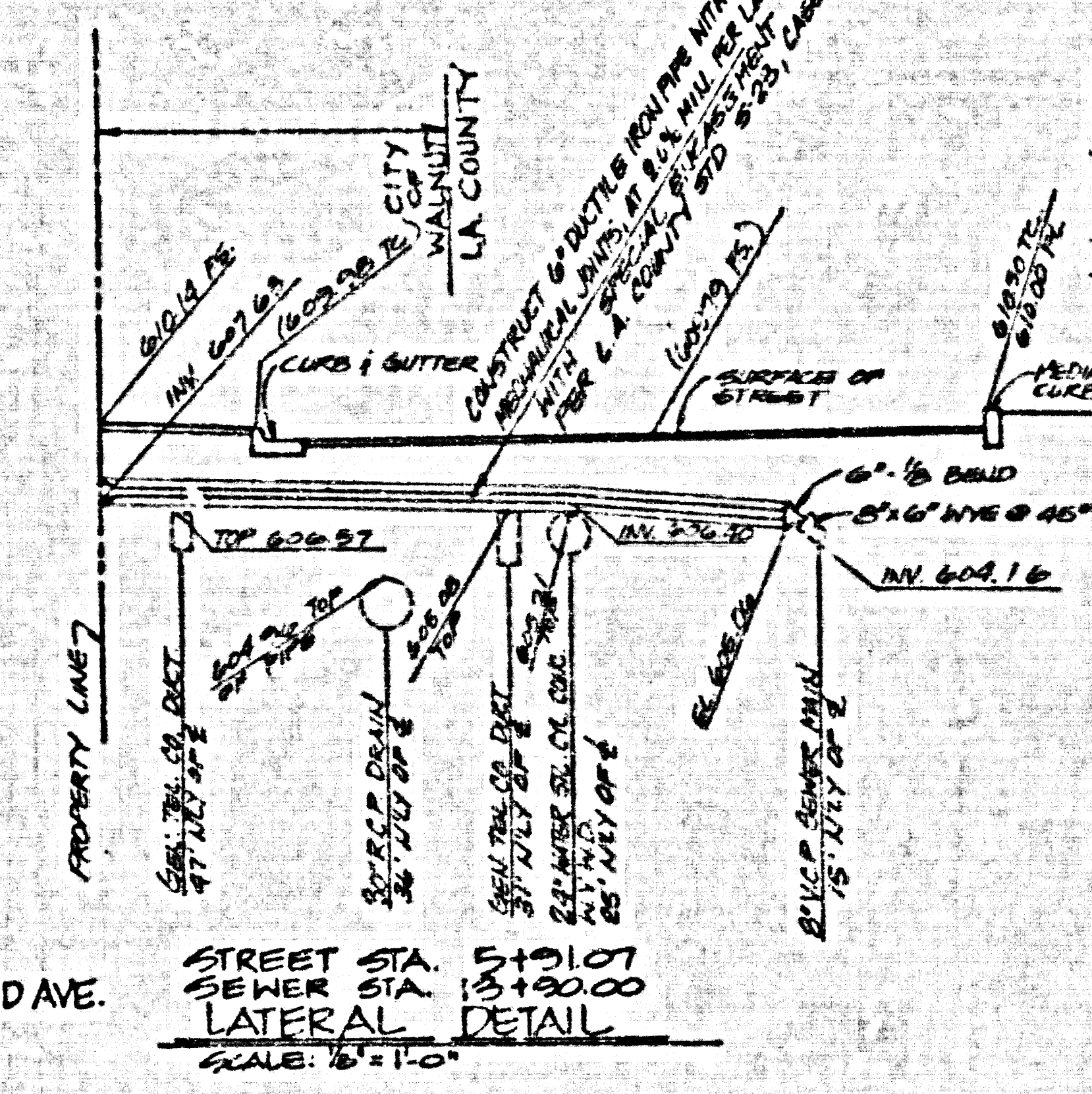

- CONSTRUCTION NOTES:**
1. ALL WORK SHALL BE CONSTRUCTED IN ACCORDANCE WITH THE STANDARD SPECIFICATIONS FOR PUBLIC WORKS OF THE COUNTY OF LOS ANGELES, CALIFORNIA, 1980 EDITION, LATEST REVISIONS.
  2. THE CONTRACTOR SHALL BE RESPONSIBLE FOR OBTAINING ALL NECESSARY PERMITS FROM THE CITY OF WALNUT, THE CITY OF VALLEY, THE CITY OF INDUSTRY, AND THE COUNTY OF LOS ANGELES.
  3. THE CONTRACTOR SHALL BE RESPONSIBLE FOR OBTAINING ALL NECESSARY PERMITS FROM THE CITY OF WALNUT, THE CITY OF VALLEY, THE CITY OF INDUSTRY, AND THE COUNTY OF LOS ANGELES.
  4. THE CONTRACTOR SHALL BE RESPONSIBLE FOR OBTAINING ALL NECESSARY PERMITS FROM THE CITY OF WALNUT, THE CITY OF VALLEY, THE CITY OF INDUSTRY, AND THE COUNTY OF LOS ANGELES.
  5. THE CONTRACTOR SHALL BE RESPONSIBLE FOR OBTAINING ALL NECESSARY PERMITS FROM THE CITY OF WALNUT, THE CITY OF VALLEY, THE CITY OF INDUSTRY, AND THE COUNTY OF LOS ANGELES.
  6. THE CONTRACTOR SHALL BE RESPONSIBLE FOR OBTAINING ALL NECESSARY PERMITS FROM THE CITY OF WALNUT, THE CITY OF VALLEY, THE CITY OF INDUSTRY, AND THE COUNTY OF LOS ANGELES.
  7. THE CONTRACTOR SHALL BE RESPONSIBLE FOR OBTAINING ALL NECESSARY PERMITS FROM THE CITY OF WALNUT, THE CITY OF VALLEY, THE CITY OF INDUSTRY, AND THE COUNTY OF LOS ANGELES.
  8. THE CONTRACTOR SHALL BE RESPONSIBLE FOR OBTAINING ALL NECESSARY PERMITS FROM THE CITY OF WALNUT, THE CITY OF VALLEY, THE CITY OF INDUSTRY, AND THE COUNTY OF LOS ANGELES.
  9. THE CONTRACTOR SHALL BE RESPONSIBLE FOR OBTAINING ALL NECESSARY PERMITS FROM THE CITY OF WALNUT, THE CITY OF VALLEY, THE CITY OF INDUSTRY, AND THE COUNTY OF LOS ANGELES.
  10. THE CONTRACTOR SHALL BE RESPONSIBLE FOR OBTAINING ALL NECESSARY PERMITS FROM THE CITY OF WALNUT, THE CITY OF VALLEY, THE CITY OF INDUSTRY, AND THE COUNTY OF LOS ANGELES.
  11. THE CONTRACTOR SHALL BE RESPONSIBLE FOR OBTAINING ALL NECESSARY PERMITS FROM THE CITY OF WALNUT, THE CITY OF VALLEY, THE CITY OF INDUSTRY, AND THE COUNTY OF LOS ANGELES.
  12. THE CONTRACTOR SHALL BE RESPONSIBLE FOR OBTAINING ALL NECESSARY PERMITS FROM THE CITY OF WALNUT, THE CITY OF VALLEY, THE CITY OF INDUSTRY, AND THE COUNTY OF LOS ANGELES.

THE FOLLOWING LATEST REVISED STANDARD PLANS IN USE IN THE OFFICE OF THE DEPARTMENT OF PUBLIC WORKS SHALL APPLY TO THE CONSTRUCTION OF THIS PROJECT:

1. STANDARD SPECIFICATIONS FOR PUBLIC WORKS OF THE COUNTY OF LOS ANGELES, CALIFORNIA, 1980 EDITION, LATEST REVISIONS	1-1
2. STANDARD SPECIFICATIONS FOR PUBLIC WORKS OF THE COUNTY OF LOS ANGELES, CALIFORNIA, 1980 EDITION, LATEST REVISIONS	1-2
3. STANDARD SPECIFICATIONS FOR PUBLIC WORKS OF THE COUNTY OF LOS ANGELES, CALIFORNIA, 1980 EDITION, LATEST REVISIONS	1-3
4. STANDARD SPECIFICATIONS FOR PUBLIC WORKS OF THE COUNTY OF LOS ANGELES, CALIFORNIA, 1980 EDITION, LATEST REVISIONS	1-4
5. STANDARD SPECIFICATIONS FOR PUBLIC WORKS OF THE COUNTY OF LOS ANGELES, CALIFORNIA, 1980 EDITION, LATEST REVISIONS	1-5
6. STANDARD SPECIFICATIONS FOR PUBLIC WORKS OF THE COUNTY OF LOS ANGELES, CALIFORNIA, 1980 EDITION, LATEST REVISIONS	1-6
7. STANDARD SPECIFICATIONS FOR PUBLIC WORKS OF THE COUNTY OF LOS ANGELES, CALIFORNIA, 1980 EDITION, LATEST REVISIONS	1-7
8. STANDARD SPECIFICATIONS FOR PUBLIC WORKS OF THE COUNTY OF LOS ANGELES, CALIFORNIA, 1980 EDITION, LATEST REVISIONS	1-8
9. STANDARD SPECIFICATIONS FOR PUBLIC WORKS OF THE COUNTY OF LOS ANGELES, CALIFORNIA, 1980 EDITION, LATEST REVISIONS	1-9
10. STANDARD SPECIFICATIONS FOR PUBLIC WORKS OF THE COUNTY OF LOS ANGELES, CALIFORNIA, 1980 EDITION, LATEST REVISIONS	1-10
11. STANDARD SPECIFICATIONS FOR PUBLIC WORKS OF THE COUNTY OF LOS ANGELES, CALIFORNIA, 1980 EDITION, LATEST REVISIONS	1-11
12. STANDARD SPECIFICATIONS FOR PUBLIC WORKS OF THE COUNTY OF LOS ANGELES, CALIFORNIA, 1980 EDITION, LATEST REVISIONS	1-12
13. STANDARD SPECIFICATIONS FOR PUBLIC WORKS OF THE COUNTY OF LOS ANGELES, CALIFORNIA, 1980 EDITION, LATEST REVISIONS	1-13
14. STANDARD SPECIFICATIONS FOR PUBLIC WORKS OF THE COUNTY OF LOS ANGELES, CALIFORNIA, 1980 EDITION, LATEST REVISIONS	1-14
15. STANDARD SPECIFICATIONS FOR PUBLIC WORKS OF THE COUNTY OF LOS ANGELES, CALIFORNIA, 1980 EDITION, LATEST REVISIONS	1-15
16. STANDARD SPECIFICATIONS FOR PUBLIC WORKS OF THE COUNTY OF LOS ANGELES, CALIFORNIA, 1980 EDITION, LATEST REVISIONS	1-16
17. STANDARD SPECIFICATIONS FOR PUBLIC WORKS OF THE COUNTY OF LOS ANGELES, CALIFORNIA, 1980 EDITION, LATEST REVISIONS	1-17
18. STANDARD SPECIFICATIONS FOR PUBLIC WORKS OF THE COUNTY OF LOS ANGELES, CALIFORNIA, 1980 EDITION, LATEST REVISIONS	1-18
19. STANDARD SPECIFICATIONS FOR PUBLIC WORKS OF THE COUNTY OF LOS ANGELES, CALIFORNIA, 1980 EDITION, LATEST REVISIONS	1-19
20. STANDARD SPECIFICATIONS FOR PUBLIC WORKS OF THE COUNTY OF LOS ANGELES, CALIFORNIA, 1980 EDITION, LATEST REVISIONS	1-20

APPROVED: *[Signature]* 1/30/91  
 CHECKED: *[Signature]* 1/30/91  
 SAN DIMAS BLDG. DIST. 10

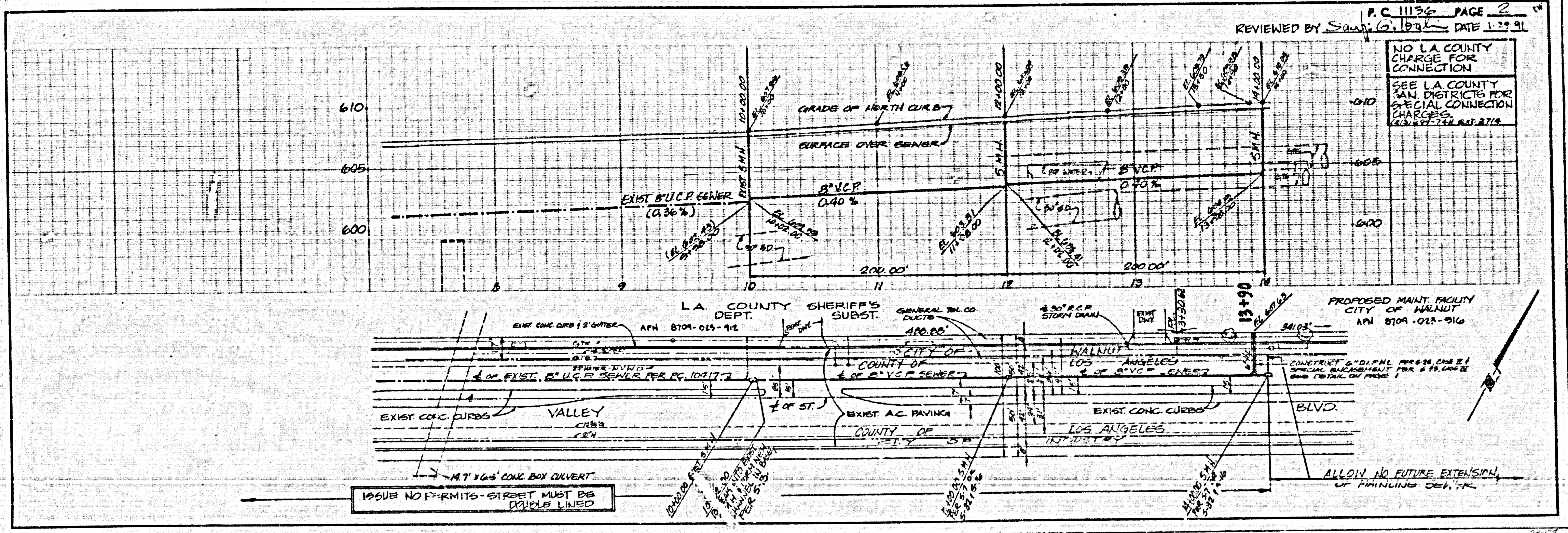

11  
 BC 1112