

B.M. 2777 ELEV. 433.509  
 4.9' ON C/L OF CURB BAKEN  
 40 FT. W. 100 FT. N. C/L. N.E.  
 BARRILLO ST. & VINCENT AVE.  
 COVINA QUAD. 19 15

REVISION NO.  $\Delta$  DATE: 6/10/93  
 REVISED STATIONS, DISTANCES, ELEVATIONS, AND  
 ADDED B'S STUBS AS SHOWN HEREON,  
 PER 'AS-BUILT' PLAN.  
 APPROVED: *Sally Gilroy* 6/30/93  
 DIST. OF PUBLIC WORKS

*Charles W. Tideman*  
 LICENSED PROFESSIONAL ENGINEER  
 REGISTERED ENGINEER

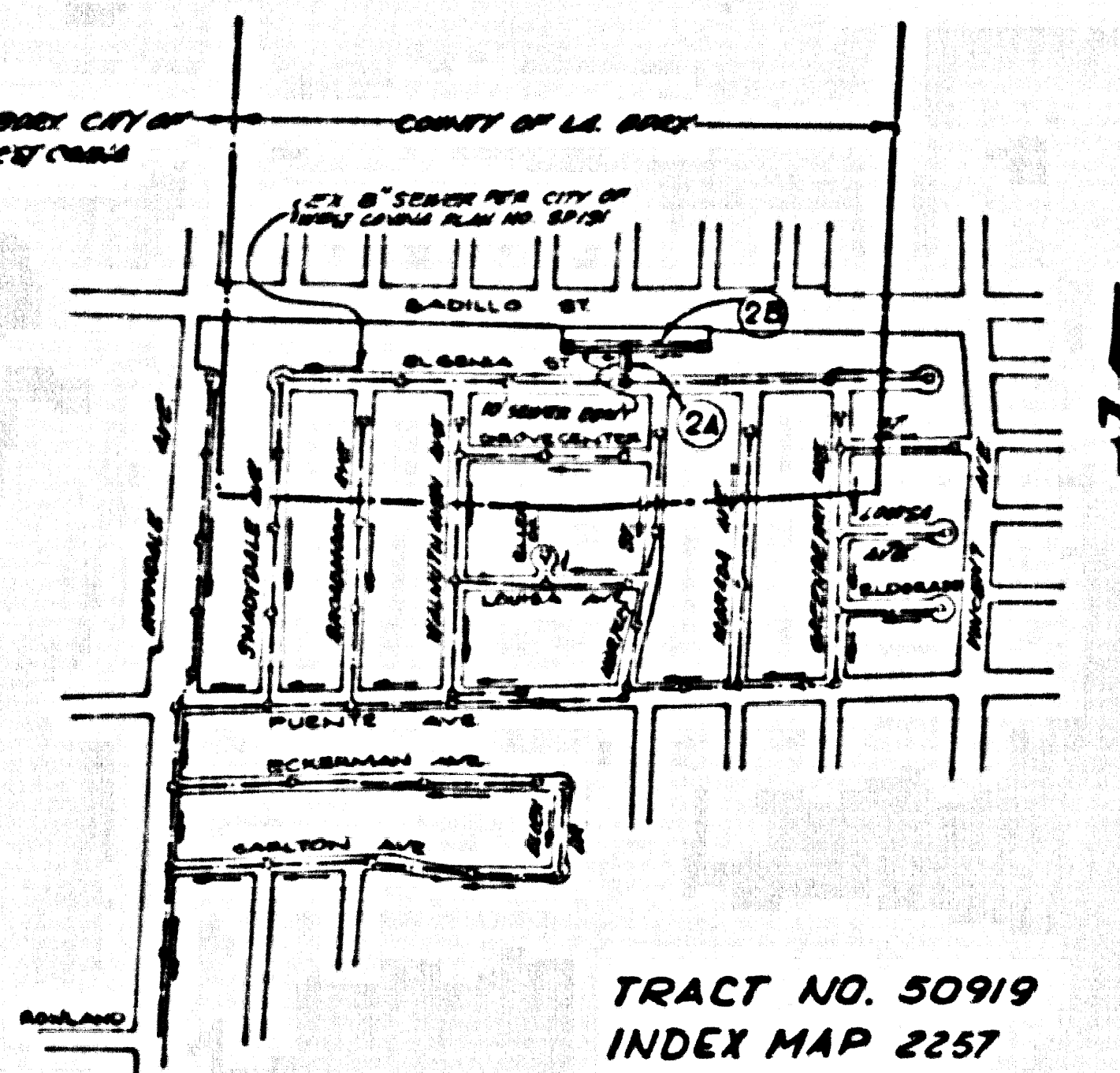

TRACT NO. 50919  
 INDEX MAP 2257  
 SCALE: 1" = 600'  
 P.C. 11207

NOTE: NUMBERS IN CIRCLES INDICATE PAGE NUMBERS

**PRIVATE ENGINEER'S NOTICE TO CONTRACTORS**

THE EXISTENCE AND LOCATION OF ANY UNDERGROUND UTILITY LINES OR STRUCTURES SHOWN ON THESE PLANS ARE OBTAINED BY A SEARCH OF THE AVAILABLE RECORDS TO THE BEST OF OUR KNOWLEDGE THERE ARE NO EXISTING UTILITIES EXCEPT AS SHOWN ON THESE PLANS. THE CONTRACTOR IS REQUIRED TO TAKE THE PRECAUTIONARY MEASURES TO PROTECT THE UTILITY LINES, DOWN AND ANY OTHER LINES ANY OF WHICH ARE NOT SHOWN ON THESE PLANS. THE CONTRACTOR SHALL BE RESPONSIBLE FOR NOTIFYING UNDERGROUND SERVICE ALERT AT 1-800-448-8433 TWO WORKING DAYS PRIOR TO ANY EXCAVATION OR CONSTRUCTION.

NO CONNECTION FOR THE DISPOSAL OF INDUSTRIAL WASTES SHALL BE MADE TO SEWERS SHOWN ON THESE DRAWINGS UNTIL A PERMIT FOR INDUSTRIAL WASTEWATER DISCHARGE HAS BEEN ISSUED BY THE SANITATION DISTRICTS FOR SAID CONNECTION. BEFORE BREAKING INTO OR CONSTRUCTION ON A COUNTY SANITATION DISTRICT SEWER AND PRIOR TO FINAL ACCEPTANCE OF THE PROJECT, SANITATION DISTRICT INSPECTOR SHALL BE NOTIFIED BY PHONE (818) 362-8605 SO THAT REQUIRED INSPECTION CAN BE MADE.

**CONSTRUCTION NOTES CONT.**

18. IN FULL COMPLIANCE WITH PART II OF THE SPECIAL PROVISIONS IS REQUIRED FOR THE INSTALLATION OF A B & C COMPOSITE PIPE.
19. MANHOLE WHITE STOP GASKETS AND CLAMPS ARE REQUIRED FOR THE CONNECTION OF A B & C COMPOSITE PIPE TO MANHOLE STRUCTURES.
20. A B & C SOLID WALL PIPE MUST BE USED FOR WYE AND HOUSE LATERAL CONNECTIONS TO A B & C COMPOSITE MAINLINE SEWER PIPE.
21. A B & C COMPOSITE PIPE SHALL BE BEDDED IN CONFORMANCE WITH THE TABLE IN SECTION B - 3.1 OF PART II OF THE SPECIAL PROVISIONS.
22. TREE DEFLECTOR COUPLERS ARE REQUIRED FOR RADIUS OF CURVATURE LESS THAN 380 FEET WHEN USING A B & C COMPOSITE PIPE.
23. NO CONNECTIONS FOR DISPOSAL OF INDUSTRIAL WASTE IS ALLOWED IN A B & C COMPOSITE PIPE IS USED.
24. SEWER LINE CURVATURE SHALL NOT BE ACHIEVED BY PULLING OF JOINTS OR BENDING PIPE ENDS WHEN USING PLASTIC PIPE.
25. A B & C COMPOSITE PIPE IS USED.
26. SEWER LINE CURVATURE SHALL NOT BE ACHIEVED BY PULLING OF JOINTS OR BENDING PIPE ENDS WHEN USING PLASTIC PIPE.
27. ALL WYE AND HOUSE LATERALS ARE TO BE LOCATED AT LEAST FIVE FEET APART AND WHEN POSSIBLE NOT CLOSER THAN FIVE FEET TO ANY MANHOLE.
28. A B & C SOLID WALL PIPE IS NOT ACCEPTABLE FOR USE AT MANHOLE JUNCTION.
29. ONLY WYE BRANCHES ARE TO BE USED FOR CONNECTION TO A B & C COMPOSITE MAINLINE SEWER PIPE.

**GENERAL NOTES:**

1. A SEWER CONSTRUCTION PERMIT SHALL BE OBTAINED AND A FILED FOR CONSTRUCTION INSPECTION AND RECORD AS PER THE DEPARTMENT OF PUBLIC WORKS AT THE PERMITS COUNTY PUBLIC WORKS DIVISION. PERMITS ARE AVAILABLE AT LEAST 72 HOURS PRIOR TO THE START OF WORK. THE CONTRACTOR SHALL BE RESPONSIBLE FOR OBTAINING THE PERMIT AND FOR THE COST THEREOF. ETC. MUST BE FILED IN THE PERMIT APPLICATION.
2. PRIOR TO ISSUANCE OF ANY PERMIT THE CONTRACTOR SHALL FILE A REPORT FOR EXCAVATIONS AND RESEARCH FROM THE STATE OF CALIFORNIA. THE REPORT SHALL BE FILED WITH THE COUNTY OF LOS ANGELES PUBLIC WORKS DIVISION. THE REPORT SHALL BE FILED WITH THE COUNTY OF LOS ANGELES PUBLIC WORKS DIVISION. THE REPORT SHALL BE FILED WITH THE COUNTY OF LOS ANGELES PUBLIC WORKS DIVISION.
3. IF WORK IS TO BE DONE IN A CITY HIGHWAY A PERMIT MUST BE OBTAINED FROM THE STATE OF CALIFORNIA DIVISION OF HIGHWAYS 120 SOUTH SPRING STREET, LOS ANGELES, CALIFORNIA.
4. SEWER WORK IS WITHIN A CONTRACT CITY THE CONTRACTOR SHALL CONTACT THE DIRECTOR OF PUBLIC WORKS OF THAT CITY TO DETERMINE THE LOCATION TO PUT THE SEWER WORK.
5. THE CONTRACTOR SHALL CONTACT THE DISTRICT OFFICE LISTED ON THE APPLICATION FOR CONSTRUCTION PERMIT TO OBTAIN AN ACCEPTABLE CONSTRUCTION START DATE AND SHALL NOTIFY THE CONSTRUCTION DIVISION BY TELEPHONE (916) 487-4847 AT LEAST TWENTY FOUR HOURS BEFORE STARTING ANY WORK UNDER THIS CONTRACT.
6. APPROVAL OF THIS PLAN BY THE COUNTY OF LOS ANGELES DOES NOT CONSTITUTE A REPRESENTATION AS TO THE ACCURACY OF THE LOCATION OF THE EXISTENCE OR NON-EXISTENCE OF ANY UNDERGROUND UTILITIES OR STRUCTURES WITHIN THE LIMITS OF THIS PROJECT. THE CONTRACTOR SHALL BE RESPONSIBLE FOR VERIFYING THE LOCATION OF ANY UNDERGROUND UTILITIES OR STRUCTURES WITHIN THE LIMITS OF THIS PROJECT.
7. ALL WORK SHALL BE IN ACCORDANCE WITH THE STANDARD SPECIFICATIONS FOR PUBLIC WORKS CONSTRUCTION. THESE SPECIFICATIONS INCLUDING SUPPLEMENTS AND THE SPECIAL PROVISIONS FOR THE CONSTRUCTION OF SANITARY SEWERS DATED JULY 31, 1988 AND SHALL BE PROVIDED ONLY IN THE PRESENCE OF THE DEPARTMENT OF PUBLIC WORKS PERSONNEL.
8. THE CONTRACTOR'S ATTENTION IS DIRECTED TO SECTION 7-18.1 OF THE STANDARD SPECIFICATIONS FOR PUBLIC WORKS CONSTRUCTION. THESE SPECIFICATIONS INCLUDE SAFETY PRECAUTIONS AND SHALL CONFORM TO THE MINIMUM PUBLIC SAFETY REQUIREMENTS AS SHOWN ON LOS ANGELES DEPARTMENT OF PUBLIC WORKS STANDARD 7-1.
9. ELEVATIONS ARE IN FEET ABOVE U.S.C. & G.S. SEA LEVEL DATUM OF 1988.
10. NO REVISIONS SHALL BE MADE IN THESE PLANS WITHOUT THE APPROVAL OF THE DIRECTOR OF PUBLIC WORKS.
11. NO REPRESENTATION OF THE DEPARTMENT OF PUBLIC WORKS SHALL BE MADE ON ANY PART OF THESE PLANS.
12. CHANGES TO THESE PLANS SHALL BE MADE BY THE CONTRACTOR IN WRITING AND SHALL BE APPROVED BY THE DIRECTOR OF PUBLIC WORKS. CHANGES TO THESE PLANS SHALL BE MADE BY THE CONTRACTOR IN WRITING AND SHALL BE APPROVED BY THE DIRECTOR OF PUBLIC WORKS.
13. THE PRIVATE ENGINEER SHALL FURNISH THE HOUSE LATERAL DEPTH AT THE PROPERTY LINE BELOW THE TOP CURB ELEVATION FOR EACH HOUSE LATERAL ON THE GRADE SHEET.

**CONSTRUCTION NOTES:**

1. HOUSE SURVEY STAKES ON THE PROPERTY LINE OR PROPERTY LINES PRODUCED AT RIGHT ANGLES TO THE SEWER LINE AT THE CENTERLINE OF EACH MANHOLE.
2. WYED OFF CLAY PIPE JOINTS SHALL BE TYPE "D" OR "F" PER STANDARD SPECIFICATIONS SECTION 20-2.
3. IF A POWER POLE IS WITHIN THREE FEET OF THE SEWER, THE SEWER SHALL BE ENCASED PER STANDARD PLAN 501-041 AND A TWO FOOT OR MORE CLEARANCE SHALL BE MAINTAINED TO THE POINT OF INTERFERENCE.
4. ALL JOINTS BETWEEN CAST IRON PIPE AND WYED OFF CLAY PIPE SHALL BE MADE WITH A RUBBER BLEND JOINT TYPE "D" WITHIN 24 HOURS OF INSTALLATION PER STANDARD SPECIFICATIONS SECTION 20-2.
5. HOUSE LATERALS TO BE CONSTRUCTED WITH INVERTS AT THE PROPERTY LINE 8 FEET BELOW CURB GRADE EXCEPT AS NOTED.
6. WYE OR THE BRANCHES MAY BE USED FOR CONNECTIONS TO MANHOLE SEWERS EXCEPT AS NOTED.
7. IF DURING THE COURSE OF CONSTRUCTION IT IS DETERMINED THAT THERE IS LESS THAN FOUR FEET OF COVER OVER THE TOP OF A HOUSE LATERAL, WYED OFF CLAY PIPE SHALL BE USED. THE PIPE SHALL BE ENCASED PER A STANDARD PLAN 501-041. IN CASE 1 UNLESS OTHERWISE APPROVED BY THE DIRECTOR OF PUBLIC WORKS.
8. ALL STRUCTURES SHALL BE EITHER BRICK OR CONCRETE PER STANDARD PLAN 501-041 OR PER STANDARD PLAN 501-041. ALL STRUCTURES SHALL BE EITHER BRICK OR CONCRETE PER STANDARD PLAN 501-041 OR PER STANDARD PLAN 501-041.
9. REINFORCE ALL TRENCHES WITHIN HAZARDOUS AREAS TO MEET LOS ANGELES COUNTY PUBLIC WORKS OF CALIFORNIA STATE HIGHWAY REQUIREMENTS IN ACCORDANCE WITH THE PERMITS.
10. FULL COMPLIANCE WITH SECTION 20-1.3.4 OF THE STANDARD SPECIFICATIONS SHALL BE REQUIRED FOR SUBSIDIARY STREETS CERTIFICATION OF MANHOLES, COUPLERS AND SPECIAL CONNECTIONS BY A QUALIFIED CIVIL ENGINEER SHALL BE PROVIDED BY THE CONTRACTOR PRIOR TO THE ISSUANCE OF A CERTIFICATE OF PARTIAL ACCEPTANCE.
11. ALL BACKFILL AND FILL OUTSIDE OF STREET RIGHT OF WAY SHALL BE COMPACTED TO 90% OF MAXIMUM DENSITY AS DETERMINED BY STANDARD CONSTRUCTION TEST 100 TO THE DEPTH OF UNLESS OTHERWISE SPECIFIED. THIS SHALL BE CERTIFIED BY A QUALIFIED CIVIL ENGINEER. THIS CERTIFICATION SHALL BE SUBMITTED TO THE CONSTRUCTION DIVISION OF THE DEPARTMENT OF PUBLIC WORKS PRIOR TO ACCEPTANCE OF THE WORK BY THE COUNTY.
12. MANHOLE TOPS IN UNIMPROVED AREAS OF 8 FT. TO 20 FT. HIGH SHALL BE PROVIDED BRACKETS AND SPECIAL PROVISIONS.
13. SEWERS TO BE 18" TO 30" DEEP PER SECTION 20-1.4 OF THE STANDARD SPECIFICATIONS AND SPECIAL PROVISIONS.

PROFILE, ALIGNMENT AND GRADE OF  
**SANITARY SEWERS**  
 TO BE CONSTRUCTED IN  
 TRACT NO. 50919

INDEX 2257  
 1 SHEETS, 2 PAGES

SCALE: HORIZ. 1" = 60' VERT. 1" = 6'  
 FEB. 1992

PREPARED IN THE OFFICES OF  
 JOHN B. ABELL, INC.  
 340 W. GARDNER ST.  
 COVINA, CA 91723  
 TEL. NO. (818) 915-7671

BY: *Charles W. Tideman*  
 REGISTERED ENGINEER  
 REG. NO. 24233  
 EX. 7-10-93

THE FOLLOWING LATEST REVISED STANDARD PLANS ON FILE IN THE OFFICE OF THE DEPARTMENT OF PUBLIC WORKS SHALL APPLY IN THE CONSTRUCTION OF THIS PROJECT:

MINIMUM PUBLIC SAFETY REQUIREMENTS	D-1
BRICK MANHOLE	D-2
REINFORCED PRECAST CONCRETE MANHOLE	D-3
STANDARD MANHOLE STEP	D-4
RECORDING FOR SEWER PIPE	D-5
CONDUIT AND ENCASUREMENT	D-6
WYE OR THE BRANCH	D-7
ALLOWABLE TRENCH SPACING	D-8
LOADING MANHOLE - FRAME AND COVER	D-9
NON-REINFORCED PRECAST CONCRETE MANHOLE	D-10

53503

COUNTY OF LOS ANGELES, CALIFORNIA  
 THOMAS A. TIDEMAN  
 DIRECTOR OF PUBLIC WORKS

APPROVED: *Charles W. Tideman* 6/10/93  
 REGISTERED ENGINEER

CHECKED: *Sally Gilroy* 6/10/93  
 DIST. OF PUBLIC WORKS  
 SAN GABRIEL W/L BLDG. DIST. 82

CITY OF WEST COVINA  
 APPROVED: *Charles W. Tideman* 6/10/93  
 CITY ENGINEER

