

B.M. D6 4749 ELEV. 440.815
 S.W. CORNER OF JELLYCK AVE & GREENWAY DR.
 20' E. & 44' S. OF INTERSECTION I.E. OF B.C.A.
 OTTERBEIN QUAD. 19 90

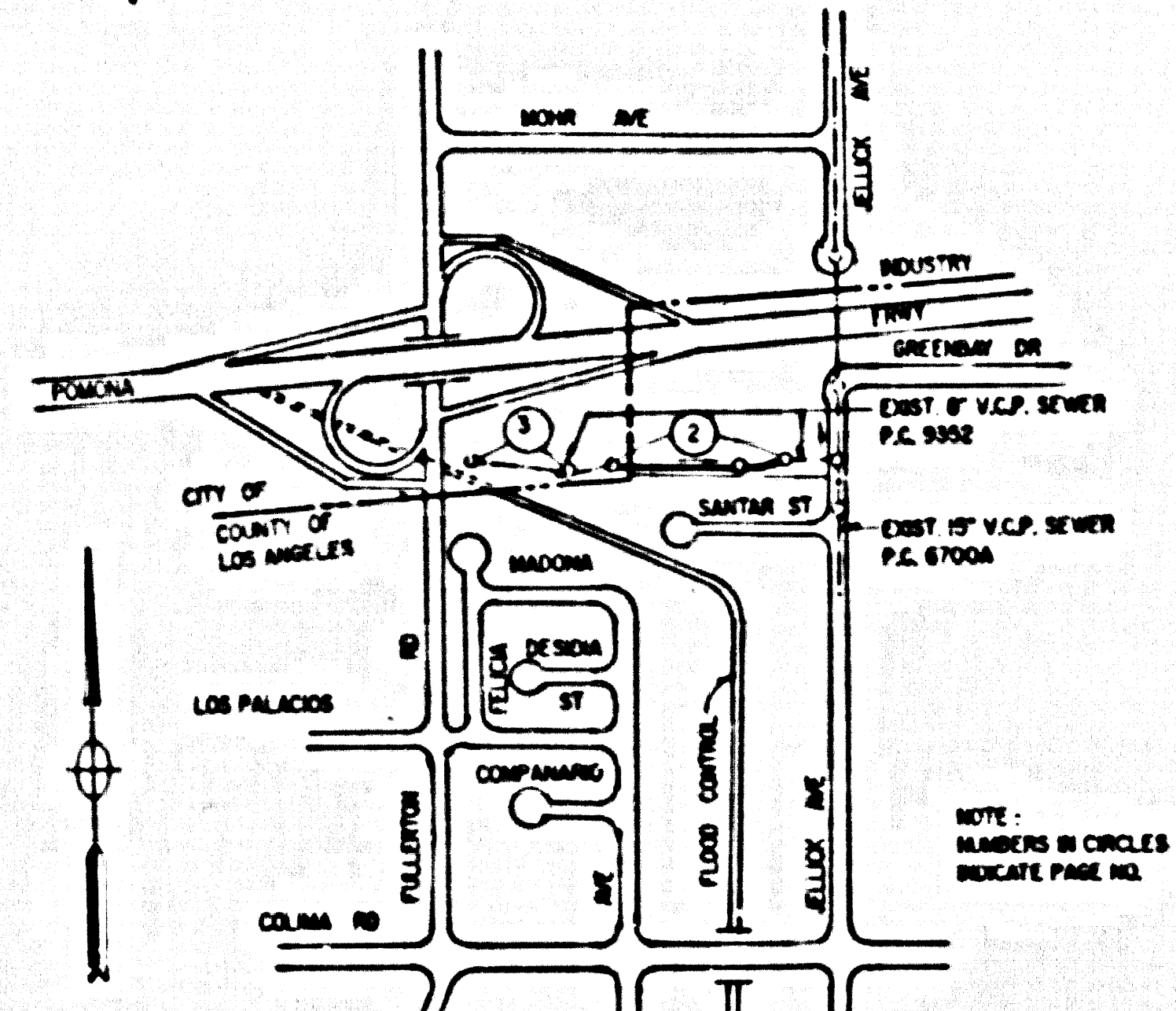

INDEX MAP
 SCALE: 1" = 600'
 P.C. 11226
 (SEWER RELOCATION ONLY)
 THOMAS: 98-E-3

PRIVATE ENGINEERS NOTICE TO CONTRACTORS

THE EXISTENCE AND LOCATION OF ANY UNDERGROUND UTILITY PIPES OR STRUCTURES SHOWN ON THESE PLANS ARE OBTAINED BY SEARCH OF THE AVAILABLE RECORD TO THE BEST OF OUR KNOWLEDGE AND BELIEF. THE CONTRACTOR IS REQUIRED TO TAKE THE NECESSARY PRECAUTIONARY MEASURES TO PROTECT THE UTILITY LINES SHOWN AND ANY OTHER LINES NOT OF RECORD OR NOT SHOWN ON THESE PLANS.

DAVID C. QUEVELL RCE 6282

NO CONNECTION FOR THE DISPOSAL OF INDUSTRIAL WASTES SHALL BE MADE TO SEWERS SHOWN ON THESE DRAWINGS UNLESS A PERMIT FOR INDUSTRIAL WASTEWATER DISCHARGE HAS BEEN ISSUED BY THE SANITATION DISTRICTS FOR SAID CONNECTION.

BEFORE BREAKING INTO OR CONSTRUCTION ON A COUNTY SANITATION DISTRICT SEWER AND PRIOR TO FINAL ACCEPTANCE OF THE PROJECT, SANITATION DISTRICT INSPECTOR SHALL BE NOTIFIED BY PHONE (818) 962-8605 SO THAT REQUIRED INSPECTION CAN BE MADE.

GENERAL NOTES:

1. A SEWER CONSTRUCTION PERMIT SHALL BE OBTAINED AND A FEE PAID FOR CONSTRUCTION, INSPECTION AND RECORD PLANS TO THE DEPARTMENT OF PUBLIC WORKS AT THE TIME OF THE PERMIT APPLICATION AND MUST BE MAINTAINED THROUGHOUT THE PROJECT.
2. PRIOR TO COMMENCEMENT OF ANY PROJECT THE CONTRACTOR SHALL FILE A PERMIT FOR EXCAVATIONS AND TRENCHES WITH THE STATE OF CALIFORNIA DIVISION OF INDUSTRIAL SAFETY AND CERTIFICATION OF AGENCIES COMPLIANCE WITH THE DEPARTMENT OF PUBLIC WORKS. THE CONTRACTOR SHALL BE RESPONSIBLE TO OBTAIN THIS PERMIT.
3. IF A SEWER IS FOUND IN A STATE HIGHWAY RIGHT-OF-WAY OBTAINED FROM THE STATE OF CALIFORNIA DIVISION OF HIGHWAYS, THE CONTRACTOR SHALL NOTIFY THE CONTRACTOR MUST NOTIFY THE DIVISION OF PUBLIC WORKS OF THAT CITY TO DETERMINE THE LOCATION TO PAY THE INSPECTION FEE.
4. THE CONTRACTOR SHALL NOTIFY THE DISTRICT OFFICE (LTP) FOR THE APPLICATION FOR CONSTRUCTION PERMIT BY TELEPHONE AT 962-8728 AT LEAST TWENTY FOUR HOURS BEFORE STARTING ANY WORK UNDER THIS CONTRACT.
5. APPROVED BY THIS PLAN BY THE COUNTY OF LOS ANGELES DOES NOT CONSTITUTE A REPRESENTATION AS TO ACCURACY OF THE LOCATION OF THE EXISTING OR NON-EXISTENCE OF ANY UNDERGROUND UTILITY PIPE OR STRUCTURE WITHIN THE LIMITS OF THIS PROJECT. THIS NOTE APPLIES TO ALL PAGES.
6. ALL WORK SHALL BE IN ACCORDANCE WITH THE STANDARD SPECIFICATIONS FOR PUBLIC WORKS CONSTRUCTION 1988 EDITION INCLUDING SUPPLEMENTS AND SPECIAL PROVISIONS FOR THE CONSTRUCTION OF SANITARY SEWERS DATED JULY 31, 1988 AND SHALL BE PRODUCED ONLY IN THE PRESENCE OF THE DEPARTMENT OF PUBLIC WORKS PERSONNEL.
7. THE CONTRACTOR'S ATTENTION IS DRAWN TO SECTION 108.1 OF THE STANDARD SPECIFICATIONS OF PUBLIC WORKS CONSTRUCTION WHICH IS REQUIRED TO BE OBTAINED AND SHALL CONFORM TO THE SANITARY PUBLIC SAFETY REQUIREMENTS AS SHOWN ON THE ANNUAL REPORT OF THE DEPARTMENT OF PUBLIC WORKS.
8. EXCAVATIONS ARE TO BE MADE ABOVE U.S.C. & G.S. SEA LEVEL DATUM OF 1985.
9. NO REVISIONS SHALL BE MADE TO THESE PLANS WITHOUT THE APPROVAL OF THE DIRECTOR OF PUBLIC WORKS.
10. NO REVISIONS SHALL BE MADE TO THESE PLANS WITHOUT THE APPROVAL OF THE DIRECTOR OF PUBLIC WORKS.
11. NO REVISIONS SHALL BE MADE TO THESE PLANS WITHOUT THE APPROVAL OF THE DIRECTOR OF PUBLIC WORKS.
12. THE CONTRACTOR SHALL BE RESPONSIBLE FOR OBTAINING ALL NECESSARY PERMITS AND APPROVALS FROM ALL AGENCIES INVOLVED IN THE PROJECT.
13. THE CONTRACTOR SHALL BE RESPONSIBLE FOR OBTAINING ALL NECESSARY PERMITS AND APPROVALS FROM ALL AGENCIES INVOLVED IN THE PROJECT.
14. THE CONTRACTOR SHALL BE RESPONSIBLE FOR OBTAINING ALL NECESSARY PERMITS AND APPROVALS FROM ALL AGENCIES INVOLVED IN THE PROJECT.
15. THE CONTRACTOR SHALL BE RESPONSIBLE FOR OBTAINING ALL NECESSARY PERMITS AND APPROVALS FROM ALL AGENCIES INVOLVED IN THE PROJECT.
16. THE CONTRACTOR SHALL BE RESPONSIBLE FOR OBTAINING ALL NECESSARY PERMITS AND APPROVALS FROM ALL AGENCIES INVOLVED IN THE PROJECT.
17. THE CONTRACTOR SHALL BE RESPONSIBLE FOR OBTAINING ALL NECESSARY PERMITS AND APPROVALS FROM ALL AGENCIES INVOLVED IN THE PROJECT.
18. THE CONTRACTOR SHALL BE RESPONSIBLE FOR OBTAINING ALL NECESSARY PERMITS AND APPROVALS FROM ALL AGENCIES INVOLVED IN THE PROJECT.
19. THE CONTRACTOR SHALL BE RESPONSIBLE FOR OBTAINING ALL NECESSARY PERMITS AND APPROVALS FROM ALL AGENCIES INVOLVED IN THE PROJECT.
20. THE CONTRACTOR SHALL BE RESPONSIBLE FOR OBTAINING ALL NECESSARY PERMITS AND APPROVALS FROM ALL AGENCIES INVOLVED IN THE PROJECT.

CONSTRUCTION NOTES:

1. FINISHED SURFACE SHALL BE THE FINISHED SURFACE OF THE PROPERTY LINE PRODUCED AT RIGHT ANGLES TO THE SEWER LINE AT THE CENTERLINE OF EACH MANHOLE.
2. FINISHED CLAY PIPE JOINTS SHALL BE PER 30" OR 48" PER STANDARD SPECIFICATIONS PER SECTION 108.2.
3. A FINISHED PIPE IS THAT WHICH SHALL BE SET BY THE SEWER. THE SEWER SHALL BE ENCASED PER STANDARD PLAN 308 CASE 11 TWO FEET OR MORE BELOW THE POINT OF INTERFERENCE.
4. ALL JOINTS BETWEEN "P" PIPE AND "P" PIPE SHALL BE MADE WITH A RUBBER GASKET JOINT PER 30" OR 48" PER STANDARD SPECIFICATIONS PER SECTION 108.2.
5. HOUSE LATERALS SHALL BE CONSTRUCTED WITH INVERTS AT THE PROPERTY LINE 8 FEET BELOW CURB GRADE EXCEPT AS NOTED.
6. 8" OR 12" BRANCHES MAY BE USED FOR CONNECTIONS TO MANHOLE SEWERS EXCEPT AS NOTED.
7. IN ALL CASES THE COURSE OF CONSTRUCTION IS TO BE DETERMINED THAT THERE IS LESS THAN FOUR FEET OF COVER OVER THE TOP OF A MANHOLE OR OVER THE TOP OF A 12" OR 18" BRANCH. THE SEWER SHALL BE ENCASED PER STANDARD PLAN 308 CASE 11 UNLESS OTHERWISE APPROVED BY THE DIRECTOR OF PUBLIC WORKS.
8. ALL EXISTING LATERALS SHALL BE SEWER BRANCH SEWER BRANCHES PER STANDARD PLAN 308 OR PRECAST CONCRETE SEWER BRANCHES PER STANDARD PLAN 308 OR REINFORCED PRECAST CONCRETE BRANCHES PER STANDARD PLAN 308 EXCEPT AS NOTED.
9. IN ALL CASES ALL TRENCHES WITHIN PAVED AREAS TO BE BY LOS ANGELES COUNTY PUBLIC WORKS OR CALIFORNIA STATE HIGHWAY DEPARTMENT SHALL BE IN ACCORDANCE WITH THE PERMITS.
10. ALL EXISTING LATERALS SHALL BE SEWER BRANCH SEWER BRANCHES PER STANDARD PLAN 308 OR PRECAST CONCRETE SEWER BRANCHES PER STANDARD PLAN 308 OR REINFORCED PRECAST CONCRETE BRANCHES PER STANDARD PLAN 308 EXCEPT AS NOTED.
11. ALL EXISTING LATERALS SHALL BE SEWER BRANCH SEWER BRANCHES PER STANDARD PLAN 308 OR PRECAST CONCRETE SEWER BRANCHES PER STANDARD PLAN 308 OR REINFORCED PRECAST CONCRETE BRANCHES PER STANDARD PLAN 308 EXCEPT AS NOTED.
12. ALL EXISTING LATERALS SHALL BE SEWER BRANCH SEWER BRANCHES PER STANDARD PLAN 308 OR PRECAST CONCRETE SEWER BRANCHES PER STANDARD PLAN 308 OR REINFORCED PRECAST CONCRETE BRANCHES PER STANDARD PLAN 308 EXCEPT AS NOTED.
13. ALL EXISTING LATERALS SHALL BE SEWER BRANCH SEWER BRANCHES PER STANDARD PLAN 308 OR PRECAST CONCRETE SEWER BRANCHES PER STANDARD PLAN 308 OR REINFORCED PRECAST CONCRETE BRANCHES PER STANDARD PLAN 308 EXCEPT AS NOTED.
14. ALL EXISTING LATERALS SHALL BE SEWER BRANCH SEWER BRANCHES PER STANDARD PLAN 308 OR PRECAST CONCRETE SEWER BRANCHES PER STANDARD PLAN 308 OR REINFORCED PRECAST CONCRETE BRANCHES PER STANDARD PLAN 308 EXCEPT AS NOTED.
15. ALL EXISTING LATERALS SHALL BE SEWER BRANCH SEWER BRANCHES PER STANDARD PLAN 308 OR PRECAST CONCRETE SEWER BRANCHES PER STANDARD PLAN 308 OR REINFORCED PRECAST CONCRETE BRANCHES PER STANDARD PLAN 308 EXCEPT AS NOTED.
16. ALL EXISTING LATERALS SHALL BE SEWER BRANCH SEWER BRANCHES PER STANDARD PLAN 308 OR PRECAST CONCRETE SEWER BRANCHES PER STANDARD PLAN 308 OR REINFORCED PRECAST CONCRETE BRANCHES PER STANDARD PLAN 308 EXCEPT AS NOTED.
17. ALL EXISTING LATERALS SHALL BE SEWER BRANCH SEWER BRANCHES PER STANDARD PLAN 308 OR PRECAST CONCRETE SEWER BRANCHES PER STANDARD PLAN 308 OR REINFORCED PRECAST CONCRETE BRANCHES PER STANDARD PLAN 308 EXCEPT AS NOTED.
18. ALL EXISTING LATERALS SHALL BE SEWER BRANCH SEWER BRANCHES PER STANDARD PLAN 308 OR PRECAST CONCRETE SEWER BRANCHES PER STANDARD PLAN 308 OR REINFORCED PRECAST CONCRETE BRANCHES PER STANDARD PLAN 308 EXCEPT AS NOTED.
19. ALL EXISTING LATERALS SHALL BE SEWER BRANCH SEWER BRANCHES PER STANDARD PLAN 308 OR PRECAST CONCRETE SEWER BRANCHES PER STANDARD PLAN 308 OR REINFORCED PRECAST CONCRETE BRANCHES PER STANDARD PLAN 308 EXCEPT AS NOTED.
20. ALL EXISTING LATERALS SHALL BE SEWER BRANCH SEWER BRANCHES PER STANDARD PLAN 308 OR PRECAST CONCRETE SEWER BRANCHES PER STANDARD PLAN 308 OR REINFORCED PRECAST CONCRETE BRANCHES PER STANDARD PLAN 308 EXCEPT AS NOTED.

SANITARY SEWERS

TO BE CONSTRUCTED IN
 R/W S/O POMONA FRWY & W/O JELLYCK AVE.
 (SEWER RELOCATION ONLY)

PRIVATE CONTRACT NO. 11226

INDEX 2305
 2 SHEETS, 3 PAGES

SCALE: HORIZ. 1" = 40' VERT. 1" = 4'
 SEPTEMBER 1992

PREPARED IN THE OFFICES OF
ANACAL ENGINEERING CO., ANAHEIM, CA. 92803-3668
 BY: J.F. [Signature]
 REG. C.E. NO. 4386

THE FOLLOWING LATEST REVISED STANDARD PLANS OR FILES IN THE OFFICE OF THE DEPARTMENT OF PUBLIC WORKS SHALL APPLY IN THE CONSTRUCTION OF THIS PROJECT:

REINFORCED PRECAST CONCRETE MANHOLE	308
REINFORCED PRECAST CONCRETE BRANCH	308
STANDARD MANHOLE STEP	308
REINFORCED PRECAST CONCRETE BRANCH	308
CANALING AND ENCLOSURE	308
PIPE OR TEE BRANCH	308
ALLOWABLE TRENCH WIDTHS	308
LOADING MANHOLE FRAMES AND COVERS	308
REINFORCED PRECAST CONCRETE MANHOLE	308

COUNTY OF LOS ANGELES, CALIFORNIA
 THOMAS A. TIDEMANSON, DIRECTOR OF PUBLIC WORKS
 CHARLES W. CARRY, CHIEF ENGINEER
 APPROVED: [Signature] 11-22-92 DATE: 11-22-92
 CHECKED: [Signature] 11-22-92 DATE: 11-22-92
 LA PUENTE, BLDG. DIST. 20

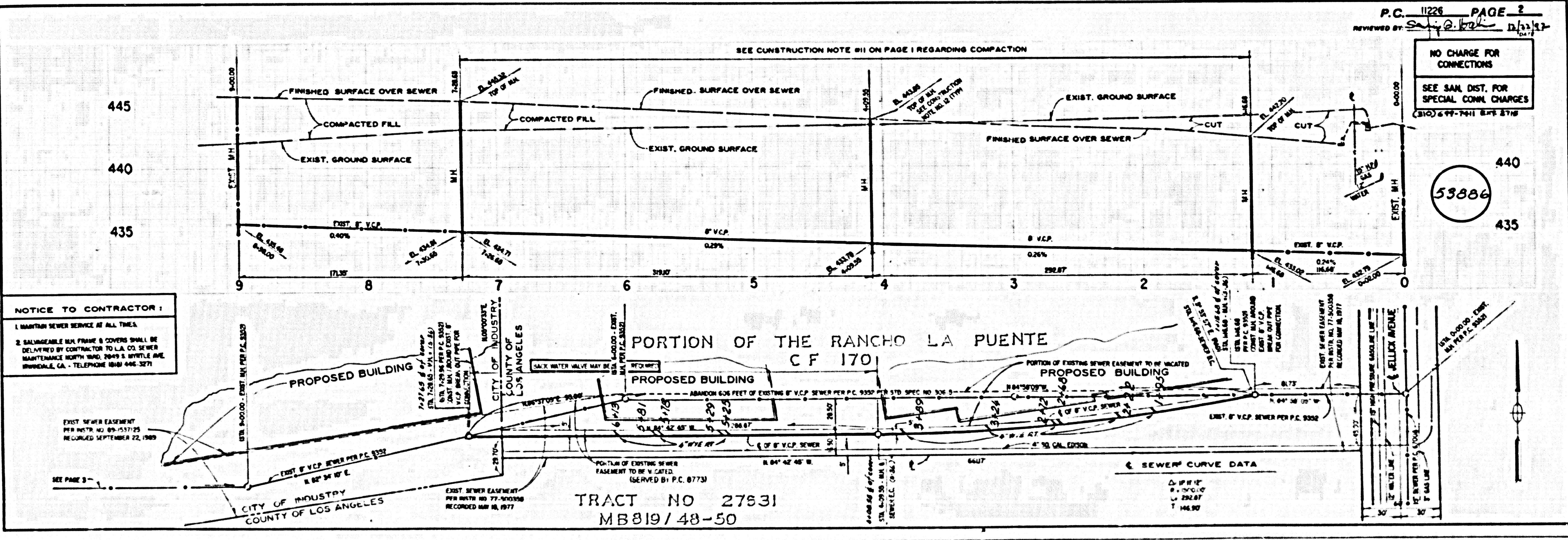

NOTICE TO CONTRACTOR:

1. SANITARY SEWER SERVICE AT ALL TIMES.
2. DRAINAGE BOX FRAME & COVERS SHALL BE DELIVERED BY CONTRACTOR TO L.A. CO. SEWER MAINTENANCE NORTH HALL, 2049 S. MYRTLE AVE, INGLEWOOD, CA. - TELEPHONE (800) 446-3271

TRACT NO 27631
 MB819/48-50

reviewed by: [Signature] 11/22/92

NO CHARGE FOR CONNECTIONS
 SEE SAN. DIST. FOR SPECIAL CONN. CHARGES
 (310) 699-7411 EXT. 8718

53886

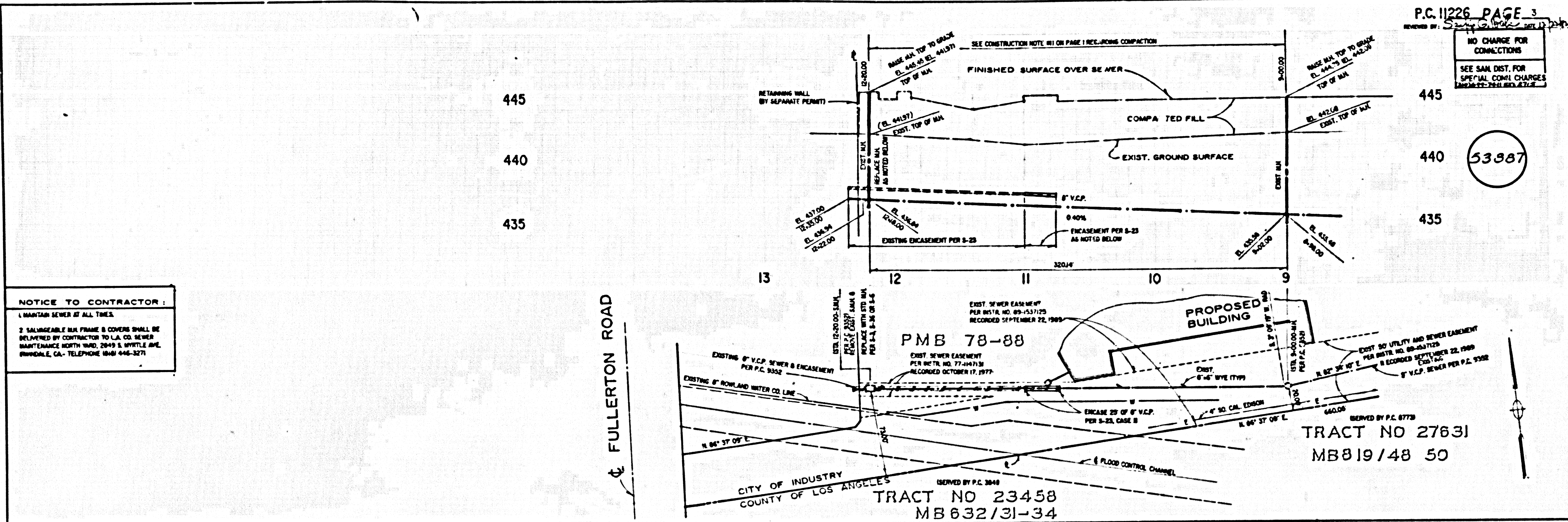

P.C. 11226 PAGE 3

NO CHANGE FOR CONNECTIONS
SEE SAN. DIST. FOR SPECIAL CONN. CHANGES

53887

NOTICE TO CONTRACTOR:
1. MAINTAIN SEWER AT ALL TIMES.
2. SALVAGEABLE MAN FRAMES & COVERS SHALL BE DELIVERED BY CONTRACTOR TO L.A. CO. SEWER MAINTENANCE NORTH TRACT, 2049 S. WHITTE AVE., INGLEWOOD, CALIF. TELEPHONE 484-4462-3271

FULLERTON ROAD

PMB 78-88
EXIST. SEWER EASEMENT PER INSTR. NO. 69-1537/25 RECORDED SEPTEMBER 22, 1969

PROPOSED BUILDING
EXIST. UTILITY AND SEWER EASEMENT PER INSTR. NO. 89-5547/25 RECORDED DECEMBER 22, 1969

TRACT NO 27631
MB819/48 50

CITY OF INDUSTRY
COUNTY OF LOS ANGELES
TRACT NO 23458
MB632/31-34

PAGE

B.C. 1155 (S)