

COUNTY OF LOS ANGELES DEPARTMENT OF PUBLIC WORKS

MARINA DEL REY

SANITARY SEWERS

TO BE LINED IN PALAWAN WAY & PROMENADE WAY

53916

RECORD PLANS

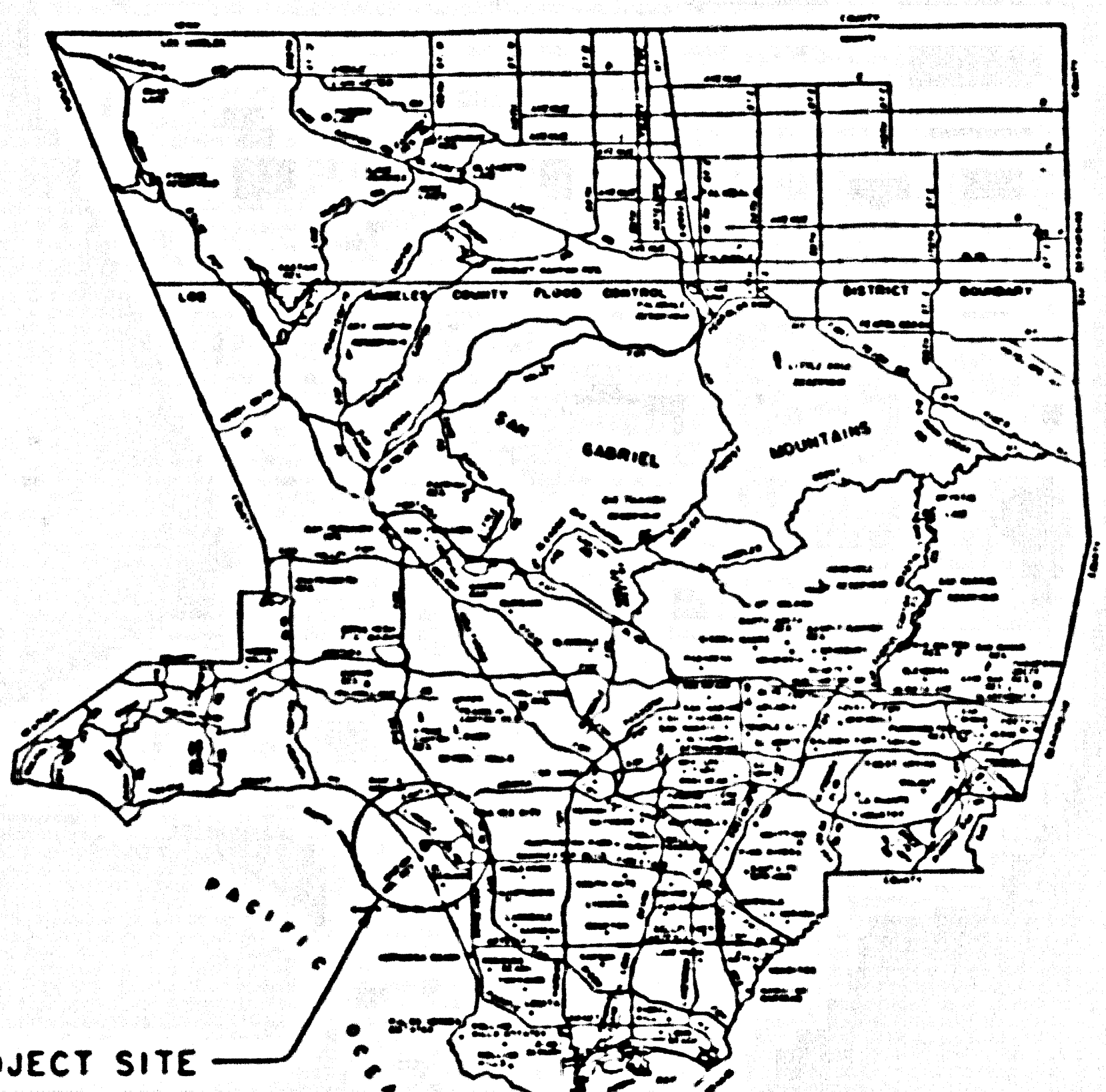

PROJECT SITE
TG Pg 672 (A-7)
016-Pg 49 (D-5)

LOCATION MAP

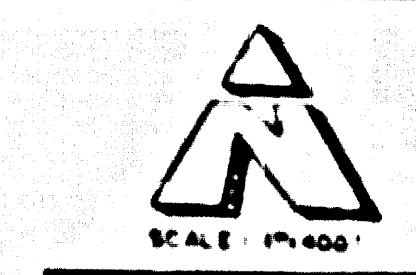
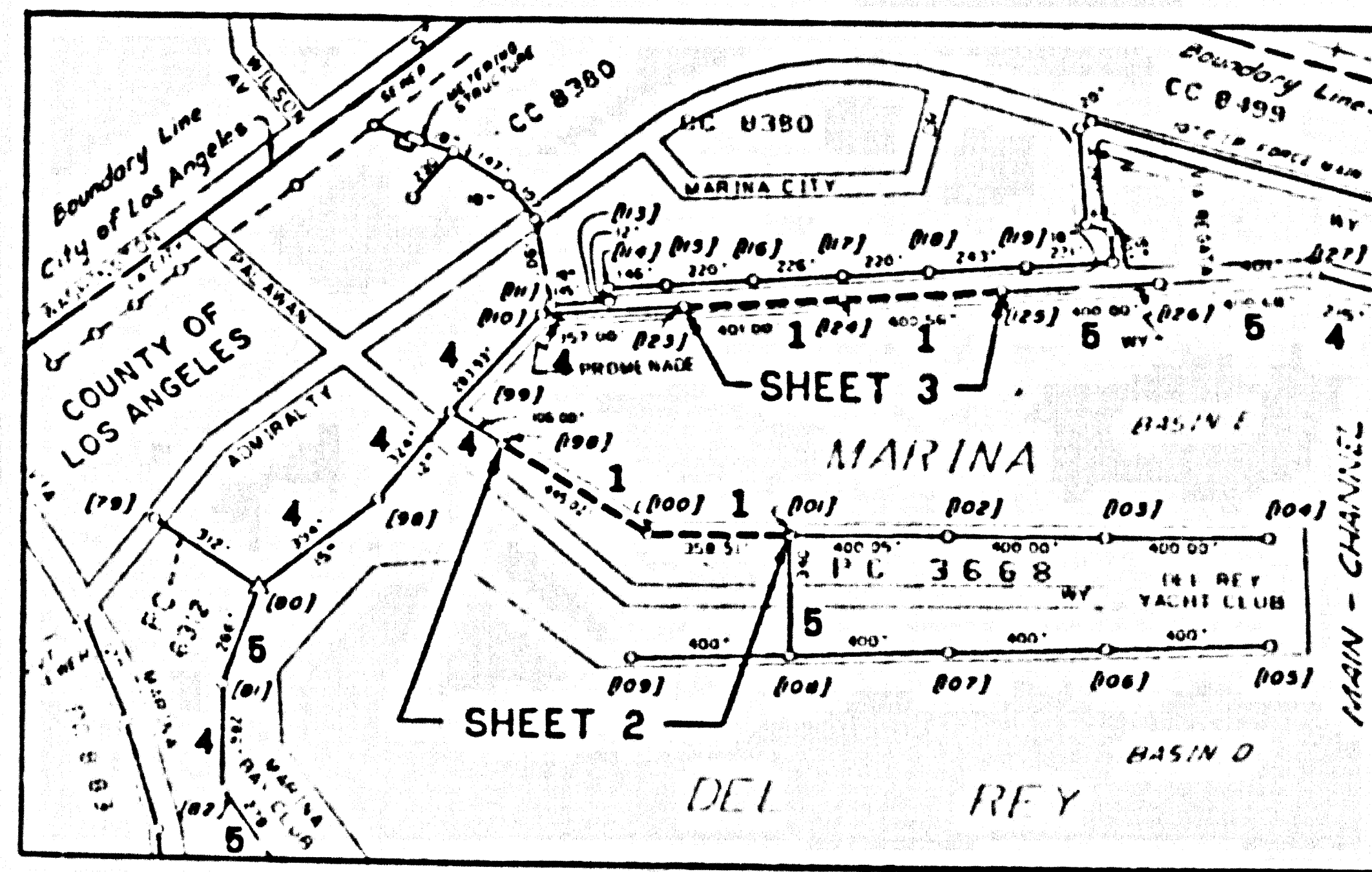

INDEX MAP

GENERAL NOTES:

1. NUMBERS 1 THROUGH 8 ON THE INDEX MAP, INDICATE THE CONDITIONS OF SEAWATER INFILTRATION. 1 AND 2 ARE IN BAD CONDITION, WHEREAS 3, 4, AND 5 ARE MODERATE.
2. NUMBERS IN BRACKETS [XXXX] IDENTIFY EXISTING MANHOLE STRUCTURES FOR CONTRACT ADMINISTRATION PURPOSES.
3. NUMBERS IN CIRCLES INDICATE ITEMS UNDER WHICH PAYMENT WILL BE MADE.
4. PLANS AND PROFILES OF THE EXISTING SEWER MAINLINES AND THE HOUSE LATERALS ARE RECORDS PER "AS BUILT" PLANS OF PC 3668, UNLESS OTHERWISE SHOWN. THE CONTRACTOR SHALL VERIFY THE EXACT LOCATIONS OF THE EXISTING SIX SEWER MANHOLES AND SEVENTEEN HOUSE LATERALS, WHICH SHALL BE RECONNECTED TO THE LINED SEWER MAINLINES. IT SHALL BE THE CONTRACTOR'S RESPONSIBILITY TO VERIFY THE LOCATIONS OF THESE AND ANY OTHER HOUSE LATERALS FROM THE LOMITA BUILDING AND SAFETY FIELD OFFICE, 24320 W. HARBORNE AVENUE LOMITA, CA 90717. TELEPHONE (310) 534-3760.
5. ELEVATIONS SHOWN ARE IN FEET ABOVE THE U.S.G.S. MEAN SEA LEVEL DATUM OF 1928.
6. THE CONTRACTOR SHALL MAINTAIN ALL SEWER SERVICES AT ALL TIMES DURING LINING PROCESS OF THIS PROJECT. THE CONTRACTOR SHALL PROVIDE NOTIFICATION OF WORK ACTIVITIES TO ALL LOCAL USERS AND PROVIDE INTERIM SEWER SERVICES AS NECESSARY. ADEQUATE PUMPING OPERATION AND PROPER METHOD SHALL BE USED TO CONTAIN ALL SEWAGE FLOWS.
7. THE WORK SHOWN ON THESE DRAWINGS REQUIRES THE PRIME CONTRACTOR TO HAVE A VALID CLASS A OR C42 LICENSE ISSUED BY THE STATE OF CALIFORNIA.

INDEX TO STANDARD DRAWINGS

APWA - AGC STANDARD PLANS

- 200-0 PRECAST CONCRETE SEWER MANHOLE
- 203-0 BRICK SEWER MANHOLE
- 210-1 24" MANHOLE FRAME AND COVER, LOCKING TYPE
- 630-1 24-INCH MANHOLE FRAME AND COVER
- 633-2 36-INCH MANHOLE FRAME AND COVER

LACDPW STANDARD PLANS

- 4000-0 LEGEND FOR SANITARY SEWER PLANS
- 2024-0 WYE OR TEE SUPPORT

REFERENCES

COUNTY OF LOS ANGELES (OLD COUNTY ENGINEERS DEPARTMENT)
"AS BUILT" DRAWINGS OF PC 3668 (J.N. 8910.76)
PAGES 23, 26, 45 3"X 6"

UTILITIES

- SANITARY SEWERS: COUNTY OF LOS ANGELES DEPARTMENT OF PUBLIC WORKS
- STORM DRAINS: COUNTY OF LOS ANGELES DEPARTMENT OF PUBLIC WORKS
- WATER LINE: SOUTHERN CALIFORNIA WATER COMPANY
- TELEPHONE LINE: PACIFIC BELL
- GAS LINES: SOUTHERN CALIFORNIA GAS COMPANY

INDEX TO DRAWINGS

SHEET NO.	TITLE
1	TITLE SHEET
2	PLAN AND PROFILE STA. 1+80.00 TO STA. 6+35.02 STA. 0+41.44 TO STA. 3+99.95
3	PLAN AND PROFILE STA. 4+98.44 TO STA. 13+00

CHECKED BY: J. W. [Signature]
 DESIGNED BY: J. W. [Signature]

APPROVED BY: [Signature] DIRECTOR OF PUBLIC WORKS	DATE: 11/18/93
RECOMMENDED BY: [Signature] ASSISTANT DEPUTY DIRECTOR	DATE: 11/17/92
REVIEWED BY: [Signature] Waterworks and Sewer Maintenance Division	DATE: 11/16/93

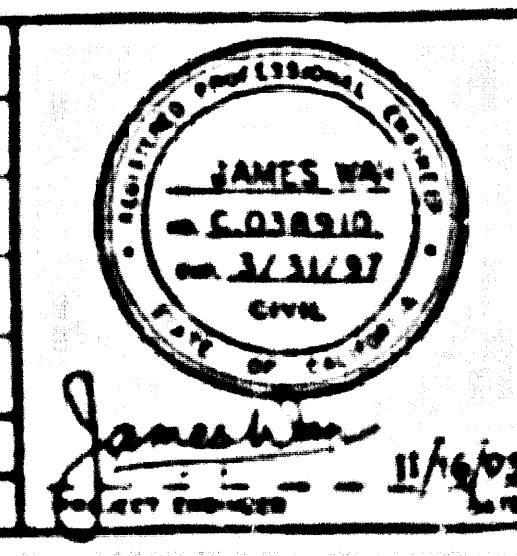

COUNTY OF LOS ANGELES DEPARTMENT OF PUBLIC WORKS
LINING FOR MARINA DEL REY SEWERS
CASH CONTRACT NO. 11263 - PHASE I
TITLE SHEET

53915

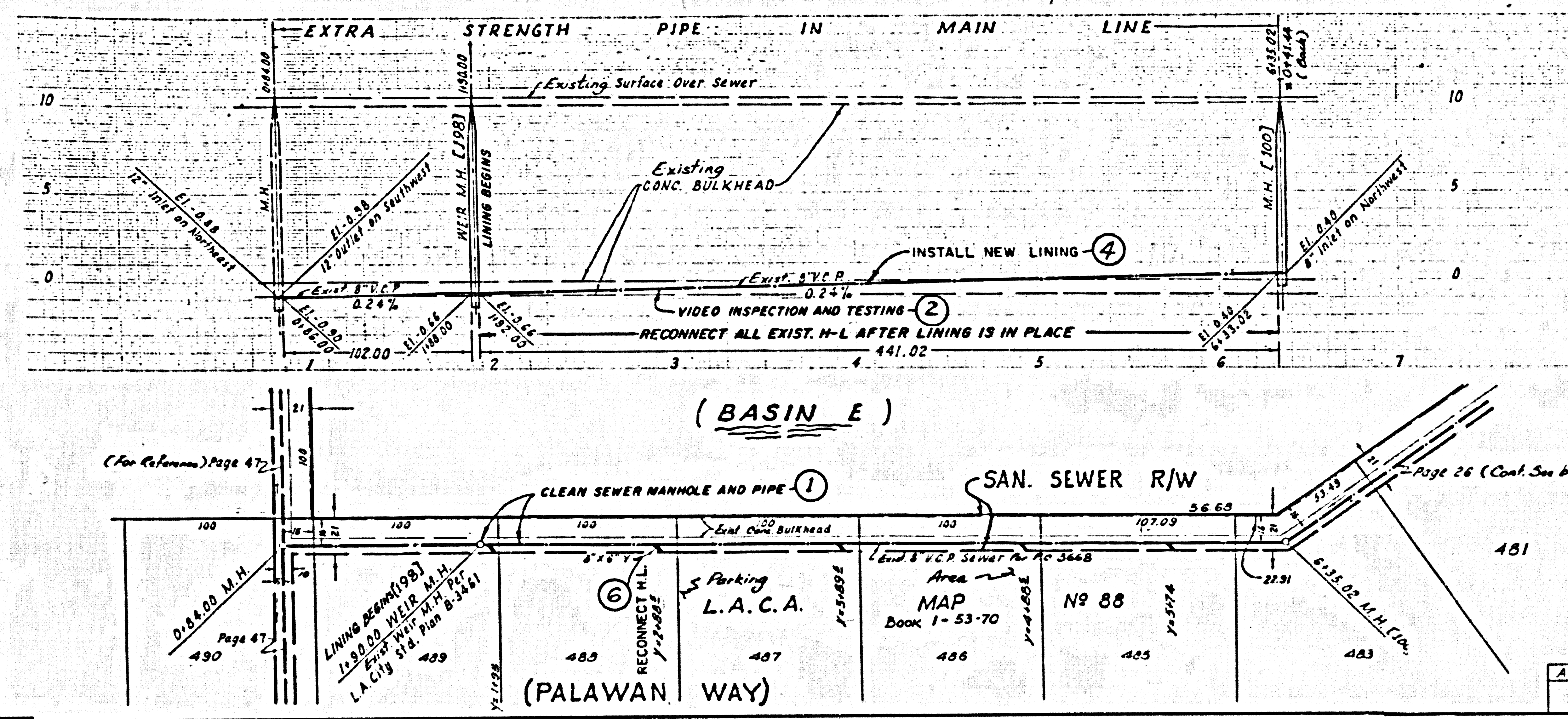

SCALE: -
HORIZ. 1" = 40'
VERT. 1" = 4'

APPROVED	MARK	DATE	REVISION
		5-15-60	New Sewer Alignment (For Reference)

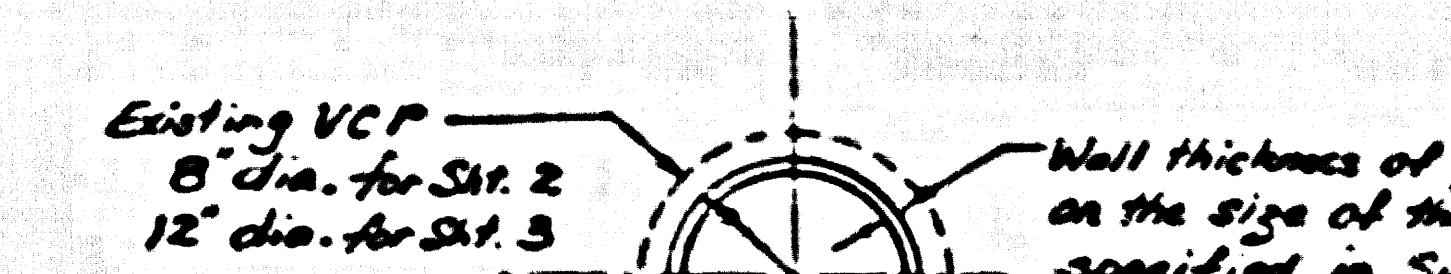
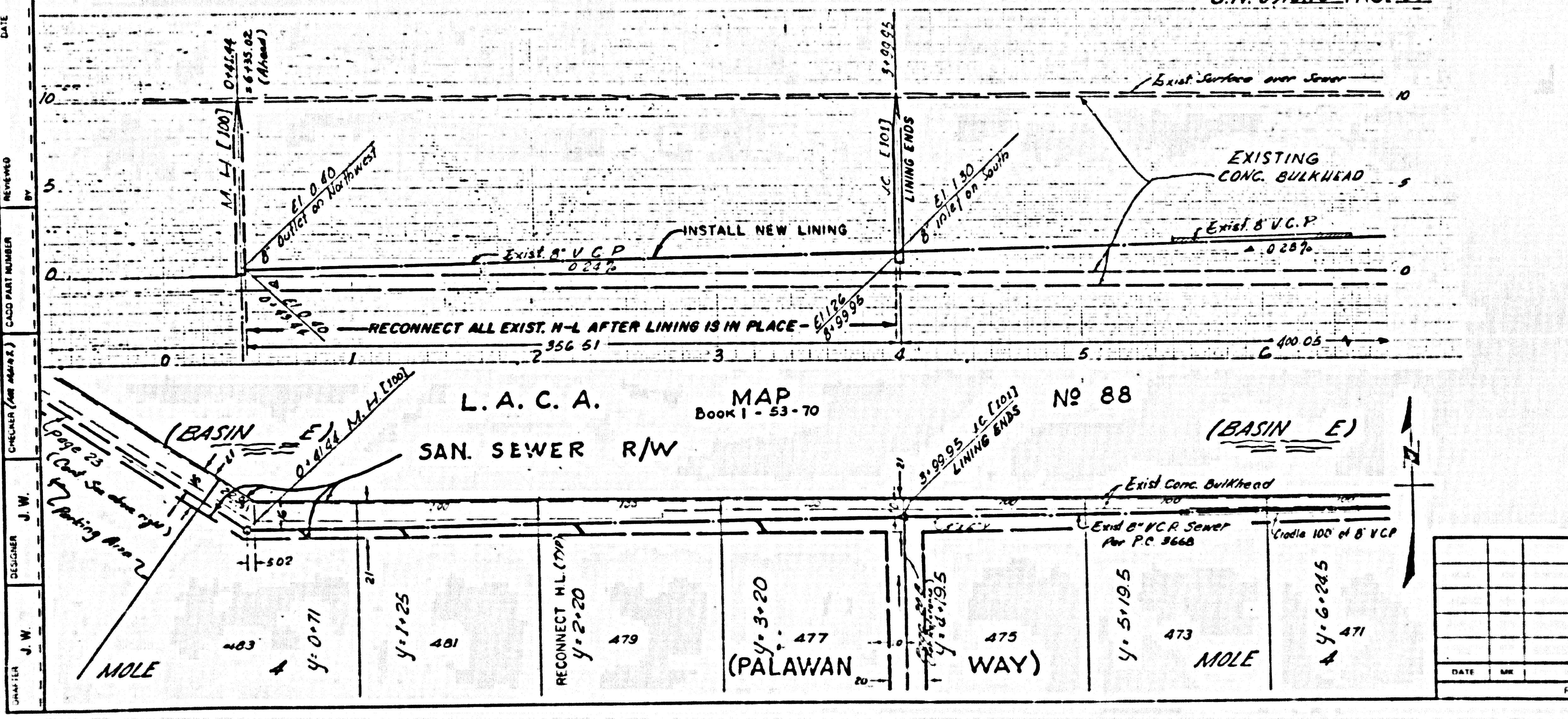

TYPICAL CROSS SECTION NO SCALE

DATE	REVIEWED BY	CHECKED (See MAPS)	CADD PART NUMBER
	J. W.	J. W.	
	J. W.	J. W.	

COUNTY OF LOS ANGELES DEPARTMENT OF PUBLIC WORKS

LINING FOR MARINA DEL REY SEWERS
CASH CONTRACT NO. 11263 - PHASE I
PLAN AND PROFILE

STA. 1+40.00 TO STA. 6+35.02
STA. 0+41.44 TO STA. 3+99.95

JOB Y050200 DRAWING SHEET 2 OF 3

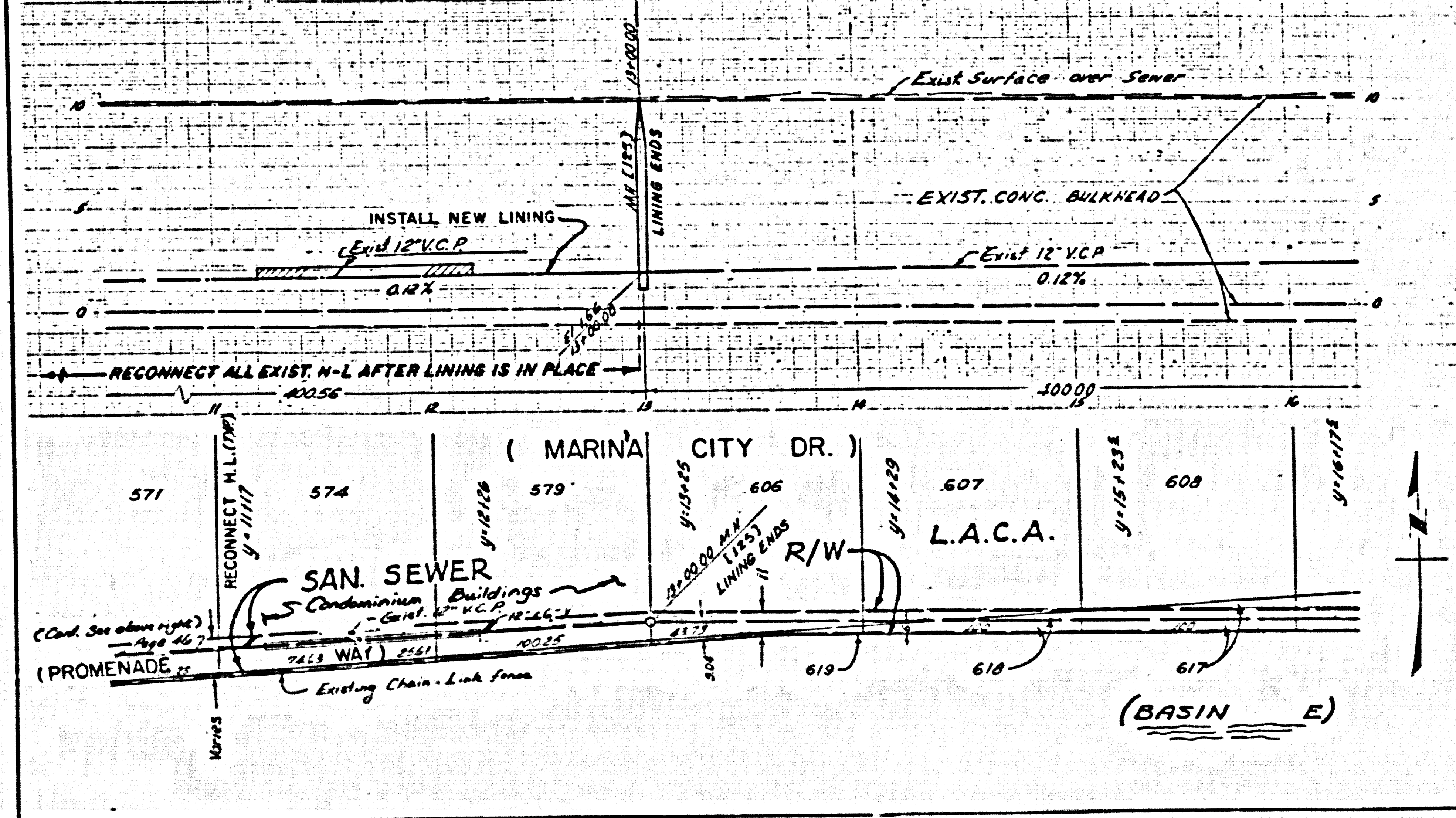
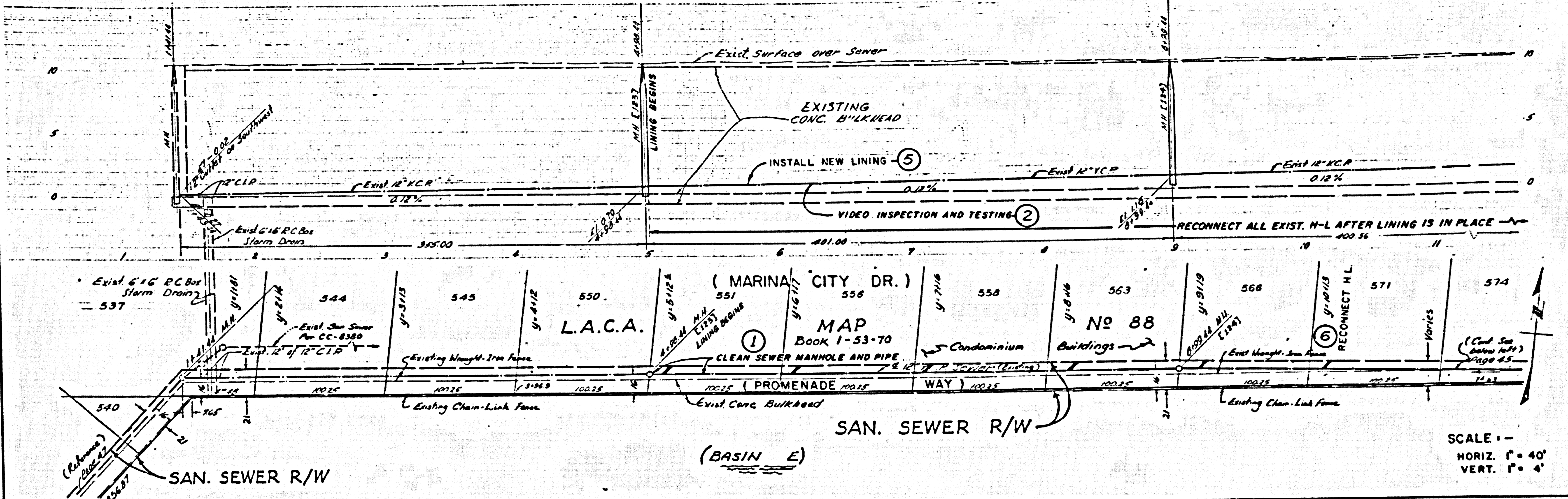

53917

DATE _____
 REVIEWED BY _____
 CHECKED BY _____
 DESIGNED BY J.W.
 DRAWN BY J.W.

DATE	BY	DESCRIPTION

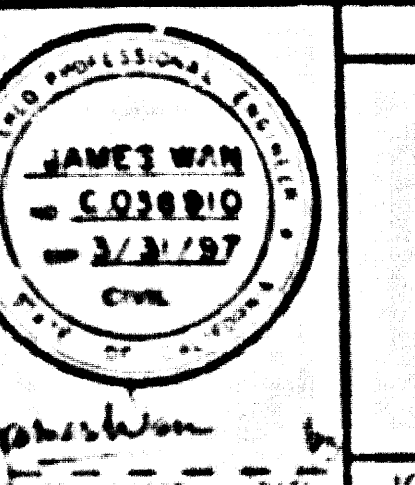

COUNTY OF LOS ANGELES DEPARTMENT OF PUBLIC WORKS
LINING FOR MARINA DEL REY SEWERS
 CASH CONTRACT NO. 11263-PHASE I
 PLAN AND PROFILE
 STA. 4+98.44 TO STA. 13+00.00
 JOB Y0502040 DRAWING _____ SHEET 3 OF 3