

# SANITARY SEWERS

TO BE CONSTRUCTED IN  
**HACIENDA BOULEVARD**  
**674' N/O FRANCISQUITO AVENUE**  
**PRIVATE CONTRACT NO. 11304**

INDEX: 2216  
1 SHEET OF 2 PAGES

SCALE: HORIZONTAL 1" = 40' VERTICAL 1" = 2'  
JANUARY, 1995

PREPARED IN THE OFFICES OF  
**CIVILTEC ENGINEERING, INC.**  
2025 W. Foothill Blvd.  
Monrovia, CA 91016  
(818) 202-0505  
REG. C.E. No. 42206

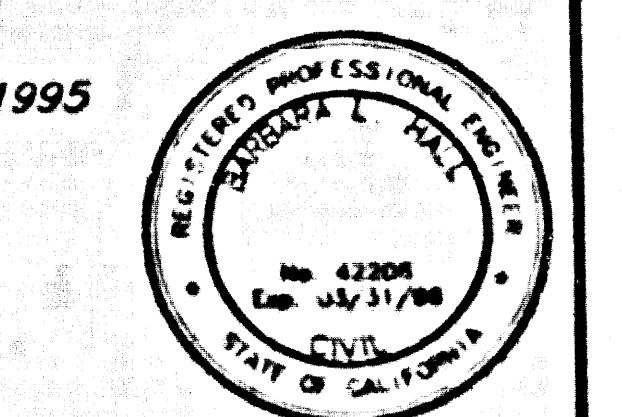

THE FOLLOWING LATEST REVISED STANDARD PLANS ON FILE IN THE OFFICE OF THE DEPARTMENT OF PUBLIC WORKS SHALL APPLY IN THE CONSTRUCTION OF THIS PROJECT:

LOS ANGELES COUNTY DEPARTMENT OF PUBLIC WORKS STANDARD PLANS	
LEGEND	2008-9
STANDARD PUBLIC SAFETY ENCOUNTERMENTS	2009-0
STANDARD PRECAST CONCRETE MANHOLE	2009-1
STANDARD MANHOLE RINGS	2009-2
STANDARD FOUR INCH PIPE	2009-3
STANDARD SIX INCH PIPE	2009-4
STANDARD EIGHT INCH PIPE	2009-5
STANDARD TEN INCH PIPE	2009-6
STANDARD FIFTEEN INCH PIPE	2009-7
STANDARD TWENTY INCH PIPE	2009-8
STANDARD TWENTYFOUR INCH PIPE	2009-9
STANDARD THIRTY INCH PIPE	2009-10
STANDARD FORTY TWO INCH PIPE	2009-11
STANDARD FIFTY FOUR INCH PIPE	2009-12
STANDARD SEVENTY TWO INCH PIPE	2009-13
STANDARD NINETY SIX INCH PIPE	2009-14
STANDARD TWELVE INCH MANHOLE	2009-15
STANDARD SIX INCH MANHOLE	2009-16
STANDARD FIVE INCH MANHOLE	2009-17
STANDARD CONCRETE SPALLER MANHOLE	2009-18

American Public Works Association Standard Plans:  
SEWER MANHOLE LOCATING MANHOLE PEGS AND COVERS 202  
PUBLIC CONCRETE SPALLER MANHOLE 210

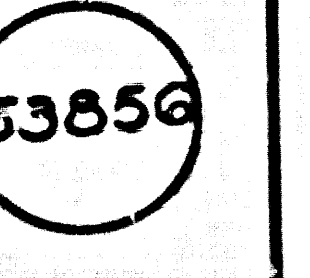

COUNTY OF LOS ANGELES, CALIFORNIA  
HARRY W. STONE  
DIRECTOR OF PUBLIC WORKS

CHARLES E. CARR  
CHIEF ENGINEER  
AS SHOWN ON

APPROVED: *Thomas Wilson* 4/13/95  
APPROVED: *Charles Carr* 4/16/95  
CHECKED: *Phil...* 4/13/95  
DATE: 4/13/95

CITY OF WEST COVINA  
REVIEWED FOR COMPLIANCE  
*...* 4/13/95

LA PUENTE BLDG. DIST. 2

### PRIVATE ENGINEER'S NOTE TO CONTRACTORS

THESE PLANS AND SPECIFICATIONS HAVE BEEN PREPARED BY ME AS A PROFESSIONAL ENGINEER...  
*John M. Hill* 42206  
REGISTERED ENGINEER  
STATE OF CALIFORNIA

### GENERAL NOTES:

- ALL WORK SHALL BE CONSTRUCTED ACCORDING TO THE STANDARD SPECIFICATIONS FOR PUBLIC WORKS CONSTRUCTION...- NO WORKING SHALL BE DONE IN THESE PLACES WITHOUT THE APPROVAL OF THE DIRECTOR OF PUBLIC WORKS...- NO REPRESENTATIVE OF THE DEPARTMENT OF PUBLIC WORKS WILL BE ON THE JOB AT ANY TIME...- CONTRACTOR SHALL BE RESPONSIBLE FOR OBTAINING ALL NECESSARY PERMITS...- THE CONTRACTOR SHALL FURNISH ALL NECESSARY MATERIALS...- THE CONTRACTOR SHALL FURNISH THE NECESSARY LABELS...- BEFORE WORK CAN BE STARTED, THE CONTRACTOR SHALL OBTAIN A PERMIT TO OCCUPY ALL STREET SPACES...- IF WORK IS TO BE DONE IN A STREET OR ALLEY, THE CONTRACTOR SHALL OBTAIN A PERMIT FROM THE CITY...- APPROVAL OF THIS PLAN BY THE COUNTY OF LOS ANGELES DOES NOT CONSTITUTE A REPRESENTATION...- WORK IN EXISTING TRENCHES OF THE SEWERAGE SYSTEMS, EXISTING SEWER LINES...- WORK SHALL BE CONSTRUCTED ACCORDING TO THE STANDARD SPECIFICATIONS FOR PUBLIC WORKS CONSTRUCTION...- THE CONTRACTOR SHALL NOTIFY THE DEPARTMENT OF PUBLIC WORKS...- HOUSE LATERALS TO BE CONSTRUCTED WITH CONCRETE...- ONE OR TWO SIZES OF PIPE MAY BE USED FOR CONNECTIONS...- ALL STRUCTURES SHALL BE BUILT ON PREPARED FOUNDATIONS...- PROTECT EXISTING SEWER LINES...- REINFORCE CONCRETE WITH STEEL...- IF A ROAD SHALL BE CLOSED...- IF PLACING THE CURB OF CONSTRUCTION...- ALL JOBS BETWEEN CURB AND ROAD...- SEWER TO BE REPEATED FOR LEAKAGE...- REFERENCE ALL THE CITY ENGINEER'S STANDARD SPECIFICATIONS...- ALL COMPLIANCE WITH SECTION 200-1.3.4...- FINAL CHECKER AND APPROVED BY A QUALIFIED REGISTERED PROFESSIONAL ENGINEER...- ALL WORK SHALL BE CONSTRUCTED ACCORDING TO THE STANDARD SPECIFICATIONS...- CONTRACTOR SHALL BE RESPONSIBLE FOR OBTAINING ALL NECESSARY PERMITS...- THE CONTRACTOR SHALL FURNISH ALL NECESSARY MATERIALS...- THE CONTRACTOR SHALL FURNISH THE NECESSARY LABELS...- BEFORE WORK CAN BE STARTED, THE CONTRACTOR SHALL OBTAIN A PERMIT...- IF WORK IS TO BE DONE IN A STREET...- APPROVAL OF THIS PLAN...- WORK IN EXISTING TRENCHES...- WORK SHALL BE CONSTRUCTED...

### CONSTRUCTION NOTES:

- HOUSE LATERALS TO BE CONSTRUCTED WITH CONCRETE...- ONE OR TWO SIZES OF PIPE MAY BE USED FOR CONNECTIONS...- ALL STRUCTURES SHALL BE BUILT ON PREPARED FOUNDATIONS...- PROTECT EXISTING SEWER LINES...- REINFORCE CONCRETE WITH STEEL...- IF A ROAD SHALL BE CLOSED...- IF PLACING THE CURB OF CONSTRUCTION...- ALL JOBS BETWEEN CURB AND ROAD...- SEWER TO BE REPEATED FOR LEAKAGE...- REFERENCE ALL THE CITY ENGINEER'S STANDARD SPECIFICATIONS...- ALL COMPLIANCE WITH SECTION 200-1.3.4...- FINAL CHECKER AND APPROVED BY A QUALIFIED REGISTERED PROFESSIONAL ENGINEER...- ALL WORK SHALL BE CONSTRUCTED ACCORDING TO THE STANDARD SPECIFICATIONS...- CONTRACTOR SHALL BE RESPONSIBLE FOR OBTAINING ALL NECESSARY PERMITS...- THE CONTRACTOR SHALL FURNISH ALL NECESSARY MATERIALS...- THE CONTRACTOR SHALL FURNISH THE NECESSARY LABELS...- BEFORE WORK CAN BE STARTED, THE CONTRACTOR SHALL OBTAIN A PERMIT...- IF WORK IS TO BE DONE IN A STREET...- APPROVAL OF THIS PLAN...- WORK IN EXISTING TRENCHES...- WORK SHALL BE CONSTRUCTED...

NO CONNECTION FOR THE DISPOSAL OF INDUSTRIAL WASTES SHALL BE MADE TO SEWERS SHOWN ON THESE DRAWINGS UNLESS A PERMIT FOR INDUSTRIAL WASTEWATER DISCHARGE HAS BEEN ISSUED BY THE SANITATION DISTRICTS FOR SAID CONNECTION.

BEFORE BREAKING INTO OR CONSTRUCTION ON A COUNTY SANITATION DISTRICT SEWER AND PRIOR TO FINAL ACCEPTANCE OF THE PROJECT, SANITATION DISTRICT SUPERVISOR SHALL BE NOTIFIED BY PHONE (818) 962-8800 SO THAT REQUIRED INSPECTION CAN BE MADE.

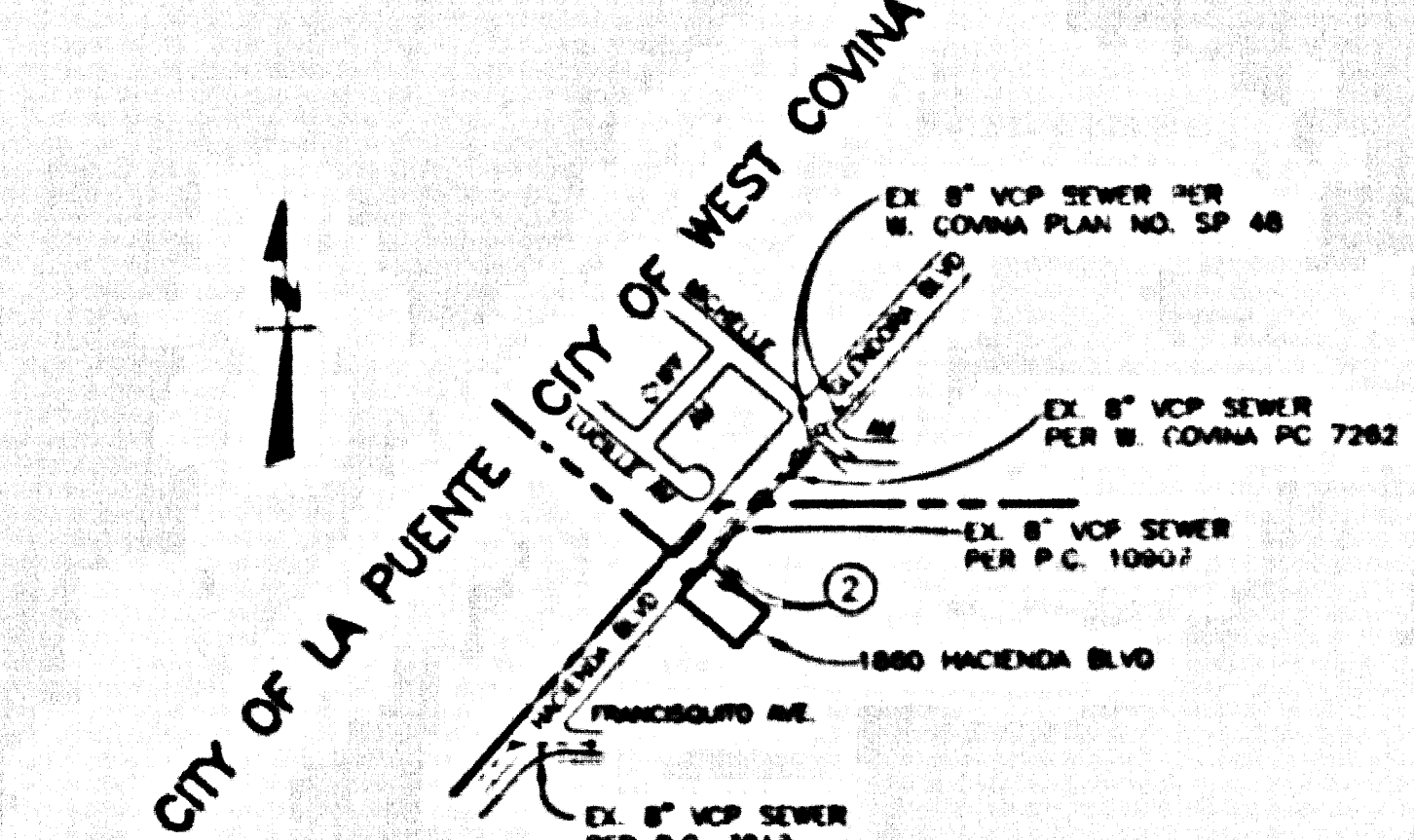
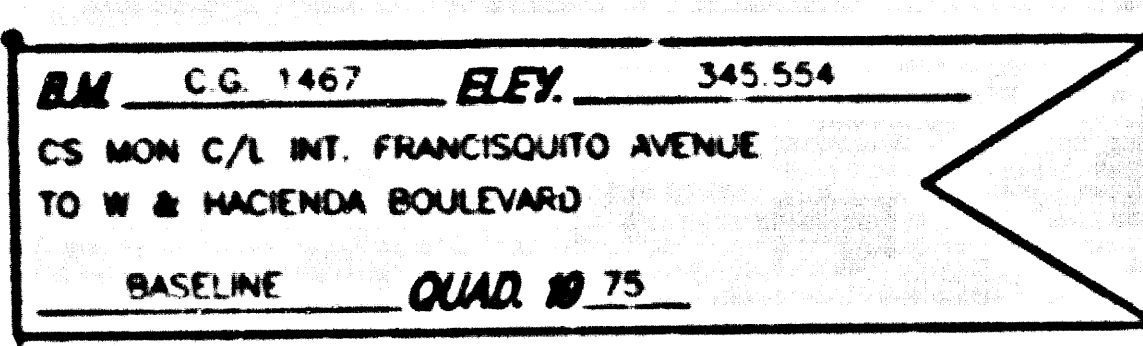

NOTE: NUMBER IN CIRCLE INDICATES PAGE NUMBER

INDEX MAP  
HACIENDA BOULEVARD  
N/O FRANCISQUITO AVENUE  
SCALE 1"=800'  
THOMAS GUIDE PG. 638-E3  
PRIVATE CONTRACT NO. 11304

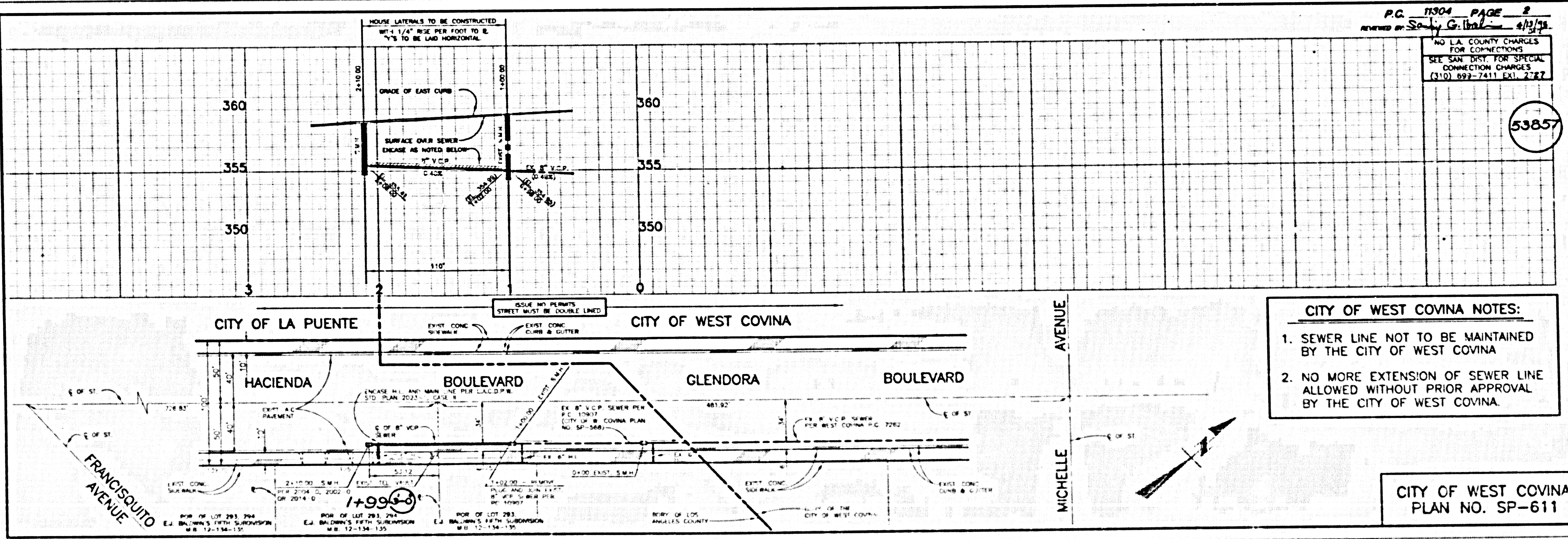

### CITY OF WEST COVINA NOTES:

- SEWER LINE NOT TO BE MAINTAINED BY THE CITY OF WEST COVINA
- NO MORE EXTENSION OF SEWER LINE ALLOWED WITHOUT PRIOR APPROVAL BY THE CITY OF WEST COVINA.

CITY OF WEST COVINA  
PLAN NO. SP-611

P.C. 11304 PAGE 2  
REVIEWED BY: *Sally G. Hall* 4/13/95  
NO L.A. COUNTY CHARGES FOR CONNECTIONS  
SEE SAN DIST FOR SPECIAL CONNECTION CHARGES  
(310) 692-7411 EX. 2727

