

STORMWATER POLLUTION CONTROL REQUIREMENTS FOR SEWER CONSTRUCTION

- Eroded sediments and other pollutants must be retained on site and may not be transported from the site via sheet flow, swales, area drains, natural drainage courses, or wind.
- Stockpiles of earth and other construction related materials must be protected from being transported from the site by the forces of wind or water.
- Fuels, oils, solvents, and other toxic materials must be stored in accordance with their listing and are not to contaminate the solid surface waters. Approved storage containers are to be protected from the weather. Spills must be cleaned up immediately and disposed of in a proper manner. Spills may not be washed into the drainage system.
- Excess or waste concrete may not be washed into the public way or any other drainage system. Provisions shall be made to retain concrete wastes on site until they can be disposed of as solid waste.
- Trash and construction-related solid wastes must be deposited into a covered receptacle to prevent contamination of rainwater and dispersal by wind.
- Sediments and other materials may not be tracked from the site by vehicle traffic. The construction entrance roadways must be stabilized so as to inhibit sediments from being deposited into the public way. Accident obstructions must be swept up immediately and may not be washed down by rain or other means.
- Any slopes with disturbed soils or denuded of vegetation must be stabilized so as to inhibit erosion by wind and water.

- | | |
|--|---|
| CA00 - DEMOLITION OPERATIONS | ES00 - SEEDING AND PLANTING |
| CA02 - PAVING OPERATIONS | ES01 - MULCHING |
| CA03 - STRUCTURE CONSTRUCTION AND PAINTING | ES02 - GEOTEXTILES AND MATS |
| CA04 - MATERIAL DELIVERY AND STORAGE | ES03 - DUST CONTROLS |
| CA05 - SOLID WASTE MANAGEMENT | ES04 - TEMPORARY STREAM CROSSING |
| CA06 - HAZARDOUS WASTE MANAGEMENT | ES05 - CONSTRUCTION ROAD STABILIZATION |
| CA07 - CONCRETE WASTE MANAGEMENT | ES06 - STABILIZED CONSTRUCTION ENTRANCE |
| CA08 - SANITARY/SEPTIC WASTE MANAGEMENT | ES07 - STORM DRAIN INLET PROTECTION |
| CA09 - VEHICLE AND EQUIPMENT CLEANING | |
| CA10 - VEHICLE AND EQUIPMENT FUELING | |
| CA11 - SCHEDULING | |
| CA12 - VEHICLE AND EQUIPMENT MAINTENANCE | |
| CA13 - SCHEDULING | |
| ES02 - PRESERVATION OF EXISTING VEGETATION | |

STANDARD PLANS:
THE FOLLOWING LATEST REVISED STANDARD PLANS ON FILE IN THE OFFICE OF THE FOLLOWING DEPARTMENT SHALL APPLY IN THE CONSTRUCTION OF THIS PROJECT.
LOS ANGELES COUNTY DEPARTMENT OF PUBLIC WORKS

COUNTY SANITATION DISTRICT OF LA COUNTY
S-A-204 STANDARD MANHOLE, TYPE "D"
S-A-209 STANDARD MANHOLE STEP
S-A-220 STANDARD PULL RING
S-A-228 STD 24" TERRAZO MH FRAME & COVER

- CONSTRUCTION NOTES (cont...)**
- NO CONNECTION FOR DISPOSAL OF INDUSTRIAL WASTES SHALL BE MADE TO SEWERS SHOWN ON THESE DRAWINGS UNLESS A PERMIT FOR INDUSTRIAL WASTE WATER DISCHARGE HAS BEEN ISSUED BY THE SANITATION DISTRICTS FOR SAID CONNECTION.
 - BEFORE BREAKING INTO OR CONSTRUCTION ON A COUNTY SANITATION DISTRICT SEWER AND PRIOR TO FINAL ACCEPTANCE OF THE PROJECT, A SANITATION DISTRICT INSPECTOR SHALL BE NOTIFIED BY PHONE AT (626) 962-8605 SO THAT REQUIRED INSPECTION CAN BE MADE.

PRIVATE CONTRACT SEWER GENERAL NOTES

- The following general notes are to be included on Page 1 of Private Contract Sewer Plans:
1.1. A sewer construction permit shall be obtained and a fee paid for construction inspection and record plans to the Department of Public Works (DPW) at the Permit Counter, 900 South Fremont Avenue, 8th Floor, at least 72 hours prior to starting work under this permit. Copies of all other required permits, such as Road Excavation, Contrans, etc. must be filed with the permit application.
1.2. Prior to issuance of any permit, the Contractor shall file a permit for excavations and trenches with the State of California Division of Industrial Safety and a Certificate of Worker's Compensation Insurance with the DPW named as the Certificate Holder to notified thirty (30) days prior to beginning work.
1.3. If work is done in a State highway, a permit must be obtained from the State of California Division of Highways, 500 South Spring Street, Los Angeles, California.
1.4. When work is within a contract city, the Contractor must contact the Director of Public Works of that city, to determine the location to pay the inspection fee.
1.5. The Contractor shall contact the district office listed on the "Application for Construction Permit" to arrange for an acceptable construction start date.
1.6. Approval of this plan by the County of Los Angeles does not constitute a representation as to accuracy of the location, depth, the existence or non-existence of any underground utility, pipe or structure within the limits of this project. This note applies to all projects.
1.7. All work shall be in accordance with the latest approved edition of the Standard Specifications for Public Works Construction, including easements and the latest Specifications for the construction of Sanitary Sewer and shall be prosecuted only in the presence of the DPW.
1.8. The Contractor's work shall conform to the "Safety Orders" section 7-0.4 of the Standard Specifications for Public Works Construction.
1.9. Elevations are in feet above U.S.C.A.S. sea level datum of 1929.
1.10. No revisions shall be made in these plans without the approval of the Director of Public Works.
1.11. No representative of the DPW shall survey or layout any portion of the work.
1.12. Grades to which this improvement is to be constructed are shown on plans and profiles. Grade points for top of curbs, centerline of streets, or centerline of alleys are shown by circles on profiles at points between designated points. The grade shall be established so as to conform to a straight line drawn between said designated points.
1.13. The private engineer shall furnish the DPW with grade sheets and staking for all house laterals and "T" branches and shall provide stakes for them at their proper locations with staking plan marked. House laterals shall be constructed in a straight alignment or right angles from the main line sewer except as shown on the plans. House laterals from chimneys shall have an angle of less than 45 degrees with the main sewer. Any change in alignment shall be requested in writing by the private engineer.
1.14. The private engineer shall furnish the house lateral depth at the property line below the top of curb elevation for each house lateral on the grade sheet.

CONSTRUCTION NOTES

- Private survey stakes on the property line or property lines produced at right angles to the sewer line at the centerline of each manhole.
- Vitrified clay pipe joints shall be type "D" or "D" per standard specifications section 208-2.
- If a powerpole is within three feet of the sewer, the sewer shall be encased per standard plan S-23, case B, two feet on each side from the point of interference.
- All joints between cast iron pipe and vitrified clay shall be made with a rubber sleeve joint, type "D" with bushing if necessary per standard specifications section 208-2.
- House laterals to be constructed with inverts at the property line 6 feet below curb grade except as noted.
- Wye or tee branches may be used for connections to the mainline sewers except as noted.
- If during the course of construction, it is determined that there is less than four feet of cover over the top of a manhole or house lateral, a brick sewer which is not included on the plans, the pipe shall be encased per standard plan S-23, case A, unless otherwise approved by the Director of Public Works.
- Structures shall be either brick sewer manholes per standard plan S-13 or precast concrete sewer manholes per standard plan S-16 or reinforced precast concrete manhole per standard plan S-18, except as noted.
- Resurface of trenches within paved areas to meet Los Angeles County Public Works or California State Highway requirements in accordance with the permits.
- Full compliance with section 306.13.4 of the standard specification will be required for backfill street certification of backfill compaction and sand equivalents by a qualified civil engineer shall be provided by the permittee prior to the issuance of a certificate of partial completion.
- Backfilling shall be outside of the street right of way shall be compacted to 90% of the maximum density as determined by ASTM soil compaction test D 1557-78 method D unless otherwise specified. This shall be certified by a qualified civil engineer. This certification shall be submitted to the Construction Division of the Department of Public Works prior to the acceptance of the work by the county.
- Manhole tops in unimproved rights of way to be six inches above finished grade.
- Sewers to be tested for leakage per section 306.14 of the standard specifications and special provisions.

PROFILE, ALIGNMENT AND GRADE OF
SANITARY SEWERS 54688

TRACT NO. 52390 PC NO. 11411
1 SHEET: 2 PAGES
COUNTY OF LOS ANGELES CALIFORNIA
INDEX 1861

HARRY STONE DIRECTOR OF PUBLIC WORKS

APPROVED: BUILDING & SAFETY/LAND DEVELOPMENT DIVISION
By: *Ronald L. Leland* 7-23-98
ASSISTANT DIVISION CHIEF DATE

SUBMITTED: *John M. Cruikshank* 7-14-98
SUBMISSION PLAN CHECKING SECTION DATE

APPROVED: COUNTY SANITATION DISTRICT
CHARLES W. CARRIS - CHIEF ENGINEER AND GENERAL MANAGER
COUNTY SANITATION DISTRICT NO. 2
By: *William J. ...* DATE: 8/25/98
OFFICE ENGINEER

PRIVATE ENGINEERS NOTICE TO CONTRACTORS:
THE EXISTENCE AND LOCATION OF ANY UNDERGROUND UTILITY PIPES OR STRUCTURES SHOWN ON THESE PLANS IS REQUIRED BY A SEARCH OF AVAILABLE RECORDS TO THE BEST OF OUR KNOWLEDGE. THERE ARE NO EXISTING UTILITIES EXCEPT AS SHOWN ON THIS MAP. THE CONTRACTOR IS REQUIRED TO TAKE PRECAUTIONARY MEASURES TO PROTECT THE UTILITY LINES SHOWN AND ANY OTHER LINES NOT OF RECORD OR NOT SHOWN ON THIS DRAWING. PRIOR TO EXCAVATION THE CONTRACTOR SHALL CALL TOLL FREE 1-800-485-4833 TO VERIFY THE UNDERGROUND LOCATION OF GAS AND TELEPHONE LINES. THE CONTRACTOR SHALL ALSO CALL WIRY DUMMIES OF GENERAL TELEPHONE COMPANY AT 1-800-548-4875 SO THAT THEY CAN MARK THE LOCATION OF UNDERGROUND TELEPHONE LINES.
By: *John M. Cruikshank* July 14, 1998
DATE
JOHN M. CRUIKSHANK P.E. 50792 - EXP. 9-30-01

NO.	REVISION	REVISED BY	APPROVED BY	DATE
1	SEWER PROFILE ② - P.P.E. LENGTH, MH DEPT'S, INVERT ELEVATIONS	<i>John M. Cruikshank</i>	<i>William J. ...</i>	7/14/98

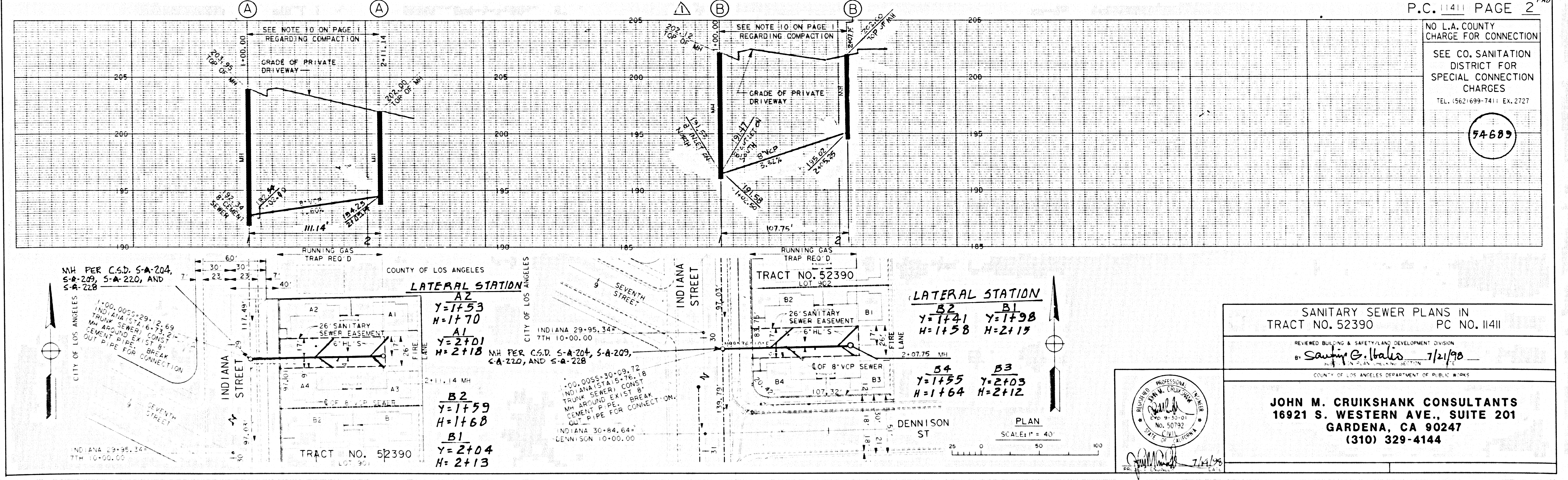

P.C. 11411 PAGE 2

NO L.A. COUNTY CHARGE FOR CONNECTION
SEE CO. SANITATION DISTRICT FOR SPECIAL CONNECTION CHARGES
TEL: (562) 699-7411 EX. 2727
54688

SANITARY SEWER PLANS IN
TRACT NO. 52390 PC NO. 11411

REVIEWED BUILDING & SAFETY/LAND DEVELOPMENT DIVISION
By: *Sammy E. ...* 7/21/98
COUNTY OF LOS ANGELES DEPARTMENT OF PUBLIC WORKS

JOHN M. CRUIKSHANK CONSULTANTS
16921 S. WESTERN AVE., SUITE 201
GARDENA, CA 90247
(310) 329-4144

1

11411.09

DEESS ON TChart