

**BENCH MARK**  
 NEHWALL 1983  
 CL 3069  
 L & BN IN CONC. FTG C/L FENCE POST 68 FT. W/LY C/L CLD RD  
 & 0.35 MI N/WY OF WLY ON OFF RAMP GOLDEN  
 STATE FRWY 771 N/O GUNITE DRAINAGE DITCH E SIDE F.C.  
 CHANNEL W/O (BN)  
 NOTE: PC 11531, THE DOWNSTREAM CONNECTION IS ON  
 THE FOLLOWING BENCHMARK. 1995 ELEV'S ARE 2.3' HIGHER.

**BENCH MARK**  
 BM L.A. COUNTY B.M. 5402 ELEV. 1031.950  
 RND. HD. SPK. TOP OF LOWEST HDWL 24 FT  
 W/O C/L THE OLD ROAD (W. ROW) & 0.6  
 MI S/O HENRY MAYO DR. NEHWALL QUAD 1995

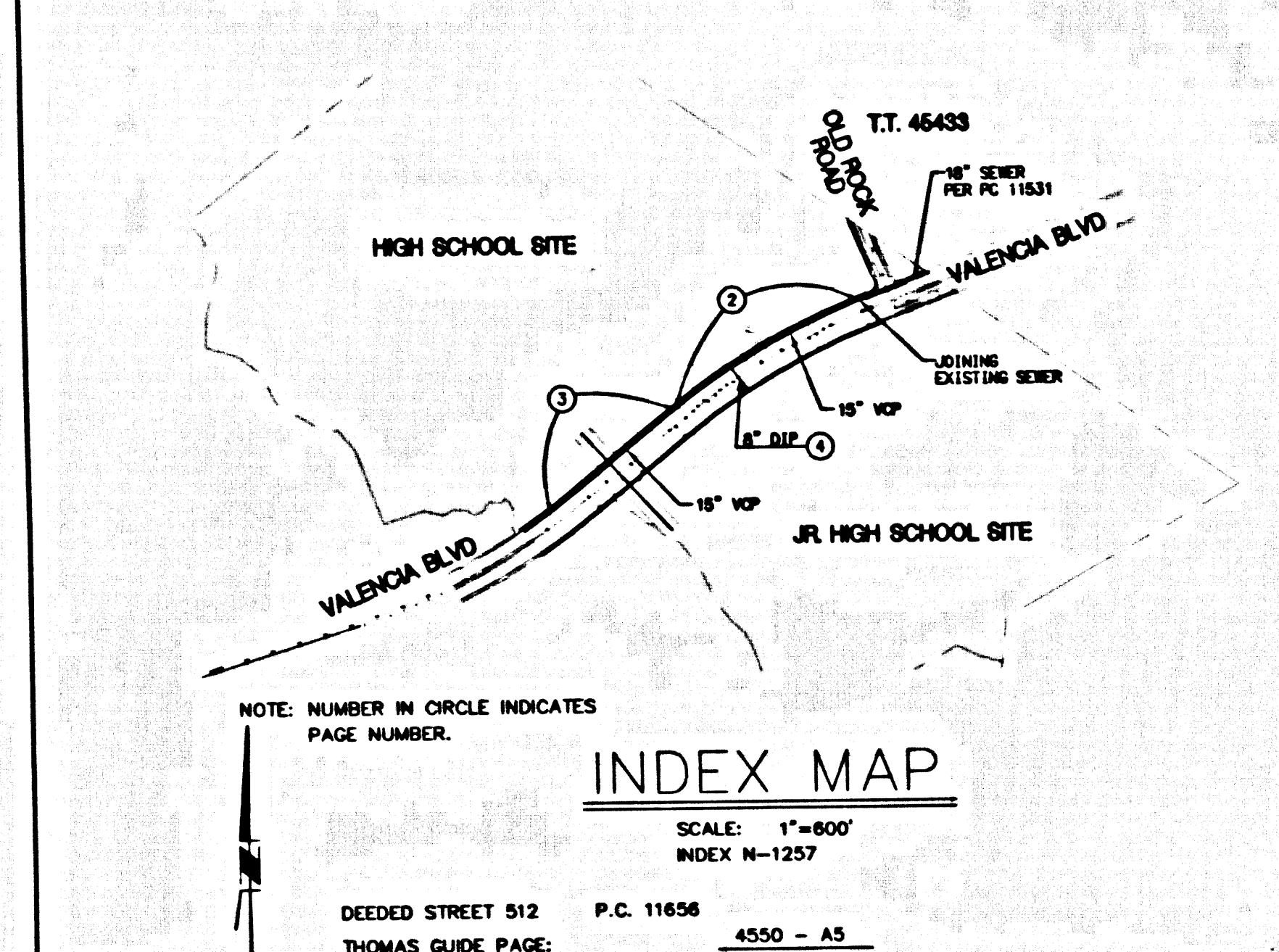

NO.	REVISION	REVISED BY	APPROVED BY	DATE

**STORMWATER POLLUTION CONTROL REQUIREMENTS FOR SEWER CONSTRUCTION**

- Erosion sediments and other pollutants must be retained on site and not be transported from the site via sheet flow, swales, area drains, natural drainage courses, or wind.
- Stockpiles of earth and other construction related materials must be protected from being transported from the site by the forces of wind or water.
- Fuels, oils, solvents, and other toxic materials must be stored in accordance with their listing and are not to contaminate the soil and surface waters. All approved storage containers are to be protected from the weather. Spills must be cleaned up immediately and disposed of in a proper manner. Spills may not be washed into the drainage system.
- Excess or waste concrete may not be trocked into the public way or any other drainage system. Provisions shall be made to retain concrete waste on site until they can be disposed of as solid waste.
- Trash and construction-related solid wastes must be deposited into a covered receptacle to prevent contamination of rainwater and dispersed by wind.
- Sediments and other materials may not be trocked from the site by vehicle traffic. The construction entrance roadways must be established so as to inhibit sediments from being deposited into the public way. Accidental depositions must be swept up immediately and may not be washed down by rain or other means.
- Any slopes with disturbed soils or denuded of vegetation must be stabilized so as to inhibit erosion by wind and water.

- |   |  |
|---|--|
| CA001 - Dewatering Operations               | ESC10 - Seeding and Planting             |
| CA002 - Paving Operations                   | ESC11 - Mulching                         |
| CA003 - Structure Construction and Painting | ESC20 - Geotextiles and Mats             |
| CA010 - Material Delivery and Storage       | ESC21 - Dust Controls                    |
| CA020 - Solid Waste Management              | ESC22 - Temporary Stream Crossing        |
| CA021 - Hazardous Waste Management          | ESC23 - Construction Road Stabilization  |
| CA022 - Concrete Waste Management           | ESC24 - Stabilized Construction Entrance |
| CA024 - Sanitary/Sepic Waste Management     | ESC54 - Storm Drain Inlet Protection     |
| CA030 - Vehicle and Equipment Cleaning      |  |
| CA031 - Vehicle and Equipment Fueling       |  |
| CA032 - Vehicle and Equipment Maintenance   |  |
| ESC00 - Scheduling                          |  |
| ESC02 - Preservation of Existing Vegetation |  |

**STANDARD PLANS:**  
 THE FOLLOWING LATEST REVISED STANDARD PLANS ON FILE IN THE OFFICE OF THE FOLLOWING DEPARTMENT SHALL APPLY IN THE CONSTRUCTION OF THIS PROJECT.  
 LOS ANGELES COUNTY DEPARTMENT OF PUBLIC WORKS  
 APWA 208-1 BREAKING INTO EXISTING MANHOLES  
 APWA 222-1 HOUSE CONNECTION SEWER  
 APWA 223-1 HOUSE CONNECTION REMODELING  
 APWA 210-2 LOCKING MANHOLE FRAME AND COVER  
 2004-1 LEGEND FOR SANITARY SEWER PLANS AND PROFILES AND DISTRICT MAPS.  
 2002-1 PRECAST CONCRETE SHALLOW MANHOLE  
 2003-2 REINFORCED PRECAST CONCRETE MANHOLE  
 2001-1 STANDARD MANHOLE STEP  
 2021-1 BEDDING FOR SEWER PIPE  
 2022-1 ORLANDING AND ENCASEMENT  
 2023-1 W/F OR TEE SUPPORT  
 2022-1 ALLOWABLE TRENCH WIDTHS  
 8006-1 MINIMUM PUBLIC SAFETY REQUIREMENTS

**NOTES:**  
 No connection for the disposal of industrial wastes shall be made to sewers shown on these drawings until a permit for industrial waste discharge has been issued by the Sanitation District for said connections. Before breaking into or constructing on a County Sanitation District Sewer and prior to final acceptance of the project, Sanitation District Inspector shall be notified by phone (661) 266-4663 so that required inspection can be made.

**PRIVATE CONTRACT SEWER GENERAL NOTES**

- A sewer construction permit shall be obtained and a fee paid for construction inspection and record plans to the Department of Public Works at the Permit Counter, 900 South Fremont Avenue, 8th Floor, Alhambra, at least 72 hours prior to starting work under this permit. Copies of all other required permits, such as Road Excavation, Caltrans, etc., must be filed with the permit application.
- Prior to issuance of any permit, the contractor shall file a permit for excavations and trenches from the State of California Division of Industrial Safety, and a Certificate of Worker's Compensation Insurance with the Department of Public Works named on the Certificate Holder to be notified 30 days prior to the start of work.
- If work is done in a State Highway, a permit must be obtained from the State of California Division of Highways, 120 South Spring Street, Los Angeles, California.
- When work is within a contract city, the contractor must contact the Director of Public Works of that city to determine the location to pay the inspection fee.
- The contractor shall contact the district office listed on the "Application for Construction Permit" to arrange for an acceptable construction start date.
- Approval of this plan by the County of Los Angeles does not constitute a representation as to accuracy of the location of or the existence or non-existence of any underground utility pipes or structure within the limits of this project. This note applies to all pages.
- All work shall be in accordance with the latest approved edition of the "Standard Specifications for Construction of Sanitary Sewers" and shall be prosecuted only in the presence of the Department of Public Works Construction Inspector, including supplements and the latest Special Provisions for the Construction of Sanitary Sewers and shall be prosecuted only in the presence of the Department of Public Works Construction Inspector in regard to safety orders and shall conform to the "Minimum Public Safety Requirements" as shown on Los Angeles Department of Public Works' Standard S-2.
- Excavations are to be in feet above U.S.C. & G.S. sea level datum of 1929.
- No revisions shall be made in these plans without the approval of the Director of Public Works.
- No representative of the Department of Public Works will survey or lay out any portion of the work. Grades to which the improvement is to be constructed are shown on plans and profiles. Grade points for top of curbs, centerline of streets, or centerline of ditches, are shown by circles on profiles at all points between designated points. The grade shall be established so as to conform to a straight line drawn between said designated points.
- The private engineer shall furnish the Department of Public Works with grade sheets and stationing for house laterals and 7" or 12" branches and shall provide stakes for them at their proper locations with stationing plainly marked. All house laterals shall be constructed in a straight alignment at right angles from the main line sewer except as shown on the plans. House laterals from chimneys shall not have an angle of less than 45 degrees with the M.L. sewer. Any change in alignment shall be requested in writing from the private engineer.
- The private engineer shall furnish the house lateral depth at the property line below the top of curb elevation for each house lateral on the grade sheet.

**CONSTRUCTION NOTES**

- Provide survey stakes on the property line or property lines produced at right angles to the sewer line at the centerline of each manhole.
- Unless otherwise specified, all pipe shall be type "D" or "C" per standard specifications section 208-2.
- Unless otherwise specified, all pipe shall be installed with a rubber sleeve joint, type "D" (with bushing if necessary) per standard specifications section 208-2.
- All joints between cast iron pipe and vitrified clay shall be made with a rubber sleeve joint, type "D" (with bushing if necessary) per standard specifications section 208-2.
- House laterals to be constructed with inverts at the property line 6 feet below curb grade except as noted.
- Wye or tee branches may be used for connections to the mainline sewer except as noted.
- If during the course of construction, it is determined that there is less than four feet of cover over the top of a manhole or house lateral V.C.P. sewer which is not indicated on the plans, the pipes shall be encased per standard plan S-23, cover, unless otherwise approved by the Director of Public Works.
- All structures shall be either brick sewer manholes per standard plan S-3 or precast concrete sewer manholes per standard plan S-36, or reinforced precast concrete manhole per standard plan S-8, except as noted.
- Reinforce all trenches within paved areas to meet Los Angeles County Public Works or California State Highway requirements in accordance with the permits.
- Full compliance with section 306-1.3.4 of the standard specification will be required for backfill in street certification of local construction and sand equivalents by a qualified civil engineer shall be provided by the permittee prior to the issuance of a certificate of partial acceptance.
- All backfill and fill outside of the street right of way shall be compacted to 90% of the maximum density as determined by ASTM soil compaction test D 1557-78 method "D" unless otherwise specified. This shall be certified by a qualified civil engineer. This certification shall be submitted to the Construction Division of the Department of Public Works prior to the acceptance of the work by the county.
- Manhole tops in unimproved rights of way to be six inches above finished grade.
- Sewers to be tested for leakage per section 306-1.4 of the standard specifications and special provisions.
- Manhole tops in improved rights-of-way to be level with finished grade.
- All wye and/or house laterals are to be located at least 5 ft apart and where possible not closer than 5 ft to any manhole.

**PROFILE, ALIGNMENT AND GRADE OF SANITARY SEWERS**  
 TO BE CONSTRUCTED IN  
 VALENCIA BLVD, WEST OF OLD ROCK ROAD  
 DEEDED STREET 512 PC NO. 11656  
 2 SHEETS: 4 PAGES  
 COUNTY OF LOS ANGELES CALIFORNIA  
 INDEX MAP N-1257

JAMES A. NOYES DIRECTOR OF PUBLIC WORKS  
 APPROVED LAND DEVELOPMENT DIVISION  
 BY *Dennis Hunter* 5/6/03  
 ASSISTANT DIVISION ENGINEER DATE  
 SUBMITTED *[Signature]* 4/11/03  
 LANSING PLAN CHECKING SECTION  
 APPROVED COUNTY SANITATION DISTRICT  
 OF LOS ANGELES CALIF. 55986  
 JAMES F. STAHL - CHIEF ENGINEER and GENERAL MANAGER  
 COUNTY SANITATION DISTRICT NO. 32  
 BY *[Signature]* DATE: 5/7/03  
 OFFICE LEADER

**PRIVATE ENGINEERS NOTICE TO CONTRACTORS:**  
 THE EXISTENCE AND LOCATION OF ANY UNDERGROUND UTILITY LINES OR STRUCTURES SHOWN ON THESE PLANS IS REQUIRED BY A SEARCH OF AVAILABLE RECORDS TO THE BEST OF OUR KNOWLEDGE. THERE ARE NO EXISTING UTILITIES EXCEPT AS SHOWN ON THIS MAP. THE CONTRACTOR IS REQUIRED TO TAKE PRECAUTIONARY MEASURES TO PROTECT THE UTILITIES SHOWN AND ANY OTHER LINES NOT OF RECORD OR NOT SHOWN ON THIS DRAWING. PRIOR TO EXCAVATION THE CONTRACTOR SHALL CALL TOLL FREE TELEPHONE LINES. THE CONTRACTOR SHALL CALL RAY CUMMINGS OF GENERAL TELEPHONE COMPANY AT 1-800-948-4871 SO THAT THEY CAN MARK THE LOCATION OF UNDERGROUND TELEPHONE LINES.  
*Edward P. Chomay* 5/10/03  
 R.E. NO. 36483 DATE

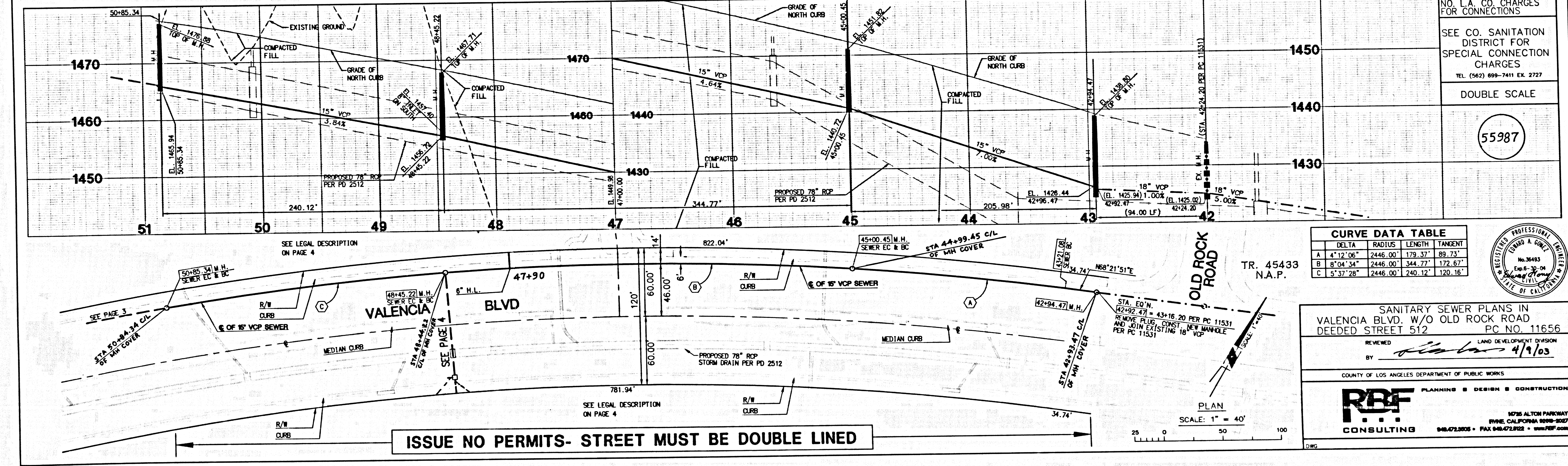

P.C.11656 PAGE 2

NO. L.A. CO. CHARGES FOR CONNECTIONS
SEE CO. SANITATION DISTRICT FOR SPECIAL CONNECTION CHARGES
DOUBLE SCALE
55987

**CURVE DATA TABLE**

DELTA	RADIUS	LENGTH	TANGENT
A 4°12'06"	2446.00'	179.37'	89.23'
B 8°04'34"	2446.00'	344.77'	172.67'
C 5°37'28"	2446.00'	240.12'	120.16'

REVIEWED BY *[Signature]* 4/9/03  
 COUNTY OF LOS ANGELES DEPARTMENT OF PUBLIC WORKS  
**RBF** PLANNING • DESIGN • CONSTRUCTION  
 CONSULTING  
 10726 ALTON PARKWAY  
 IRVINE, CALIFORNIA 92618-9027  
 949.472.2255 • FAX 949.472.2252 • WWW.RBF.COM

08811 02 512 TREET 21622 DEEDED 21622 BOCK ROAD OLD O.W. (V)A1 A1C1A1A1A1  
 2/18/03 11:07 AM  
 H:\DATA\343404\4.DWG\IMPROVE SEWER\94055\STILL.DWG



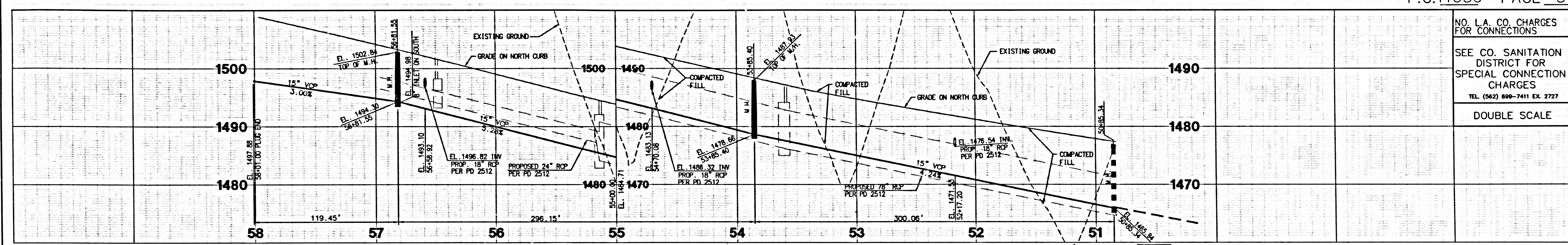

NO. L.A. CO. CHARGES FOR CONNECTIONS
SEE CO. SANITATION DISTRICT FOR SPECIAL CONNECTION CHARGES TEL. (562) 699-7411 EX. 2727
DOUBLE SCALE

CURVE	DELTA	RADIUS	LENGTH	TANGENT
A	1° 14' 38"	2446.00'	53.10'	26.55'
B	6° 16' 05"	2354.00'	138.07'	128.89'
C	6° 16' 05"	2354.00'	119.45'	128.89'

55989

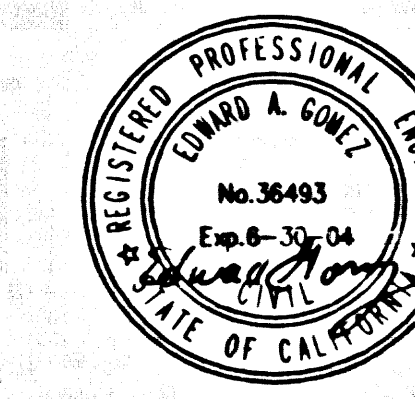

REVIEWED BY LAND DEVELOPMENT DIVISION  
BY: [Signature] DATE: 4/9/03  
SUBDIVISION PLAN CHECKING SECTION

AVENUE BLVD. W/O OLD ROCK BOYD DEEDED SHEET 215 P.C. 11628

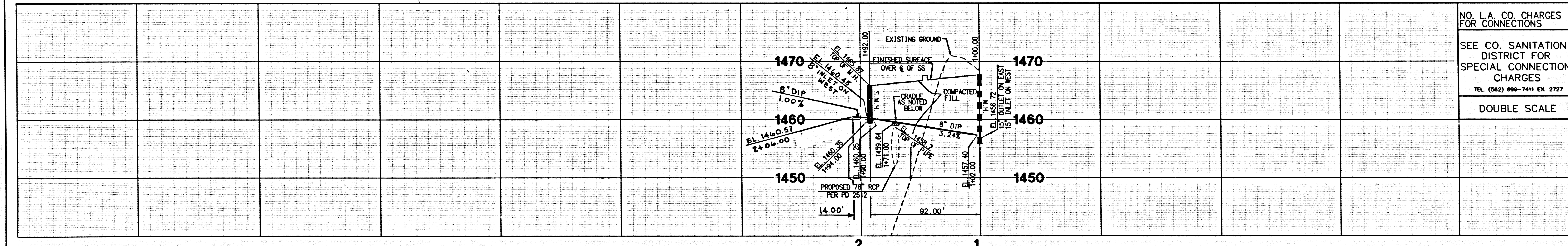

NO. L.A. CO. CHARGES FOR CONNECTIONS
SEE CO. SANITATION DISTRICT FOR SPECIAL CONNECTION CHARGES TEL. (562) 699-7411 EX. 2727
DOUBLE SCALE

55989

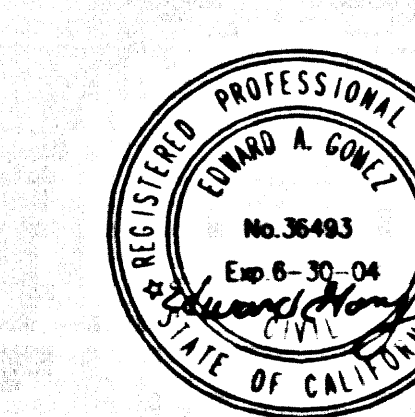

REVIEWED BY LAND DEVELOPMENT DIVISION  
BY: [Signature] DATE: 4/9/03  
SUBDIVISION PLAN CHECKING SECTION

HYDRA 1A 34340GA.DWG IMPROVE SEWER 3405501.DWG TS 2/18/03 11:09 am

**ISSUE NO PERMITS- MAINLINE MUST BE EXTENDED AND MANHOLE CONSTRUCTED**

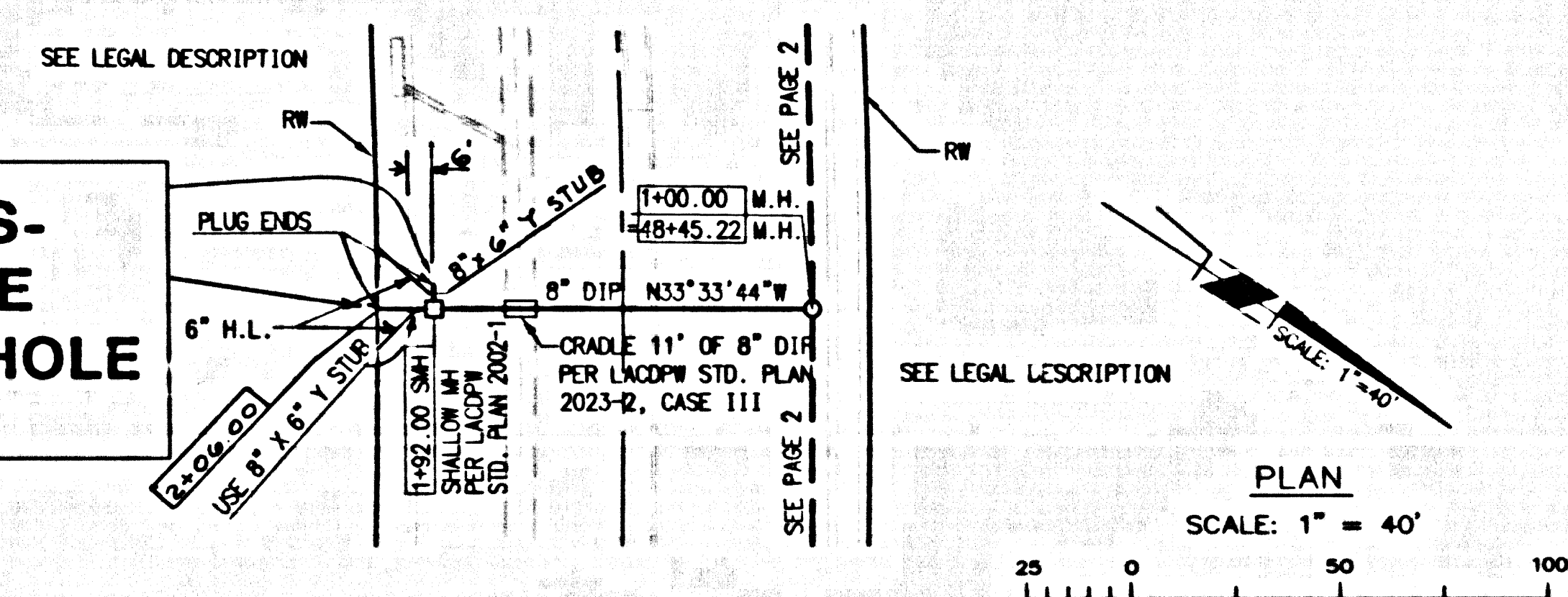

LEGAL DESCRIPTION  
PARCEL 5 OF PARCEL MAP NO. 15955  
FILED IN BOOK 188, PAGES 90 THROUGH 95

PLAN  
SCALE: 1" = 40'