

BENCH MARKS
 BM Y 9123 Elev. 867.235
 1ST IN NW COR ROCK STORE BLDG SLAB @ 3035A MULHOLLAND HWY
 1ST IN E/O C/L @ 6.26 S/O @ 10742E 126M W/O SIERRA CREEK RD
 MALIBU QUAD 2003

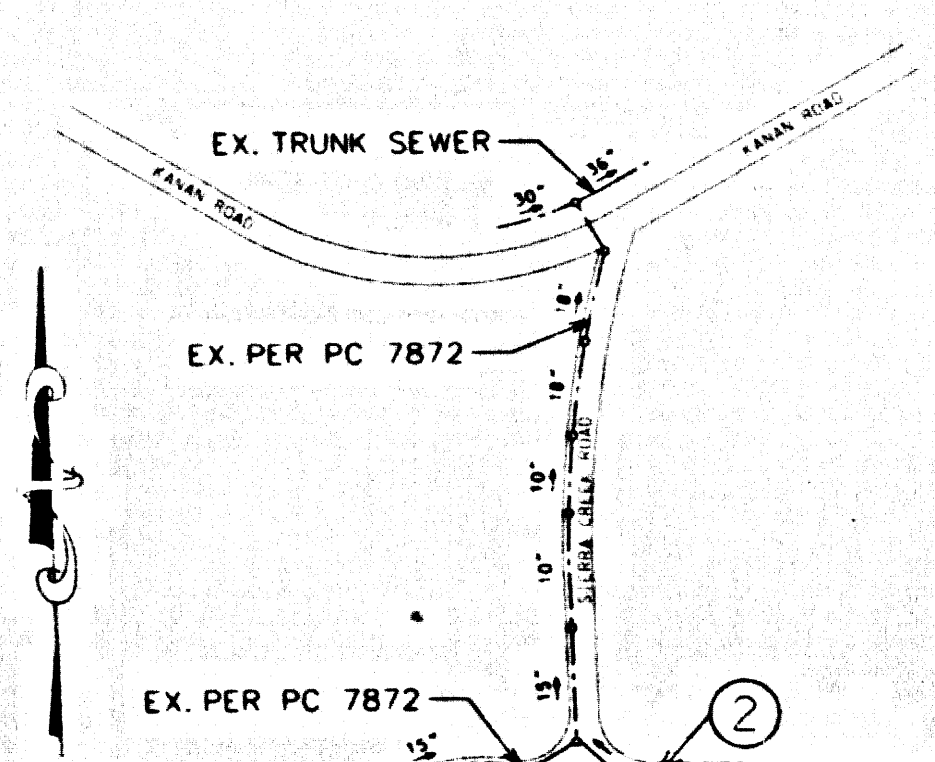

INDEX MAP
 SCALE: 1" = 600' (HORIZ. & VERT.)
 P.C. 11786
 ADDRESS: E/O SIERRA CREEK RD
 THOMAS GUYE PAGE: 587

NO.	REVISION	REVISED BY	APPROVED BY	DATE
1	RAISE SEWER TO MINIMIZE CONSTRUCTION IN ROCK	THOMAS GUYE	[Signature]	1/14/05

STORMWATER POLLUTION CONTROL REQUIREMENTS FOR SEWER CONSTRUCTION

- Eroded sediments and other pollutants must be retained on site and may not be transported from the site via sheet flow, swales, or drainage, natural drainage courses, or creeks.
- Stockpiles of earth and other construction related materials must be protected from being transported from the site by the forces of wind or water.
- Fuels, oils, solvents, and other toxic materials must be stored in accordance with their labeling and are not to contaminate the soil and surface waters. Approved storage containers are to be protected from the weather. Spills must be cleaned up immediately and disposed of in a proper manner. Spills may not be washed into the drainage system.
- Excess or waste concrete may not be washed into the public way or any other drainage system. Provisions shall be made to retain concrete wastes on site until they can be disposed of as solid waste. Construction of concrete waste disposal is to be completed prior to the start of construction.
- Trash and construction-related solid wastes must be deposited into a covered receptacle to prevent contamination of rainwater and dispersal by wind.
- Sediments and other materials may not be tracked from the site by vehicle traffic. The construction entrance roadways must be stabilized as to prevent sediments from being deposited into the public way. Accidental depositions must be swept up immediately and may not be washed down by rain or other means.
- Any areas with disturbed soils or denuded of vegetation must be stabilized so as to inhibit erosion by wind and water.

- STANDARD PLANS:**
 THE FOLLOWING LATEST REVISED STANDARD PLANS ON FILE IN THE OFFICE OF THE FOLLOWING DEPARTMENT SHALL APPLY IN THE CONSTRUCTION OF THIS PROJECT:
 LOS ANGELES COUNTY DEPARTMENT OF PUBLIC WORKS
 2000-0 LEGEND FOR SANITARY SEWER PLANS AND PROFILES AND DISTRICT MAPS
 2002-1 PRECAST REINFORCED CONCRETE MANHOLE
 2003-2 REINFORCED PRECAST CONCRETE RECTANGULAR SHALLOW MANHOLE
 204-1 RECTANGULAR MANHOLE FRAME AND COVER
 204-1-1 RECTANGULAR MANHOLE FRAME AND COVER
 202-1 BEDDING FOR SEWER PIPE
 202-2 STRUKING AND ENCASING
 202-4 WIRE OR TEE SUPPORT
 202-11 EROSION PROTECTION IN STEEP SLOPES
 2027-0 ALLOWABLE TRENCH WIDTHS
 6008-0 AMERICAN PUBLIC SAFETY REQUIREMENTS
 AMERICAN PUBLIC WORKS ASSOCIATION
 207-1 PRECAST REINFORCED CONCRETE MANHOLE BASE
 208-1 BREAKING INTO EXISTING MANHOLES
 210-2 MANHOLE FRAME AND COVER LOKING TYPE
 211-1 CHIMNEYS
 221-1 PIPE ANCHORS AND BACKSET STABILIZERS
 222-1 HOUSE CONNECTION SEWER
 223-1 HOUSE CONNECTION RECYCLING
 224-0 TRAMP SEWER MANHOLE
 NOTES:
 NO CONNECTION FOR THE DISPOSAL OF INDUSTRIAL WASTES SHALL BE MADE TO SEWERS SHOWN ON THESE DRAWINGS UNLESS A PERMIT FOR INDUSTRIAL WASTE DISCHARGE HAS BEEN ISSUED BY THE COUNTY SANITATION DISTRICTS FOR SAID CONNECTIONS.

NOTICE TO CONTRACTOR:
 BEFORE BREAKING INTO OR CONSTRUCTION OF COUNTY SANITATION DISTRICT SEWER AND PRIOR TO FINAL ACCEPTANCE OF THE PROJECT, A COUNTY SANITATION DISTRICT INSPECTOR SHALL BE ADVISED BY PHONE (805) 862-8060 SO THAT REQUIRED INSPECTION CAN BE MADE.

THIS SEWER PRIVATE CONTRACT ACCEPTED FOR PUBLIC USE
 06/14/2005
 COUNTY OF LOS ANGELES
 DEPARTMENT OF PUBLIC WORKS
 LAND DEVELOPMENT DIVISION

PRIVATE CONTRACT SEWER GENERAL NOTES

- The following general notes are to be included on Page 1 of all Private Contract Sewer Plans:
 A sewer construction permit shall be obtained and a fee paid for construction inspection and record plans to the Department of Public Works of the Permit Counter, 900 South Fremont Avenue, 8th Floor, Alhambra, at least 72 hours prior to starting work under the permit. Copies of all other required permits, such as Road Excavation, California, etc., must be filed with the permit application.
 Prior to issuance of any permit, the contractor shall file a permit for excavations and trenches from the State of California Division of Industrial Safety, and a Certificate of Worker's Compensation Insurance with the Department of Public Works named as the Certificate Holder. The Department of Public Works shall be notified 30 days prior to cancellation of the insurance policy.
 If work is done in a State Highway, a permit must be obtained from the State of California Division of Highways, 120 South Spring Street, Los Angeles, California.
 When work is within a contract city, the contractor must contact the Director of Public Works of that city, to determine the location to pay the inspection fee.
 The contractor shall contact the district office listed on the "Application for Construction Permit" to arrange for an acceptable construction start date.
 Approval of this plan by the County of Los Angeles does not constitute a representation as to accuracy of the location of or the existence or non-existence of any underground utility pipe or structure within the limits of the project. This plan applies to all pipes, appurtenances and the latest "Special Provisions for the Construction of Sanitary Sewer" and shall be prosecuted only in the presence of the Department of Public Works.
 The contractor's attention is directed to Section 7-10.4.1 of the "Standard Specifications for Public Works Construction" in regard to safety orders and shall conform to the Minimum Public Safety Requirement as shown on Los Angeles Department of Public Works' standard plan 8008-1.
 Elevation are in feet above U.S.C. & G.S. sea level datum of 1929.
 No revisions shall be made in these plans without the approval of the Director of Public Works.
 No representative of the Department of Public Works shall survey or lay out any portion of the work.
 Grades to which the improvement is to be constructed are shown on plans and profiles. Grade points for top of curbs, centerline of streets, or centerline of alleys, are shown by circles on profiles at all points between said designed points. The grade shall be established as to conform to a straight line drawn between said design points.
 The private engineer shall furnish the Department of Public Works with grade sheets and stationing for allhouse laterals and "T" or "T" branches and shall provide stakes for them at their proper locations with stationing clearly marked. Allhouse laterals shall be constructed on a straight alignment at right angles from the main line sewer except as shown on the plans. House laterals, from chimneys that are not a straight alignment at right angles from the main line sewer, shall be requested in writing by the private engineer.
 The private engineer shall furnish the house lateral depth at the property line below the top of curb elevation for each house lateral on the grade sheet.
 An approved backwater valve is required when the pad is lower in elevation than the top of the next upstream manhole.

- CONSTRUCTION NOTES**
- Provide survey stakes on the property line or property lines produced at right angles to the sewer line at the centerline of each manhole.
 - Manhole clay pipe joints shall be type "D" or "C" per "Standard Specifications for Public Works Construction" Section 208-2.
 - If a pipe is to be installed within three feet of the sewer, the sewer shall be encased per LACDPW standard plan 2023-2, Case 4, two feet on each side from the joint of interferences.
 - All joints between cast iron pipe and vitrified clay shall be made with a rubber sleeve joint, type "D" with bushing if necessary per "Standard Specifications for Public Works Construction" Section 208-2.
 - House laterals to be constructed with manhole at the property line 6 feet below curb grade except as noted.
 - Wye or tee branches may be used for connections to the main sewer except as noted.
 - If during the course of construction, it is determined that there is less than four feet of cover over the top of a manhole or house lateral V.C.P. sewer which is not indicated on the plans, the pipes shall be encased per LACDPW standard plan 2023-2, Case 4, unless otherwise approved by the Director of Public Works.
 - Structures shall be either brick sewer manholes per LACDPW standard plan 5-3 (APWA 203-0), or precast concrete sewer manholes per LACDPW standard plan 5-3e (APWA 200-2), or reinforced precast concrete manhole per LACDPW standard plan 2003-2, except as noted.
 - Reinforce all structures within paved areas to meet Department of Public Works or California State Highway requirements in accordance with the permit.
 - Full compliance with Section 306-1.3.4 of the "Standard Specifications for Public Works Construction" will be required for backfill in street. Certification of backfill, compaction, and soil specimens by a qualified civil engineer shall be provided by the permittee prior to the issuance of a certificate of partial acceptance.
 - All structures on the outside of the street right of way shall be connected to 90% of the maximum density as determined by ASTM soil compaction test D 1557-78 method "D" unless otherwise specified. The shall be certified by a qualified civil engineer. This certification shall be submitted to the Construction Division of the Department of Public Works prior to the acceptance of the work by the county.
 - Manhole tops in unimproved rights of way to be six inches above finished grade.
 - Sewers to be tested for leakage per section 306-1.4 of the "Standard Specifications for Public Works Construction" and "Special Provisions for the Construction of Sanitary Sewer".
 - Manhole tops in improved rights of way to be level with finished grade.
 - Wyes and/or house laterals are to be located at least 5' apart and when possible not closer than 5' to any manhole.

PROFILE, ALIGNMENT, AND GRADE OF
SANITARY SEWERS
 TO BE CONSTRUCTED IN
 MULHOLLAND HWY E/O SIERRA CREEK ROAD
 (30168 MULHOLLAND HWY)
 PC NO. 11786
 1 SHEETS: 2 PAGES
 COUNTY OF LOS ANGELES CALIFORNIA
 INDEX S-1067

APPROVED BY LAND DEVELOPMENT DIVISION
 BY Dennis Hunter 12/6/04
 15844 RCE NO. DATE
 SUBMITTED BY [Signature] 12/6/04
 15844 RCE NO. DATE
 REVIEWED: LAS VIRGENES MUNICIPAL WATER DISTRICT

REVIEWED: LAS VIRGENES MUNICIPAL WATER DISTRICT

APPROVED BY LAND DEVELOPMENT DIVISION
 BY [Signature] 12/6/04
 15844 RCE NO. DATE

PRIVATE ENGINEERS NOTICE TO CONTRACTORS:
 THE EXISTENCE AND LOCATION OF ANY UNDERGROUND UTILITY PIPES OR STRUCTURES SHOWN ON THESE PLANS IS BELIEVED BY A SEARCH OF AVAILABLE RECORDS TO BE THE BEST OF OUR KNOWLEDGE. THERE ARE NO EXISTING UTILITIES EXCEPT AS SHOWN ON THIS MAP. THE CONTRACTOR IS REQUIRED TO TAKE PRECAUTIONARY MEASURES TO PROTECT THE UTILITY LINES SHOWN AND ANY OTHER LINES NOT OF RECORD OR NOT SHOWN ON THIS DRAWING. PRIOR TO EXCAVATION THE CONTRACTOR SHALL CALL TOLL FREE 1-800-422-4333 TO VERIFY THE UNDERGROUND LOCATION OF GAS AND TELEPHONE LINES. THE CONTRACTOR SHALL ALSO CALL MR. RAY CHAMBERS OF GENERAL TELEPHONE COMPANY AT 1-800-948-4871 SO THAT THEY CAN MARK THE LOCATION OF UNDERGROUND TELEPHONE LINES.

PROJECT ENGINEER [Signature] 15844 RCE NO. 12/6/04 DATE

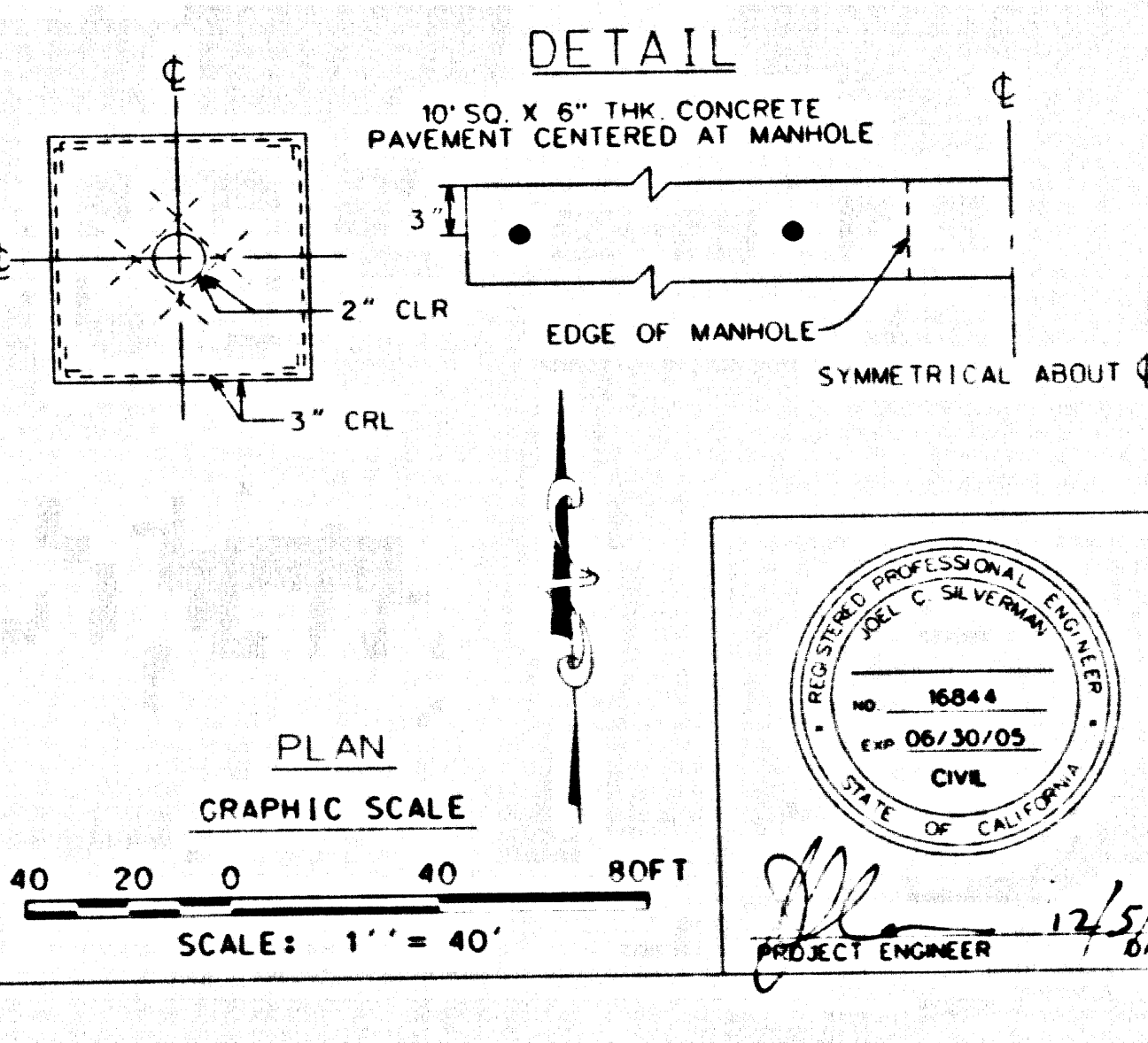
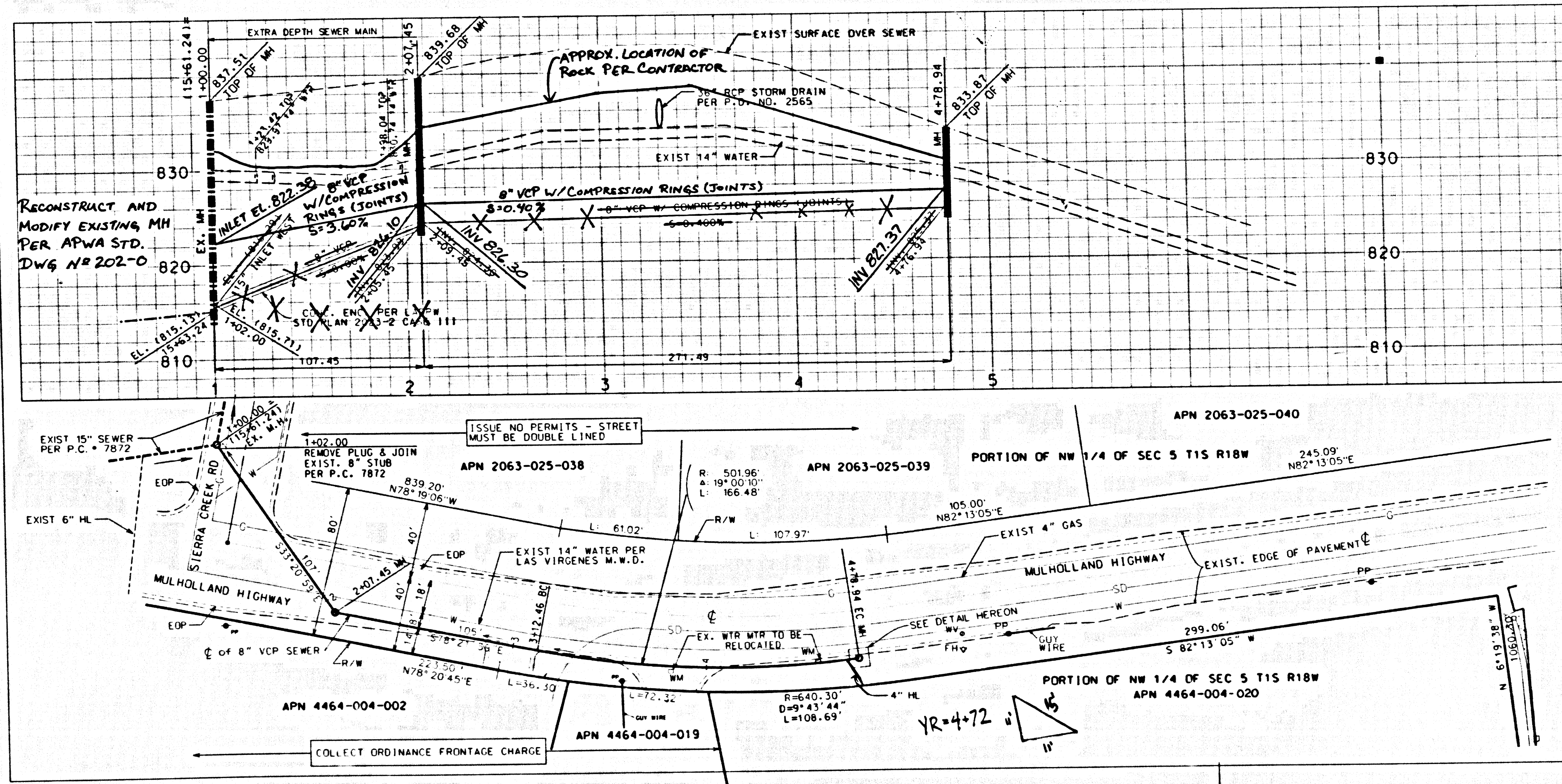

P.C. 11786 PAGE 2
 COLLECT CHARGES AS INDICATED
 SEE L.V.M.W.D. FOR CONNECTION CHARGES
 TEL (818) 251-2200 EX.
 REIMBURSEMENT CHARGES CALL LAND DEVELOPMENT DIVISION
 DOUBLE SCALE

RECORD PLANS

SCALE: HORIZ. 1" = 40'
 VERT. 1" = 4'

PLAN GRAPHIC SCALE
 SCALE: 1" = 40'

DATE 12/6/04

SANITARY SEWER PLANS IN MULHOLLAND HWY E/O SIERRA CREEK ROAD PC NO. 11786

REVIEWED BY LAND DEVELOPMENT DIVISION
 BY [Signature] 12/6/04
 15844 RCE NO. DATE
 COUNTY OF LOS ANGELES DEPARTMENT OF PUBLIC WORKS

CIVIL ENGINEERS - LAND PLANNERS - SURVEYORS
 2280 CALIFORNIA RD. SUITE 2039, CALIFORNIA, CALIFORNIA 91302
 (818) 222-3700 • (800) 228-3544 • FAX (818) 222-3710
 HTTP://WWW.JSA-ENG.COM/