

BENCH MARK: L.A.C.P.W. CL3973
 LACS BM MON. IN CTR. CONC. HDWL
 22 FEET WLY C.L. THE OLD ROAD AND
 0.50 MILES WLY GASTRAC JUNCTION
 MKD (BM 208-50-1968 RE-5993)
 NEWHALL QUAD. (1933) ELEV. 1019.648

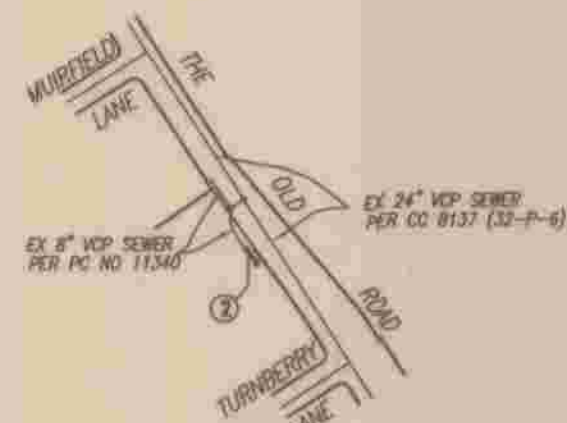

INDEX MAP
 SCALE 1" = 800'
 P.M. 26574 P.C. 11857
 THOMAS GUIDE PAGE NO. 4459 J-6

NOTE: NUMBER IN CIRCLE INDICATES PAGE NUMBER

STORMWATER POLLUTION CONTROL REQUIREMENTS FOR SEWER CONSTRUCTION

- Eroded sediments and other pollutants must be retained on site and may not be transported from the site via sheet flow, swales, area drains, natural drainage courses, or wind.
- Stockpiles of earth and other construction related materials must be protected from being transported from the site by the forces of wind or water.
- Fuels, oils, solvents, and other toxic materials must be stored in accordance with their listing and are not to contaminate the soil and surface waters. All approved storage containers are to be protected from the weather. Spills must be cleaned up immediately and disposed of in a proper manner. Spills may not be washed into the drainage system.
- Excess or waste concrete may not be washed into the public way or any other drainage system. Provisions shall be made to retain concrete wastes on site until they can be disposed of as solid waste.
- Trash and construction-related solid wastes must be deposited into a covered receptacle to prevent contamination of rainwater and dispersal by wind.
- Sediments and other materials may not be tracked from the site by vehicle traffic. The construction entrance roadways must be stabilized so as to inhibit sediments from being deposited into the public way. Accidental depositions must be swept up immediately and may not be washed down by rain or other means.
- Any slopes with disturbed soils or denuded of vegetation must be stabilized so as to inhibit erosion by wind and water.
- The following BMPs as outlined in, but not limited to, the "Best Management Practice Handbook, California Stormwater Quality Task Force, Sacramento, California, 2003," or the latest revised edition, may apply during the construction of this project (additional measures may be required if deemed appropriate by County inspectors):

EROSION CONTROL

- EC-1 Scheduling
- EC-2 Preservation of Existing Vegetation
- EC-3 Hydraulic Mulch
- EC-4 Hydroseeding
- EC-5 Soil Binders
- EC-6 Straw Mulch
- EC-7 Geotextiles and Mats
- EC-8 Wood Mulching
- EC-9 Earth Dikes and Drainage Swales
- EC-10 Velocity Dissipation Devices
- EC-11 Slope Drains
- EC-12 Streambank Stabilization
- EC-13 Polyacrylamide

WASTE MANAGEMENT & MATERIAL POLLUTION CONTROL

- WM-1 Material Delivery and Storage
- WM-2 Material Use
- WM-3 Stockpile Management
- WM-4 Spill Prevention and Control
- WM-5 Solid Waste Management
- WM-6 Hazardous Waste Management
- WM-7 Contaminated Soil Management
- WM-8 Concrete Waste Management
- WM-9 Sanitary/Septic Waste Management
- WM-10 Liquid Waste Management

TEMPORARY SEDIMENT CONTROL

- SE-1 Silt Fence
- SE-2 Sediment Basin
- SE-3 Sediment Trap
- SE-4 Check Dams
- SE-5 Fiber Rolls
- SE-6 Onsite Bag Barr
- SE-7 Street Sweeping and Vacuuming
- SE-8 Sandbag Barrier
- SE-9 Straw Bale Barrier
- SE-10 Storm Drain Inlet Protection
- SE-11 Chemical Treatment

NON-STORMWATER MANAGEMENT

- NS-1 Water Conservation Practices
- NS-2 Dewatering Operations
- NS-3 Paving and Grinding Operations
- NS-4 Temporary Stream Crossing
- NS-5 Clear Water Diversion
- NS-6 Illicit Connection/Discharge
- NS-7 Potable Water/Irrigation
- NS-8 Vehicle and Equipment Cleaning
- NS-9 Vehicle and Equipment Fueling
- NS-10 Vehicle & Equipment Maintenance
- NS-11 Fuel Draining Operations
- NS-12 Concrete Curing
- NS-13 Concrete Finishing
- NS-14 Material Over Water
- NS-15 Demolition Adjacent to Water
- NS-16 Temporary Batch Plants

WIND EROSION CONTROL

- WE-1 Wind Erosion Control

EQUIPMENT TRACKING CONTROL

- TC-1 Stabilized Construction Entrance/Exit
- TC-2 Stabilized Construction Roadway
- TC-3 Entrance/Outlet Tire Wash

PRIVATE CONTRACT SEWER GENERAL NOTES

- A sewer construction permit shall be obtained and a fee paid for construction inspection and record plans to the Department of Public Works at the Permit Counter, 900 South Fremont Avenue, 8th Floor, Alhambra, at least 72 hours prior to starting work under this permit. Copies of all other required permits, such as Road Excavation, Caltrans, etc., must be filed with the permit application.
- Prior to issuance of any permit, the contractor shall file a permit for excavations and trenches from the State of California Division of Industrial Safety, and a Certificate of Worker's Compensation Insurance with the Department of Public Works named as the Certificate Holder. The Department of Public Works shall be notified 30 days prior to cancellation of insurance policy.
- If work is done in a State Highway, a permit must be obtained from the State of California Division of Highways, 120 South Spring Street, Los Angeles, California.
- When work is within a contract city, the contractor must contact the Director of Public Works of that city, to determine the location to pay the inspection fee.
- The contractor shall contact the district office listed on the "Application for Construction Permit" to arrange for an acceptable construction start date.
- Approval of this plan by the County of Los Angeles does not constitute a representation as to accuracy of the location of or the existence or non-existence of any underground utility pipe or structure within the limits of this project. This note applies to all pages.
- All work shall be in accordance with the latest approved edition of the "Standard Specifications for Public Works Construction", including supplements and the latest "Special Provisions for the Construction of Sanitary Sewer" and shall be protected only in the presence of the Department of Public Works.
- The contractor's attention is directed to Section 7-10.4.1 of the "Standard Specifications for Public Works Construction" in regard to safety orders and shall conform to the "Minimum Public Safety Requirement" as shown on Los Angeles Department of Public Works standard plan 6006-1.
- Elevations are in feet above U.S.C. & G.S. sea level datum of 1929.
- No revisions shall be made in these plans without the approval of the Director of Public Works.
- No representative of the Department of Public Works will survey or lay out any portion of the work.
- Grades to which this improvement is to be constructed are shown on plans and profiles. Grade points for top of curbs, centerline of streets, or centerline of alleys, are shown by circles on profiles at all points between said design points. The grade shall be established so as to conform to a straight line drawn between said design points.
- The private engineer shall furnish the Department of Public Works with grade sheets and stationing for all house laterals and "Y" or "T" branches and shall provide stakes for them at their proper locations with stationing plainly marked. All house laterals shall be constructed in a straight alignment at right angles from the main line sewer except as shown on the plans. House laterals from chimneys shall not have an angle of less than 45 degrees with the M.L. sewer. Any change in alignment shall be requested in writing by the private engineer.
- The private engineer shall furnish the house lateral depth at the property line below the top of curb elevation for each house lateral on the grade sheet.
- An approved backwater valve is required when the pad is lower in elevation than the top of the next upstream manhole.

CONSTRUCTION NOTES

- Provide survey stakes on the property line or property lines produced at right angles to the sewer line at the centerline of each manhole.
- Vitrified clay pipe joints shall be type "D" or "Q" per "Standard Specifications for Public Works Construction" Section 208-2.
- If a pipe is within three feet of the sewer, the sewer shall be encased per LACDPW standard plan 2023-2, Case II, two feet on each side from the point of interference.
- All joints between cast iron pipe and vitrified clay shall be made with a rubber sleeve joint, type "D" (with bushing if necessary) per "Standard Specifications for Public Works Construction" Section 208-2.
- House laterals to be constructed with inverts at the property line 6 feet below curb grade except as noted.
- Wye or tee branches may be used for connections to the mainline sewers except as noted.
- If during the course of construction, it is determined that there is less than four feet of cover over the top of a mainline or house lateral V.C.P. sewer which is not indicated on the plans, the pipes shall be encased per LACDPW standard plan 2023-2, Case II, unless otherwise approved by the Director of Public Works.
- All structures shall be either brick sewer manholes per LACDPW standard plan S-3 (APWA 203-0), or precast concrete sewer manholes per LACDPW standard plan S-36 (APWA 200-2), or reinforced precast concrete manhole per LACDPW standard plan 200-3-2, except as noted.
- Resurface all trenches within paved areas to meet Los Angeles County Department of Public Works or California State Highway requirements in accordance with the permits.
- Full compliance with section 306-1.3.4. of the "Standard Specifications for Public Works Construction" will be required for backfill in street. Certification of backfill compaction, and sand equivalent by a qualified civil engineer shall be provided by the permittee prior to the issuance of a certificate of partial acceptance.
- All backfill and fills outside of the street right of way shall be compacted to 90% of the maximum density as determined by ASTM soil composition test D 1557-78 method "D" unless otherwise specified. This shall be certified by a qualified civil engineer. This certification shall be submitted to the Construction Division of the Department of Public Works prior to the acceptance of the work by the county.
- Manhole tops in unimproved rights of way to be six inches above finished grade.
- Sewers to be tested for leakage per section 306-1.4 of the "Standard Specifications for Public Works Construction" and "Special Provisions for the Construction of Sanitary Sewer".
- Manholes tops in improved rights of way to be level with finished grade.
- All wyes and /or house laterals are to be located at least 5' apart and when possible not closer than 5' to any manhole.

RECORD PLANS

PROFILE, ALIGNMENT AND GRADE OF **PAGE 1**
SANITARY SEWERS
 TO BE CONSTRUCTED IN
 PARCEL MAP NO. 26574 PC NO. 11857
 SHEETS: 1 PAGES 2
 COUNTY OF LOS ANGELES CALIFORNIA
 INDEX N-1216

DONALD LWOLFE ACTING DIRECTOR OF PUBLIC WORKS
 APPROVED BY LAND DEVELOPMENT DIVISION
 BY: [Signature] 7/13/05
 ASSISTANT DIVISION ENGINEER DATE
 SUBMITTED BY: [Signature] 7/13/05
 SUBMISSION PLAN CHECKING SECTION DATE

APPROVED: COUNTY SANITATION DISTRICT
 OF LOS ANGELES COUNTY CALIF.
 JAMES F. STAHL - CHIEF ENGINEER and GENERAL MANAGER
 COUNTY SANITATION DISTRICT NO. 32
 BY: [Signature] 7/14/05
 OFFICE ENGINEER DATE

PRIVATE ENGINEERS NOTICE TO CONTRACTORS:
 THE EXISTENCE AND LOCATION OF ANY UNDERGROUND UTILITY PIPES OR STRUCTURES SHOWN ON THESE PLANS IS REQUIRED BY A SEARCH OF AVAILABLE RECORDS TO THE BEST OF OUR KNOWLEDGE. THERE ARE NO EXISTING UTILITIES EXCEPT AS SHOWN ON THIS MAP. THE CONTRACTOR IS REQUIRED TO TAKE PRECAUTIONARY MEASURES TO PROTECT THE UTILITY LINES SHOWN AND ANY OTHER LINES NOT OF RECORD OR NOT SHOWN ON THIS DRAWING. PRIOR TO EXCAVATION THE CONTRACTOR SHALL CALL TOLL FREE 1-800-422-4133 TO VERIFY THE UNDERGROUND LOCATION OF GAS AND TELEPHONE LINES. THE CONTRACTOR SHALL ALSO CALL MR. RAY CUMMINGS OF GENERAL TELEPHONE COMPANY AT 1-800-848-4871 SO THAT THEY CAN MARK THE LOCATION OF UNDERGROUND TELEPHONE LINES.
 [Signature] 6-23-05
 RCE NO DATE

P.C. 11857 PAGE 2

DOUBLE SCALE
 NO L.A. CO. CHARGES FOR CONNECTIONS
 SEE CO. SANITATION DISTRICTS FOR SPECIAL CONNECTION CHARGES
 TEL No. (562) 699-7411 EXT. 2727

NO.	REVISION	REVISED BY	APPROVED BY	DATE

NOTICE TO CONTRACTOR:
 MAINTAIN SEWER FLOW AT ALL TIMES DURING CONSTRUCTION.

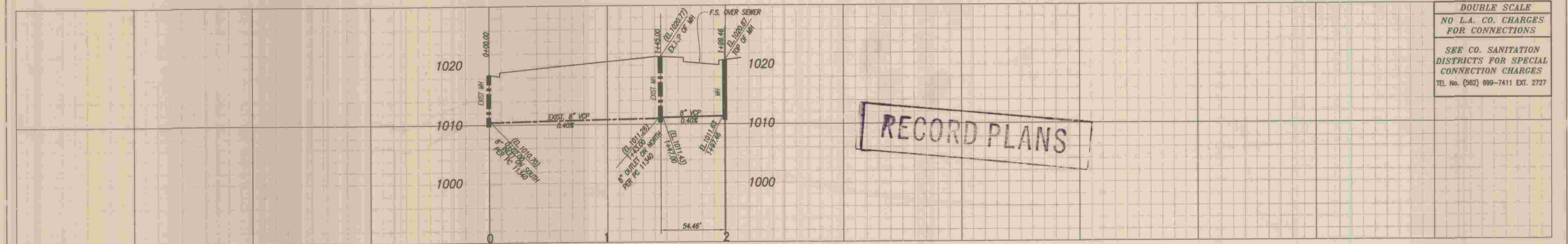

RECORD PLANS

EASEMENT LINE TABLE

LINE	BEARING	DISTANCE
L1	N52°12'03"E	10.00'
L2	N53°08'00"E	10.00'
L3	N56°59'57"E	16.05'

EASEMENT CURVE TABLE

CURVE	DELTA	RADIUS	LENGTH
C1	0°02'16"	3066.00'	2.02'
C2	0°58'10"	2934.00'	49.64'
C3	0°58'10"	2924.00'	49.47'
C4	0°02'13"	3076.00'	1.98'
C5	0°11'41"	2950.00'	10.02'
C6	0°11'45"	2934.00'	10.03'

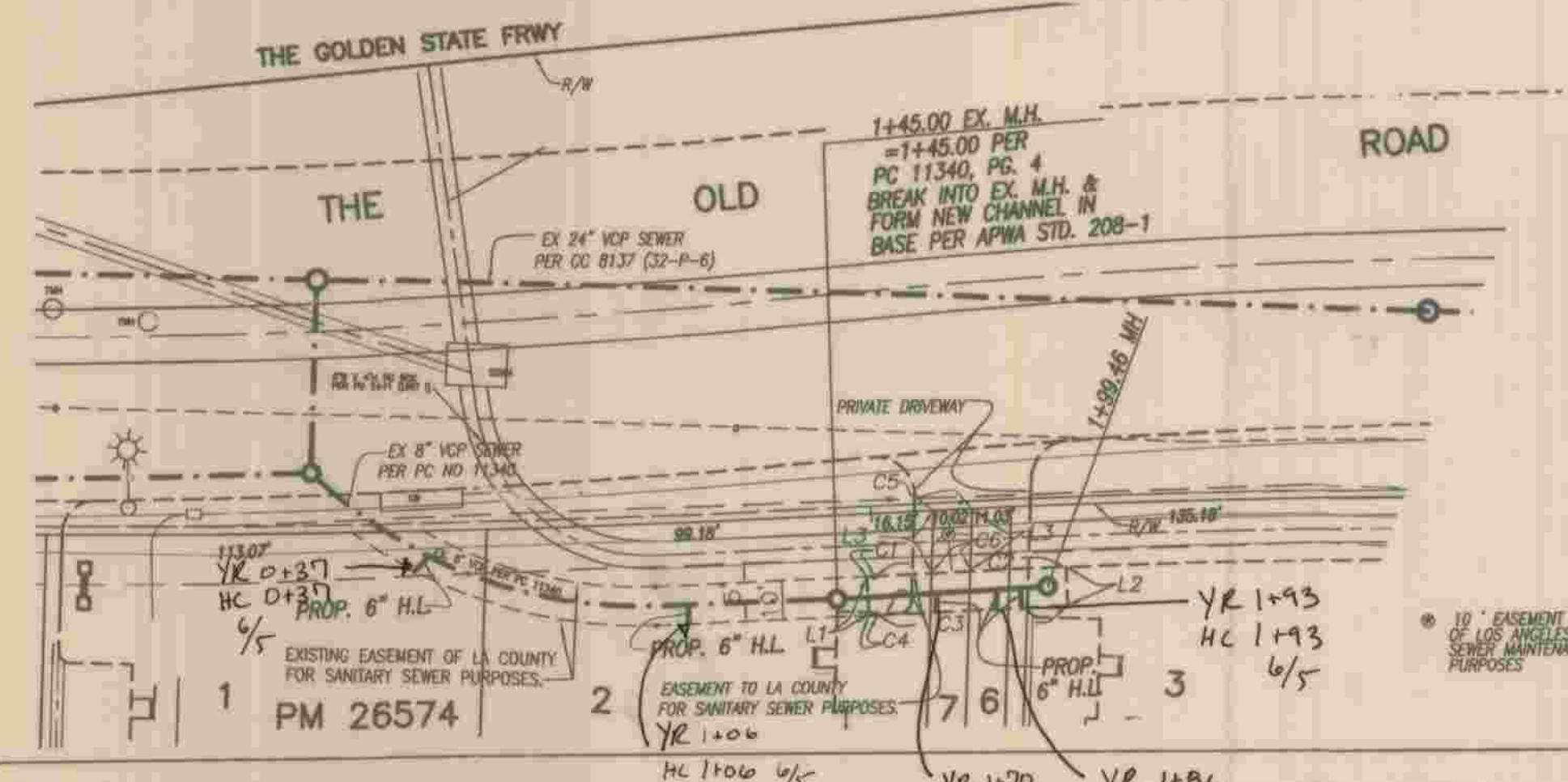

SCALE: 1" = 40'

SANITARY SEWER PLANS IN
 PARCEL MAP NO. 26574 P.C. NO. 11857
 REVIEWED LAND DEVELOPMENT DIVISION
 BY: *Fabricia Constanza* 07/13/05
 COUNTY OF LOS ANGELES DEPARTMENT OF PUBLIC WORKS
SIKAND Engineering | Planning | Surveying
 15230 Burbank Blvd, Van Nuys, CA 91411
 Tel: (818) 787-3550
 Fax: (818) 901-7451
 info@sikand.com

X:\skand\5101-2003\05\Engineering\Sanitary Sewer\DWG\SS-SHT 1.dwg, Layout1
 Plot Date: 06/28/05 15:46:05 by Doug