

**BENCH MARKS**  
 BM CY 9123 Elev. 864.986  
 L & T IN N END BAS ISLAND SERVICE STA NO 30354 SEMINOLA HOT SPRINGS STORE 49FT E C/L MULHOLLAND HWY 54FT S/O PPS38045E 0.35MI W/O SIERRA CREEK RD MKD (BM)  
 MALIBU NGVD 29 DATUM QUAD: 1980

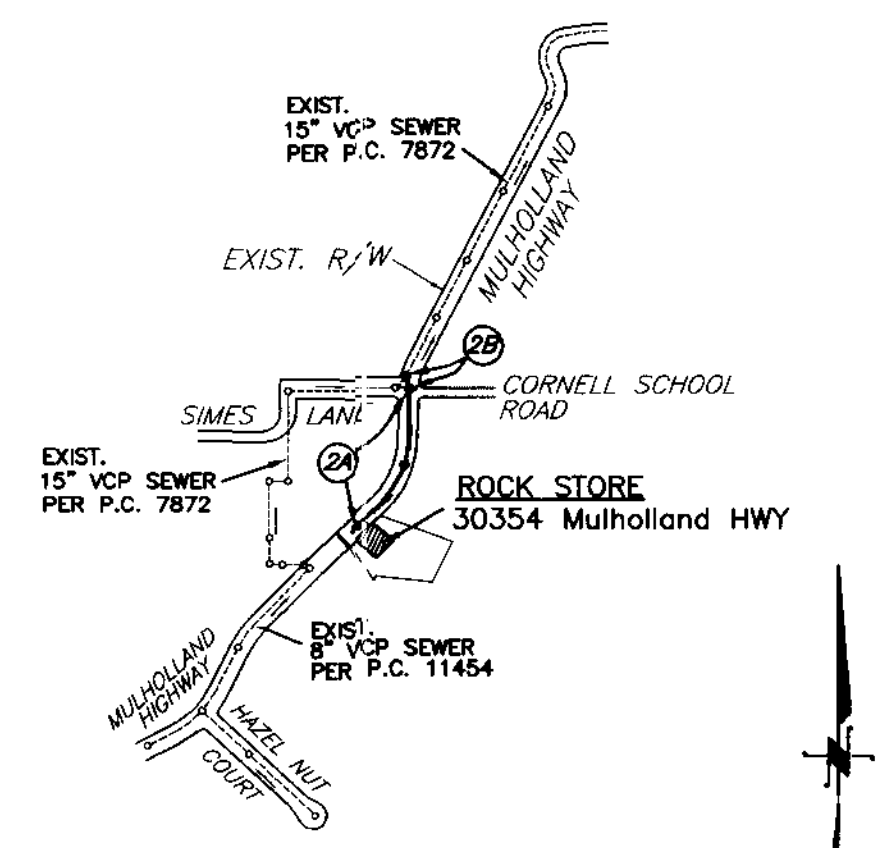

**INDEX MAP**  
 SCALE: 1"=600'  
 Note: Number in Circle Indicates Page Number

THOMAS GUIDE PAGE: 587-G4  
 INDEX S-1067 P.C. 11870 Mulholland Hwy and Cornell School Road

| NO. | REVISION | REVISED BY | APPROVED BY | DATE |
|-----|----------|------------|-------------|------|
|     |          |            |             |      |
|     |          |            |             |      |

**STORMWATER POLLUTION NOTES:**

- Eroded sediments and other pollutants must be retained on site and may not be transported from the site via sheet flow, swales, area drains, natural drainage courses, or wind.
- Stockpiles of earth and other construction related materials must be protected from being transported from the site by the forces of wind or water.
- Fuels, oils, solvents, and other toxic materials must be stored in accordance with their listing and are not to contaminate the soil and surface waters. All approved storage containers are to be protected from the weather. Spills must be cleaned up immediately and disposed of in a proper manner. Spills may not be washed into the drainage system.
- Excess or waste concrete may not be washed into the public way or any other drainage system. Provisions shall be made to retain concrete wastes on site until they can be disposed of as solid waste.
- Traffic and construction-related solid wastes must be deposited into a covered receptacle to prevent contamination of rainwater and dispersed by wind.
- Sediments and other materials may not be tracked from the site by vehicle traffic. The construction entrance roadway must be stabilized so as to inhibit sediments from being deposited into the public way. Accidental depositions must be swept up immediately and may not be washed down by rain or other means.
- Any slopes with disturbed soils or denuded of vegetation must be stabilized so as to inhibit erosion by wind and water.
- THE FOLLOWING BMP'S AS OUTLINED IN, BUT NOT LIMITED TO THE "BEST MANAGEMENT PRACTICE HANDBOOK, CALIFORNIA STORM WATER QUALITY TASK FORCE, SACRAMENTO, CALIFORNIA 2003 OR THE LATEST REVISED EDITION, MAY APPLY DURING THE CONSTRUCTION OF THIS PROJECT (ADDITIONAL MEASURES MAY BE REQUIRED IF DEEMED APPROPRIATE BY THE COUNTY INSPECTORS):

**NOTICE TO CONTRACTOR:**  
 MAINTAIN SEWER FLOW AT ALL TIMES DURING CONSTRUCTION.

**STANDARD PLANS:**  
 THE FOLLOWING LATEST REVISED STANDARD PLANS ON FILE IN THE OFFICE OF THE FOLLOWING DEPARTMENT SHALL APPLY IN THE CONSTRUCTION OF THIS PROJECT.

- LOS ANGELES COUNTY DEPARTMENT OF PUBLIC WORKS  
 2000-0 LEGEND FOR SANITARY SEWER PLANS AND PROFILES AND DISTRICT MAPS.  
 2003-2 REINFORCED PRECAST CONCRETE MANHOLE  
 2015-1 STANDARD MANHOLE STEP  
 2021-1 BEDDING FOR SEWER PIPE  
 2024-1 WYE OR TEE SUPPORT  
 2027-1 ALLOWABLE TRENCH WIDTHS  
 6008-1 MINIMUM PUBLIC SAFETY REQUIREMENTS

- AMERICAN PUBLIC WORKS ASSOCIATION  
 210-2 MANHOLE FRAME AND COVER LOCKING TYPE  
 222-1 HOUSE CONNECTION SEWER  
 223-1 HOUSE CONNECTION REMODELING

**NOTES:**  
 NO CONNECTION FOR THE DISPOSAL OF INDUSTRIAL WASTES SHALL BE MADE TO SEWERS SHOWN ON THESE DRAWINGS UNTIL A PERMIT FOR INDUSTRIAL WASTE WATER DISCHARGE HAS BEEN ISSUED BY THE COUNTY SANITATION DISTRICTS FOR SAID CONNECTIONS.

BEFORE BREAKING INTO OR CONSTRUCTION ON A COUNTY SANITATION DISTRICT SEWER AND PRIOR TO FINAL ACCEPTANCE OF THE PROJECT, A COUNTY SANITATION DISTRICT INSPECTOR SHALL BE NOTIFIED BY PHONE (626) 962-8605 SO THAT REQUIRED INSPECTION CAN BE MADE.

- TEMPORARY SOIL STABILIZATION**  
 SS1 - SCHEDULING  
 SS2 - PRESERVATION OF EXISTING VEGETATION  
 SS3 - HYDRAULIC MULCH  
 SS4 - HYDROSEEDING  
 SS5 - SOIL EROSION  
 SS6 - STRAW MULCH  
 SS7 - GEOTEXTILES, PLASTIC COVER, & EROSION CONTROL BLANKETS/MATS  
 SS8 - WOOD MULCHING  
 SS9 - EARTH DICES/ DRAINAGE SWALES & LINED DITCHES  
 SS10 - OUTLET PROTECTION/VELOCITY DISSIPATION DEVICES  
 SS11 - SLOPE DRAINS  
 SS12 - STREAMBANK STABILIZATION
- TEMPORARY SEDIMENT CONTROL**  
 SC1 - SILT FENCE  
 SC2 - SEDIMENT/DESILTING BASIN  
 SC3 - SEDIMENT TRAP  
 SC4 - CHECK DAM  
 SC5 - FILTER ROLLS  
 SC6 - GRAVEL BAG BERM  
 SC7 - STREET SWEEPING AND VACUUMING  
 SC8 - SANDBAG BARRIER  
 SC9 - STRAW BALE BARRIER  
 SC10 - STORM DRAIN INLET PROTECTION
- WIND EROSION CONTROL**  
 WE1 - WIND EROSION CONTROL
- TRACKING CONTROL**  
 TC1 - STABILIZED CONSTRUCTION ENTRANCE/EXIT  
 TC2 - STABILIZED CONSTRUCTION ROADWAY  
 TC3 - ENTRANCE/OUTLET TIRE WASH

- WASTE MANAGEMENT AND MATERIALS POLLUTION CONTROL**  
 MW1 - MATERIAL DELIVERY AND STORAGE  
 MW2 - MATERIAL USE  
 MW3 - STOCKPILE MANAGEMENT  
 MW4 - SPILL PREVENTION AND CONTROL  
 MW5 - SOLID WASTE MANAGEMENT  
 MW6 - HAZARDOUS WASTE MANAGEMENT  
 MW7 - CONTAMINATED SOIL MANAGEMENT  
 MW8 - CONCRETE WASTE MANAGEMENT  
 MW9 - SANITARY/SEPTIC WASTE MANAGEMENT  
 MW10 - LIQUID WASTE MANAGEMENT
- NON-STORMWATER MANAGEMENT**  
 NS1 - WATER CONSERVATION PRACTICES  
 NS2 - Dewatering OPERATIONS  
 NS3 - PAVING AND GRINDING OPERATION  
 NS4 - TEMPORARY STREAM CROSSING  
 NS5 - CLEAR WATER DIVERSION  
 NS6 - ILLEGAL CONNECTION/ILLEGAL DISCHARGE  
 NS7 - DETECTION AND REPORTING  
 NS8 - POTABLE WATER/IRRIGATION  
 NS9 - VEHICLE AND EQUIPMENT CLEANING  
 NS10 - VEHICLE AND EQUIPMENT FUELING  
 NS11 - FUEL DRAINING OPERATIONS  
 NS12 - CONCRETE CURING  
 NS13 - MATERIAL AND EQUIPMENT USE OVER WATER  
 NS14 - CONCRETE FINISHING  
 NS15 - STRUCTURE DEMOLITION/REMOVAL OVER OR ADJACENT TO WATER

**PRIVATE CONTRACT SEWER GENERAL NOTES**

- A sewer construction permit shall be obtained and a fee paid for construction inspection and record plans to the Department of Public Works at the Permit Counter, 500 South Fremont Avenue, 8th Floor, Alhambra, at least 72 hours prior to starting work under this permit. Copies of all other required permits, such as Road Excavation, Caltrans, etc., must be filed with the permit application.
  - Prior to issuance of any permit, the contractor shall file a permit for excavations and trenches from the State of California Division of Industrial Safety, and a Certificate of Worker's Compensation Insurance with the Department of Public Works named as the Certificate Holder to be notified 30 days prior to work.
  - If work is done in a State Highway, a permit must be obtained from the State of California Division of Highways, 120 South Spring Street, Los Angeles, California.
  - When work is within a contract city, the contractor must contact the Director of Public Works of that city to determine the location to pay the inspection fee.
  - The contractor shall contact the district office listed on the "Application for Construction Permit" to arrange for an acceptable construction start date.
  - Approval of this plan by the County of Los Angeles does not constitute a representation as to accuracy of the location of or the existence or non-existence of any underground utility pipe or structure within the limits of this project. This note applies to all pages.
  - All work shall be in accordance with the latest approved edition of the "Standard Specifications for Public Works Construction, including supplements and the latest Special Provisions for the Construction of Sanitary Sewers and shall be prosecuted only in the presence of the Department of Public Works.
  - The contractor's attention is directed to Section 7-10.4.1 of the Standard Specifications for Public Works Construction in regard to safety orders and shall conform to the "Minimum Public Safety Requirements" as shown on Los Angeles Department of Public Works' Standard S-2.
  - Elevations are in feet above U.S.C. & G.S. sea level datum of 1929.
  - No revisions shall be made in these plans without the approval of the Director of Public Works.
  - No representative of the Department of Public Works will survey or lay out any portion of the work.
  - Grades to which this improvement is to be constructed are shown on plans and profiles. Grade points for top of curbs, centerline of streets, or centerline of alleys, are shown by circles on profiles of all points between designated points. The grade shall be established so as to conform to a straight line drawn between said designated points.
  - The private engineer shall furnish the Department of Public Works with grade sheets and stationing for all house laterals and 1" or 1 1/2" branches and shall provide stakes for them at their proper locations with stationing plainly marked. All house laterals shall be constructed in a straight alignment at right angles from the main sewer except as shown on the plans. House laterals from chimneys shall not have an angle of less than 45 degrees with the M.L. sewer. Any change in alignment shall be requested in writing by the private engineer.
  - The private engineer shall furnish the house lateral depth at the property line below the top of curb elevation for each house lateral on the grade sheet.
  - An approved backwater valve is required when the pad is lower in elevation than the top of the next upstream manhole.
- CONSTRUCTION NOTES**
- Provide survey stakes on the property line or property lines produced at right angles to the sewer line at the centerline of each manhole.
  - Verified clay pipe joints shall be type "D" or "C" per standard specifications section 208-2.
  - If a powerpole is within three feet of the sewer, the sewer shall be encased per standard plan S-23, case II, two feet on each side from the point of interference.
  - All joints between cast iron pipe and vitrified clay shall be made with a rubber sleeve joint, type "D" (with bushing if necessary) per standard specifications section 208-2.
  - House laterals to be constructed with inverts at the property line 6 feet below curb grade except as noted.
  - Wye or tee branches may be used for connections to the mainline sewers except as noted.
  - If during the course of construction, it is determined that there is less than four feet of cover over the top of a mainline or house lateral V.C.P. sewer which is not indicated on the plans, the pipes shall be encased per standard plan S-23, case II, unless otherwise approved by the director of Public Works.
  - All structures shall be either brick sewer manholes per standard plan S-3 or precast concrete sewer manholes per standard plan S-36, or reinforced precast concrete manhole per standard plan S-8, except as noted.
  - Clearance of all trenches within paved areas to meet Los Angeles County Public Works or California State Highway requirements in accordance with the permits.
  - Full compliance with section 306-1.3.4 of the standard specification will be required for backfill in street certification of backfill composition and sand equivalents by a qualified civil engineer shall be provided by the permittee prior to the issuance of a certificate of partial acceptance.
  - All backfill and fills outside of the street right of way shall be compacted to 90% of the maximum density as determined by ASTM soil compaction test D 1557-76 method 1b, unless otherwise specified. This shall be certified by a qualified civil engineer. This certification shall be submitted to the Construction Division of the Department of Public Works prior to the acceptance of the work by the county.
  - Manhole tops in unimproved rights of way to be six inches above finished grade.
  - Sewers to be tested for leakage per section 306-1/A of the standard specifications and special provisions.
  - Manhole tops in improved rights of way to be level with finished grade.
  - All wyes and/or house laterals are to be located at least 5' apart and when possible not closer than 5' to any manhole.

PROFILE, ALIGNMENT AND GRADE OF  
**SANITARY SEWERS**  
 TO BE CONSTRUCTED IN  
 Mulholland Hwy and Cornell School Road PC NO. 11870  
 1 SHEET: 2 PAGES  
 COUNTY OF LOS ANGELES CALIFORNIA  
 INDEX S-1067

Donald L. Wolfe DIRECTOR OF PUBLIC WORKS  
 APPROVED BY LAND DEVELOPMENT DIVISION  
 BY: [Signature] DATE: 8/1/05  
 ASSISTANT DIVISION ENGINEER  
 SUBMITTED BY: [Signature] DATE: 8/1/05  
 SUBDIVISION PLAN CHECKING SECTION DATE

LAS VIRGENES MUNICIPAL WATER DISTRICT  
 John Mundy - GENERAL MANAGER  
 APPROVED BY: [Signature] DATE: 8/1/05  
 David R. Lippman  
 DIRECTOR OF FACILITIES AND OPERATIONS

**PRIVATE ENGINEERS NOTICE TO CONTRACTORS:**  
 THE EXISTENCE AND LOCATION OF ANY UNDERGROUND UTILITY PIPES OR STRUCTURES SHOWN ON THESE PLANS IS REQUIRED BY A SEARCH OF AVAILABLE RECORDS TO THE BEST OF OUR KNOWLEDGE. THERE ARE NO EXISTING UTILITIES EXCEPT AS SHOWN ON THIS MAP. THE CONTRACTOR IS REQUIRED TO TAKE PRECAUTIONARY MEASURES TO PROTECT THE UTILITY LINES SHOWN AND ANY OTHER LINES NOT OF RECORD OR NOT SHOWN ON THIS DRAWING. PRIOR TO EXCAVATION THE CONTRACTOR SHALL CALL TOLL FREE 1-800-425-4133 TO VERIFY THE UNDERGROUND LOCATION OF GAS AND TELEPHONE LINES. THE CONTRACTOR SHALL ALSO CALL MR. RAY CUMMINGS OF GENERAL TELEPHONE COMPANY AT 1-805-948-4871 SO THAT THEY CAN MARK THE LOCATION OF UNDERGROUND TELEPHONE LINES.  
 [Signature] DATE: 7/29/05  
 E.J. KIM/REG. NO. 42388, EXP. 3/31/06

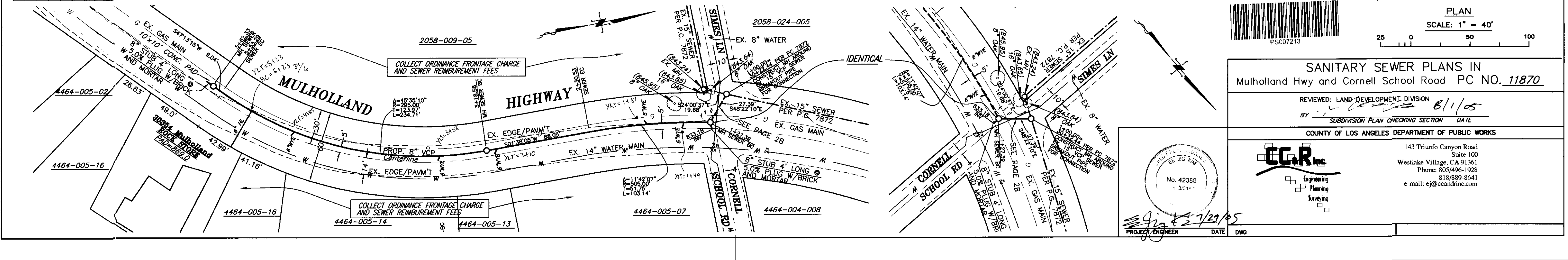
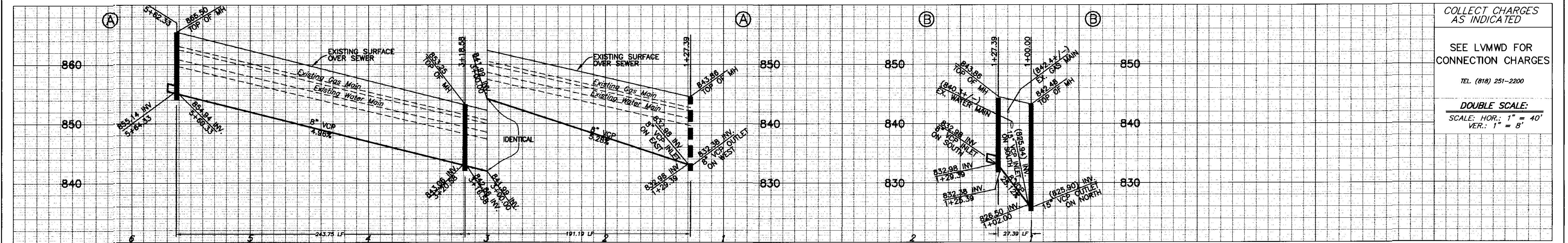

PLAN  
 SCALE: 1" = 40'  
 25 0 50 100

COLLECT CHARGES AS INDICATED  
 SEE LVMWD FOR CONNECTION CHARGES  
 TEL. (818) 251-2200  
 DOUBLE SCALE:  
 SCALE: HOR.: 1" = 40'  
 VER.: 1" = 8'

SANITARY SEWER PLANS IN  
 Mulholland Hwy and Cornell School Road PC NO. 11870  
 REVIEWED: LAND DEVELOPMENT DIVISION  
 BY: [Signature] DATE: 8/1/05  
 SUBDIVISION PLAN CHECKING SECTION DATE  
 COUNTY OF LOS ANGELES DEPARTMENT OF PUBLIC WORKS

CC&R Inc.  
 Engineering  
 Planning  
 Surveying

143 Triunfo Canyon Road  
 Suite 100  
 Westlake Village, CA 91361  
 Phone: 805/496-1928  
 818/889-8641  
 e-mail: e@ccandrc.com

No. 42388  
 PROJECT ENGINEER DATE: 7/29/05 DWG