

APPROVED BY LAND DEVELOPMENT DIVISION DIRECTOR OF PUBLIC WORKS
 BY *[Signature]* DATE 1/20/10
 SUBMITTED BY *[Signature]* DATE 01/20/2010
 DATE 01/20/2010

COUNTY SANITATION DISTRICT NO. 1
 OF LOS ANGELES COUNTY, CALIFORNIA
 STEPHEN R. MAGUIRE - CHIEF ENGINEER AND GENERAL MANAGER
 APPROVED BY *[Signature]* DATE 4/1/2010

CITY OF COMPTON APPROVAL
 TRACT/PARCEL/ADDRESS 15810 FRAYLEY AVE. PC NO.
 CITY OF COMPTON DISCHARGE CHECKED APPROVED
 WE APPROVE THIS AREA STUDY/PLAN AND CONCUR WITH THE FOLLOWING
 FINDINGS WITHIN THE CITY NO MITIGATION MITIGATION
 APPROVED BY *[Signature]* DATE 1/20/10
 DATE 3/22/10

PRIVATE ENGINEERS NOTICE TO CONTRACTORS:
 THE EXISTENCE AND LOCATION OF ANY UNDERGROUND UTILITY PIPES OR STRUCTURES SHOWN
 ON THESE PLANS IS REQUIRED BY A SEARCH OF AVAILABLE RECORDS TO THE BEST OF OUR
 KNOWLEDGE. THERE ARE INDICATING UTILITIES EXCEPT AS SHOWN ON THIS MAP. THE
 CONTRACTOR IS REQUIRED TO TAKE PRECAUTIONARY MEASURES TO PROTECT THE UTILITY
 LINES SHOWN AND ANY OTHER LINES NOT SHOWN OR NOT SHOWN ON THE DRAWING.
 PRIOR TO EXCAVATION THE CONTRACTOR SHALL CALL TOLL FREE 1-800-422-4133 TO
 VERIFY THE UNDERGROUND LOCATION OF GAS AND TELEPHONE LINES. THE CONTRACTOR
 SHALL ALSO CALL MR. RAY CANNON OF GENERAL TELEPHONE COMPANY AT 1-800-948-4877
 SO THAT THEY CAN MARK THE LOCATION OF UNDERGROUND TELEPHONE LINES.
 PROJECT ENGINEER *[Signature]* RCE NO. 30790 DATE 1-7-10

NO. L.A. Co. DPW CHARGES
 FOR CONNECTIONS
 SEE SANITATION
 DISTRICTS FOR
 SPECIAL CONNECTION
 CHARGES
 TEL. (562) 808-4288 EX. 2727
 HOR: 1"=40'
 VER: 1"=4'

BENCH MARKS
 COUNTY OF LOS ANGELES PUBLIC WORKS IN NUMBER Y-6788
 ELEV=66.374
 DESCRIPTION: BENCH TAG IN W. OF C. 121 N.W. 1/2 SEC. 8 N.W. COR.
 ATLANTIC AVE. & ALDINE BLVD. 348 N. & 121 W. 1/2 C/L INT.
 BELLFLOWER-LAKEWOOD QUAD YEAR 2005 ASL MAY 20 08

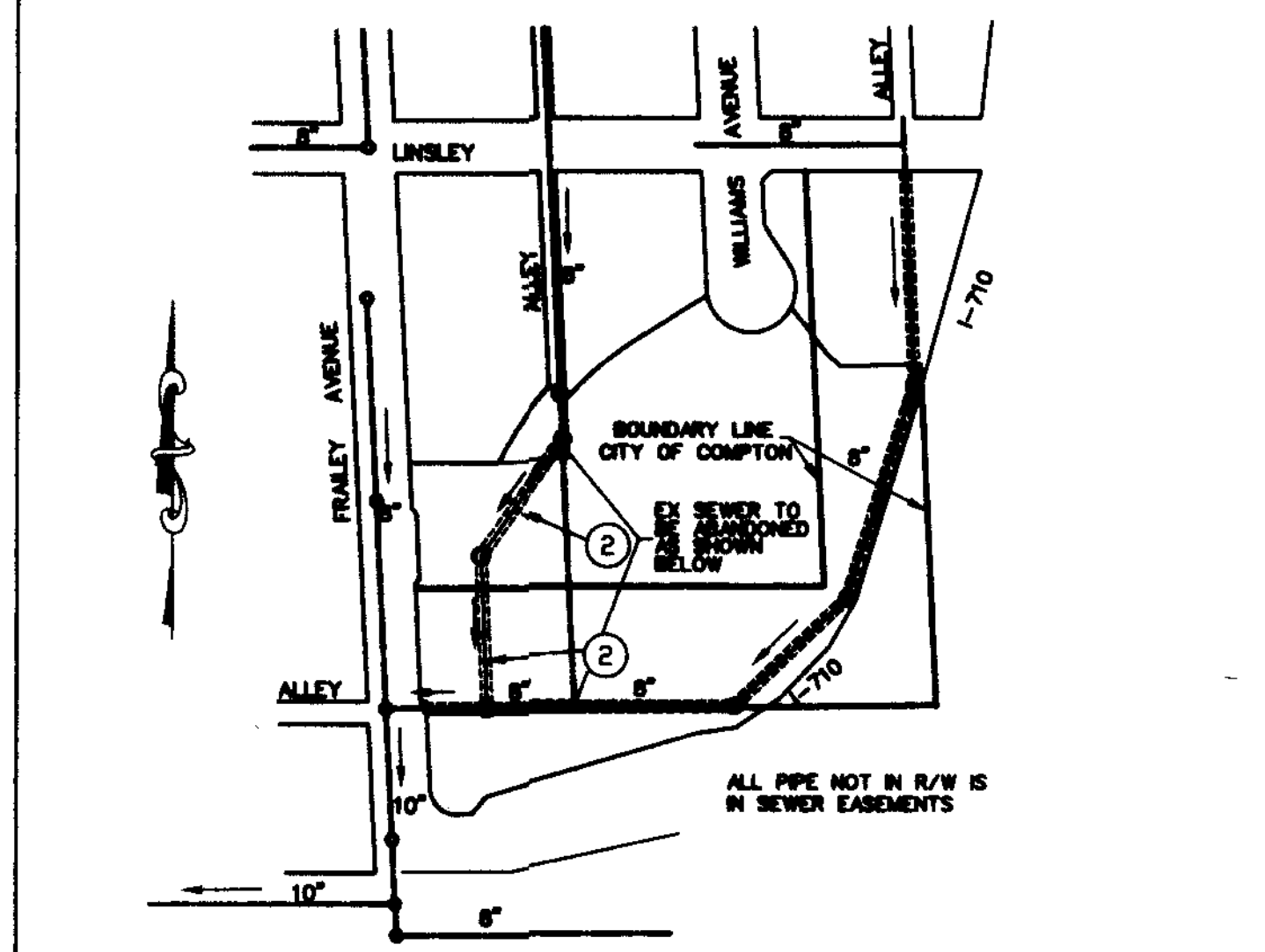

INDEX MAP
 Building and Safety District Office: FIRESTONE
 NOTES: NUMBER IN CIRCLE INDICATES PAGE NUMBER.
 ALL MAINLINE SANITARY SEWERS ARE WITHIN
 THE SANITARY SEWER EASEMENT
 P.C. 12092 CUP:2007-00134(2)
 THOMAS GUIDE PAGE: 736 D5

STORMWATER POLLUTION PLAN NOTES
 A. NOTES:
 1. Erosion sediments and other pollutants must be retained on site and may not be transported from the site via sheetflow, swales, area drains, natural drainage courses or wind.
 2. Stockpiles of earth and other construction related materials must be protected from being transported from the site by the forces of wind or water.
 3. Fuels, oils, solvents, and other toxic materials must be stored in accordance with their labeling and are not to contaminate the soil and surface waters. All approved storage containers are to be protected from the weather. Spills must be cleaned up immediately and disposed of in a proper manner. Spills may not be washed into the drainage system.
 4. Excess or waste concrete may not be washed into the Public way or any other drainage system. Provisions shall be made to retain concrete wastes on site until they can be disposed of as solid waste.
 5. Trash and construction related solid wastes must be deposited into a covered receptacle to prevent contamination of rainwater and degraded by wind.
 6. Sediments and other materials may not be tracked from the site by vehicle traffic. The construction entrance roadways must be stabilized so as to inhibit sediments from being deposited into the public way. Accidental depositions must be swept up immediately and may not be washed down by rain or other means.
 7. Any slopes with disturbed soil or denuded vegetation must be stabilized so as to inhibit erosion by wind and water.
 8. The following BMPs as outlined in, but not limited to, the "Best Management Practice Handbook, California Stormwater quality task force, Sacramento, California, 2003", or the latest revised edition, may apply during the construction of this project (Additional measures may be required if deemed appropriate by county inspectors):

- EROSION CONTROL**
 EC-1 Scheduling
 EC-2 Preservation of Existing Vegetation
 EC-3 Hydraulic Mulch
 EC-4 Hydroseeding
 EC-5 Soil Binders
 EC-6 Straw Mulch
 EC-7 Geotextiles and Mats
 EC-8 Wood Mulching
 EC-9 Earth Dams and Drainage Swales
 EC-10 Velocity Dissipation Swales
 EC-11 Slope Drains
 EC-12 Streambank Stabilization
 EC-13 Polyacrylamide
- TEMPORARY SEDIMENT CONTROL**
 SE-1 Silt Fence
 SE-2 Sediment Basin
 SE-3 Sediment Trap
 SE-4 Check Dams
 SE-5 Fiber Rolls
 SE-6 Gravel Bag Berm
 SE-7 Street Sweeping and Vacuuming
 SE-8 Sandbag Barrier
 SE-9 Straw Bale Barrier
 SE-10 Storm Drain Inlet Protection
 SE-11 Chemical Treatment
- WIND EROSION CONTROL**
 WE-1 Wind Erosion Control

- WASTE MANAGEMENT AND MATERIALS POLLUTION CONTROL**
 WM-1 Material Delivery and Storage
 WM-2 Material Use
 WM-3 Stockpile Management
 WM-4 Spill Prevention and Control
 WM-5 Solid Waste Management
 WM-6 Hazardous Waste Management
 WM-7 Contaminated Soil Management
 WM-8 Concrete Waste Management
 WM-9 Sanitary/Special Waste Management
 WM-10 Liquid Waste Management
- NON-STORM WATER MANAGEMENT**
 NS-1 Water Conservation Practices
 NS-2 Dewatering Operations
 NS-3 Paving and Grinding Operations
 NS-4 Temporary Stream Crossing
 NS-5 Clear Water Diversion
 NS-6 Inlet Connection/Discharge
 NS-7 Potable Water/Irrigation
 NS-8 Vehicle and Equipment Cleaning
 NS-9 Vehicle and Equipment Maintenance
 NS-10 Vehicle and Equipment Maintenance
 NS-11 Pile Driving Operations
 NS-12 Concrete Curing
 NS-13 Concrete Finishing
 NS-14 Material Over Water
 NS-15 Demolition Waste to Water
 NS-16 Temporary Batch Plants
- EQUIPMENT TRACKING CONTROL**
 TR-1 Stabilized Construction Entrance/Exit
 TR-2 Stabilized Construction Roadway
 TR-3 Entrance/Outlet Tire Wash

SANITATION DISTRICTS NOTES:
 1. No connection for the disposal of industrial wastes shall be made to sewers shown on these drawings until a permit for industrial waste discharge has been issued by the County Sanitation Districts for solid connections.
 2. Before breaking into or constructing a Sanitation Districts sewer and prior to final acceptance of the project, a Sanitation Districts inspector shall be notified by telephone at (310) 638-1900, so that required inspection can be made.
 Any damage to the sewer line shall be the responsibility of the contractor/owner. All grading and construction occurring over and the vicinity of the existing sewer shall be performed in the presence of a County Inspector. Where applicable, the sewers shall be protected per Std. Plan 203-2 at storm drain crossings.

PRIVATE CONTRACT SEWER GENERAL NOTES

- The following general notes are to be included on Page 1 of all Private Contract Sewer Plans:
- A sewer construction permit shall be obtained and a fee paid for construction inspection and record plans to the County of Los Angeles Department of Public Works, City Engineer for the City of Compton at the Permit Counter, 900 South Fremont Avenue, 8th Floor, Alhambra, at least 72 hours prior to starting work under the permit. Copies of all other required permits, such as Road Excavation, Curb, etc., must be filed with the permit application.
 - Prior to issuance of any permit, the contractor shall file a permit for excavations and trenches from the State of California Division of Industrial Safety, and a Certificate of Worker's Compensation Insurance with the Department of Public Works named as the Certificate Holder, The County of Los Angeles Department of Public Works, City Engineer for the City of Compton shall be notified 30 days prior to cancellation of the insurance policy.
 - If work is done in a State Highway, a permit must be obtained from the State of California Division of Highways, 120 South Spring Street, Los Angeles, California.
 - When work is within a contract city, the contractor must contact the Director of Public Works of that city, to determine the location to pay the inspection fee.
 - The contractor shall contact the district office listed on the "Application for Construction Permit" to arrange for an acceptable construction start date.
 - Approval of this plan by the County of Los Angeles Department of Public Works, City Engineer for the City of Compton does not constitute a representation as to accuracy of the location or the existence or non-existence of any underground utility pipe or structure within the limits of this project. This note applies to all pages.
 - All work shall be in accordance with the latest approved edition of the "Standard Specifications for Public Works Construction", including supplements of (there is any), the latest "Additions and Amendments to the Standard Specifications for Public Works Construction" and the latest "Special Provisions for the Construction of Sanitary Sewer" and shall be prosecuted only in the presence of the County of Los Angeles Department of Public Works.
 - The contractor's attention is directed to Section 7-10.4.1 of the "Standard Specifications for Public Works Construction" in regard to safety orders and shall conform to the "Minimum Public Safety Requirements" as shown on Los Angeles Department of Public Works standard plan 8008-1.
 - Elevations are in feet above U.S.C. & G.S. sea level datum of 1988.
 - No revisions shall be made in these plans without the approval of the County of Los Angeles Department of Public Works, City Engineer for the City of Compton.
 - No representative of the County of Los Angeles Department of Public Works, City Engineer for the City of Compton will survey or lay out any portion of the work.
 - Grades to which this improvement is to be constructed are shown on plans and profiles. Grade points for top of curbs, cantinere of streets, or cantinere of alleys are shown by circles on profiles at all points between said designed points. The grade shall be established so as to conform to a straight line across between said design points.
 - The private engineer shall furnish the County of Los Angeles Department of Public Works, City Engineer for the City of Compton with grade sheets and stationing for all house laterals and "T" or "Y" branches and shall provide stakes for them at their proper locations with stationing clearly marked. All house laterals shall be constructed in a straight alignment at right angles from the main line sewer except as shown on the plans. House laterals from chimneys shall not have an angle of less than 45 degrees with the M.L. sewer. Any change in alignment shall be requested in writing by the private engineer.
 - The private engineer shall furnish the house lateral depth at the property line below the top of curb elevation for each house lateral on the grade sheet.
 - An approved backwater valve is required when the pad is lower in elevation than the top of the next upstream manhole.
 - Contact Environmental Programs Division for industrial waste discharge permit # (626) 458-3517
- CONSTRUCTION NOTES**
- Provide survey stakes on the property line or property lines produced at right angles to the sewer line at the centerline of each manhole.
 - Vitrified clay pipe joints shall be type "D" or "C" per "Standard Specifications for Public Works Construction" Section 208-2.
 - If a powerpole is within three feet of the sewer, the sewer shall be encased per LACDPW standard plan 203-2, Case II, two feet on each side from the point of interference.
 - All joints between cast iron pipe and vitrified clay shall be made with a rubber sleeve joint, type "D" (with bushing if necessary) per "Standard Specifications for Public Works Construction" Section 208-2.
 - House laterals to be constructed with inverts at the property line 6 feet below curb grade except as noted.
 - Wye or tee branches may be used for connections to the mains sewers except as noted.
 - If during the course of construction, it is determined that there is less than four feet of cover over the top of a mainline or house lateral V.C.P. sewer which is not indicated on the plans, the pipes shall be encased per LACDPW standard plan 203-2, Case II, unless otherwise approved by the County of Los Angeles Department of Public Works, City Engineer for the City of Compton.
 - All structures shall be either brick sewer manholes per LACDPW standard plan S-3 (SPPWC 203-0), or precast concrete sewer manholes per LACDPW standard plan S-36 (SPPWC 200-2), or reinforced precast concrete manhole per LACDPW standard plan 203-2, except as noted.
 - Resurface all trenches within paved areas to meet Department of Public Works or California State Highway requirements in accordance with the permits.
 - Full compliance with Section 306-1.3 of the "Standard Specifications for Public Works Construction" shall be required for backfill in street. Certification of backfill composition, and sand analysis by a qualified civil engineer shall be provided by the contractor prior to the issuance of a certificate of partial acceptance.
 - All backfill and fills outside of the street right of way shall be compacted to 90% of the maximum density as determined by ASTM soil compaction test D 1557-78 method "D" unless otherwise specified. This shall be certified by a qualified civil engineer. This certification shall be submitted to the Construction Division prior to the acceptance of the work by the county.
 - Manhole tops in unimproved rights of way to be six inches above finished grade.
 - Sewers to be tested for leakage per section 306-1.4 of the "Standard Specifications for Public Works Construction" and "Special Provisions for the Construction of Sanitary Sewer" if applicable.
 - Manhole tops in improved rights of way to be level with finished grade.
 - All wyes and/or house laterals are to be located at least 5' apart and when possible not closer than 5' to any manhole.
 - All pipe materials shall be vitrified clay pipe or ductile iron pipe or other approved materials by the County Engineer.
- NOTICE TO CONTRACTOR:**
 MAINTAIN SEWER FLOW AT ALL TIMES DURING CONSTRUCTION. BACKWATER VALVES ARE NECESSARY FOR ALL BUILDING CONNECTIONS.
- ISSUE NO HOUSE LATERAL CONNECTION PERMITS UNTIL OUTLET SEWER PC 12092 IS ACCEPTED FOR PUBLIC USE BY THE COUNTY OF LOS ANGELES.

NO.	REVISION	REVISED BY	APPROVED BY	DATE
1	REVISED LATERAL DIAPHRAGMS AND CONNECTION POINTS	VINCENT SCARPATI RCE 33520	<i>[Signature]</i>	8/19/10

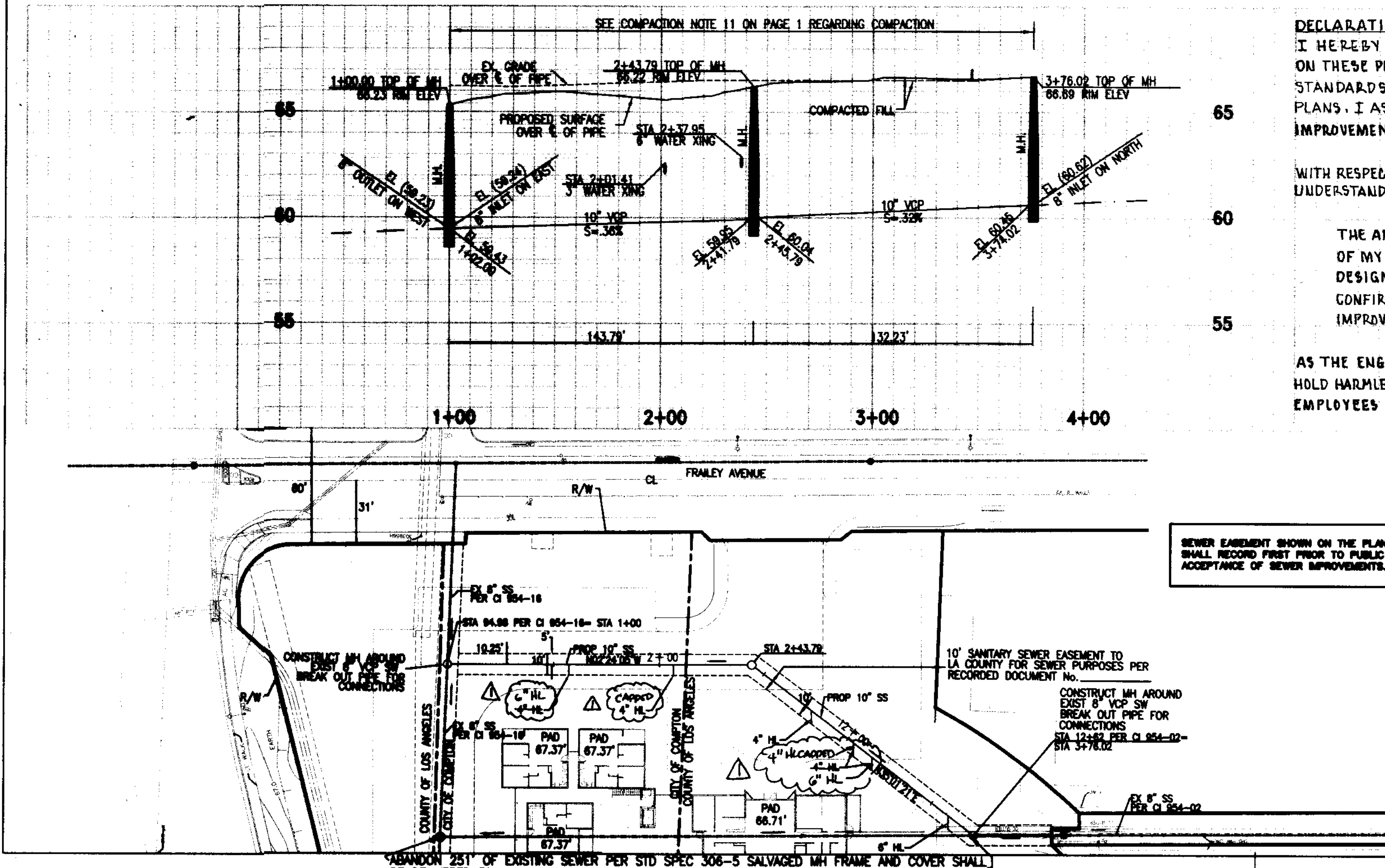

DECLARATION OF ENGINEER OF RECORD:
 I HEREBY DECLARE THAT THE DESIGN OF IMPROVEMENTS SHOWN ON THESE PLANS COMPLIES WITH ALL PROFESSIONAL ENGINEERING STANDARDS AND PRACTICES, AS THE ENGINEER OF RECORD FOR THE PLANS, I ASSUME FULL RESPONSIBILITY FOR THE DESIGN OF THE IMPROVEMENTS.
 WITH RESPECT TO THE APPROVAL OF THE CITY OF COMPTON, I UNDERSTAND AND ACKNOWLEDGE THE FOLLOWING:
 THE APPROVAL OF THE CITY OF COMPTON DOES NOT RELIEVE ME OF MY LEGAL AND PROFESSIONAL RESPONSIBILITY FOR THE DESIGN OF THE IMPROVEMENTS. NOR DOES THE APPROVAL CONFIRM THE TECHNICAL ADEQUACY OF THE DESIGN OF THE IMPROVEMENTS.
 AS THE ENGINEER OF RECORD, I AGREE TO DEFEND, INDEMNIFY, AND HOLD HARMLESS THE CITY OF COMPTON, ITS ELECTED OFFICIALS, EMPLOYEES AND AGENTS FROM ANY AND ALL ACTUAL OR ALLEGED

CLAIMS, DEMANDS, CAUSES OF ACTION, LIABILITY, LOSS, DAMAGE, OR INJURY TO PROPERTY OF PERSONS, INCLUDING WRONGFUL DEATH, WHETHER IMPOSED BY A COURT OF LAW OR ADMINISTRATIVE ACTION OF ANY FEDERAL, STATE OR LOCAL GOVERNMENT AGENCY, ARISING OUT OF OR INCIDENT TO ANY NEGLIGENT ACTS, OMISSIONS, OR ERRORS BY THE ENGINEER OF RECORD, ITS EMPLOYEES, CONSULTANTS, OR AGENTS.
 VINCENT SCARPATI RCE 33520
 DATE 3-10-10



PROJECT INTERIOR APN(S): 818-032-040, 041, 043, 044, 045, 046, 047, 048
 RECONSTRUCTION NOTES:
 1. Remove existing sewer pipe and install new sewer as noted above.
 2. Break into existing manhole and form new channel in base per APWA 208-1.
 3. Maintain sewer flow at all times during construction.
 4. Remedial and reconnect all existing house laterals per LA County standards.
 PLAN
 SCALE: 1" = 40'
 EXISTING SEWER SYSTEM SHALL BE OPERATIONAL AT ALL TIMES DURING RECONSTRUCTION. NOTIFY AFFECTED HOMEOWNERS AT LEAST 72 HRS IN ADVANCE.
 RECONSTRUCTION NOTES:
 1. Remove existing sewer pipe and install new sewer as noted above.
 2. Break into existing manhole and form new channel in base per APWA 208-1.
 3. Maintain sewer flow at all times during construction.
 4. Remedial and reconnect all existing house laterals per LA County standards.
 PLAN
 SCALE: 1" = 40'
 EXISTING SEWER SYSTEM SHALL BE OPERATIONAL AT ALL TIMES DURING RECONSTRUCTION. NOTIFY AFFECTED HOMEOWNERS AT LEAST 72 HRS IN ADVANCE.

NO.	REVISION	REVISED BY	APPROVED BY	DATE

SANITARY SEWER PLANS IN
 CUP 200700134 - (2)
 REVIEWED BY LAND DEVELOPMENT DIVISION
 BY *[Signature]* DATE 1/19/10
 COUNTY OF LOS ANGELES DEPARTMENT OF PUBLIC WORKS
 CONSULTING, INC. CIVIL ENGINEERING LAND PLANNING & SURVEYING
 18 TECHNOLOGY STE 154 IRVINE, CALIFORNIA 92618
 (949) 769-8800 (949) 769-8605 FAX VSCARPATI@CVC-INC.NET

ABANDON 251' OF EXISTING SEWER PER STD SPEC 306-5 SALVAGED MH FRAME AND COVER SHALL BE DELIVERED TO LA COUNTY SOUTH SEWER MAINTENANCE YARD AT 1129 E 59TH ST LOS ANGELES CA 90001 TEL. (323) 233-3330.