

BENCHMARK:
 LOS ANGELES COUNTY DEPARTMENT OF PUBLIC WORKS BM. NO. Y 7784
 L&T IN CATCH BASIN 13.4M (44') E/O BCR @ NORTHEAST CORNER OF
 IMPERIAL HWY & RIVES AVE.
 ELEVATION: 99.698 FT (2005 ADJUSTMENT, NAVD 88)

BASIS OF BEARING:
 THE INVERSE OF THE STATE PLANE COORDINATES HELD
 FIXED BETWEEN POINTS 73 AND 70 PER RECORD OF SURVEY FILED IN BOOK
 145 PAGE 49 TO 53 OF RECORD OF SURVEY IN THE OFFICE OF THE LOS
 ANGELES COUNTY RECORDER.

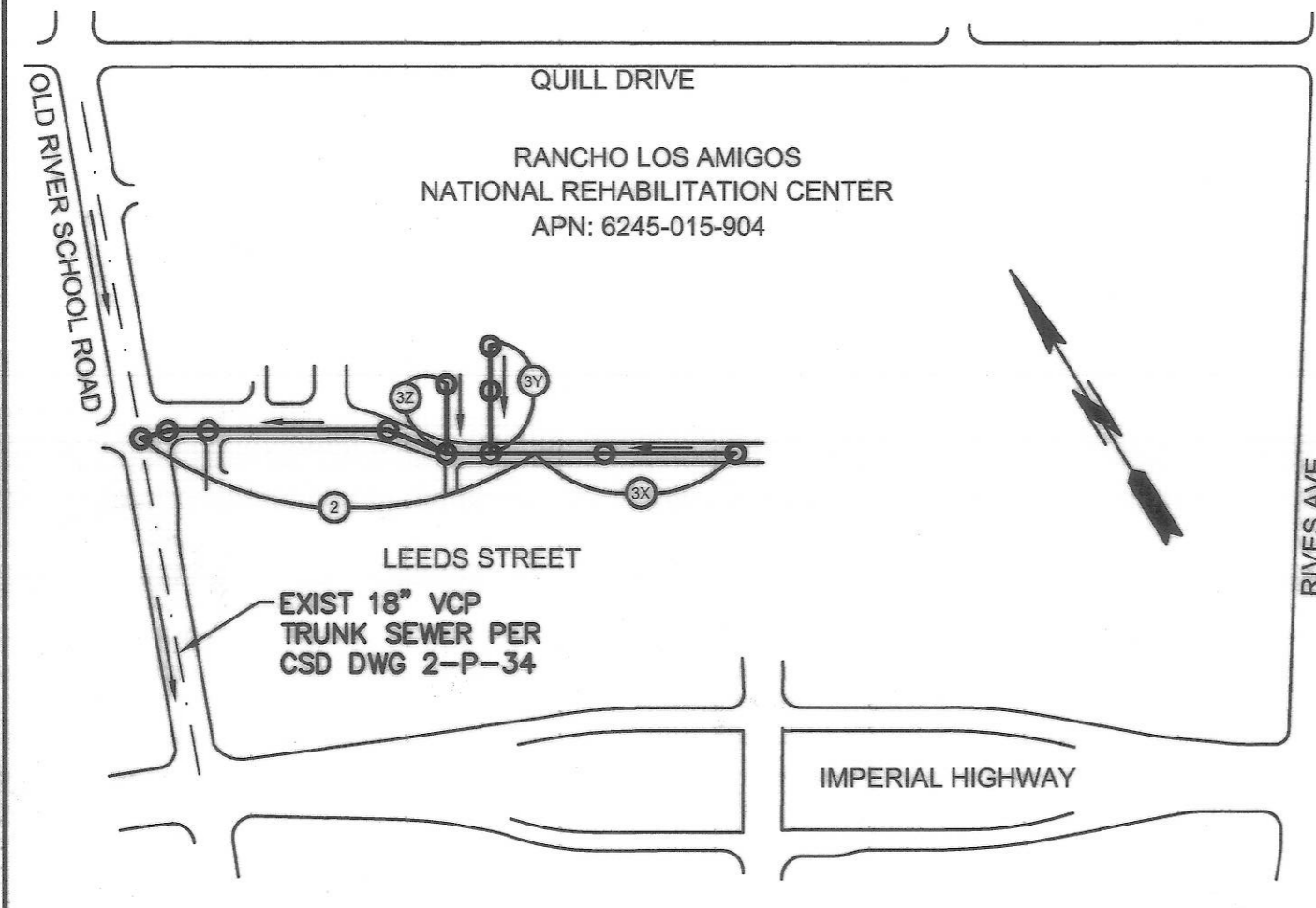

INDEX MAP
 CENTRAL OFFICE
 900 SOUTH FREMONT AVE.
 3RD FLOOR ALHAMBRA, CA 91803
 BUILDING AND SAFETY DISTRICT OFFICE: ALHAMBRA, CA 91803
 NOTES: NUMBER IN CIRCLE INDICATES PAGE NUMBER.
 ALL MAINLINE SEWER WITHIN SANITARY SEWER SET ASIDE.

STORMWATER POLLUTION PLAN NOTES

- Every effort should be made to eliminate the discharge of non-stormwater from the project site at all times.
- Eroded sediments and other pollutants must be retained on-site and may not be transported from the site via sheet flow, swales, area drains, natural drainage courses or wind.
- Stockpiles of earth and other construction related materials must be protected from being transported from the site by the forces of wind or water.
- Fuels, oils, solvents, and other toxic materials must be stored in accordance with their labeling and are not to contaminate the soil and surface waters. All approved storage containers are to be protected from the weather. Spills must be cleaned up immediately and disposed of in a proper manner. Spills may not be washed into the drainage system.
- Excess or waste concrete may not be washed into the public way or any other drainage system. Provisions shall be made to retain concrete wastes on-site until they can be disposed of as solid waste.
- Trash and construction related solid wastes must be deposited into a covered receptacle to prevent contamination of rainwater and dispersal by wind.
- Sediments and other materials may not be tracked from the site by vehicle traffic. The construction entrance roadways must be stabilized so as to inhibit sediments from being deposited into the public way. Accidental depositions must be swept up immediately and may not be washed down by rain or other means.
- Any slopes with disturbed soils or denuded of vegetation must be stabilized so as to inhibit erosion by wind and water.
- The following BMPs as outlined in, but not limited to, the latest edition of the California BMP Handbook (Construction) or Caltrans Stormwater Quality Handbooks (Construction Site BMP Manual), may apply during the construction of this project (additional measures may be required if deemed appropriate by the Project Engineer or the Building Inspector).

EROSION CONTROL		NON-STORM WATER MANAGEMENT		WASTE MANAGEMENT AND MATERIALS POLLUTION CONTROL	
E01 SCHEDULING	N01 WATER CONSERVATION PRACTICES	WM1 MATERIAL DELIVERY AND STORAGE	SE1 SILT FENCE	TS1 SILT FENCE	TS1 SILT FENCE
E02 PRESERVATION OF EXISTING VEGETATION	N02 DEMATERING OPERATIONS	WM2 MATERIAL USE	SE2 SEDIMENT BASIN	TS2 SEDIMENT BASIN	TS2 SEDIMENT BASIN
E03 HYDRULIC MULCH	N03 PAVING AND GRINDING OPERATIONS	WM3 STOCKPILE MANAGEMENT	SE3 SEDIMENT TRAP	TS3 SEDIMENT TRAP	TS3 SEDIMENT TRAP
E04 HYDROSEEDING	N04 TEMPORARY STREAM CROSSING	WM4 SPILL PREVENTION AND CONTROL	SE4 CHECK DAM	TS4 CHECK DAM	TS4 CHECK DAM
E05 SOIL BINDERS	N05 CLEAR WATER DIVERSION	WM5 SOLID WASTE MANAGEMENT	SE5 FIBER ROLLS	TS5 FIBER ROLLS	TS5 FIBER ROLLS
E06 STRAW MULCH	N06 LIQUID CONNECTION/DISCHARGE	WM6 HAZARDOUS WASTE MANAGEMENT	SE6 GRAVEL BAG BERM	TS6 GRAVEL BAG BERM	TS6 GRAVEL BAG BERM
E07 GEOTEXTILES & MATS	N07 POTABLE WATER IRRIGATION	WM7 CONTAMINATION SOIL MANAGEMENT	SE7 STREET SWEEPING AND VACUUMING	TS7 STREET SWEEPING AND VACUUMING	TS7 STREET SWEEPING AND VACUUMING
E08 WOOD MULCHING	N08 VEHICLE AND EQUIPMENT CLEANING	WM8 CONCRETE WASTE MANAGEMENT	SE8 SAUCIBAG BARRIER	TS8 SAUCIBAG BARRIER	TS8 SAUCIBAG BARRIER
E09 EARTH DRESSES AND DRAINAGE SWALES	N09 VEHICLE AND EQUIPMENT FUELING	WM9 SANITARY/SEPTIC WASTE MANAGEMENT	SE9 STRAW BALE BARRIER	TS9 STRAW BALE BARRIER	TS9 STRAW BALE BARRIER
E10 VELOCITY DISSIPATION DEVICES	N10 VEHICLE AND EQUIPMENT MAINTENANCE	WM10 LIQUID WASTE MANAGEMENT	SE10 STORM DRAIN INLET PROTECTION	TS10 STORM DRAIN INLET PROTECTION	TS10 STORM DRAIN INLET PROTECTION
E11 SLOPE DRAINS	N11 PILE DRIVING OPERATIONS	WIND EROSION CONTROL	SE11 ACTIVE TREATMENT SYSTEMS	TS11 ACTIVE TREATMENT SYSTEMS	TS11 ACTIVE TREATMENT SYSTEMS
E12 STREAMBANK STABILIZATION	N12 CONCRETE CURING	WE1 WIND EROSION CONTROL	SE12 TEMPORARY SILT DWE	TS12 TEMPORARY SILT DWE	TS12 TEMPORARY SILT DWE
E13 RESERVED	N13 CONCRETE FINISHING	EQUIPMENT TRACKING CONTROL	SE13 COMPOST SOCKS & BERMS	TS13 COMPOST SOCKS & BERMS	TS13 COMPOST SOCKS & BERMS
E14 COMPOST BLANKETS	N14 MATERIAL AND EQUIPMENT USE	TC1 STABILIZED CONSTRUCTION ENTRANCE EXIT	SE14 BIOPILTER BAGS	TS14 BIOPILTER BAGS	TS14 BIOPILTER BAGS
E15 SOIL PREPARATION/ROUGHENING	N15 DEMOLITION ADJACENT TO WATER	TC2 STABILIZED CONSTRUCTION ROADWAY			
E16 NON-VEGETATED STABILIZATION	N16 TEMPORARY BATCH PLANTS	TC3 ENTRANCE/EXIT TIRE WASH			

STANDARD PLANS FOR PUBLIC WORKS CONSTRUCTION (SPPWC)
 2003-3 Legend for sanitary sewer plans and profiles and district maps.
 2003-2 Precast concrete shallow manhole.
 2003-1 Reinforced precast concrete manhole.
 2004-1 Rectangular shallow manhole.
 2014-1 Rectangular manhole frame and cover.
 2015-1 Standard manhole step.
COUNTY SANITATION DISTRICT (CSD) NOTES:
 1. NO CONNECTION FOR THE DISPOSAL OF INDUSTRIAL WASTES SHALL BE MADE TO SEWERS SHOWN ON THESE DRAWINGS UNTIL A PERMIT FOR INDUSTRIAL WASTE WATER DISCHARGE HAS BEEN ISSUED BY THE COUNTY SANITATION DISTRICTS FOR SAID CONNECTION.
 2. SEE CSD MANHOLE DETAIL ON THESE DRAWINGS
 3. ALL WORK INVOLVING CSD SEWER OR MANHOLES SHALL BE IN ACCORDANCE WITH THE LATEST EDITION OF THE STANDARD SPECIFICATIONS FOR PUBLIC WORKS CONSTRUCTION, AND CSD'S LATEST AMENDMENTS TO THE STANDARD SPECIFICATIONS FOR PUBLIC WORKS CONSTRUCTION AND STANDARD DRAWINGS FOR CONSTRUCTION. A COPY OF THE AMENDMENTS AND STANDARD DRAWINGS MAY BE OBTAINED FROM THE CSD ENGINEERING CENTER (ROOM 110) AT 1955 WORKMAN MILL ROAD, WHITTIER, CA 90601 OR FROM THE CSD WEBSITE "WWW.LACSD.ORG".

NOTICE TO CONTRACTOR:
 1. ISSUE NO HOUSE LATERAL CONNECTION PERMITS UNTIL OUTLET SEWER CP 12267 IS/ARE ACCEPTED FOR PUBLIC USE BY THE COUNTY OF LOS ANGELES.
 2. THE DEVELOPER SHALL BE RESPONSIBLE FOR THE CONTINUED MAINTENANCE OF PC12267/SANITARY SEWER UNTIL THE COUNTY FORMALLY ACCEPTS IT FOR MAINTENANCE. ALL MAINLINE, MANHOLES AND LATERALS SHALL BE PROTECTED FROM DAMAGE AND INFILTRATION.
 3. MAINTAIN SEWER FLOW AT ALL TIMES DURING CONSTRUCTION.
NOTES:
 Any damage to the sewer line shall be the responsibility of the contractor/owner. All grading and construction occurring over and the vicinity of the existing sewer shall be performed in the presence of a County Inspector. Where applicable, the sewers shall be protected per Std. Plan 202-2 at all significant crossings.

PRIVATE CONTRACT SEWER GENERAL NOTES

- A sewer construction permit shall be obtained and a fee paid for construction inspection and record plans to the County of Los Angeles Department of Public Works at the Permit Counter, 900 South Fremont Avenue, 3rd Floor, Alhambra, at least 72 hours prior to starting work under this permit. Copies of all other required permits, such as road excavation, Caltrans, etc., must be filed with the permit application.
- When work is within a contract city, a sewer construction permit shall be obtained and a fee paid for construction inspection and record plans to the City. The contractor must contact the Director of Public Works of that City to determine the location to pay the inspection fees.
- Prior to issuance of any permit, the contractor shall file a permit for excavations and trenches from the State of California Division of Industrial Safety, and a Certificate of Worker's Compensation Insurance with the Department of Public Works named as the Certificate Holder or both as applicable. The County of Los Angeles Department of Public Works shall be notified 30 days prior to cancellation of the insurance policy.
- If work is done in a State Highway, a permit must be obtained from the State of California Division of Highways, 120 South Spring Street, Los Angeles, California.
- The contractor shall contact the district office listed on the "Application for Construction Permit" to arrange for an acceptable construction start date.
- Approval of this plan by the County of Los Angeles Department of Public Works does not constitute a representation as to accuracy of the location of the existence or nonexistence of any underground utility pipes or structures within the limits of this project. The note applied to all pages.
- All work shall be in accordance with the latest approved edition of the "Standard Specifications for Public Works Construction" including supplements (if there is any), the latest "Additions and Amendments to the Standard Specifications for Public Works Construction," and the latest "Special Provisions for the Construction for Sanitary Sewer" and shall be prosecuted only in the presence of the County of Los Angeles Department of Public Works.
- The contractor's attention is directed to Section 7-10.4.1 of the "Standard Specifications for Public Works Construction" in regard to safety orders and shall conform to the "Minimum Public Safety Requirement" as shown on County of Los Angeles Department of Public Works Standard Plan No. 9008-1.
- Elevations are in feet above U.S.C. and G.S. sea level datum of 1988.
- No revisions shall be made in these plans without the approval of the County of Los Angeles Department of Public Works.
- No representative of the County of Los Angeles Department of Public Works will survey or layout any portion of the work.
- Grades to which this improvement is to be constructed are shown on plans and profiles. Grade point for top of curbs, centerline of streets, or centerline of alleys, is shown by crosses on profiles at all points between said designated points. The grade shall be established so as to conform to a straight line drawn between said design points.
- The private engineer shall furnish the County of Los Angeles Department of Public Works with grade sheets and stationing for all house laterals and "Y" and "T" branches and shall provide stakes for them at their proper locations with stationing plainly marked. All house laterals shall be constructed in a straight line with right angles from the main line sewer except as shown on the plans. House laterals from chimeys shall not have an angle of less than 45 degrees with the M.L. sewer. Any change in alignment shall be requested in writing by the private engineer.
- The private engineer shall furnish the house lateral depth at the property line below the top of curb elevation for each house lateral on the grade sheet.
- An approved backwater valve is required when the pipe is lower in elevation than the top of the next upstream manhole.
- Contact Environmental Programs Division for an Industrial Waste Discharge Permit at (626) 468-3517.

CONSTRUCTION NOTES

- Provide survey stakes on the property line or property lines produced at right angles to the sewer line at the centerline of each manhole.
- Verified clay pipe joints shall be type "D" or "G" per "Standard Specifications for Public Works Construction" Section 208-2.
- If a sewer pipe is within three feet of the sewer, the sewer shall be encased, per LACDPW Standard Plan 2023-2, Case II, two feet on each side from the point of interference.
- All joints between cast-iron pipe and vitrified clay shall be made with a rubber sleeve joint, type "D" (with bushing if necessary), per "Standard Specifications for Public Works Construction" Section 208-2.
- House laterals to be constructed with inverts at the property line 6 feet below curb grade except as noted.
- Wye or tee branches may be used for connections to the mainline sewers except as noted.
- If during the course of construction it is determined that there is less than four feet of cover over the top of a mainline or house lateral V.C.P. sewer, which is not indicated on the plans, the pipes shall be encased per LACDPW Standard Plan 2023-2, Case II, unless otherwise approved by the County of Los Angeles Department of Public Works.
- All structures shall be either brick sewer manholes per LACDPW Standard Plan S-3 (SPPWC 203-2), or precast concrete sewer manholes per LACDPW Standard Plan S-36 (SPPWC 203-3), or reinforced precast manhole per LACDPW Standard Plan 2023-2, Case II, except as noted.
- Reinforce all trenches within paved areas to meet Department of Public Works or California State Highway requirements in accordance with the permits.
- Full compliance with Section 305-1.3 of the "Standard Specifications for Public Works Construction" will be required for backfill in street. Certification of backfill, compaction, and soil equivalent by a qualified Civil Engineer shall be provided by the permittee prior to the issuance of a Certificate of Partial Acceptance.
- All backfill and fills outside of the street right of way shall be compacted to 90 percent of the maximum density as determined by ASTM Soil Compaction Test 1557-76, Method "D" unless otherwise specified. This shall be certified by a qualified Civil Engineer. This certification shall be submitted to the Land Development Division, Permit Section of the County of Los Angeles Department of Public Works prior to the acceptance of the work by the County.
- Manhole tops in unimproved rights of way to be six inches above finished grade.
- Sewers to be tested for leakage per Section 306-1.4 of the "Standard Specification for Public Works Construction" and "Special Provisions for the Construction of Sanitary Sewer" if applicable.
- Manhole tops in improved rights of way to be level with finished grade.
- All wyes and/or house laterals are to be located at least 5 feet apart, and when possible, not closer than 5 feet to any manhole.
- All pipe materials shall be vitrified clay pipe or ductile iron pipe or other approved materials by the County of Los Angeles Department of Public Works.

NOTICE TO CONTRACTOR:
 EXISTING SEWER SYSTEM SHALL BE OPERATIONAL AT ALL TIMES DURING CONSTRUCTION / RECONSTRUCTION. NOTIFY EFFECTED HOMEOWNERS AT LEAST 72 HOURS IN ADVANCE.
 SEWER VIDEO OF ALL SEGMENTS SHALL BE SUBMITTED PRIOR TO PARTIAL FIELD ACCEPTANCE (65%) AND COMPLETE FIELD ACCEPTANCE (80%). FINAL MAP AND AS-BUILT SEWER PLANS SHALL BE SUBMITTED PRIOR TO PARTIAL FIELD ACCEPTANCE.
 SEWER LATERALS SHOWN ON PLANS ARE FOR REFERENCE ONLY.
 CONTRACTOR TO PROTECT AND PRESERVE IN PLACE ALL EXISTING SURVEY MONUMENT. ANY MONUMENTS DISTURBED SHALL BE RESET BY A LICENSED LAND SURVEYOR AND THE APPROPRIATE CORNER RECORD MUST BE FILED WITH THE COUNTY OF LOS ANGELES.

Per Title 20.24.140 of LA County Code, obstructing access to sewer facilities is prohibited. No object difficult to remove shall be located over the sewer easement(s) so as to interfere with ready access to sewer facilities.

SEWERS HEREON, WITH EXCEPTION TO LACSD MANHOLE, TO BE OWNED AND MAINTAINED BY LOS ANGELES COUNTY CONSOLIDATED SEWER MAINTENANCE DISTRICT

PS007670

REGISTERED PROFESSIONAL ENGINEER
 No. 38832
 Exp. 3-31-17
 CIVIL
 STATE OF CALIFORNIA

DOUGLAS R. HOWARD, PLS
 PROJECT MANAGER RCE NO. 38832
 DATE 10/29/2015

NO.	REVISION	REVISED BY	APPROVED BY	DATE

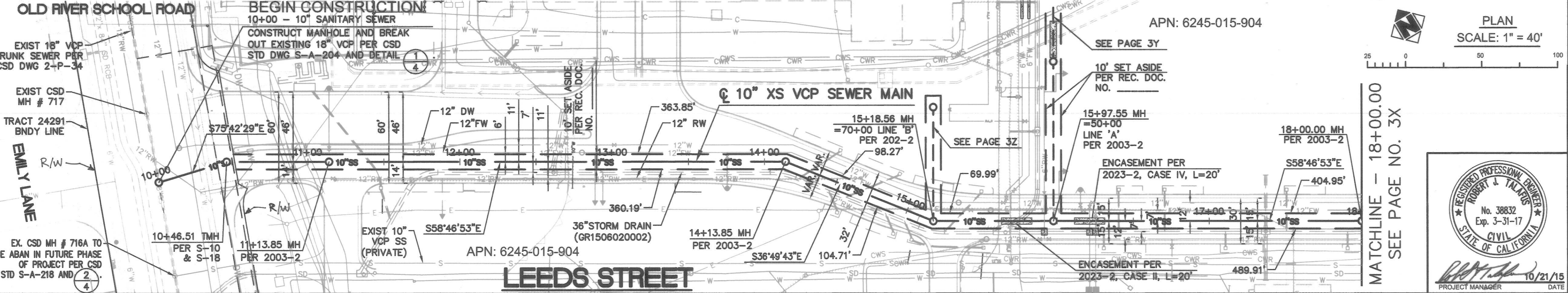
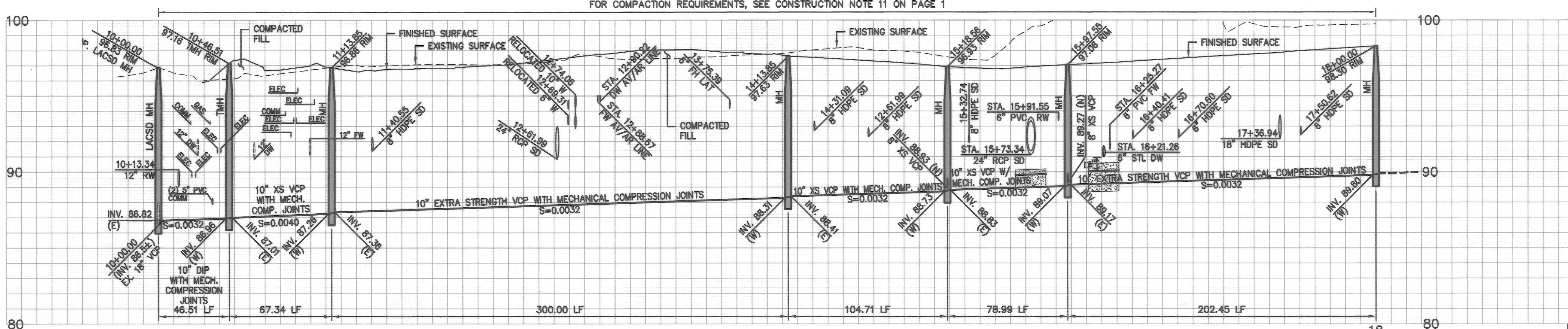

P.C. 12267 PAGE 2

NO LA COUNTY CHARGES FOR CONNECTION SEE COUNTY SANITATION DISTRICT FOR SPECIAL CONNECTION CHARGES
 TEL: (626) 908-4288 Ext. 2727
 SCALE: VERT. 1" = 4'
 HORIZ. 1" = 40'
 DOUBLE SCALE (when applicable)

NO.	REVISION	REVISED BY	APPROVED BY	DATE

SANITARY SEWER PLANS IN
RANCHO LOS AMIGOS NATIONAL REHAB CENTER PC NO. 12267

REVIEWED BY LAND DEVELOPMENT DIVISION
 BY: *[Signature]* 11/03/15
 FINAL MAPS, SEWER, AND LANDSCAPING SUBDIVISION PLAN CHECKING SECTION

COUNTY OF LOS ANGELES DEPARTMENT OF PUBLIC WORKS

TAYLOR PSOMAS
 Design
 Irvine 17850 Fitch Suite 200 Santa Ana, CA 92707 949.574.1325
 3 Hutton Centre Drive Suite 200 Santa Ana, CA 92707 (714) 751-7373 Fax(714) 545-8885

REGISTERED PROFESSIONAL ENGINEER
 No. 38832
 Exp. 3-31-17
 CIVIL
 STATE OF CALIFORNIA

DOUGLAS R. HOWARD
 PROJECT MANAGER DATE 10/21/15

DWG

NO LA COUNTY CHARGES FOR CONNECTION
 SEE CO. SANITATION DISTRICT FOR SPECIAL CONNECTION CHARGES
 TEL: (562) 699-7411 EX. 2727
 SCALE: VERT. 1" = 4'
 HORIZ. 1" = 40'
 DOUBLE SCALE (when applicable)

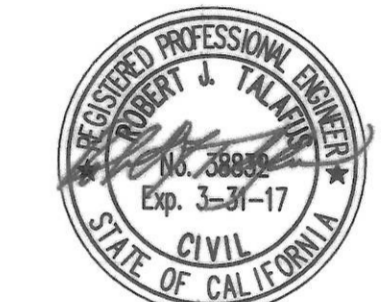
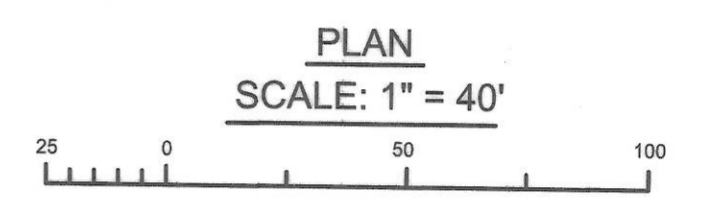
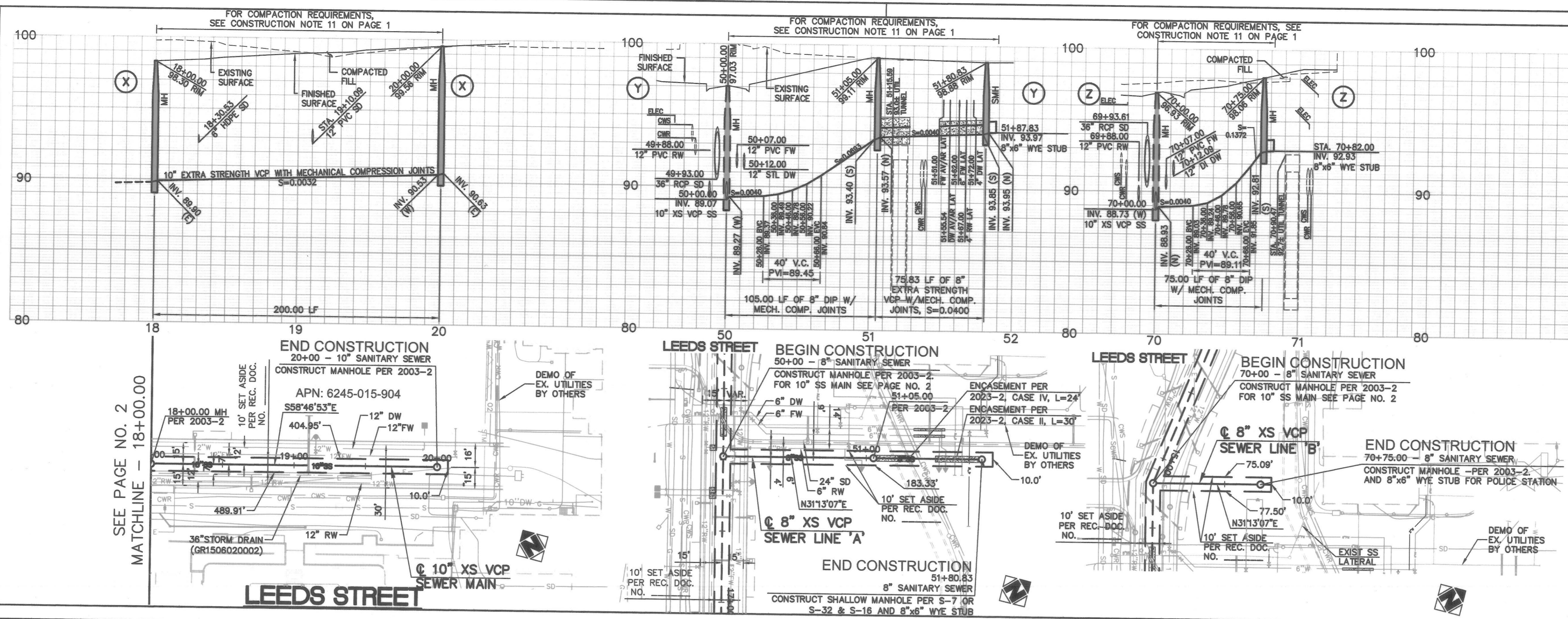

REVIEWED BY LAND DEVELOPMENT DIVISION
 BY: [Signature] DATE: 11/23/15
 FINAL MAPS, SEWER, AND LANDSCAPING SUBDIVISION PLAN CHECKING SECTION

NO LA COUNTY CHARGES FOR CONNECTION
 SEE CO. SANITATION DISTRICT FOR SPECIAL CONNECTION CHARGES
 TEL: (562) 699-7411 EX. 2727
 SCALE: HORIZ. 1" = 40'

- NOTES FOR PROPOSED CSD MANHOLE:**
1. THE CONTRACTOR SHALL PARTIALLY FORM THE BASE OF THE MANHOLE AROUND THE EXISTING PIPE. WHEN ALLOWED BY THE COUNTY SANITATION DISTRICTS (CSD) INSPECTOR, THE CONTRACTOR SHALL BREAK OUT THE ENTIRE EXISTING PIPE, INSERT A FLEXIBLE FLOW-THRU PLUG IN THE MANHOLE TO CONTAIN THE FLOW, AND COMPLETE CHANNELIZATION OF THE MANHOLE BASE IN THE DRY. THE CONTRACTOR IS ADVISED THIS WORK MAY HAVE TO BE PERFORMED DURING OVERNIGHT HOURS WHEN FLOWS ARE LOWER. AS OF MARCH 2011 THE PEAK FLOW IN THE 18" TRUNK SEWER WAS 2.5 CFS.
 2. VERIFY EXISTING INVERTS PRIOR TO CONSTRUCTION.
 3. CONSTRUCT MANHOLE PER CSD STANDARD DRAWING S-a-204.
 4. SUBMIT SHOP DRAWING, STACKING PLAN, ETC. TO THE CSD SEWER DESIGN SECTION FOR APPROVAL PRIOR TO CONSTRUCTION.
 5. NOTIFY THE CSD FIELD ENGINEERING MANAGER, MR. ANTHONY ULIZIO, AT (310) 830-8050 AT LEAST FIVE (5) WORKING DAYS PRIOR TO THE START OF MANHOLE CONSTRUCTION TO ARRANGE FOR INSPECTION.

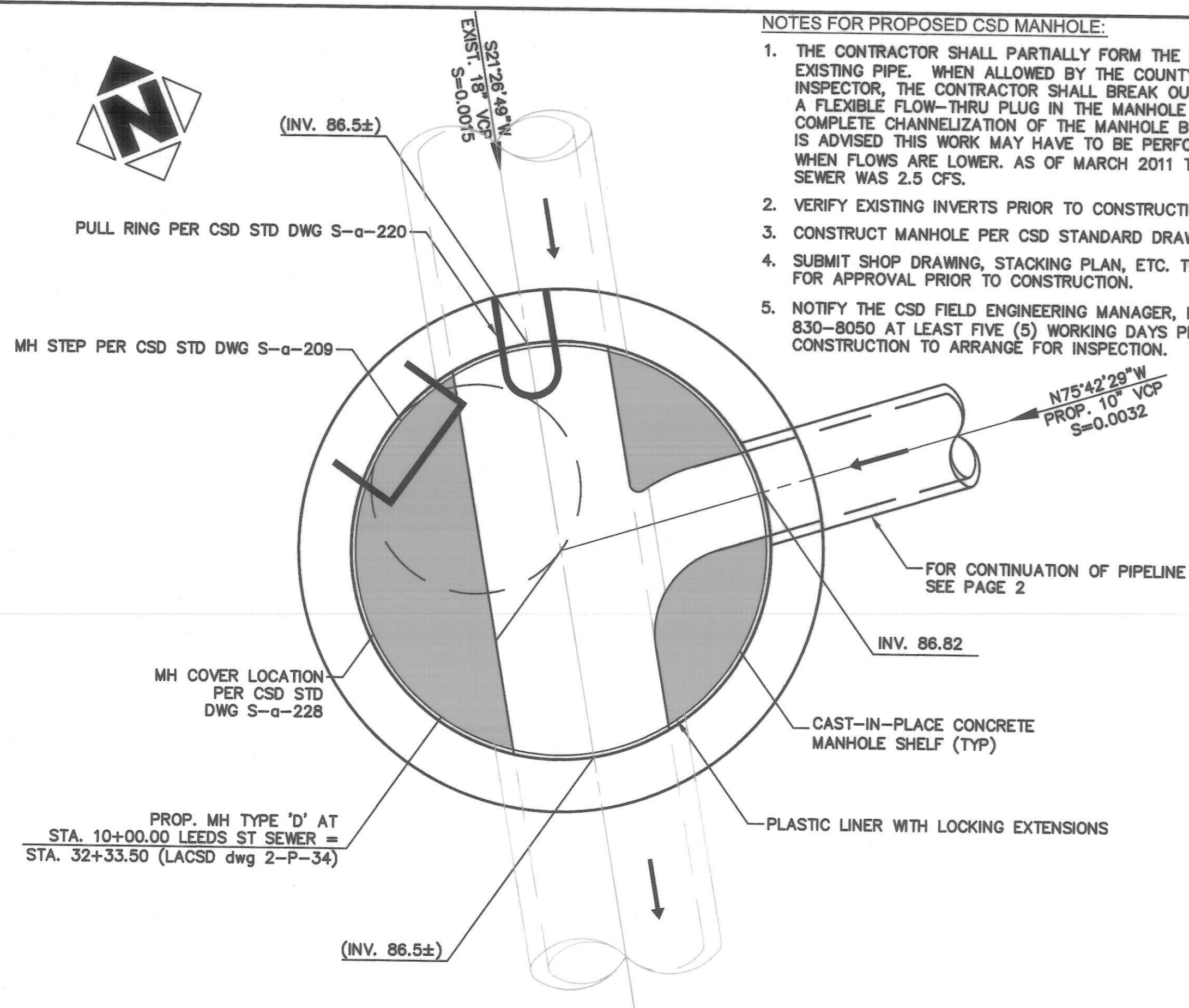

CONNECTION TO PROPOSED CSD MANHOLE DETAIL 1
 SCALE: 1"=1'-0"

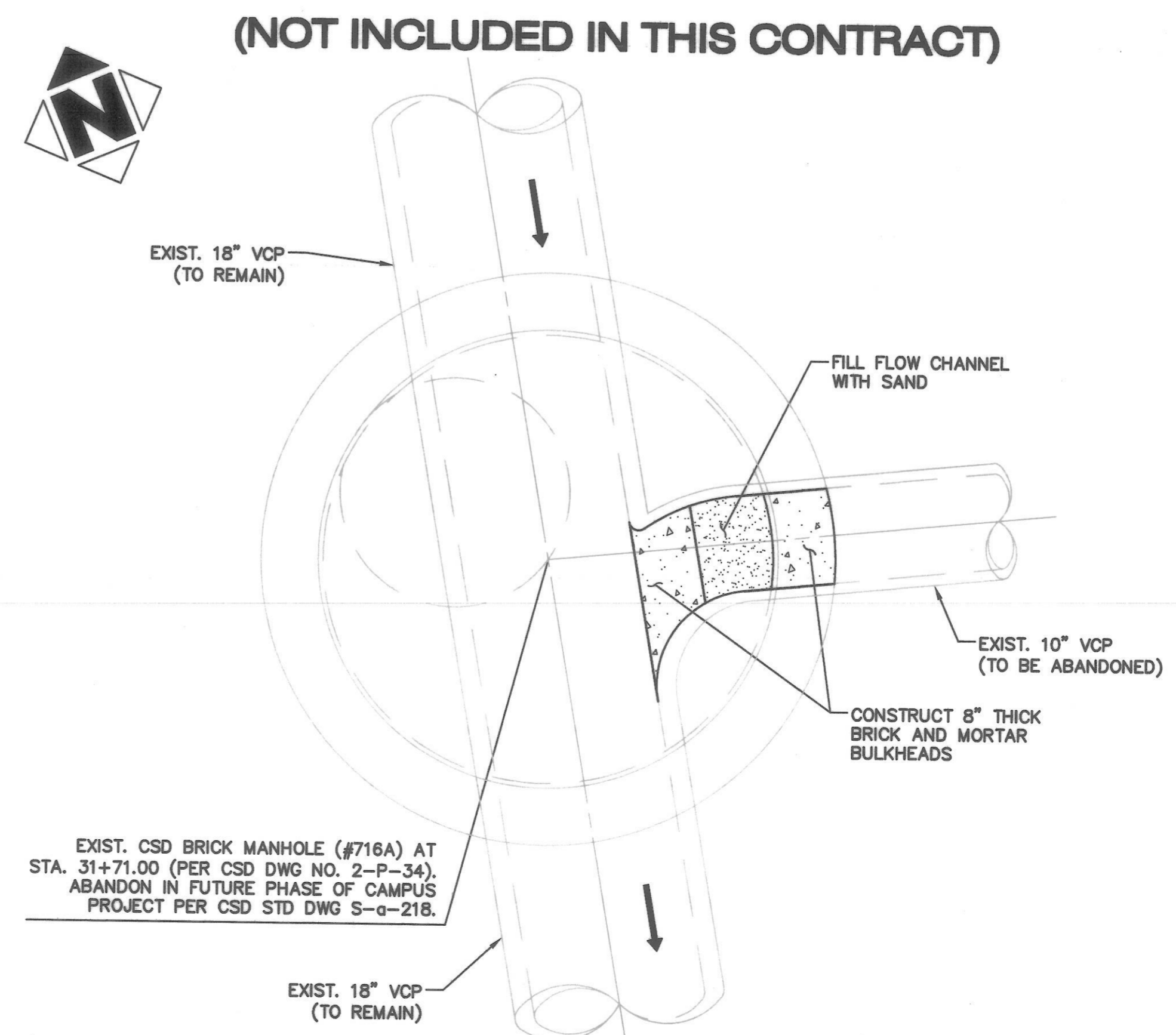

FUTURE ABANDONMENT OF CSD MANHOLE DETAIL 2
 SCALE: 1"=1'-0"



REVIEWED BY LAND DEVELOPMENT DIVISION
 BY: [Signature] DATE: 11/23/15
 FINAL MAPS, SEWER, AND LANDSCAPING SUBDIVISION PLAN CHECKING SECTION