

SANITARY SEWER

TO BE CONSTRUCTED IN VALLEY BLVD 800' SW'LY OF FAURE AVE PC 12562

2 SHEETS: 2 PAGES

CSMD INDEX E-2389 EIMP 202100039

Table with 4 columns: QUAD YEAR, ELEV FOOT/METER, DESCRIPTION, BM NUMBER. Contains data for COVINA QUAD BENCH MARKS.

- A. NOTES: 1. EVERY EFFORT SHALL BE MADE TO ELIMINATE THE DISCHARGE OF NON-STORMWATER FROM THE PROJECT SITE AT ALL TIMES. 2. ERODED SEDIMENTS AND OTHER POLLUTANTS MUST BE RETAINED ON-SITE...

- EROSION CONTROL: EC1 SCHEDULING, EC2 PRESERVATION OF EXISTING VEGETATION, EC3 HYDRAULIC MULCH, EC4 HYDROSEEDING, EC5 SOIL BINDERS, EC6 STRAW MULCH, EC7 GEOTEXTILES & MATS, EC8 WOOD MULCHING, EC9 EARTH DIKES AND DRAINAGE SWALES, EC10 VELOCITY DISSIPATION DEVICES, EC11 SLOPE DRAINS, EC12 STREAMBANK STABILIZATION, EC13 RESERVED, EC14 COMPOST BLANKETS, EC15 SOIL PREPARATION/ROUGHENING, EC16 NON-VEGETATED STABILIZATION.

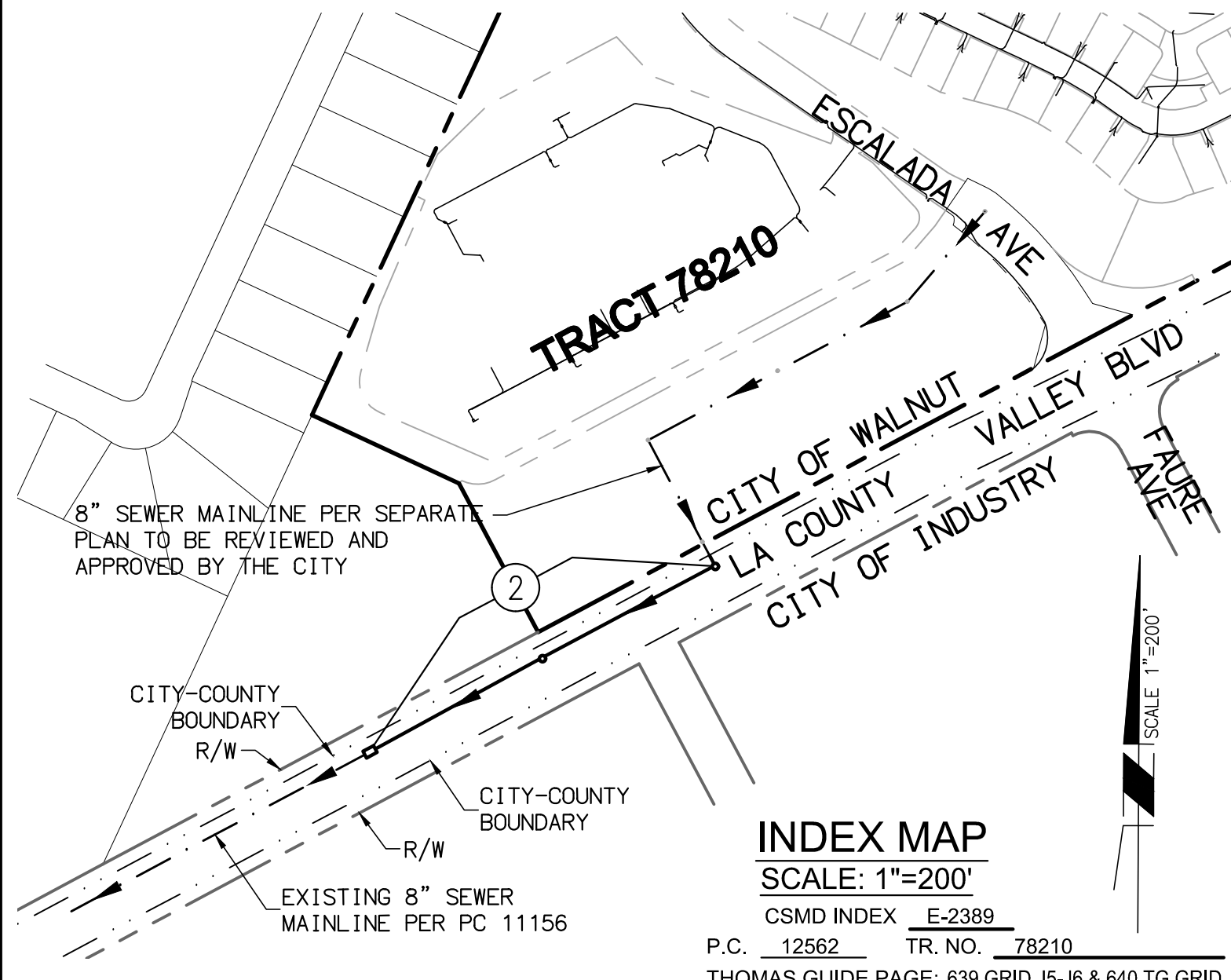

Table with 6 columns: NO., REVISION, REVISED BY, SMD APPROVAL, DATE, CITY APPROVAL, DATE. Includes a revision history table.

B. STANDARD PLANS: THE FOLLOWING LATEST REVISED STANDARD PLANS ON FILE IN THE OFFICE OF THE FOLLOWING DEPARTMENT SHALL APPLY IN THE CONSTRUCTION OF THIS PROJECT.

- LOS ANGELES COUNTY DEPARTMENT OF PUBLIC WORKS (LACPDW) 2000-0 LEGEND FOR SANITARY SEWER PLANS AND PROFILES AND DISTRICT MAPS. 2002-1 PRECAST CONCRETE SHALLOW MANHOLE. 2003-2 REINFORCED PRECAST CONCRETE MANHOLE. 2004-1 RECTANGULAR SHALLOW MANHOLE. 2014-1 RECTANGULAR MANHOLE FRAME AND COVER. 2015-1 STANDARD MANHOLE STEP.

STORMWATER POLLUTION PLAN NOTES

- NON-STORM WATER MANAGEMENT: NS1 WATER CONSERVATION PRACTICES, NS2 DEWATERING OPERATIONS, NS3 PAVING AND GRINDING OPERATIONS, NS4 TEMPORARY STREAM CROSSING, NS5 CLEAR WATER DIVERSION, NS6 ILLICIT CONNECTION/DISCHARGE, NS7 POTABLE WATER/IRRIGATION, NS8 VEHICLE AND EQUIPMENT CLEANING, NS9 VEHICLE AND EQUIPMENT FUELING, NS10 VEHICLE AND EQUIPMENT MAINTENANCE, NS11 PILE DRIVING OPERATIONS, NS12 CONCRETE CURING, NS13 CONCRETE FINISHING, NS14 MATERIAL AND EQUIPMENT USE, NS15 DEMOLITION ADJACENT TO WATER, NS16 TEMPORARY BATCH PLANTS.

THIS DRAWING IS ATTACHED TO AND MADE PART OF PERMIT # PWRP2022006374. ANY DEVIATION FROM THE ATTACHED DRAWING WITHOUT WRITTEN AUTHORIZATION FROM THIS DEPARTMENT WILL VOID THIS PERMIT.

PERMIT WRITER: BH DATE: 10/13/2022

ANY DAMAGE TO THE SEWER LINE SHALL BE THE RESPONSIBILITY OF THE CONTRACTOR/OWNER. ALL GRADING AND CONSTRUCTION OCCURRING OVER AND THE VICINITY OF THE EXISTING SEWER SHALL BE PERFORMED IN THE PRESENCE OF A COUNTY INSPECTOR...

LOS ANGELES COUNTY SANITATION DISTRICTS (LACSD) NOTES:

- 1. NO CONNECTION FOR THE DISPOSAL OF INDUSTRIAL WASTES SHALL BE MADE TO SEWERS SHOWN ON THESE PLANS UNTIL A PERMIT FOR INDUSTRIAL WASTE WATER DISCHARGE HAS BEEN ISSUED BY LACSD FOR SAID CONNECTION. 2. LACSD WILL NOT OWN/OPERATE ANY FACILITIES SHOWN ON THE PLANS UNLESS ALREADY OWNED BY LACSD OR UNLESS OTHERWISE SPECIFIED OR NOTED ON THESE PLANS.

ENGINEER'S/SURVEYOR'S STATEMENT REGARDING THE PRESENCE OF MONUMENTS WITHIN PROJECT LIMITS

I HEREBY ATTEST THAT I HAVE LOCATED AND REFERENCED ON THESE PLANS THE MONUMENTS EXISTING PRIOR TO CONSTRUCTION TO ENSURE PERPETUATION OF THEIR LOCATION IN ACCORDANCE WITH SECTION 8771 OF THE BUSINESS AND PROFESSIONS CODE...

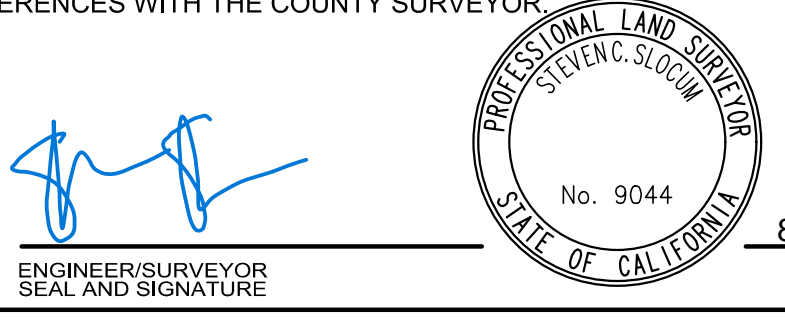

- LEGEND: - - - - - O - - - - - EXISTING & FUTURE SANITARY SEWER PER SEPARATE PLAN (PC). - - - - - O - - - - - PROPOSED SANITARY SEWER. - - - - - O - - - - - EXISTING RECYCLED WATER. - - - - - O - - - - - EXISTING DOMESTIC WATER. - - - - - O - - - - - EXISTING ELECTRIC. - - - - - O - - - - - EXISTING TELECOMM. - - - - - O - - - - - EXISTING STORM DRAIN. - - - - - O - - - - - EXISTING STREET CURB & GUTTER. - - - - - O - - - - - EXISTING ABANDONED WATER PIPE. - - - - - O - - - - - STREET CURB. - - - - - O - - - - - STREET CENTERLINE. - - - - - O - - - - - STREET RIGHT OF WAY & TRACT PL. - - - - - O - - - - - CITY-COUNTY BOUNDARY.

THE DEVELOPER SHALL BE RESPONSIBLE FOR THE CONTINUED MAINTENANCE OF PC 12562 SANITARY SEWER UNTIL THE COUNTY FORMALLY ACCEPTS IT FOR MAINTENANCE. ALL MAINLINE, MANHOLES AND LATERALS SHALL BE PROTECTED FROM DAMAGE AND INFILTRATION.

EXISTING SEWER SYSTEM SHALL BE OPERATIONAL AT ALL TIMES DURING CONSTRUCTION/RECONSTRUCTION. NOTIFY AFFECTED HOMEOWNERS AT LEAST 72 HRS IN ADVANCE.

ALL SANITARY SEWER MANHOLE SHAFTS AND FRAMES SHALL BE WATERTIGHT WITH BUTYL RUBBER MASTIC JOINT SEALING COMPOUND OR APPROVED EQUAL BY THE LA COUNTY PUBLIC WORKS.

SEWER VIDEO OF ALL SEGMENTS SHALL BE SUBMITTED PRIOR TO PARTIAL FIELD ACCEPTANCE (95%) AND COMPLETED FIELD ACCEPTANCE (98%). FINAL MAP AND AS-BUILT SEWER PLANS SHALL BE SUBMITTED PRIOR TO PARTIAL FIELD ACCEPTANCE.

SEWER LATERALS SHOWN ON PLANS ARE FOR REFERENCE ONLY.

Approval form for Mark Pestrella, LA County Director of Public Works, dated 10/11/2022. Includes signature and date.

Approval form for Robert C. Ferrante, County Sanitation District No. 21, dated 10/12/2022. Includes signature and date.

PRIVATE ENGINEERS NOTICE TO CONTRACTORS: THE EXISTENCE AND LOCATION OF ANY UNDERGROUND UTILITY PIPES OR STRUCTURES SHOWN ON THESE PLANS IS REQUIRED BY A SEARCH OF AVAILABLE RECORDS TO THE BEST OF OUR KNOWLEDGE...

Approval form for Rick L. Howe, Project Engineer, dated 8/25/22. Includes signature and date.

Table of ABBREVIATIONS: ADJ ADJUST, BC BEGIN CURVE, BWV BACKWATER VALVE, C&G CURB AND GUTTER, CL CENTER LINE, C/C CENTER LINE, CO CLEANOUT, COMM COMMUNICATION, DW DOMESTIC WATER, EC END CURVE, ELEV ELEVATION, ESMT EASEMENT, EX EXISTING, INV INVERT, H.L. HOUSE LATERAL, LACDPW LOS ANGELES COUNTY DEPARTMENT OF PUBLIC WORKS, LGT LIGHT, LT LEFT, MH MANHOLE, ML MAIN LINE, PCC POINT OF COMPOUND CURVATURE, PE PAD ELEVATION, PL PROPERTY LINE, PROP PROPOSED, RW RECLAIMED WATER, R/W RIGHT OF WAY, SD STORM DRAIN, SPPWC STANDARD PLANS FOR PUBLIC WORKS CONSTRUCTION, STD STANDARD, SS SANITARY SEWER, ST STREET, TYP TYPICAL, TELE TELEPHONE, UT UTILITY, VCP VITRIFIED CLAY PIPE.

PRIVATE CONTRACT SEWER GENERAL NOTES:

- THE FOLLOWING GENERAL NOTES ARE TO BE INCLUDED ON PAGE 1 OF ALL PRIVATE CONTRACT SEWER PLANS: 1. A SEWER CONSTRUCTION PERMIT SHALL BE OBTAINED AND A FEE PAID FOR CONSTRUCTION INSPECTION AND RECORD PLANS TO THE LA COUNTY PUBLIC WORKS AT HTTPS://EPICLA.LACOUNTY.GOV AT LEAST 4 WEEKS PRIOR TO YOUR DERIVED START-UP DATE...

CONSTRUCTION NOTES:

- 1. PROVIDE SURVEY STAKES ON THE PROPERTY LINE OR PROPERTY LINES PRODUCED AT RIGHT ANGLES TO THE SEWER LINE AT THE CENTERLINE OF EACH MANHOLE. 2. VITRIFIED CLAY PIPE JOINTS SHALL BE TYPE "D" OR "G" PER "STANDARD SPECIFICATIONS FOR PUBLIC WORKS CONSTRUCTION" SECTION 208-2. 3. IF A POWER POLE IS WITHIN THREE FEET OF THE SEWER, THE SEWER SHALL BE ENCASED, PER LACDPW STANDARD PLAN 2023-2, CASE II, TWO FEET ON EACH SIDE FROM THE POINT OF INTERFERENCE...

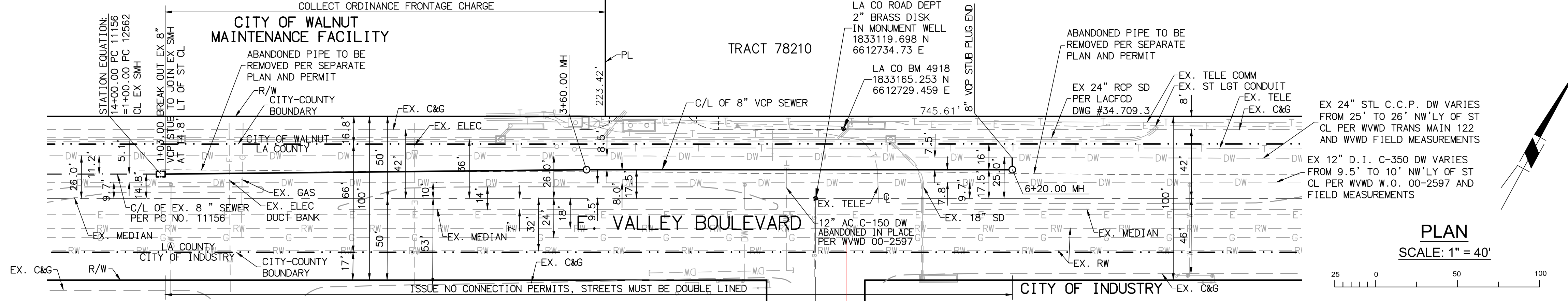
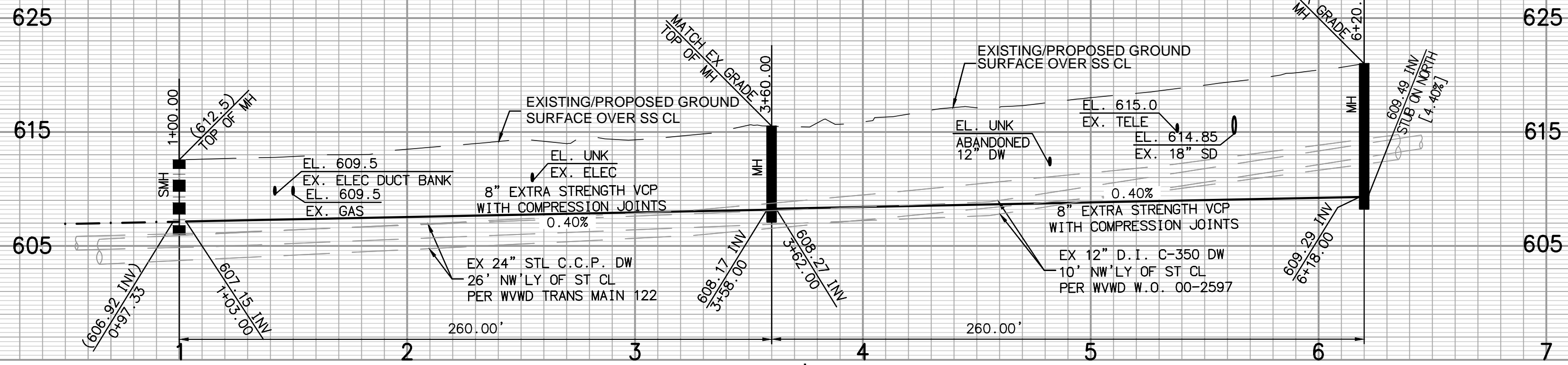

Table with 5 columns: NO., REVISION, REVISED BY, APPROVED BY, DATE. Includes a revision history table.

SANITARY SEWER PLANS IN COUNTY UNINCORPORATED AREA TRACT NO. 78210 PC NO. 12562

REVIEWED /LAND DEVELOPMENT DIVISION DATE: 9/13/22

Michael Baker INTERNATIONAL logo and contact information: 5 Hutton Centre Dr, Suite 500 Santa Ana, CA 92707 Phone: (949) 472-3505 MBAKERINTL.COM



NO.	REVISION	REVISED BY	APPROVED BY	DATE



COLLECT CHARGES AS INDICATED

SEE LOS ANGELES COUNTY SANITATION DISTRICTS FOR SPECIAL CONNECTION CHARGES

TEL. (562) 908-4288 EX. 2727

SCALE: VERT. 1" = 8'
HORIZ. 1" = 40'

DOUBLE SCALE

EIMP 2021000039

REVIEWED BY LAND DEVELOPMENT DIVISION

BY: *[Signature]*
SEWER PLAN CHECKING UNIT
DATE: 9/13/22

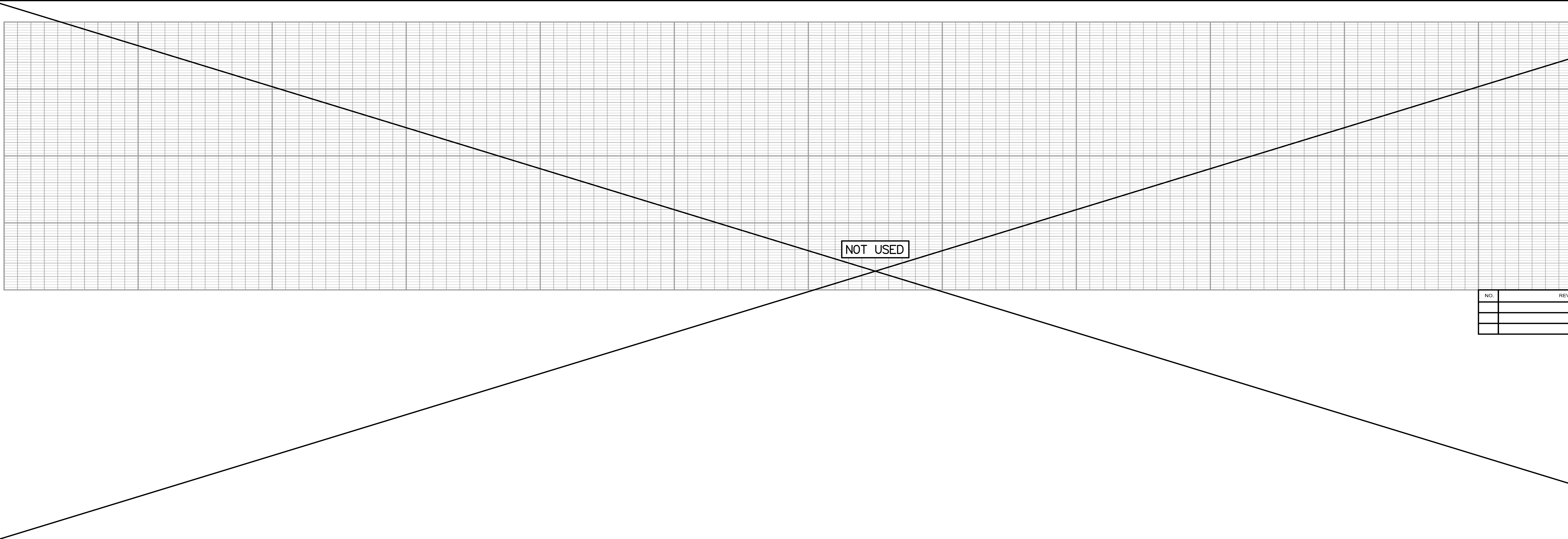

NO.	REVISION	REVISED BY	APPROVED BY	DATE

COLLECT CHARGES AS INDICATED

SEE LOS ANGELES COUNTY SANITATION DISTRICTS FOR SPECIAL CONNECTION CHARGES

TEL. (562) 908-4288 EX. 2727

SCALE: VERT. 1" = 8'
HORIZ. 1" = 40'

DOUBLE SCALE

EIMP

REVIEWED BY LAND DEVELOPMENT DIVISION

BY: *[Signature]*
SEWER PLAN CHECKING UNIT
DATE:

PLAN
SCALE: 1" = 40'

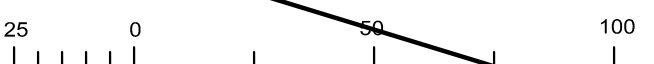

TR 78210 PC 12562 SHEET 2