

The elevation of the mean high tide of the Pacific Ocean is 193 feet above mean sea level per U.S.G.S. Bench Marks.

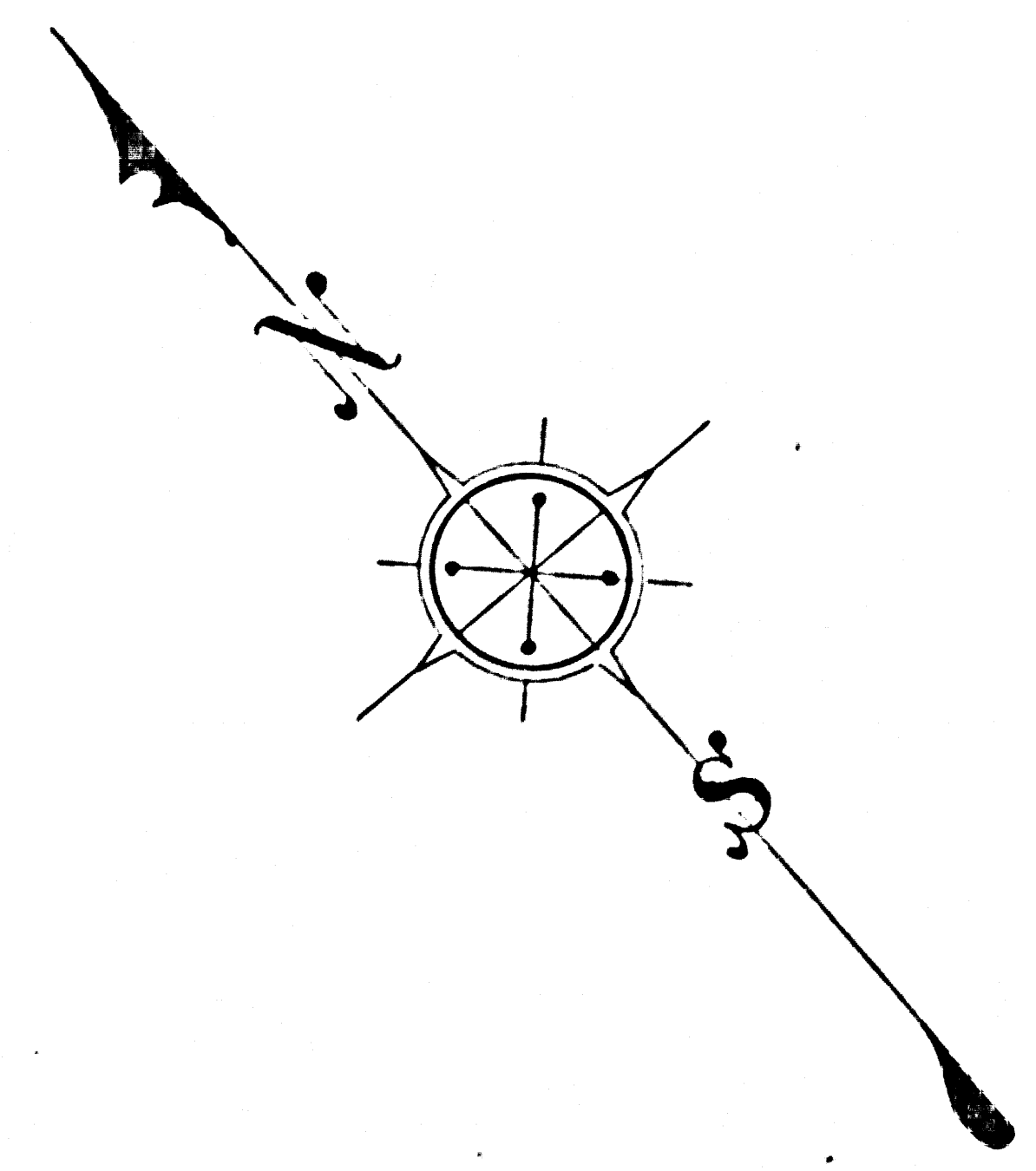

TOPOGRAPHIC MAP OF  
**SANTA MONICA CANYON PARK**  
 AT THE  
**MOUTH OF SANTA MONICA CANYON**

COUNTY SURVEYORS MAP N° B-443  
 SHEET 2 OF 2 SHEETS  
 SCALE: 1-INCH = 50 FEET  
 J. E. ROCKHOLD COUNTY SURVEYOR  
 SURVEYED IN AUGUST 1930

WORK ORDER N° 950

SURVEYED UNDER INSTRUCTIONS OF THE BOARD OF SUPERVISORS PER ORDER DATED JUNE 17 1929 BEARINGS ARE BASED ON THE BEARING OF THE EASTERLY BOUNDARY LINE OF THE CITY OF LOS ANGELES (WESTGATE ADDITION AS SHOWN ON C. S. B-409

PLANE TABLE SURVEY

FIELD WORK BY.....T. WALSH  
 OFFICE WORK BY.....P.W. ATKINS  
 CHECKED BY.....W.J. LUCAS

FOR SURVEY OF PROPERTY LINES SEE C.S.B. 427

BOUNDARIES OF PARK SHOWN WITHIN BLUE BORDER LINE.

DATUM  
 BENCH MARK ELEVATIONS SHOWN HEREON ARE ESTABLISHED FROM U.S.C. & G.S. B.M. N° 50 PER L.B. 486-99

CSB-443-2  
 A1 of A2

EAN

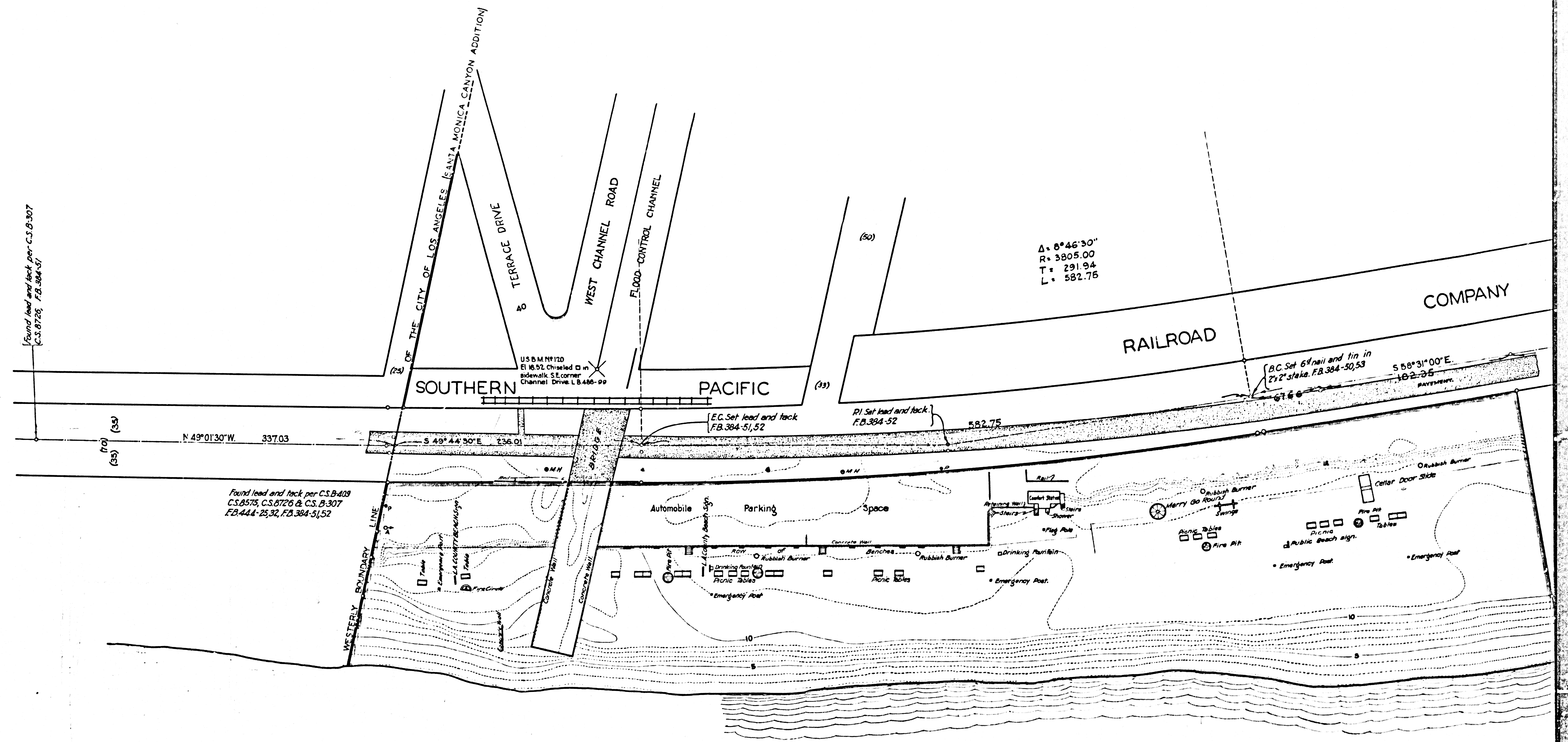

PACIFIC OCEAN

CSB-443-2  
A2 of A2

32

77