

ST.
ST.
ST.
2ND ST.

Found nail and back in
placement per L.B. 604-251
F.B. 275-251

Found nail and back in
placement per L.B. 604-251
F.B. 275-251

Found nail and back in
placement per L.B. 604-251
F.B. 275-251

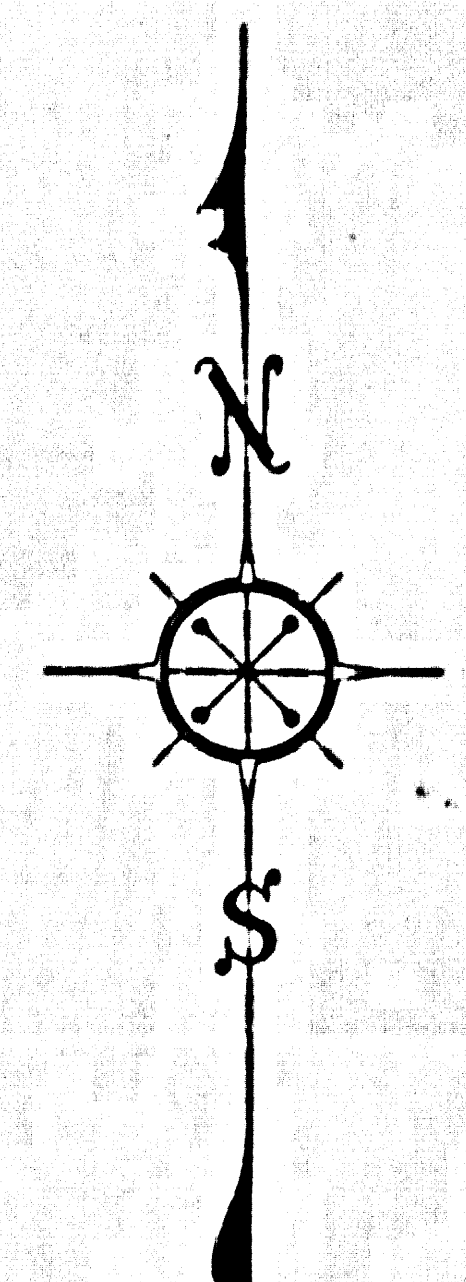

MAP OF
TORRANCE HEALTH CENTER SITE
 IN
 BLOCK 50, TORRANCE TRACT, M.B. 22-94-95
 AT
 CARSON STREET & PLAZA DEL AMO
 COUNTY SURVEYORS MAP N° B-602
 SHEET N° 1 OF 2 SHEETS
 SCALE - 1 INCH = 100 FT.
 1 INCH = 40 FT.

WORK ORDER N° 692
 J.E. ROCKHOLD - COUNTY SURVEYOR
 SURVEYED... OCTOBER... 1930
 BEARINGS ARE BASED ON THE NORTHERLY LINE
 OF BLOCK 50, TORRANCE TRACT, M.B. 22-94-95
 F. B. 275 - 247 - 254.
 FIELD WORK BY... H. F. GRABER
 OFFICE WORK BY... FRED HOLADAY
 CHECKED BY... H. U. M. HIGGINS
 Sht. 25

SCALE - 1 INCH = 40 FT.

NOTE
 Area shown within blue colored border
 indicates title of Torrance Health Center
 Portion of above shown colored lavender, deeded
 to City of Torrance for Public Park.

CSB-602-1
 A1 OF A2

CONTRACT NO. 1001
 MAP N° B-602
 SHEET N° 1 OF 2

TORRANCE TRACT M.B. 22-94-95

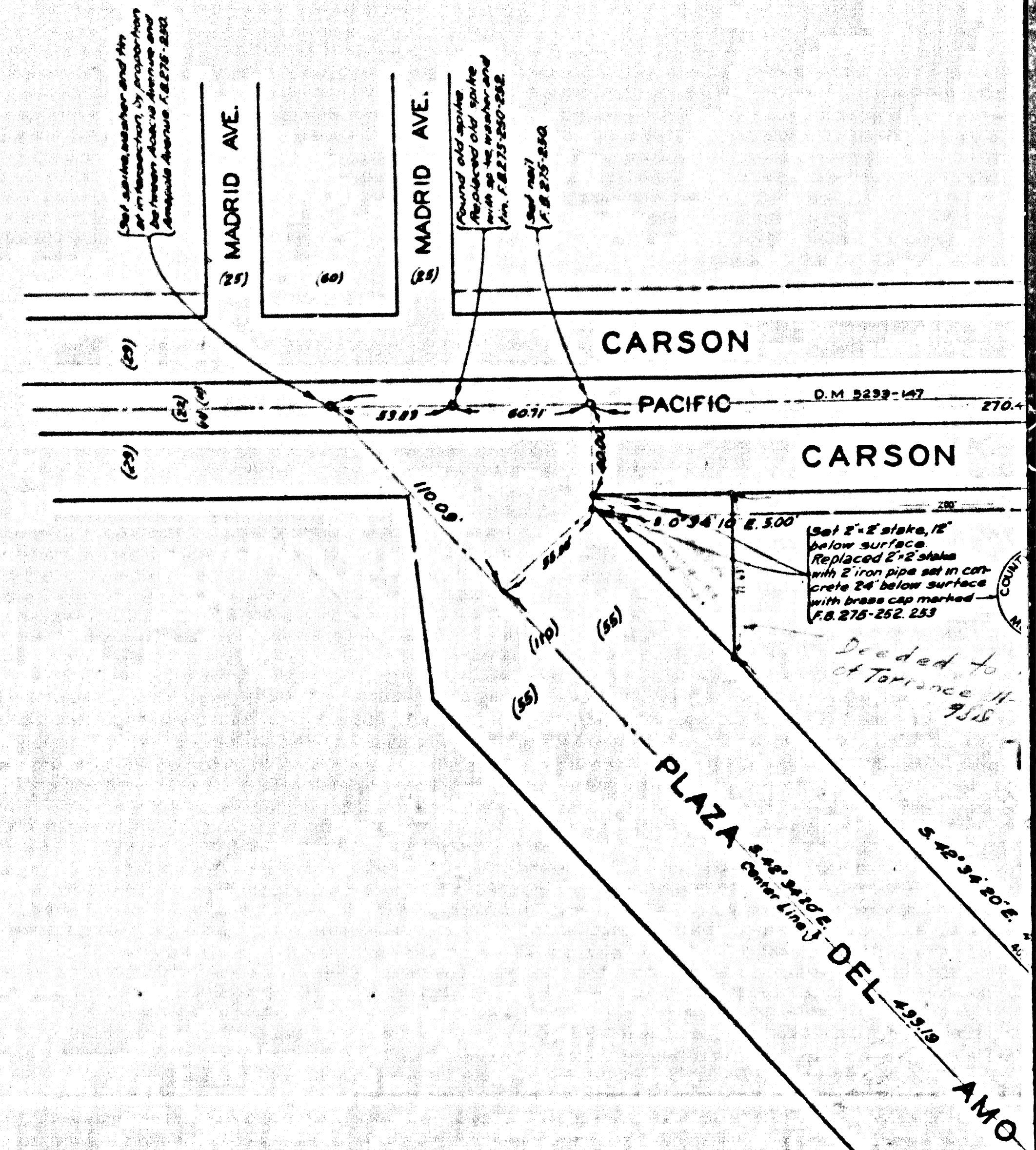
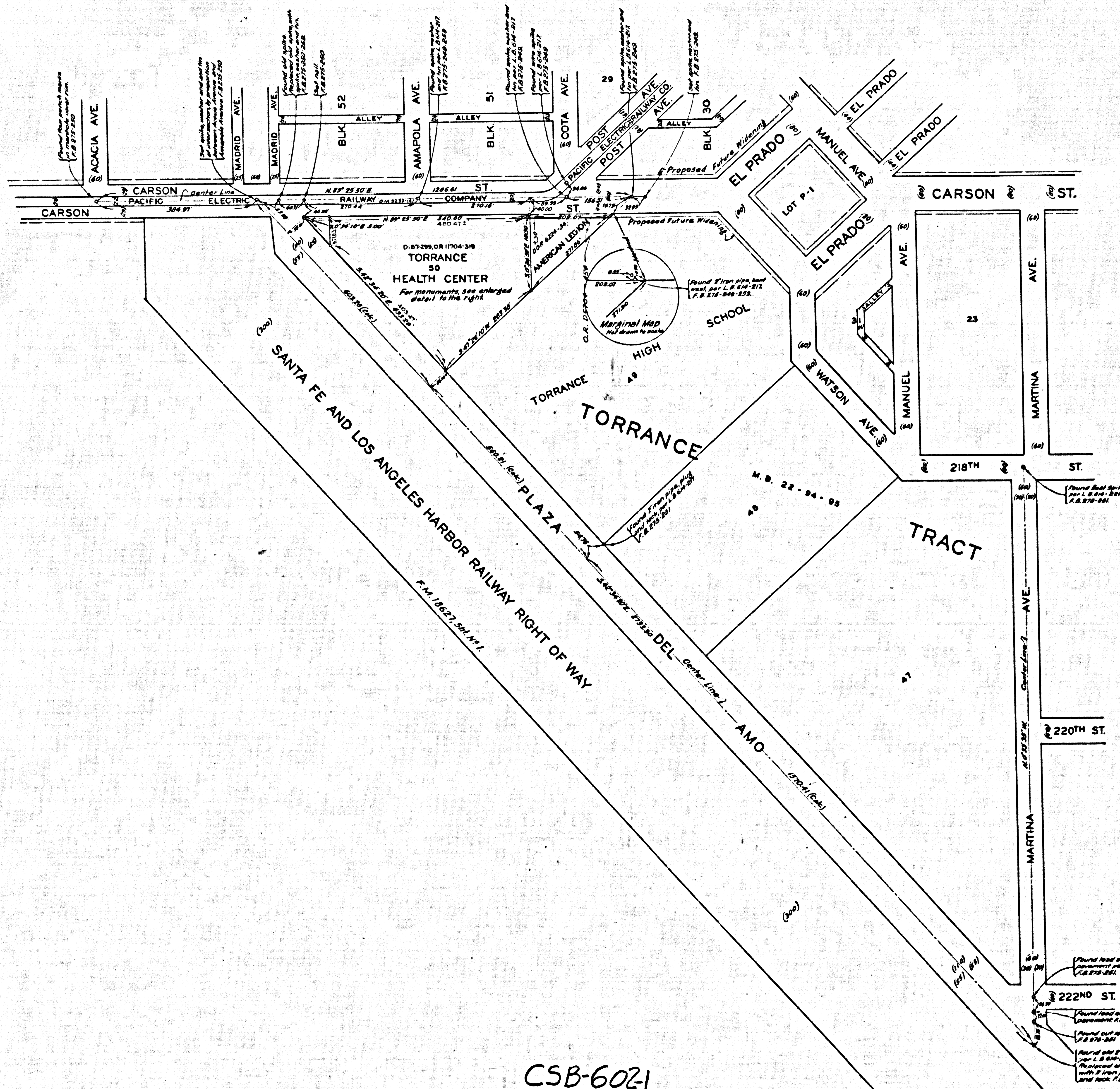

SHEET No. 1 OF 5 SHEETS

CSB-6021
AL OFAZ