

MARGINAL MAP
SHOWING
TYPE OF BOTTOM MATERIAL
SCALE - 1 INCH = 400 FEET

MAP OF
PROPOSED
REDONDO BEACH YACHT HARBOR
AT
CITY OF REDONDO BEACH
LOS ANGELES COUNTY, CALIFORNIA

COUNTY SURVEYORS MAP NO B-1083
SHEET NO 6 OF 7 SHEETS
SCALE - 1 INCH = 100 FT

JOB NUMBER - 8102

ALFRED JONES - COUNTY SURVEYOR
SURVEYED JULY - OCT. 1933.

SURVEYED UNDER INSTRUCTIONS OF THE
BOARD OF SUPERVISORS PER ORDER DATED
JULY 2ND 1933

BEARINGS ARE BASED ON THE BEARING OF
SOUTHERLY LINE-CITY OF TORRANCE PER C.S. B-434

F.B. 589 - CONTROL.
F.B. 595, 596, 597 - SOUNDINGS.
SHORE TOPOGRAPHY - PLANE TABLE

S.E. BUTLER
FIELD WORK BY... T.H. MONCURE
R.T. DONLAP
OFFICE WORK R.W. MALLISTER
W.J. LUCAS
CHECKED BY... A.A. ROESER.

NOTE -
DATUM IS MEAN LOWER LOW WATER.
CONTOURS ARE BELOW DATUM PLANE
UNLESS MARKED WITH PLUS SIGN.

INDEX 25

CSB-1083-6
A1 OF A2

FOR BLUE PRINTING
WIDTH OF MAP - 36 INCHES
AREA / FOOT LENGTH - 3 ... 8"
TOTAL AREA OF MAP - 24 ... 8"

CSB-1083-6
A1 OF A2
LOS ANGELES COUNTY SURVEYORS MAP NO B-1083
SHEET NO 6 OF 7 SHEETS

LOS ANGELES COUNTY SURVEYORS MAP NO B-1083
SHEET NO 6 OF 7 SHEETS

COMPL. & REVISED BY 8-19-35

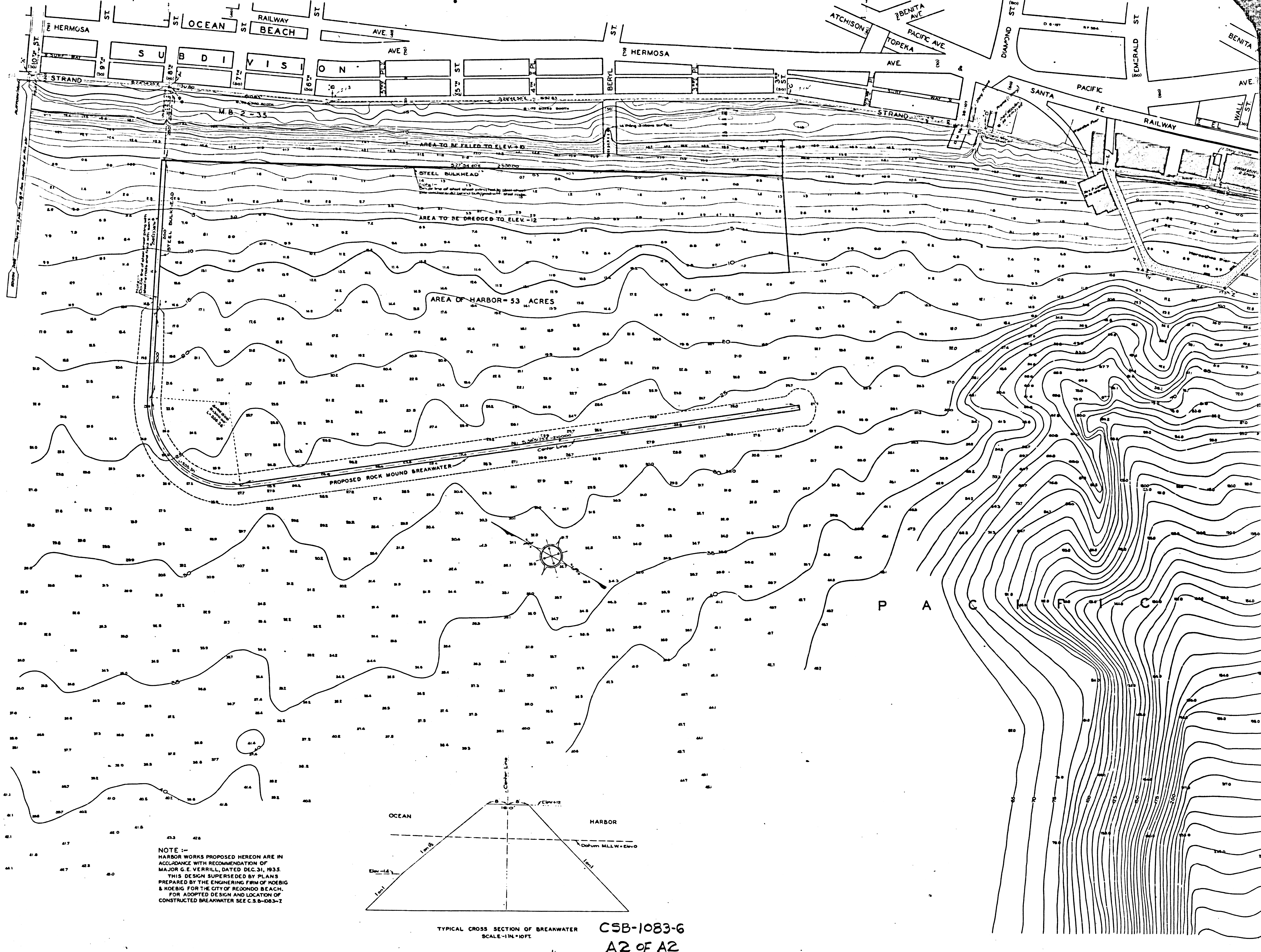

NOTE :-
 HARBOR WORKS PROPOSED HEREON ARE IN ACCORDANCE WITH RECOMMENDATION OF MAJOR G. E. VERRILL, DATED DEC. 31, 1935. THIS DESIGN SUPERSEDED BY PLANS PREPARED BY THE ENGINEERING FIRM OF KOEBIG & KOEBIG FOR THE CITY OF REDONDO BEACH, FOR ADOPTED DESIGN AND LOCATION OF CONSTRUCTED BREAKWATER SEE C.S. 8-1083-2

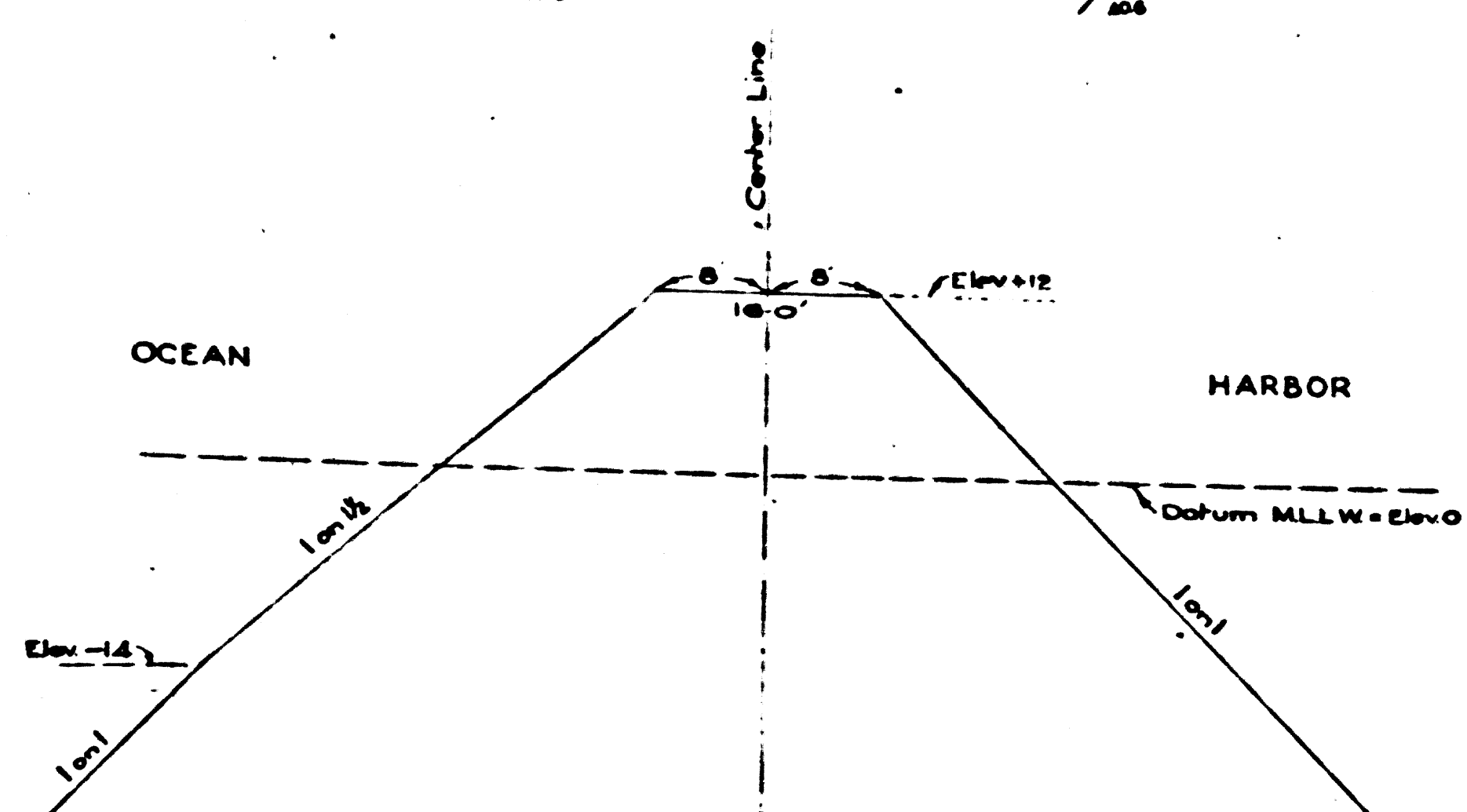

TYPICAL CROSS SECTION OF BREAKWATER
 SCALE - 1" = 10 FT.

CSB-1083-6
 A2 OF A2

11 SHEETS OF 11 SHEETS