

MARGINAL MAP  
SHOWING  
TYPE OF BOTTOM MATERIAL  
SCALE: 1 INCH = 400 FEET

MAP OF  
PROPOSED  
REDONDO BEACH YACHT HARBOR  
AT  
CITY OF REDONDO BEACH  
LOS ANGELES COUNTY, CALIFORNIA  
COUNTY SURVEYORS MAP NO B-1083  
SHEET NO 7 OF 7 SHEETS  
SCALE: 1 INCH = 100 FT

JOB NUMBER - 8102  
ALFRED JONES - COUNTY SURVEYOR  
SURVEYED JULY - OCT. 1935.  
SURVEYED UNDER INSTRUCTIONS OF THE  
BOARD OF SUPERVISORS PER ORDER DATED  
JULY 2<sup>ND</sup> 1935  
BEARINGS ARE BASED ON THE BEARING OF  
SOUTHERLY LINE-CITY OF TORRANCE PER C.S.B-434  
F.B. 589 - CONTROL.  
F.B.'S 595, 596, 597 - SOUNDINGS.  
SHORE TOPOGRAPHY - PLANE TABLE  
S.E. BUTLER  
FIELD WORK BY... T.H. MONCURE  
P.T. DUNLAP  
R.W. MALLISTER  
OFFICE WORK... W.J. LUCAS  
CHECKED BY... A.A. ROESER.

INDEX 25

Note:-  
For detail on Base Lines  
see marginal map above

CSB-1083-7  
A1 OF A2

FOR BLUE PRINTING  
WIDTH OF MAP = .38 INCHES  
AREA / FOOT LENGTH = .3 . . . 8"  
TOTAL AREA OF MAP = .24 . . . 8"

NOTE:-  
DATUM IS MEAN LOWER LOW WATER.  
CONTOURS ARE BELOW DATUM PL. ARE  
UNLESS MARKED WITH PLUS SIGN  
SEE C.S.B-1083-6, FOR  
PROPOSED BREAKWATER LOCATION

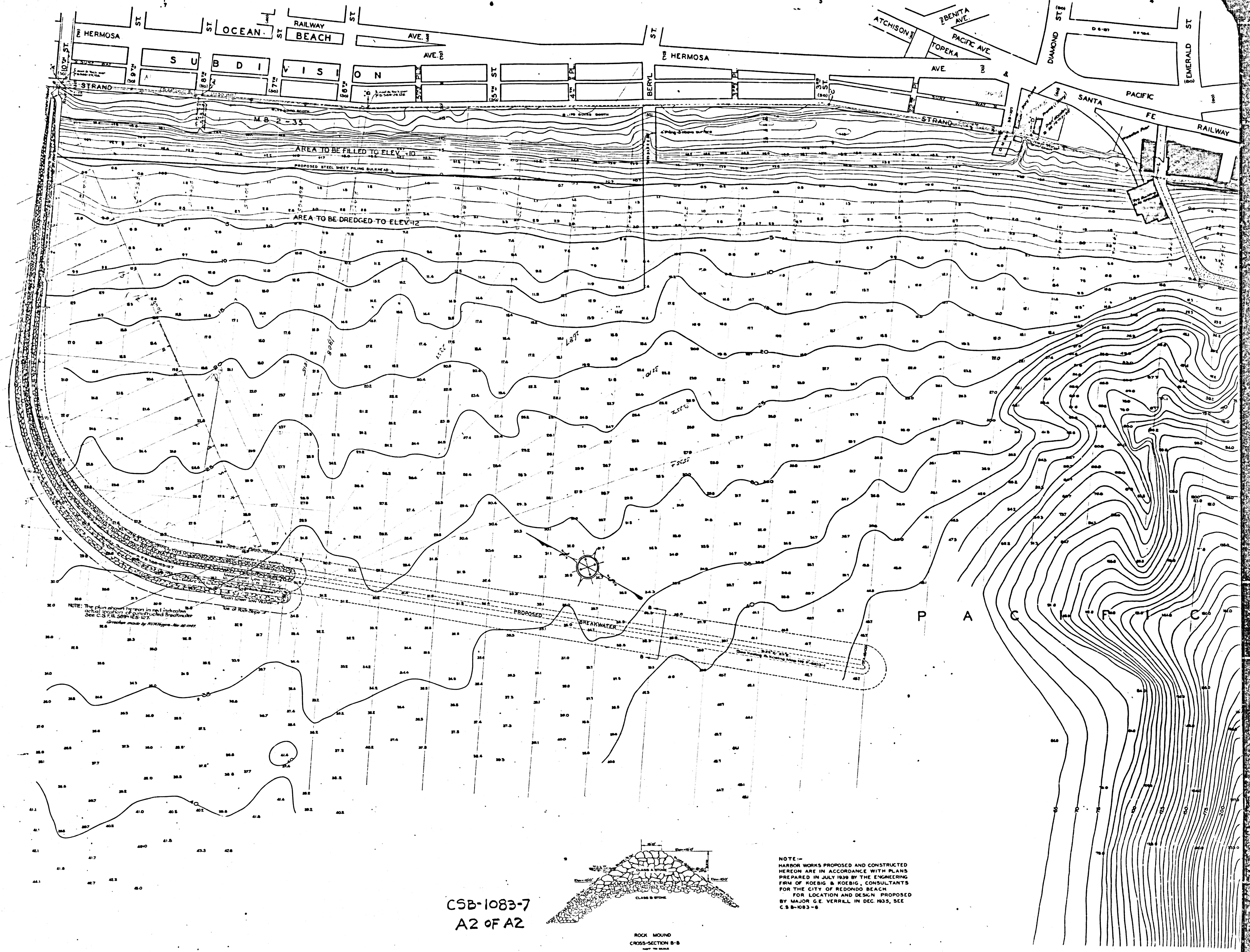

NOTE: The plan shows features in red indicating actual location of constructed breakwater. See C.S. 1083-7, 1083-8, 1083-9. Drawings made by HUNTER, Inc. 10/1/33.

CSB-1083-7  
A2 of A2

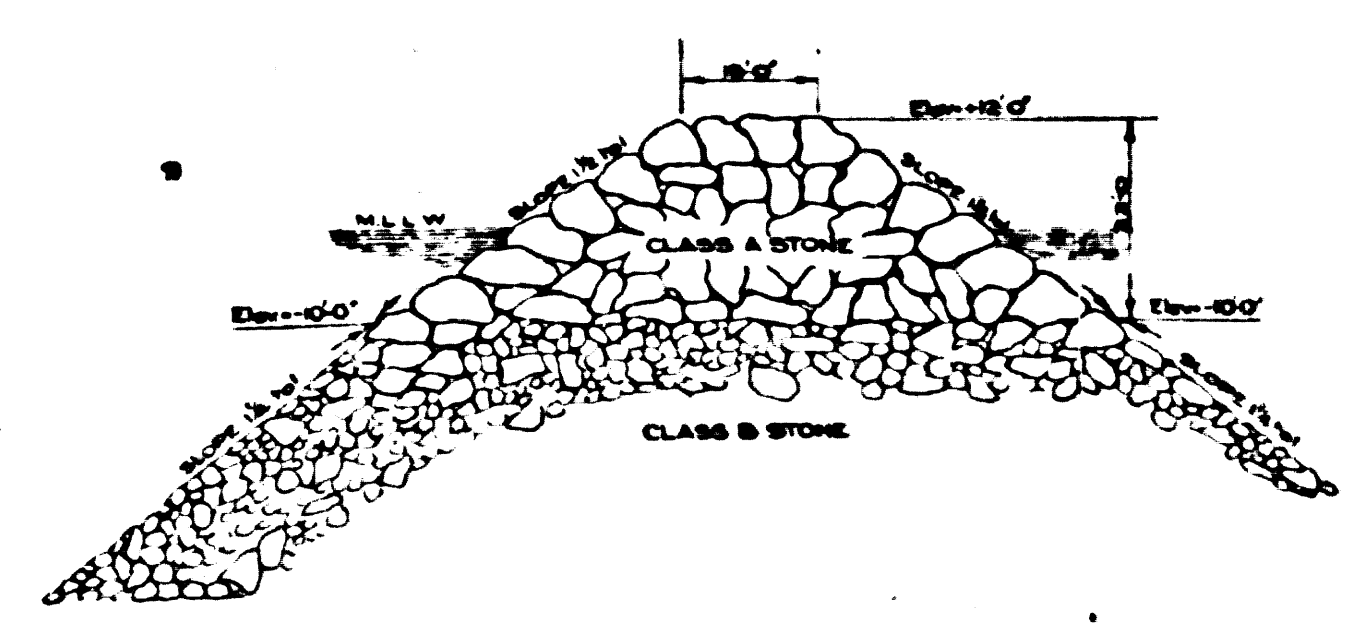

ROCK MOUND  
CROSS-SECTION B-B

NOTE: HARBOR WORKS PROPOSED AND CONSTRUCTED HEREON ARE IN ACCORDANCE WITH PLANS PREPARED IN JULY 1933 BY THE ENGINEERING FIRM OF KOEBIG & KOEBIG, CONSULTANTS FOR THE CITY OF REDONDO BEACH. FOR LOCATION AND DESIGN PROPOSED BY MAJOR G. E. VERRILL IN DEC. 1935, SEE C.S. 1083-6.