

CSB-1164-5  
A10FA4

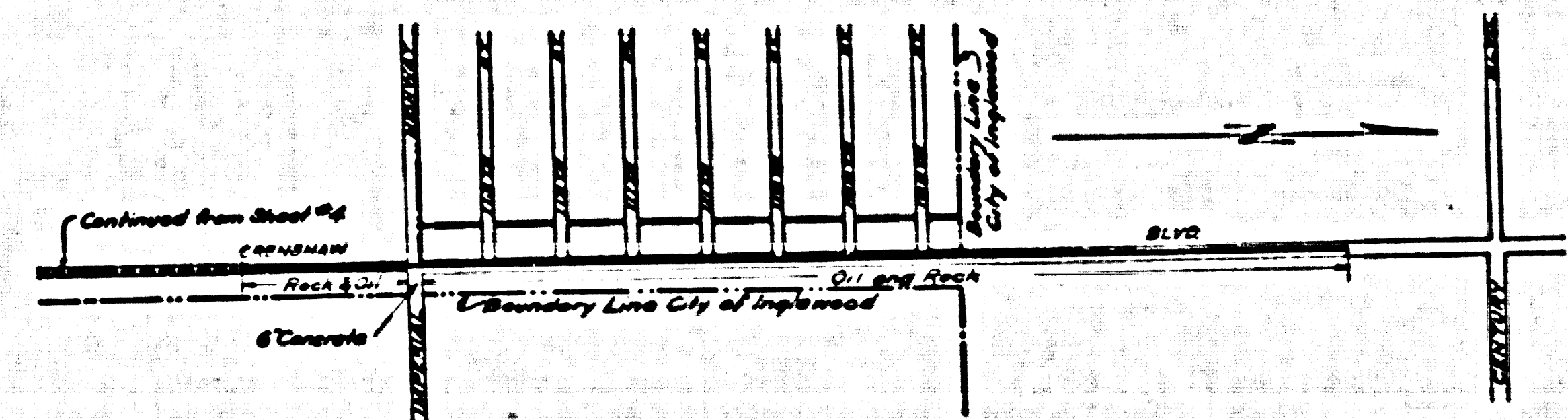

KEY MAP  
SHOWING DRAINS AND RESURFACING

**NOTES:**  
 Elevations are in feet above U.S.G.S. or mean Sea Level Datum.  
 Stations of inlets and junctions refer to the intersections of the center lines of the inlets with the center line of the main drain.  
 Elevations of all inlets except catch basin inlets into box sections refer to the flow lines of the inlets produced on their gradients to the vertical plane thru the center line of the main drain. Elevations of catch basin inlets into box sections refer to the intersections of the flow lines of these inlets with the inside wall of the box section.  
 For details of all standard structures see Standard Plans.  
 All pipe not otherwise specified shall be plain cement pipe.  
 All stubs to be one length of pipe with ends sealed with 2" red wood planking, unless otherwise specified.  
 Catch basins shall be built with a curb face of 10" or more which shall include a minimum depression of opening of 4" below gutter grade, unless otherwise specified.  
 Sanitary sewers crossing storm drains, shown in profile with less than two feet clearance, are to be encased as per Sec 6 for a length equal to the width of conduit trench.  
 All reinforced concrete structures shall be Class "A-1" Concrete.  
 Weep holes 3/4" in diameter shall be placed in each sidewall and spaced not more than five feet each way.

**LENOX  
DRAINAGE SYSTEM**  
 OF THE COUNTY OF LOS ANGELES, CALIFORNIA  
 PLAN AND PROFILE OF  
 CYPRESS AVENUE LINE

SHEET 5 OF 10 SHEETS  
 SCALE 1"=20' H.C.  
 NOVEMBER 1935  
 ALFRED JONES COUNTY SURVEYOR  
 RECOMMENDED BY [Signature] APPROVED BY [Signature]

REFERENCE	DESIGNED	J.H. Martley	JULY 1935
F.B. 1218	TRACED	Fred Hafner H.C. O'Leary	JULY 1935
L.B. 289, 817	CHECKED	J.H. Rice	JULY 1935





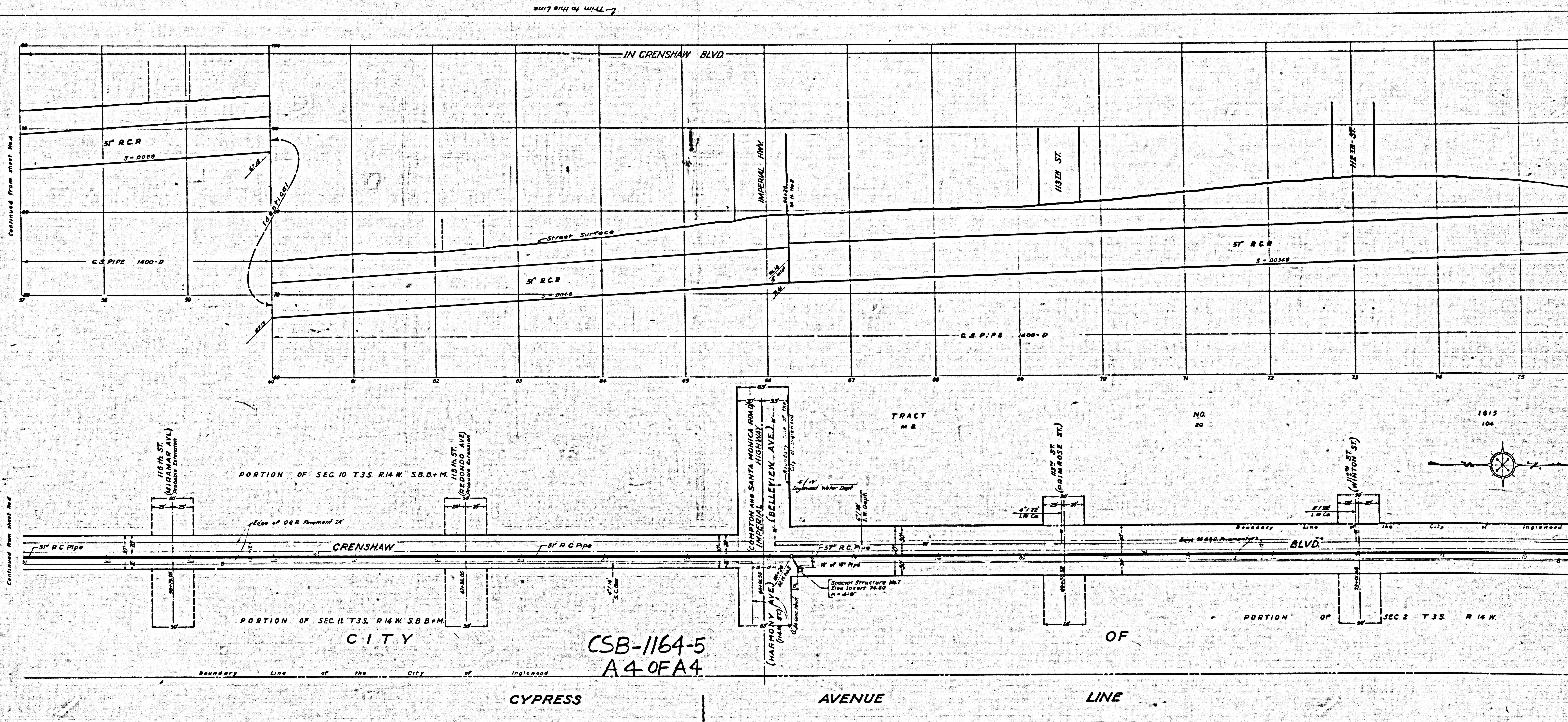

Continued from sheet No. 4

Continued from sheet No. 4

Trim to this line

Trim to this line

CSB-1164-5  
A4 OF A4

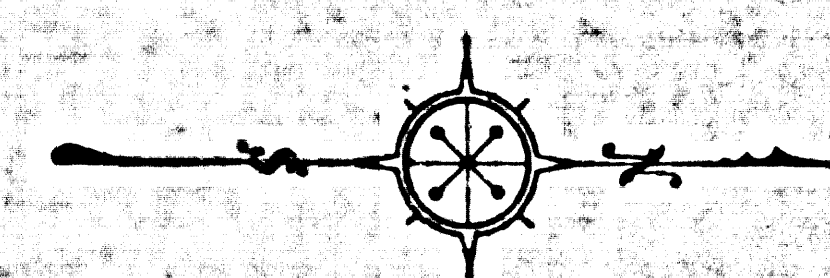

PORTION OF SEC. 10 T. 3 S. R. 14 W. S. B. & M.

PORTION OF SEC. 11 T. 3 S. R. 14 W. S. B. & M.

TRACT  
M. E.

N. 10  
20

1615  
104

PORTION OF SEC. 2 T. 3 S. R. 14 W.

Boundary Line of the City of Inglewood

Boundary Line of the City of Inglewood

Boundary Line of the City of Inglewood

Boundary Line of the City of Inglewood

Boundary Line of the City of Inglewood

Boundary Line of the City of Inglewood

Boundary Line of the City of Inglewood

Boundary Line of the City of Inglewood

Boundary Line of the City of Inglewood

Boundary Line of the City of Inglewood

Boundary Line of the City of Inglewood

Boundary Line of the City of Inglewood

Boundary Line of the City of Inglewood

Boundary Line of the City of Inglewood

Boundary Line of the City of Inglewood

Boundary Line of the City of Inglewood

Boundary Line of the City of Inglewood

Boundary Line of the City of Inglewood

Boundary Line of the City of Inglewood

Boundary Line of the City of Inglewood