

Note: This set of Plans consists of Sheet No. 1
 Sheet No. 2
 Sheet No. 3
 Sheet No. 4
 Sheet No. 5

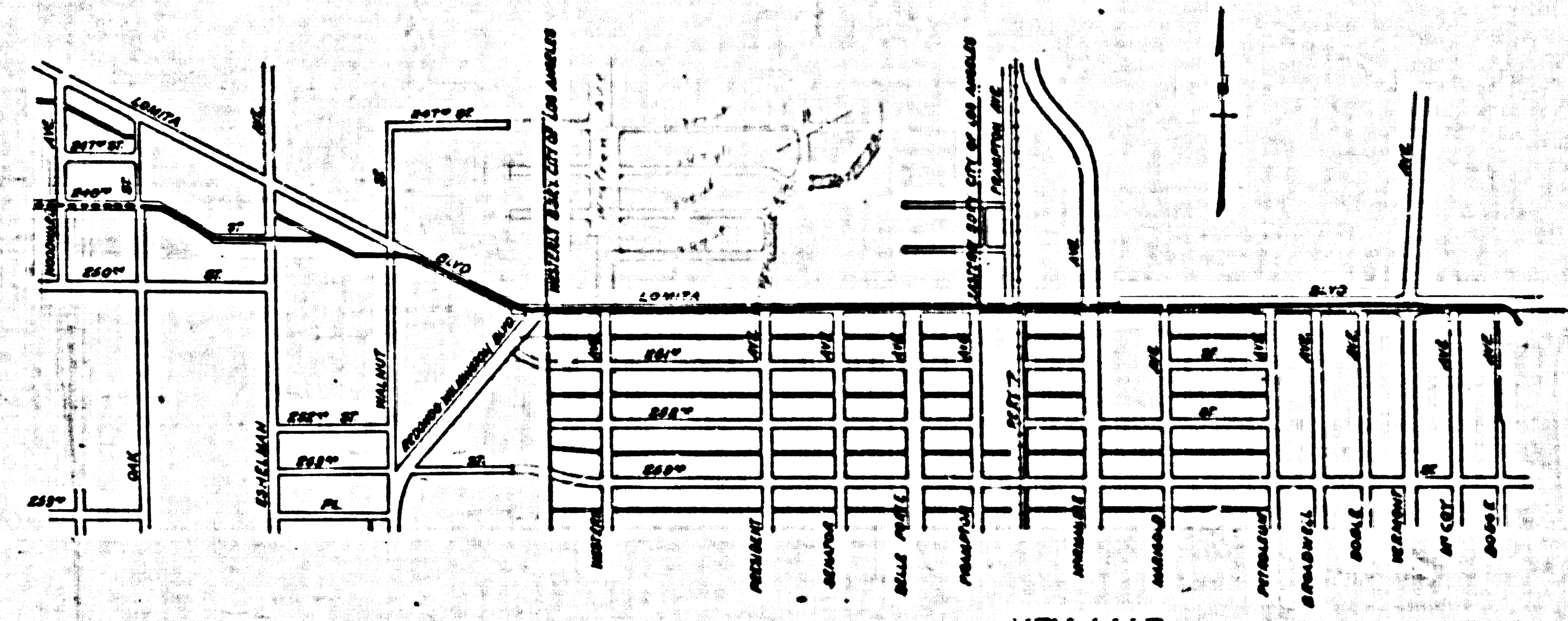

KEY MAP
 SHOWING DRAIN

NOTE:
 Elevations are in feet above U.S.G.S. or mean Sea Level Datum.
 Elevations of all Lateral Inlets refer to the intersection of the invert of the Lateral with the inside face of the main or structure.
 Stations of all Connector Pipe Inlets refer to the intersection of the center line of the connector pipe with the inside face of the main drain or structure. Bring connector pipes in parallel to pipe drains where structures are not designated.
 Connector Pipes in Box Sections shall be laid in conjunction with Junction Structure N44 (Standard Dc. 85), unless otherwise specified by the Engineer of Construction.
 Connector Pipes located under pavement with cover less than two feet shall be created according to Case C4 (Standard Dc. 84).
 All Pipes not otherwise specified shall be Standard Strength Cement Concrete Pipes.
 For Structures marked SPEC. STR. N41, or SECTION - see structural details on Special Structures and Box Section Sheet.
 All Structures not otherwise specified are Standard Structures. See details on Standard Plans.
 Elevations shown of Catch Basins refer to top of proposed curb of center line of basin if one elevation is given or to ends of basin if two elevations are given.
 Sanitary Sewers crossing over or with a clearance of 150 feet or less under Storm Drain shall be constructed or reconstructed as shown on Standard Dc. 54, except as otherwise specified on detail Sewer Plan.

**LOMITA BOULEVARD
 DRAINAGE SYSTEM**
 OF THE COUNTY OF LOS ANGELES, CALIFORNIA.

PLAN AND PROFILE OF
 LOMITA-LOMITA TRUNK RINK

SHEET 2 OF 5 SHEETS
 SCALE 1/4" = 1'-0"
 JULY 1940
 ALFRED JONES - COUNTY ENGINEER

Contracted as constructed by A.W. Lynn 8-6-42
 Checked by L.G. Langhorne 8-12-42

| REFERENCE | REMARKS | DATE | BY |
|-----------|----------|-----------|------------------|
| 1-1-40 | DESIGNED | July 1940 | J.H. Hartley |
| 1-1-40 | TRACED | July 1940 | J.H. Hartley |
| 1-1-40 | CHECKED | July 1940 | G.W. Stinchfield |

APPROVED *[Signature]*
 LOMITA ALAMOGA CITY ENGINEER

CSB-1165-2
 A1 OF A7

SHEET NO. 2 OF 5 SHEETS
 COUNTY ENGINEER

SHEET NO. 2 OF 5 SHEETS
 COUNTY ENGINEER

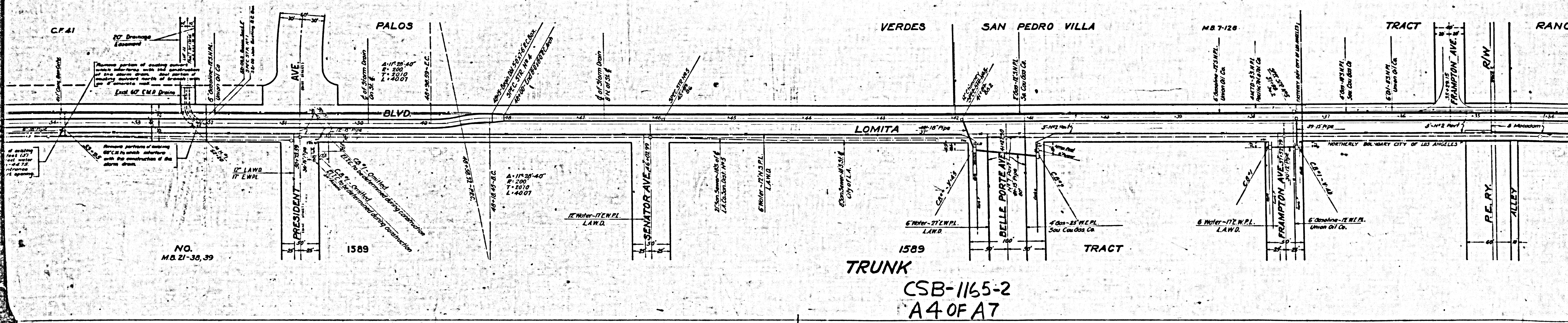
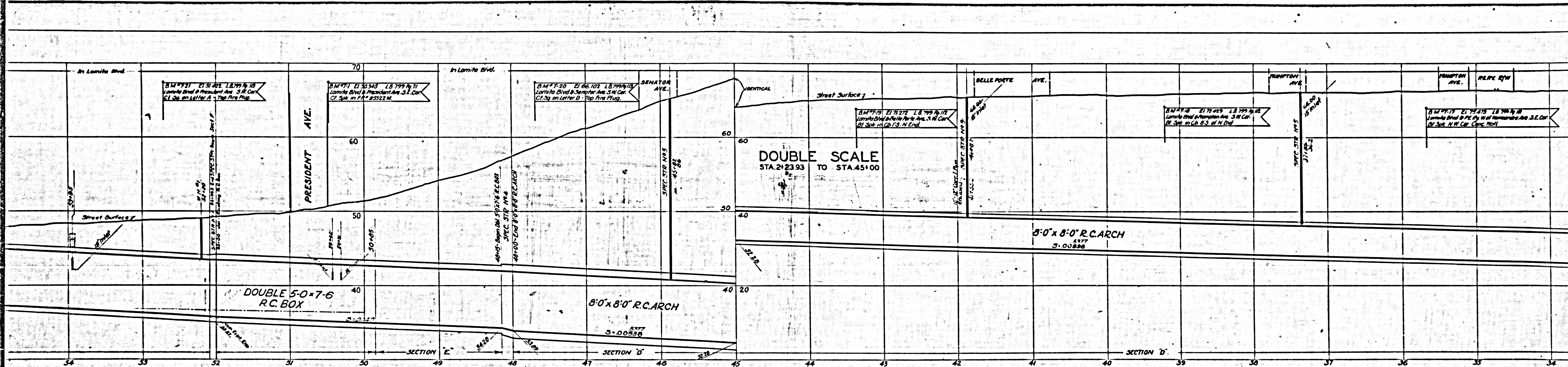

NO. M.B. 21-35, 39

1589

TRUNK
CSB-1165-2
A4 OF A7

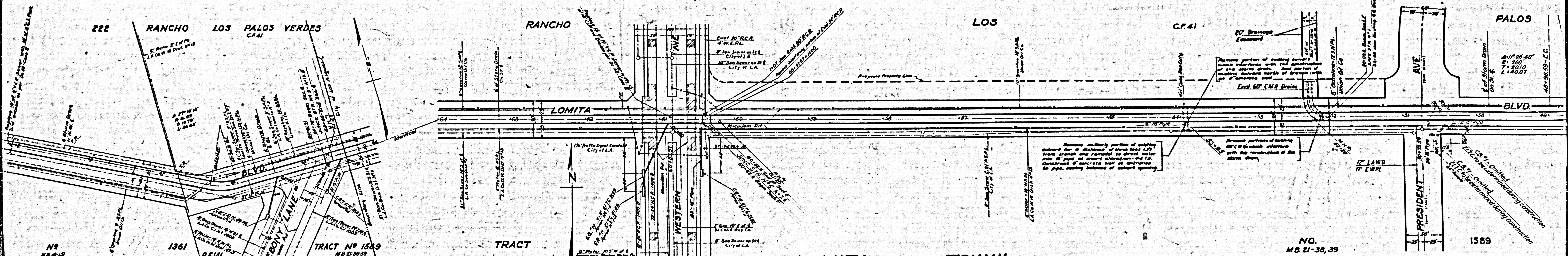
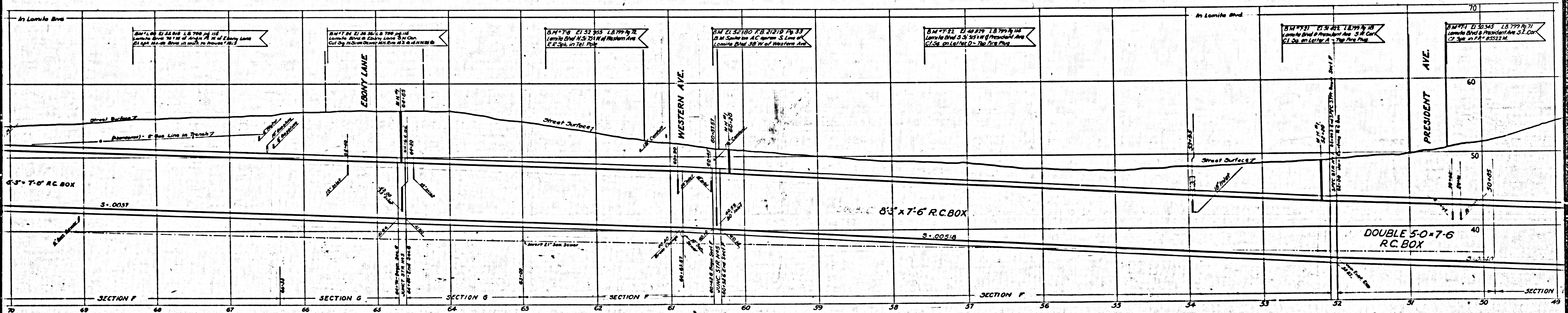

LOMITA TRUNK
 CSB-1165-2
 A5 OF A 7

NO.
 M.D. 21-35, 39

1589

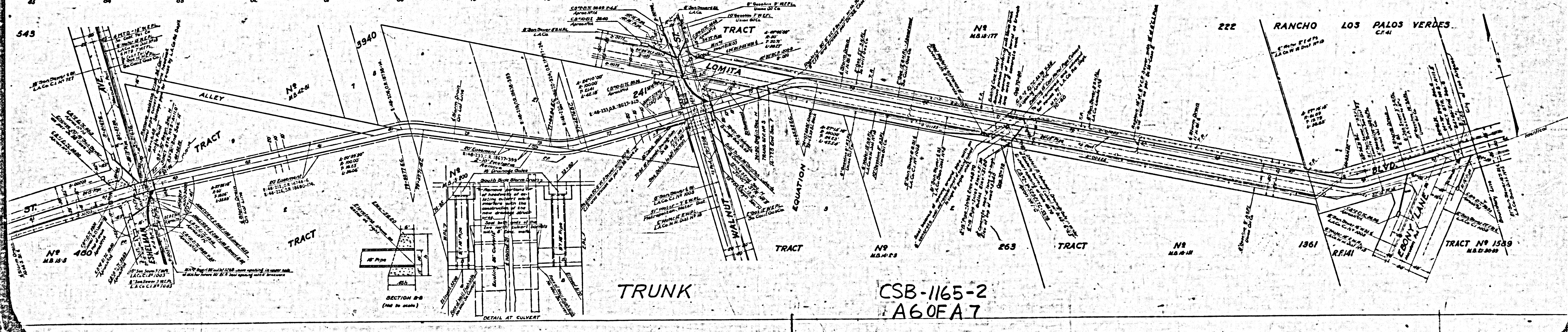
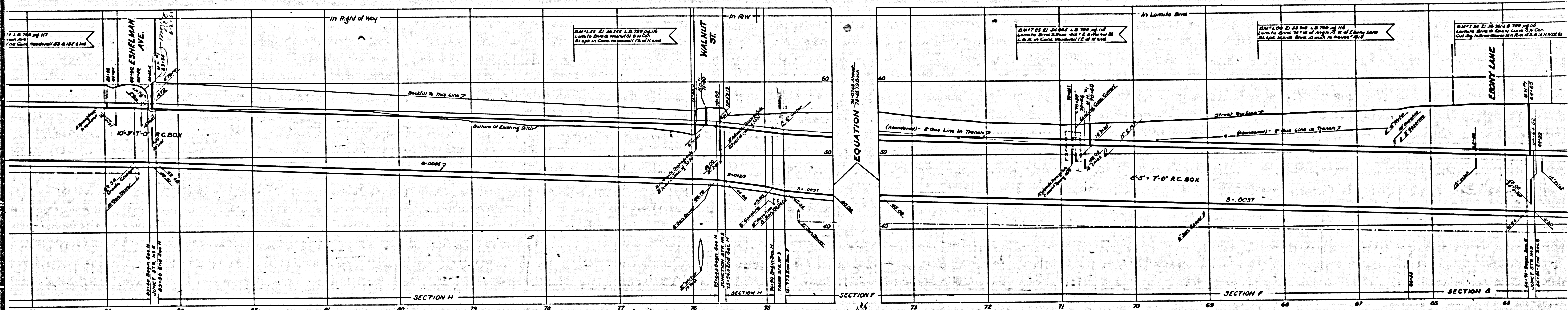

CSB-1165-2
A60FA7

SHEET NO. 5 OF 9 SHEETS
CONTRACT 2786-LEACH MVB NO. B-1182

SHEET NO. 5 OF 9 SHEETS
CONTRACT 2786-LEACH MVB NO. B-1182

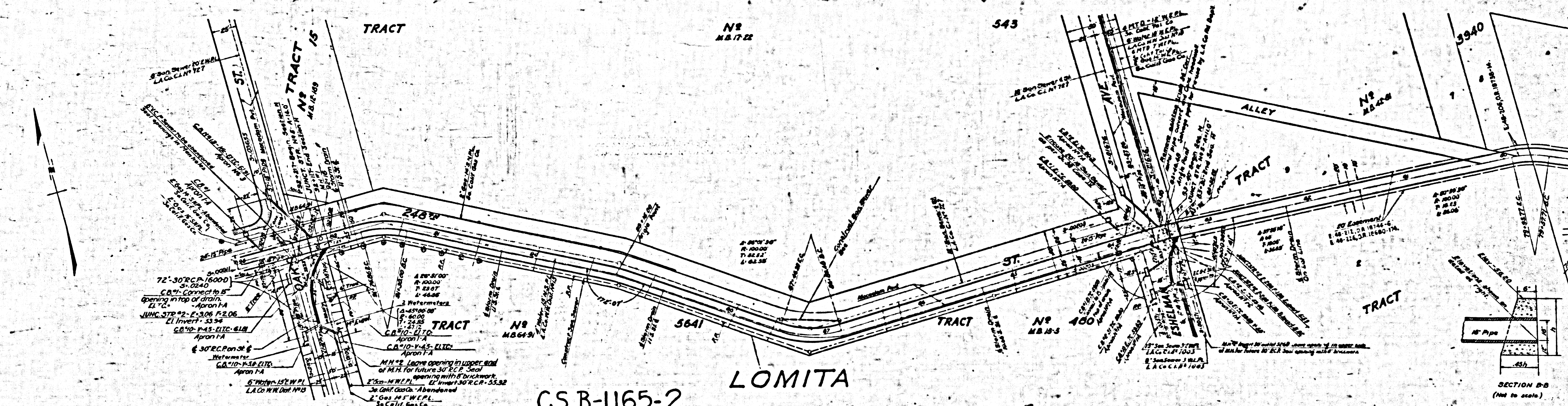
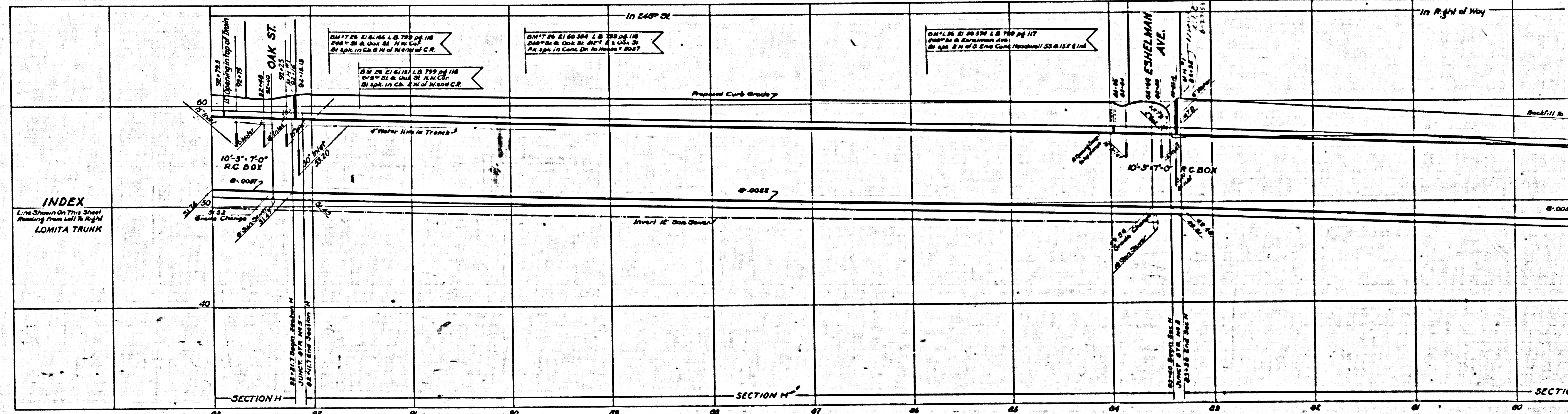

CSB-1165-2
A7 OF A7

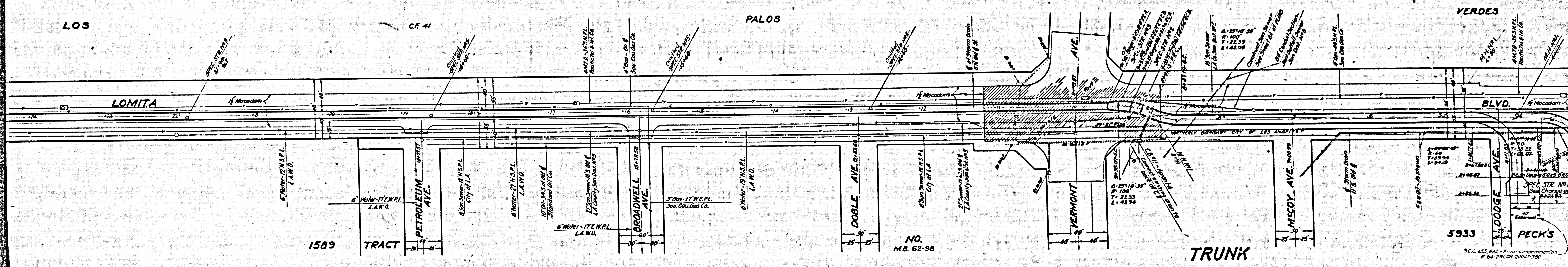
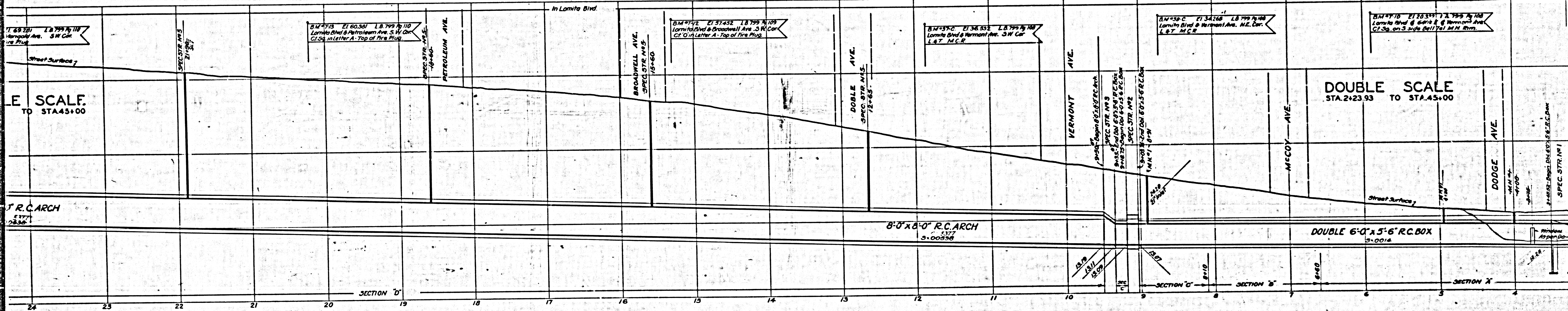

CSB-1165-2
A2 OF A7

5933 PECK'S
S.C. 453 682 - Final Construction
E 04 29 04 2047 030

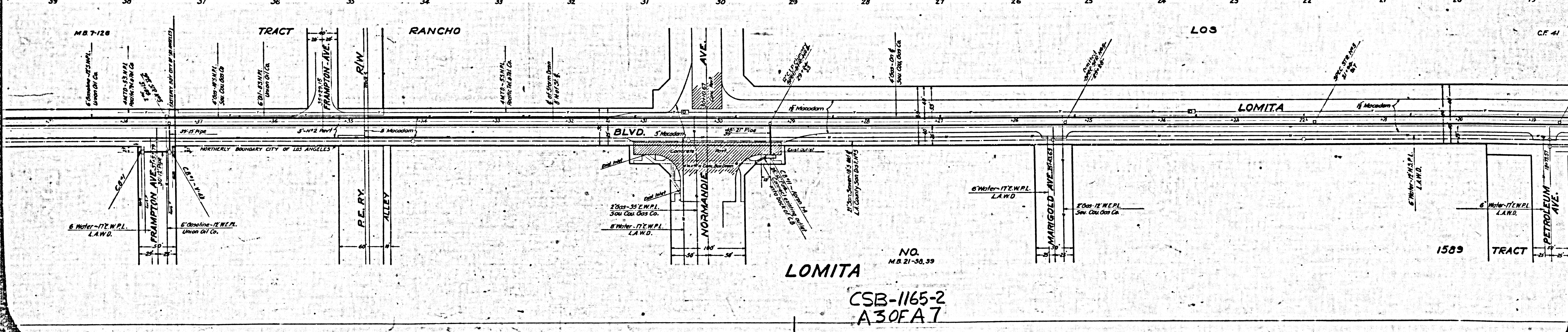
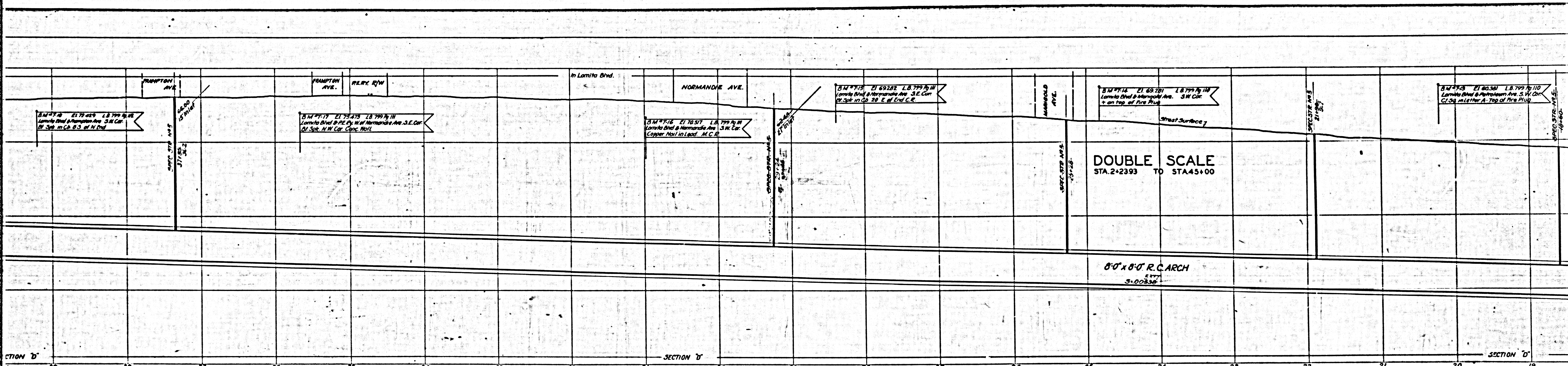

NO. 1589
 M.B. 21-30, 39
 LOMITA
 CSB-1165-2
 A30FA7