

CSB-1171-11A
A1 OF A4

Corrected as Constructed
August 1941
A.T. Kincaid

COUNTY OF LOS ANGELES, CALIFORNIA
OFFICE OF COUNTY SURVEYOR

**PROPOSED ADDITIONAL DRAINAGE STRUCTURES
GLEN AVENUE DRAINAGE SYSTEM
SEC. B**

IN
MONA BLVD.
BETWEEN
124TH ST. & 135TH ST.
IN
STOCKWELL ST.
BETWEEN
PENROSE AVE. & WILLOWBROOK AVE.
AND
WILLOWBROOK AVE.
AT
119TH ST. & 130TH ST.

SCALE: 1"=40'
SHEET 11A OF 26 SHEETS
MARCH 1938.

ALFRED JONES COUNTY SURVEYOR
RECOMMENDED: *E.F. Linnell* CHIEF DEPUTY
APPROVED: *Alfred Jones* COUNTY SURVEYOR

NOTE:
This plan is to accompany Change of Plan Order No. 2

1171-11A
SHEET 11A OF 26 SHEETS
COUNTY ENGINEER: M.B. BELLI

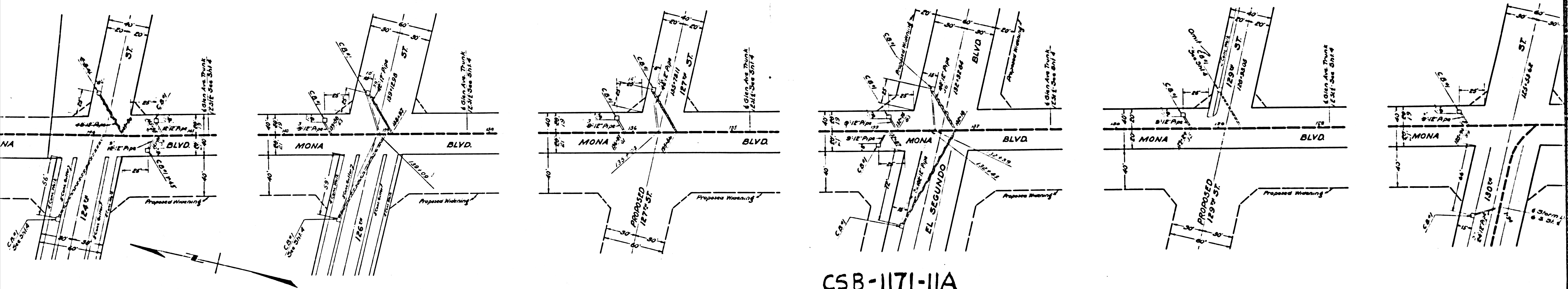

CSB-1171-11A
 A3 OF A4

SHEET No 11-A OF 59 SHEETS
COMPLY SURVEYORS MAP No B-1111

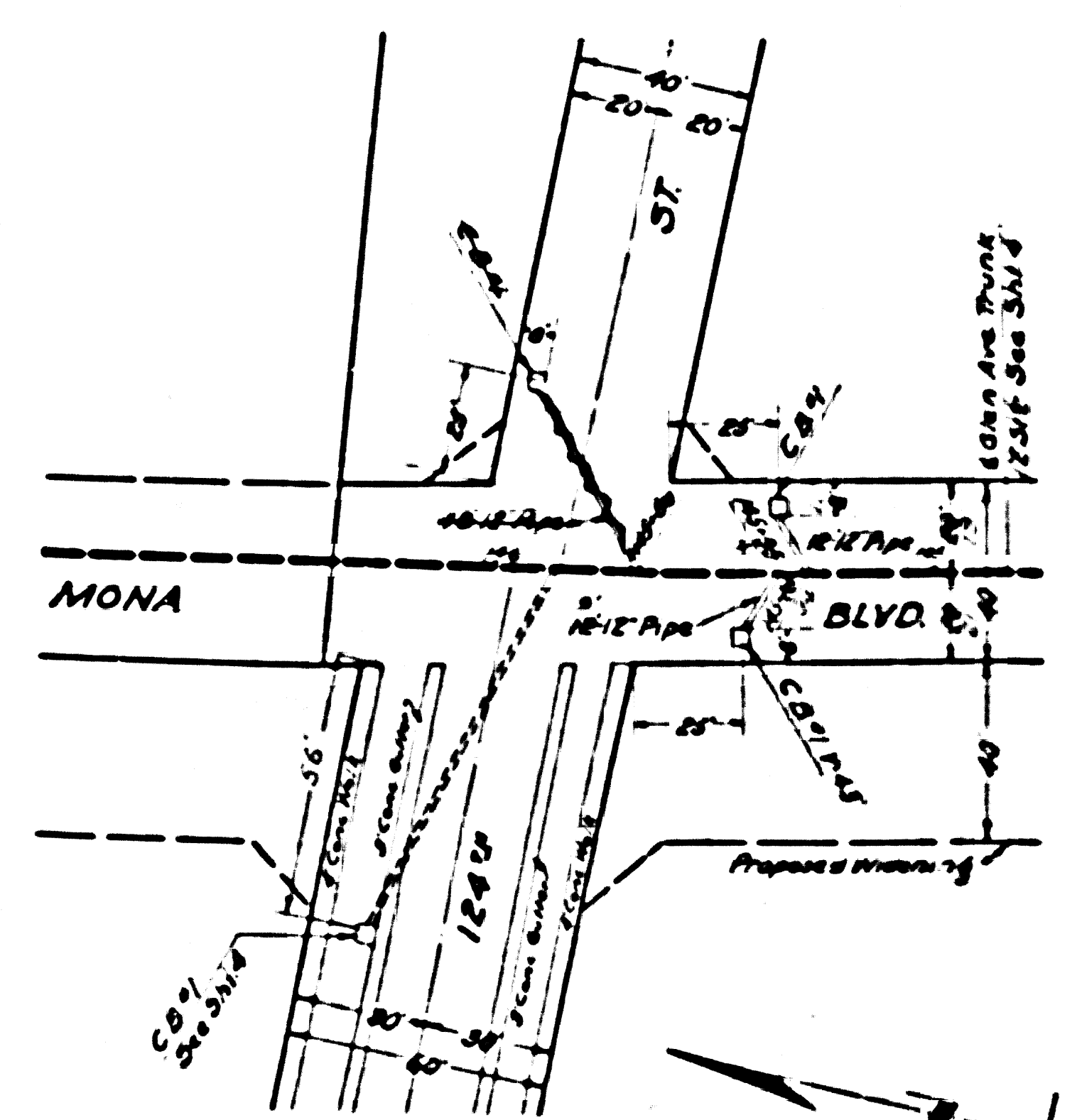
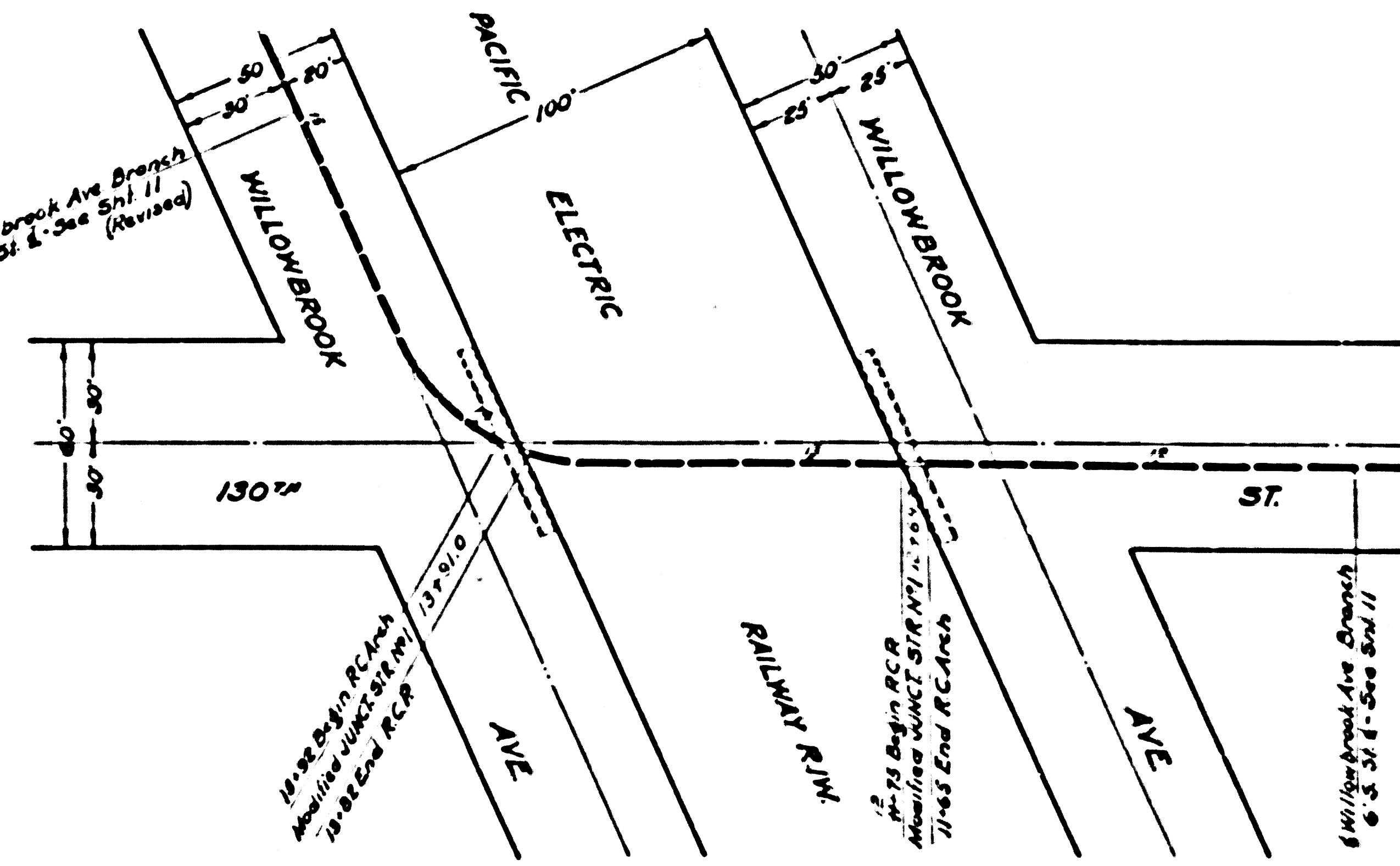
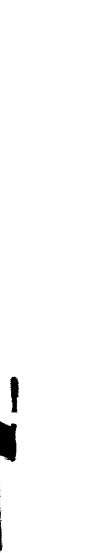
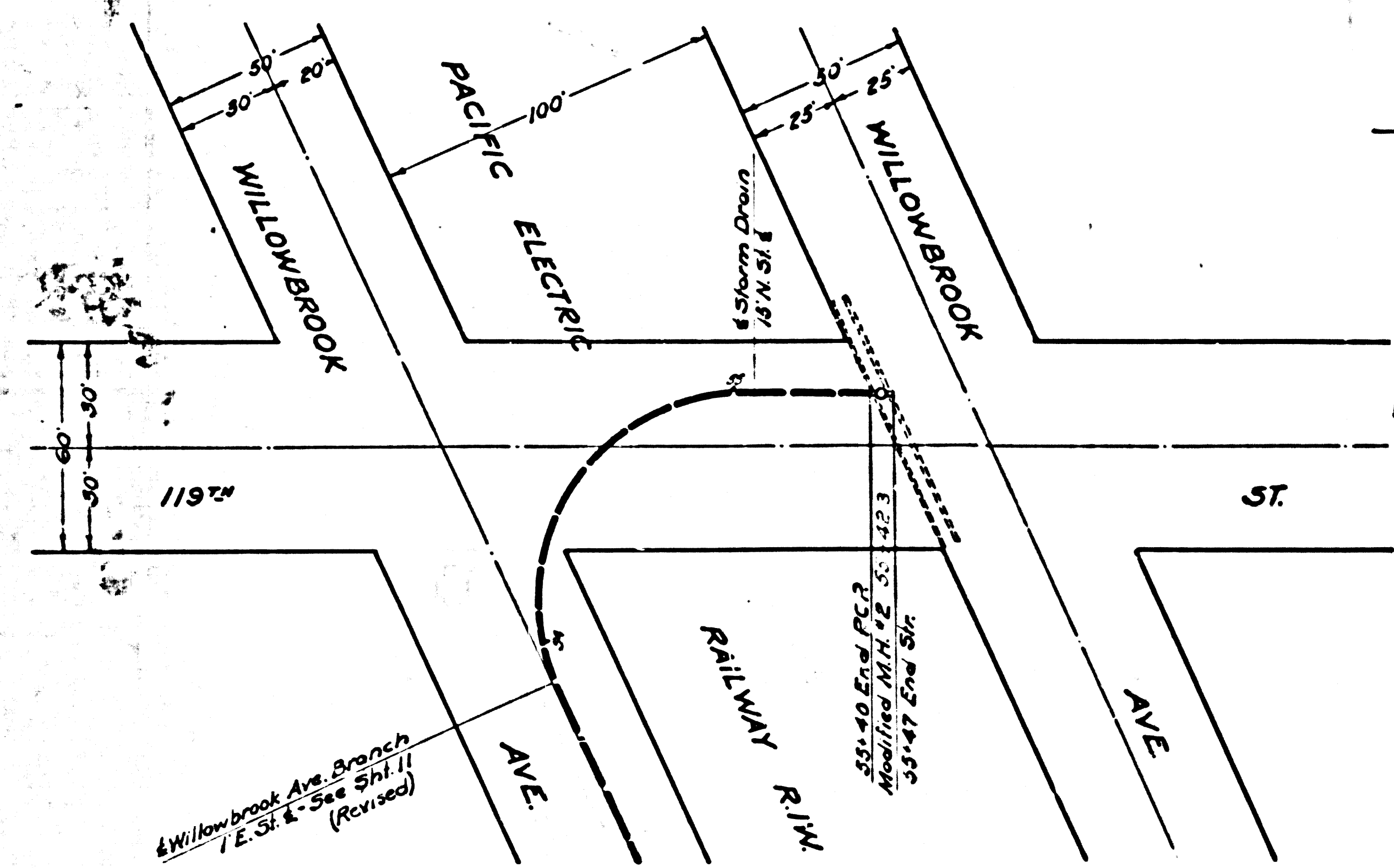

CSB-1171-11A
A4 OF A4

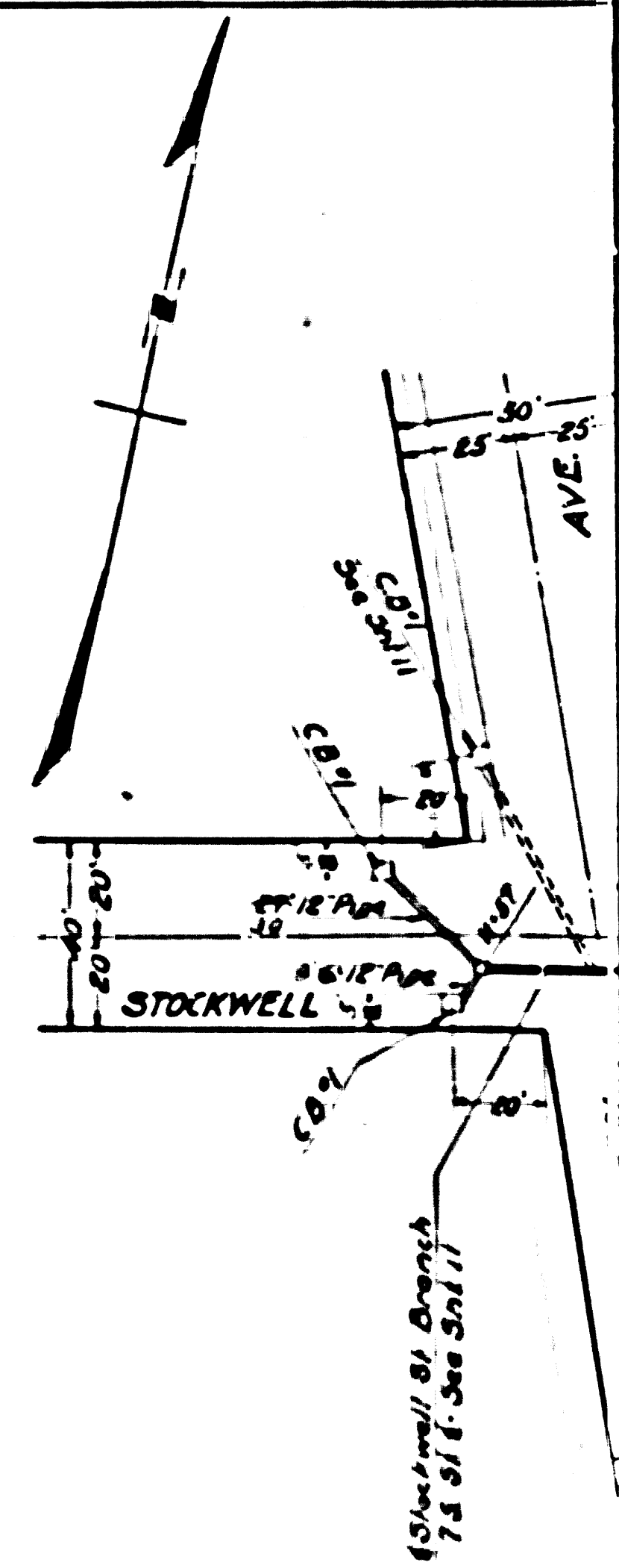
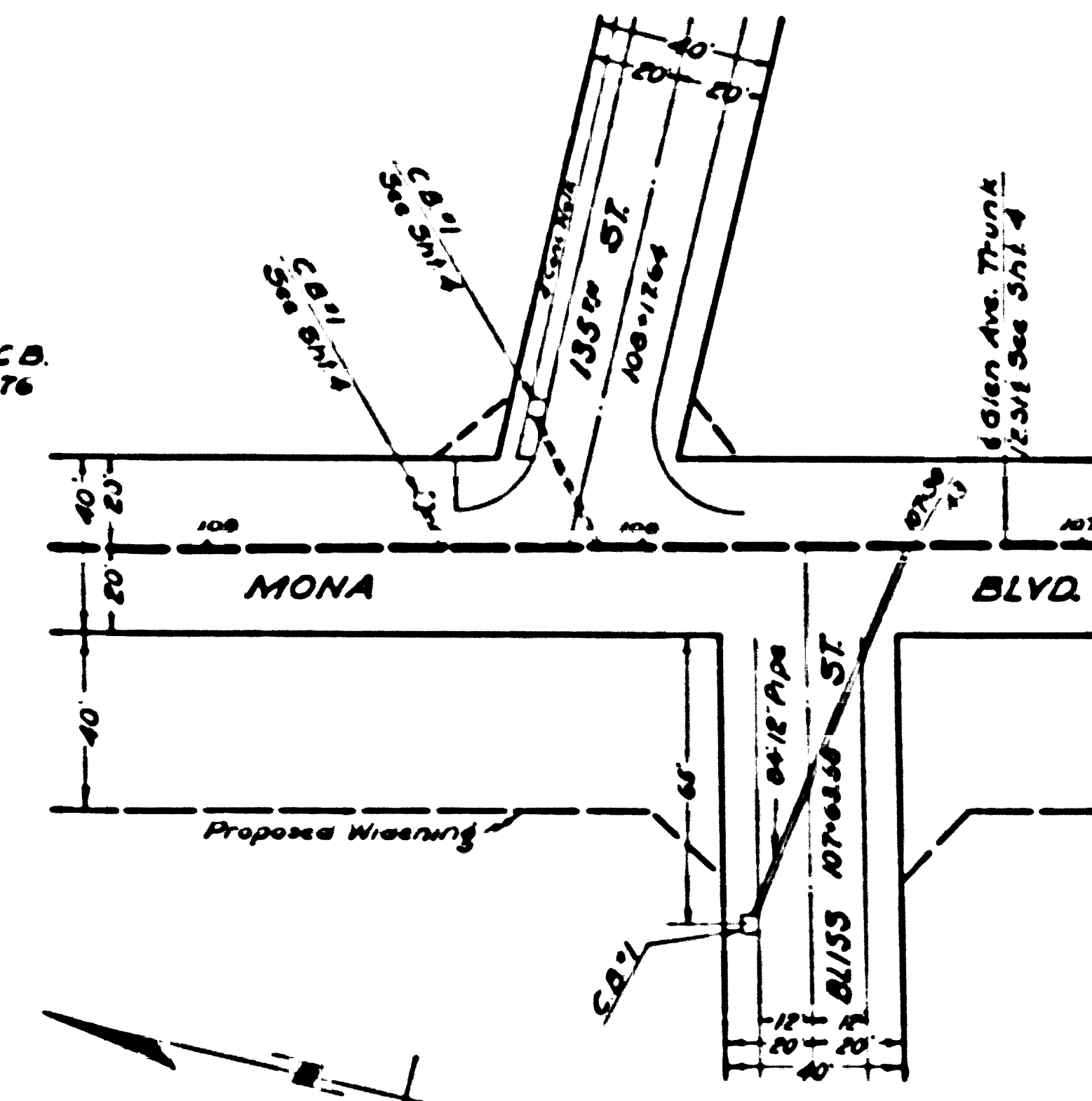
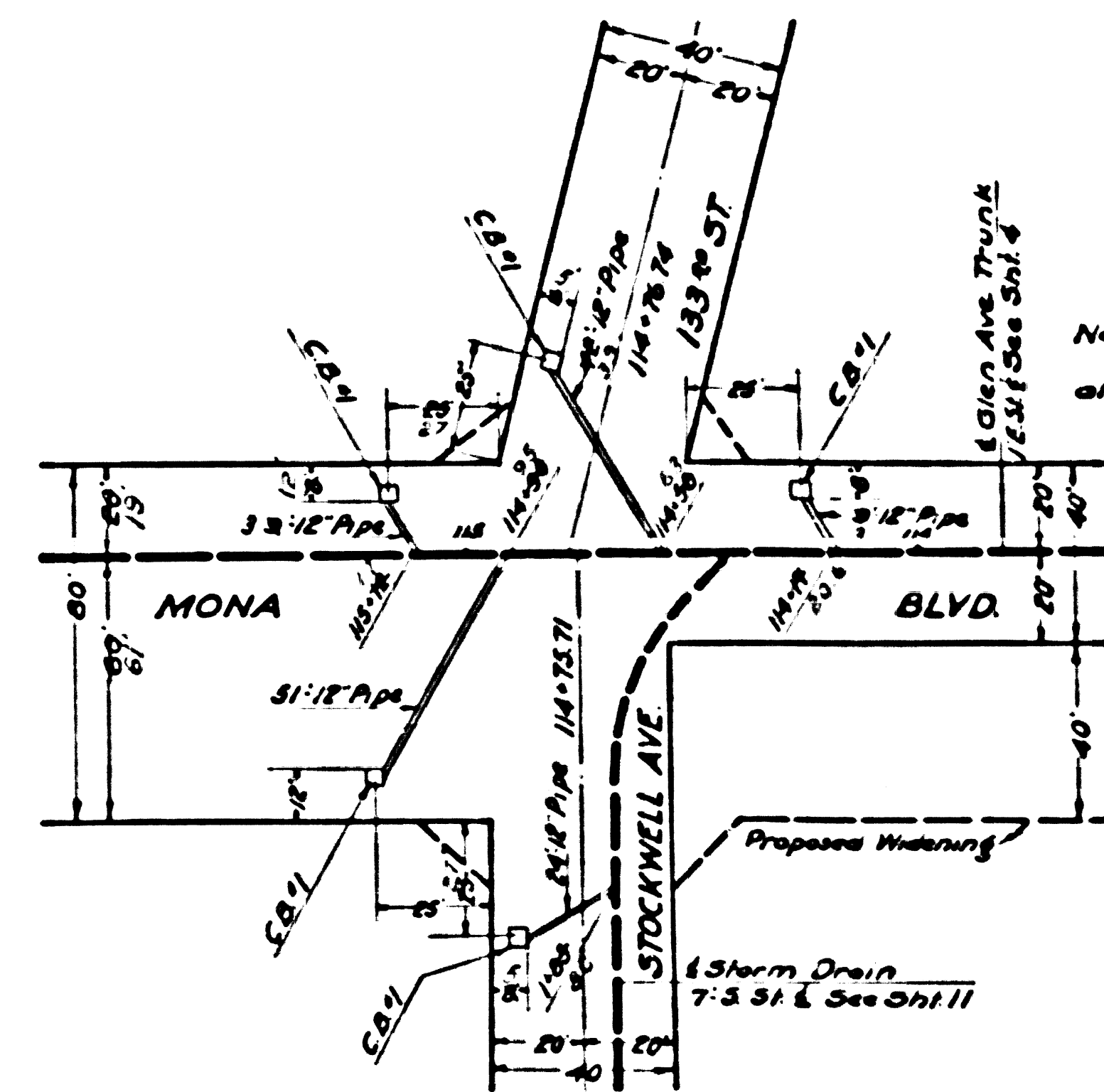
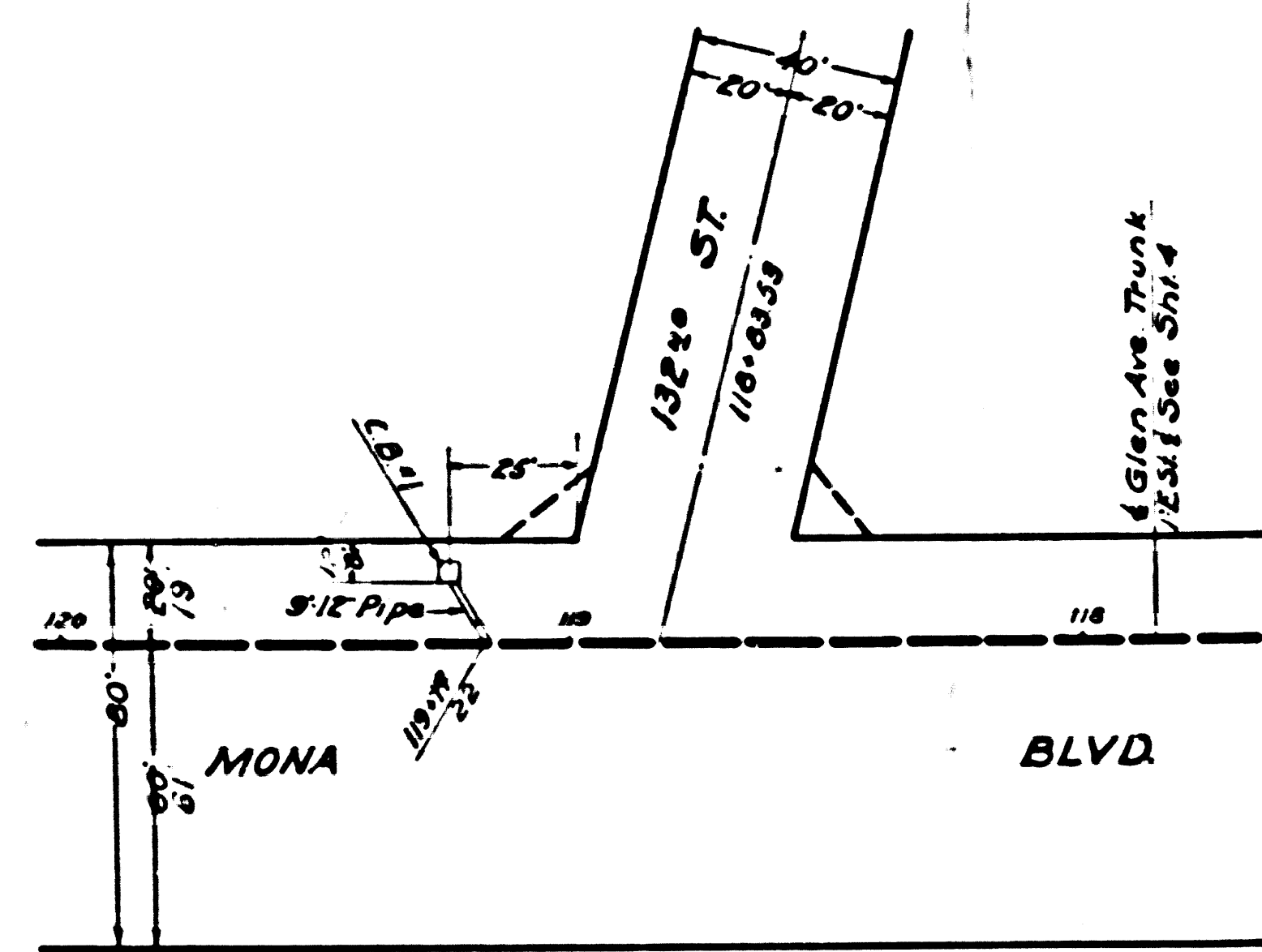
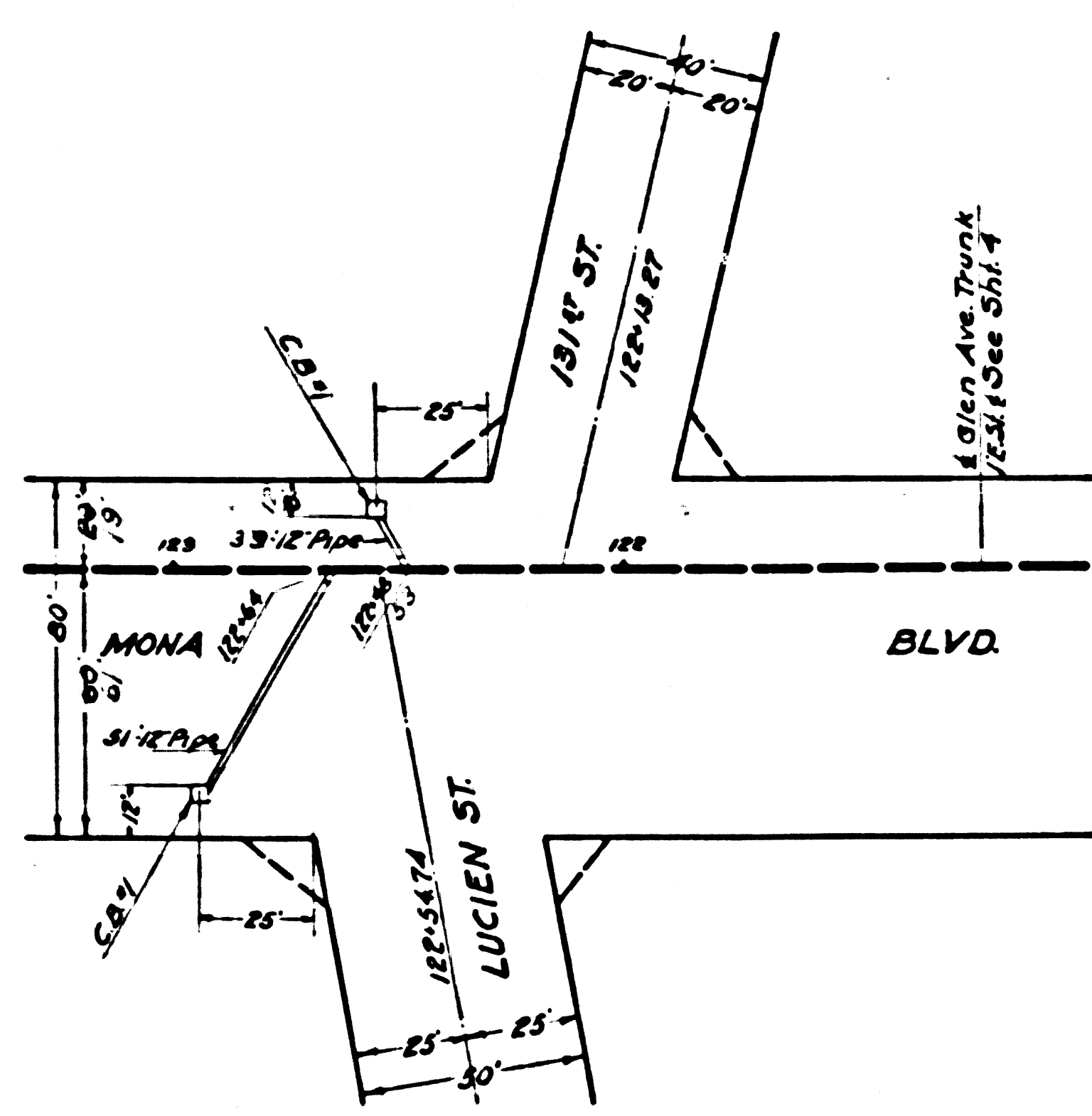
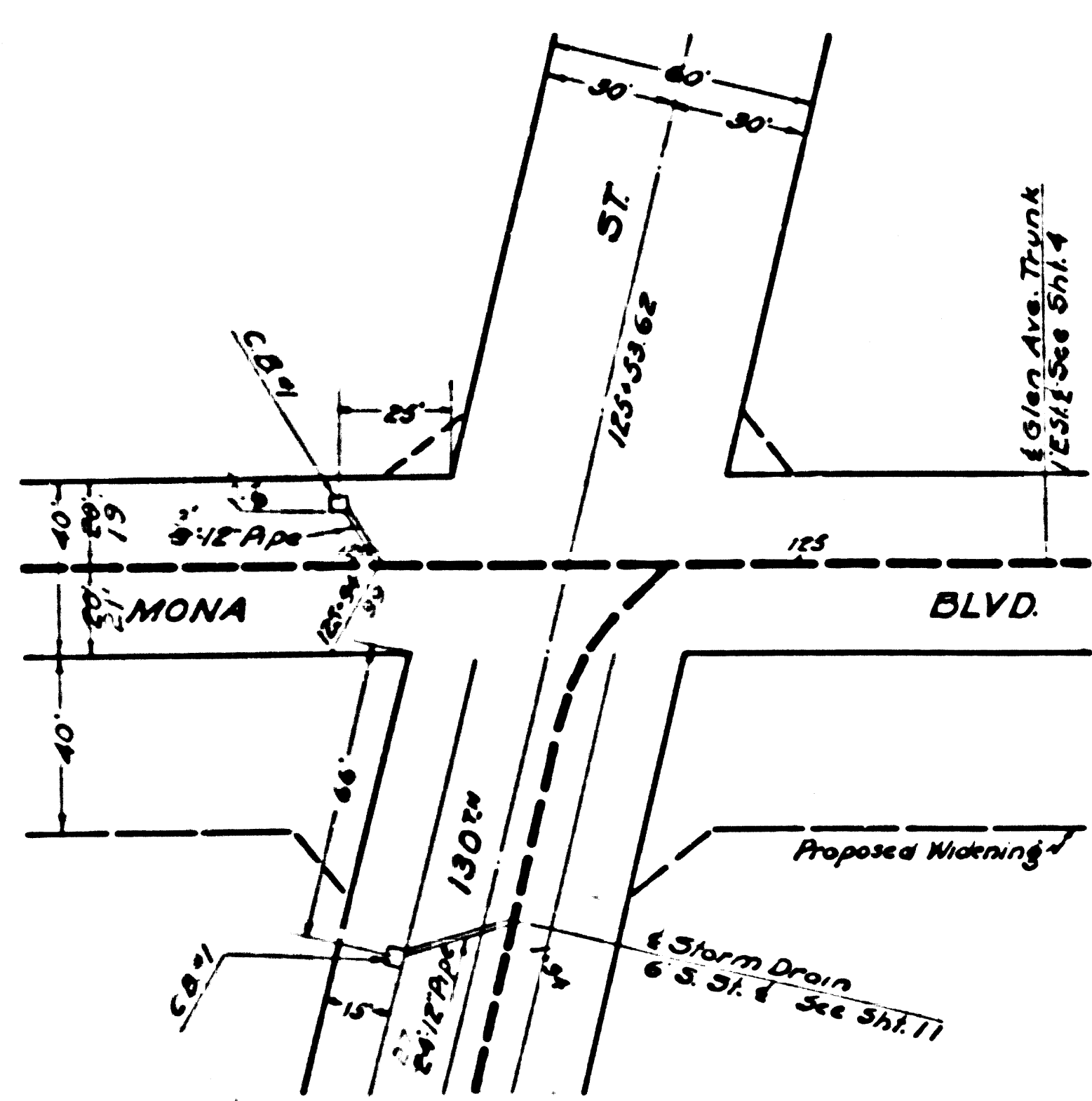

CSB-1171-11A
A2 OF A4