

KEY MAP  
SHOWING DRAINS AND RESURFACING

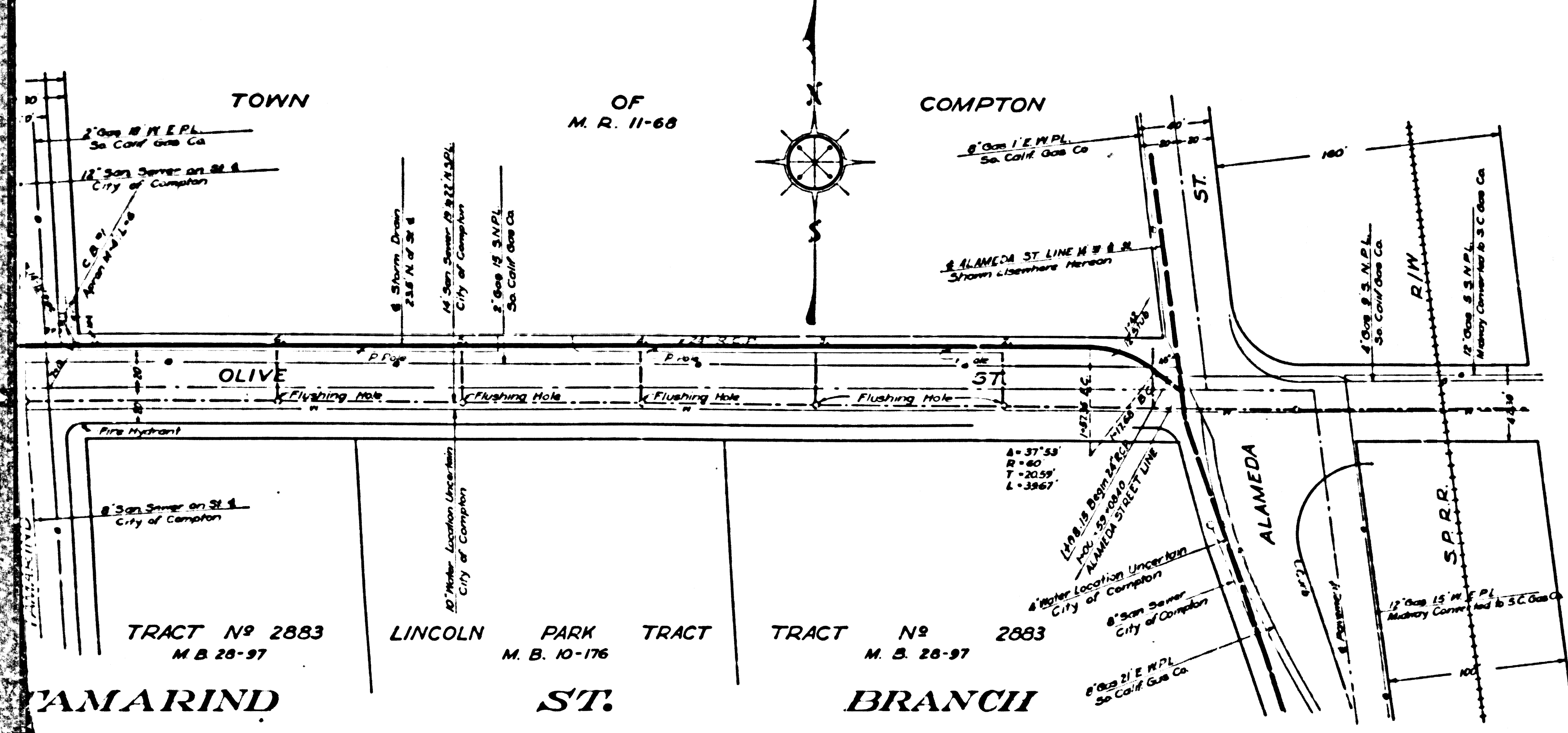

NOTES:

- Elevations are in feet above USGS or mean Sea Level Datum.
- Stations of inlets and junctions refer to the intersections of the center lines of the inlets with the center line of the main drain.
- Elevations of all inlets except catch basin inlets into box sections refer to the flow lines of the inlets produced on their gradients to the vertical plane thru the center line of the main drain. Elevations of catch basin inlets into box sections refer to the intersections of the flow lines of these inlets with the inside wall of the box section.
- For details of all standard structures see Standard Plans.
- All pipe not otherwise specified shall be plain cement pipe.
- All stubs to be one length of pipe with ends sealed with 2" red wood planking, unless otherwise specified.
- Catch basins shall be built with a curb face of 10" or more which shall include a minimum depression at opening of 4" below gutter grade, unless otherwise specified.
- Sanitary sewers crossing storm drains, shown in profile with less than 1 1/2 feet clearance, are to be encased as per S-6 for a length equal to the width of conduit trench. In addition if less than 1/2 ft clearance sewers must be of cast iron pipe and encased as noted above.

GLEN AVENUE  
DRAINAGE SYSTEM  
OF THE COUNTY OF LOS ANGELES CALIFORNIA  
PLAN AND PROFILE OF  
ALAMEDA ST. LINE  
TAMARIND ST. BRANCH

SHEET 17 OF 26 SHEETS

NOVEMBER 1933  
ALFRED JONES COUNTY SUPERVISOR  
RECOMMENDED [Signature] APPROVED [Signature]

REFERENCE	DESIGNED	DATE
F. R. 496	L. Longacre	APR 1932
L. B. 651	TRACED Noonan	APR 1934
Revised at 21' of Jun 27-1933	CHECKED E. E. Mitchell	APR 1934

CSB-1171-17  
A1 OF A8

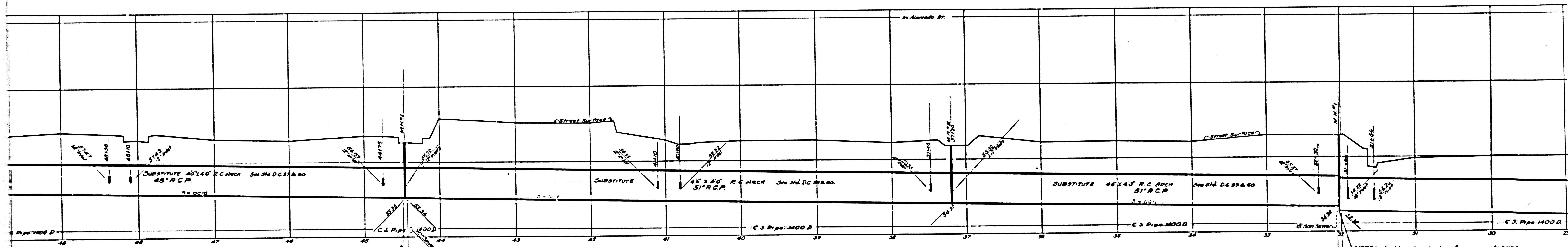

NOTE: Adjust transition structures if necessary to bring  
 33 cover just inside of north end of transition structure

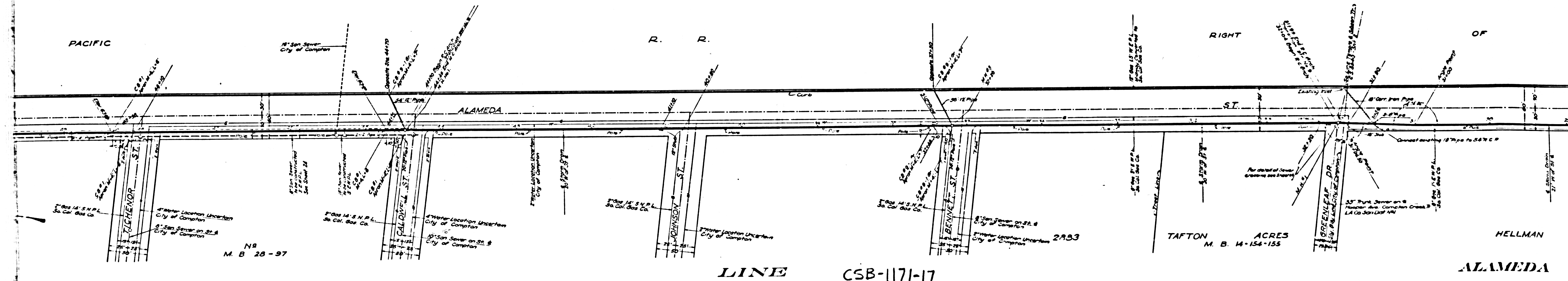

LINE CSB-1171-17  
 A5 OF A8

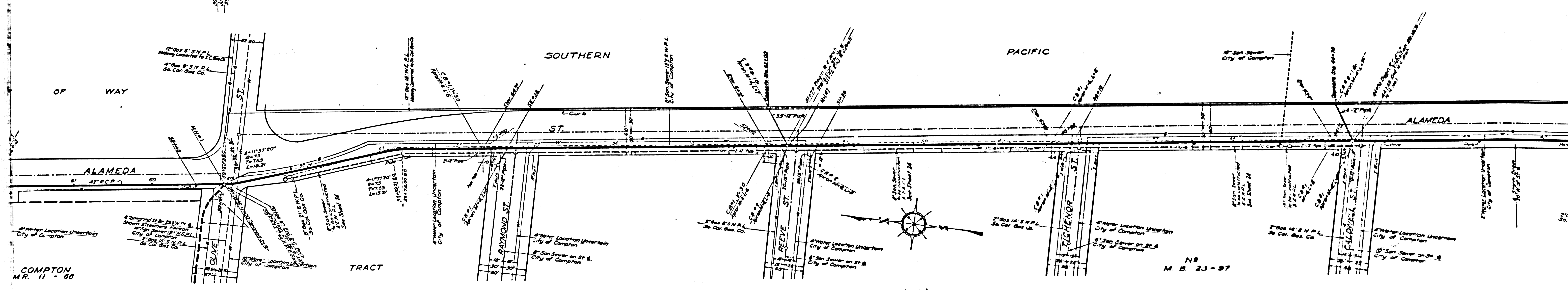
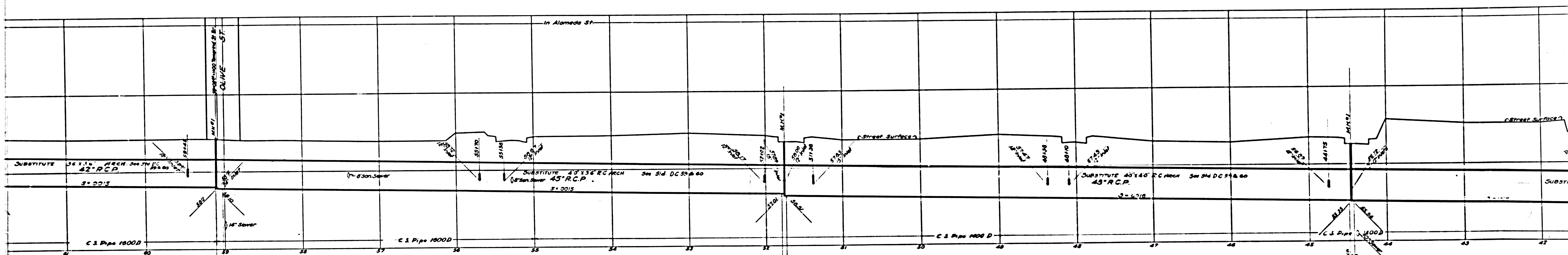

COMPTON  
M.R. 11 - 88

TRACT

STREET

CSB-1171-17  
A6 OF A8

NB  
M. B. 23-97

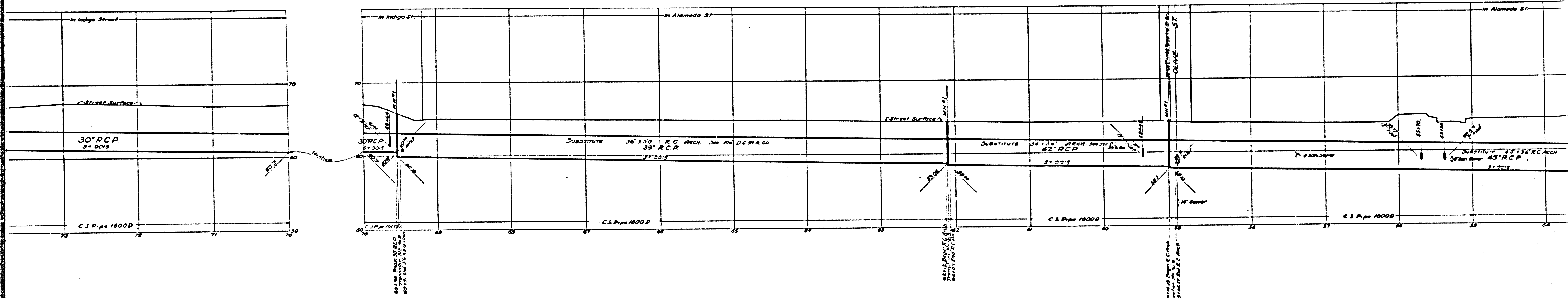

TOWN OF COMPTON  
M. R. 11 - 68

SOUTHERN PACIFIC R. R. RIGHT OF WAY

SOUTHERN

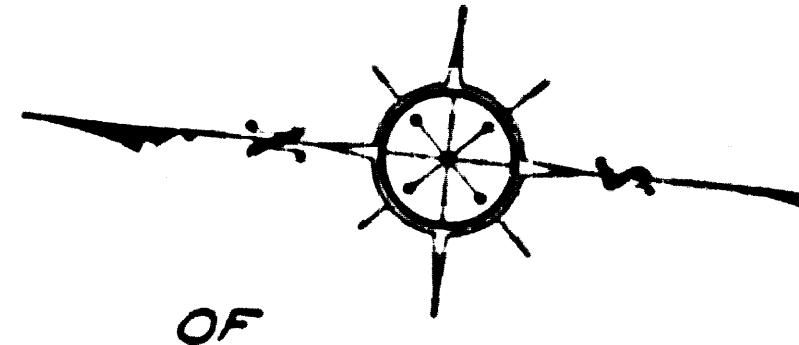
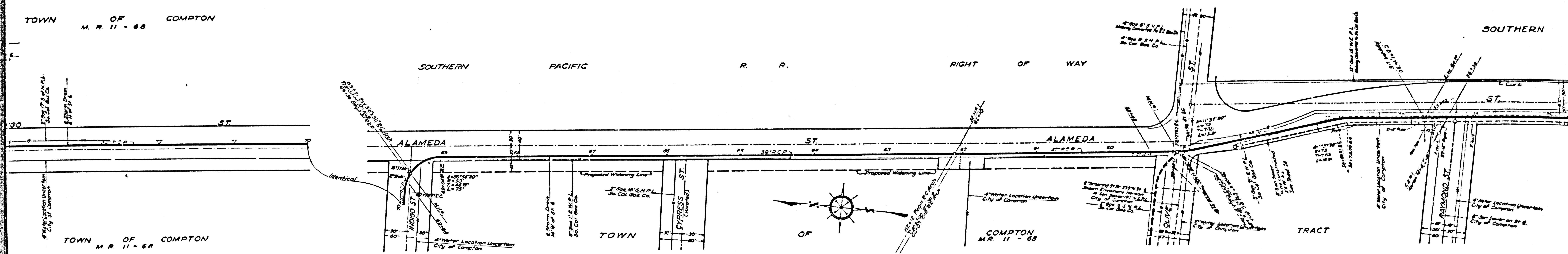

CSB-1171-17  
A7 OF A8

COPY TO 2184E1002 PWS NO B-111

Trim prints to this line

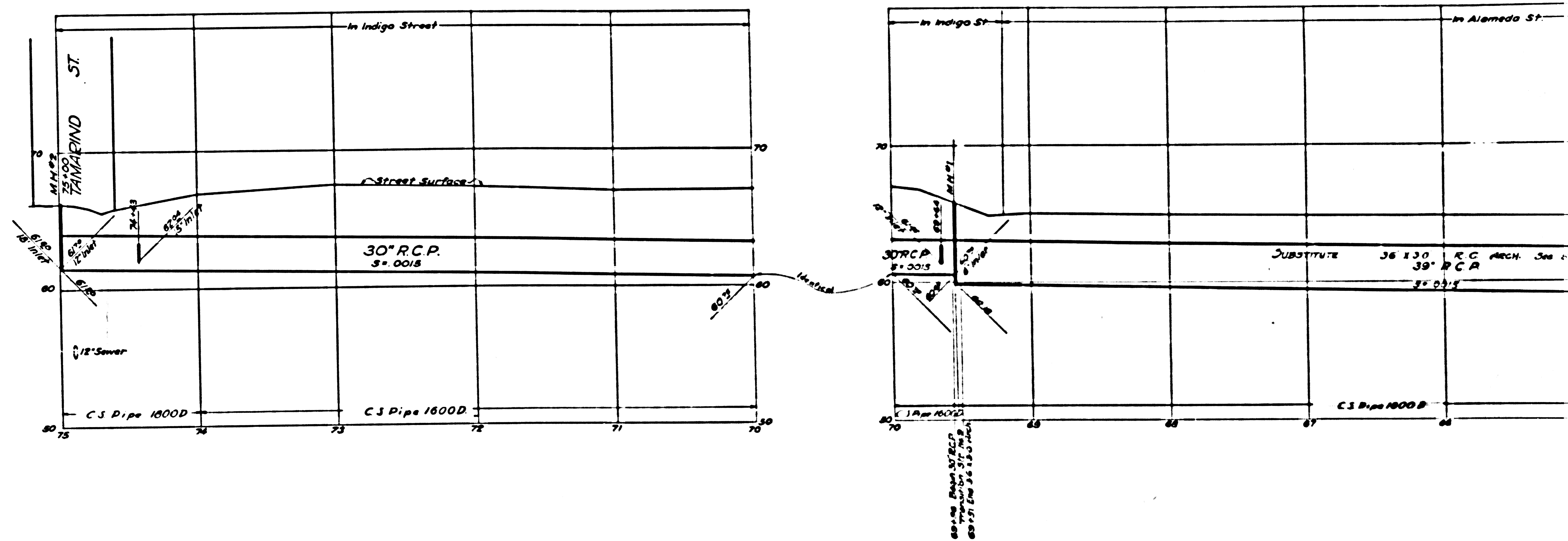

INDEX  
 Lines Shown on this Sheet  
 Reading from Left to Right  
 PLAN AND PROFILE  
 ALAMEDA STREET LINE  
 TAMARIND STREET BRANCH

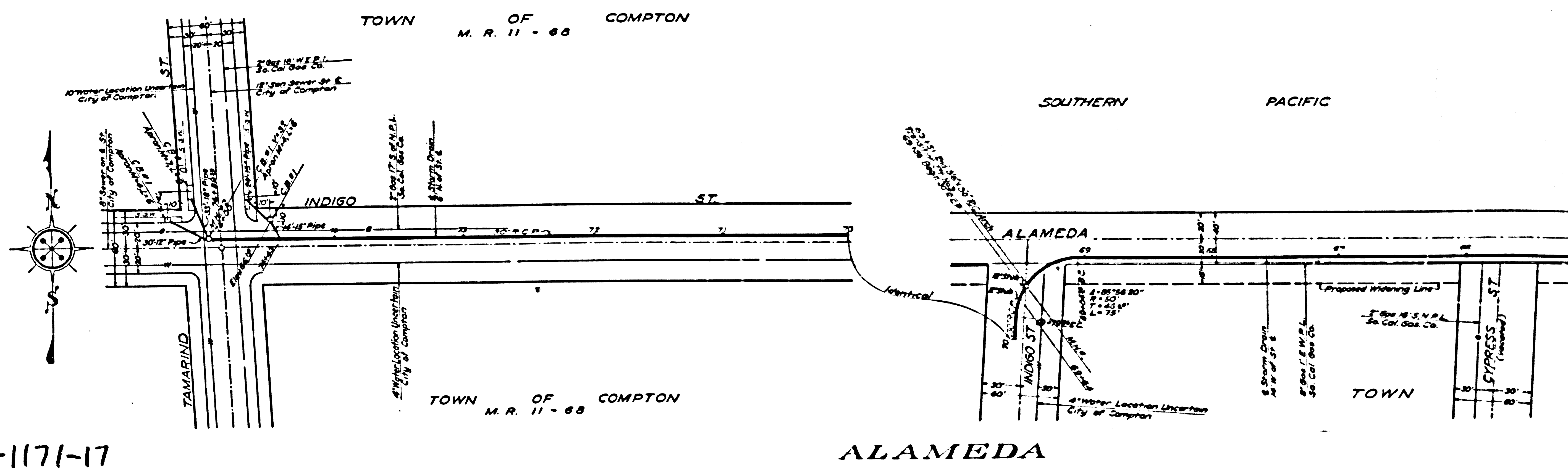

CSB-1171-17  
 A8 OF A8

Trim prints to this line

SEE LISTING 1101.58 SHEET 2

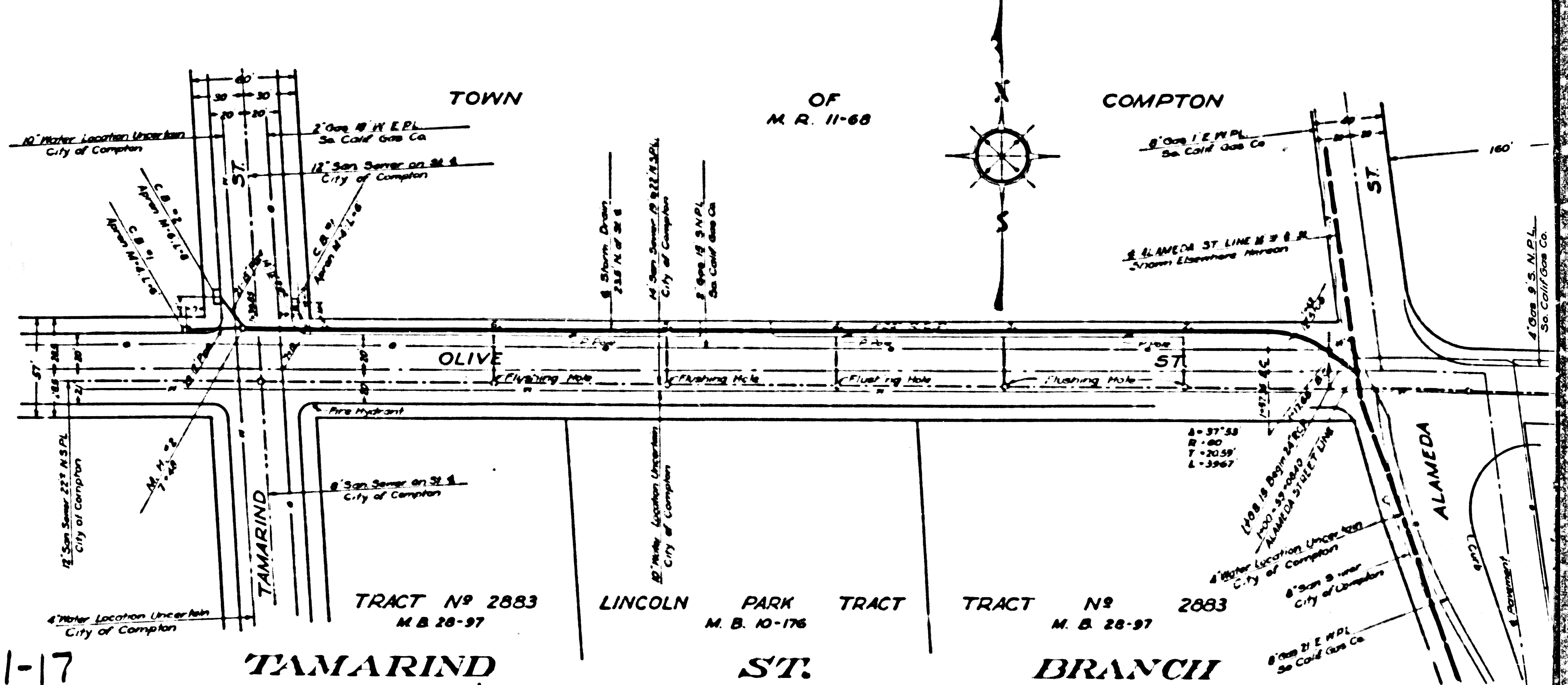
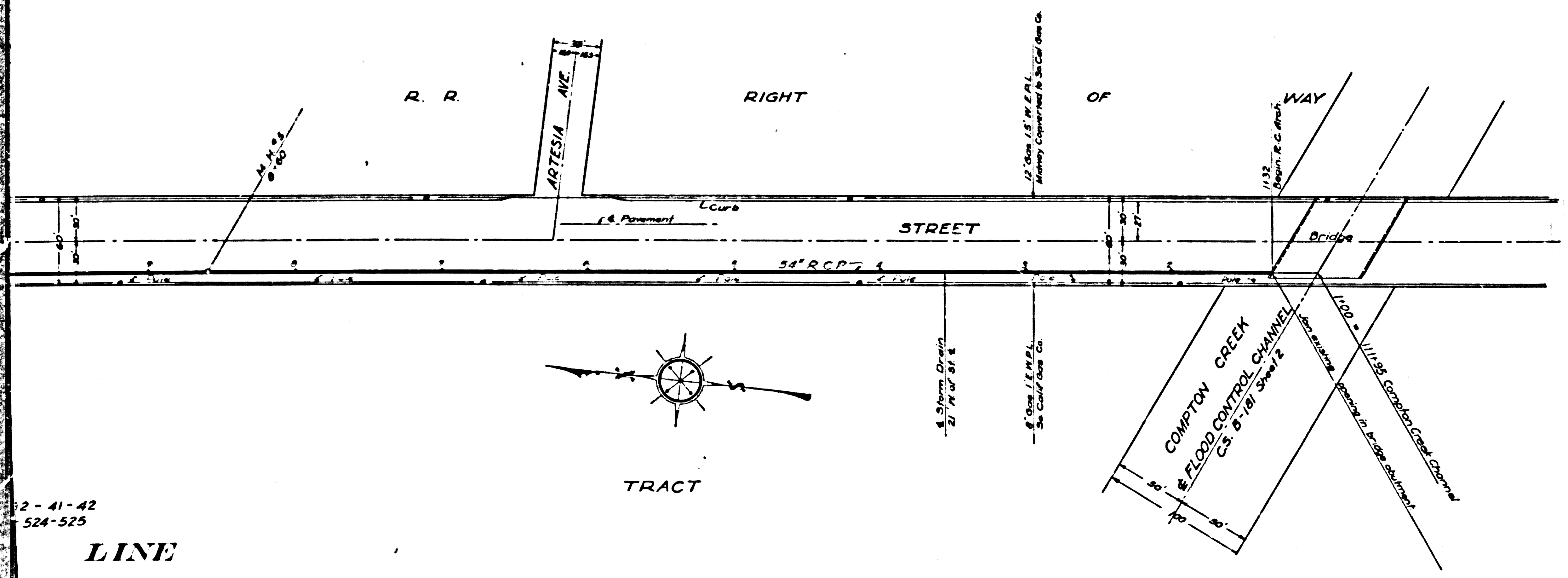
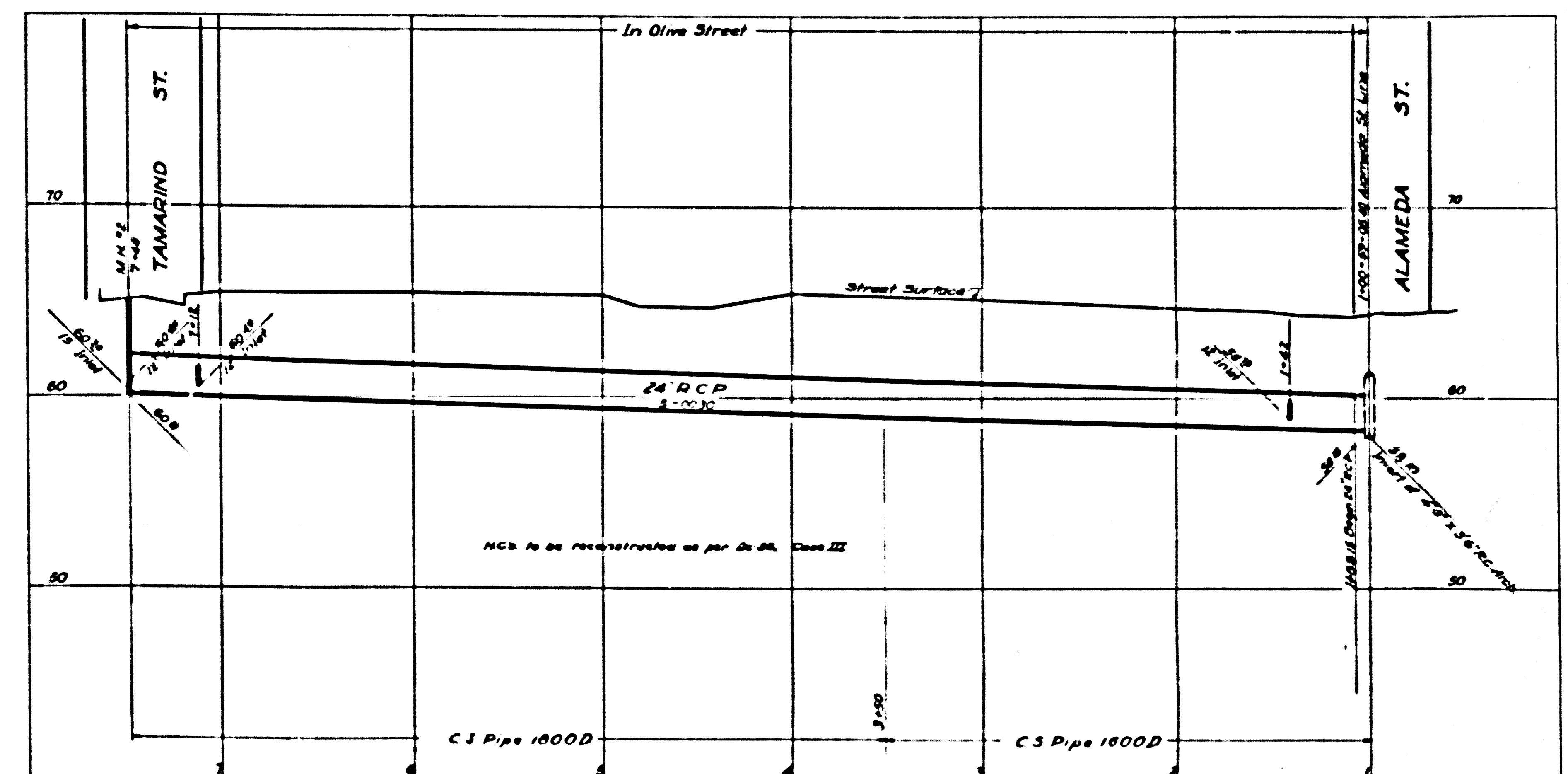
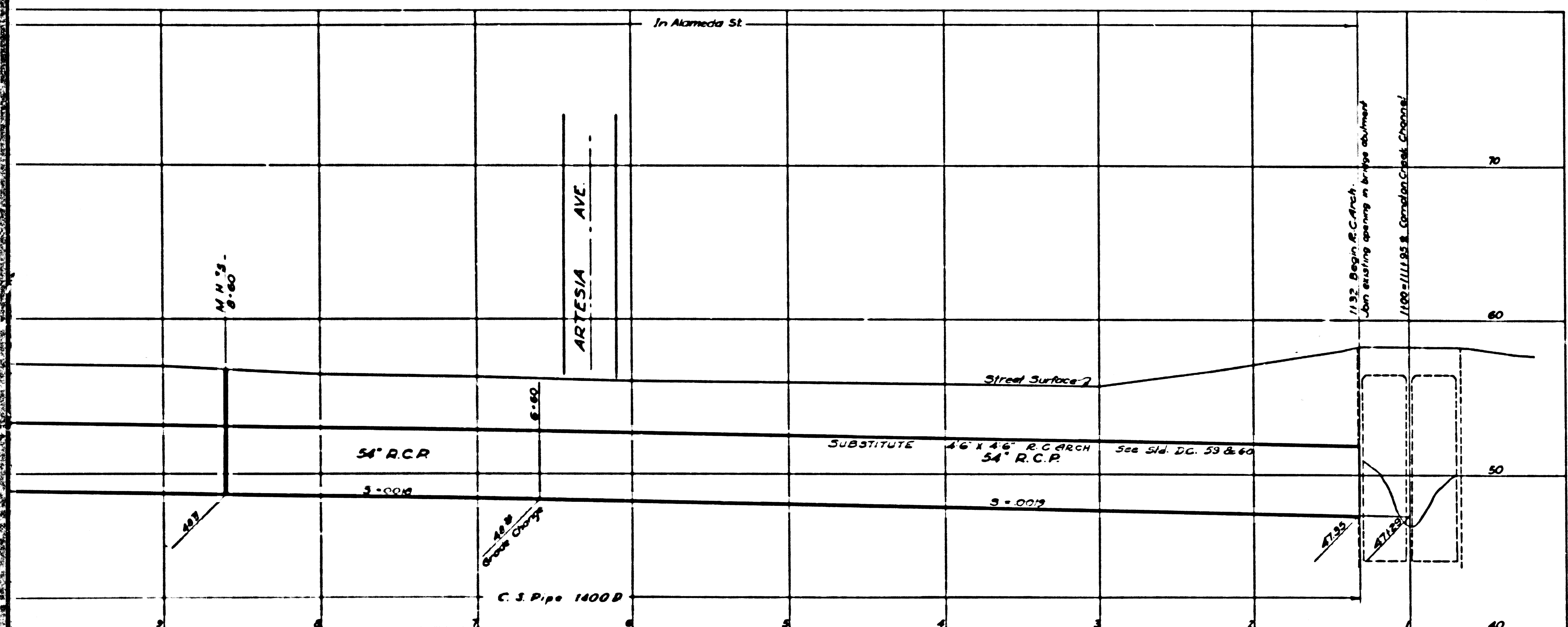

2-41-42  
524-525

LINE

CSB-1171-17  
A2 OF A8

TAMARIND

ST.

BRANCH

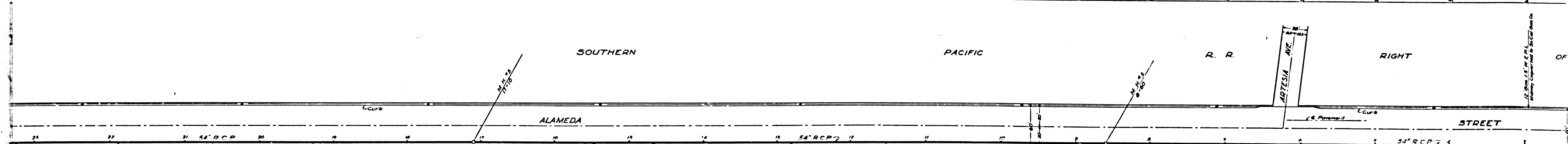
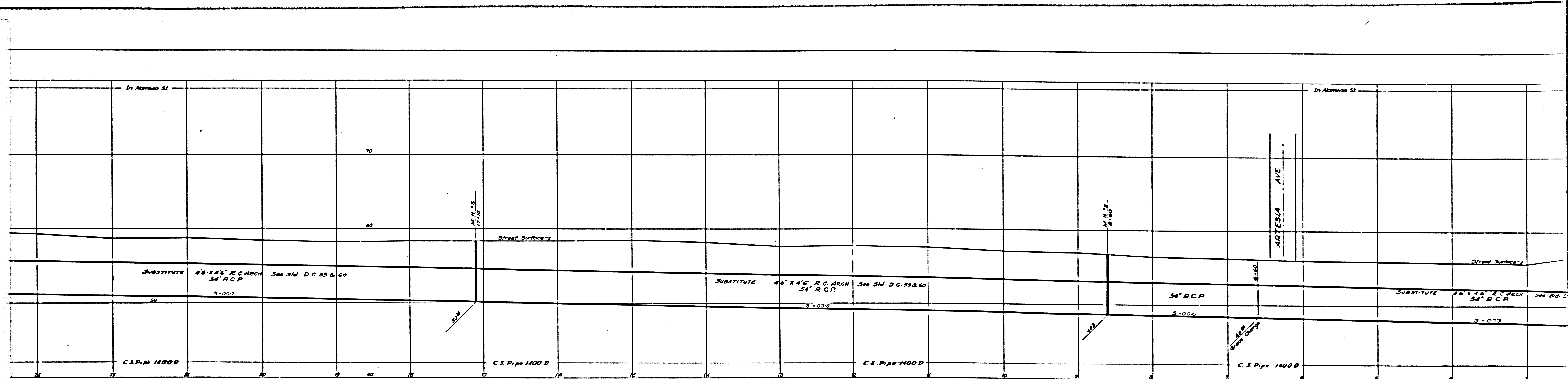

TRACT HELLMAN TRACT

STREET

M. R. 32 - 41 - 42  
M. R. 2 - 524 - 525

CSB-1171-17  
A3 OF A8

LINE

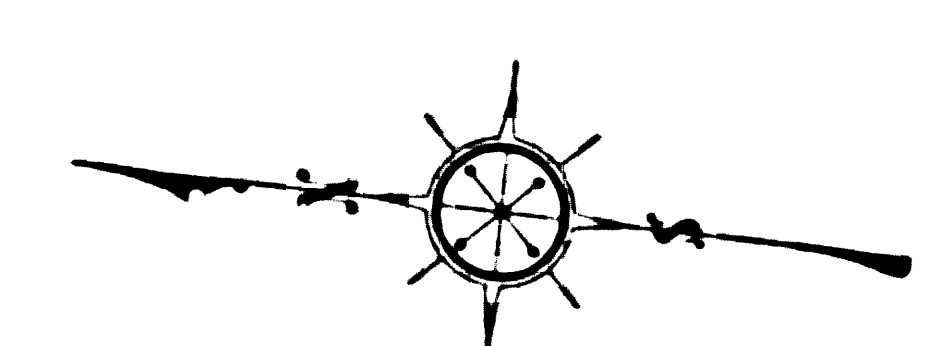

17. Street, L.S. of C.P. & M. Co.  
 18. Street, L.S. of C.P. & M. Co.  
 19. Street, L.S. of C.P. & M. Co.  
 20. Street, L.S. of C.P. & M. Co.

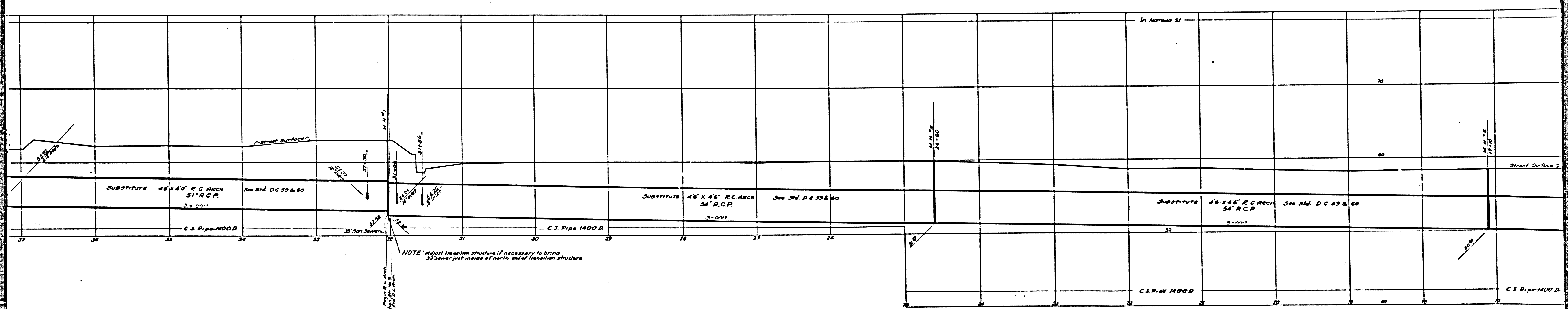

NOTE: Adjust transition structure if necessary to bring  
33 sewer just inside of north end of transition structure

RIGHT OF WAY

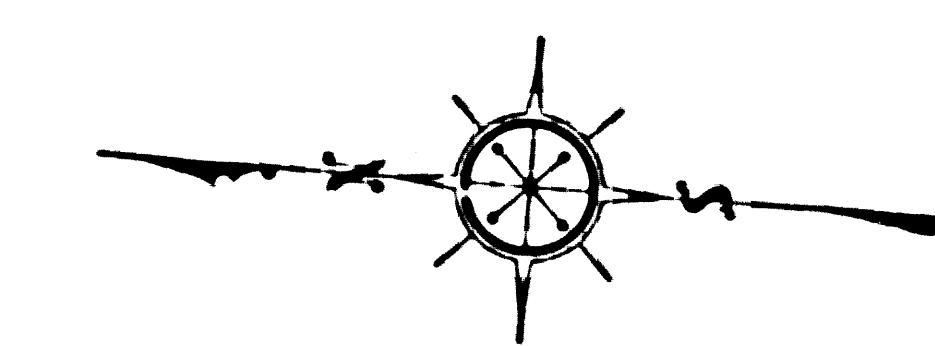
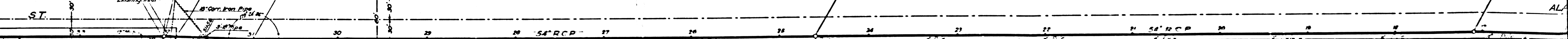

San Sewer - M.B. 4  
City of Compton

TAFTON ACRES  
M. B. 14-154-155

HELLMAN  
ALAMEDA

M.R. 32-41-42  
M.R. 2-524-525

TRACT

STREET

CSB-1171-17  
A4 OF A8