

CONTINUED FROM SHEET "9"

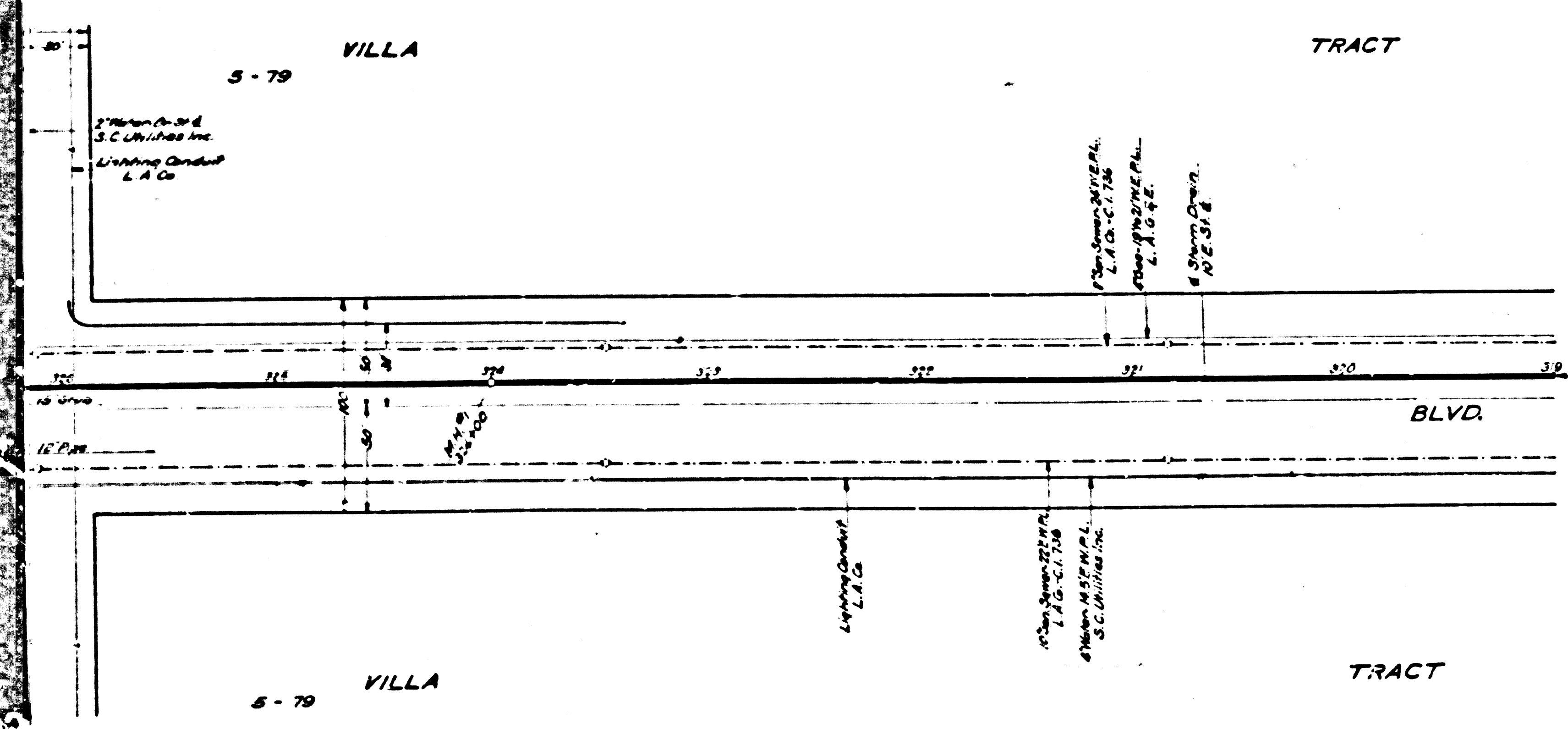

Section F
Corrected as Constructed
September 1941
A.T. Hirschard

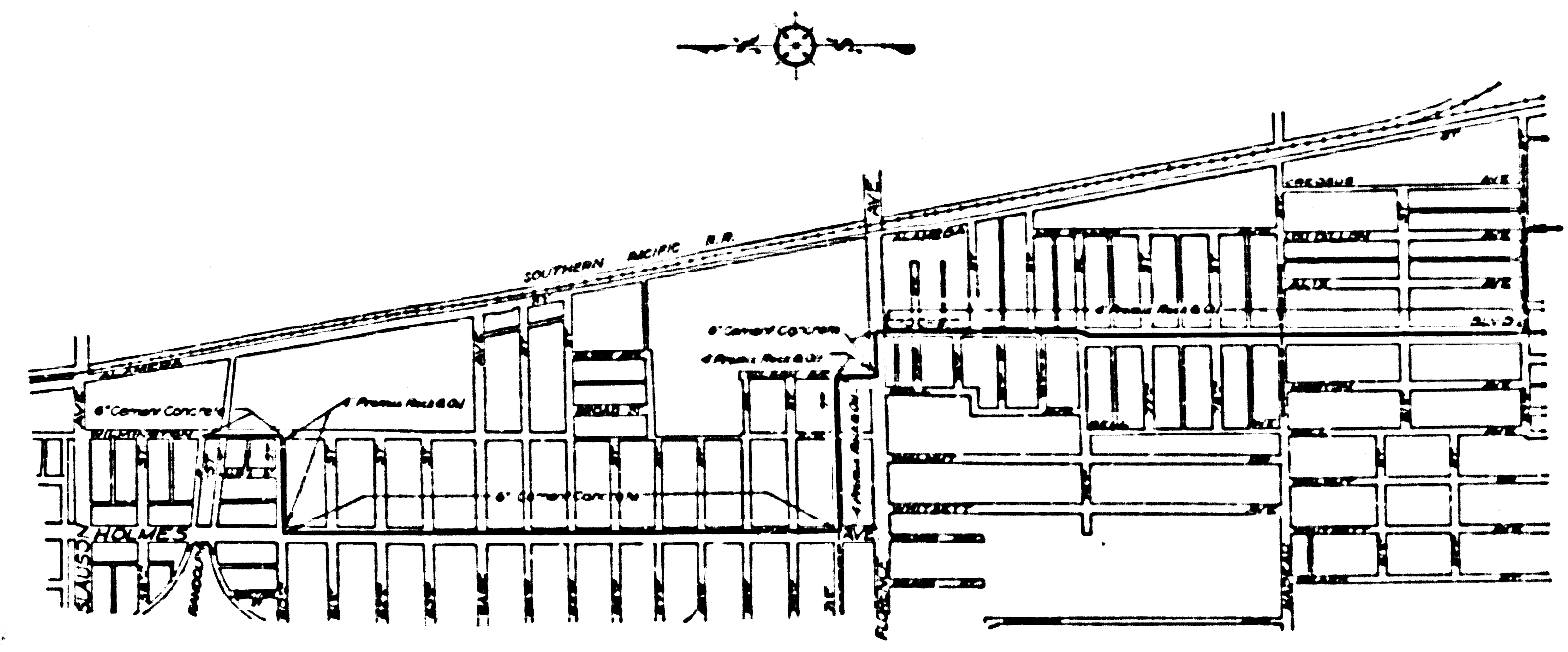

KEY MAP
SHOWING DOWNS AND RESURFACING

NOTES:

Elevations are in feet above USGS or mean Sea Level Datum.

Stations of inlets and junctions refer to the intersections of the center lines of the inlets with the center line of the main drain.

Elevations of all inlets except catch basin inlets into box sections refer to the flow lines of the inlets produced on their gradients; to the vertical plane thru the center line of the main drain. Elevations of catch basin inlets into box sections refer to the intersections of the flow lines of these inlets with the inside wall of the box section.

For details of all standard structures see standard plans.

All pipe not otherwise specified shall be plain cement pipe.

All stubs to be one length of pipe with ends sealed with 2" red wood planking, unless otherwise specified.

Catch basins shall be built with a curb face of 12" or more which shall include a minimum depression of opening of 4" below gutter grade, unless otherwise specified.

Sanitary sewers crossing storm drains, shown in profile with less than 1 1/2 feet clearance, are to be encased as per Sp-6 for a length equal to the width of conduit trench. In addition if less than 12" clearance sewers must be of cast iron pipe and encased as noted above.
Corrected as Constructed September 1941 A. T. Hirschard

GLEN AVENUE
DRAINAGE SYSTEM
OF THE COUNTY OF LOS ANGELES, CALIFORNIA
PLAN AND PROFILE OF

GLEN AVE. TRUNK
STA. 423+40 TO STA. 310+00

SHEET 2 OF 26 SHEETS

NOVEMBER 1935
ALFRED JONES COUNTY SURVEYOR
RECOMMENDED [Signature] APPROVED [Signature]

REFERENCE	DESIGNED	DATE
P. B. 475	L. Longac-W	OCT 1934
L. B. 678	TRACED P. I. Hunsstock	MAY 1933
	CHECKED E. E. Mitchell	NOV 1933

CSB-1171-2
A1 OF A8

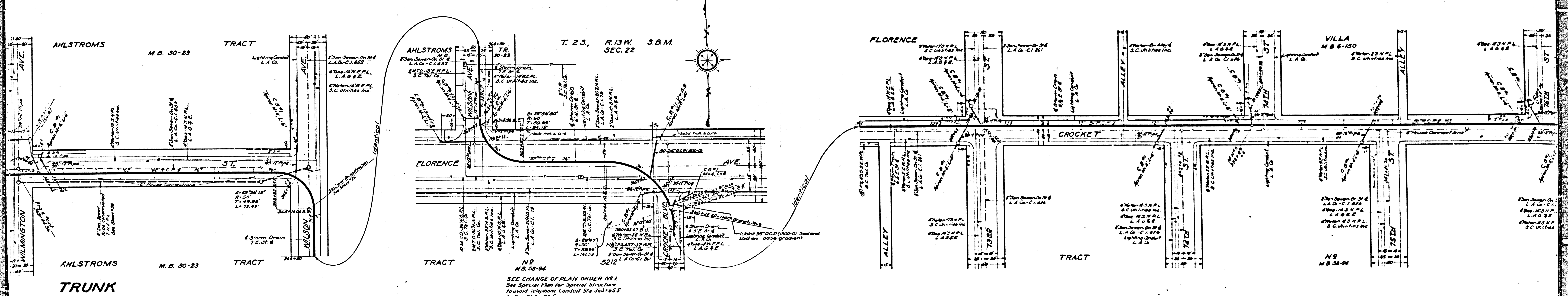
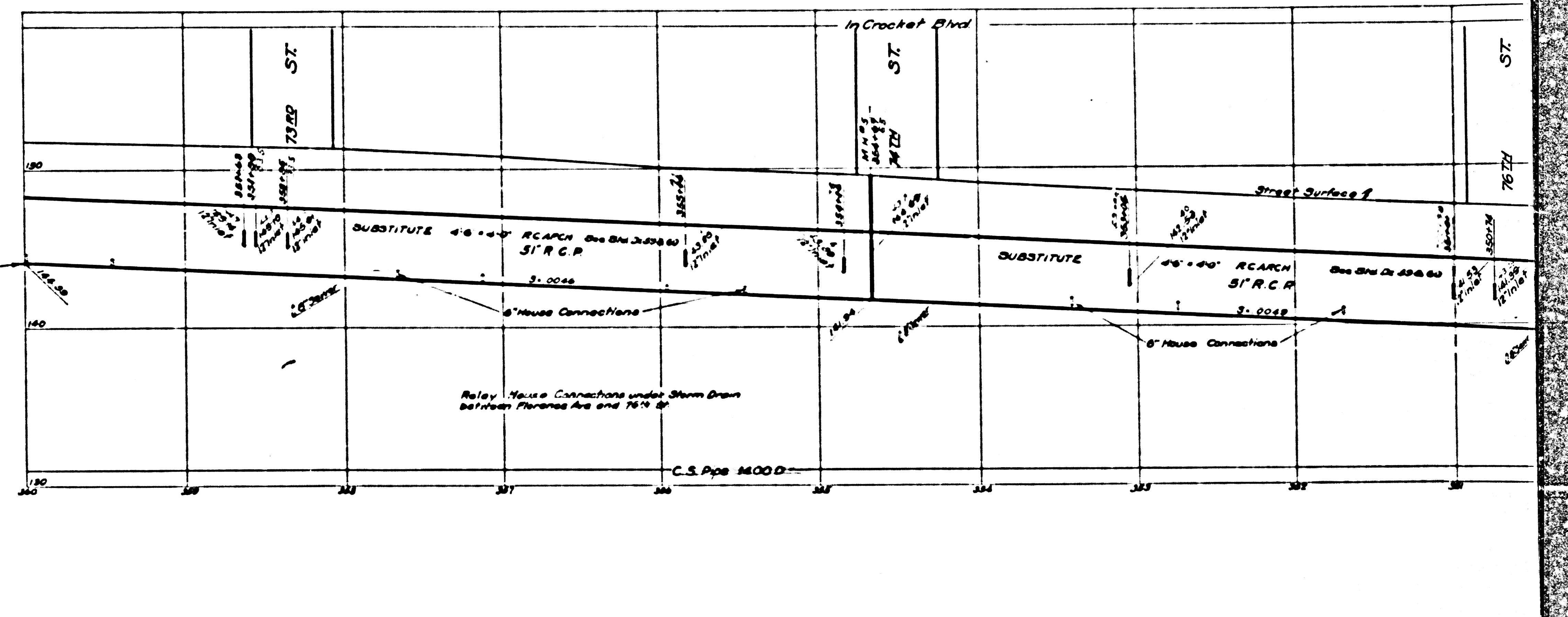
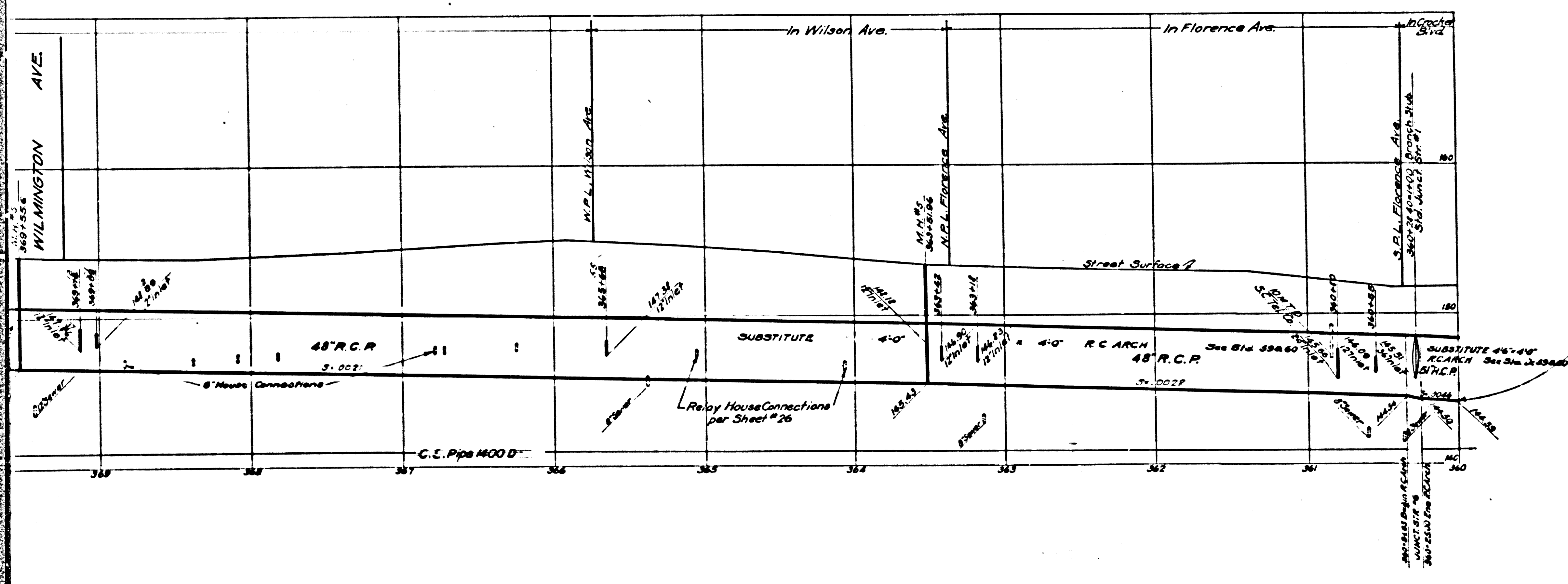

CSB-1171-2
A4-0FA8

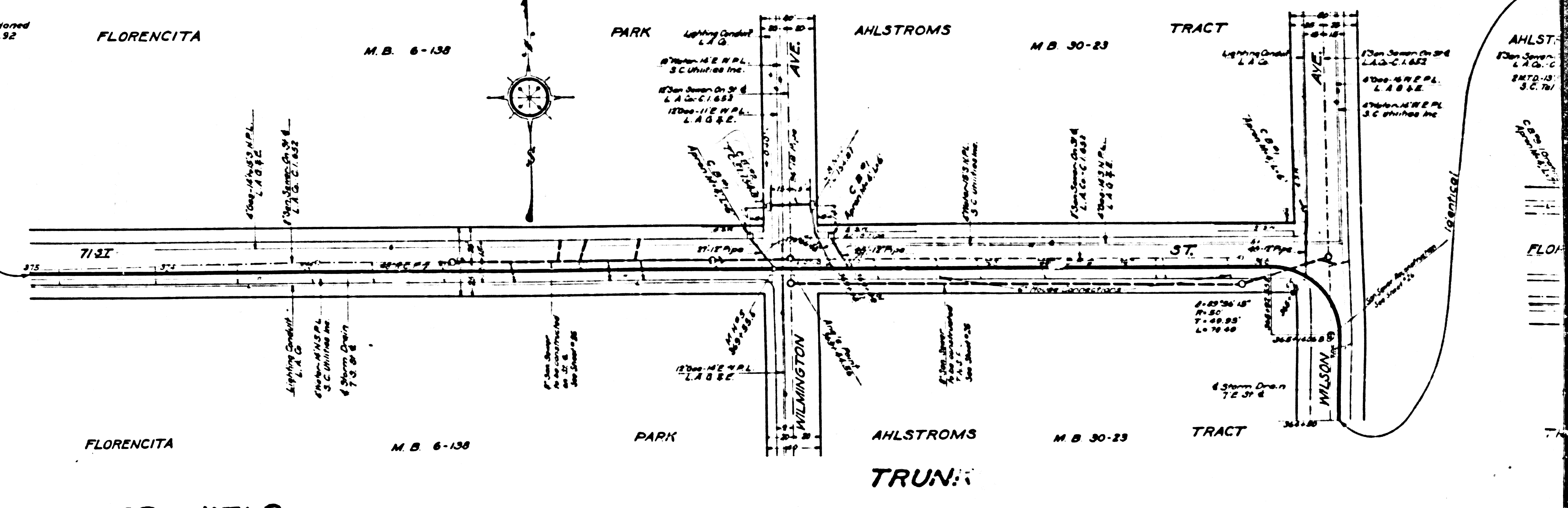
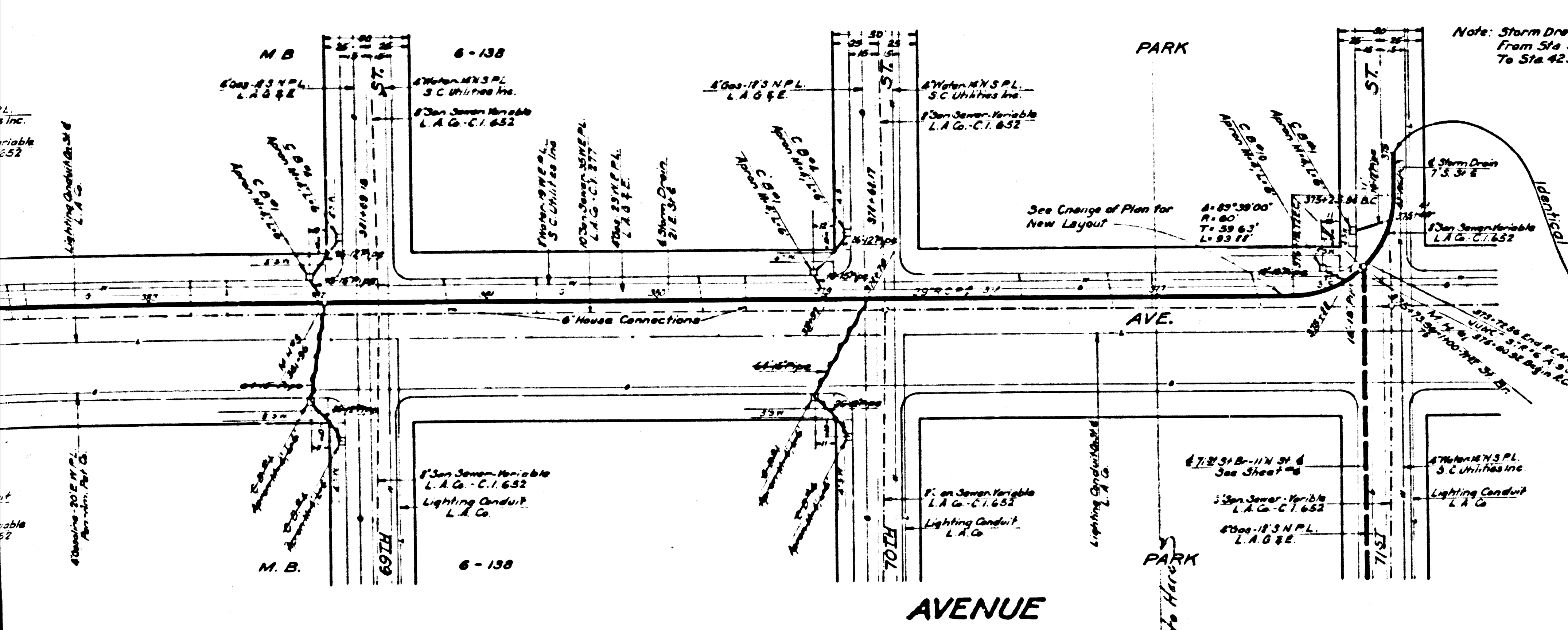
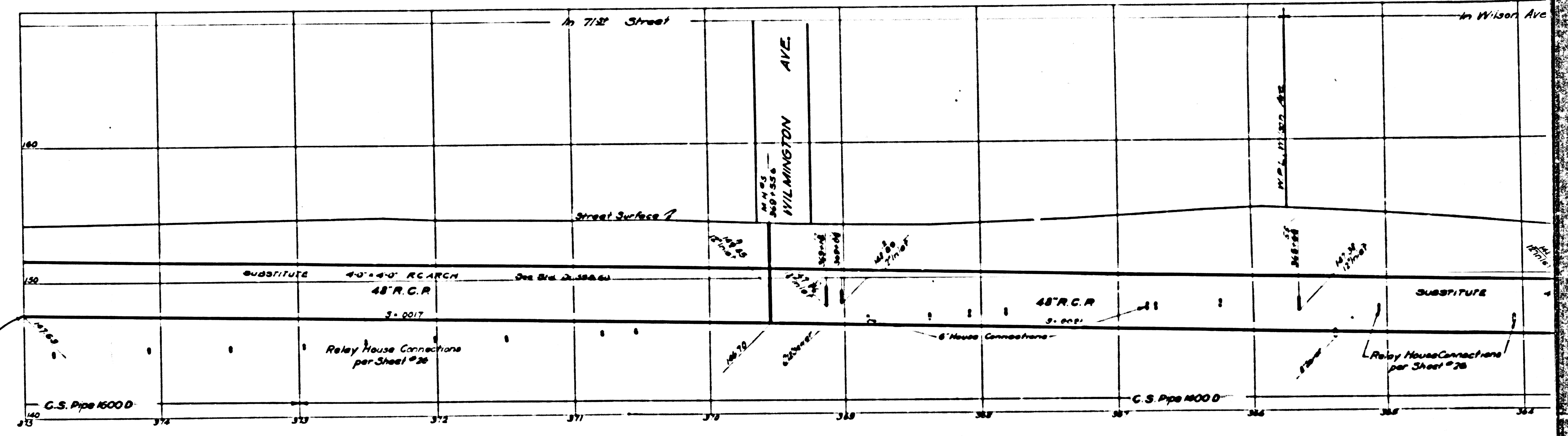
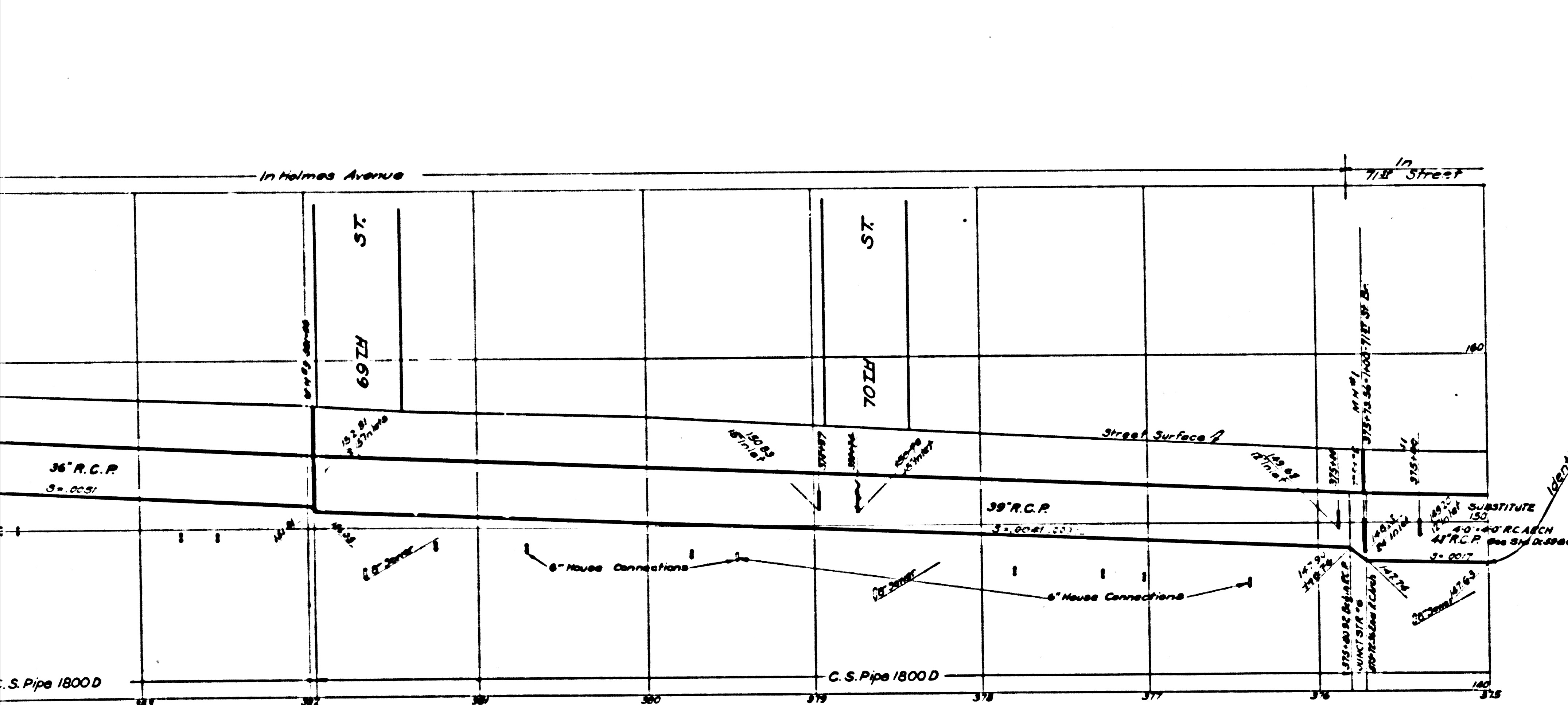

CSB-1171-2
A50FA8

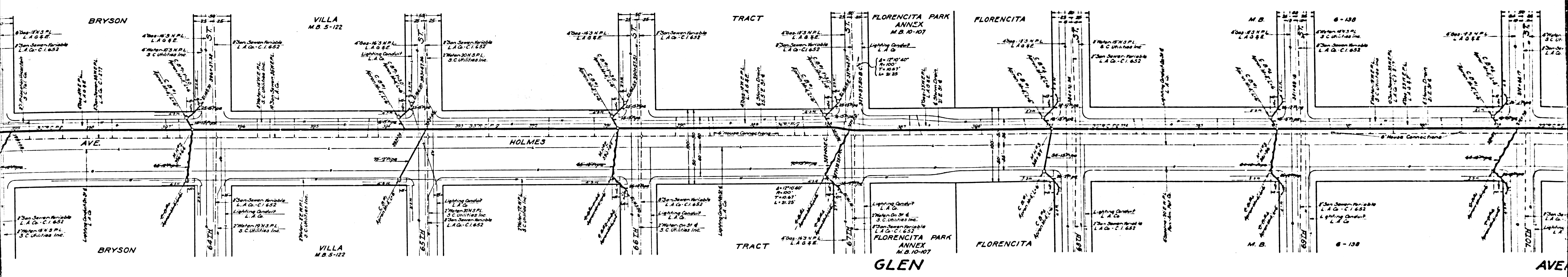
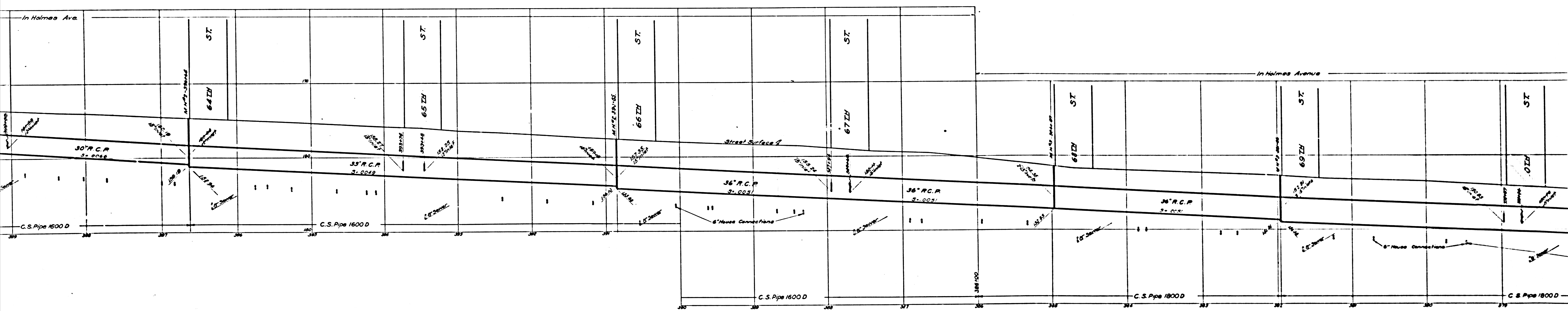

CSB-1171-2
AG0FA8

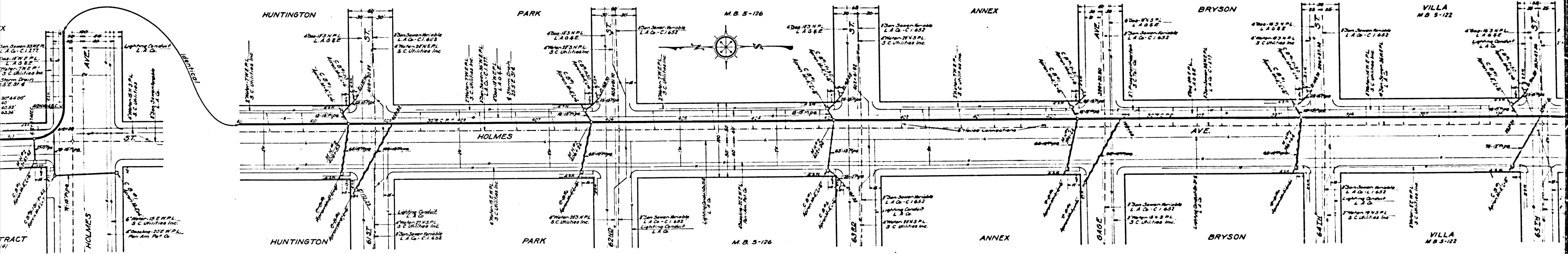
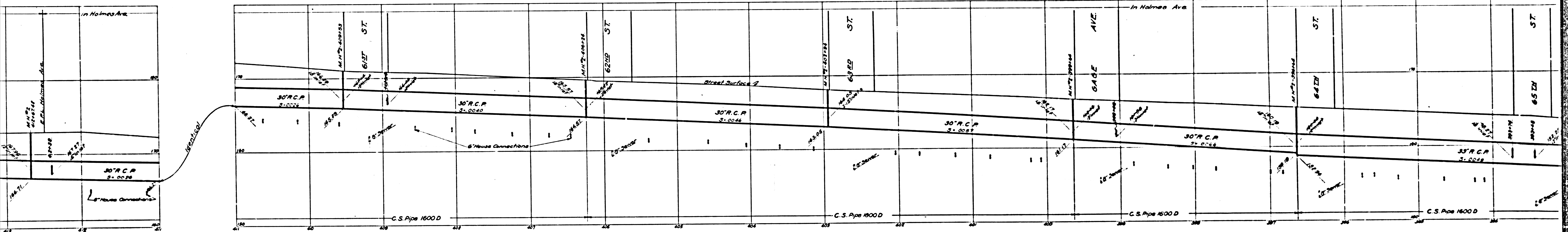

CSB-1171-2
A TO FAB

North 3 feet

INDEX
 Lines shown on this sheet
 Reading from left to right
 PLAN AND PROFILE
 GLEN AVE. TRUNK

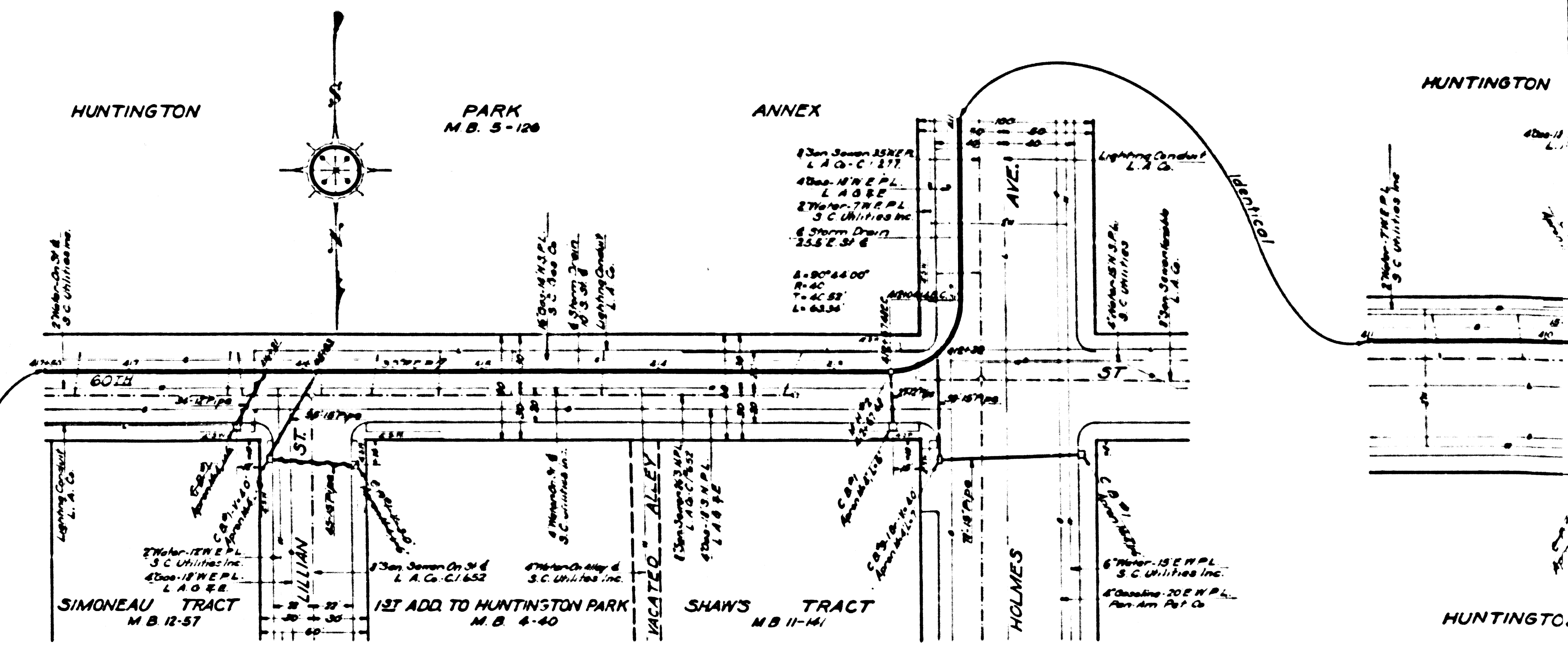
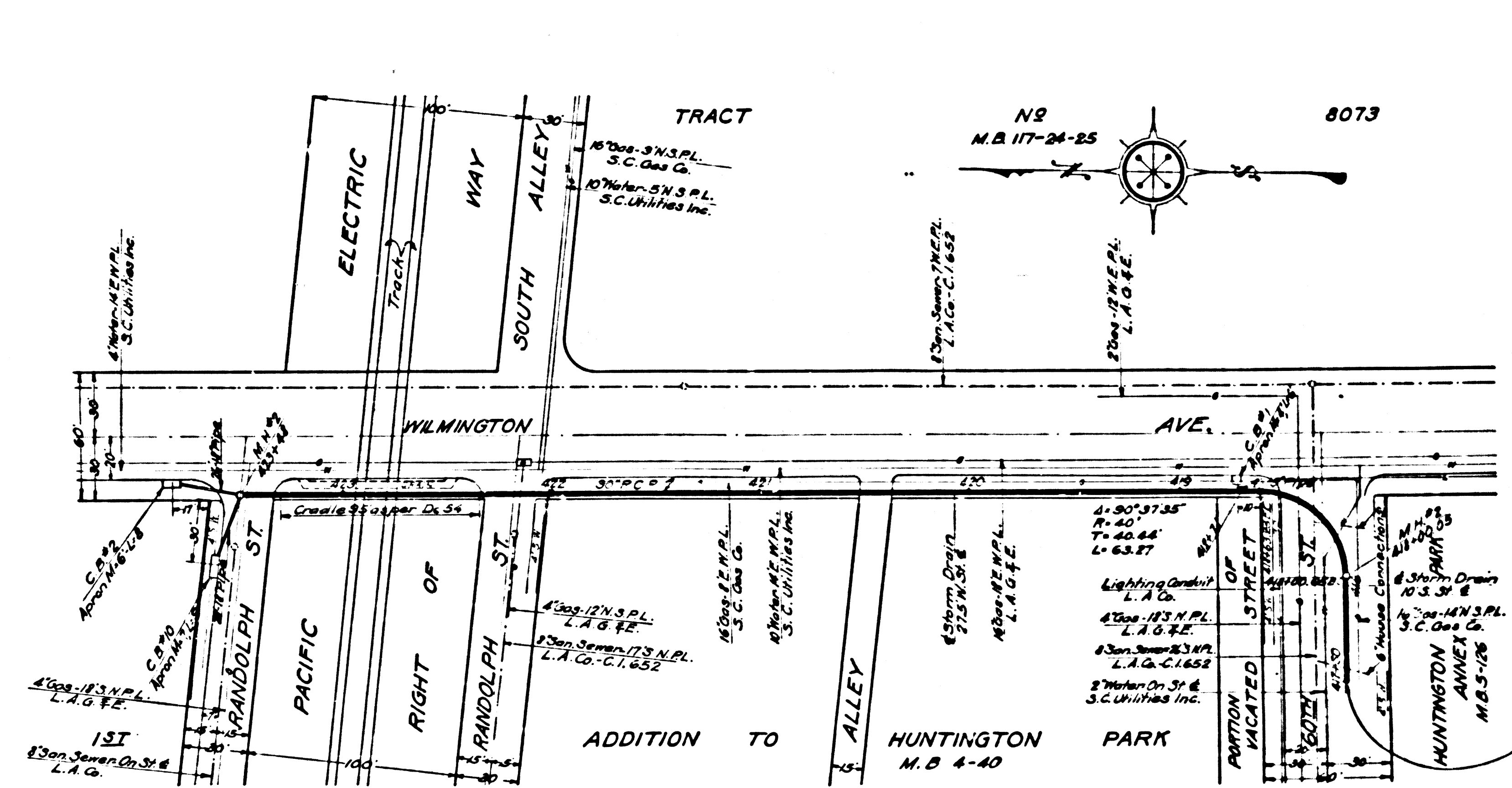
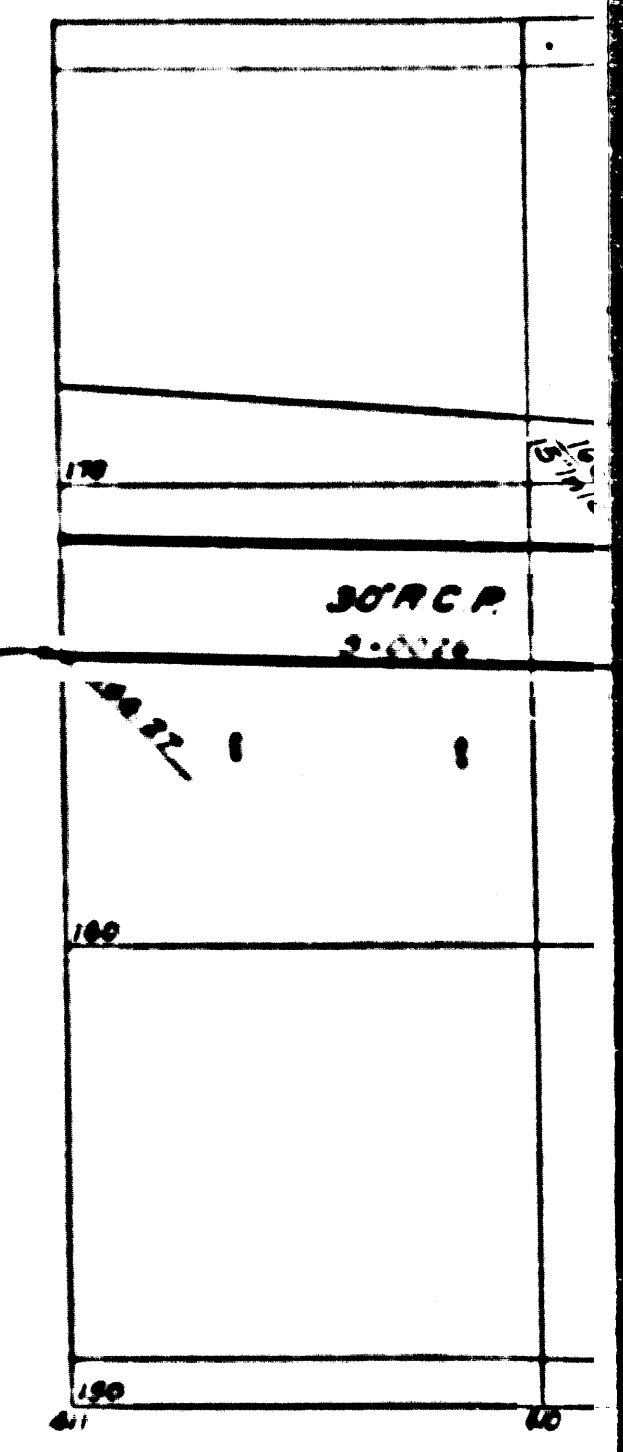
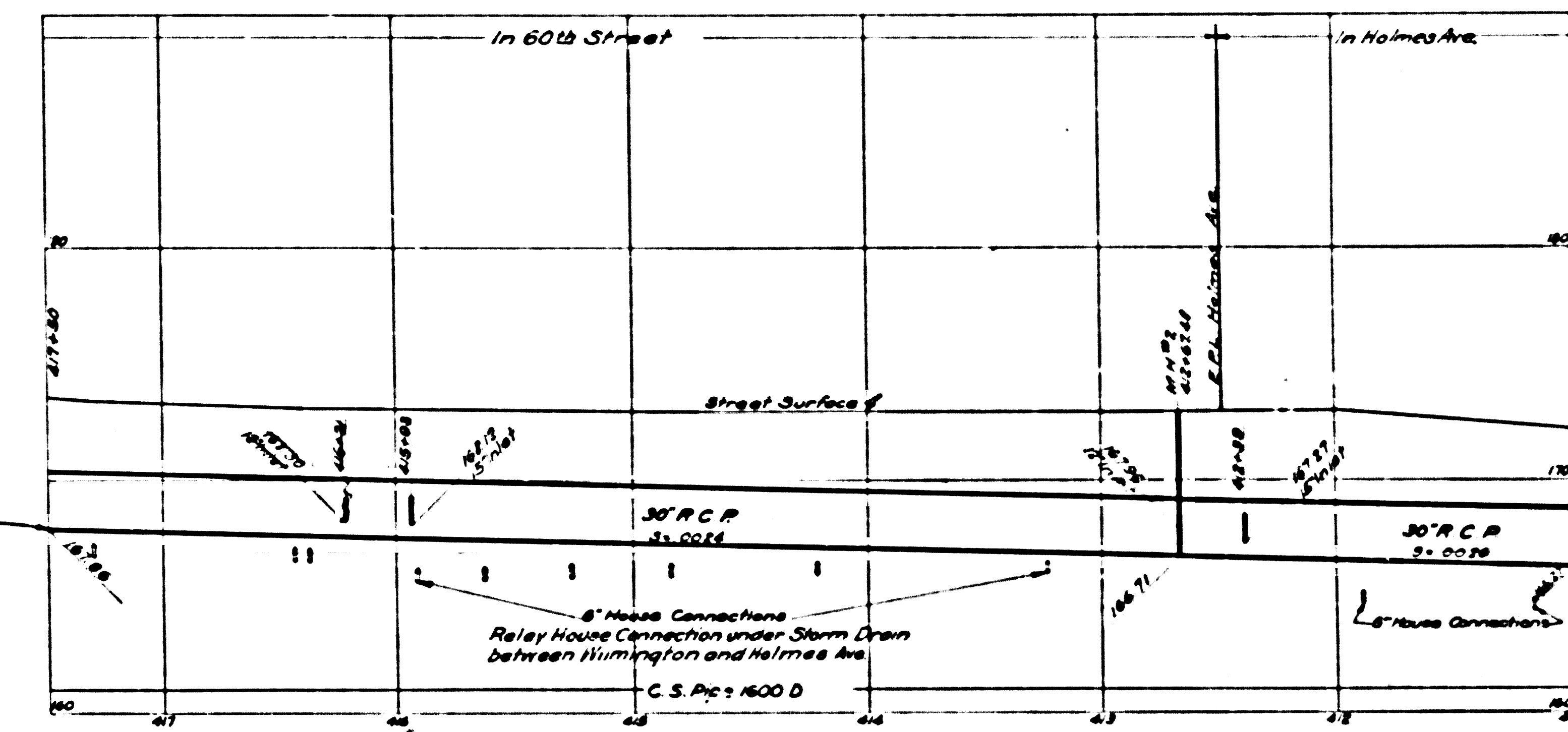
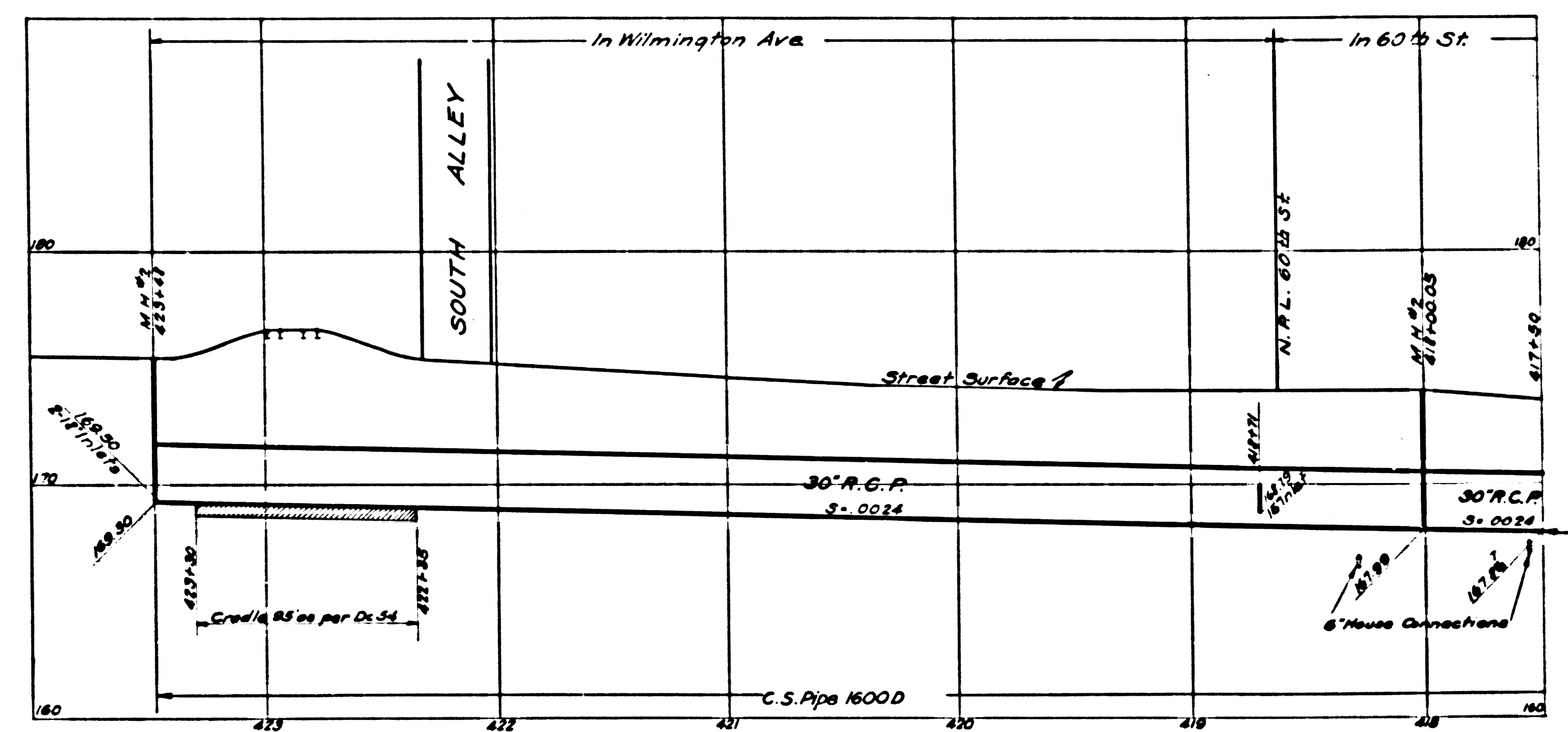

CSB-1171-2
 A8 OF A8

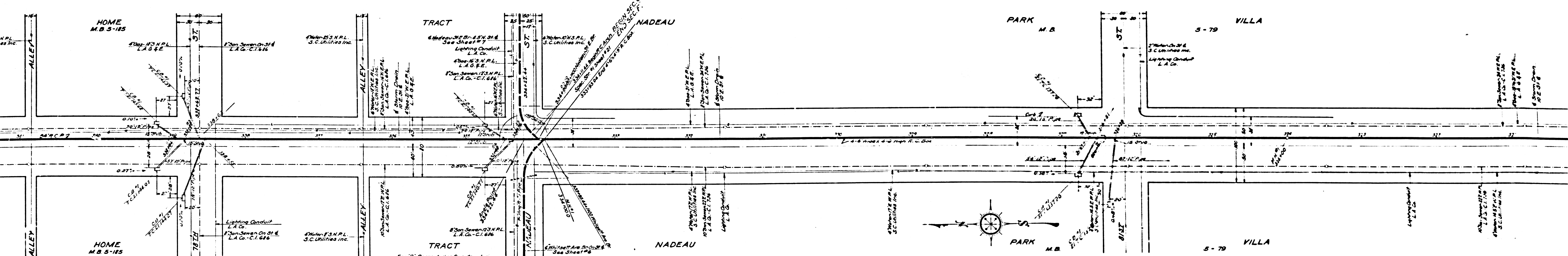
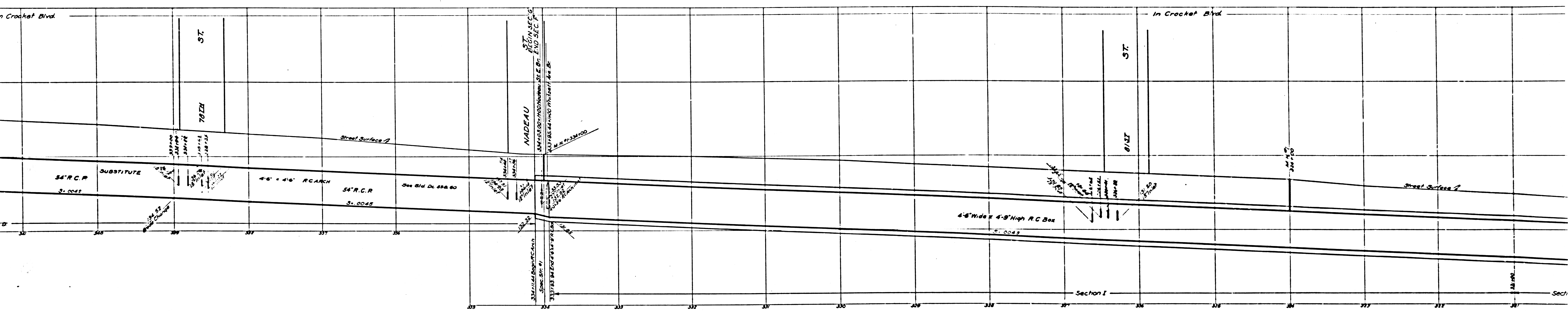

Sec. 6 Corrected as Constructed
September 1941 A7. Hincosa

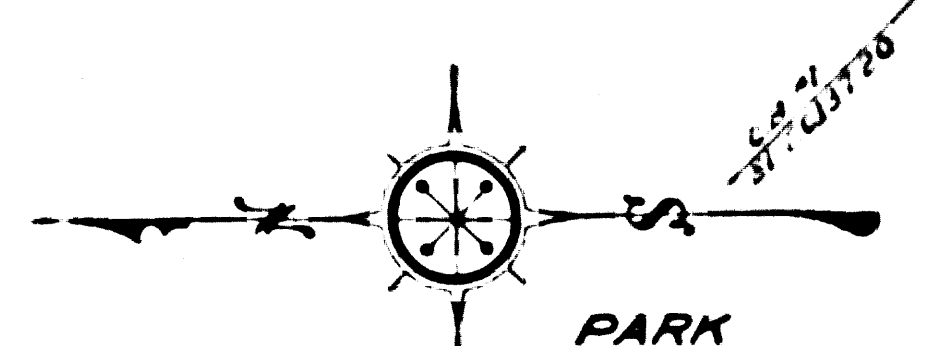

CSB-1171-2
A20FA8




CSB-1171-2
A30FA8

Sec G Corrs
September 1911