

Trim Prints

# GLEN AVENUE DRAINAGE SYSTEM

23

PROFILE, ALIGNMENT AND GRADE OF  
**SANITARY SEWERS**  
 TO BE CONSTRUCTED IN  
**WILMINGTON AVENUE**  
 BETWEEN SLY. LINE TR No. 4472 M. B. 48, 69 AND 124TH. ST.  
 120TH. ST. EAST OF WILMINGTON AVE. & 120TH. ST. WEST OF WILMINGTON AVE.  
**WILLOWBROOK AVENUE**  
 BETWEEN GREENLEAF DR. AND COMPTON BLVD.  
 AND IN PORTIONS OF  
 124TH. ST. COMPTON BLVD.  
 WILLOWBROOK AVE. OLIVE ST.

SCALE: VERT. 1"=40'  
 HORIZ. 1"=40'  
 DEC 1935

SHEET 23 OF 26 SHEETS

COUNTY OF LOS ANGELES, CALIFORNIA  
 ALFRED JONES COUNTY SURVEYOR

RECOMMENDED *E. J. ...* CHIEF DEPUTY  
 APPROVED *Alfred Jones* COUNTY SURVEYOR  
 APPROVED *R. ...* CHIEF ENGINEER OF COUNTY SANITATION DISTRICT NO. 1

FOR LEGEND  
 SEE PLAN NO. S-9-94

NOTES:  
 GRADES TO WHICH THIS IMPROVEMENT IS TO BE CONSTRUCTED ARE SHOWN ON PLANS AND PROFILES.  
 GRADE POINTS FOR TOP OF CURB, CENTER LINE OF STREET OR CENTER LINE OF ALLEY ARE SHOWN BY  
 CIRCLES ON PROFILES. AT ALL POINTS BETWEEN DESIGNATED POINTS THE GRADE SHALL BE ESTABLISHED  
 SO AS TO CONFORM TO A STRAIGHT LINE DRAWN BETWEEN SAID DESIGNATED POINTS.  
 ELEVATIONS ARE IN FEET ABOVE U. S. G. S. DATUM OR MEAN SEA LEVEL.  
 UNIT PRICES FOR ADDITIONAL WORK WHICH MAY BE REQUIRED BUT WHICH CANNOT BE ASCERTAINED  
 IN ADVANCE SHALL BE SUBMITTED IN THE PROPOSAL.  
 THIS DRAWING AND THE DATA HEREON ARE HEREBY MADE A PART OF THE SPECIFICATIONS.

REFERENCES			
W. S. 26	DESIGNED	BEMIS	OCT. 1935
A. B.	TRACED	BLACKMER	OCT. 1935
L. B. 462-146	CHECKED	KUENZEL	DEC. 1935

### NOTES

1. USE WESTON'S GASKETS AND FORMS FOR ALL PIPE JOINTS.
2. USE "D & D" SAFETY AND NOISELESS MANHOLE FRAMES AND COVERS. - NOTE - THE WORD "COUNTY" SHALL BE OMITTED FROM ALL COVERS TO BE INSTALLED WITHIN THE CITY OF COMPTON.
3. USE STANDARD STRENGTH PIPE EXCEPT AS NOTED.
4. RESURFACE ALL TRENCH WITHIN PAVED AREA WITH PREMIX ROCK AND OIL EXCEPT AS NOTED.
5. CONSTRUCT HOUSE CONNECTIONS AS PER STANDARD SPECIFICATIONS EXCEPT AS NOTED.
6. RECONNECT EXISTING HOUSE SERVICES.

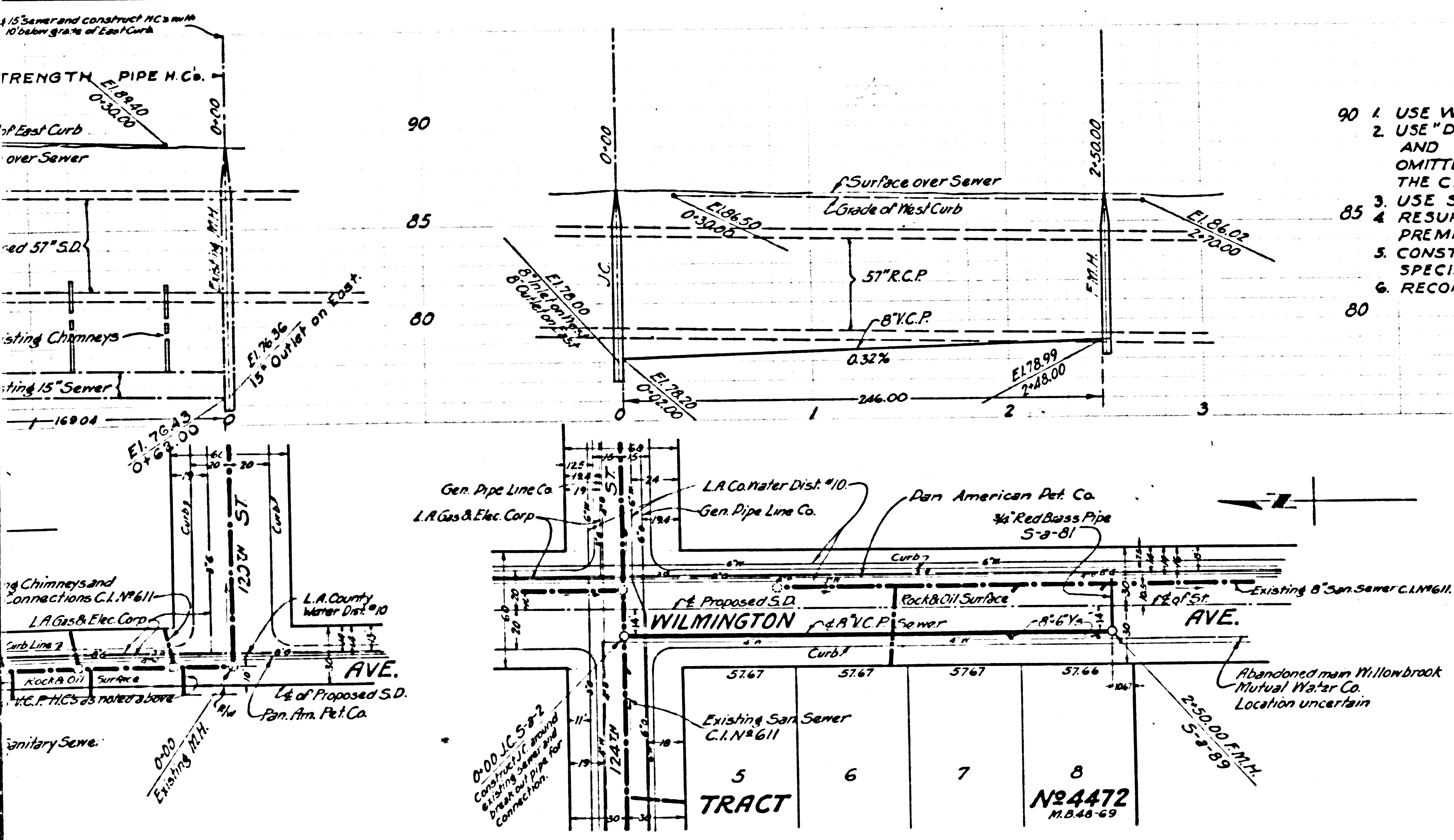

Corrected as Constructed August 1941  
 A. T. Mincaid  
 CSB-1171-23  
 A1 OF A6  
 Trim Prints

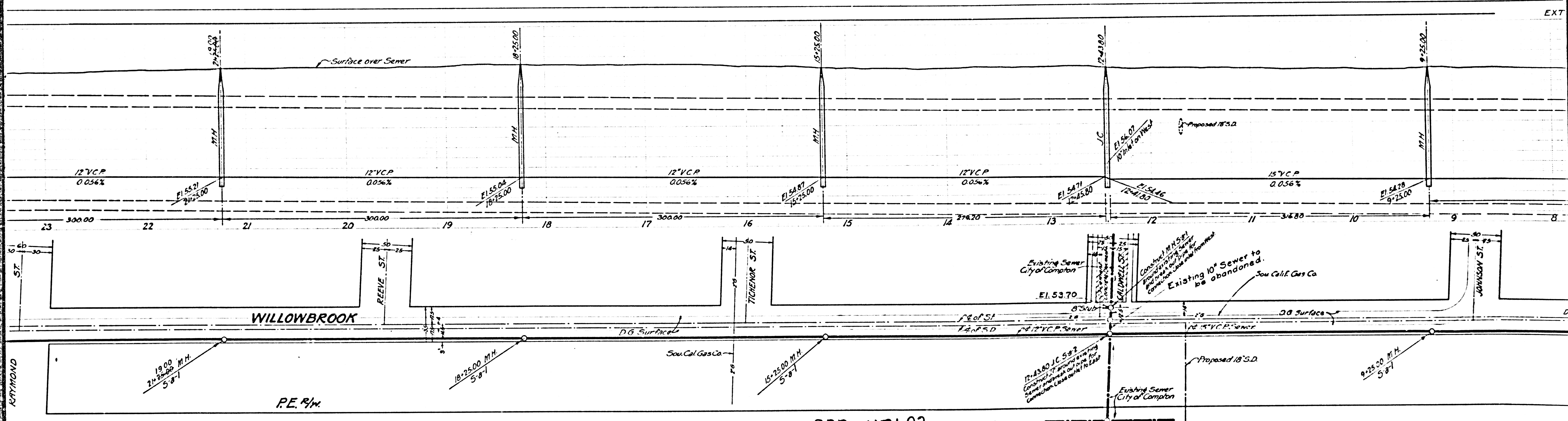

CSB-1171-23  
 A3 OF A6

LB 678112  
 LB 8191106

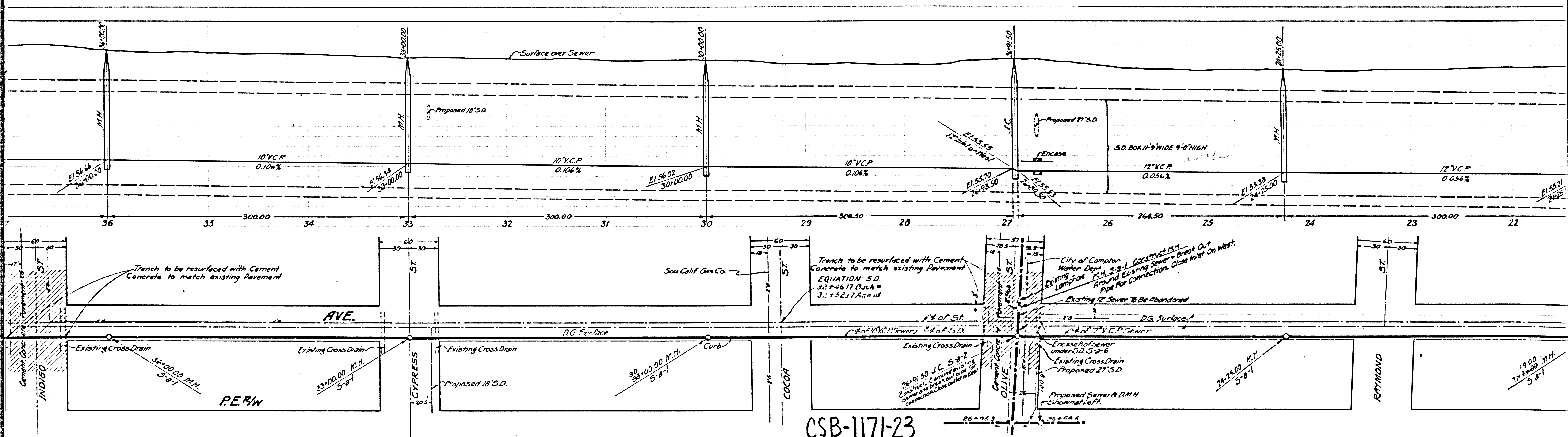

CSB-1171-23

A4 OF A6

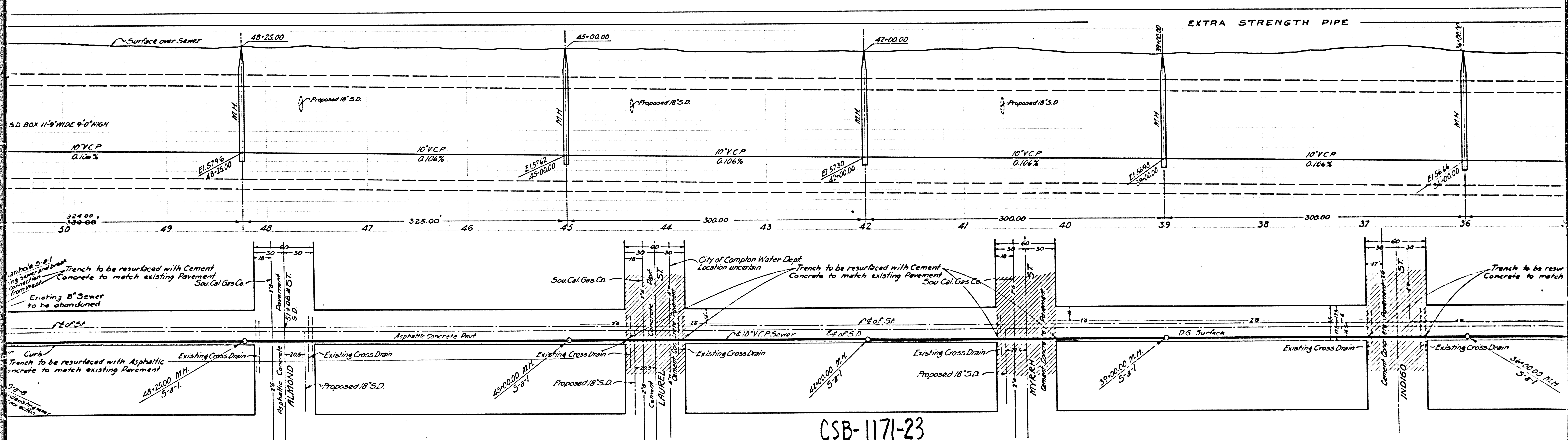

EXTRA STRENGTH PIPE

CSB-1171-23  
A5 OF A6

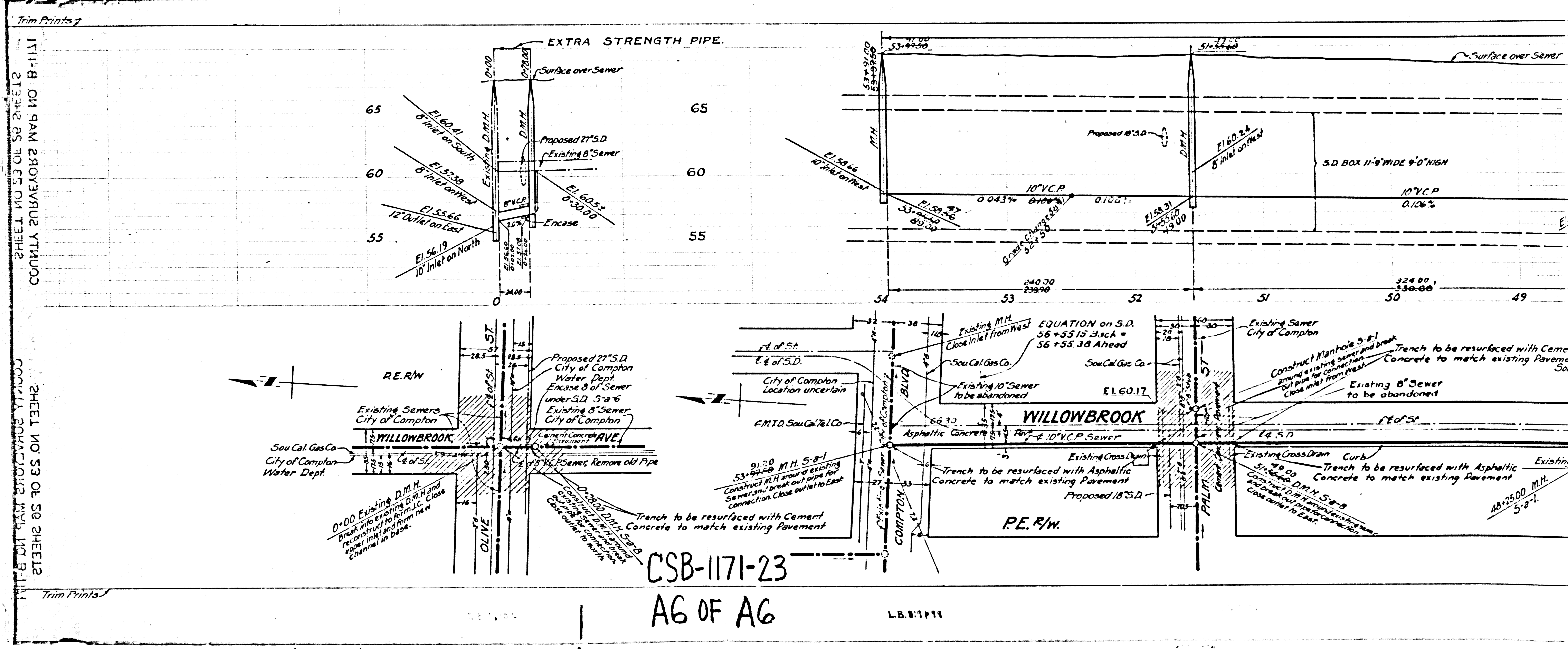

SHEET NO. 53 OF 58 SHEETS  
COMPTON BRANCH, MAP NO. R-111

SHEET NO. 53 OF 58 SHEETS  
COMPTON BRANCH, MAP NO. R-111

CSB-1171-23

AG OF AG

LB. 8/11

Trim Prints

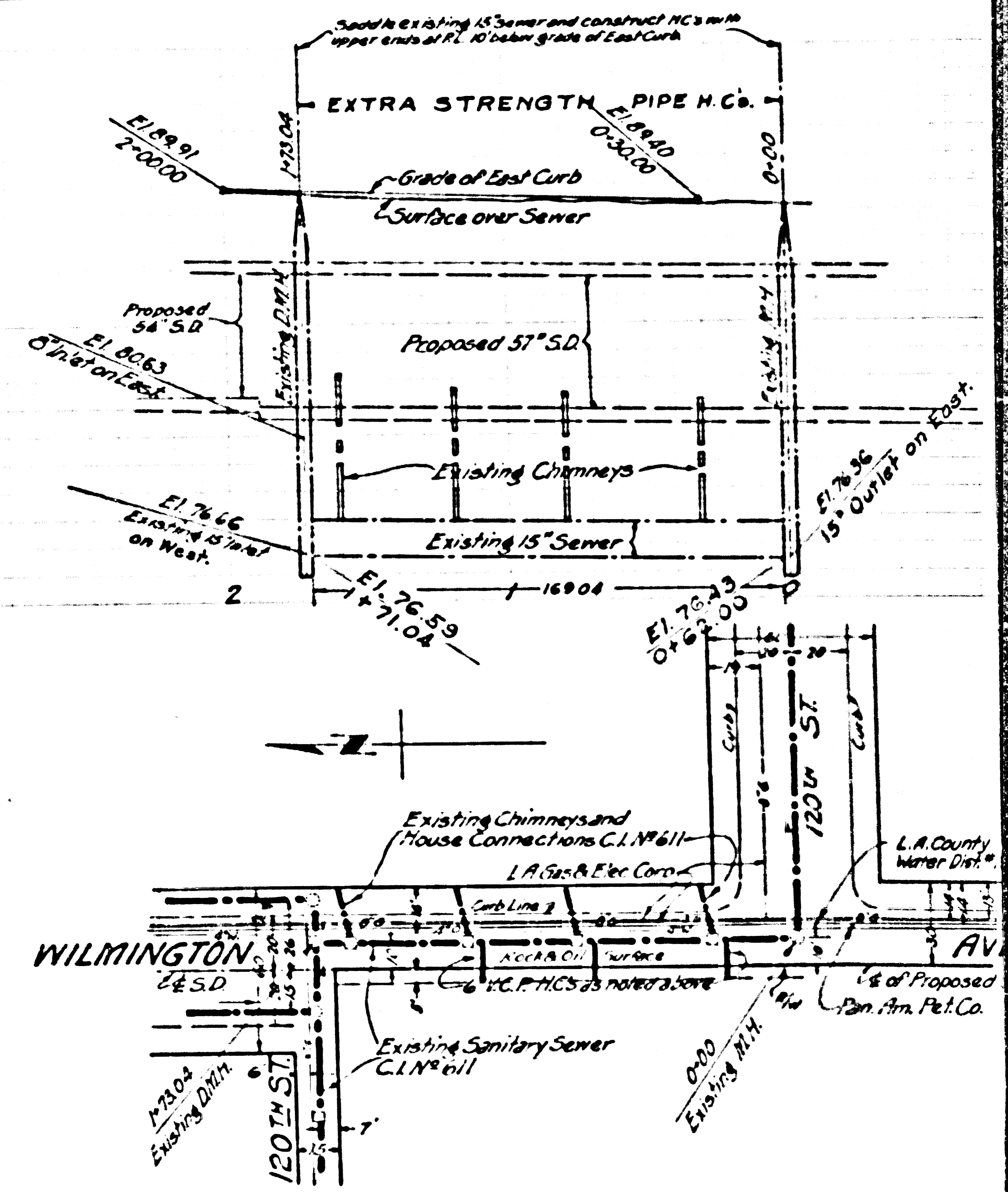
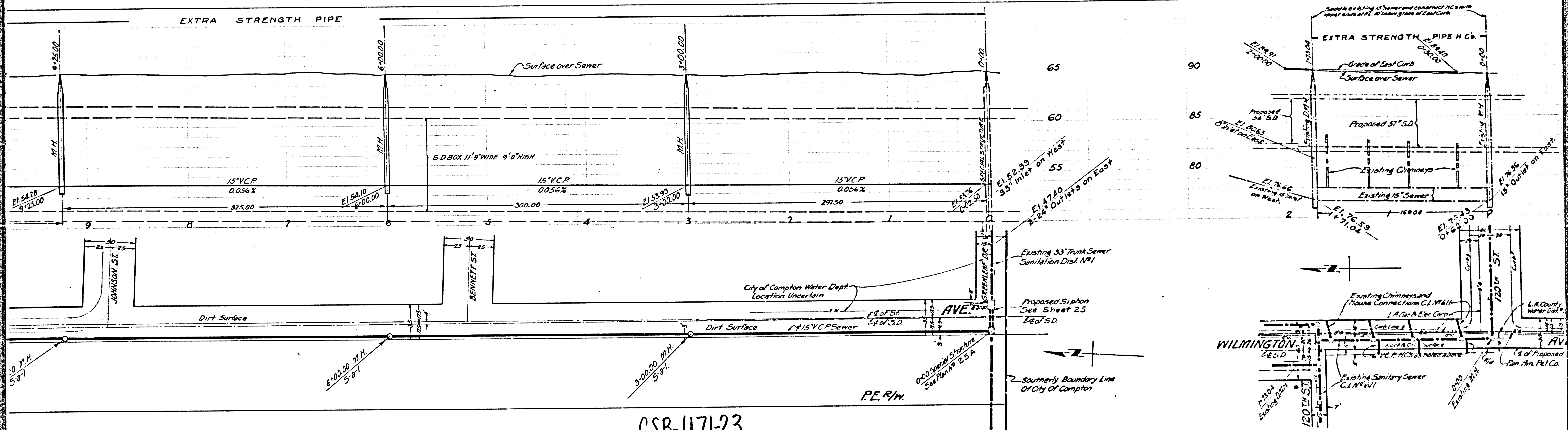

CSB-1171-23  
A2 OF A6

Trace G.G.B. 10-14-35  
W.S. 26

L.B. 641 p. 135