

FOR TOPOGRAPHY WEST, SEE SHEET N02

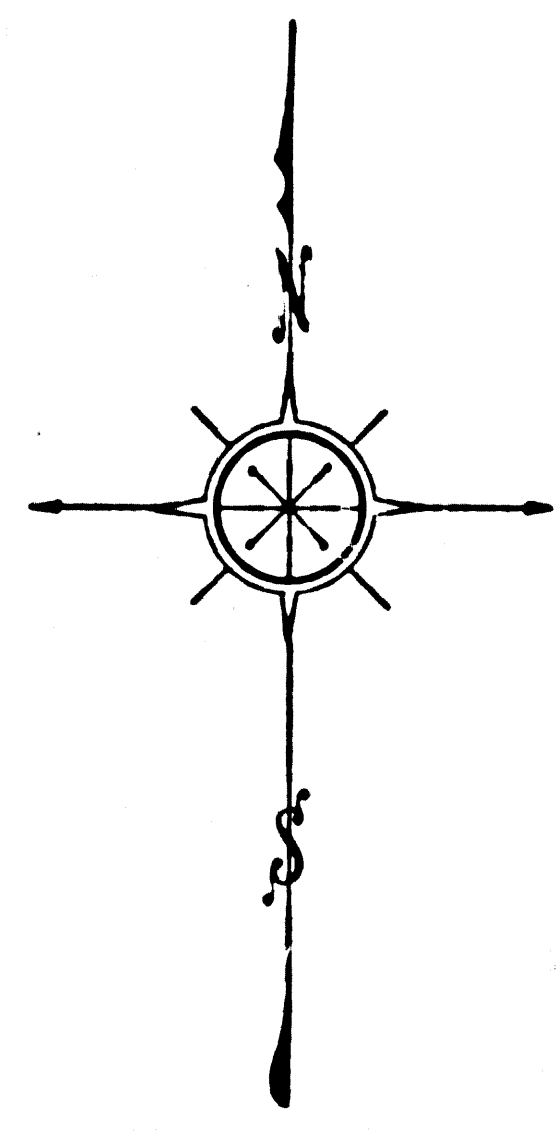
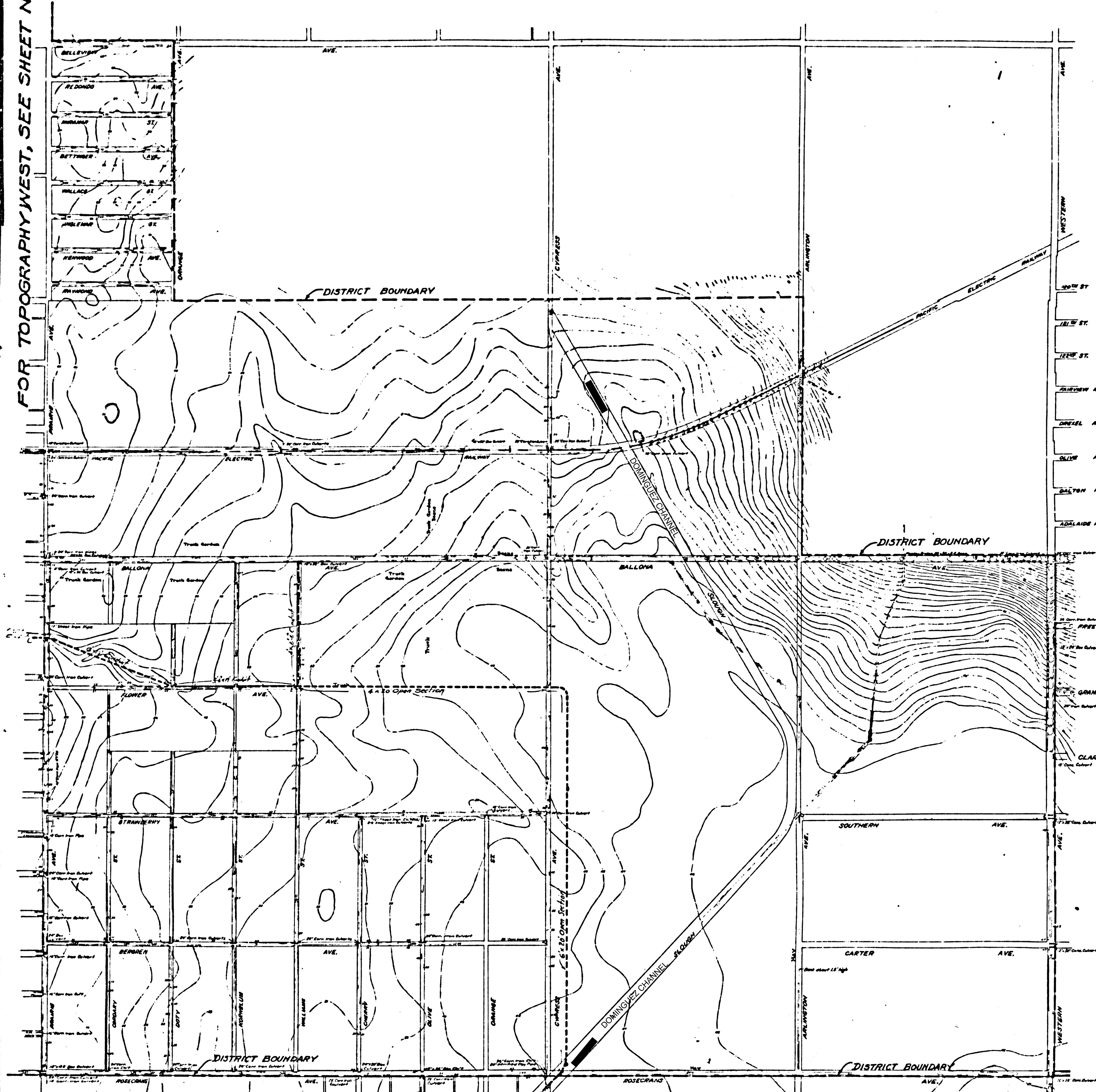

**DRAINAGE DISTRICT
IMPROVEMENT N08**
OF THE
COUNTY OF LOS ANGELES
TOPOGRAPHICAL MAP OF
PORTION OF DISTRICT EAST OF PRAIRIE AVE.
AND SOUTH OF BELLEVUE AVE
SHOWING GENERAL LOCATION OF IMPROVEMENT
SCALE: 1"=400' OCTOBER 1921
SHEET 3 OF 12 SHEETS
J.E. ROCKHOLD - COUNTY SURVEYOR
Submitted: *[Signature]* Approved: *[Signature]*
Senior Engineer County Surveyor
Drawn by A.T. Sumner & Co. Checked by F.H. Adams
Approved as to County Topography by E.T. Water
Edward T. Water
County Eng. Topography
By: *[Signature]*
Chief Dept.

LEGEND
DISTRICT BOUNDARIES, SHOWN
LOCATION OF IMPROVEMENT
Negative of this map filed in Blue Print Dept.
as Negative No. 325 Sht. 3

CSB-1180-3
A1 OF A1