

SHEET NO. 15 OF 21 SHEETS
COUNTY SURVEYORS MAP NO. B-1185

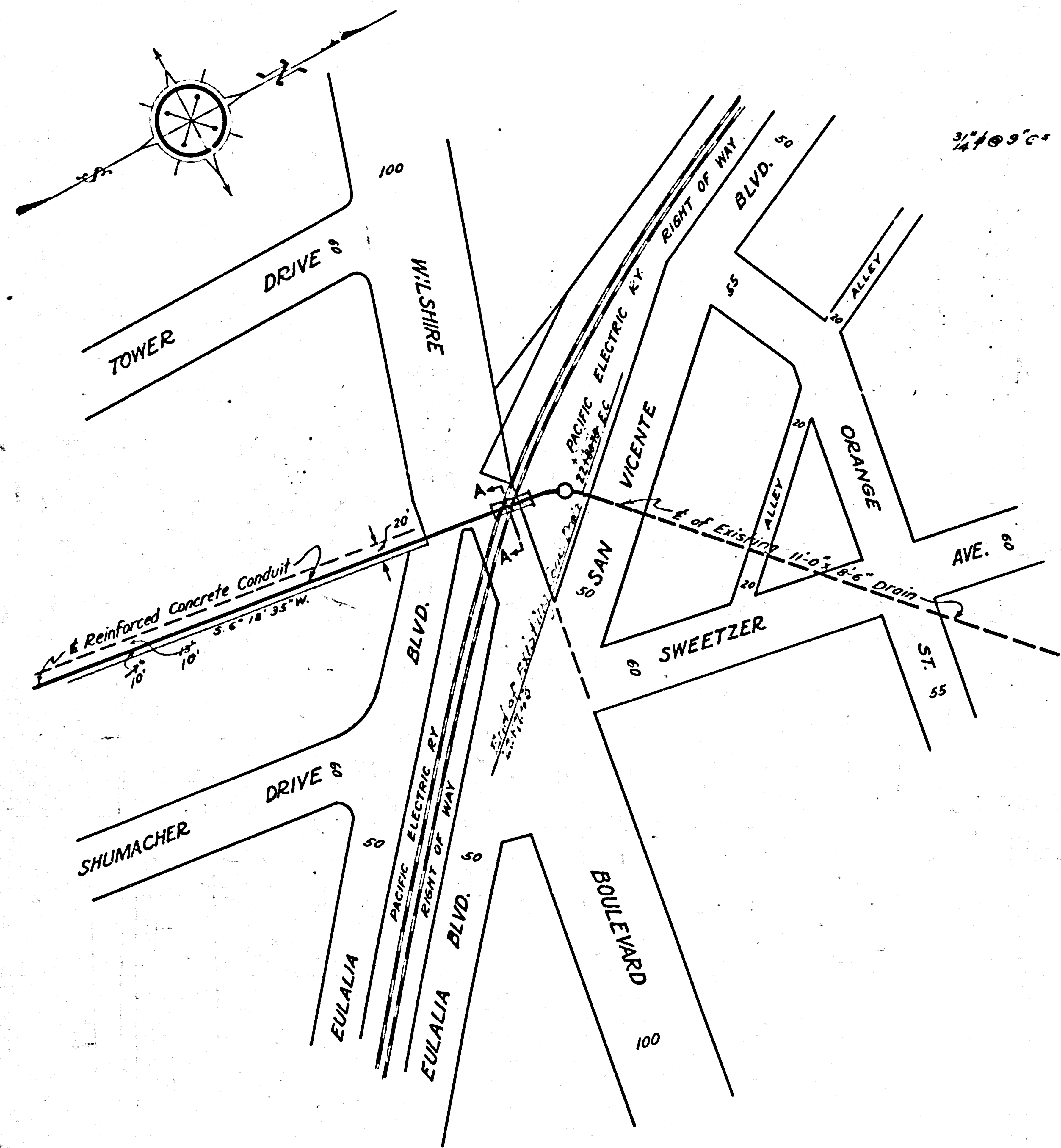

SITUATION SKETCH
Length = 40'-00"
Scale 1" = 100'

NOTE:
Elevation of Top Rail = 141.0
Elevation of Top of Conduit = 137.0

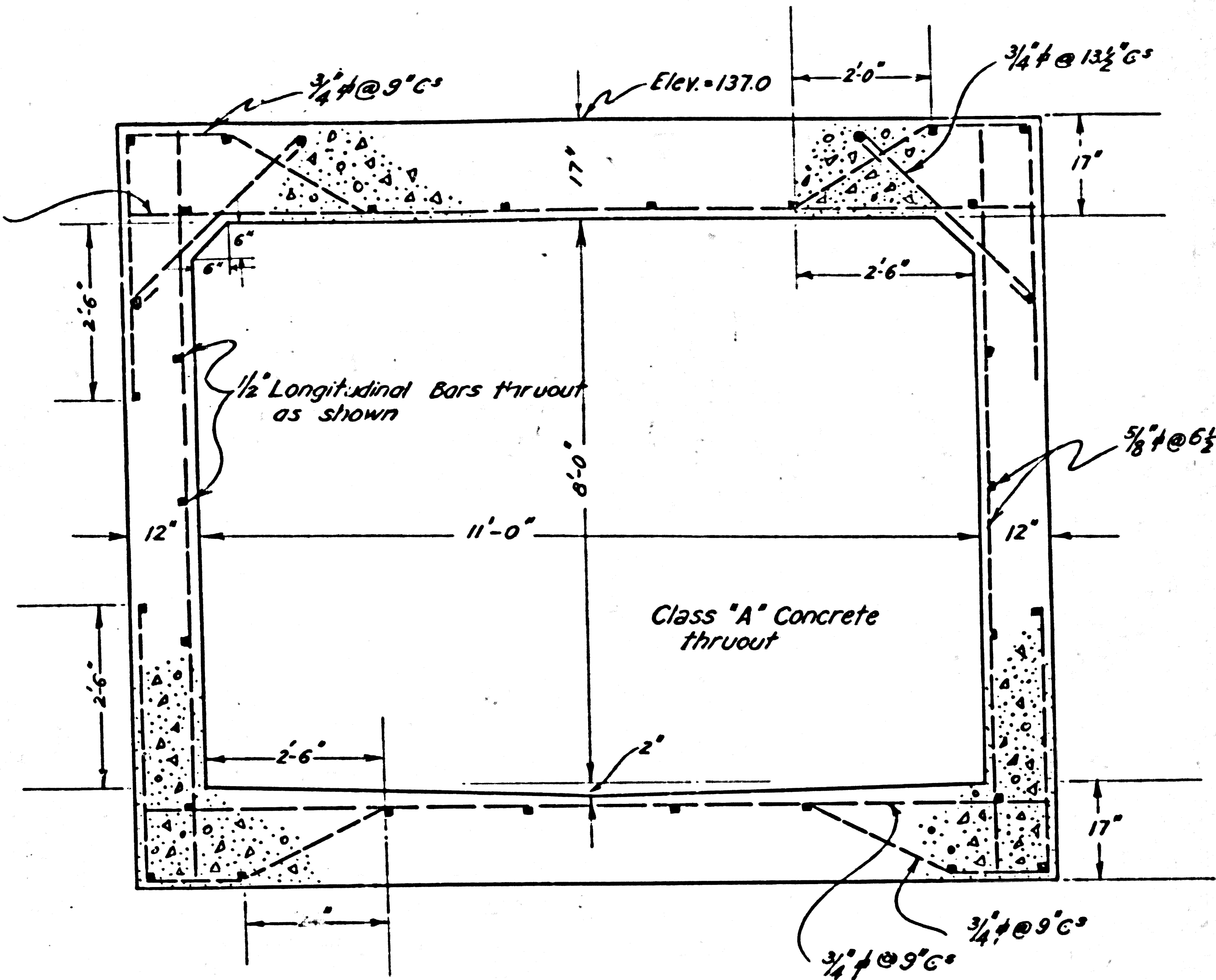

SECTION A-A
Scale 1/2" = 1'
8'-0" x 11'-0" CONDUIT
Under Pacific Electric Ry. Right of Way at WILSHIRE & EULALIA BLVDS.
Length = 40'-0"

DRAINAGE DIST. IMPROVEMENT No. 11
LOS ANGELES COUNTY, CALIFORNIA
CONDUIT SECTION
PACIFIC ELECTRIC RY. Rof W. XING
AT WILSHIRE AND EULALIA BLVDS.
SCALES: - As shown
Nov. 29, 1924

J. E. ROCKHOLD COUNTY SURVEYOR
Submitted *alvarado* Approved *J. E. Rockhold*
SENIOR ENGINEER COUNTY SURVEYOR

Approved as to form
Edward T. Bishop
County Counsel
By *J. J. Moroney*
DEPUTY

CSB 1182-21
A10E A1

D. D. I. No. 11		
DRAWN	AM RAWN	11-28-24
TRACED	JACK RENIE	11-29-24
CHECKED	AM RAWN	12-1-24
REVISION		

SHEET 21 OF 21 SHEETS

SHEET NO. 21 OF 21 SHEETS
COUNTY SURVEYORS MAP NO. B-1185

SHEET NO. 15 OF 21 SHEETS
COUNTY SURVEYORS MAP NO. B-1185

SHEET NO. 21 OF 21 SHEETS
COUNTY SURVEYORS MAP NO. B-1185